

**STRUCTURAL NOTES**

**DESIGN CRITERIA**

1. DESIGNS ARE BASED ON THE FOLLOWING DESIGN BASIS:
  - 1.1. ALLOWABLE BEARING PRESSURE = 1500 PSF - CONTRACTOR RESPONSIBLE FOR PROPER SUBGRADE PREPARATION AND COMPACTION.
  - 1.2. EQUIVALENT FLUID PRESSURE = 35 PSF (HYDROSTATIC PRESSURE NOT INCLUDED)
  - 1.3. PASSIVE PRESSURE = 250 PSF (STRUCTURAL FILL)
  - 1.4. COEFFICIENT OF FRICTION = 0.3
2. WIND SPEED = 104 MPH, CATEGORY II, EXPOSURE B

**CONCRETE**

1. PORTLAND CEMENT ASTM C 150, TYPE I/II
2. 28 DAY COMPRESSIVE STRENGTH OF CONCRETE  $F'_c$  = 3000 PSI
3. 3-5 INCH SLUMP
4. MAXIMUM WATER TO CEMENT RATIO = 0.5
5. MAXIMUM AGGREGATE SIZE = 1 INCH
6. WATER SHALL CONFORM TO ASTM C 94 AND BE POTABLE

**CONCRETE MASONRY UNITS (CMU)**

1. THE NET AREA COMPRESSIVE STRENGTH OF MASONRY,  $F'_m$ , SHALL BE A MINIMUM OF 1500 PSI AS DETERMINED BY THE UNIT STRENGTH METHOD.
2. MASONRY UNITS SHALL CONFORM TO ASTM C90 AND SHALL BE MEDIUM WEIGHT.
3. MORTAR SHALL BE TYPE S or M AND SHALL CONFORM TO ASTM C270 AND THE PROPORTION TABLE OF THE 2021 IBC.
4. 28 DAY COMPRESSIVE STRENGTH OF GROUT SHALL BE 2500 PSI
5. GROUT SHALL BE COURSE AND CONFORM TO ASTM C476 BY VOLUMETRIC PROPORTION. SLUMP SHALL BE WITHIN THE RANGE OF 8" to 11".
6. REINFORCING SHALL COMPLY WITH ASTM A615, GRADE 40
7. INSTALL CONTROL JOINTS WITH ONE VERTICAL BAR EACH SIDE OF JOINT AT A MAXIMUM SPACING OF 12'-0".

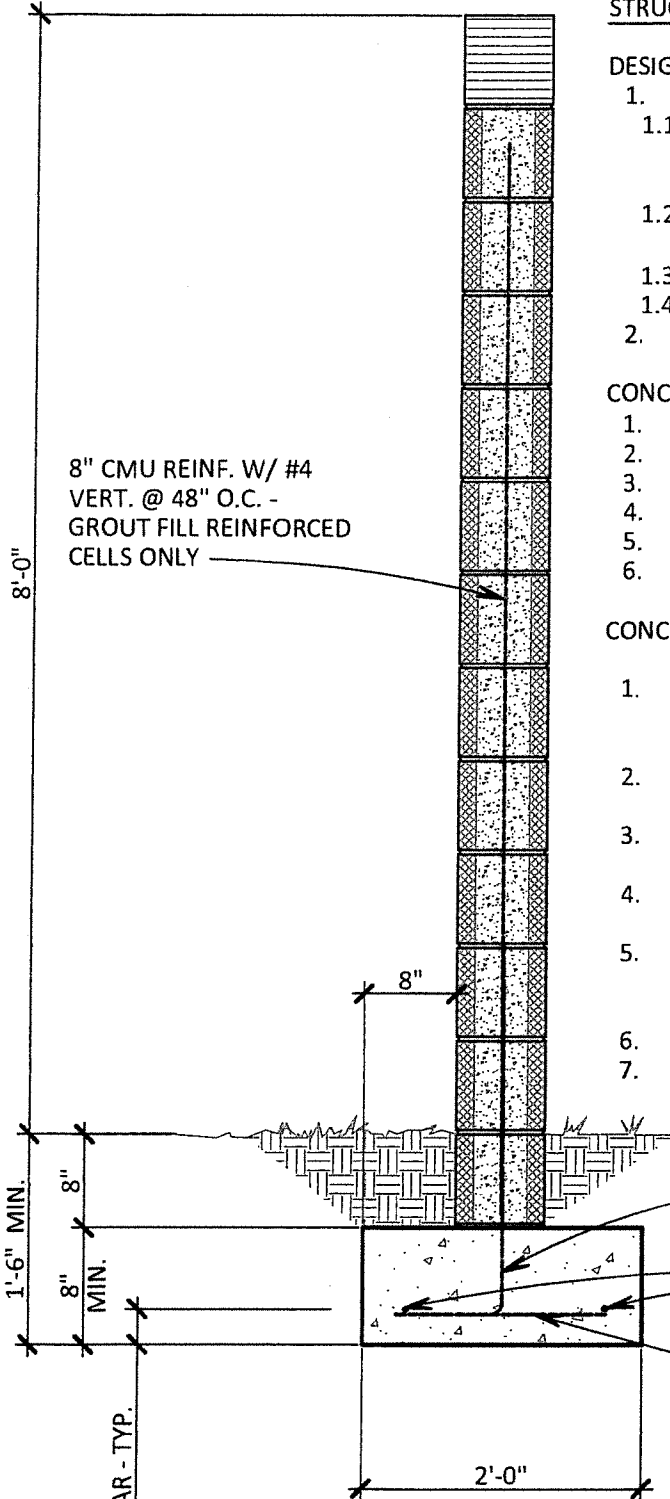

**1**

**8'-0" CMU CMU GARDEN WALL**

3/4" = 1' - 0"

#4 DOWELS @ 48" O.C. W/ 2' MIN. LAP SPLICE  
 2 - #4 CONT.  
 #4 @ 14" O.C.



©Angelini, LLC  
 All rights reserved. All designs, drawings, plans & specifications are the property of Angelini, LLC. Purchaser's rights are conditional & limited to a one-time use to construct a single project on the site & use is limited specifically to such property. The use or reproduction of these plans concerning any other construction is strictly prohibited without the written permission of Angelini, LLC

<p><b>Angelini Engineers</b>                  255 YORKS XING                  DRIFTWOOD, TEXAS 78619                  PH: (512) 565-2396</p>	<p>TYPICAL GARDEN WALL</p>	<p><b>S1.0</b></p>
--	--------------------------------	--------------------

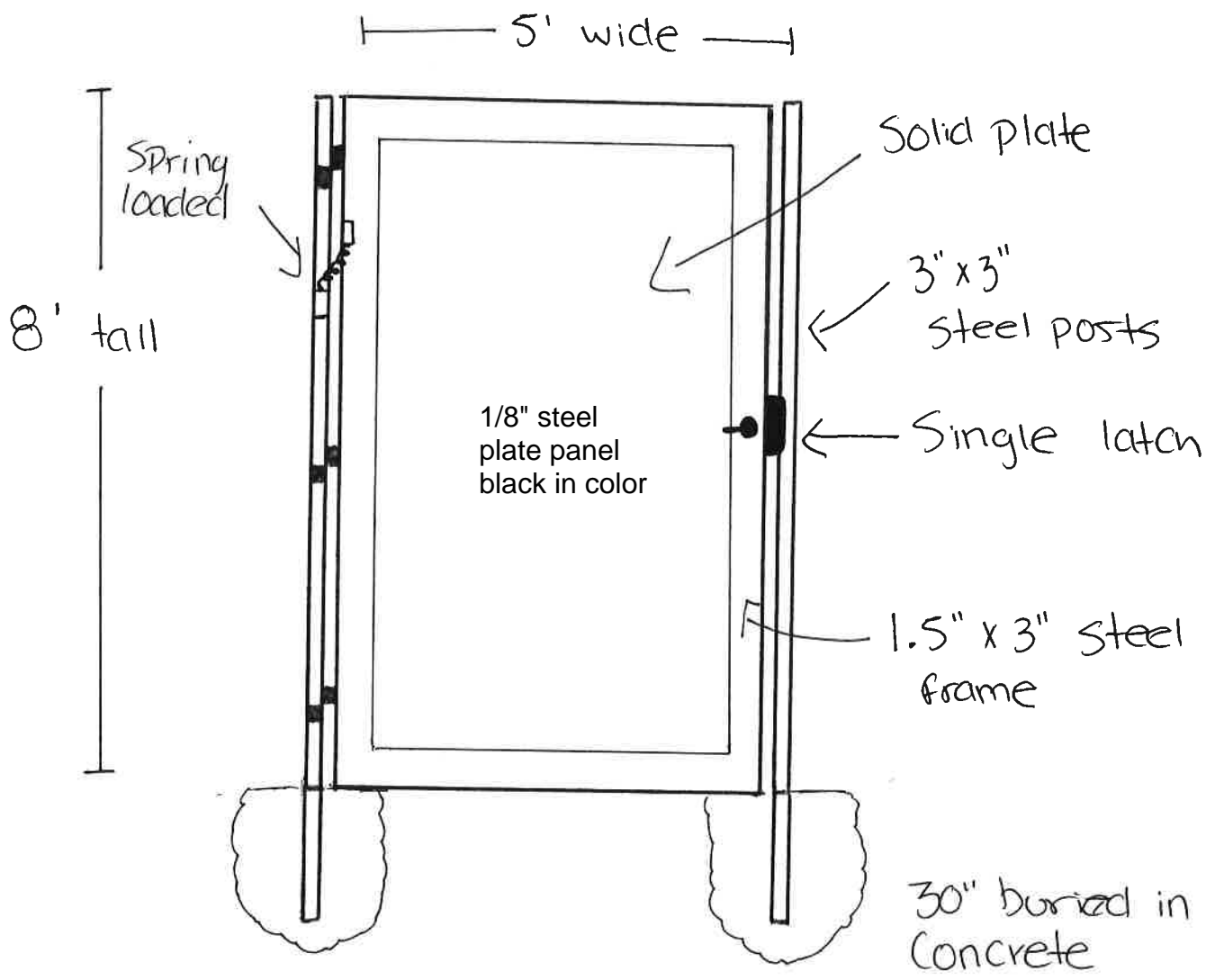

5' wide

8' tall

Spring loaded

Solid plate

3" x 3" steel posts

Single latch

1/8" steel plate panel black in color

1.5" x 3" steel frame

30" buried in Concrete



*Figure 1 Variation in wall height*



*Figure 2 View showing the trail corridor*



*Figure 3 Section of wall with anti-graffiti coating*



*Figure 4 Close up of finished coating*



*Figure 5 View of pedestrian gate opening with pilasters*



*Figure 6 Wall along Miami Road*