

TYPICAL SECTION FOR
32 FT. OR 40 FT. ESTATE TYPE STREET

8' space to do
swale

1-1/2" AC TYPICAL SURFACE COURSE—TYPE C PLACED AFTER ALL MANHOLE, VALVE COVERS/RINGS ARE SET TO GRADE. (SECTION 116,336).

FINISH SURFACE OF SUBGRADE SHALL BE MOISTURE CONTROLLED AT COMPACTION MOISTURE RANGE, AND/OR PRIME COAT APPLIED AS REQUIRED BY THE ENGINEER.

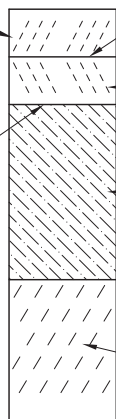

TACK COAT AS REQUIRED BY THE ENGINEER.

1-1/2" AC TYPE C PAVEMENT COURSE (SECTIONS 116, 336).

12" SUBGRADE SOIL R-VALUE > 50. 95% MIN COMPACTION PER SECTION 301.

SEE SECTIONS 202, 204, AND 301 FOR CUT, FILL, AND SUBGRADE CONSTRUCTION REQUIREMENTS.

FLEXIBLE PAVEMENT SECTION

GENERAL NOTES:

1. ESTATE TYPE STREET SECTION TO BE USED ONLY WHEN PERMITTED IN THE APPROVED DRAINAGE PLANS.
2. RIGHT-OF-WAY REQUIREMENTS TO BE ESTABLISHED BY THE DRB. DESIGN OF SIDEWALK CONFIGURATION, DRAINAGE REQUIREMENTS & OTHER APPURTENANCE LOCATIONS SHALL BE APPROVED ON AN INDIVIDUAL SITE BASIS AND SHALL BE SHOWN ON THE PROJECT CONSTRUCTION PLANS.
3. ALL ASPHALT CONCRETE (AC) PAVEMENT SHALL COMPLY WITH SECTION 116.
4. IN ACCORDANCE WITH COA DPM THE FOLLOWING APPLIES UNLESS AUTHORIZED OTHERWISE BY THE CITY ENGINEER:
 - * RESIDENTIAL STREETS SERVING 50 LOTS OR LESS SHALL BE DESIGNED AS LOCAL RESIDENTIAL STREETS.
 - * RESIDENTIAL STREETS SERVING MORE THAN 50 LOTS AND WITH AWDT GREATER THAN 1000 SHALL BE DESIGNED AS MAJOR LOCAL STREETS.
5. FOR SUBGRADE R-VALUE <50, PAVEMENT SECTION SHALL BE DESIGNED IN ACCORDANCE WITH DPM, CH 23.
6. SUBGRADE PREPARATION SHALL BE PERFORMED AFTER ALL SUBSURFACE UTILITIES ARE CONSTRUCTED.

CONSTRUCTION NOTES:

- A. ASPHALT CONCRETE (AC) PAVEMENT.
- B. PROJECT-DESIGNED SWALE.
- C. COMPACTED SUBGRADE, 95% COMPACTION.
- D. MOUNTABLE CURB ESTATE TYPE.
- E. THEORETICAL FACE OF CURB OR FLOWLINE.
- F. SIDEWALK

REVISIONS	CITY OF ALBUQUERQUE
1/91	LOCAL RESIDENTIAL PAVING
12/15/92	ESTATE TYPE STREETS
8/29/94	
	DWG. 2406 JANUARY 2003