

SITE DATA

LOCATION	531 SILVER CREEK RD. N.W. ALBUQUERQUE, NM
LEGAL DESCRIPTION	LOT 21-A MERIDIAN BUSINESS PARK
CURRENT ZONING	NR-BP
ZONE ATLAS PAGE	K-10
BUILDING FOOTPRINT AREA	38,150 SF
NET LOT AREA (LOT AREA - BUILDING AREA)	138,025 SF
NUMBER OF UNITS	1 BUILDING
PAVED AREA	111,600 SF
REQUIRED PARKING	SELF STORAGE 1/3000 SQ.FT.=13 SPACES
PARKING PROVIDED	45 SPACES
REQUIRED ADA PARKING	3 SPACES (1 VAN)
PROVIDED ADA PARKING	4 SPACES (1 VAN)
REQUIRED MC PARKING	1 SPACE
PROVIDED MC PARKING	5 SPACES
REQUIRED BICYCLE PARKING	3 SPACES
PROVIDED BICYCLE PARKING	4 SPACES

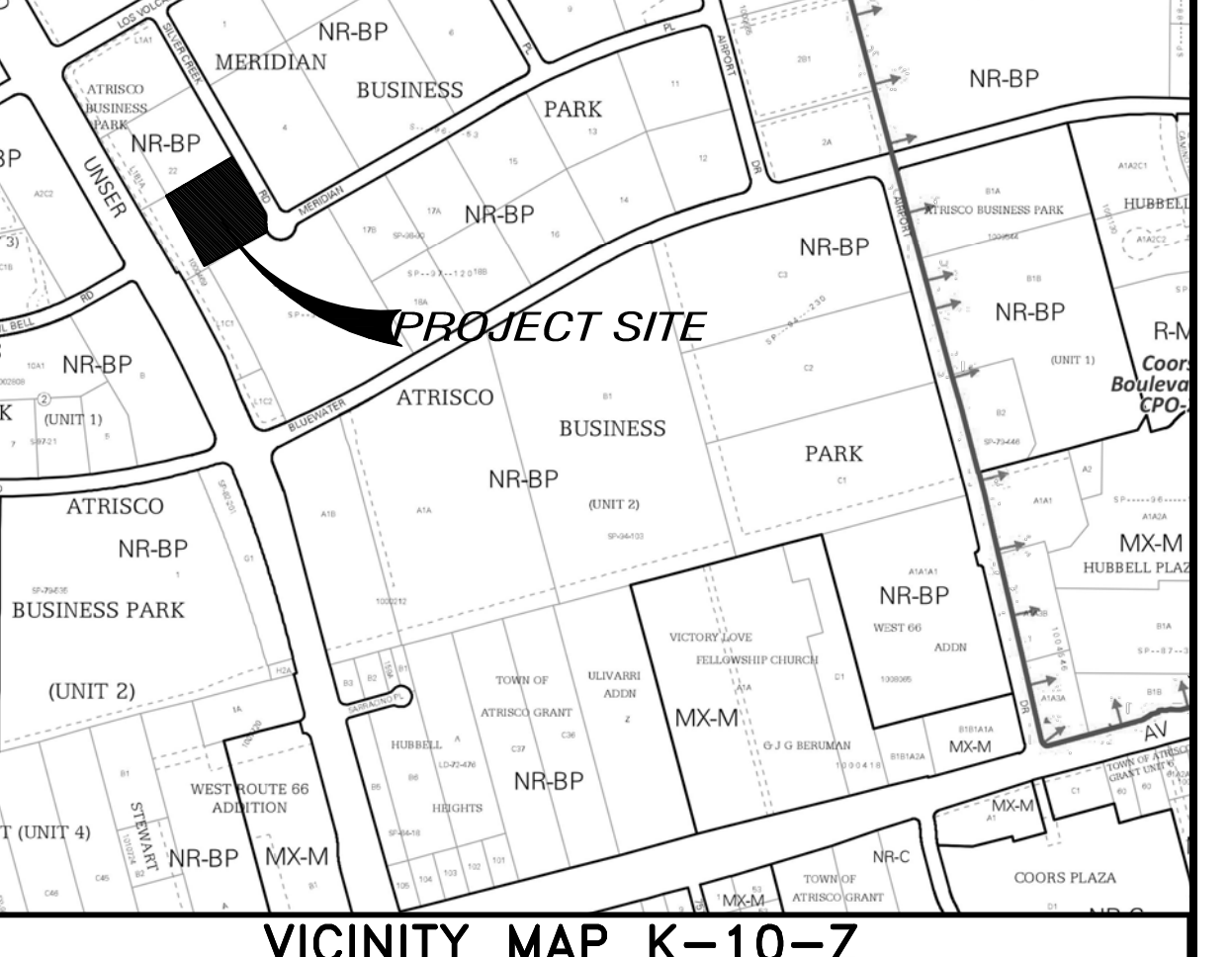

1 PARKING DETAIL
Scale: 1"=5'

2 ADA PARKING DETAILS
Scale: 1"=5'

3 ADA SIGNAGE DETAIL
Scale: NTS

4 MOTORCYCLE PARKING DETAIL
Scale: 1"=5'

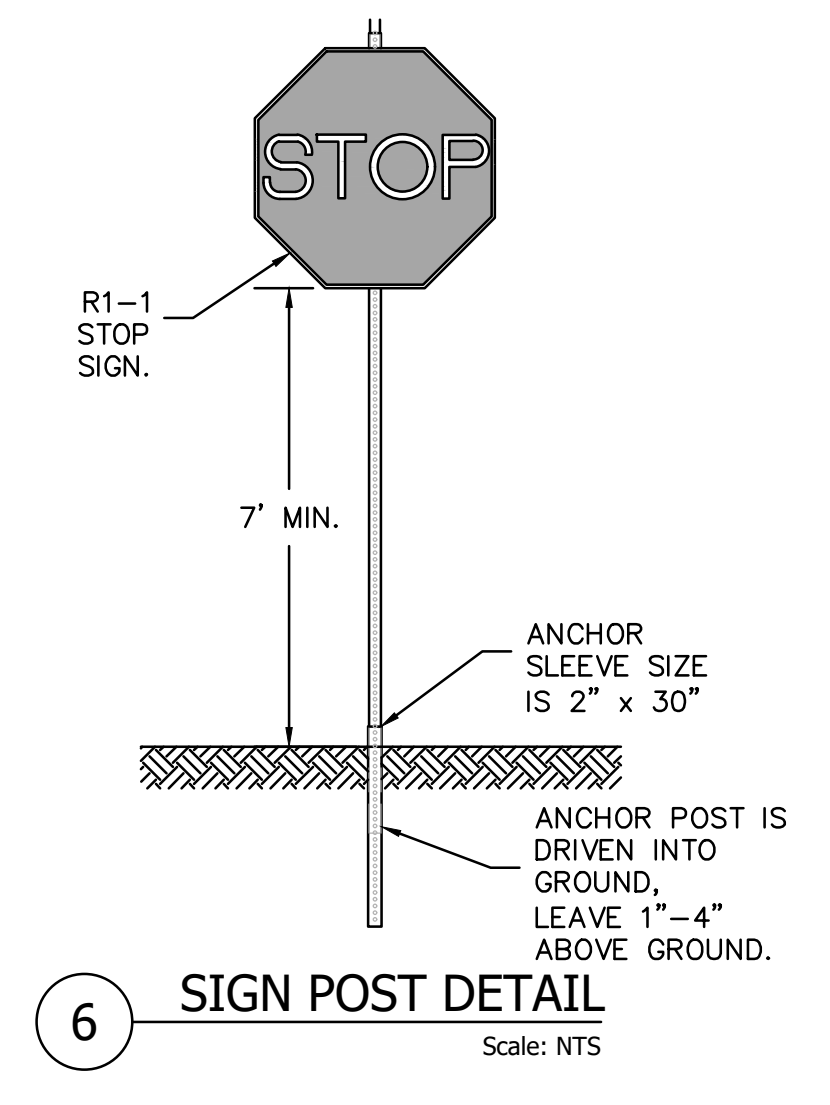
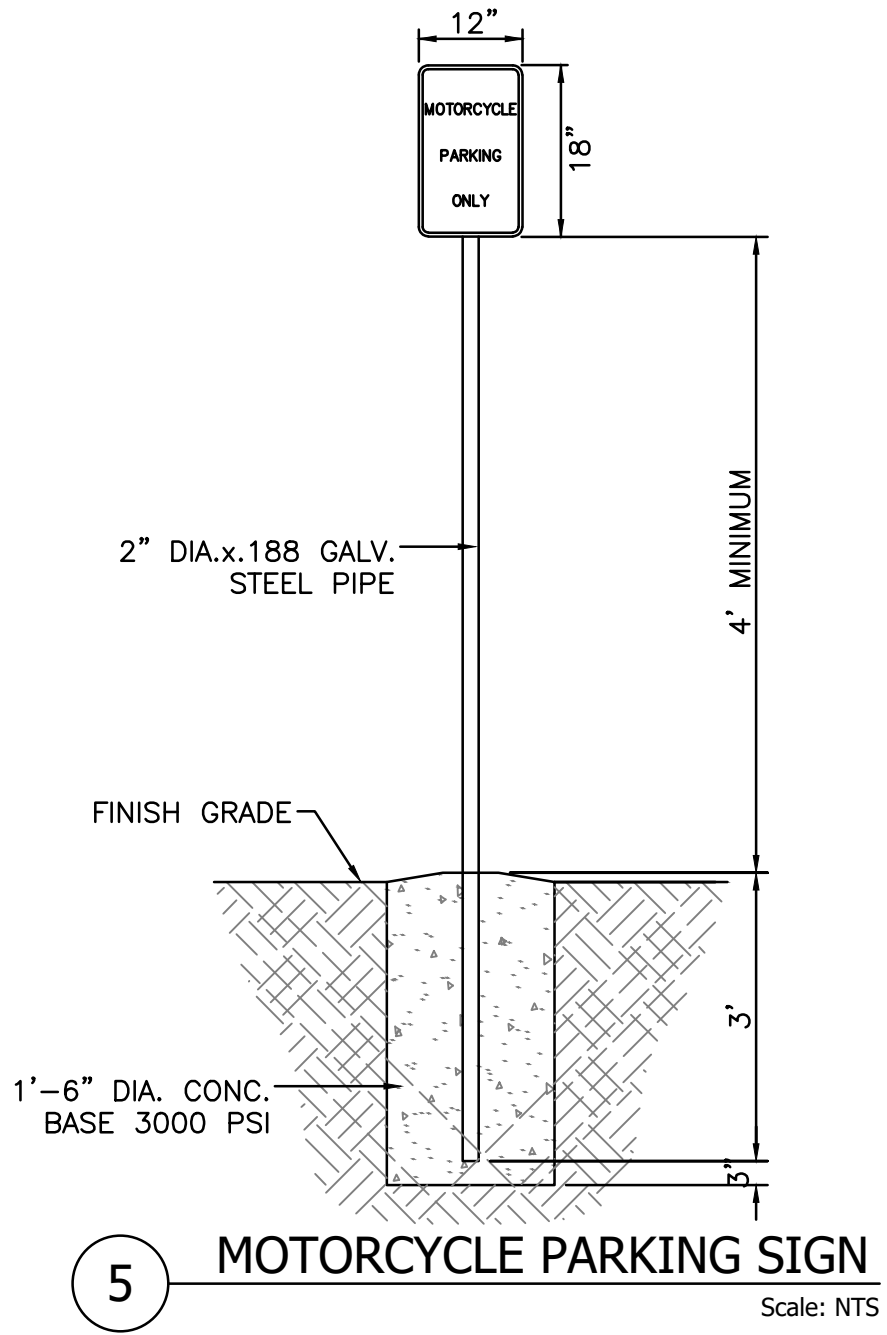

5 MOTORCYCLE PARKING SIGN
Scale: NTS

6 SIGN POST DETAIL
Scale: NTS

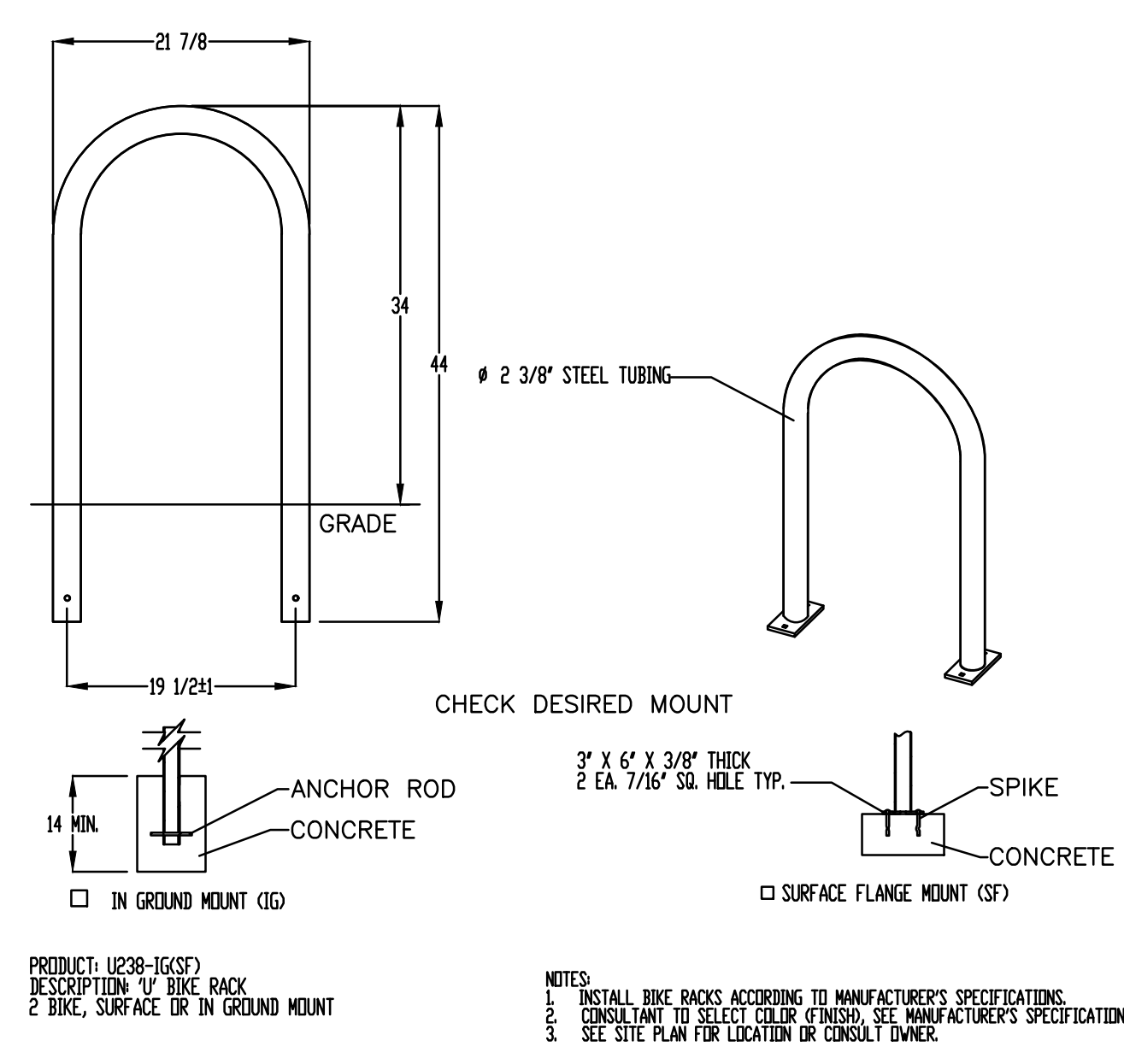
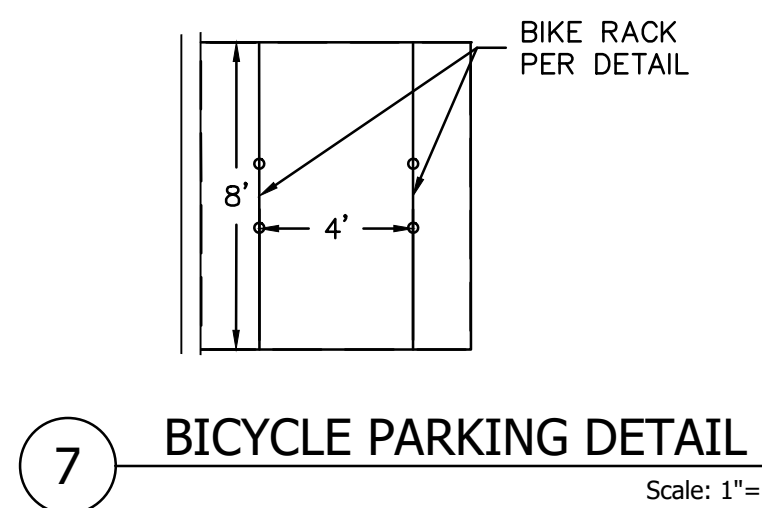

8 BIKE RACK DETAIL
Scale: NTS

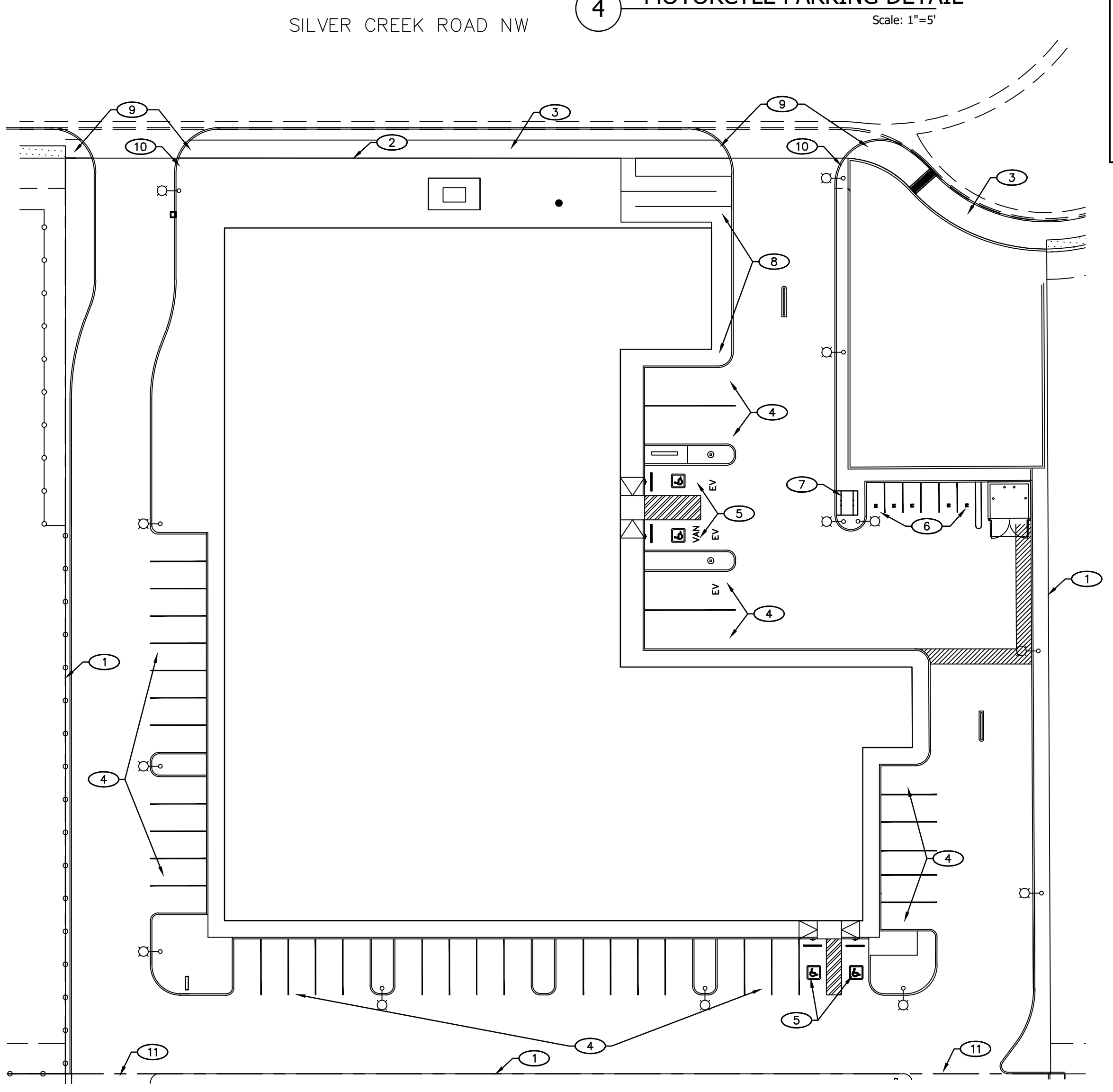

GENERAL NOTES

- ALL WORK DETAILED ON THESE PLANS TO BE PERFORMED UNDER THIS CONTRACT SHALL, EXCEPT AS OTHERWISE STATED OR PROVIDED HEREIN, BE CONSTRUCTED IN ACCORDANCE WITH THE CITY OF ALBUQUERQUE STANDARD SPECIFICATIONS
- CURB DIMENSIONS ARE TO FACE OF CURB UNLESS OTHERWISE NOTED.
- WORK WITHIN CITY ROW WILL REQUIRE CITY WORK ORDER
- SITE LIGHTING - LIGHTING PROVIDED ON BUILDING FACADES AND IN THE PARKING LOT TO BE CUT-OFF TYPE ANGLED TO BE NON-INTRUSIVE TO ADJACENT PROPERTIES AND RIGHT-OF-WAYS
- SEE GEO-TECHNICAL REPORT FOR SUB-GRADE PREP REQUIREMENTS OF THE BUILDING AND PARKING LOT
- ALL BROKEN OR CRACKED SIDEWALK MUST BE REPLACED WITH SIDEWALK AND CURB & GUTTER PER COA STD DWG 2415

KEYED NOTES

- PROPERTY LINE
- RIGHT OF WAY
- 5' SIDEWALK
- STANDARD PARKING SPACE (TYP.) PER DETAIL
- ADA PARKING PER DETAILS
- MOTORCYCLE PARKING PER DETAIL
- BICYCLE PARKING PER DETAIL
- 6' ADA ROUTE WITH 1.5% (2% MAX) CROSS SLOPE
- HANDICAP RAMP W/ TRUNCATED DOME SURFACE
- STOP SIGN R1-1
- SHARED ACCESS PER PLAT

TRAFFIC CIRCULATION LAYOUT APPROVED

Sertil A. Kanbar 7/31/2025

Signed Date

IRON E. HENSLEY
NEW MEXICO
21850
LICENSED PROFESSIONAL ENGINEER
JUNE 5, 2025

THE group

THE HENSLEY ENGINEERING GROUP
300 BRANDING IRON RD. SE
RIO RANCHO, NEW MEXICO 87124
Phone: (505) 410-1622

Afra Construction & Design
2501 Yale Blvd SE Suite 102
Albuquerque, New Mexico 87106
Tel 505.242.1745
Fax 505.242.1737

Excess Space Storage
531 Silver Creek Rd NW
Albuquerque New Mexico 87121

REV	DATE	DESCRIPTION	APVD

TCL
6/5/2025

