



City of Albuquerque
P.O. Box 1293 Albuquerque, NM 87103
Planning Department
Alan Varela, Interim Director

Tim Keller, Mayor
Sarita Nair, CAO

DATE: 10-14-2024

SUBJECT: Albuquerque Archaeological Ordinance - Compliance Documentation

Case Number(s): 1002322, ZA-97-89, V84-23, Z-1028
Agent: David Aube (Studio Southwest Architects)
Applicant: Albuquerque Collegiate Charter School
Legal Description: LOT 23 EXC N 300FT BLK 11 ORIGINAL TOWNSITE OF WESTLAND CONT 8.19 AC
Zoning: NR-C
Acreage: 8.19
Zone Atlas Page(s): L-09-Z

CERTIFICATE OF NO EFFECT: Yes No

CERTIFICATE OF APPROVAL: Yes No

SUPPORTING DOCUMENTATION:

SITE VISIT:

RECOMMENDATIONS:

SUBMITTED BY:

SUBMITTED TO:

Planning, Development Services

Date

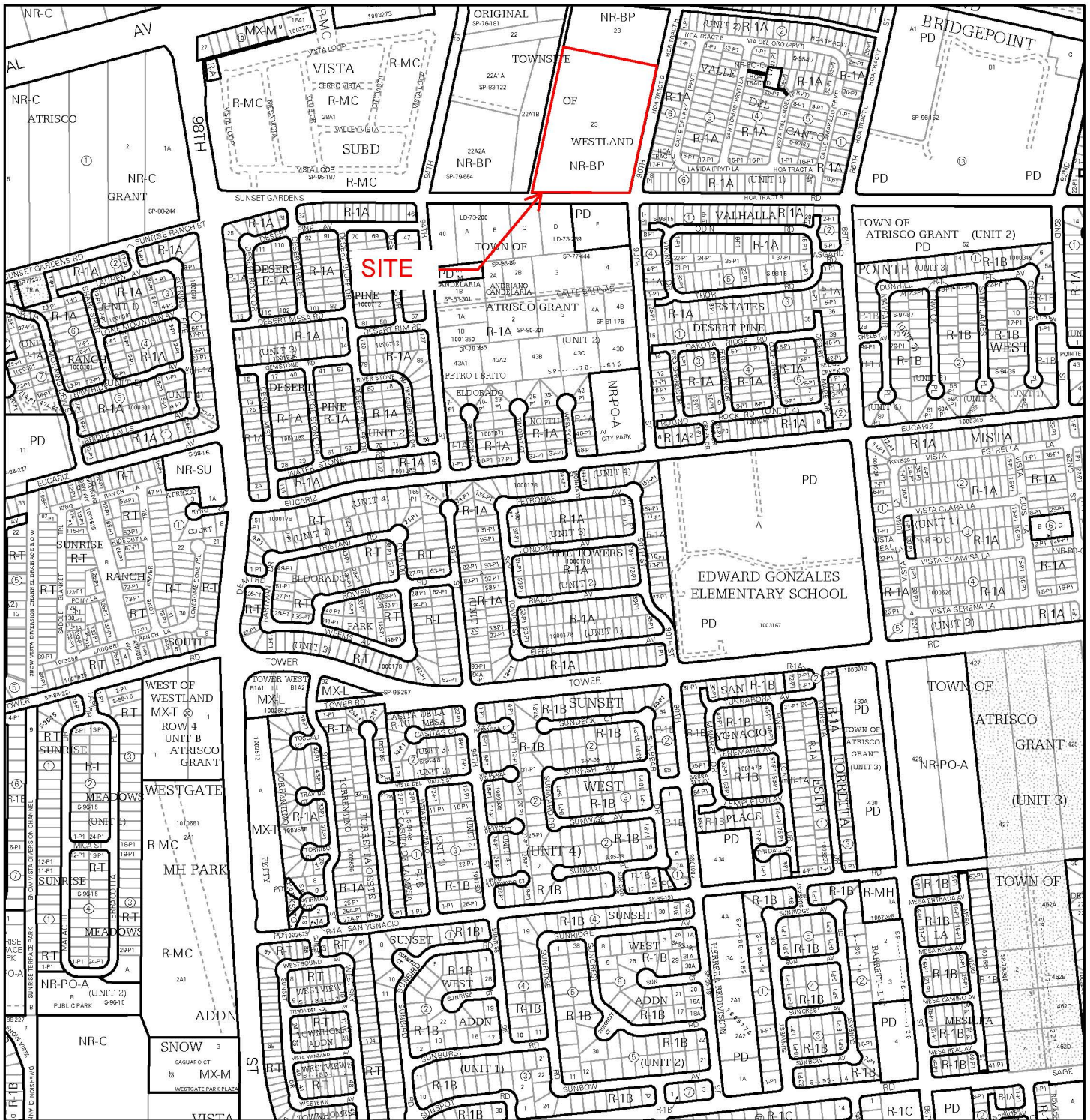

For more details about the Integrated Development Ordinance visit: <http://www.cabq.gov/planning/codes-policies-regulations/integrated-development-ordinance>

IDO Zone Atlas

May 2018



IDO Zoning information as of May 17, 2018
The Zone Districts and Overlay Zones are established by the Integrated Development Ordinance (IDO).

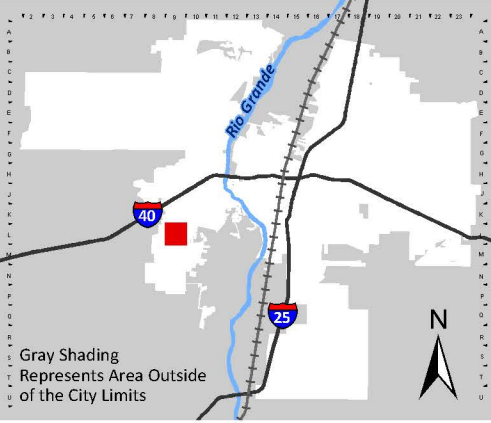

Zone Atlas Page:
L-09-Z

- Easement
- Escarpment
- Petroglyph National Monument
- Areas Outside of City Limits
- Airport Protection Overlay (APO) Zone
- Character Protection Overlay (CPO) Zone
- Historic Protection Overlay (HPO) Zone
- View Protection Overlay (VPO) Zone

Feet
0 250 500 1,000