

FILE COPY



City of Albuquerque

P.O. BOX 1293 ALBUQUERQUE, NEW MEXICO 87103

January 9, 1990

Jeff Mortensen, P.E.
Jeff Mortensen & Associates, Inc.
811 Dallas, NE
Albuquerque, New Mexico 87110

RE: DRAINAGE PLAN FOR AN ADDITION TO CIBOLA HIGH SCHOOL
(A-13/D4) ENGINEER'S STAMP DATED OCTOBER 8, 1989

Dear Mr. Mortensen:

Based on the information provided on your submittal of December 21, 1989, the referenced drainage plan is approved for Foundation Permit.

Please be advised that prior to Building Permit release, we will need a revised drainage plan which addresses all concerns that Mr. Charles Easterling, on behalf of ABQ Development has voiced on their February 28, 1989 letter to Mr. Cliff Anderson of AMAFCA.

Also, please provide Cliff Anderson and Charles Easterling with a copy of the plan which will address their concerns.

It is critical that the information required pertaining to the ponding capacities within the Cibola High School area be submitted as soon as possible. This will avoid a conflict when applying for the building permit.

If I can be of further assistance, please feel free to call me at 768-2650.

Cordially,

Bernie J. Montoya, C.E.
Engineering Assistant

xc: Cliff Anderson
Charles Easterling

BJM/bsj
(WP+1322)

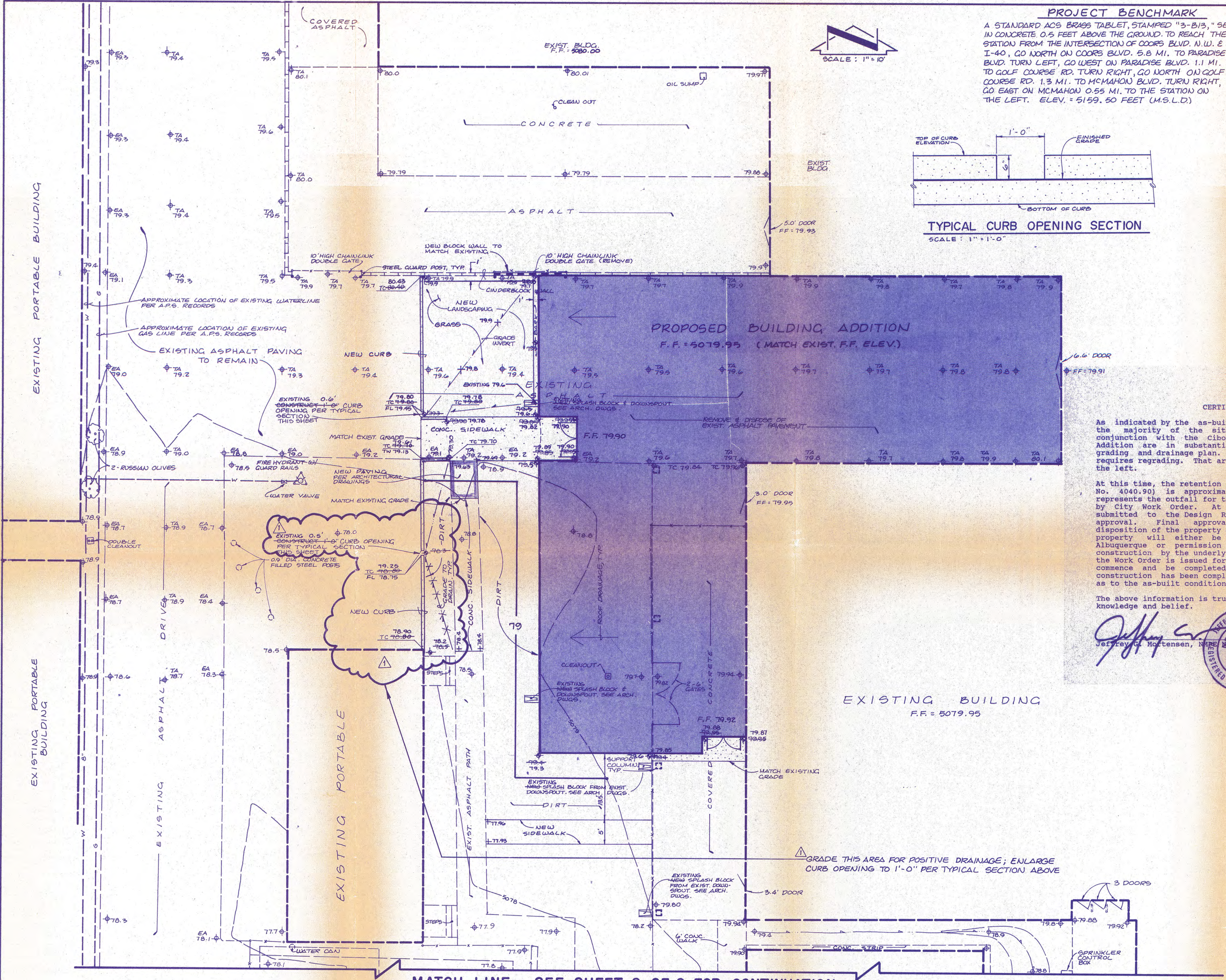

PROJECT BENCHMARK
A STANDARD ACS BRASS TABLE, STAMPED "3-B13," SET IN CONCRETE 0.5 FEET ABOVE THE GROUND. TO REACH THE STATION FROM THE INTERSECTION OF COORS BLVD. N.W. & I-40, GO NORTH ON COORS BLVD. 5.8 MI. TO PARADISE BLVD. TURN LEFT, GO WEST ON PARADISE BLVD. 1.1 MI. TO GOLF COURSE RD. TURN RIGHT, GO NORTH ON GOLF COURSE RD. 1.3 MI. TO MCMAHON BLVD. TURN RIGHT, GO EAST ON MCMAHON 0.55 MI. TO THE STATION ON THE LEFT. ELEV. = 5159.50 FEET (M.S.L.D.)

LEGAL DESCRIPTION
TRACT 1, CIBOLA HIGH SCHOOL
T.B.M.
TOP OF CONCRETE @ SOUTHWEST CORNER OF 10' SIDEWALK AS SHOWN ON SHEET 2.
ELEVATION = 5079.53 FEET (M.S.L.D.)

- LEGEND**
- 5079 EXISTING CONTOUR
 - EXISTING SPOT ELEVATION
 - EXISTING CHAINLINK FENCE
 - EXISTING SWALE
 - T.A. TOP OF ASPHALT
 - EA EDGE OF ASPHALT
 - PROPOSED BLDG. ADDITION
 - PROPOSED CONCRETE
 - PROPOSED SPOT ELEVATION
 - 70 PROPOSED CONTOUR
 - PROPOSED ASPHALT
 - AS-BUILT ELEVATION

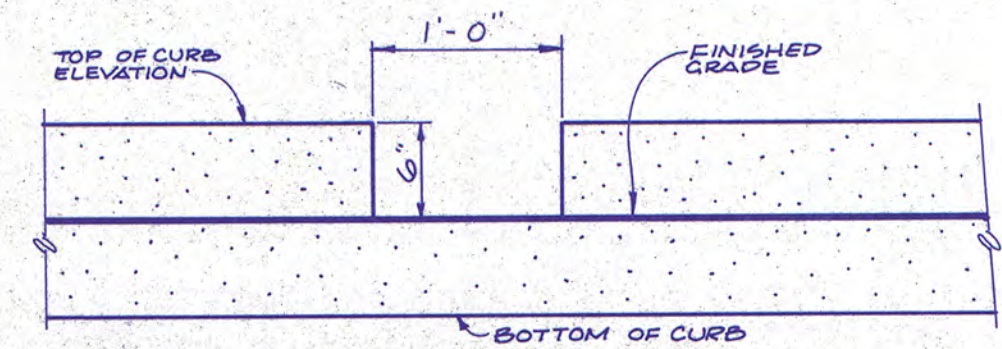

TYPICAL CURB OPENING SECTION
SCALE: 1" = 1'-0"

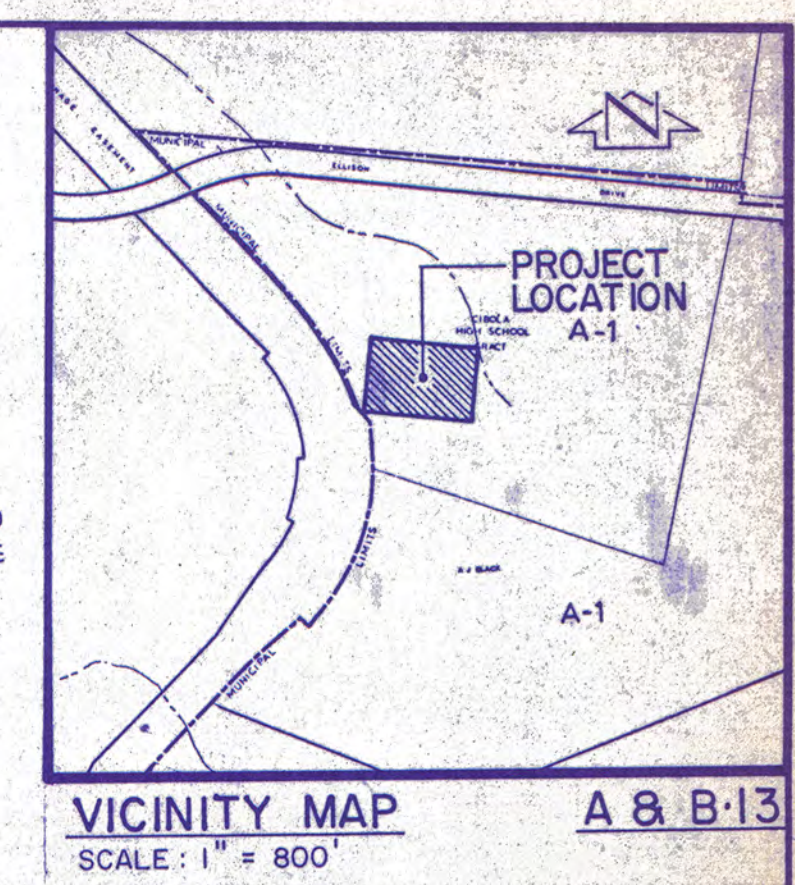

CERTIFICATION
As indicated by the as-built spot elevations shown hereon, the majority of the site improvements constructed in conjunction with the Cibola High School Science Building Addition are in substantial compliance with the approved grading and drainage plan. There is one area, however, that requires regrading. That area is "bubbled" on the drawing to the left.
At this time, the retention pond construction (City Project No. 4040.90) is approximately 50% complete. This pond represents the outfall for this site and is to be constructed by City Work Order. At present, the plans have been submitted to the Design Review Committee for review and approval. Final approval is being withheld pending disposition of the property upon which the pond lies. That property will either be reclaimed to the City of Albuquerque or permission granted for the continuance of construction by the underlying property owner. As soon as the Work Order is issued for the project, construction will commence and be completed shortly thereafter. Once the construction has been completed, certification will be made as to the as-built conditions of the pond.

The above information is true and correct to the best of my knowledge and belief.

Jeffrey G. Mortensen, N.E. 8547
REGISTERED PROFESSIONAL ENGINEER
NEW MEXICO

09-10-90
Date

- CONSTRUCTION NOTES:**
- Two (2) working days prior to any excavation, contractor must contact line locating service 765-1234, for location of existing utilities.
 - Prior to construction, the contractor shall excavate and verify the horizontal and vertical location of all potential obstructions. Should a conflict exist, the contractor shall notify the engineer in writing so that the conflict can be resolved with a minimum amount of delay.
 - All work on this project shall be performed in accordance with applicable federal, state and local laws, rules and regulations concerning construction safety and health.
 - All construction within public right-of-way shall be performed in accordance with applicable City of Albuquerque Standards and Procedures.
 - If any utility lines, pipelines, or underground utility lines are shown on these drawings, they are shown in an approximate manner only, and such lines may exist where none are shown. If any such existing lines are shown, the location is based upon information provided by the owner of said utility, and the information may be incomplete, or may be obsolete by the time construction commences. The engineer has conducted only preliminary investigation of the location, depth, size, or type of existing utility lines, pipelines, or underground utility lines. This investigation is not conclusive, and may not be complete, therefore, makes no representation pertaining thereto, and assumes no responsibility or liability therefor. The contractor shall inform itself of the location of any utility line, pipeline, or underground utility line in or near the area of the work in advance of and during excavation work. The contractor is fully responsible for any and all damage caused by its failure to locate, identify and preserve any and all existing utilities, pipelines, and underground utility lines. In planning and conducting excavation, the contractor shall comply with state statutes, municipal and local ordinances, rules and regulations, if any, pertaining to the location of these lines and facilities.
 - The design of planters and landscaped areas is not part of this plan. All planters and landscaped areas adjacent to the building(s) shall be provided with positive drainage to avoid any ponding adjacent to the structure. For construction details, refer to landscaping plan.

Erosion Control Measures

- The contractor shall ensure that no soil erodes from the site into public right-of-way or onto private property. This can be achieved by constructing temporary berms at the property lines and wetting the soil to keep it from blowing.
- The contractor shall promptly clean up any material excavated within the public right-of-way so that the excavated material is not susceptible to being washed down the street.
- The contractor shall secure "Topsoil Disturbance Permit" prior to beginning construction.

RECEIVED
SEP 11 1990
CROLOGY DIVISION

JEFFREY G. MORTENSEN
REGISTERED PROFESSIONAL ENGINEER
NEW MEXICO
8547
10-08-89



JEFF MORTENSEN & ASSOCIATES, INC.
811 DALLAS, N.E. ALBUQUERQUE, NM 87110
ENGINEERS & ARCHITECTS (505) 265-5611

GRADING AND DRAINAGE PLAN
CIBOLA HIGH SCHOOL SCIENCE BUILDING ADDITION

DESIGN BY	L.P.U.
DRAWN BY	S.G.H.
APPROVED BY	J.G.M.

No.	Date	By	Revision
1	09/07/90	J.G.M.	AS-BUILT & CERTIFICATION

JOB NO.	30946
DATE	8 - 89
SHEET	OF
1	2