

GENERAL EROSION NOTES

- A. CONTRACTOR SHALL IMPLEMENT BEST MANAGEMENT PRACTICES AS REQUIRED BY THIS STORM WATER POLLUTION PREVENTION PLAN. ADDITIONAL BEST MANAGEMENT PRACTICES SHALL BE IMPLEMENTED AS DICTATED BY CONDITIONS AT NO ADDITIONAL COST OF OWNER THROUGHOUT ALL PHASES OF CONSTRUCTION.
- B. BEST MANAGEMENT PRACTICES (BMP'S) AND CONTROLS SHALL CONFORM TO FEDERAL, STATE, OR LOCAL REQUIREMENTS OR MANUAL OF PRACTICE, AS APPLICABLE. CONTRACTOR SHALL IMPLEMENT ADDITIONAL CONTROLS AS DIRECTED BY PERMITTING AGENCY OR OWNER.
- C. SITE MAP MUST CLEARLY DELINEATE ALL STATE WATERS. PERMITS FOR ANY CONSTRUCTION ACTIVITY IMPACTING STATE WATERS OR REGULATED WETLANDS MUST BE MAINTAINED ON SITE AT ALL TIMES.
- D. CONTRACTOR TO LIMIT DISTURBANCE OF SITE IN STRICT ACCORDANCE WITH EROSION CONTROL SEQUENCING SHOWN ON THIS PLAN, OR AS REQUIRED BY THE APPLICABLE GENERAL PERMIT. NO UNNECESSARY OR IMPROPERLY SEQUENCED CLEARING AND/OR GRADING SHALL BE PERMITTED.
- E. GENERAL CONTRACTOR SHALL DENOTE ON PLAN THE TEMPORARY PARKING AND STORAGE AREA WHICH SHALL ALSO BE USED AS THE EQUIPMENT MAINTENANCE AND CLEANING AREA, EMPLOYEE PARKING AREA, AND AREA FOR LOCATING PORTABLE FACILITIES, OFFICE TRAILERS, AND TOILET FACILITIES. CONTRACTOR SHALL CONSTRUCT TEMPORARY BERM ON DOWNSTREAM SIDES AS NEEDED.
- F. ALL WASH WATER (CONCRETE TRUCKS, VEHICLE CLEANING, EQUIPMENT CLEANING, ETC.) SHALL BE DETAINED AND PROPERLY TREATED OR DISPOSED.
- G. SUFFICIENT OIL AND GREASE ABSORBING MATERIALS AND FLOTATION BOOMS SHALL BE MAINTAINED ON SITE OR READILY AVAILABLE TO CONTAIN AND CLEAN-UP FUEL OR CHEMICAL SPILLS AND LEAKS.
- H. DUST ON THE SITE SHALL BE MINIMIZED. THE USE OF MOTOR OILS AND OTHER PETROLEUM BASED OR TOXIC LIQUIDS FOR DUST SUPPRESSION OPERATIONS IS PROHIBITED.
- I. RUBBISH, TRASH, GARBAGE, LITTER, OR OTHER SUCH MATERIALS SHALL BE DEPOSITED INTO SEALED CONTAINERS. MATERIALS SHALL BE PREVENTED FROM LEAVING THE PREMISES THROUGH THE ACTION OF WIND OR STORMWATER DISCHARGE INTO DRAINAGE DITCHES OR WATERS OF THE STATE.
- J. ALL DENUDE/BARE AREAS THAT WILL BE INACTIVE FOR 14 DAYS OR MORE, MUST BE STABILIZED IMMEDIATELY UPON COMPLETION OF MOST RECENT GRADING ACTIVITY, WITH THE USE OF FAST-GERMINATING ANNUAL GRASS/GRAN VARIETIES, STRAW/HAY MULCH, WOOD CELLULOSE FIBERS, TACKIFIERS, NETTING OR BLANKETS.
- K. DISTURBED PORTIONS OF THE SITE WHERE CONSTRUCTION ACTIVITY HAS PERMANENTLY STOPPED SHALL BE PERMANENTLY STABILIZED AS SHOWN ON THE PLANS. THESE AREAS SHALL BE SEED, SOODED, AND/OR VEGETATED IMMEDIATELY, OR STABILIZED AS SHOWN ON PLANS, NO LATER THAN 14 DAYS AFTER THE LAST CONSTRUCTION ACTIVITY OCCURRING IN THESE AREAS. REFER TO THE GRADING PLAN AND/OR LANDSCAPE PLAN.
- L. IF THE ACTION OF VEHICLES TRAVELING OVER THE GRAVEL CONSTRUCTION ENTRANCES IS NOT SUFFICIENT TO PREVENT TRACKING OF DIRT, DUST OR MUD, THEN THE TIRES MUST BE WASHED BEFORE THE VEHICLES ENTER A PUBLIC ROAD. PROVISIONS MUST BE MADE TO INTERCEPT THE WASH WATER AND TRAP THE SEDIMENT BEFORE IT IS CARRIED OFF THE SITE. ONLY USE INGRESS/EGRESS LOCATIONS AS PROVIDED.
- M. ALL MATERIALS SPILLED, DROPPED, WASHED, OR TRACKED FROM VEHICLES ONTO ROADWAYS OR INTO STORM DRAINS MUST BE REMOVED IMMEDIATELY.
- N. CONTRACTORS OR SUBCONTRACTORS WILL BE RESPONSIBLE FOR REMOVING SEDIMENT IN THE DETENTION POND AND ANY SEDIMENT THAT MAY HAVE COLLECTED IN THE STORM SEWER DRAINAGE SYSTEMS IN CONJUNCTION WITH THE STABILIZATION OF THE SITE.
- O. ON-SITE AND OFFSITE SOIL STOCKPILE AND BORROW AREAS SHALL BE PROTECTED FROM EROSION AND SEDIMENTATION THROUGH IMPLEMENTATION OF BEST MANAGEMENT PRACTICES. STOCKPILE AND BORROW AREA LOCATIONS SHALL BE NOTED ON THE SITE MAP AND PERMITTED IN ACCORDANCE WITH GENERAL PERMIT REQUIREMENTS.
- P. SLOPES SHALL BE LEFT IN A ROUGHENED CONDITION DURING THE GRADING PHASE TO REDUCE RUNOFF VELOCITIES AND EROSION.
- Q. DUE TO THE GRADE CHANGES DURING THE DEVELOPMENT OF THE PROJECT, THE CONTRACTOR SHALL BE RESPONSIBLE FOR ADJUSTING THE EROSION AND SEDIMENT CONTROL MEASURES (SILT FENCES, ETC.) TO PREVENT EROSION AND POLLUTANT DISCHARGE.
- R. GENERAL CONTRACTOR IS TO DESIGNATE/IDENTIFY AREAS ON THE SITE MAPS, INSIDE OF THE LIMITS OF DISTURBANCE, FOR WASTE DISPOSAL AND DELIVERY AND MATERIAL STORAGE.

SEQUENCE OF CONSTRUCTION

- PHASE I
1. INSTALL STABILIZED CONSTRUCTION ENTRANCES.
 2. PREPARE TEMPORARY PARKING AND STORAGE AREA.
 3. CONSTRUCT THE SILT FENCES ON THE SITE.
 4. INSTALL ALL PERIMETER SEDIMENT MEASURES.
 5. INSTALL ALL TEMPORARY EROSION & SEDIMENT CONTROLS AS NEEDED.
 6. CLEAR AND GRUB THE SITE.
 7. BEGIN GRADING THE SITE.
- PHASE II
8. START CONSTRUCTION OF BUILDING PAD, STRUCTURES, AND OFF-SITE IMPROVEMENTS.
 9. TEMPORARILY SEED DENUDE AREAS.
 10. INSTALL UTILITIES, UNDERDRAINS, STORM SEWERS, CURBS AND GUTTERS.
 11. INSTALL INLET/FLUME PROTECTION DEVICES.
 12. INSTALL RIP RAP AROUND OUTLET STRUCTURES.
 13. PREPARE SITE FOR PAVING.
 14. PAVE SITE.
 15. COMPLETE GRADING AND INSTALL PERMANENT SEEDING AND PLANTING.
 16. REMOVE EROSION AND TEMPORARY SEDIMENT CONTROL DEVICES AFTER FINAL STABILIZATION IS ACHIEVED.

BMP MAINTENANCE NOTES

- ALL MEASURES STATED ON THIS SITE MAP, AND IN THE STORM WATER POLLUTION PREVENTION PLAN, SHALL BE MAINTAINED IN FULLY FUNCTIONAL CONDITION UNTIL NO LONGER REQUIRED FOR A COMPLETED PHASE OF WORK OR FINAL STABILIZATION OF THE SITE. ALL EROSION AND SEDIMENTATION CONTROL MEASURE SHALL BE CHECKED BY A QUALIFIED PERSON IN ACCORDANCE WITH THE CONTRACT DOCUMENTS OR THE APPLICABLE PERMIT, WHICHEVER IS MORE STRINGENT, AND REPAIRED IN ACCORDANCE WITH THE FOLLOWING:
1. INLET PROTECTION DEVICES AND BARRIERS SHALL BE REPAIRED OR REPLACED IF THEY SHOW SIGNS OF UNDERMINING OR DETERIORATION.
 2. ALL SEEDING AREAS SHALL BE CHECKED REGULARLY TO SEE THAT GOOD STAND IS MAINTAINED. AREAS SHOULD BE FERTILIZED, WATERED, AND RESEED AS NEEDED.
 3. SILT FENCES SHALL BE REPAIRED TO THEIR ORIGINAL CONDITIONS IF DAMAGED. SEDIMENT SHALL BE REMOVED FROM THE SILT FENCES WHEN IT REACHES ONE-HALF OF THE SILT FENCE.
 4. THE CONSTRUCTION EXITS SHALL BE MAINTAINED IN A CONDITION WHICH WILL PREVENT TRACKING OR FLOW OF MUD ONTO PUBLIC RIGHTS-OF-WAY. THIS MAY REQUIRED PERIODIC TOP DRESSING OF THE CONSTRUCTION EXITS AS CONDITIONS DEMAND.
 5. THE TEMPORARY PARKING AND STORAGE AREA SHALL BE KEPT IN GOOD CONDITION (SUITABLE FOR PARKING AND STORAGE). THIS MAY REQUIRE PERIODIC TOP DRESSING OF THE TEMPORARY PARKING AREA AS CONDITIONS DEMAND.
 6. FILTER TUBES SHALL BE REPAIRED TO THEIR ORIGINAL CONDITIONS IF DAMAGED. SEDIMENT SHALL BE REMOVED FROM TUBES WHEN IT REACHES 1/2 OF ITS EXPOSED HEIGHT. SEE DETAILS.
 7. PRIOR TO LEAVING THE SITE, ALL VEHICLES SHALL BE CLEANED OF DEBRIS. ANY DEBRIS AND/OR SEDIMENT REACHING THE PUBLIC STREET SHALL BE CLEANED IMMEDIATELY BY A METHOD OTHER THAN FLUSHING.

24 HR EMERGENCY CONTACT:
JASON LAIRD 870-866-7681

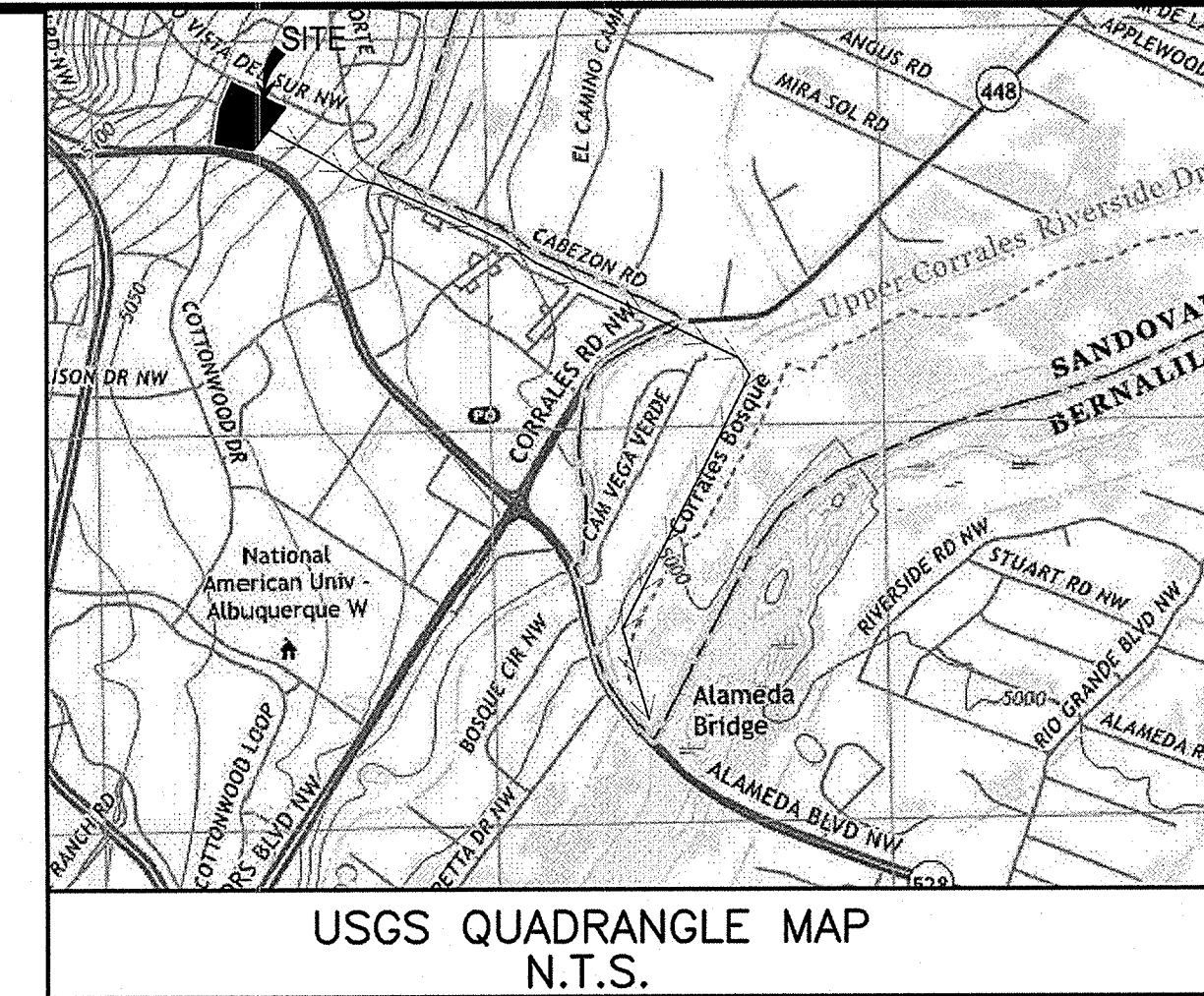

EXISTING

- | | |
|-------------------------------|---------------------------------|
| Sanitary Sewer Manhole | Hand Railing |
| Power Pole w/underground feed | Light Pole |
| Power Pole | Ballard |
| High Voltage Tower | Concrete Symbol |
| Guy Wire | Telephone Pedestal |
| Overhead Wires | Underground Electric Line |
| Water Meter | Underground Communications Line |
| Water Valve | Underground Gas Line |
| Hydrant | Underground Water Line |
| Electric Meter | SAS Sanitary Sewer Line |
| Traffic Box | SD Storm Drain Line |
| Overhead Traffic Light Pole | Control Point |
| Fence | Wall |

PROPOSED

- | |
|--|
| BOUNDARY LINE |
| CF CONSTRUCTION FENCE |
| LIMITS OF DISTURBED AREA |
| CFP CONSTRUCTION FENCE ON PAVEMENT (SEE DETAIL SHEETS) |
| ## SOIL TYPE DESIGNATION |

PROJECT INFORMATION

RECEIVING WATER IS UN-NAMED LOCAL DEPRESSION. DEPRESSION EVENTUALLY CONNECTS TO THE RIO GRANDE ± 1 MILE FROM THE PROJECT SITE.

PROPOSED PROJECT SITE MADE UP OF AN EXISTING COMMERCIAL LOT. STORM RUN-OFF FROM SITE WILL PIPE INTO THE PROPOSED DETENTION POND CONSTRUCTED TO ACCOMMODATE STORM RUN-OFF FOR THE GAS STATION.

PROPOSED PROJECT IS CONSTRUCTING A GAS STATION CONSISTING OF 3445 S.F. CONVENIENT STORE WITH (8) PUMP ISLANDS AND ASSOCIATED PARKING AREA.

ACREAGE OF SITE IS 1.25 ACRES.

DISTURBED ACREAGE OF SITE (INCLUDING OFF-SITE WORK) IS 1.42 ACRES.

ANTICIPATED CONSTRUCTION START DATE IS APRIL 2018 AND COMPLETION DATE IS JULY 2018.

CONTRACTOR TO TAKE APPROPRIATE MEASURES TO KEEP SEDIMENT FROM ESCAPING SITE AND ALL ACCUMULATED SEDIMENT SHALL BE CLEANED OUT AND REMOVED FROM SITE.

DOWNSTREAM CONDITION WILL NOT BE NEGATIVELY AFFECTED BY PROPOSED DEVELOPMENT.

EROSION DETAILS -- SEE DETAIL SHEET C-4.2

- | | |
|----|--|
| CE | STABILIZED CONSTRUCTION ACCESS |
| SF | SEDIMENTATION/SILT FENCE WITH WIRE SUPPORT |
| DC | DUST CONTROL (USING: PHASING OF THE PROJECT, MULCH, SPRINKLING WATER, SPRAY-ON-ADHESIVE, CALCIUM CHLORIDE, BARRIERS, ETC.) |

SITE SOILS

- | | |
|-----|---------------------------|
| MWA | MADUREZ-WINK ASSOCIATION |
| BCC | BLUEPOINT LOAMY FINE SAND |

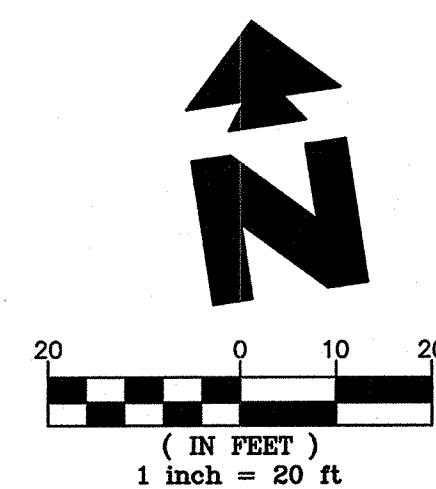

GreenbergFarrow
1430 W. PEACHTREE ST., NW SUITE 200
ATLANTA, GA 30309
PHONE: (404) 601 4000
FAX: (404) 601 9970
DWG NAME: ALBUQUERQUE, NM
JOB NO.: 20160873

MURPHY OIL USA, INC.
MURPHY USA
200 PEACH STREET
EL DORADO, AR 71730

EROSION CONTROL PHASE 1
MURPHY EXPRESS
3751 HIGHWAY 528 NW
ALBUQUERQUE NEW MEXICO

SHEET NO. C-4

14/16
19062
PROFESSIONAL ENGINEER
J. H. LAIRD

REV-6
DATE
05-09-18
JN
PRN
YO
PM
DS
DES
DRW