

CITY OF ALBUQUERQUE



**Planning Department
Transportation Development Services Section**

June 23, 2009

Kevin Murtagh, PE
Bohannon Huston Inc.
7500 Jefferson, Courtyard I
Albuquerque, NM 87109

Re: Certification Submittal for Final Building Certificate of Occupancy for
Jack in the Box – Burlington Coat Factory, [A-14 / D004A1]
3400 Calle Cuervo NW
Architect's Stamp Dated 06/23/09

PO Box 1293

Dear Mr. Murtagh:

Albuquerque

The TCL / Letter of Certification submitted on June 22, 2009 is sufficient for acceptance by this office for final Certificate of Occupancy (C.O.). Notification has been made to the Building and Safety Section.

NM 87103

Sincerely,

www.cabq.gov

Nilo E. Salgado-Fernandez, P.E.
Senior Traffic Engineer
Development and Building Services
Planning Department

c: Engineer
Hydrology file
CO Clerk

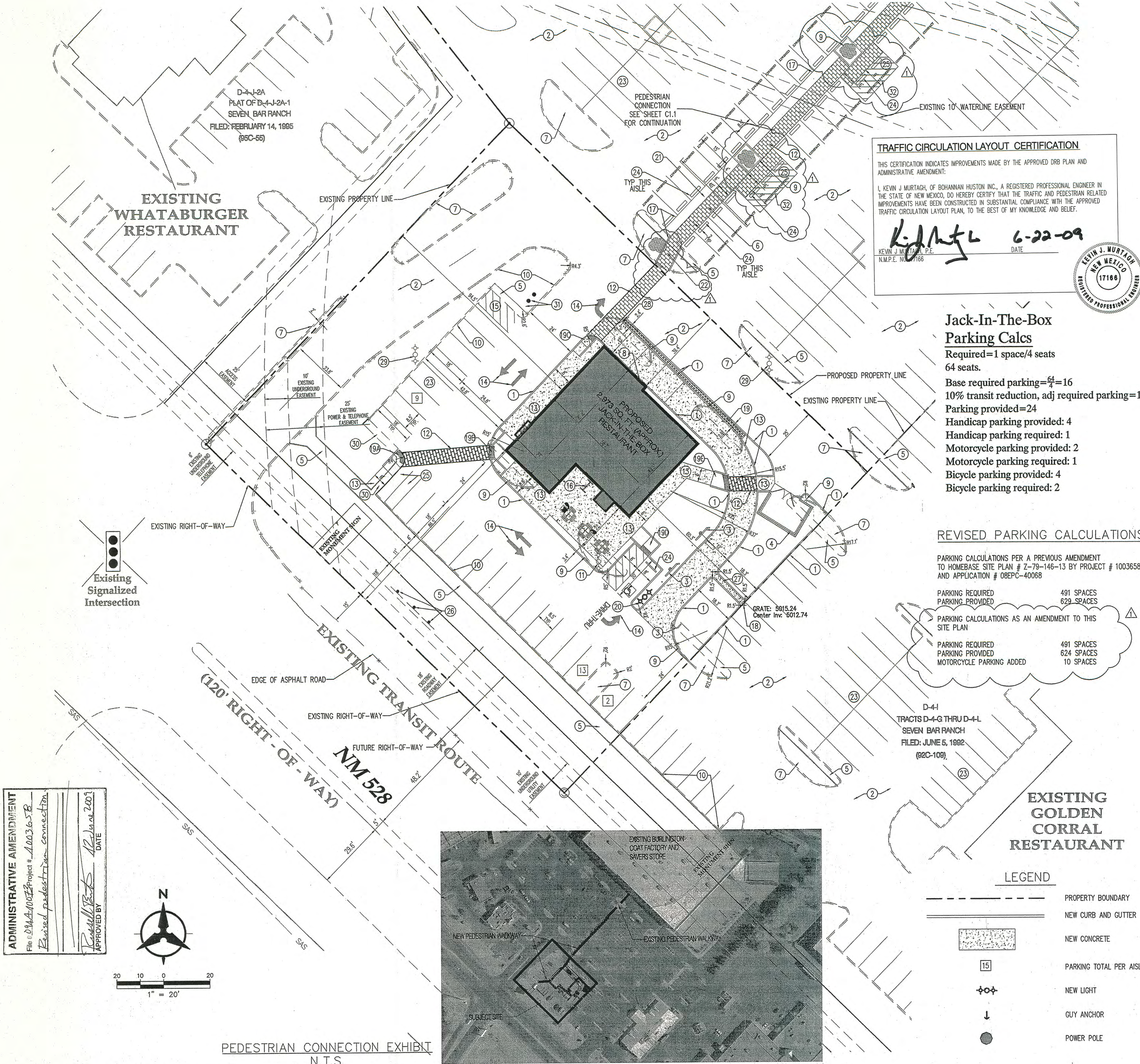

TRAFFIC CIRCULATION LAYOUT CERTIFICATION

THIS CERTIFICATION INDICATES IMPROVEMENTS MADE BY THE APPROVED DRB PLAN AND ADMINISTRATIVE AMENDMENT:

I, KEVIN J. MURTAGH, OF BOHANNAN HUSTON INC., A REGISTERED PROFESSIONAL ENGINEER IN THE STATE OF NEW MEXICO, DO HEREBY CERTIFY THAT THE TRAFFIC AND PEDESTRIAN RELATED IMPROVEMENTS HAVE BEEN CONSTRUCTED IN SUBSTANTIAL COMPLIANCE WITH THE APPROVED TRAFFIC CIRCULATION LAYOUT PLAN, TO THE BEST OF MY KNOWLEDGE AND BELIEF.

Kevin J. Murtagh 6-22-09
KEVIN J. MURTAGH, P.E.
N.M.P.E. NO. 17166

KEVIN J. MURTAGH
NEW MEXICO
REGISTERED PROFESSIONAL ENGINEER
17166

**Jack-In-The-Box
Parking Calcs**

Required=1 space/4 seats
64 seats.

Base required parking= $\frac{64}{4}=16$
10% transit reduction, adj required parking=15
Parking provided=24
Handicap parking provided: 4
Handicap parking required: 1
Motorcycle parking provided: 2
Motorcycle parking required: 1
Bicycle parking provided: 4
Bicycle parking required: 2

REVISED PARKING CALCULATIONS

PARKING CALCULATIONS PER A PREVIOUS AMENDMENT TO HOMEBASE SITE PLAN # Z-79-146-13 BY PROJECT # 1003658 AND APPLICATION # 08EPC-40068

PARKING REQUIRED	491 SPACES
PARKING PROVIDED	629 SPACES
PARKING CALCULATIONS AS AN AMENDMENT TO THIS SITE PLAN	
PARKING REQUIRED	491 SPACES
PARKING PROVIDED	624 SPACES
MOTORCYCLE PARKING ADDED	10 SPACES

D-41
TRACTS D-4-G THRU D-4-L
SEVEN BAR RANCH
FILED: JUNE 6, 1992
(92C-109)

EXISTING GOLDEN CORRAL RESTAURANT

LEGEND

- PROPERTY BOUNDARY
- NEW CURB AND GUTTER
- NEW CONCRETE
- PARKING TOTAL PER AISLE
- NEW LIGHT
- GUY ANCHOR
- POWER POLE

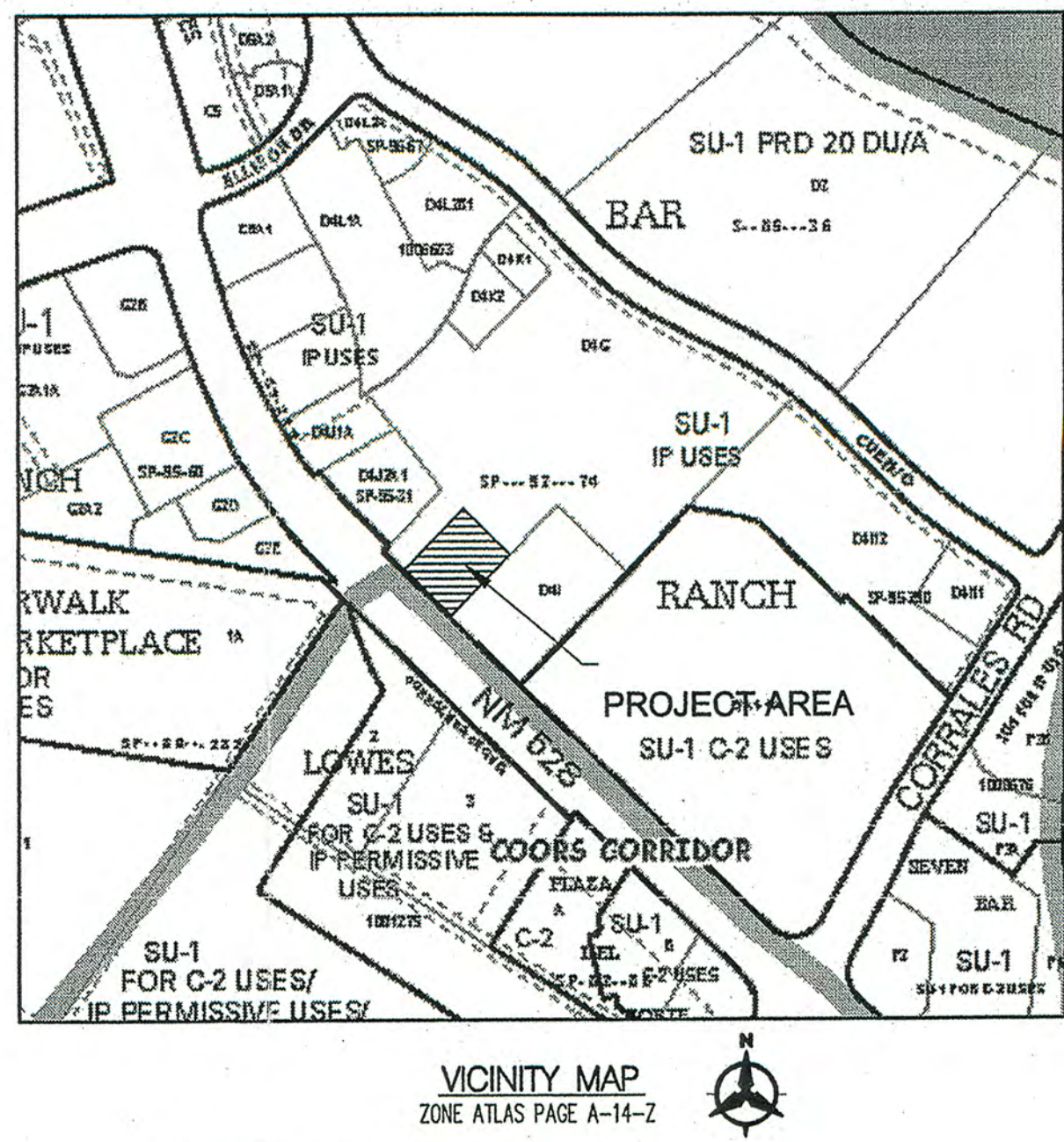

GENERAL NOTES

- SEE L1 FOR LANDSCAPING PLAN
- CONTRACTOR SHALL OBTAIN APPROPRIATE PERMITS FOR WORK IN CITY OF ALBUQUERQUE RIGHT-OF-WAY
- ALL WORK SHALL COMPLY W/COA STANDARD SPECIFICATIONS UPDATE 7, UNLESS OTHERWISE NOTED
- SEE SHEET C2.0 FOR GRADING & PAVING DETAILS

KEYED NOTES

- NEW MEDIAN CURB AND GUTTER PER COA STANDARD DWG. 2415B
- EXISTING VEHICULAR DRIVE AISLE
- MENU BOARD/SIGN
- REFUSE AND RECYCLE ENCLOSURE - 6' HIGH STUCCOED CMU STRUCTURE COLOR TO MATCH BUILDING (SEE SHEET C1.1)
- EXISTING SIDEWALK TO REMAIN
- NEW PEDESTRIAN WALKWAY TO EXISTING BUILDING - SEE PEDESTRIAN CONNECTION DETAIL SHEET C1.1
- EXISTING LANDSCAPE ISLAND TO REMAIN
- DRIVE UP WINDOW
- EXISTING LANDSCAPE ISLAND AND TREES TO REMAIN
- EXISTING CURB TO REMAIN
- EXISTING LIGHT AND POLE TO BE RELOCATED
- 6' WIDE PATTERNED CONCRETE - COLOR & PATTERN BY OWNER APPROVAL
- INSTALL NEW SIDEWALK (6' MIN.)
- NEW PAINTED DIRECTIONAL ARROW - SIZE & COLOR TO MATCH ADJACENT SITES
- STRIPED TEMPORARY PARKING AREA FOR DRIVE UP WINDOW.
- BICYCLE RACK FOR 4 BIKES - (SEE SHEET C1.1)
- INSTALL NEW HEADER CURB.
- EXISTING DROP INLET TO REMAIN
- 19A-E. WHEEL CHAIR RAMP TYPE "A" THROUGH TYPE "E" (SEE SHEET C1.1)
- RELOCATED LIGHT AND POLE. SEE DETAIL SHEET C1.1. SHALL COMPLY WITH ZONING CODE 14.6.3.9.
- NEW LANDSCAPE PLANTER - SEE SHEET C1.1
- REBUILD EXISTING LANDSCAPE ISLAND TO ALLOW PEDESTRIANS ACCESS AND TO PRESERVE TREE
- EXISTING PARKING TO REMAIN (8.5' TYPICAL)
- 8' PRE-MANUFACTURED CONCRETE WHEEL STOP
- MOTORCYCLE PARKING SPACES (SEE SHEET C1.1)
- TEMPORARY CONSTRUCTION SIGNAGE LOCATION
- 2' CONCRETE DRAINAGE RUNDOWN
- STOP SIGN (SEE SHEET C1.1)
- EXISTING LIGHT AND POLE TO REMAIN
- REMOVE EXISTING SIDEWALK
- BOLLARD (SEE SHEET C1.1)
- 4" STRIPING 45 DEG @ 4' SPACING

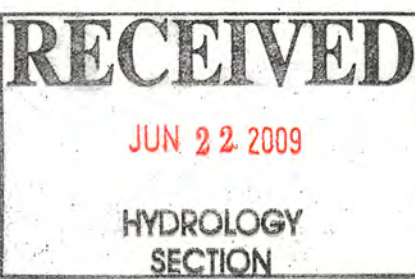

ADMINISTRATIVE AMENDMENT

File: 04410033 Project # 1003658
Revised pedestrian connection

APPROVED BY: *Kevin J. Murtagh* DATE: 12 June 2007

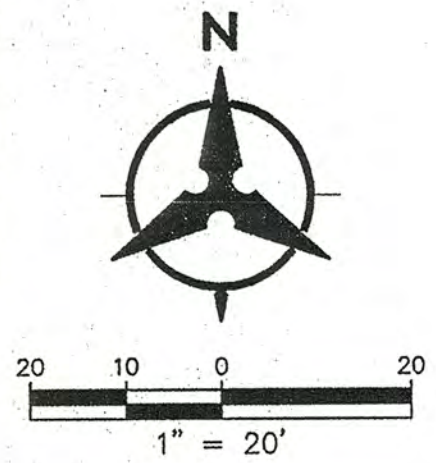

PEDESTRIAN CONNECTION EXHIBIT
N.T.S.

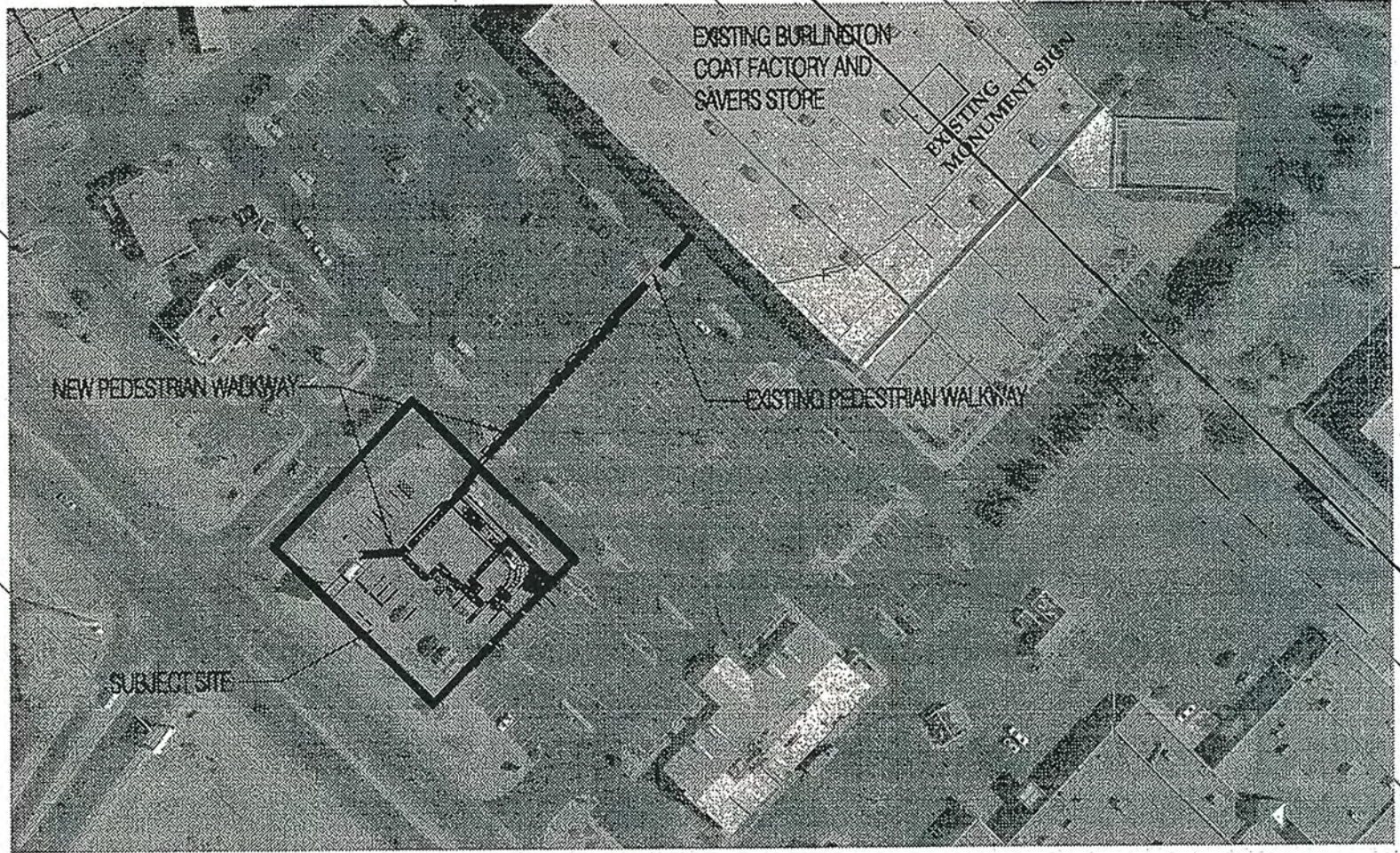

DESIGN ARCHITECTURE ENGINEERING

9330 BALBOA AVENUE
SAN DIEGO, CA 92123
© 2007 Jack in the Box Inc.
These designs, drawings and specifications are the property of Jack in the Box Inc. and shall not be copied or reproduced without its previous written consent.

DATES

RELEASE: _____
P.M. UPDATES: _____
PERMIT: _____
BID: _____
CONSTRUCTION: _____

REVISIONS

△	_____
△	_____
△	_____
△	_____
△	_____
△	Admin Amend for Ped Connection May 2009

JACK IN THE BOX #1261
NM 528
ALBUQUERQUE, NEW MEXICO

Bohannon & Huston
ENGINEERING & ARCHITECTURE
3444 N. Country Club, Suite # 105
(505) 327-6670 / 327-8816

LARRY J. CLUCK & ASSOCIATES
ARCHITECTS
3444 N. Country Club, Suite # 105
(505) 327-6670 / 327-8816

SITE INFORMATION

MK TYPE: _____
JOB #: 1261
ADDRESS: 3400 CALLE CUERVO NW
ALBUQUERQUE, NM
DRAWN BY: LJCA
SCALE: 1:20

Site Plan and
Traffic Circulation
Layout For
Building Permit

MAY 2009
C1.0