



# ***City of Albuquerque***

P.O. BOX 1293 ALBUQUERQUE, NEW MEXICO 87103

June 6, 2003

Ronald R. Bohannon, P.E.  
Tierra West, LLC  
8509 Jefferson NE  
Albuquerque, New Mexico 87113

**RE: COTTONWOOD CORNERS- CHUCK E. CHEESE (A-14/D7F)**  
**(10510 Coors By Pass Rd NW)**  
**ENGINEERS CERTIFICATION FOR CERTIFICATE OF OCCUPANCY**  
**ENGINEERS STAMP DATED 1/28/2003**  
**ENGINEERS CERTIFICATION DATED 6/6/2003**

Dear Mr. Bohannon:

Based upon the information in your Engineers Certification submittal dated 6/6/2003, the above referenced site is approved for Permanent Certificate of Occupancy.

If I can be of further assistance, please contact me at 924-3981.

Sincerely,

Teresa A. Martin  
Hydrology Plan Checker  
Development & Building Services Division  
*BuB*

C: Certificate of Occupancy Clerk, COA  
drainage file  
approval file



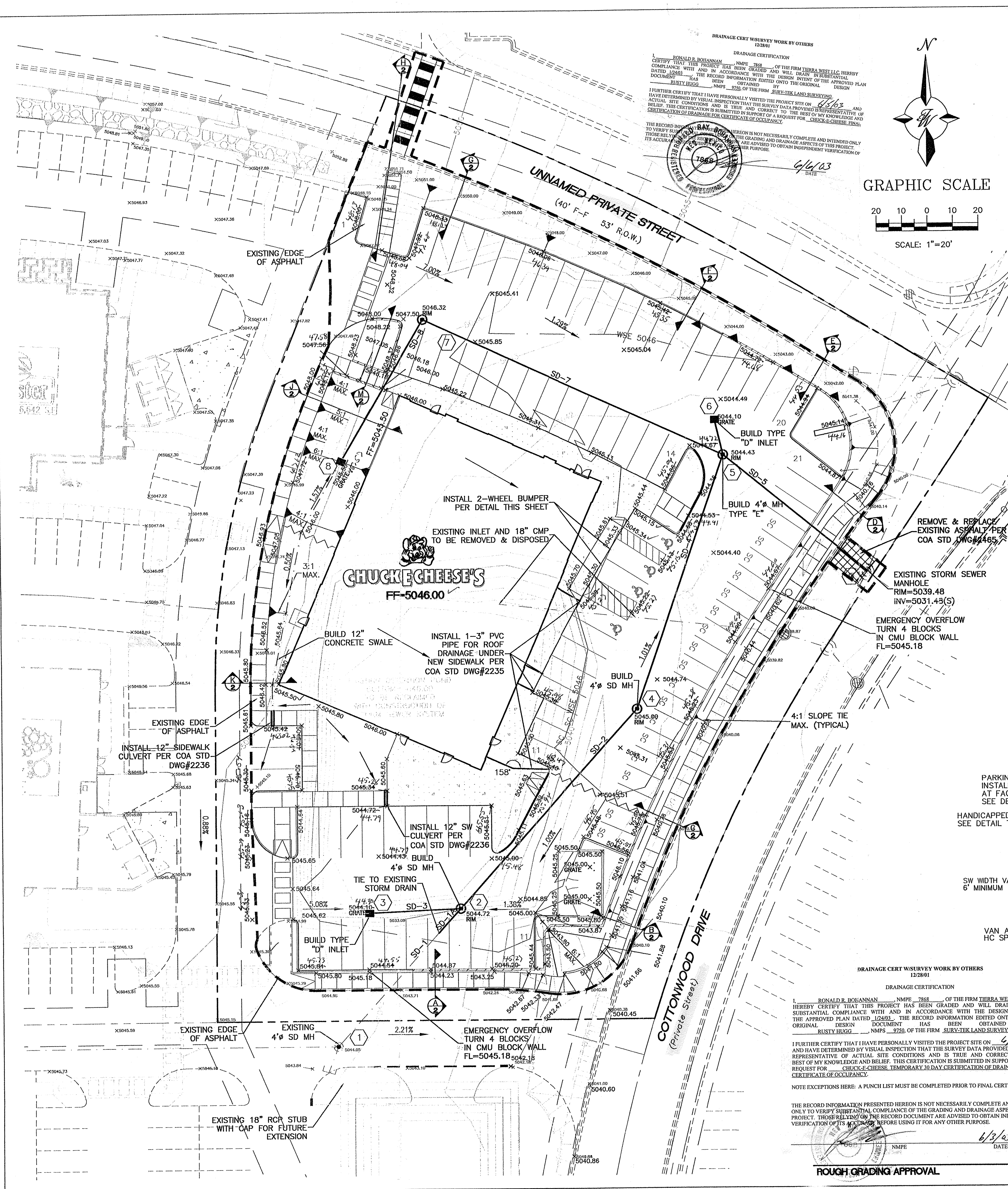

- EROSION CONTROL NOTES:**
1. CONTRACTOR IS RESPONSIBLE FOR OBTAINING A TOPSOIL DISTURBANCE PERMIT PRIOR TO BEGINNING WORK.
  2. CONTRACTOR IS RESPONSIBLE FOR MAINTAINING RUN-OFF ON SITE DURING CONSTRUCTION.
  3. CONTRACTOR IS RESPONSIBLE FOR CLEANING ALL SEDIMENT THAT GETS INTO EXISTING RIGHT-OF-WAY.
  4. REPAIR OF DAMAGED FACILITIES AND CLEANUP OF SEDIMENT ACCUMULATIONS ON ADJACENT PROPERTIES AND IN PUBLIC FACILITIES IS THE RESPONSIBILITY OF THE CONTRACTOR.
  5. ALL EXPOSED EARTH SURFACES MUST BE PROTECTED FROM WIND AND WATER EROSION PRIOR TO FINAL (CITY) ACCEPTANCE OF ANY PROJECT.

**KEYED STORM DRAIN MH/DI DATA**

#	TYPE	RIM/GRATE	INV IN	INV OUT	ORIFICE DIA.
1	EXIST STUB OUT	-	-	5033.09	-
2	4" MANHOLE TYPE "E"	5044.72	5033.09	5032.99	-
3	TYPE "D" INLET	5044.10	-	5040.00	2.50"
4	4" MANHOLE TYPE "E"	5045.00	5032.57	5032.47	-
5	4" MANHOLE TYPE "E"	5044.43	5037.00(N/W)	5031.85	-
6	TYPE "D" INLET	5044.10	-	5040.00	4.25"
7	4" MANHOLE TYPE "E"	5046.32	5040.00	5039.90	-
8	TYPE "D" INLET	5045.50	-	5041.50	-
9	EX. 4" MH	5039.48	-	5031.48	-

**KEYED STORM DRAIN LINE DATA**

SD-#	SIZE & TYPE	LF-LENGTH	SLOPE	BEARINGS
1	EX. 18" HDPE	59.44	-	N 42-08-13 E
1A	18" HDPE	13.00	EXISTING	N 42-08-13 E
2	24" HDPE	104.75	0.500	N 42-05-16 E
3	18" HDPE	36.00	2.000	S 87-31-17 W
4	24" HDPE	104.81	0.500	N 19-15-29 E
5	24" RCP-TYPE III	72.67	0.509	S 50-32-47 E
6	18" HDPE	14.08	2.000	N 13-14-07 W
7	8" HDPE	129.80	2.000	N 65-34-46 W
8	8" HDPE	63.94	2.000	S 30-34-37 W

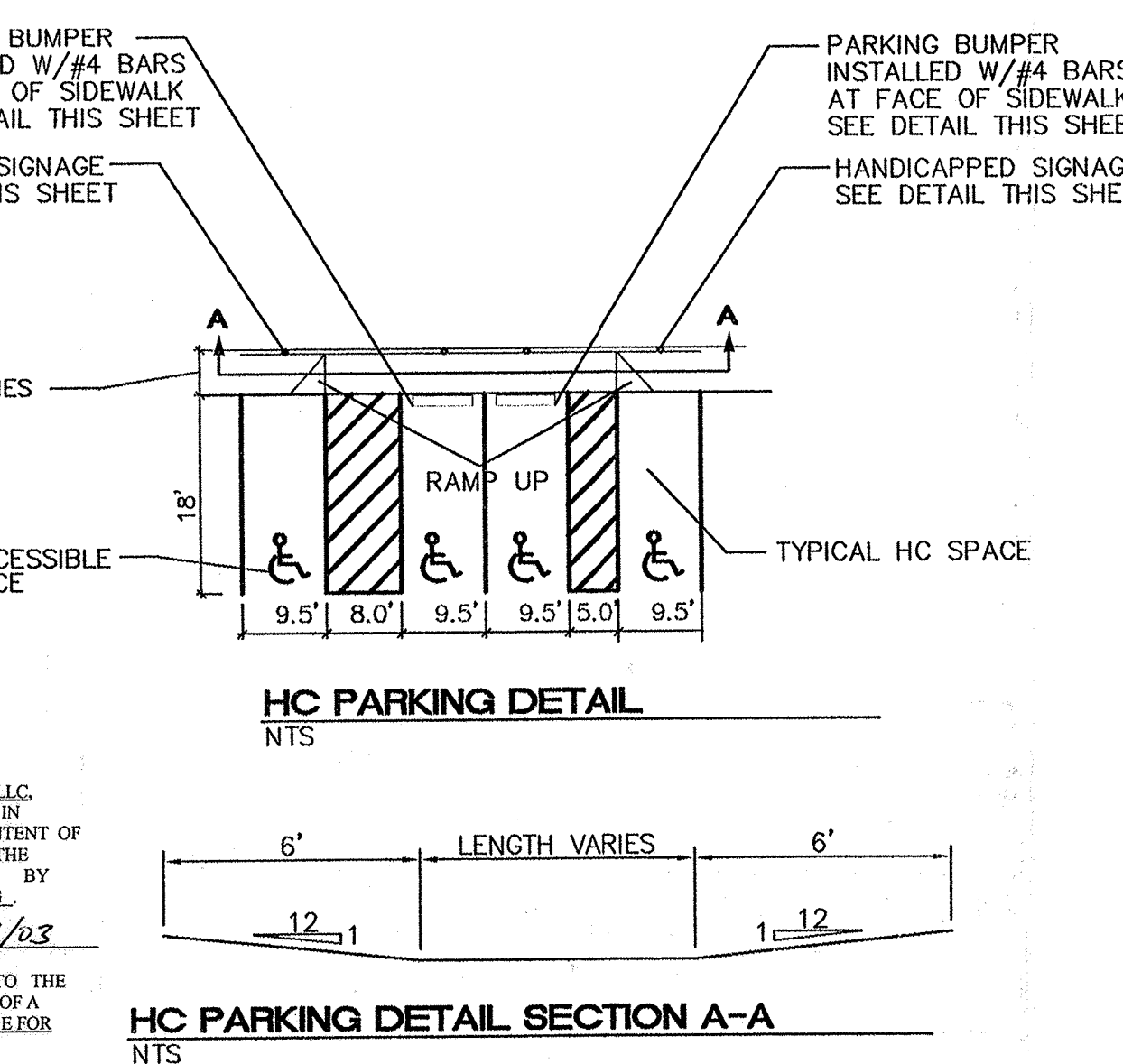
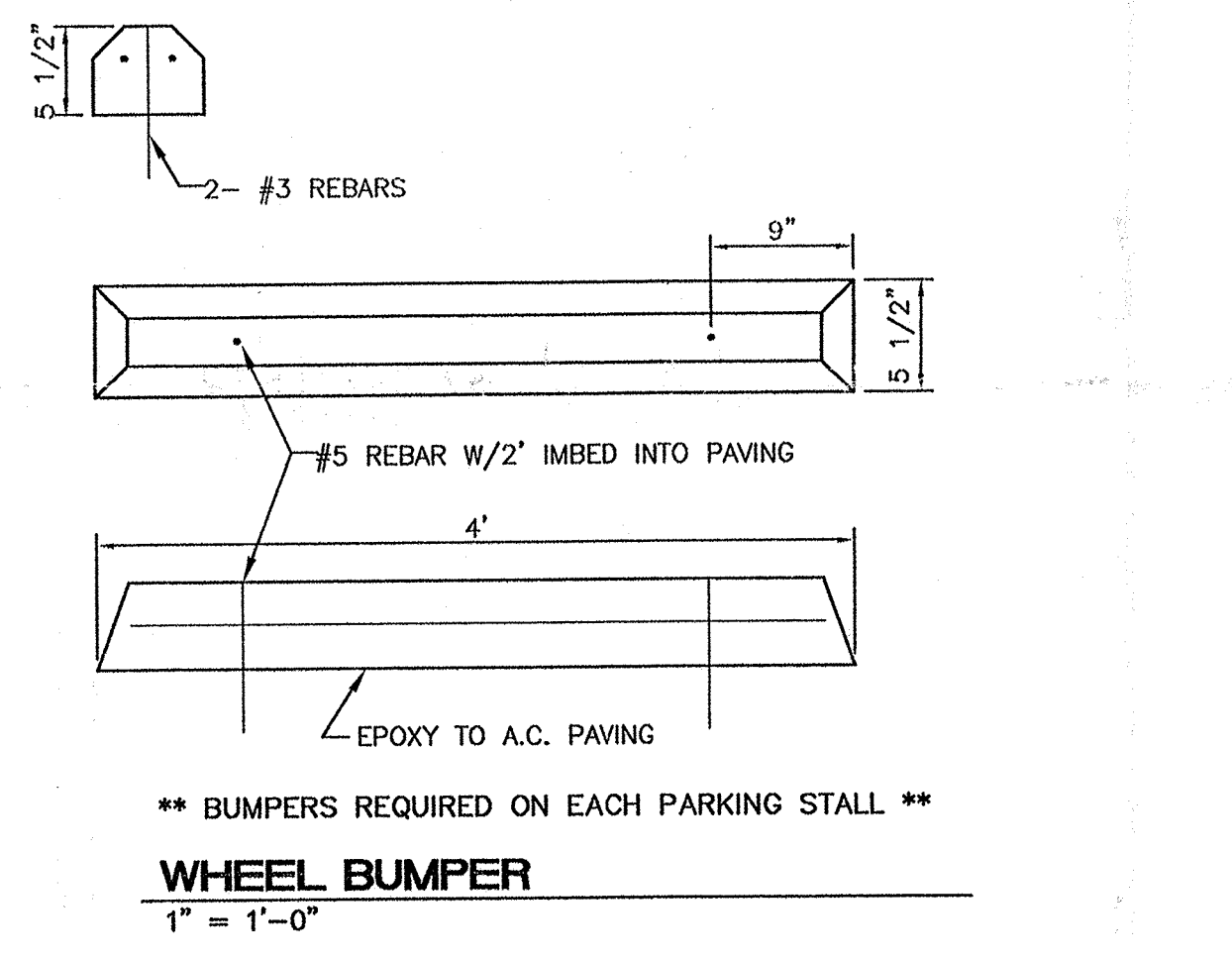

**CAUTION:** UTILITIES ARE NOT SHOWN. IT SHALL BE THE SOLE RESPONSIBILITY OF THE CONTRACTOR TO CONDUCT ALL NECESSARY FIELD INVESTIGATIONS PRIOR TO ANY EXCAVATION TO DETERMINE THE ACTUAL LOCATION OF UTILITIES & OTHER IMPROVEMENTS.

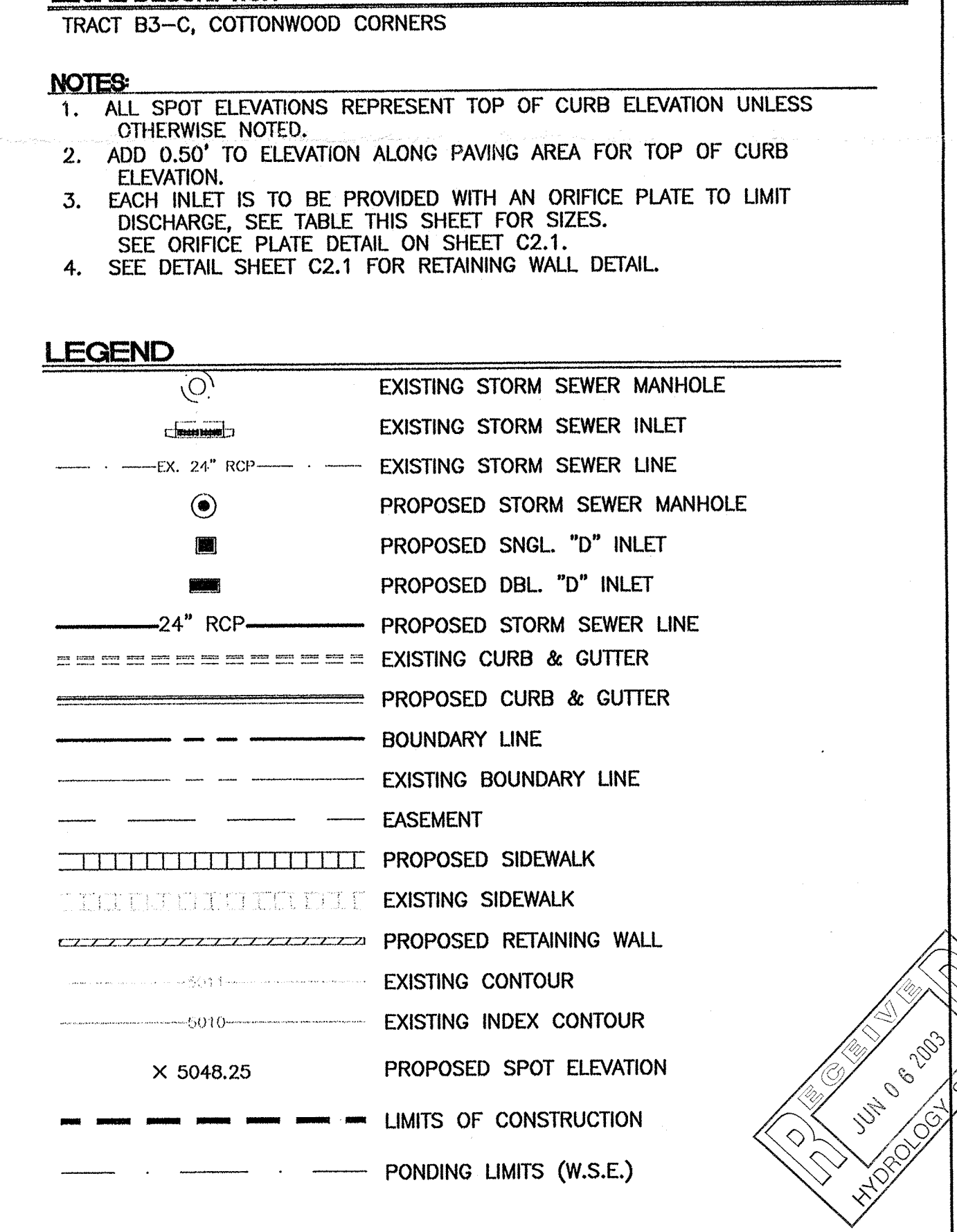
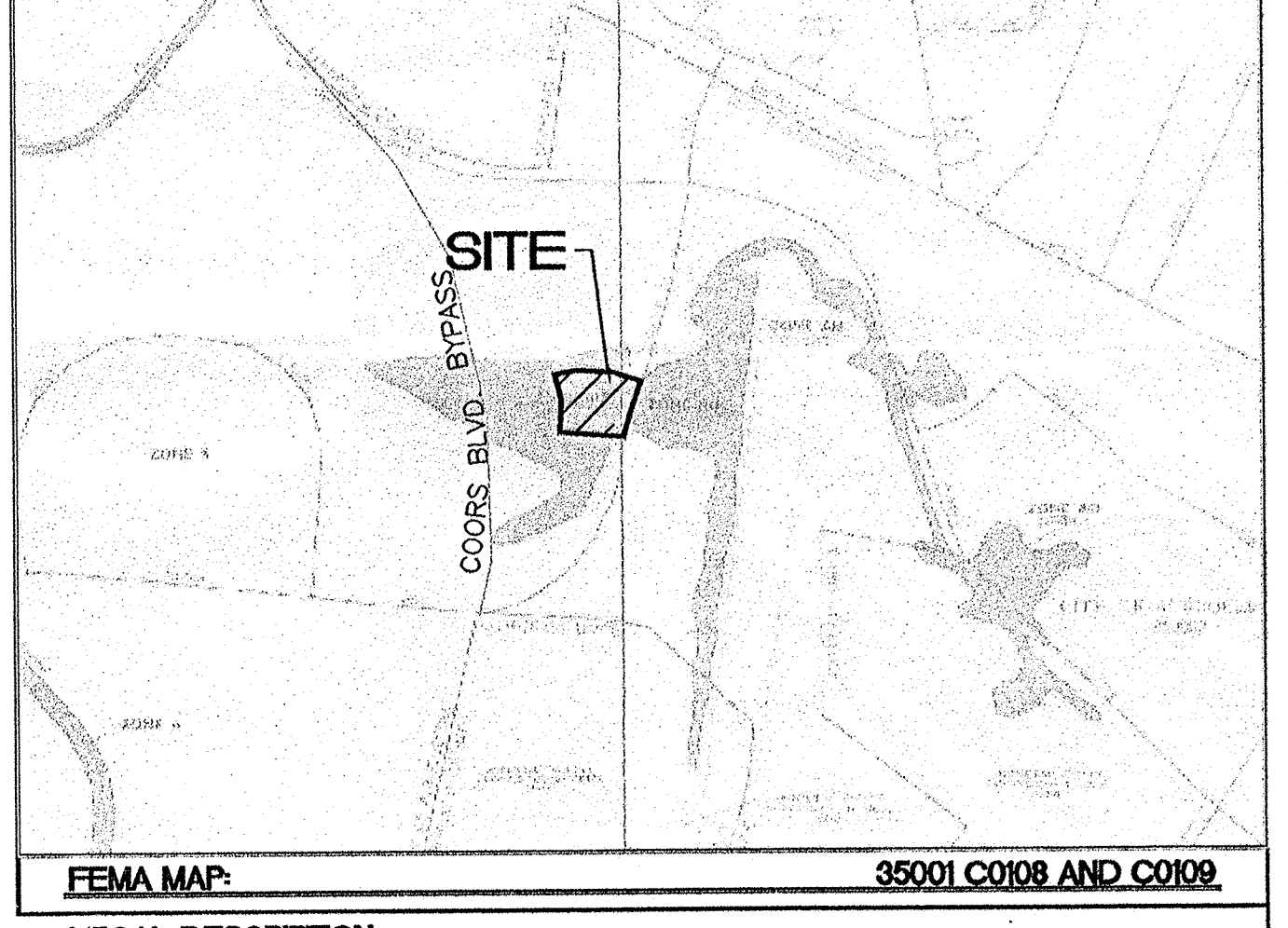
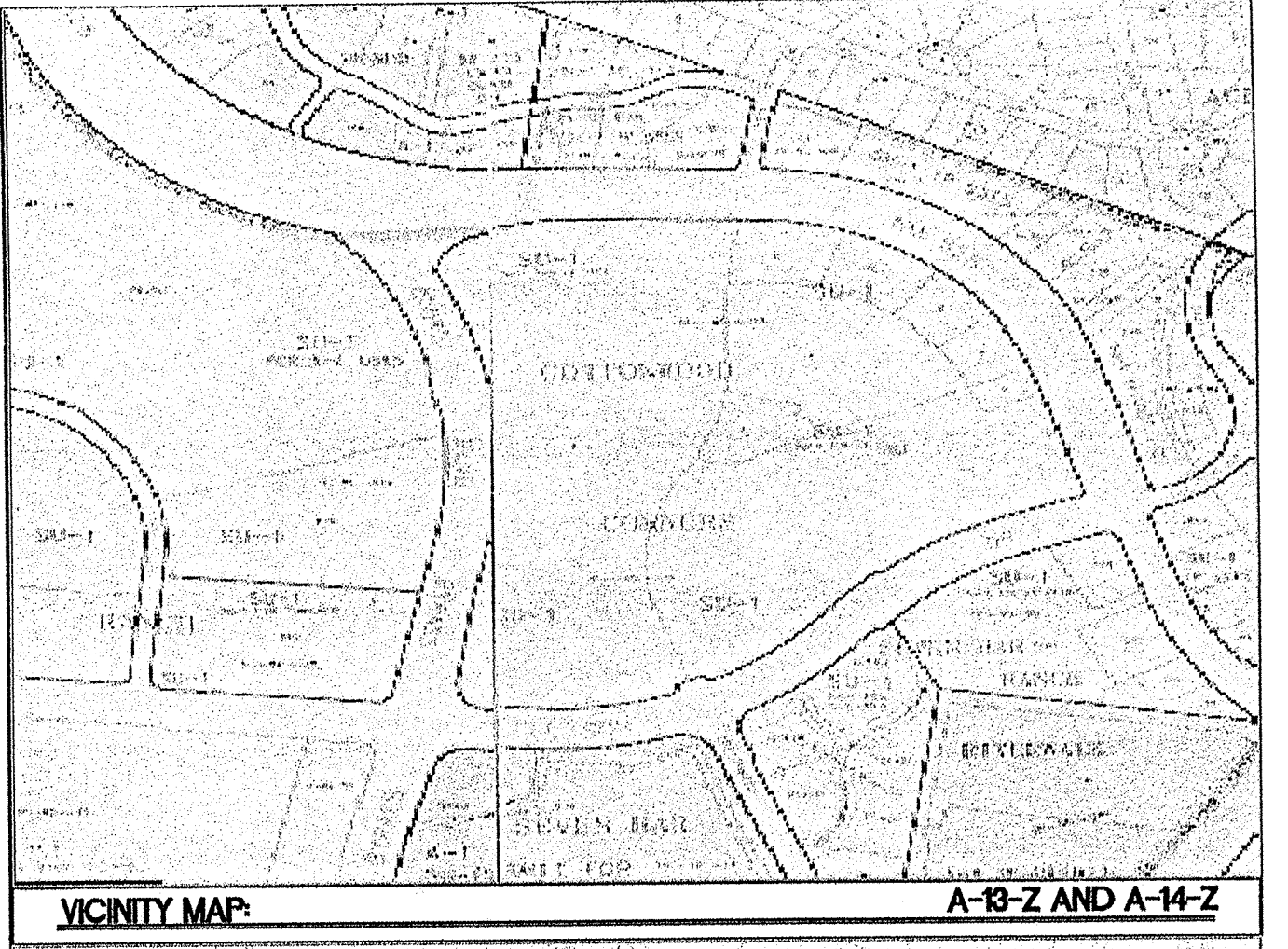

<b>ENGINEER'S SEAL</b>  <b>RONALD R. BOHANNAN</b> P.E. #7868	<b>CHUCK 'E' CHEESE'S</b>	<b>DRAWN BY</b> MP
	<b>GRADING AND DRAINAGE PLAN</b>	<b>DATE</b> 01.22.2003
		<b>SHEET #</b> <b>C2.0</b>
		<b>JOB #</b> 220067