



City of Albuquerque

P.O. BOX 1293 ALBUQUERQUE, NEW MEXICO 87103

October 12, 1995

Roger Martinez
Mark Goodwin & Assoc.
P.O. Box 90606
Albuquerque, NM 87199

**RE: THE KNOLLS OF PARADISE HILLS (B12-D5) ENGINEER'S
CERTIFICATION FOR CERTIFICATE OF OCCUPANCY APPROVAL.
ENGINEER'S CERTIFICATION DATED 9-28-95. ENGINEER'S STAMP
DATED 6-13-95.**

Dear Mr. Martinez:

Based on the information provided on your October 10, 1995
submittal, the above referenced project is approved for
Certificate of Occupancy.

If I can be of further assistance, please feel free to contact me
at 768-3622.

Sincerely,



Lisa Ann Manwill
Engineering Assoc./Hyd.

c: Andrew Garcia
File

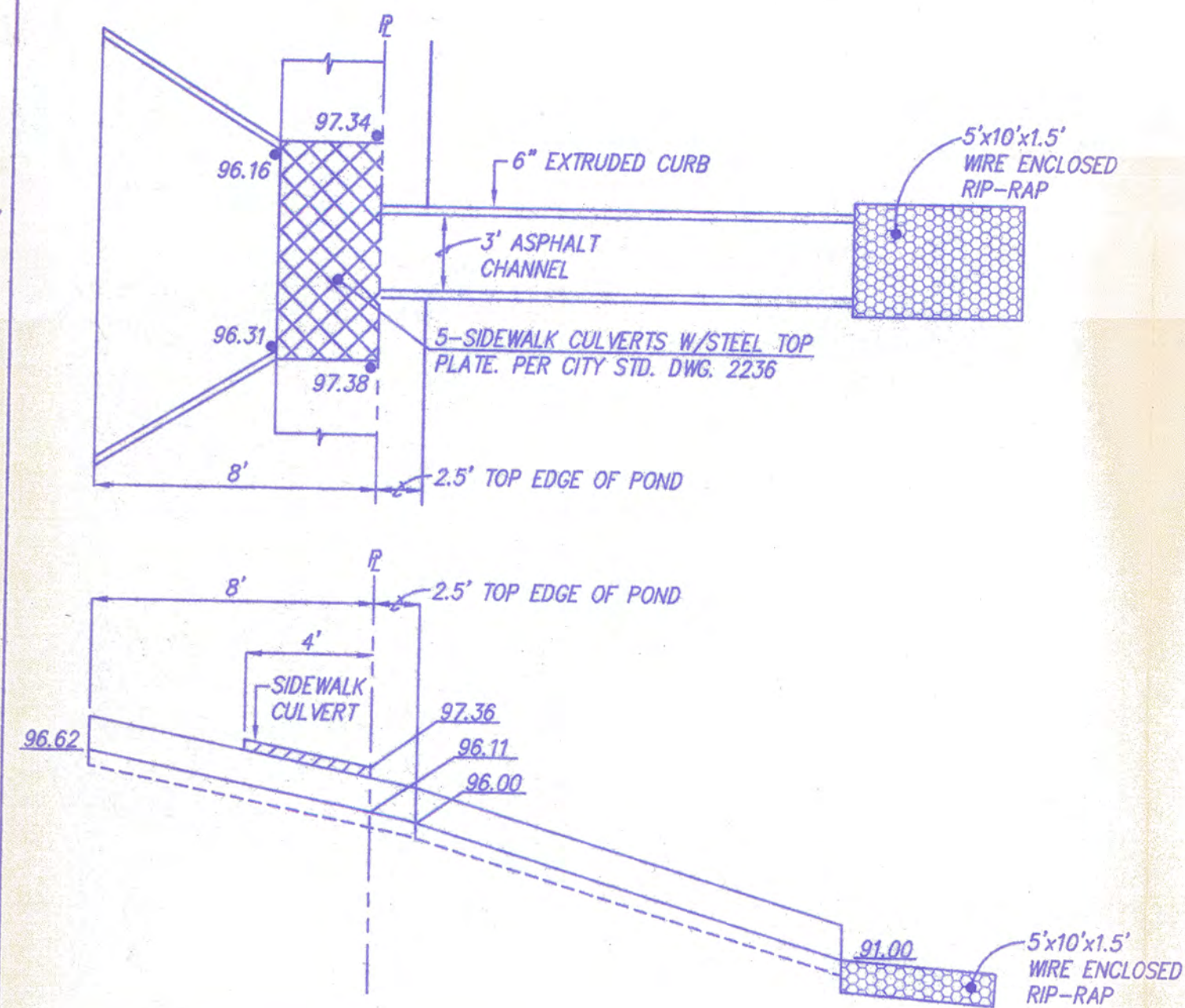

INLET & CHANNEL DETAIL ACADEMY ROAD N.W.
N.T.S.

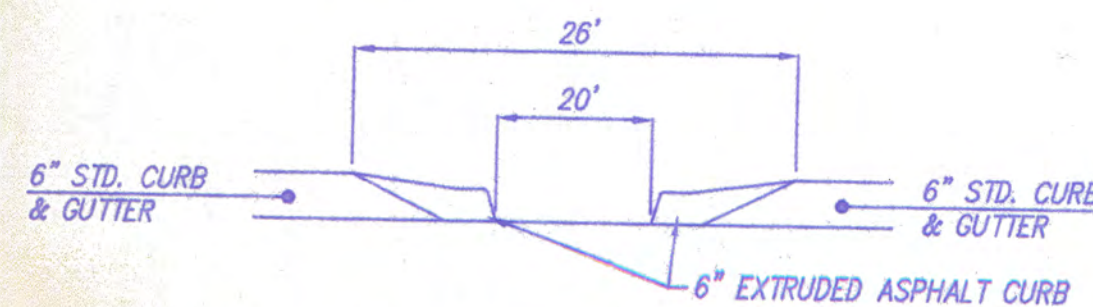

CURB OPENING DETAIL ACADEMY ROAD N.W.
N.T.S.

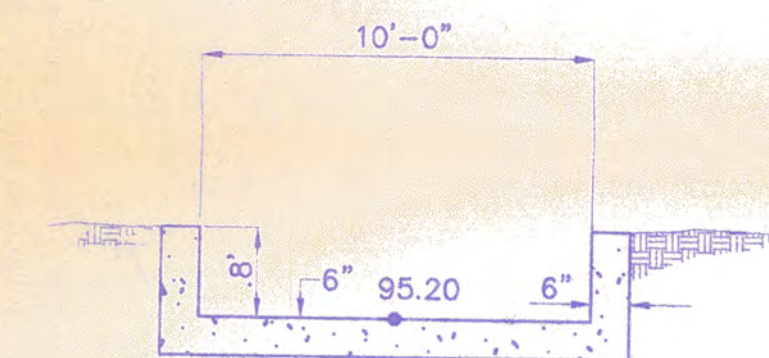

EMERGENCY SPILLWAY WEIR OPENING
N.T.S. (SEE DETAIL BELOW RIGHT)

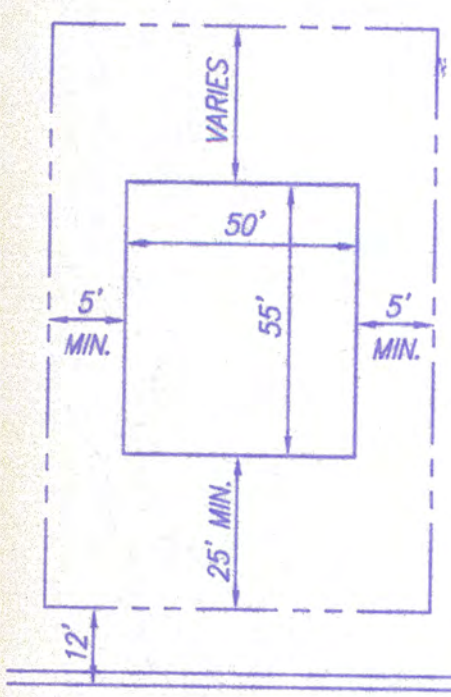

TYPICAL LOT LAYOUT
N.T.S.

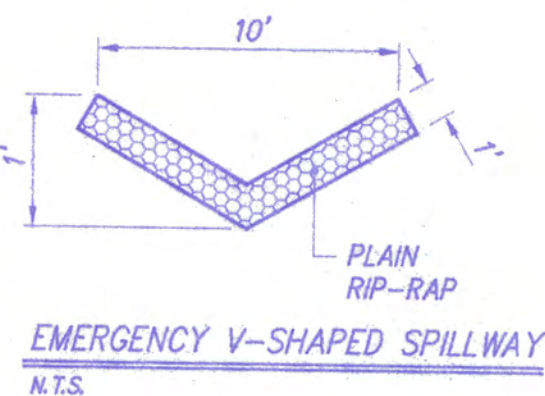

EMERGENCY V-SHAPED SPILLWAY
N.T.S.

EROSION CONTROL NOTES

1. CONTRACTOR IS RESPONSIBLE FOR OBTAINING A TOPSOIL DISTURBANCE PERMIT PRIOR TO BEGINNING WORK.
2. CONTRACTOR IS RESPONSIBLE FOR KEEPING ALL SEDIMENT OUT OF EXISTING RIGHT-OF-WAY.
3. CONTRACTOR IS RESPONSIBLE FOR CLEANING UP ANY SEDIMENT THAT GETS INTO EXISTING RIGHT-OF-WAY.
4. EROSION CONTROL BERMS ARE REQUIRED AROUND THE ENTIRE SITE.
5. ALL EROSION CONTROL BERMS MUST BE IN PLACE AND ENGINEER CERTIFIED PRIOR TO BUILDING PERMIT RELEASE.

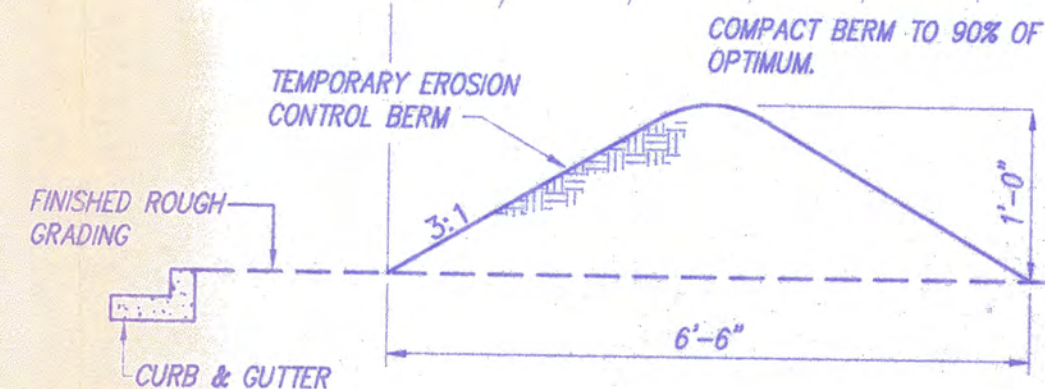

EROSION CONTROL BERM DETAIL
N.T.S.

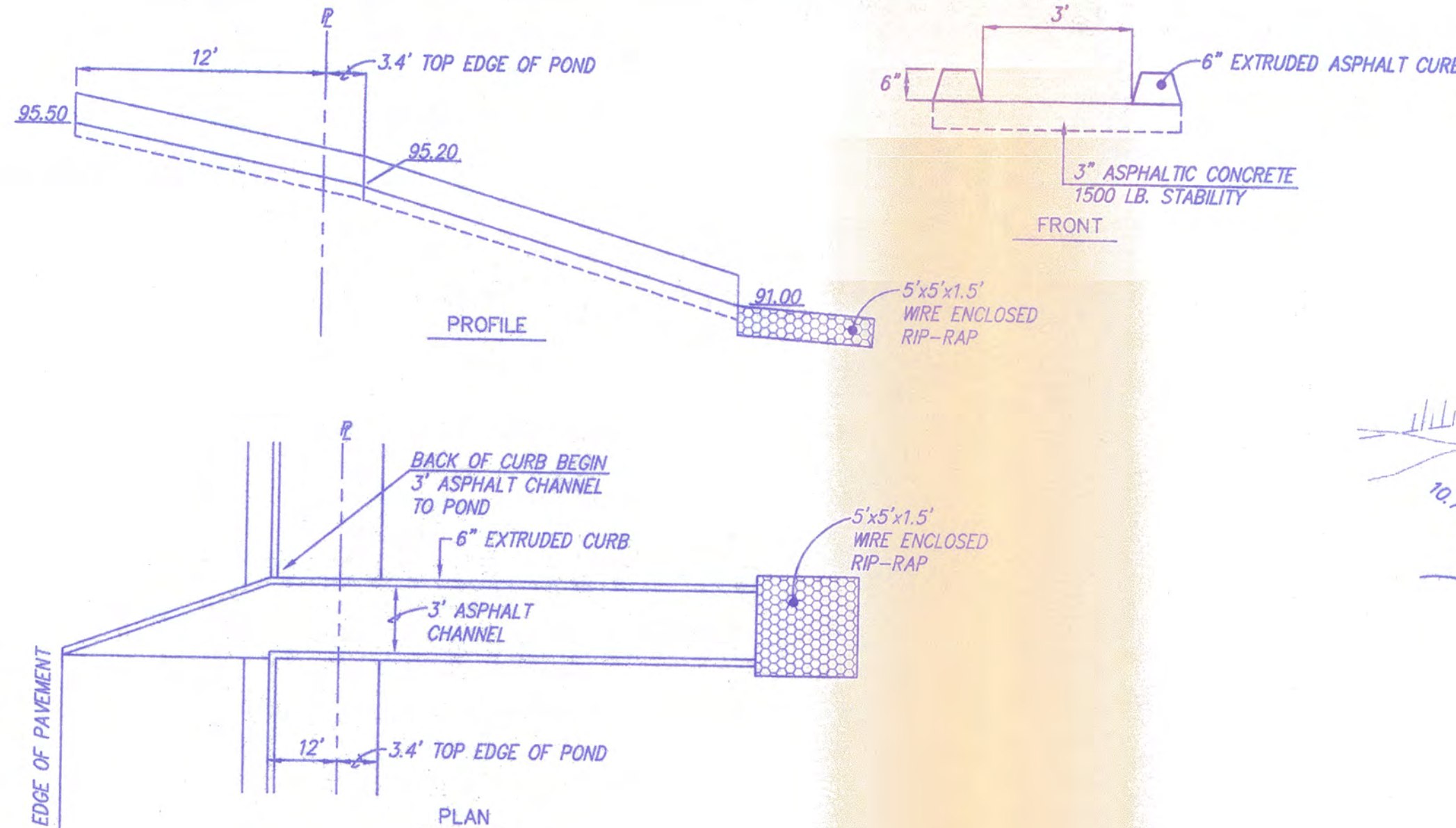

INLET & CHANNEL DETAIL CONGRESS AVENUE N.W.
N.T.S.

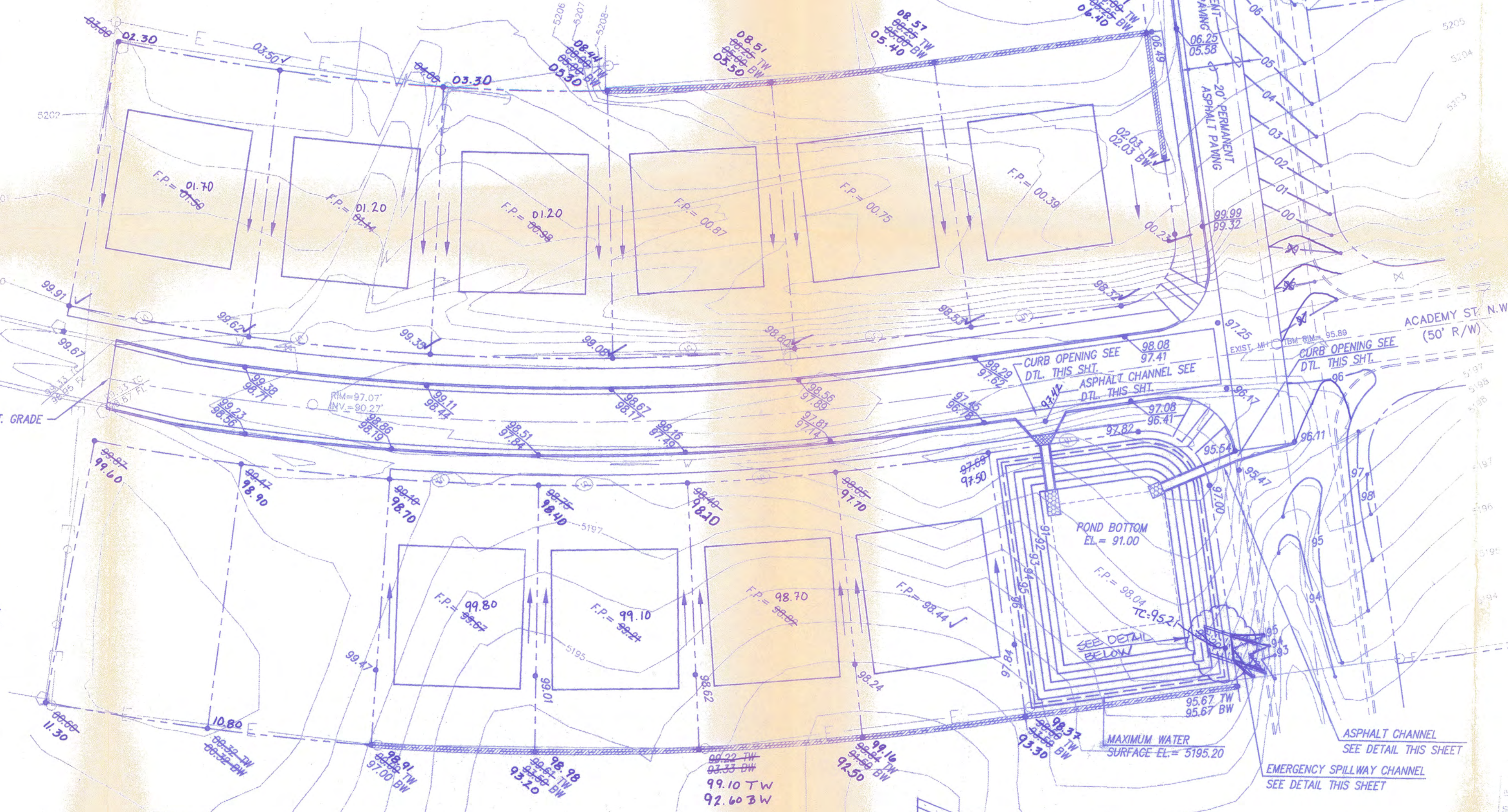

EMERGENCY SPILLWAY WEIR OPENING N.T.S.

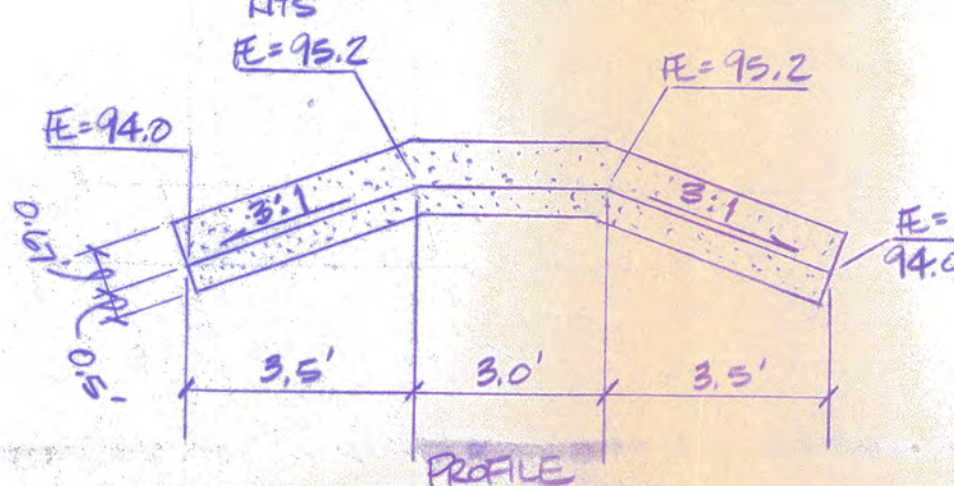

EROSION CONTROL BERM DETAIL
N.T.S.

RECORD DRAWING
I hereby certify that the information contained on this drawing was prepared by me or under my direct supervision and that I am a duly Licensed Professional Engineer in the State of New Mexico. I am not aware of any falsification of the information furnished to me by the client, and I am not aware of any falsification of the information furnished to me by the client, and I am not aware of any falsification of the information furnished to me by the client.
Gregory J. Krenik, NMPE 11929
DATE: 9-28-95

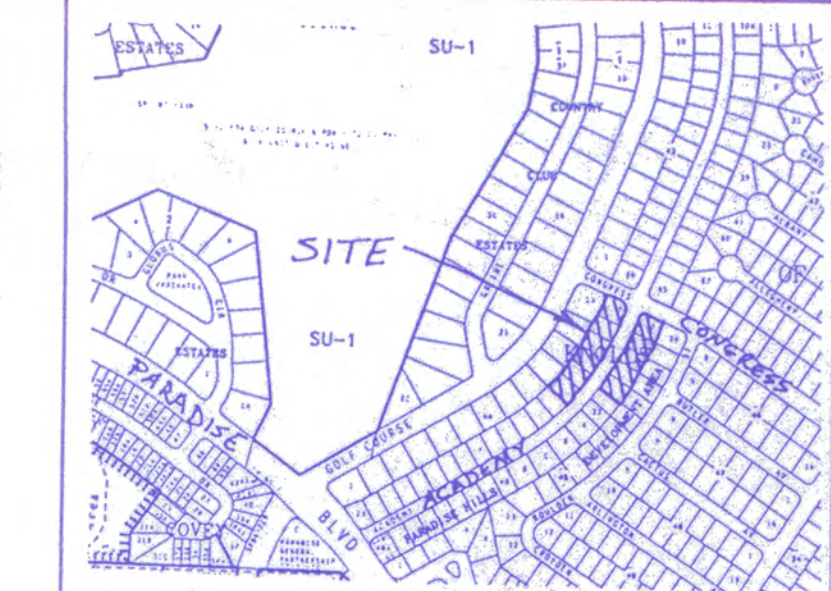
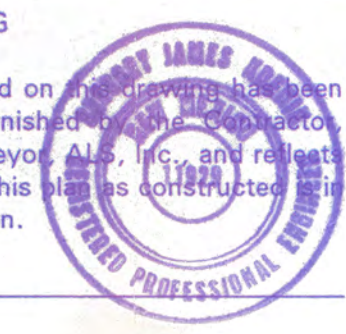

VICINITY MAP

LEGAL DESCRIPTION

LOTS 14-19, BLOCK 44, KNOLLS OF PARADISE
LOTS 27-31, BLOCK 45, KNOLLS OF PARADISE

TEMPORARY BENCH MARK

SANITARY MH RIM IN INTERSECTION OF CONGRESS AVE. AND ACADEMY ST.
ELEV. = 5195.89

NOTES

1. SITE DOES NOT LIE WITHIN A 100 YEAR FLOOD ZONE.
2. FREE DISCHARGE IS NOT ALLOWED.
3. ALL LANDSCAPE AREAS ADJACENT TO BUILDING TO BE GRADED SUCH THAT ROOF RUNOFF DOES NOT POND.
4. CONTRACTOR MUST OBTAIN A TOPSOIL DISTURBANCE PERMIT FROM THE ENVIRONMENTAL HEALTH DIVISION PRIOR TO CONSTRUCTION.
5. CITY OF ALBUQUERQUE STANDARD SPECIFICATIONS FOR PUBLIC WORKS CONSTRUCTION, LATEST EDITION SHALL GOVERN ALL WORK.
6. THE CONTRACTOR SHALL CONFORM TO ALL CITY, COUNTY, STATE AND FEDERAL DUST CONTROL MEASURES AND REQUIREMENTS AND WILL BE RESPONSIBLE FOR PREPARING AND OBTAINING ALL NECESSARY APPLICATIONS AND APPROVALS.
7. THE CONTRACTOR SHALL ENSURE THAT NO SOIL ERODES FROM THE LOTS INTO PUBLIC RIGHT-OF-WAY. THIS CAN BE ACHIEVED BY CONSTRUCTING TEMPORARY BERMS AS PER DTL. THIS SHT. AND WETTING THE SOIL TO KEEP IT FROM BLOWING.
8. THE EARTHWORK CONTACTOR SHALL STOCKPILE ENOUGH MATERIAL ADJACENT TO RETAINING WALL LOCATIONS TO BE UTILIZED FOR WALL BACKFILL.
9. ALL CONCRETE CURBING TO BE 4000 PSI @ 28 DAYS. REFER TO SECTION 101 OF CITY SPECIFICATIONS FOR FLYASH CONTENT.
10. OFFSITE FLOWS ARE ALLOWED TO ENTER THIS SITE.

LEGEND

- PROPERTY LINE
- NEW STD. CURB & GUTTER
- PROPOSED CONTOUR
- PROPOSED SPOT ELEVATION
- FLOW DIRECTION ARROW
- EXISTING CONTOURS
- EXIST. FIRE HYDRANT
- EXIST. SAS SERVICE
- EXIST. CONCRETE CURB
- EXIST. WATER VALVE
- EXIST. SPOT ELEVATION

D. MARK GOODWIN & ASSOCIATES, P.A.
CONSULTING ENGINEERS & SURVEYORS
P.O. BOX 90606
ALBUQUERQUE, NEW MEXICO 87199
(505) 345-2010

CITY OF ALBUQUERQUE
PUBLIC WORKS DEPARTMENT
ENGINEERING GROUP

TITLE: PARADISE HILLS - CONGRESS & ACADEMY
GRADING & DRAINAGE PLAN

APPROVALS	ENGINEER	DATE	APPROVALS	ENGINEER	DATE
DRC CHAIRMAN	B. J. Goodwin	6-27-95	WATER	NIA RWE	6-14-95
TRANSPORTATION	NIA RWE	6-14-95	WASTE WATER	NIA RWE	6-14-95
HYDROLOGY	JPC	6-21-95	NMUI		

PROJECT	MAP NO.	SHEET	OF
NO. 5216.90	B12	2	3