

**ALBUQUERQUE FIRE MARSHAL'S  
DIVISION OFFICE PLANS  
CHECKING DIVISION  
PERMIT**  
PERMIT NUMBER: FP-24-021509  
NEWLY  
APPROVED DATE: 08/06/2024

THESE CONSTRUCTION DOCUMENTS WERE REVIEWED AND APPROVED BY THE ALBUQUERQUE FIRE MARSHAL'S OFFICE IN ACCORDANCE WITH THE CITY ORDINANCE, THE INTERNATIONAL FIRE CODE, AND NFPA STANDARDS. THIS PERMIT IS VALID FOR 90 DAYS. FURTHER ACTION IS REQUIRED.

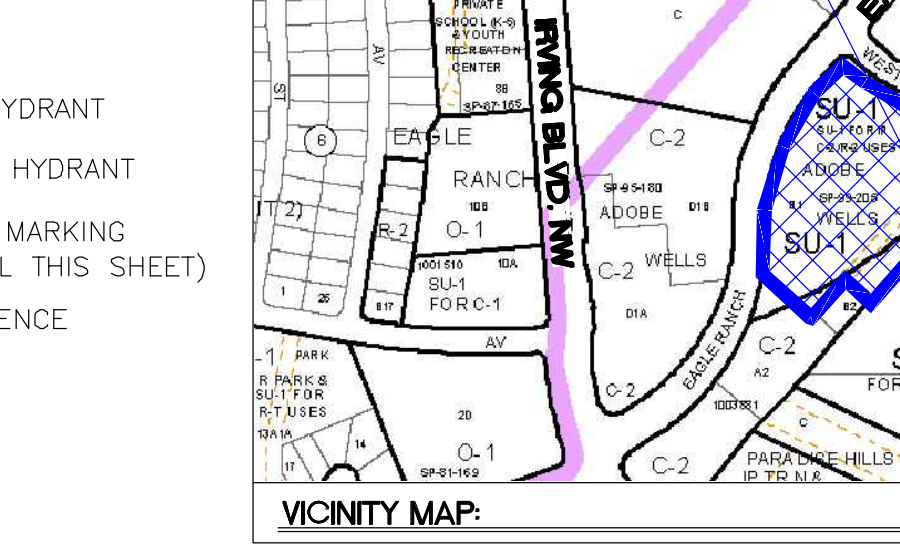

**VICINITY MAP:**  
TRACT B-1, ADOBE WELLS

**PITRE KIA**  
9640 EAGLE RANCH ROAD N.W.  
ALBUQUERQUE, NM 87114  
MODERATE INTENSITY ZONE DISTRICT (MX-M)  
NON-RESIDENTIAL - BUSINESS PARK ZONE DISTRICT (NR-BP)  
OCCUPANCY TYPE: LIGHT VEHICLE SALES AND RENTAL / LIGHT VEHICLE REPAIR

LOT AREA: 261,360 SF (6 ACRES)  
BUILDING AREA: 23,414 SF  
1 STORY HIGH BUILDING  
CONSTRUCTION TYPE: II-B

BUILDING IS FULLY SPRINKLERED  
FIRE SEPARATION = 2-HOUR RATING  
MAX BUILDING HEIGHT 28'-0"  
FIRE-FLOW = 1,625 GPM (3,250 GPM WITH 50% REDUCTION)  
FH'S REQUIRED = 1  
FH'S PROVIDED = 3

- LEGEND**
- CURB & GUTTER
  - BOUNDARY
  - BUILDING
  - - - EXISTING CURB
  - - - EXISTING BOUNDARY
  - - - EXISTING WATERLINE
  - - - EXISTING FIRE ACCESS
  - EXISTING HYDRANT
  - PROPOSED HYDRANT
  - - - FIRE LANE MARKING (SEE DETAIL THIS SHEET)
  - - - EXISTING FENCE

**KEYED NOTES**

- 1 EXISTING PRIVATE FIRE HYDRANT AND 6" VALVE
- 2 POSITION INDICATOR VALVE (PIV)
- 3 BUILDING ADDRESS
- 4 KNOX BOX
- 5 EXISTING FIRE DEPARTMENT CONNECTION (FDC)
- 6 EXISTING 8" PUBLIC GATE VALVE
- 7 EXISTING 8" PRIVATE GATE VALVE
- 8 EXISTING 6" PRIVATE GATE VALVE
- 9 EXISTING WATERLINE
- 10 EXISTING FIRELINE
- 11 EXISTING DOMESTIC WATER SERVICE LINE
- 12 EXISTING SANITARY SEWER LINE
- 13 EXISTING SAS SERVICE LINE
- 14 ELECTRICAL SERVICE LINE

**NOTES**

1. ON SITE FIRE LANE ROAD SHALL BE MARKED ON BOTH SIDES, AS DIRECTED BY FIRE MARSHALL.
2. FIRE APPARATUS ACCESS ROADS SHALL NOT EXCEED 10 PERCENT IN GRADE AND SHALL HAVE AN ALL WEATHER DRIVING SURFACE CAPABLE OF SUPPORTING THE IMPOSED LOAD OF FIRE APPARATUS WEIGHING AT LEAST 75000 LBS.
3. KNOX KEY BOX SWITCH SHALL BE MOUNTED BETWEEN 4 AND 6 FEET ABOVE GRADE AND SHALL BE ILLUMINATED. ONE IS TO BE PROVIDED FOR ALL ELECTRIC GATES AND ALL BUILDINGS.
4. KNOX KEY SWITCH REQUIRED FOR ALL ELECTRIC GATES AND ALL BUILDINGS.
5. BUILDINGS WILL REQUIRE VERTICAL AND HORIZONTAL FIRE SEPARATION BETWEEN EACH DWELLING UNIT WITH A FIRE-RESISTANCE RATING NO LESS THAN 2 HOURS PER 707.3.10 OF THE IBC.

**CAUTION:**

ALL EXISTING UTILITIES SHOWN WERE OBTAINED FROM RESEARCH, AS-BUILTS, SURVEYS OR INFORMATION PROVIDED BY OTHERS. IT SHALL BE THE SOLE RESPONSIBILITY OF THE CONTRACTOR TO CONDUCT ALL NECESSARY FIELD INVESTIGATIONS PRIOR TO AND INCLUDING ANY EXCAVATION, TO DETERMINE THE ACTUAL LOCATION OF UTILITIES AND OTHER IMPROVEMENTS, PRIOR TO STARTING THE WORK. ANY CHANGES FROM THIS PLAN SHALL BE COORDINATED WITH AND APPROVED BY THE ENGINEER.

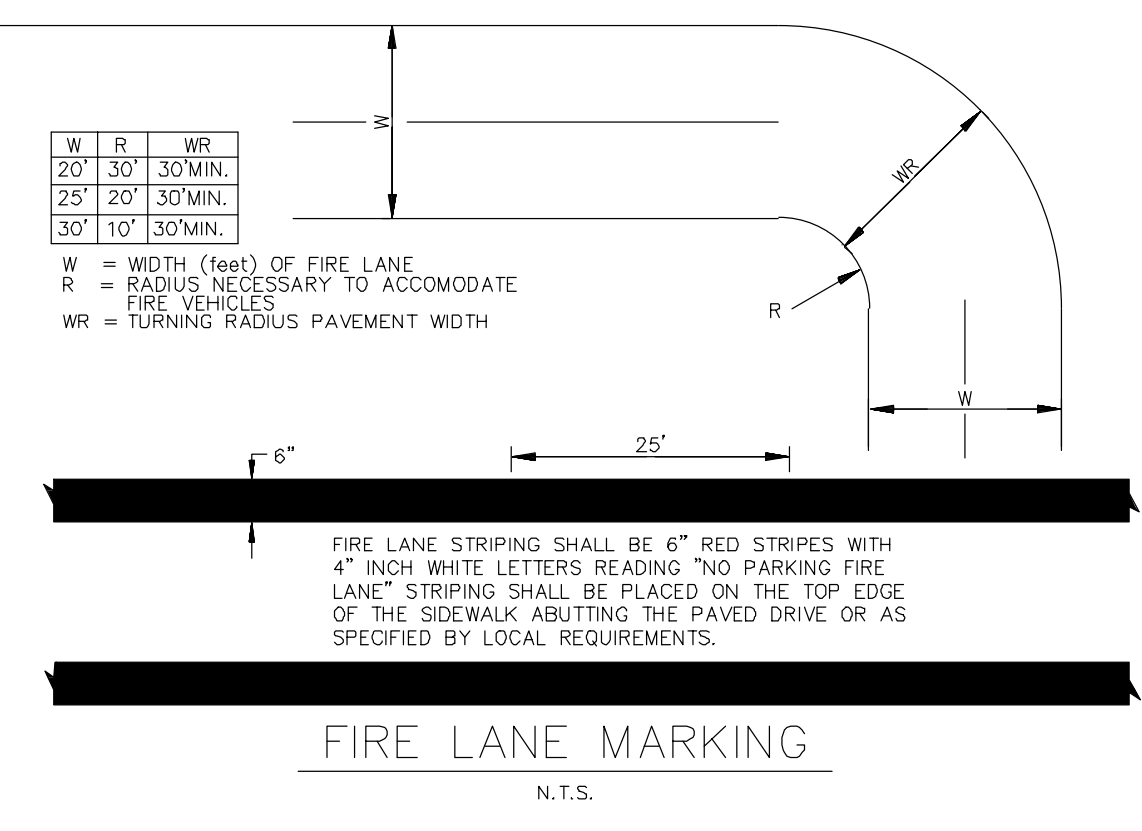
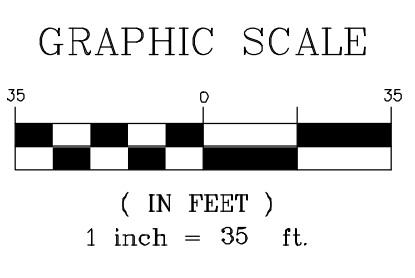
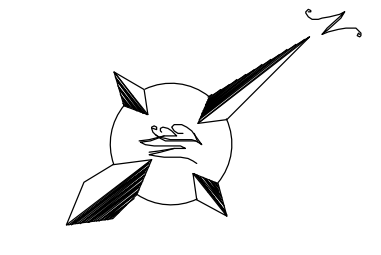

Z:\2024\2024019 Pitre Kia ABD.dwg Construction\2024019\_F1.dwg Aug 22, 2024 - 9:00am

	<b>KIA WESTSIDE AUTO DEALERSHIP</b> FIRE ONE PLAN	DRAWN BY RMG DATE 08/06/2024
	TERRA WEST, LLC 5571 MIDWAY PARK PLACE NE ALBUQUERQUE, NM 87109 (505) 858-3100 www.tterrawestllc.com	SHEET # <b>F1-1</b> JOB # 2024019