



# ***City of Albuquerque***

P.O. BOX 1293 ALBUQUERQUE, NEW MEXICO 87103

**January 27, 1999**

**Scott McGee, P.E.  
Isaacson & Arfman, P.A.  
128 Monroe Street NE  
Albuquerque, N.M. 87108**

**RE: REVISED PHASING PLAN FOR WESTWOOD RANCH APTS. (B-13/D6B)  
RECEIVED DEC 21, 1998 FOR PHASE 2A  
ENGINEER'S CERTIFICATION DATED 12/21/98**

**Dear Mr. McGee:**

**Based on the information included in the submittal referenced above, City Hydrology  
accepts the Revised Phasing Plan creating Phase 2A.**

**If I can be of further assistance, You may contact me at 768-2727.**

**Sincerely,**

**John P. Curtin, P.E.  
Civil Engineer/Hydrology**

**c: Andrew Garcia**

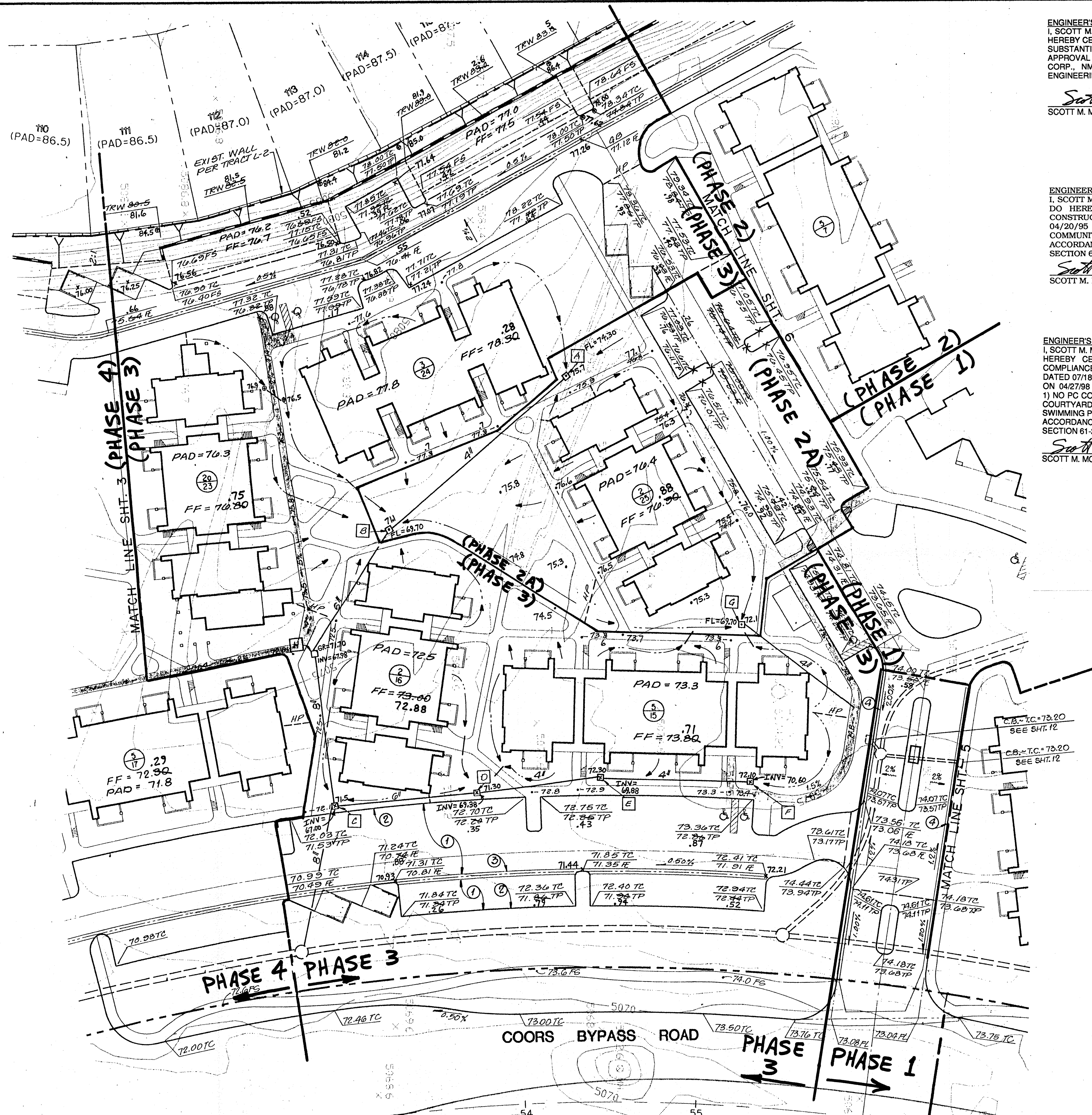

ENGINEER'S CERTIFICATION: BUILDING 25 (PHASE 2A)  
I, SCOTT M. MCGEE, LICENSED UNDER THE LAWS OF THE STATE OF NEW MEXICO, DO HEREBY CERTIFY THAT THE NOTED PORTION OF THIS PROJECT WAS CONSTRUCTED IN SUBSTANTIAL COMPLIANCE WITH THE APPROVED PLAN DATED 04/20/95 (CITY APPROVAL LETTER DATED 07/18/95) AS FIELD VERIFIED BY COMMUNITY SCIENCES CORP., NMLS NO. 5211 ON 12/15/98 IN ACCORDANCE WITH THE "NEW MEXICO ENGINEERING AND SURVEYING ACT" SECTION 61-23-1 THROUGH 61-23-32 NMSD (1979).

*Scott M. McGee*  
SCOTT M. MCGEE, NMPE NO. 10519  
12/21/98  
DATE

ENGINEER'S CERTIFICATION: BUILDINGS 15-24 (PHASES 3 & 4)  
I, SCOTT M. MCGEE, LICENSED UNDER THE LAWS OF THE STATE OF NEW MEXICO, DO HEREBY CERTIFY THAT THE NOTED PORTION OF THIS PROJECT WAS CONSTRUCTED IN SUBSTANTIAL COMPLIANCE WITH THE APPROVED PLAN DATED 04/20/95 (CITY APPROVAL LETTER DATED 07/18/95) AS FIELD VERIFIED BY COMMUNITY SCIENCES CORP., NMLS NO. 5211 ON 03/11/99 THROUGH 03/15/99 IN ACCORDANCE WITH THE "NEW MEXICO ENGINEERING AND SURVEYING ACT" SECTION 61-23-1 THROUGH 61-23-32 NMSD (1979).

*Scott M. McGee*  
SCOTT M. MCGEE, NMPE NO. 10519  
3/23/99  
DATE

ENGINEER'S CERTIFICATION: ALL BUILDINGS - ALL PHASES - FINAL  
I, SCOTT M. MCGEE, LICENSED UNDER THE LAWS OF THE STATE OF NEW MEXICO, DO HEREBY CERTIFY THAT THIS PROJECT WAS CONSTRUCTED IN SUBSTANTIAL COMPLIANCE WITH THE APPROVED PLAN DATED 04/20/95 (CITY APPROVAL LETTER DATED 07/18/95) AS FIELD VERIFIED BY COMMUNITY SCIENCES CORP., NMLS NO. 5211 ON 04/27/98 THROUGH 04/29/98 AND 08/11/99 WITH THE FOLLOWING EXCEPTIONS: 1) NO PC CONCRETE VALLEY GUTTERS WERE CONSTRUCTED AND 2) THE INTERIOR COURTYARD AREA BEHIND THE CLUBHOUSE (SHEET 4) HAS BEEN AS-BUILT WITH 2 SWIMMING POOLS AND REVISED AREA DRAINS AS SHOWN. THIS CERTIFICATION IS IN ACCORDANCE WITH THE "NEW MEXICO ENGINEERING AND SURVEYING ACT" SECTION 61-23-1 THROUGH 61-23-32 NMSD (1979).

*Scott M. McGee*  
SCOTT M. MCGEE, NMPE NO. 10519  
11/16/99  
DATE

LEGEND:  
[Symbol] HANDICAP ACCESSIBILITY ROUTE  
[Symbol] BLDG. TYPE  
[Symbol] BLDG. NO.  
PHASE LINE  
76.88 AS-BUILT ELEVATION

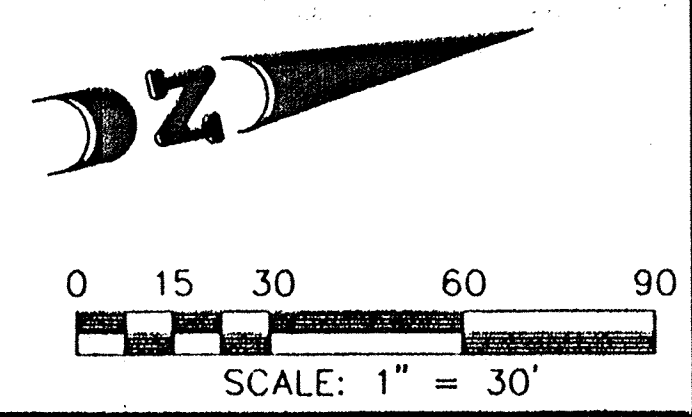

ISAACSON & ARFMAN, P.A.  
Consulting Engineering Associates  
128 Monroe Street N.E.  
Albuquerque New Mexico

CITY OF ALBUQUERQUE PUBLIC WORKS DEPARTMENT ENGINEERING GROUP					
TITLE: WESTWOOD RANCH APARTMENTS GRADING & DRAINAGE PHASING PLAN					
APPROVALS	ENGINEER	DATE	APPROVALS	ENGINEER	DATE
DRC CHAIRMAN			WATER		
TRANSPORTATION			WASTE WATER		
HYDROLOGY					
DRAWING NO.	MAP NO.		SHEET 4 OF 18		