

## PROJECT LOCATION MAP

N.T.S.



### GENERAL SWPPP NOTES:

- COPIES OF THE APPROVED STORM WATER POLLUTION PREVENTION PLANS SHALL BE MAINTAINED ON THE SITE AT ALL TIMES ALONG WITH ANY NECESSARY PERMITS AND INSPECTION FORMS. ALL CONSTRUCTION ACTIVITIES SHALL BE IN COMPLIANCE WITH THE PROJECT SWPPP.
- ALL EROSION AND SEDIMENTATION CONTROL MEASURES AND DEVICES SHALL BE INSTALLED AND FUNCTIONAL BEFORE THE SITE IS OTHERWISE DISTURBED. THEY SHALL BE KEPT OPERATIONAL AND MAINTAINED CONTINUOUSLY THROUGHOUT THE PERIOD OF LAND DISTURBANCE UNTIL PERMANENT SITE STABILIZATION HAS BEEN ACHIEVED.
- CONTRACTOR SHALL IMPLEMENT SITE SPECIFIC BEST MANAGEMENT PRACTICES (BMPs) AS SHOWN AND REQUIRED BY THE SWPPP. ADDITIONAL BEST MANAGEMENT PRACTICES SHALL BE IMPLEMENTED BY THE CONTRACTOR AS DICTATED BY SITE CONDITIONS OR THE PROJECT GOVERNING AUTHORITIES AT NO ADDITIONAL COST TO THE OWNER THROUGHOUT ALL PHASES OF CONSTRUCTION.
- ALL BEST MANAGEMENT PRACTICES AND CONTROLS SHALL CONFORM TO THE APPLICABLE FEDERAL, STATE, OR LOCAL REQUIREMENTS, STANDARDS, AND SPECIFICATIONS OR MANUAL OF PRACTICE.
- IF AFTER REPEATED FAILURE ON THE PART OF THE CONTRACTOR TO PROPERLY CONTROL SOIL EROSION, SEDIMENT AND/OR POLLUTION FROM THE PROJECT SITE, THE GOVERNING AUTHORITIES RESERVE THE RIGHT TO EFFECT NECESSARY CORRECTIVE MEASURES AND CHARGE ANY COSTS TO THE CONTRACTOR.
- INLET PROTECTION SHALL BE INSTALLED AROUND EACH INLET OR CATCH BASIN WITHIN THE VICINITY OF THE DISTURBED AREA LIMITS AS SHOWN ON THE PLANS. THESE SHALL BE MAINTAINED UNTIL THE TRIBUTARY DRAINAGE AREAS HAVE ADEQUATE GRASS COVER AND/OR APPROPRIATE GROUND STABILIZATION.
- ALL STREETS ADJACENT TO THE PROJECT SITE SHALL BE KEPT FREE OF DIRT, MUD AND DEBRIS. CONTRACTOR SHALL CLEAN ADJACENT PAVEMENTS AT THE END OF EACH WORKING DAY WHEN NECESSARY. ANY FUGITIVE DIRT/DEBRIS ON ADJACENT PAVEMENTS SHALL BE REMOVED AT THE END OF EACH DAY.
- CONTRACTORS SHALL MINIMIZE BARE EARTH SURFACES DURING CONSTRUCTION TO THE EXTENT PRACTICABLE.
- ALL DISTURBED AREAS SHALL BE SEEDED OR SODDED AS SOON AS IS PRACTICABLE.
- IF DURING CONSTRUCTION OPERATIONS ANY LOOSE MATERIALS ARE DEPOSITED IN THE FLOW LINE OF GUTTERS, DRAINAGE STRUCTURES, OR DITCHES SUCH THAT THE NATURAL FLOW LINE OF WATER IS OBSTRUCTED, THIS LOOSE MATERIAL SHALL BE REMOVED.
- ALL SEDIMENT SHALL BE PREVENTED FROM ENTERING ANY EXISTING STORM DRAINAGE SYSTEMS BY THE USE OF INLET PROTECTION OR OTHER APPROVED FUNCTIONAL METHODS. THE CONTRACTOR SHALL BE RESPONSIBLE FOR REMOVING SEDIMENT RESULTING FROM CONSTRUCTION ACTIVITIES ASSOCIATED WITH THIS PROJECT.
- CONSTRUCTION ACCESS POINTS TO THE SITE SHALL BE PROTECTED IN SUCH A WAY AS TO PREVENT TRACKING OF MUD OR SOIL ONTO PUBLIC THOROUGHFARES. ALL SEDIMENT SPILLED, DROPPED, WASHED OR TRACKED ONTO PUBLIC RIGHTS-OF-WAY MUST BE REMOVED IMMEDIATELY BY THE CONTRACTOR.
- SUFFICIENT OIL AND GREASE ABSORBING MATERIALS AND FLotation BOOMS SHALL BE MAINTAINED ON SITE OR READILY AVAILABLE TO CONTAIN AND CLEAN-UP FUEL OR CHEMICAL SPILLS AND LEAKS.
- DUST SHALL BE ADEQUATELY CONTROLLED ON THE PROJECT SITE AT ALL TIMES DURING CONSTRUCTION.
- RUBBISH, TRASH, GARBAGE, LITTER, OR OTHER SUCH MATERIALS SHALL BE DEPOSITED INTO SEALED TRASH CONTAINERS. MATERIALS SHALL BE PREVENTED FROM LEAVING THE PREMISES THROUGH THE ACTION OF WIND OR STORMWATER DISCHARGE INTO DRAINAGE DITCHES OR WATERS OF THE STATE.
- DURING DEWATERING OPERATIONS, WATER SHALL BE PUMPED OR OTHERWISE DISCHARGED FROM THE SITE INTO SEDIMENT BASINS, SILT TRAPS, DEWATERING BAGS OR POLYMER MIXING SWALES. DEWATERING DIRECTLY INTO FIELD TILES OR STORMWATER SYSTEMS IS PROHIBITED.
- ALL DISTURBED AREAS SHALL BE SEEDED OR SODDED WITHIN THREE (3) DAYS OF FINAL DISTURBANCE.
- ALL SOIL STOCKPILES SHALL BE STABILIZED WITHIN THREE (3) DAYS OF FORMING THE STOCKPILE. STABILIZATION MEASURES SHALL BE INITIATED AS SOON AS PRACTICABLE IN PORTIONS OF THE SITE WHERE CONSTRUCTION ACTIVITIES HAVE TEMPORARILY OR PERMANENTLY CEASED, BUT IN NO CASE MORE THAN SEVEN (7) DAYS AFTER THE CONSTRUCTION ACTIVITY IN THAT PORTION OF THE SITE HAS TEMPORARILY OR PERMANENTLY CEASED AS FOLLOWS:
  - WHEN THE INITIATION OF STABILIZATION MEASURES BY THE 7TH DAY AFTER CONSTRUCTION ACTIVITY TEMPORARILY OR PERMANENTLY CEASES IS PRECLUDED BY SNOW COVER, STABILIZATION MEASURES SHALL BE INITIATED AS SOON AS PRACTICABLE.
  - WHEN CONSTRUCTION ACTIVITY WILL RESUME ON A PORTION OF THE SITE WITHIN 14 DAYS FROM WHEN ACTIVITIES CEASED (I.E. THE TOTAL TIME PERIOD THAT CONSTRUCTION ACTIVITY IS TEMPORARILY CEASED IS LESS THAN 14 DAYS), THEN STABILIZATION MEASURES DO NOT HAVE TO BE INITIATED ON THAT PORTION OF THE SITE BY THE 7TH DAY AFTER CONSTRUCTION ACTIVITY TEMPORARILY CEASES.
- PRE-QUALIFIED PERSONNEL (PROVIDED BY THE CONTRACTOR) SHALL INSPECT DISTURBED AREAS OF THE CONSTRUCTION SITE THAT HAVE NOT BEEN FINALLY STABILIZED, STRUCTURAL CONTROL MEASURES, AND LOCATIONS WHERE VEHICLES ENTER OR EXIT THE SITE AT LEAST ONCE EVERY SEVEN (7) CALENDAR DAYS AND WITHIN TWENTY-FOUR (24) HOURS OF THE END OF A RAINFALL EVENT THAT IS 0.5 INCH OR GREATER (OR EQUIVALENT SNOWFALL). REQUIRED REPAIRS SHOULD BE COMPLETED WITHIN FORTY-EIGHT (48) HOURS OF THE INSPECTION.
- EROSION CONTROL BLANKETS SHALL BE USED IN AREAS OF 4:1 SLOPE OR STEEPER.
- ALL TEMPORARY EROSION CONTROL AND SEDIMENT CONTROL MEASURES SHALL BE REMOVED THIRTY (30) DAYS AFTER FINAL SITE STABILIZATION IS ACHIEVED OR AFTER THE TEMPORARY MEASURES ARE NO LONGER NEEDED. TRAPPED SEDIMENT SHALL BE PROPERLY STABILIZED OR DISPOSED OF OFF SITE BY THE CONTRACTOR.
- PRIOR TO COMMENCING LAND DISTURBING ACTIVITIES IN AREAS OTHER THAN THOSE INDICATED ON THESE PLANS (INCLUDING BUT NOT LIMITED TO ADDITIONAL PHASES OF DEVELOPMENT AND OFF-SITE BORROW OR WASTE AREAS) A SUPPLEMENTARY STORM WATER POLLUTION PREVENTION PLAN SHALL BE SUBMITTED TO THE OWNER AND ENGINEER FOR REVIEW.
- ALL DIRT AND DEBRIS ORIGINATING FROM CONSTRUCTION ACTIVITIES SHALL REMAIN WITHIN THE LIMITS OF DISTURBANCE AS SHOWN ON THIS PLAN. DIRT AND DEBRIS DESIGNATED FOR EXPORT SHALL BE REMAIN WITHIN THE LIMITS OF DISTURBANCE EXCEPT FOR MATERIALS THAT ARE ACTIVELY BEING EXPORTED.
- ALL GOOD HOUSEKEEPING MEASURES LISTED IN THE PROJECT SWPPP SHALL BE MAINTAINED THROUGHOUT CONSTRUCTION ACTIVITIES AND UNTIL FINAL STABILIZATION OF THE SITE HAS OCCURRED.
- REFER TO THE PROJECT LANDSCAPE PLANS FOR IMPERVIOUS AREA SURFACE TREATMENT FOR FINAL SITE STABILIZATION. REMOVAL OF TEMPORARY SITE EROSION AND SEDIMENT CONTROL MEASURES SHALL NOT OCCUR UNTIL FINAL SITE STABILIZATION.

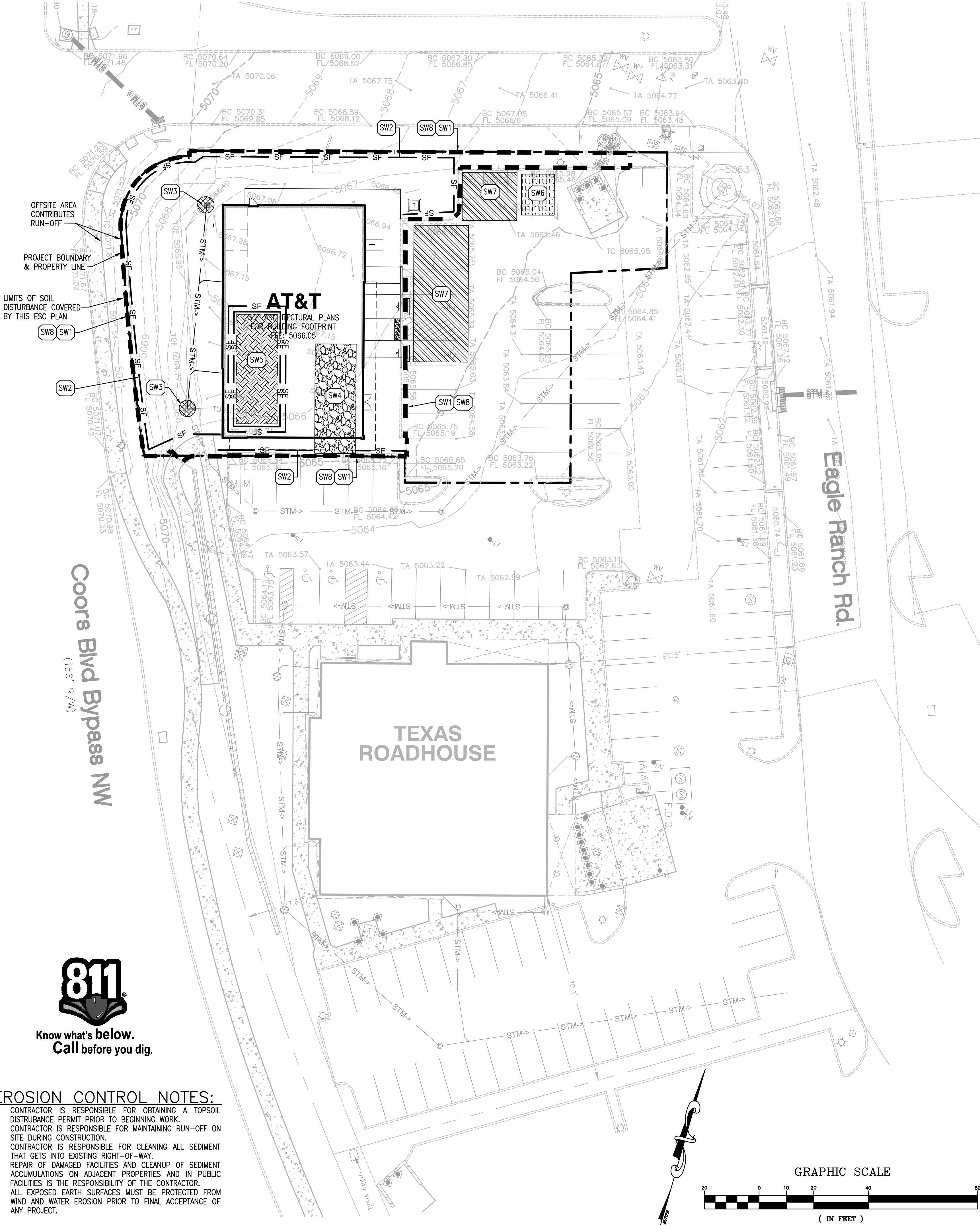

Know what's below.  
Call before you dig.

### EROSION CONTROL NOTES:

- CONTRACTOR IS RESPONSIBLE FOR OBTAINING A TOPSOIL DISTURBANCE PERMIT PRIOR TO BEGINNING WORK.
- CONTRACTOR IS RESPONSIBLE FOR MAINTAINING RUN-OFF ON SITE DURING CONSTRUCTION.
- CONTRACTOR IS RESPONSIBLE FOR CLEANING ALL SEDIMENT THAT GETS INTO EXISTING RIGHT-OF-WAY.
- REPAIR OF DAMAGED FACILITIES AND CLEANUP OF SEDIMENT ACCUMULATIONS ON ADJACENT PROPERTIES AND IN PUBLIC FACILITIES IS THE RESPONSIBILITY OF THE CONTRACTOR.
- ALL EXPOSED EARTH SURFACES MUST BE PROTECTED FROM WIND AND WATER EROSION PRIOR TO FINAL ACCEPTANCE OF ANY PROJECT.

### EXISTING LEGEND:

- PROPERTY LINE
- EXISTING EASEMENT LINE
- EXISTING CONCRETE CURB AND GUTTER
- EXISTING STORM SEWER STRUCTURES
- EXISTING SANITARY SEWER STRUCTURES
- EXISTING FIRE HYDRANT
- EXISTING WATER VALVE
- EXISTING WATER METER
- EXISTING DOUBLE CHECK DETECTOR ASSEMBLY WITH HOT BOX
- EXISTING WATER METER AND BACKFLOW PREVENTION DEVICE WITH HOT BOX
- EXISTING POST INDICATOR VALVE
- EXISTING LIGHT POLE
- EXISTING TRANSFORMER
- EXISTING DRAINAGE FLOW DIRECTION
- EXISTING STORM SEWER
- EXISTING CONTOUR

### PROPOSED LEGEND:

- PROPERTY LINE
- PROPOSED CONTOUR
- LAND DISTURBANCE LIMITS (SEE DISTURBED SITE AREA TABLE)
- PROPOSED SILT FENCE
- PROPOSED STONE BAG INLET PROTECTION
- PROPOSED STABILIZED CONSTRUCTION ENTRANCE
- PROPOSED TEMPORARY TOPSOIL STOCKPILE (SUGGESTED LOCATION)
- PROPOSED CONCRETE WASHOUT (SUGGESTED LOCATION)
- PROPOSED CONTRACTOR STAGING AREA (SUGGESTED LOCATION)
- PROPOSED STORM SEWER
- PROPOSED DRAINAGE FLOW DIRECTION
- PROPOSED STORM SEWER STRUCTURES
- PROPOSED CONCRETE WHEEL STOP
- PROPOSED CONCRETE CURB AND GUTTER

### SWPPP KEY NOTES:

- SW1 PROPOSED PROJECT LAND DISTURBANCE LIMITS
- SW2 PROPOSED SILT FENCE
- SW3 PROPOSED INLET PROTECTION
- SW4 PROPOSED STABILIZED CONSTRUCTION ENTRANCE
- SW5 PROPOSED TEMPORARY TOPSOIL STOCKPILE WITH DOUBLE SILT FENCE PROTECTION
- SW6 PROPOSED CONCRETE WASHOUT WITH MINIMUM 30-MIL POLYETHYLENE LINING AND LOCATION SIGNAGE
- SW7 PROPOSED CONTRACTOR STAGING AREA INCLUDING BUILDING MATERIALS STORAGE, COVERED TRASH DUMPSTER, AND PORTABLE TOILET FACILITIES
- SW8 GENERAL SCOPE OF WORK LIMITS. SCOPE MAY INCLUDE ITEMS OUTSIDE GENERAL LIMITS OR EXCLUDE ITEMS WITHIN. SEE KEY NOTES ON PLAN FOR ADDITIONAL INFORMATION.

### PROJECT INFORMATION:

TOTAL DISTURBED AREA: 13,500 SQ. FT. / 0.31 ACRES  
TOTAL SITE AREA: 19,989 SQ. FT. / 0.4589 ACRES

### SWPPP MAINTENANCE & SCHEDULE:

- OBTAIN ALL APPLICABLE SITE PERMITS AND THOROUGHLY REVIEW PROJECT'S STORMWATER POLLUTION PREVENTION PLAN (SWPPP) PRIOR TO COMMENCEMENT OF CONSTRUCTION OPERATIONS. CONTRACTOR SHALL BE RESPONSIBLE FOR MAINTAINING AND UPDATING THE SWPPP THROUGHOUT THE DURATION OF CONSTRUCTION AS NECESSARY UNTIL FINAL SITE STABILIZATION IS ACHIEVED.
- INSTALL PERIMETER SEDIMENT CONTROL MEASURES (I.E. SILT FENCE AND STABILIZED CONSTRUCTION ENTRANCE).
- INSTALL INLET PROTECTION DEVICES FOR EXISTING STORM SEWER INLETS AND DRAINAGE STRUCTURES.
- PERFORM STORMWATER POLLUTION PREVENTION SITE INSPECTIONS ON A WEEKLY BASIS AND WITHIN TWENTY-FOUR (24) HOURS OF THE END OF A RAINFALL EVENT THAT IS 0.5 INCH OR GREATER (OR EQUIVALENT SNOWFALL). AT A MINIMUM, THE INSPECTIONS SHALL INCLUDE THE DISTURBED AREAS OF THE CONSTRUCTION SITE THAT HAVE NOT BEEN FINALLY STABILIZED, ALL STRUCTURAL CONTROL MEASURES, LOCATIONS WHERE VEHICLES ENTER OR EXIT THE SITE, AND ANY ADDITIONAL BEST MANAGEMENT PRACTICES IDENTIFIED IN THE SWPPP.
  - ALL SITE EROSION AND SEDIMENT CONTROL MEASURES AND BEST MANAGEMENT PRACTICES SHALL BE THE RESPONSIBILITY OF THE GENERAL CONTRACTOR AND SHALL BE CONTINUOUSLY MAINTAINED THROUGHOUT THE DURATION OF CONSTRUCTION. CONTRACTOR SHALL MAKE AND COMPLETE THE REQUIRED REPAIRS WITHIN FORTY-EIGHT (48) HOURS OF THE INSPECTION.
  - CONTRACTOR IS RESPONSIBLE FOR INSTALLATION OF ANY ADDITIONAL STRUCTURAL CONTROL MEASURES NECESSARY TO PREVENT EROSION AND SEDIMENTATION AS DETERMINED BY THE SITE INSPECTIONS.
- INSTALL NEW STORM SEWERS AND OTHER SITE UTILITIES AS INDICATED ON THE PLANS.
- PROVIDE TEMPORARY SEEDING AND/OR MULCHING FOR ALL DISTURBED SITE AREAS THAT WILL NOT BE WORKED ON FOR MORE THAN FOURTEEN (14) DAYS.
- INSTALL TEMPORARY CONCRETE WASHOUT FACILITY PRIOR TO COMMENCEMENT OF ANY CONCRETE WORK ON SITE.
- INSTALL CURBS AND BEGIN SITE PAVING OPERATIONS (I.E. DRIVEWAYS, SIDEWALKS, ETC.).
- PERFORM STREET CLEANING OPERATIONS AND OTHER BEST MANAGEMENT PRACTICES AS NEEDED FOR AREAS ADJACENT TO THE PROJECT SITE.
- INSTALL BUILDING FOUNDATION AND COMPLETE BUILDING CONSTRUCTION AND REMAINING SITE IMPROVEMENTS.
- REMOVE ALL TEMPORARY SITE EROSION AND SEDIMENT CONTROL MEASURES WITHIN THIRTY (30) DAYS OF FINAL SITE STABILIZATION.

## GreenbergFarrow

19000 MacArthur Blvd, Suite 250  
Irvine, CA 92612  
t: 949 296 0450 f: 949 296 0479

### PROJECT TEAM

COPYRIGHT NOTICE  
This drawing is the property of the above referenced Professional and is not to be used for any purpose other than the specific project and site named herein, and cannot be reproduced in any manner without the express written permission from the Professional.

### ISSUE/REVISION RECORD

DATE	DESCRIPTION
05/20/16	PERMIT & BID SET

### PROFESSIONAL SEAL



### PROFESSIONAL IN CHARGE

**FARMAN SHIR, P.E.**  
PROFESSIONAL ENGINEER  
LICENSE NO. 21307

### PROJECT MANAGER

MIKE HOLMES

### QUALITY CONTROL

LARRY DIEHL

### DRAWN BY

JOSH WILMOTH

### PROJECT NAME

**AT&T**

**ALBUQUERQUE  
NEW MEXICO**

**10036 COORS  
BOULEVARD BYPASS NW**

**TEKIN & ASSOCIATES**  
REAL ESTATE INVESTMENT & DEVELOPMENT

### PROJECT NUMBER

20160093.0

### SHEET TITLE

**STORMWATER  
POLLUTION  
PREVENTION PLAN**

### SHEET NUMBER

**C5.0**

NOT ISSUED FOR CONSTRUCTION