

PROPOSED LEGEND:

- PROPERTY LINE
- 6"W PROPOSED 6" FIRE PROTECTION WATER LINE
- 4"W PROPOSED 4" FIRE PROTECTION WATER LINE
- 2"W PROPOSED 2" DOMESTIC WATER SERVICE
- 1"W PROPOSED 1" IRRIGATION WATER SERVICE
- PROPOSED STORM SEWER STRUCTURE WITH OPEN GRATE
- PROPOSED STORM SEWER STRUCTURE WITH CLOSED LID
- PROPOSED STORM SEWER CLEAN OUT
- HEAVY DUTY AREA DRAIN
- PROPOSED SANITARY SEWER GREASE INTERCEPTOR
- PROPOSED SANITARY SEWER SAMPLING WELL
- PROPOSED SANITARY SEWER MANHOLE
- PROPOSED TAPPING SLEEVE AND VALVE
- PROPOSED LIGHT POLE
- PROPOSED GAS METER
- PROPOSED ELECTRIC METER, CT CABINET AND DISCONNECT
- PROPOSED TRANSFORMER

NOTE: SEE SHEET C1.0 FOR EXISTING LEGEND

CODE CRITERIA:

CONSTRUCTION TYPE: VB  
SQUARE FOOTAGE: 7,575 SF  
FIRE FLOW: 1,000 GPM  
NUMBER OF HYDRANTS REQUIRED: 1  
HYDRANT SPACING REQUIRED: 750 FEET WITH SPRINKLERS  
SPRINKLER SYSTEM: SPRINKLERED

FIRE INFORMATION:

FIRE CASE#: TEXAS ROADHOUSE BUILDING AREA: 7,575 SQ. FT.  
CONSTRUCTION TYPE: VB  
OCCUPANCY: A2  
BUILDING HEIGHT: 25'-6"

KNOX BOX LOCATION: MAIN ENTRANCE ON WEST SIDE OF BUILDING (SEE PLAN)  
FDC LOCATION: SE OF BUILDING (SEE PLAN)  
PIV LOCATION: S CORNER OF BUILDING (SEE PLAN)  
HYDRANT LOCATIONS: EXISTING SE OF PROPERTY (SEE PLAN)

PAVEMENT HATCH LEGEND:

- PROPOSED ASPHALT PAVEMENT  
2" ASPHALT SURFACE COURSE  
6" AGGREGATE BASE  
(SEE GEOTECHNICAL REPORT)
- PROPOSED HEAVY DUTY ASPHALT PAVEMENT  
3" ASPHALT SURFACE COURSE  
6" AGGREGATE BASE  
(SEE GEOTECHNICAL REPORT)

FIRE FLOW: 1000 GPM

FIRE CASE#:

NO PORTIONS OF FIRE APPARATUS  
ACCESS ROADS EXCEED 10  
PERCENT IN GRADE

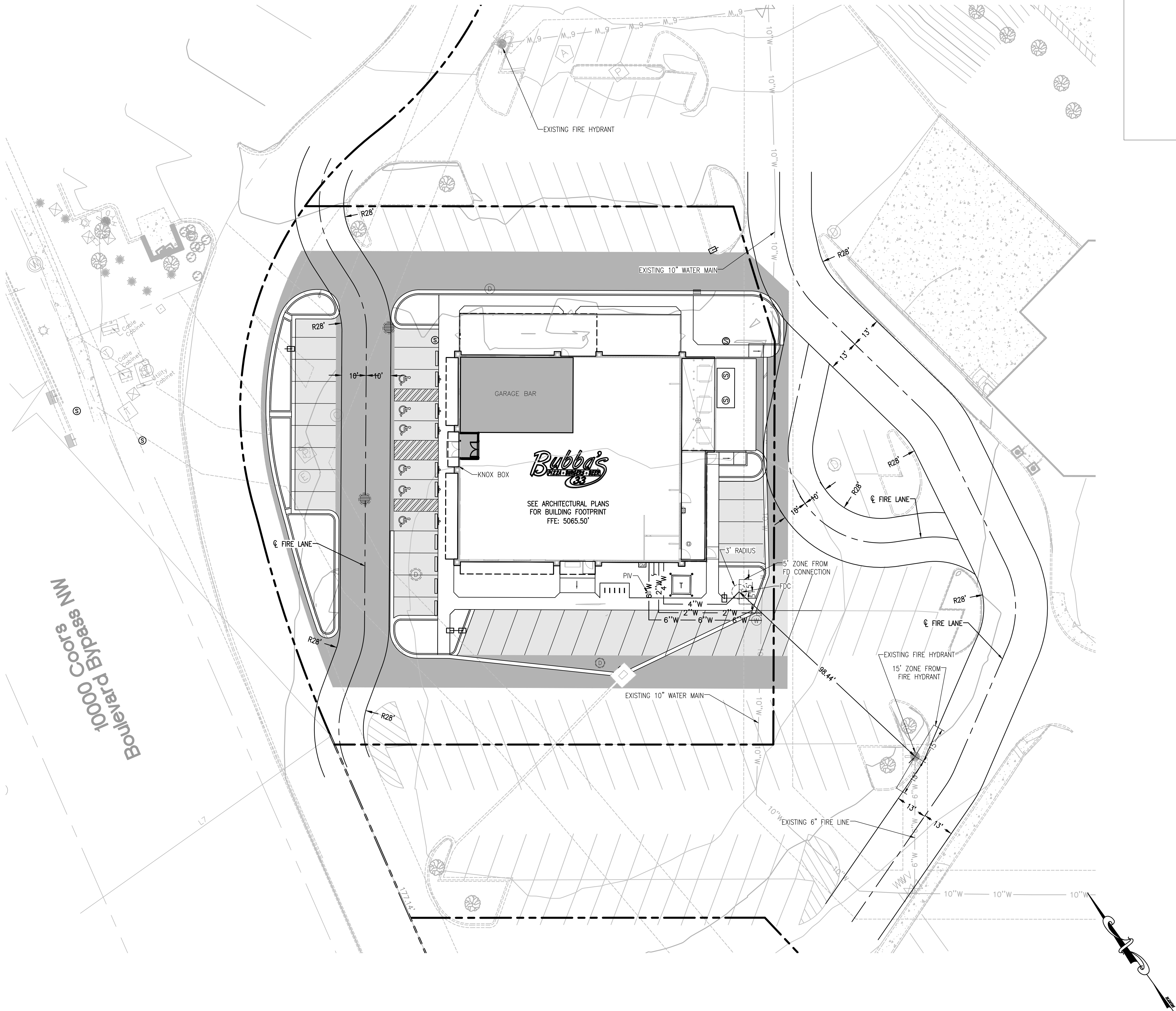

COPYRIGHT NOTICE  
This drawing is the property of the above referenced Professional and is not to be used for any purpose other than the specific project and site named herein, and cannot be reproduced in any manner without the express written permission from the Professional

ISSUE/REVISION RECORD

DATE	DESCRIPTION
02/28/21	COORDINATION SET
03/19/21	PERMIT SET

Proj 20182050  
MICHAEL E. HAAS  
NEW MEXICO  
26056  
PROFESSIONAL ENGINEER  
N. Haas  
expires 12/31/22  
date 3/19/21

PROFESSIONAL IN CHARGE  
MICHAEL HAAS  
PROFESSIONAL ENGINEER  
LICENSE NO. 26056

PROJECT MANAGER  
EDWARD GOSS

QUALITY CONTROL  
EDWARD GOSS

DRAWN BY  
MITCH HEFFERNAN

PROJECT NAME  
TEXAS  
ROADHOUSE

ALBUQUERQUE  
NEW MEXICO  
10000 COORS BYPASS NW  
ALBUQUERQUE, NM 87114

Bubba's  
PIZZA • BURGERS • BEER

PROJECT NUMBER  
20182050.0

SHEET TITLE

FIRE 1

SHEET NUMBER

C5.1

