

EROSION AND SEDIMENT CONTROL PLAN

10120 COORS BLVD NW

NOVEMBER, 2025

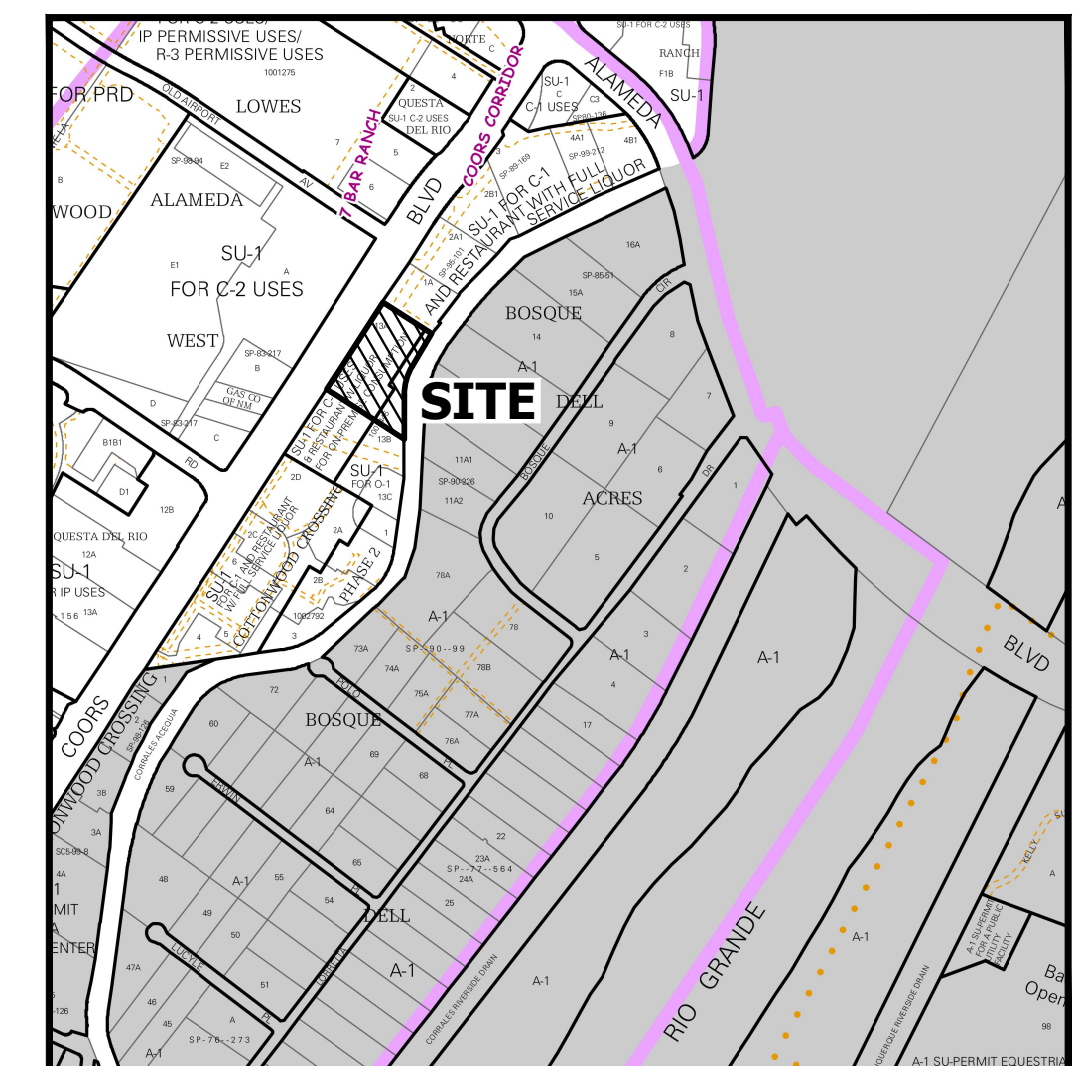

ZONE ATLAS MAP B-14-Z

ADDRESS: 10120 Coors Blvd NW, Albuquerque, NM
 LEGAL DESCRIPTION: Tract 13-A Black Ranch
 SITE AREA: 107,491 SF (2.47 acres)
 EXISTING CONDITIONS: The site is presently undeveloped. All site runoff surface flows to the east and discharges to the Corrales Main Canal.
 EROSION CONTROL: Disturbed portions of the site shall be kept wetted to minimize wind erosion. A temporary construction fence with screening will follow the site perimeter which will help mitigate windblown sediment. The impact on surrounding streets and properties should be minimized.

- ESC Plan Standard Notes (2023-06-16)
- All Erosion and Sediment Control (ESC) work on these plans, except as otherwise stated or provided hereon shall be permitted, constructed, inspected, and maintained in accordance with:
 - The City Ordinance § 14-5-2-11, the ESC Ordinance,
 - The EPA's 2022 Construction General Permit (CGP), and
 - The City of Albuquerque Construction BMP Manual.
 - All BMP's must be installed prior to beginning any earthmoving activities except as specified hereon in the Phasing Plan. Construction of earthen BMP's such as sediment traps, sediment basins, and diversion berms shall be completed and inspected prior to any other construction or earthwork. Self-inspection is required after installation of the BMPs and prior to beginning construction.
 - Self-inspections - In accordance with City Ordinance § 14-5-2-11(C)(1), "at a minimum a routine self-inspection is required to review the project for compliance with the Construction General Permit once every 14 days and after any precipitation event of 1/4 inch or greater until the site construction has been completed and the site determined as stabilized by the city. Reports of these inspections shall be kept by the person or entity authorized to direct the construction activities on the site and made available upon request.
 - Corrective action reports must be kept by the person or entity authorized to direct the construction activities on the site and made available upon request.
 - Final Stabilization and Notice of Termination (NOT) - In accordance with City Ordinance § 14-5-2-11(C)(1), self-inspections must continue until the site is "determined as stabilized by the city." The property owner/operator is responsible for determining when the "Conditions for Terminating CGP Coverage" per CGP Part 8.2 are satisfied and then for filing their Notice of Termination (NOT) with the EPA. Each operator may terminate CGP coverage only if one or more of the conditions in Part 8.2.1, 8.2.2, or 8.2.3 has occurred. After filing the NOT with the EPA, the property owner is responsible for requesting a Determination of Stabilization from the City.
 - When doing work in the City right-of-way (e.g. sidewalk, drive pads, utilities, etc.) prevent dirt from getting into the street. If dirt is present in the street, the street should be swept daily or prior to a rain event or contractor induced water event (e.g. curb cut or water test).
 - When installing utilities behind the curb, the excavated dirt should not be placed in the street.
 - When cutting the street for utilities the dirt shall be placed on the uphill side of the street cut and the area swept after the work is complete. A wattle or mulch sock may be placed at the toe of the excavated dirt pile if site constraints do not allow placing the excavated dirt on the uphill side of the street cut.
 - ESC Plans must show longitudinal street slope and street names. On streets where the longitudinal slope is steeper than 2.5%, wattles/mulch socks or j-hood silt fence shall be shown in the front yard swale or on the side of the street.

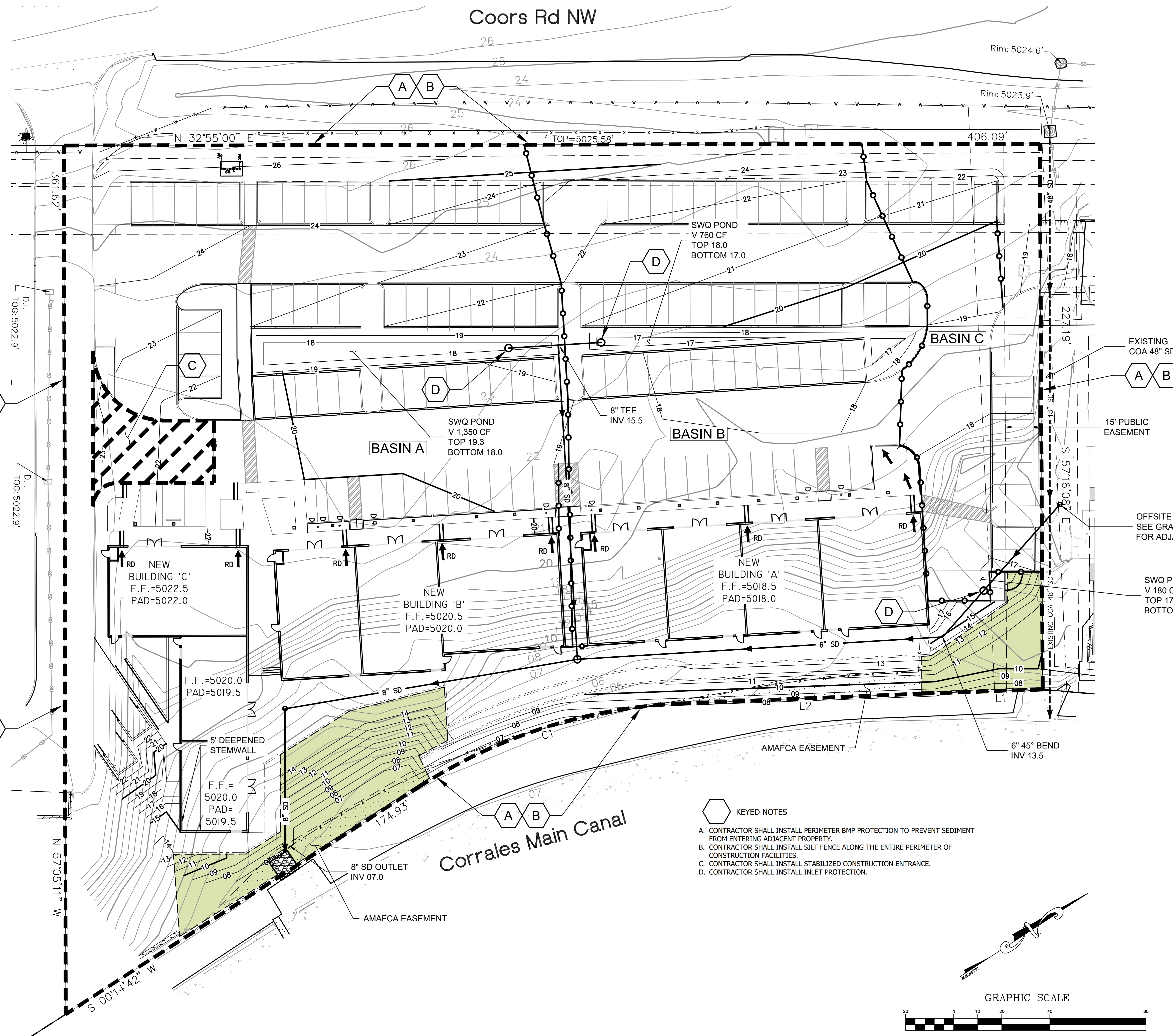

- KEYED NOTES
- CONTRACTOR SHALL INSTALL PERIMETER BMP PROTECTION TO PREVENT SEDIMENT FROM ENTERING ADJACENT PROPERTY.
 - CONTRACTOR SHALL INSTALL SILT FENCE ALONG THE ENTIRE PERIMETER OF CONSTRUCTION FACILITIES.
 - CONTRACTOR SHALL INSTALL STABILIZED CONSTRUCTION ENTRANCE.
 - CONTRACTOR SHALL INSTALL INLET PROTECTION.

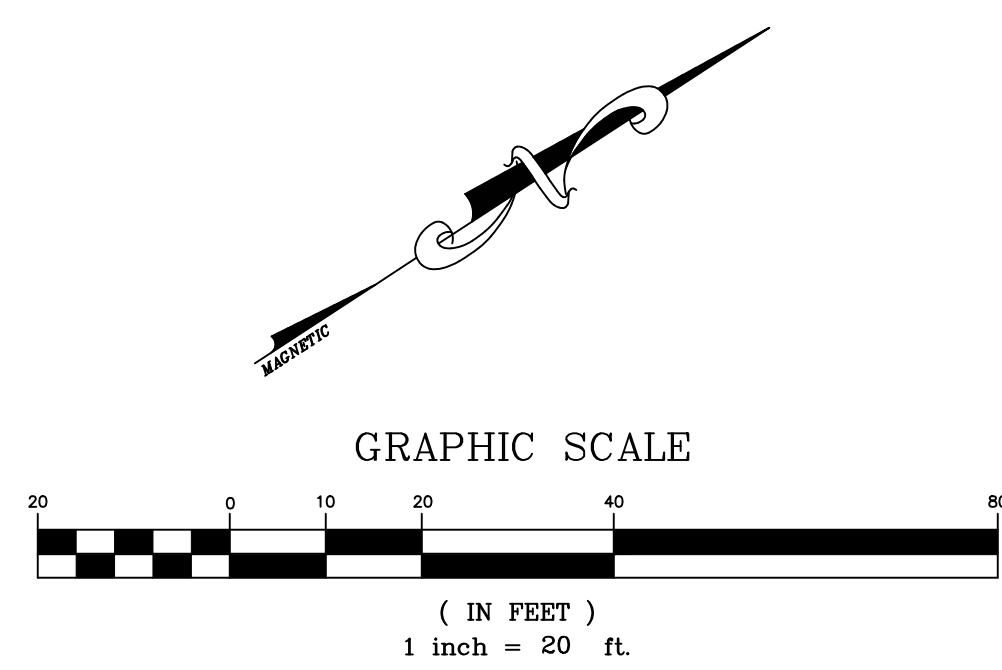

Scott M McGee PE

PO Box 1273
 Elephant Butte, NM 87935
 505.263.2905
 scottmmcgee@gmail.com

D:\Acad\dwg\Brett\Demis\Bovillans_Architecture - Site - Grading_052025.dwg

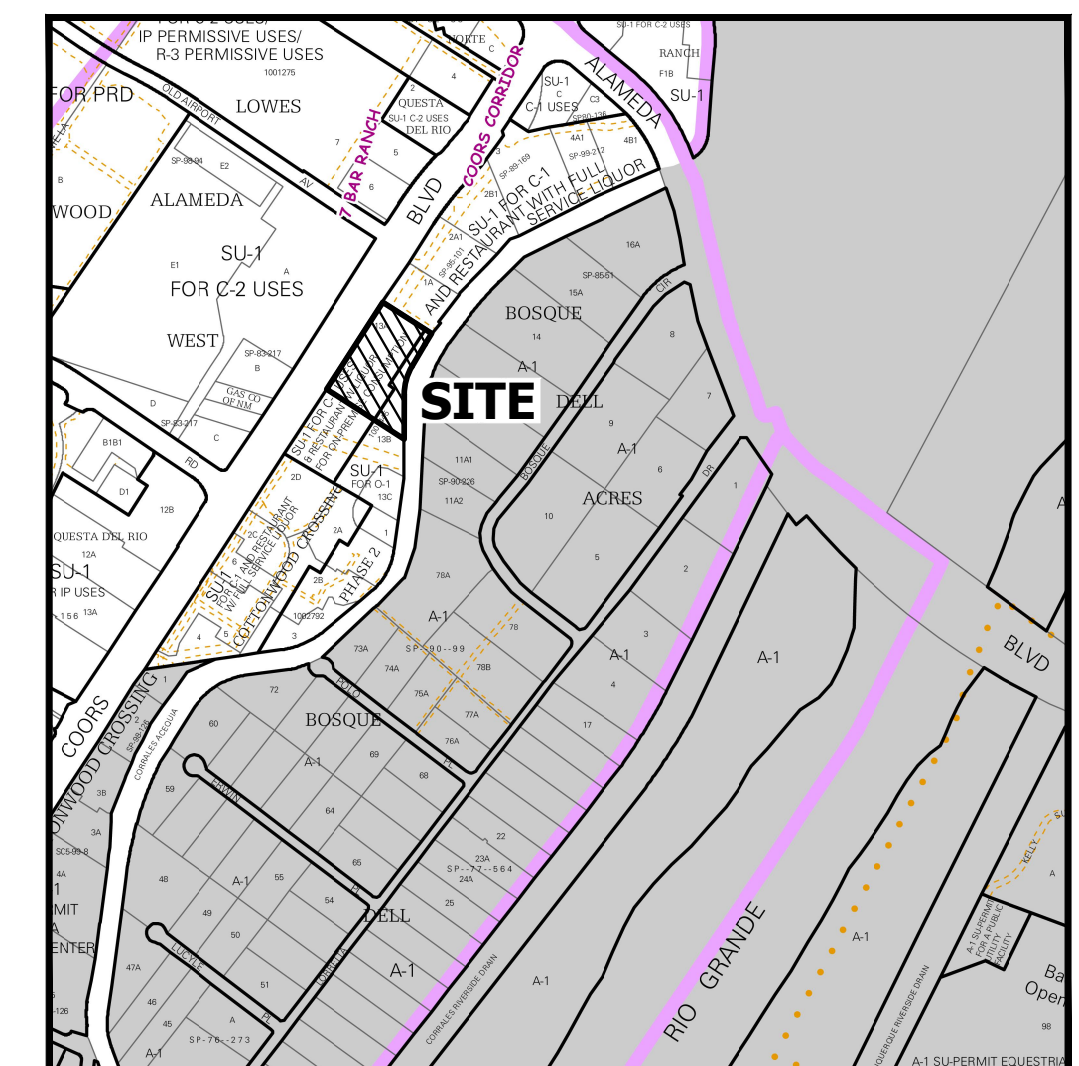

ZONE ATLAS MAP B-14-Z

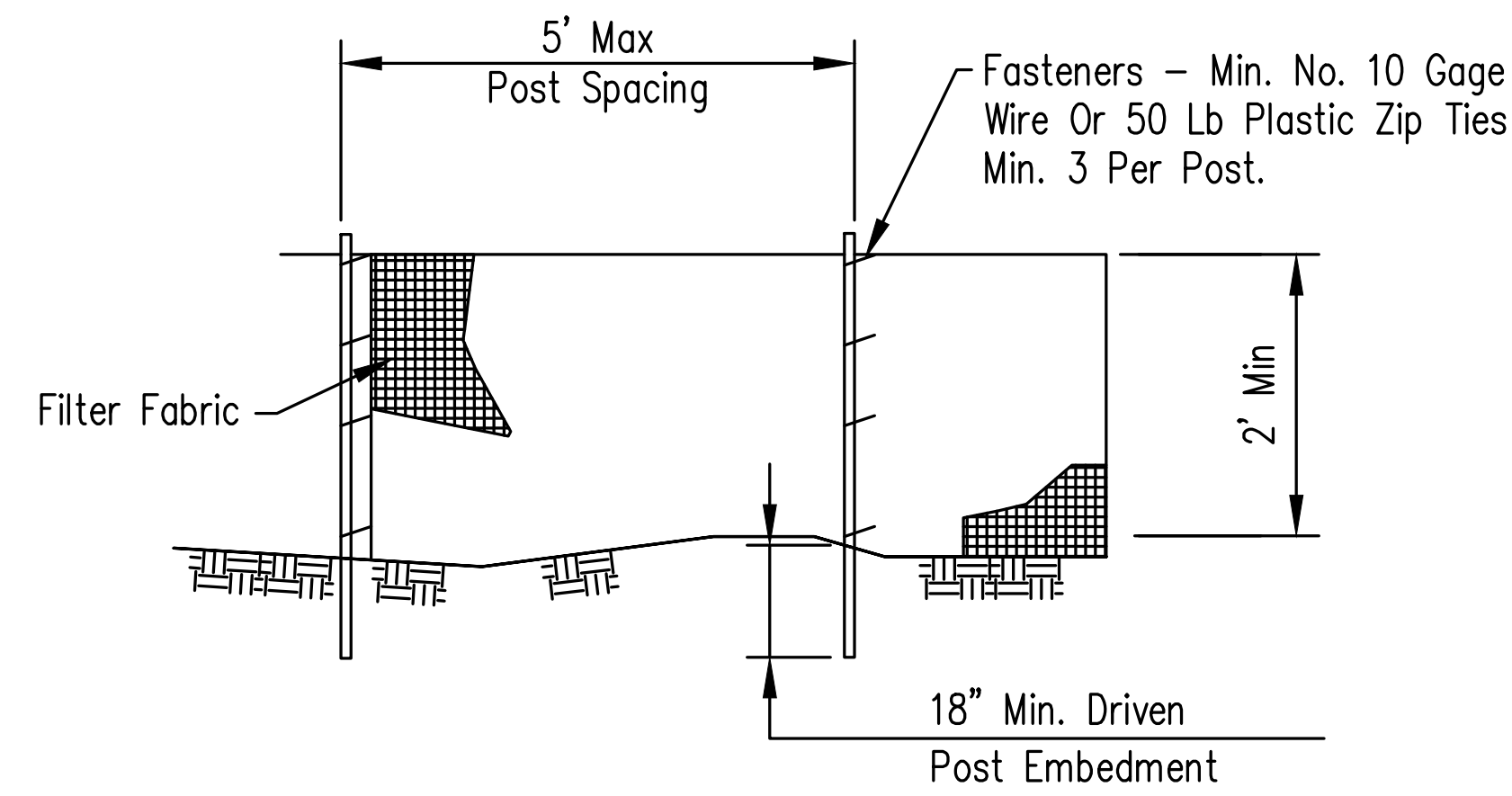

ELEVATION

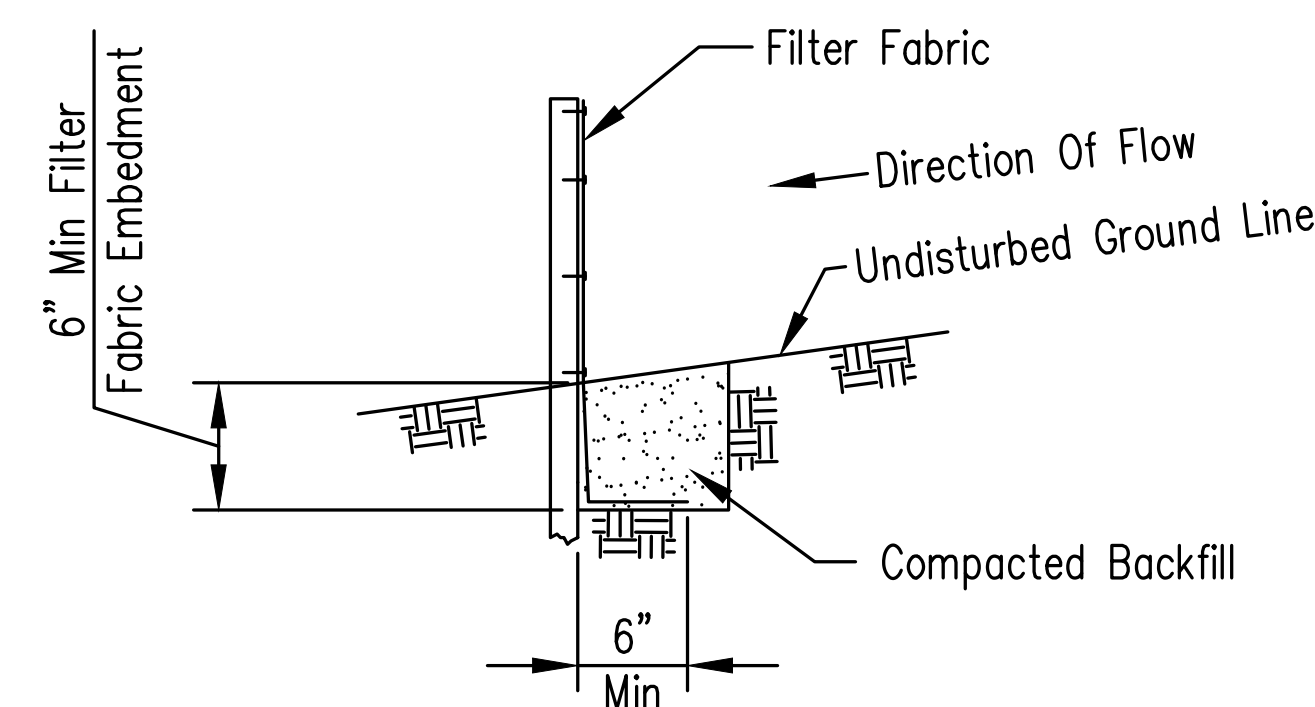

FABRIC ANCHOR DETAIL
SILT FENCE DETAILS

NTS

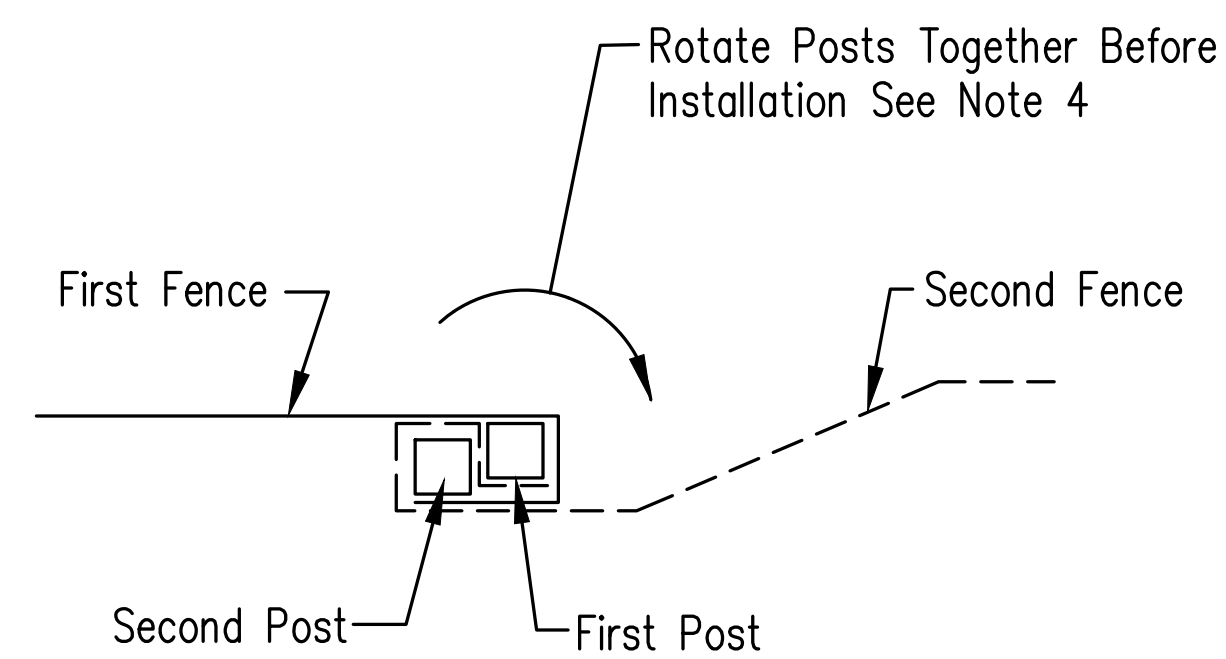

SPLICE DETAIL PLAN VIEW

NOTES:

1. TEMPORARY SILT FENCE SHALL BE INSTALLED PRIOR TO ANY GRADING WORK IN THE AREA TO BE PROTECTED, FENCE SHALL BE MAINTAINED THROUGHOUT THE CONSTRUCTION PERIOD AND REMOVED IN CONJUNCTION WITH THE FINAL GRADING AND SITE STABILIZATION.
2. FILTER FABRIC SHALL MEET THE REQUIREMENTS OF MATERIAL SPECIFICATION 592 GEOTEXTILE TABLE 1 OR 2, CLASS 1 WITH EQUIVALENT OPENING SIZE OF AT LEAST 30 FOR NONWOVEN AND 50 FOR WOVEN.
3. FENCE POSTS SHALL BE WITHER WOOD POST WIT A MINIMUM CROSS-SECTIONAL AREA 1.5"x1.5" OR A STANDARD STEEL POST
4. WHEN SLICES ARE NECESSARY, MAKE SPLICE AT POST ACCORDING TO SPLICE DETAIL. PLACE THE END POSE OF THE SECOND FENCE INSIDE THE END POST OF THE FIRST FENCE. ROTATE BOTH POSTS TOGETHER AT LEAST 180 DEGREES TO CREATE A TIGHT SEAL WITH THE FABRIC MATERIAL. CUT THE FABRIC NEAR THE BOTTOM OF THE POSTS TO ACCOMMODATE THE 6" FLAP. THEN DRIVE BOTH POSTS AND BURY THE FLAP. COMPACT BACKFILL WELL.

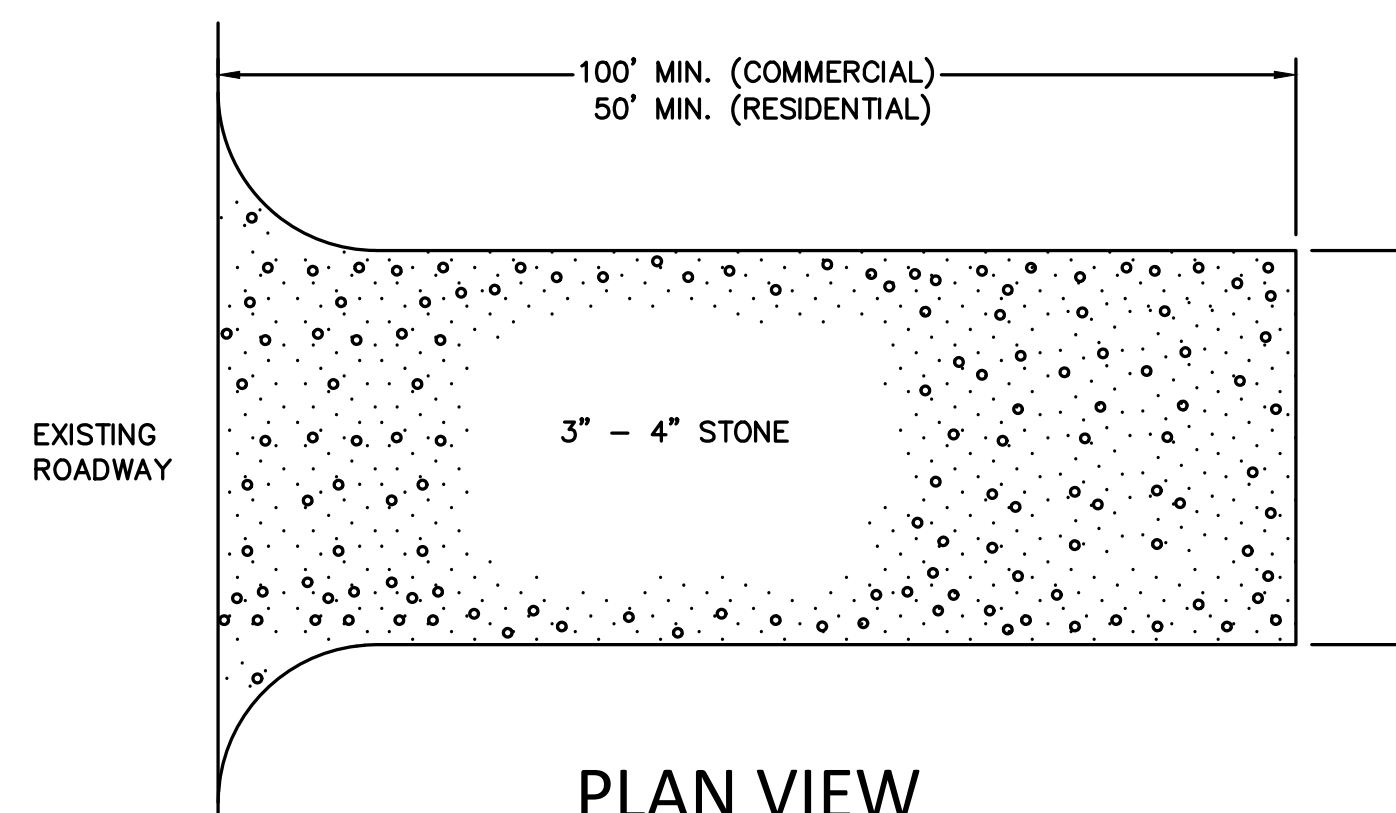

PLAN VIEW

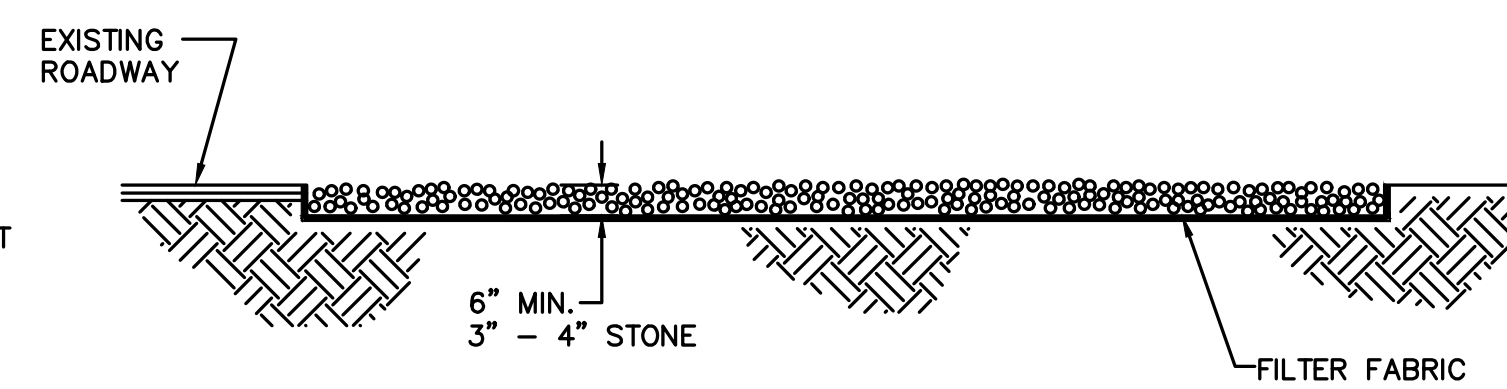

SIDE CROSS SECTION VIEW

NOTES:

1. ENTRANCE(S) SHALL BE LOCATED TO PROVIDE MAXIMUM UTILITY BY ALL CONSTRUCTION VEHICLES.
2. TURNING RADIUS SUFFICIENT TO ACCOMMODATE LARGE TRUCKS IS TO BE PROVIDED
3. MUST BE MAINTAINED IN A CONDITION WHICH WILL PREVENT PERIODIC TOPDRESSING WITH STONE WITH BE NECESSARY. CONTRACTOR SHALL MAINTAIN AS NECESSARY.
4. ANY MATERIAL WHICH STILL MAKES IT ONTO THE ROAD MUST BE CLEANED UP IMMEDIATELY.
5. FREQUENT CHECKS OF THE ENTRANCE(S) AND TIMELY MAINTENANCE SHALL BE PROVIDED.
6. NOTES ARE APPLICABLE AT ALL POINTS OF INGRESS AND EGRESS UNTIL SITE IS STABILIZED.
7. UTILIZE FILTER FABRIC IN CLAY SOILS.

CONSTRUCTION ENTRANCE FOR EROSION CONTROL

NTS

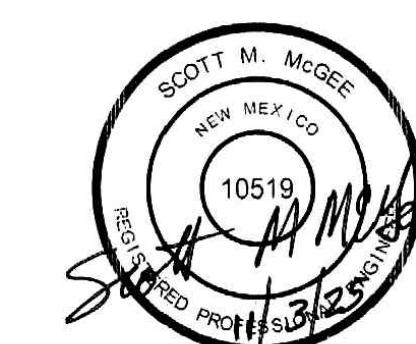

Scott M McGee PE

PO Box 1273
Elephant Butte, NM 87935
505.263.2905
scottmmcgee@gmail.com

