

LEGEND

LIMITS OF PONDED AREA IN 100-YR STORM

SURVEY POINTS

Onsite Basin 1 Existing Conditions:

Area = 0.514 ac

Treatment Type Areas

A_A = 0.00 ac A_B = 0.00 ac A_C = 0.51 ac A_D = 0.00 ac

Excess Precipitation (e) for a 100-year, 6-hour storm event based on Table A-8

E_A = 0.44 in E_B = 0.67 in E_C = 0.99 in E_D = 1.97 in

Weighted Excess Precipitation (E) calculation using equation a-5

E = (E_A*A_A+E_B*A_B+E_C*A_C+E_D*A_D)/(A_A+A_B+A_C+A_D)

E = 0.99 in

Precipitation Depth (P) for 100-year, 24-hour storm event based on Table A-2

P(24-hr) = 2.66 in

P for 100-year, 6-hour storm event based on Table A-2

P(6-hr) = 2.20 in

Runoff Volume for 100-year, 6-hour calculation using equation a-6

V = Weighted E*(AA+AB+AC+AD)

V(6-hr) = 0.042 ac-ft = 1847.1618 cu ft

Runoff Volume for 100-year, 24-hour calculation using equation a-7

V = V(6-hr)+AD*(P(24-hr)-P(6-hr))

V(24-hr) = 0.042 ac-ft = 1847.1618 cu ft

Onsite Basin 2 Existing Conditions:

Area = 1.079 ac

Treatment Type Percentages

A_A = 0.00 ac A_B = 0.00 ac A_C = 1.079 ac A_D = 0.00 ac

Excess Precipitation (e) for a 100-year, 6-hour storm event based on Table A-8

E_A = 0.44 in E_B = 0.67 in E_C = 0.99 in E_D = 1.97 in

Weighted Excess Precipitation (E) calculation using equation a-5

E = (E_A*A_A+E_B*A_B+E_C*A_C+E_D*A_D)/(A_A+A_B+A_C+A_D)

E = 0.99 in

Precipitation Depth (P) for 100-year, 24-hour storm event based on Table A-2

P(24-hr) = 2.66 in

P for 100-year, 6-hour storm event based on Table A-2

P(6-hr) = 2.20 in

Runoff Volume for 100-year, 6-hour calculation using equation a-6

V = Weighted E*(AA+AB+AC+AD)

V(6-hr) = 0.089 ac-ft = 3877.6023 cu ft

Runoff Volume for 100-year, 24-hour calculation using equation a-7

V = V(6-hr)+AD*(P(24-hr)-P(6-hr))

V(24-hr) = 0.089 ac-ft = 3877.6023 cu ft

SURVEYOR CERTIFICATION

THE CHANGES SHOWN HEREON ARE BASED UPON A FIELD SURVEY CONDUCTED BY ME OR UNDER MY SUPERVISION AND REFLECT THE LOCATIONS (VERTICALLY AND HORIZONTALLY) TO THE BEST OF MY KNOWLEDGE AND BELIEF.

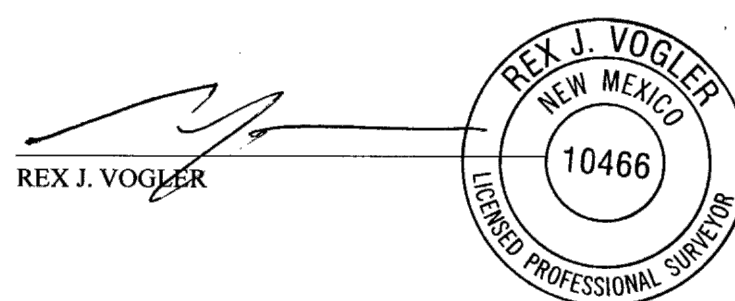

03/28/2018
DATE

DRAINAGE CERTIFICATION

I, HUGH W. FLOYD, NMPE 16633, OF THE FIRM RESPEC, HEREBY CERTIFY THAT THIS PROJECT HAS BEEN GRADED AND WILL DRAIN IN SUBSTANTIAL COMPLIANCE WITH AND IN ACCORDANCE WITH THE DESIGN INTENT OF THE APPROVED PLAN WITH STAMP DATE 03/26/18. THE RECORD INFORMATION EDITED ONTO THE ORIGINAL DESIGN DOCUMENT HAS BEEN OBTAINED BY REX J. VOGLER, NMPS 10466, OF THE FIRM RIO GRANDE SURVEYING CO. I FURTHER CERTIFY THAT I HAVE PERSONALLY VISITED THE PROJECT SITE ON 3/20/18 AND HAVE DETERMINED BY VISUAL INSPECTION THAT THE SURVEY DATA PROVIDED IS REPRESENTATIVE OF ACTUAL SITE CONDITIONS AND IS TRUE AND CORRECT TO THE BEST OF MY KNOWLEDGE AND BELIEF. THIS CERTIFICATION IS SUBMITTED IN SUPPORT OF A REQUEST FOR CERTIFICATE OF OCCUPANCY.

THE RECORD INFORMATION PRESENTED HEREON IS NOT NECESSARILY COMPLETE AND INTENDED ONLY TO VERIFY SUBSTANTIAL COMPLIANCE OF THE GRADING AND DRAINAGE ASPECTS OF THIS PROJECT. THOSE RELYING ON THIS RECORD DOCUMENT ARE ADVISED TO OBTAIN INDEPENDENT VERIFICATION OF ITS ACCURACY BEFORE USING IT FOR ANY OTHER PURPOSE.

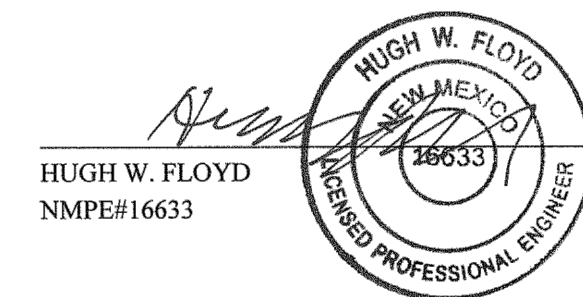

DATE: 3/26/18

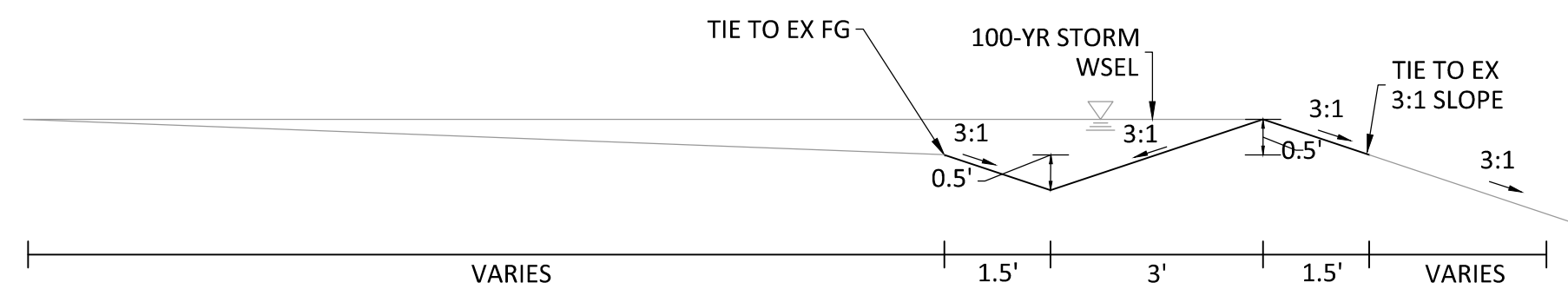

SECTION B-B: TEMPORARY RETENTION TERRACE
NTS

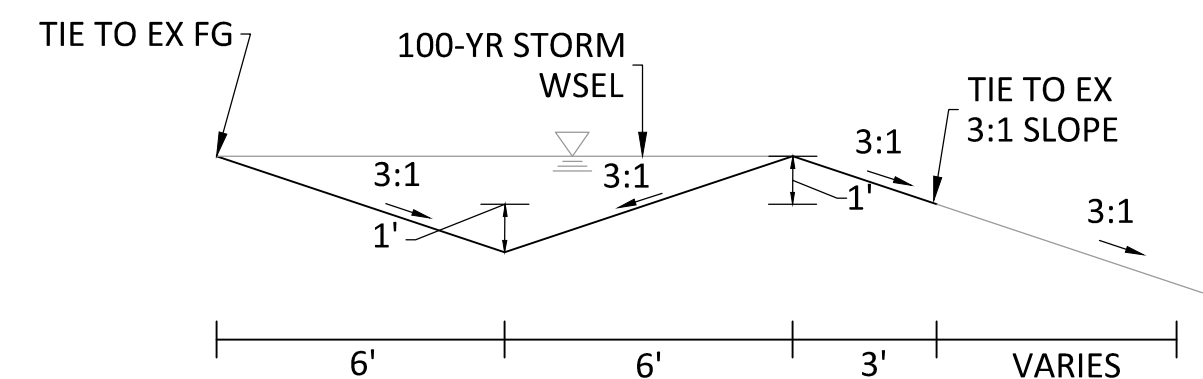

SECTION A-A: TEMPORARY RETENTION TERRACE
NTS

Terrace Pond A

Retention Area (A)	=	12	sq. ft.
Terrace Length (L)	=	205	ft.
Retention Volume (V)	=	2460	cu. Ft.

Terrace Pond B

Avg. Retention Area (A)	=	17.5	sq. ft.
Terrace Length (L)	=	230	ft.
Retention Volume (V)	=	4025	cu. Ft.

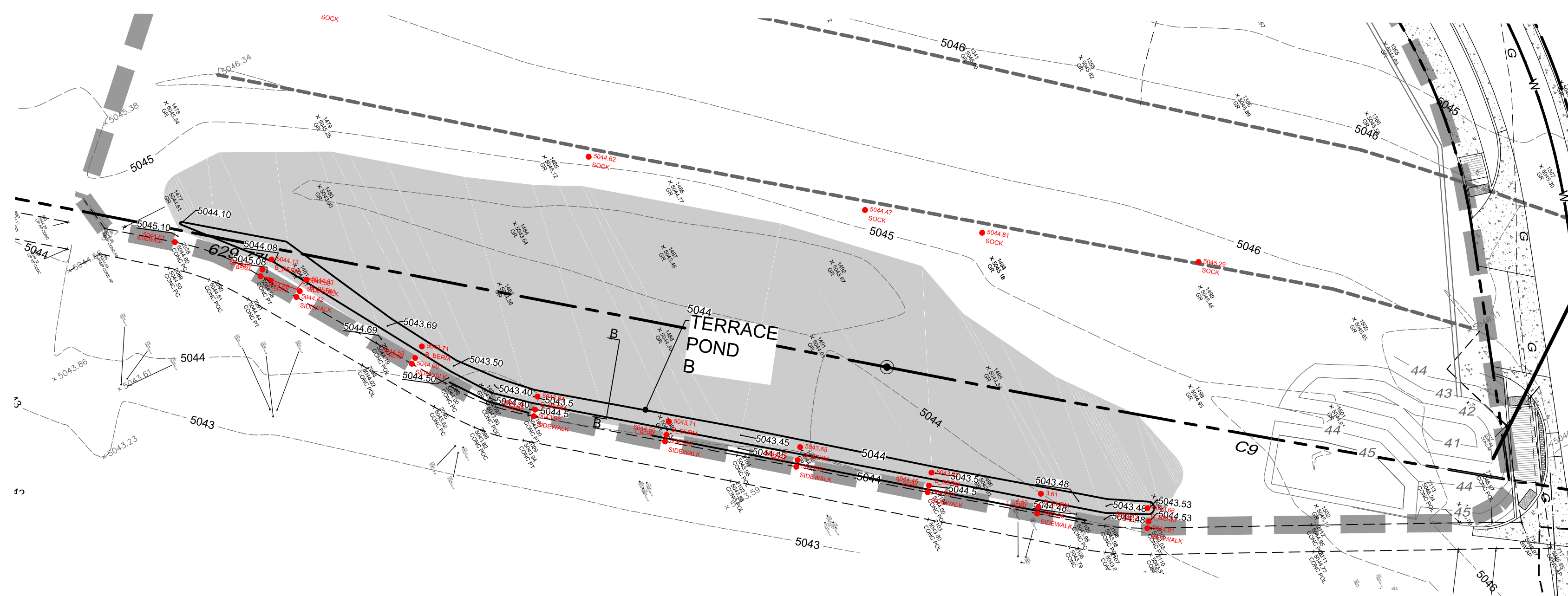

9971 JEFFERSON ST NE
SUITE 101
ALBUQUERQUE, NM 87109
PHONE: 505.366.4187

RESPEC
WATER & NATURAL RESOURCES

DESIGNED: HWF
DRAWN: BIM
CHECKED: HWF
DATE: 03/26/2018

REVISION

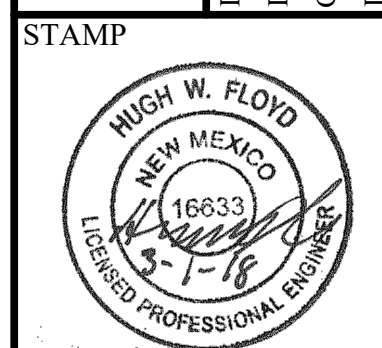

TRACT B,
LANDS OF BLACK DEVELOPMENT ONE
9820 COORS BLVD NW

INTERIM GRADING AND DRAINAGE PLAN

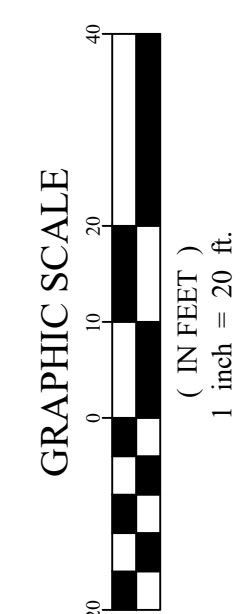

SHEET NUMBER:
1 OF 1