

September 25, 1997

Martin J. Chávez, Mayor

Diane Hoelzer, P.E.
Mark Goodwin & Assoc.
P.O. Box 90606
Albuquerque, NM 87199

**RE: MCT INDUSTRIAL PARK (B18-D4). ENGINEER'S CERTIFICATION FOR
CERTIFICATE OF OCCUPANCY APPROVAL. ENGINEER'S CERTIFICATION
DATED SEPTEMBER 4, 1997.**

Dear Ms. Hoelzer:

Based on the information provided on your September 5, 1997 submittal, the above referenced project is approved for a 30-day Temporary Certificate of Occupancy. AMAFCA must accept the work done in their right-of-way prior to final Certificate of Occupancy approval.

If I can be of further assistance, please feel free to contact me at 924-3984.

Sincerely,

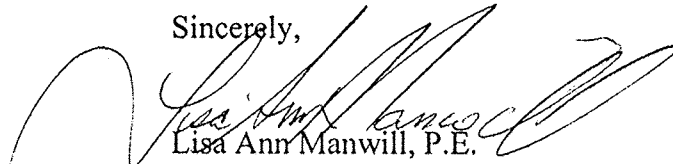

Lisa Ann Manwill, P.E.
Hydrology

c: Kurt Browning, P.E. - AMAFCA
Andrew Garcia
File



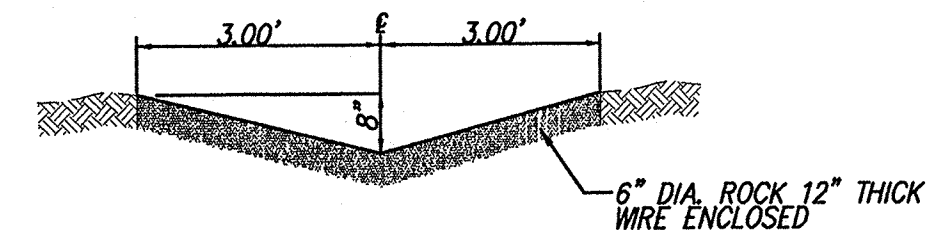
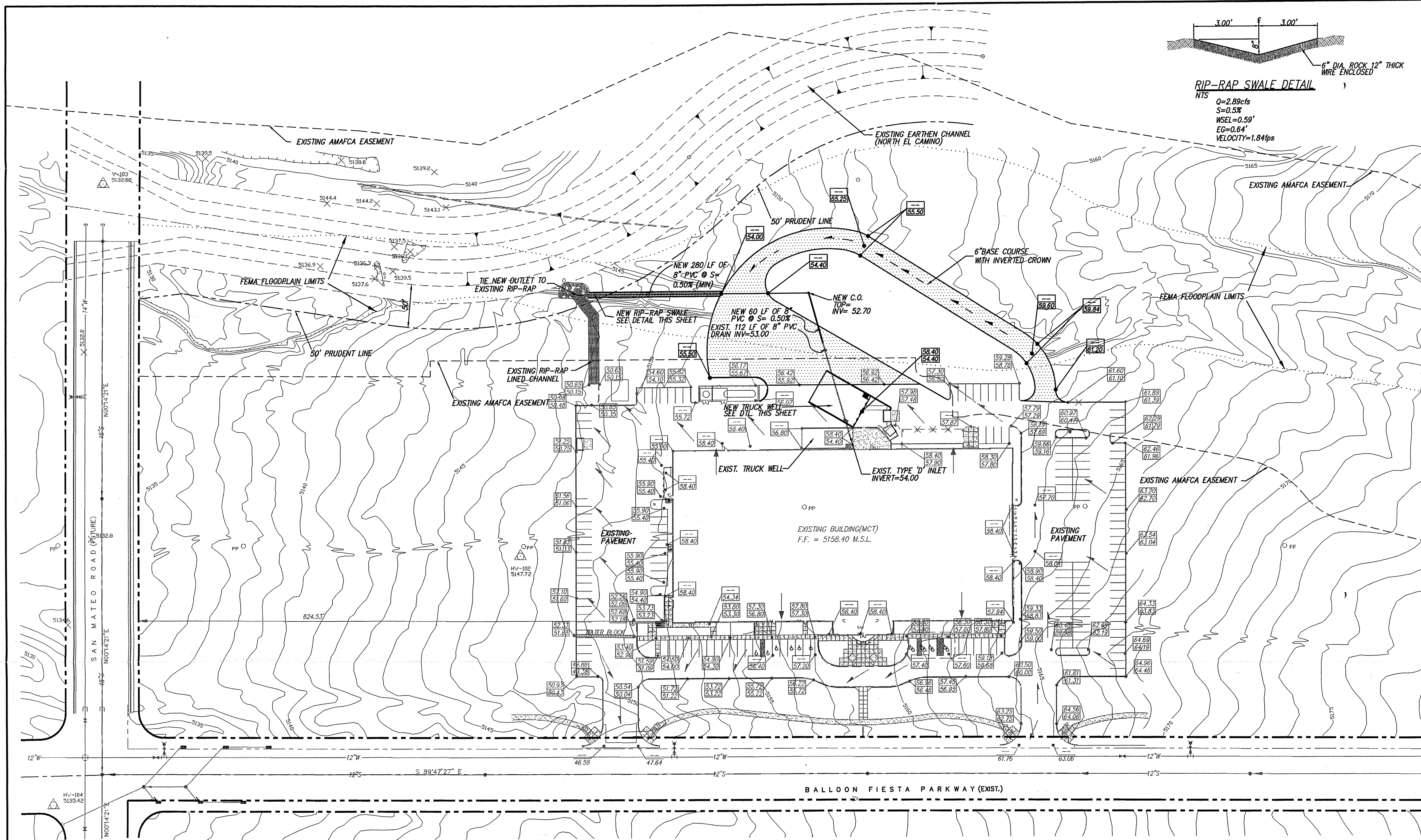

RIP-RAP SWALE DETAIL
 NTS
 $Q = 2.89 \text{ cfs}$
 $S = 0.5\%$
 $WSEL = 0.59'$
 $EO = 0.64'$
 $VELOCITY = 1.84 \text{ fps}$

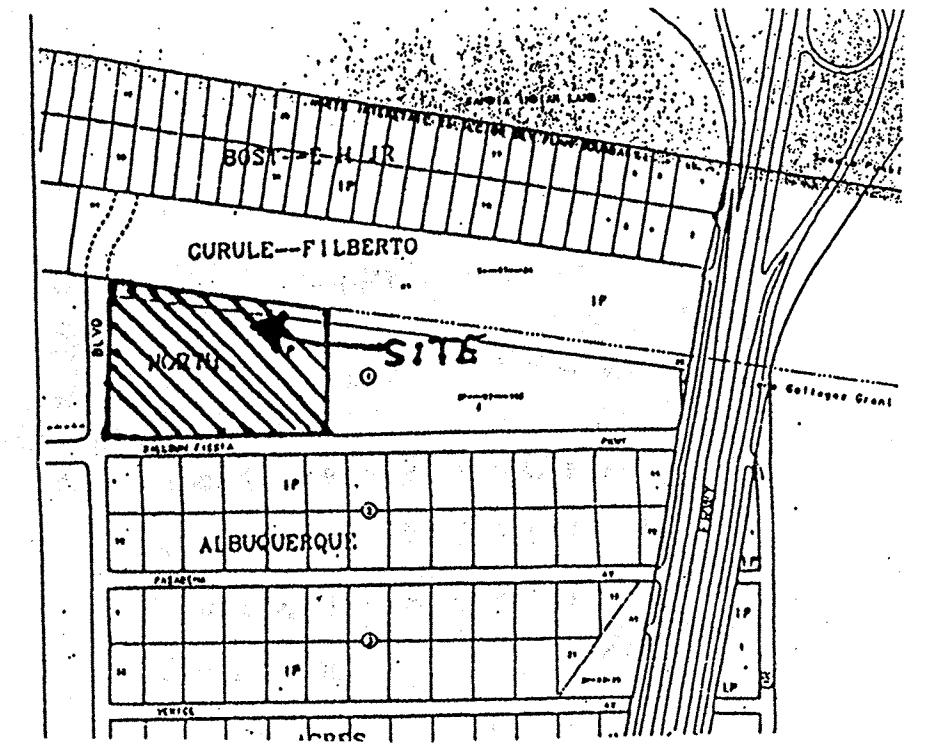

VICINITY MAP **ZONE MAP: B-18**

ACS BENCHMARK

Station is located 9 miles NE of downtown Albuquerque, approximately 0.6 miles west of the north end of the north-south runway of Coronado Airport.

To reach the station from the junction of State Road 556 and the I-15 Frontage Road (Alameda Interchange), go south on the West Frontage Road 0.4 miles to a dirt road leading west, then west on the dirt road 0.45 mile to the SW corner of a dirt tract and the station.

Station mark is a standard USGLO brass tablet stamped "USGLO, CC 11 12, T11N, R3E, 1920" riveted to an iron pipe around which has been poured a 12-inch concrete collar projecting 0.1 feet.

LEGAL DESCRIPTION

LOT 1A, BLOCK 1, TRACT A, UNIT B
 NORTH ALBUQUERQUE ACRES

LEGEND

- NEW SPOT ELEVATION
- EXISTING SPOT ELEVATION
- EXISTING CURB
- NEW EDGE OF PAVING
- 6" BASE COURSE

NOTES:

1. AN EXISTING "INTERIM" EARTHEN CHANNEL WITH RIP-RAP CHECK STRUCTURES WAS CONSTRUCTED IN THE SUMMER OF 1998 WITHIN THE PROPOSED ALIGNMENT FOR THE FUTURE CONCRETE LINED CHANNEL. THE "INTERIM" CHANNEL IS 30' WIDE, 5.5' DEEP WITH 3:1 SIDE SLOPES. THE CITY OF ALBUQUERQUE AND AMAFCA WERE INVOLVED IN THE "INTERIM" CONDITION SOLUTION. A "LOWR", UNDER CONTRACT WITH AMAFCA, IS IN THE PROCESS OF BEING PREPARED FOR THE FUTURE CONCRETE LINED CHANNEL.
2. THE "INTERIM" CHANNEL CROSS SECTION DESIGN WAS BASED ON 2500 cfs AS AGREED UPON BY AMAFCA. EROSION SETBACK BOUNDARY FOR NON-STRUCTURAL IMPROVEMENTS IS 2 FEET PER 100 CFS OR 50 FEET IN THIS CASE.

6' / 100 cfs = 150'

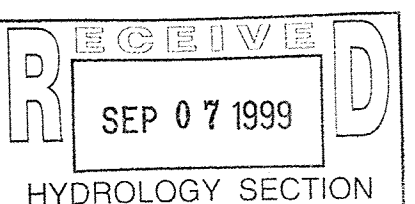

ENVIRCO

GRADING AND DRAINAGE PLAN

dmg MARK GOODWIN & ASSOCIATES, P.A.
 CONSULTING ENGINEERS
 P.O. BOX 90606
 ALBUQUERQUE, NEW MEXICO 87199
 (505)828-2200, FAX (505)797-9539

Designed: DMG Drawn: KJS Checked: DMG Sheet 1 of 1
 Scale: 1" = 60' Date: 3 MAY 99 Job: 99054

DRAINAGE CALCULATIONS
 PRECIPITATION = ZONE 2
 $T_c = 10 \text{ MINS}$
 AREA = .624 ACRES

EXISTING	DEVELOPED
TR. A = 100%	TR. D = 100%
$Q_c = 0.96 \text{ cfs}$	$Q_D = 2.89 \text{ cfs}$
Vol = .028 AC. FT.	Vol = .110 AC. FT.

PROJECT DESCRIPTION

THIS PROJECT ENTAILS THE ADDITION OF A NEW TRUCK WELL TO AN EXISTING BUILDING AND A NEW DRIVEWAY/TURNAROUND TO AN EXISTING PARKING LOT. DISCHARGE WILL BE TO AN EXISTING RIP-RAP PAD.

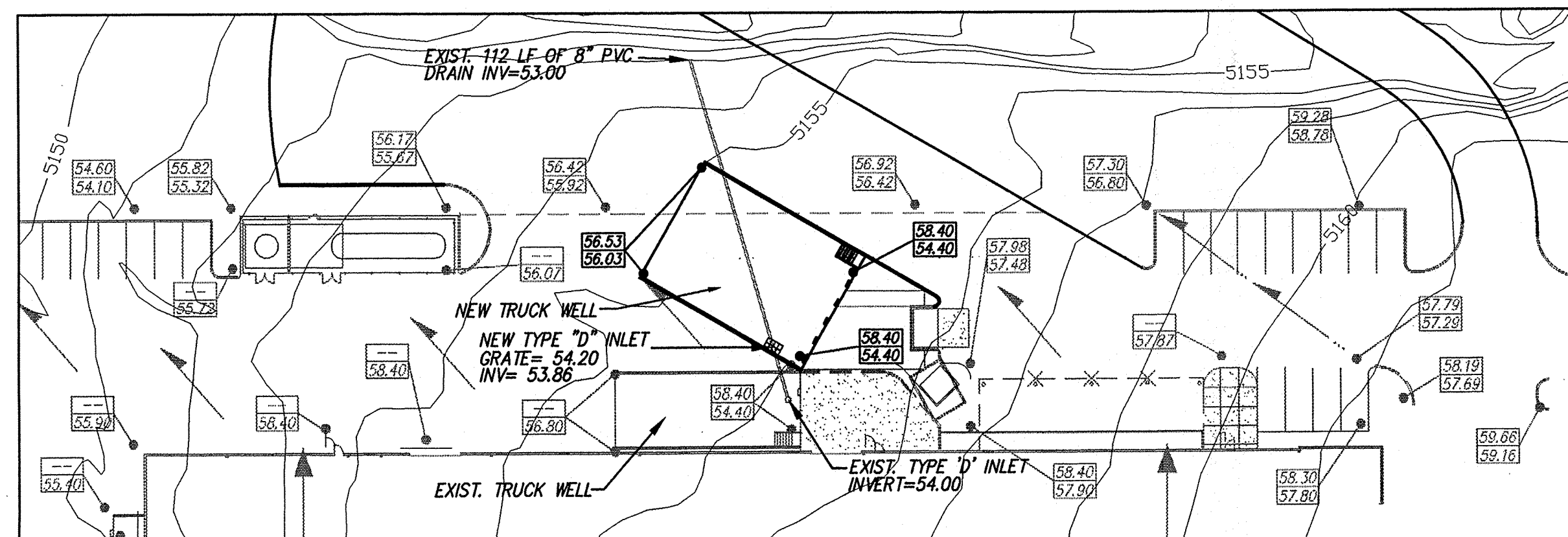
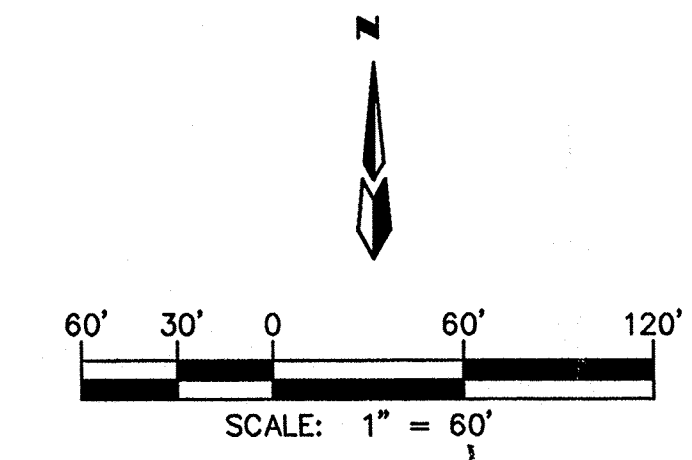
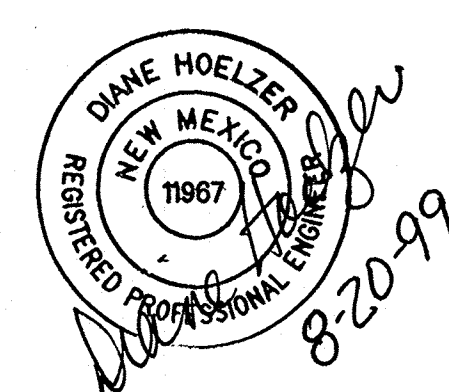

TRUCK WELL DETAIL
 SCALE: 1" = 40'