

09/D001

S CASITAS SUBDIVISION AT VENTANA RANCH

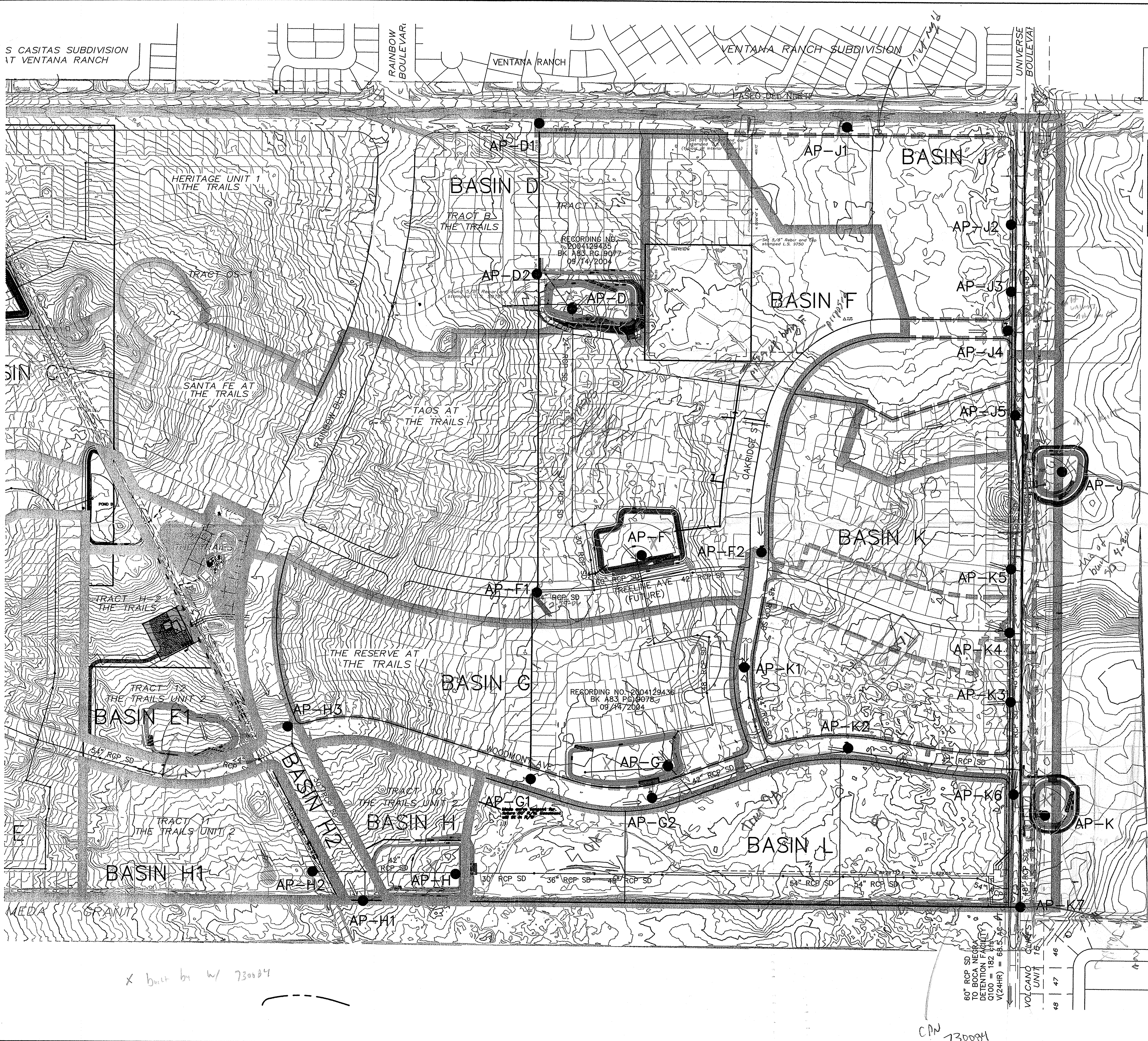

LEGEND

- BASIN BOUNDARY
- SUB-BASIN BOUNDARY
- FLOW DIRECTION

Developed Condition SURGE POND SUMMARY

Analysis Point	Description	Drainage Area (Ac.)	Q100 (cfs)in	Q100 (cfs)out	MAX STORAGE (Ac-Ft)	TOP ELEV =	BOP ELEV =	MAX WSEL =
AP-D	POND D	253.25	164.89	23.56	5.39	5436.85	5430.00	5436.21
AP-F	POND F	349.70	338.86	33.92	9.41	5424.33	5416.00	5423.04
AP-G	POND G	381.63	138.81	33.51	3.66	5422.50	5416.00	5420.35
AP-J	POND J	32.90	82.74	21.37	2.14	5423.00	5417.00	5421.87
AP-H	POND H	164.29	112.14	35.28	2.77	5422.00	5418.00	5421.87
AP-K	POND K	459.65	164.27	101.37	2.15	5410.50	5405.00	5410.18

Developed Condition SUB-BASIN ANALYSIS POINT SUMMARY

Analysis Point	Description	Drainage Area (Ac.)	Q100 (cfs)
AP-D1	PASEO DEL NORTE BYPASS FLOW	-	12.85
AP-D2	FROM HERITAGE-REPORT DATED 03/04	-	172.0
AP-F1	FROM SANTA FE/TAOS-REPORT DATED 12/03	-	167.4
AP-F2	OAKRIDGE ST INLETS	2.36	8.03
AP-G1	FROM RESERVE-REPORT DATED 04/04	-	52.80
AP-G2	WOODMONT AVE SUMP INLETS	4.26	17.99
AP-H1	RAINBOW INLETS	3.15	12.88
AP-H2	TRACT 11 STUB	11.71	33.32
AP-H3	RAINBOW INLETS	2.62	11.06
AP-J1	PASEO DEL NORTE SUMP INLETS	3.04	12.85
AP-J2	STUB TO UNIVERSE STORM DRAIN	14.54	36.65
AP-J3	UNIVERSE INLETS	2.92	12.31
AP-J4	OAKRIDGE ST INLETS	0.82	3.47
AP-J5	STUB TO UNIVERSE STORM DRAIN	4.22	12.00
AP-K1	OAKRIDGE ST SUMP INLETS	1.34	5.65
AP-K2	WOODMONT AVE SUMP INLETS	2.04	8.62
AP-K3	STUB TO UNIVERSE STORM DRAIN	10.84	31.35
AP-K4	STUB TO UNIVERSE STORM DRAIN	6.37	18.41
AP-K5	STUB TO UNIVERSE STORM DRAIN	12.85	36.54
AP-K6	UNIVERSE INLETS	6.24	21.29
AP-K7	TRAILS OUTFALL TO BOCA NEGRA DAM	651.0	181.75

HYDROLOGIC DATA - DEVELOPED

BASIN	AREA (acres)	LAND TREATMENT PERCENTAGES BY TYPE					YIELD (cfs/ac)	Q100 (cfs)	V100-24 (ac-ft)
		A	B	C	D	E			
ON-D	58.30	0	25	25	50	2.61	151.97	7.84	
ON-H	7.43	0	15	25	60	3.54	26.30	1.11	
ON-H1	11.71	0	39.9	39.9	20.2	2.77	32.46	1.10	
ON-H2	5.77	0	0	10	90	4.10	23.59	1.09	
ON-G	31.93	0	25	25	50	3.32	105.96	4.29	
ON-F	82.94	0	25	25	50	3.32	274.98	11.15	
ON-J	32.92	0	25	25	50	2.52	82.74	4.42	
ON-K	45.12	0	25	25	50	2.84	128.14	6.06	
ON-L	27.03	0	25	25	50	2.89	78.21	3.63	

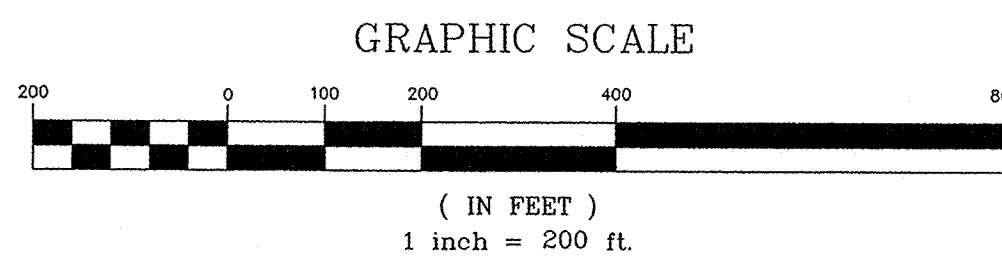

**WILSON & COMPANY**  
 2600 THE AMERICAN ROAD S.E. SUITE 100  
 RIO RANCHO, NEW MEXICO 87124  
 (505) 898-8021

RECEIVED  
 DEC 23 2005  
 HYDROLOGY SECTION

CITY OF ALBUQUERQUE  
 PUBLIC WORKS DEPARTMENT  
 ENGINEERING GROUP

**AMENDMENT TO TRAILS UNIT II & III OVERALL GRADING & DRAINAGE PLAN DEVELOPED CONDITIONS**

Design Review Committee	City Engineer Approval	Mo./Day/Yr.	Mo./Day/Yr.
	(09/D001)		
City Project No.	Zone Map No.	PLATE 1	
730084	C-9-Z		

**AS-BUILT INFORMATION**

CONTRACTOR: \_\_\_\_\_ DATE: \_\_\_\_\_  
 DESIGNED BY: \_\_\_\_\_ DATE: \_\_\_\_\_  
 DRAWN BY: \_\_\_\_\_ DATE: \_\_\_\_\_  
 CHECKED BY: \_\_\_\_\_ DATE: \_\_\_\_\_

**BENCH MARKS**

ACS BRASS TABLET STAMPED "2-B10 1980"  
 Geographic Position (NAD 1927)  
 N.M. State Plane Coordinates (Central Zone)  
 X= 357,543.73 Y= 1,527,976.48  
 Ground-to-Grid Factor = 0.999966354  
 SLD 1929 Elevation = 5429.35

**SURVEY INFORMATION**

FIELD NOTES BY: \_\_\_\_\_ DATE: \_\_\_\_\_  
 NO. \_\_\_\_\_

**ENGINEER'S SEAL**

SAKAZAR ENGINEERING INC.  
 1624 N. WILSON AVE.  
 ALBUQUERQUE, NM 87104  
 LICENSED PROFESSIONAL ENGINEER

REVISIONS: \_\_\_\_\_  
 NO. DATE BY  
 WILSON & COMPANY, ENGINEERS & ARCHITECTS  
 DESIGNED BY: \_\_\_\_\_ DATE: MAY 05  
 DRAWN BY: \_\_\_\_\_ DATE: MAY 05  
 CHECKED BY: \_\_\_\_\_ DATE: MAY 05

CAN 730084

placed to south  
open to park

x built by w/ 730084

working on Basin F to drainage

much soil  
in 1  
Ac  
100 cb  
changed



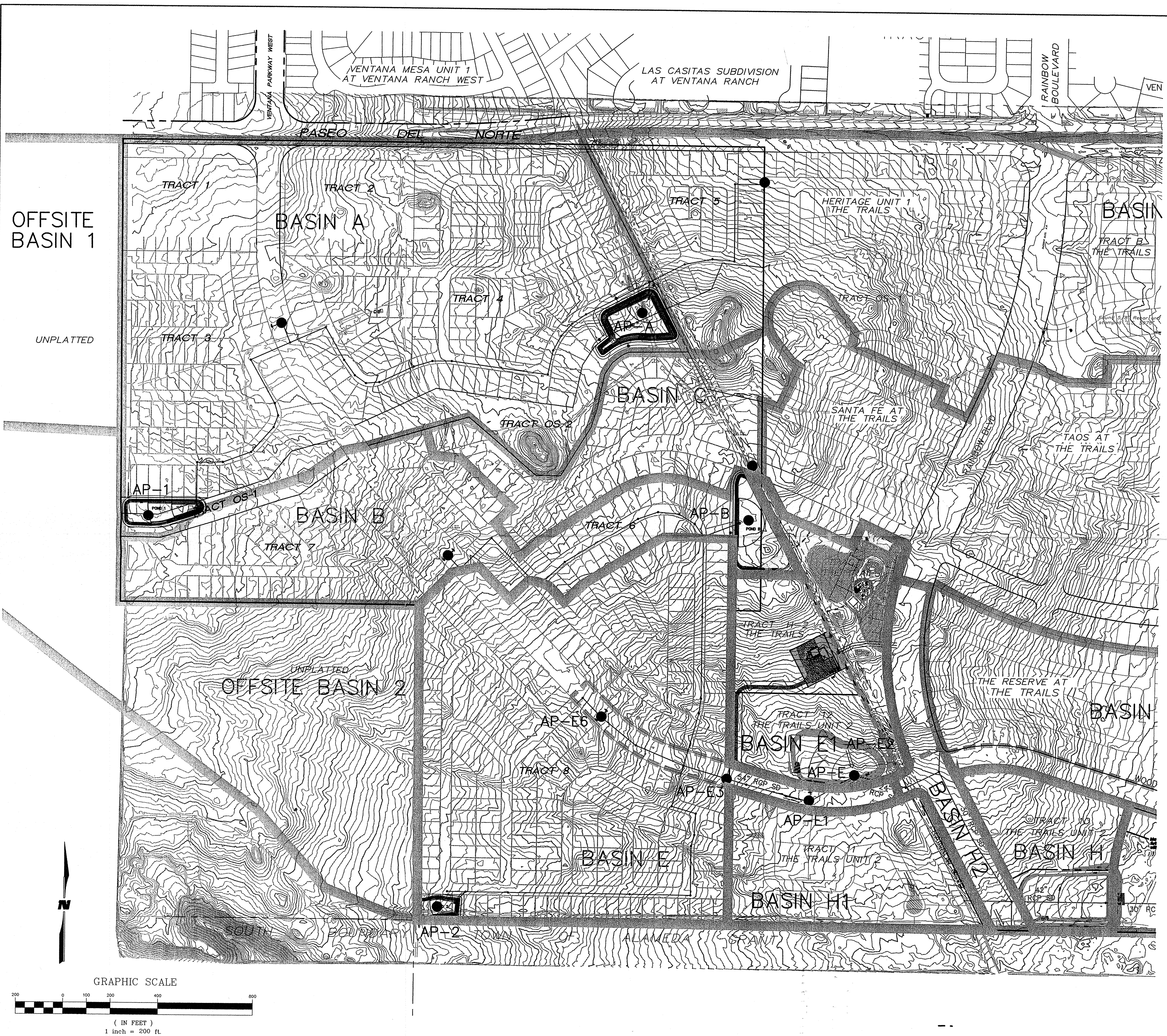

**LEGEND**

BASIN BOUNDARY

SUB-BASIN BOUNDARY

FLOW DIRECTION

**Developed Condition SURGE POND SUMMARY**

Analysis Point	Description	Inflow into Onsite Pond #	Drainage Area (Ac.)	Q100 (cfs)in	Q100 (cfs)out	V100 MAX STORAGE (Ac-ft)	TOP ELEV =	BOP ELEV =	MAX WSEL =
AP-1	OFFSITE-1	127.87	38.48	9.40	2.42	5546.50	5540.00	5445.97	
AP-2	OFFSITE-2	51.52	14.42	4.49	0.86	5481.50	5477.00	5481.32	
AP-A	POND A	194.94	224.45	16.94	6.38	6507.00	5497.00	5504.70	
AP-B	POND B	77.18	85.67	3.38	3.15	5490.50	5486.00	5489.92	
AP-E	POND E	139.39	187.59	34.26	3.55	5448.00	5443.00	5447.42	

**Developed Condition SUB-BASIN ANALYSIS POINT SUMMARY**

Analysis Point	Description	Drainage Area (Ac.)	Q100 (cfs)
AP-E1	WOODMONT AVE SUMP INLETS	3.27	13.81
AP-E2	FROM TRACT E - THOMPSON ENG. G&D PLAN	5.98	8.30
AP-E3	FLOW TO UNIT 2 STORM DRAIN	120.25	145.28

**HYDROLOGIC DATA - DEVELOPED**

BASIN	AREA (acres)	LAND TREATMENT PERCENTAGES BY TYPE				YIELD (cfs/ac)	Q100 (cfs)	V100-24 (ac-ft)
		A	B	C	D			
ON-E	46.35	0	25	25	50	3.32	153.72	6.23
ON-E1	15.90	43	25	25	7	1.98	31.45	0.97
OFF-1	127.90	100	0	0	0	0.30	38.48	4.59
OFF-2	51.55	100	0	0	0	0.28	14.42	1.85
ON-A	67.05	0	25	25	50	3.32	222.42	9.01
ON-B	25.65	0	25	25	50	3.32	85.15	3.45
ON-C	13.48	0	25	25	50	3.32	44.81	1.82

OFFSITE BASIN 1

UNPLATTED

OFFSITE BASIN 2

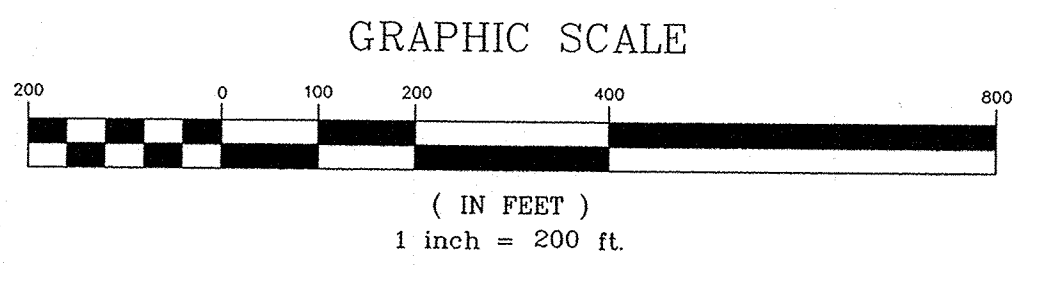

**AS-BUILT INFORMATION**

CONTRACTOR: \_\_\_\_\_ DATE: \_\_\_\_\_

WORK: \_\_\_\_\_ DATE: \_\_\_\_\_

SUPERVISOR'S ACCEPTANCE BY: \_\_\_\_\_ DATE: \_\_\_\_\_

DESIGNER'S ACCEPTANCE BY: \_\_\_\_\_ DATE: \_\_\_\_\_

DRAWINGS BY: \_\_\_\_\_ DATE: \_\_\_\_\_

RECORDED BY: \_\_\_\_\_ DATE: \_\_\_\_\_

**MICRO-FILM INFORMATION**

NO. \_\_\_\_\_ DATE: \_\_\_\_\_

---

**BENCH MARKS**

ACS BRASS TABLE STAMPED "2-B10 1980"

Geographic Position (NAD 1927)

N.M. State Plane Coordinates (Central Zone)

X= 357,543.73 Y= 1,527,976.48

Ground-to-Grid Factor = 0.99966354

A.O. = -00'16"30"

SLD 1929 Elevation = 5429.35

---

**SURVEY INFORMATION**

FIELD NOTES

NO. \_\_\_\_\_ DATE: \_\_\_\_\_

BY \_\_\_\_\_

---

**ENGINEER'S SEAL**

REVISIONS

NO.	DATE	REMARKS	BY

DESIGNED BY: \_\_\_\_\_ DATE: MAY 05

DRAWN BY: \_\_\_\_\_ DATE: MAY 05

CHECKED BY: \_\_\_\_\_ DATE: MAY 05

---

**WILSON & COMPANY** 2600 THE AMERICAN ROAD S.E. SUITE 100 RIO RANCHO, NEW MEXICO 87124 (505) 898-8021

CITY OF ALBUQUERQUE PUBLIC WORKS DEPARTMENT ENGINEERING GROUP

**AMENDMENT TO TRAILS UNIT II & III OVERALL GRADING & DRAINAGE PLAN DEVELOPED CONDITIONS**

Design Review Committee City Engineer Approval

City Project No. **730084** Zone Map No. **C-9-Z**

PLATE 2



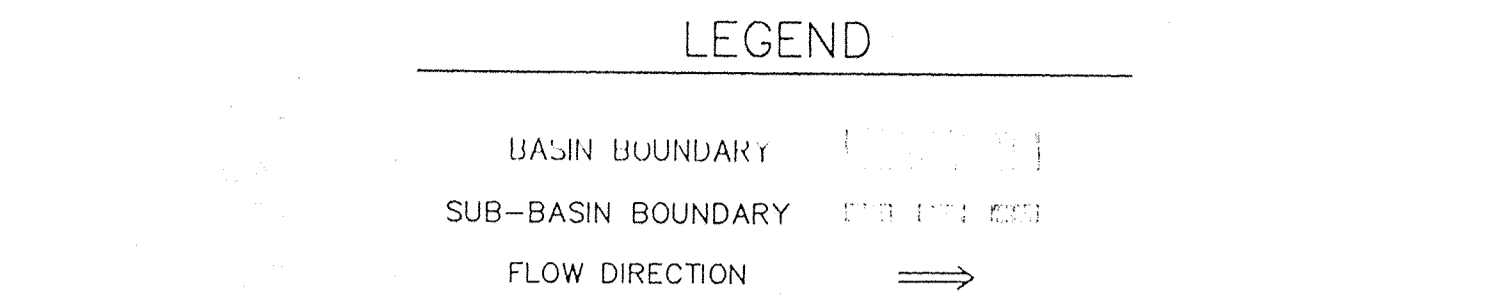

Developed Condition SURGE POND SUMMARY

Analysis Point	Description Inflow Into Onsite Pond #	Drainage Area (Ac.)	Q100 (cfs)in	Q100 (cfs)out	V100 MAX STORAGE (Ac-Ft)	TOP ELEV =	BOP ELEV =	MAX WSEL =
AP-1	OFFSITE-1	127.87	38.48	9.40	2.42	5546.50	5540.00	5445.97
AP-2	OFFSITE-2	51.52	14.42	4.49	0.86	5481.50	5477.00	5481.32
AP-A	POND A	194.94	224.45	16.94	6.38	5507.00	5497.00	5504.70
AP-B	POND B	77.18	85.67	3.38	3.15	5490.50	5486.00	5489.92
AP-E	POND E	139.39	187.59	34.26	3.55	5448.00	5443.00	5447.42

Developed Condition SUB-BASIN ANALYSIS POINT SUMMARY

Analysis Point	Description	Drainage Area (Ac.)	Q100 (cfs)
AP-E1	WOODMONT AVE SUMP INLETS	3.27	13.81
AP-E2	FROM TRACT E - THOMPSON ENG. G&D PLAN	5.98	8.30
AP-E3	FLOW TO UNIT 2 STORM DRAIN	120.25	145.28

HYDROLOGIC DATA - DEVELOPED

BASIN	AREA (acres)	LAND TREATMENT PERCENTAGES BY TYPE				YIELD (cfs/ac)	Q100 (cfs)	V100-24 (ac-ft)
		A	B	C	D			
ON-E	46.35	0	25	25	50	3.32	153.72	6.23
ON-E1	15.90	0	25	25	7	1.98	31.45	0.97
OFF-1	127.90	100	0	0	0	0.30	38.48	4.59
OFF-2	51.55	100	0	0	0	0.28	14.42	1.85
ON-A	67.05	0	25	25	50	3.32	227.47	9.01
UN B	25.65	0	25	25	50	3.32	85.15	3.45
ON-C	15.48	0	25	25	50	3.32	44.81	1.57

OFFSITE BASIN 1

UNPLATTED

UNPLATTED OFFSITE BASIN 2

**WILSON & COMPANY**  
 2600 THE AMERICAN ROAD, SUITE 100  
 RIO RANCHO, NEW MEXICO 87144  
 (505) 259-8811

CITY OF ALBUQUERQUE  
 PUBLIC WORKS DEPARTMENT  
 ENGINEERING GROUP

AMENDMENT TO TRAILS UNIT II & III  
 OVERALL GRADING & DRAINAGE PLAN  
 DEVELOPED CONDITIONS

Design Review Committee	City Engineer Approval	Mo. Day/yr.	Mo. Day/yr.

City Project No. 730084 Zone Map No. C-9-Z PLATE 2

AS-BUILT INFORMATION

NO. DATE BY

ACS BRASS TABLET STAMPED "2-B10 1980"

Geographic Position (NAD 1927)  
 N.M. State Plane Coordinates (Central Zone)  
 X = 357,543.73 Y = 1,527,976.48  
 Ground-to-Grid Factor = C.99986354  
 ΔG = -0.1630'  
 SLD 1925 Elevation = 5429.35

SURVEY INFORMATION

FIELD NOTES

NO. DATE BY

ENGINEER'S SEAL

SEAL OF STATE ENGINEER  
 MEXICO  
 16241  
 11/27/05  
 I. GONZALEZ

REVISIONS

NO.	DATE	REMARKS	BY

WILSON & COMPANY, ENGINEERS & ARCHITECTS  
 ESTABLISHED: P.D. MAY 05  
 DRAWN BY: P.M. MAY 05  
 CHECKED BY: S.S. MAY 05

