

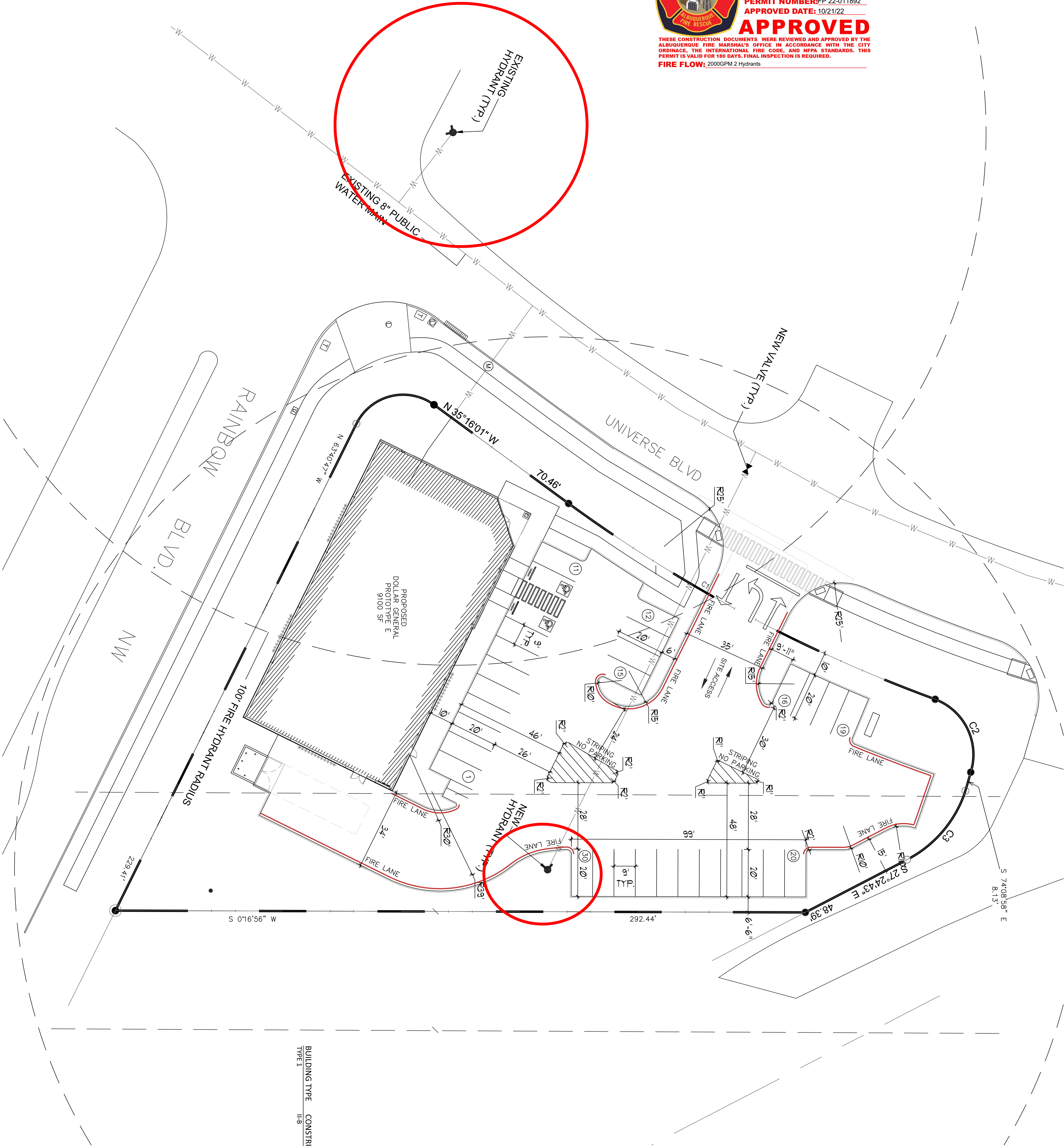

ALBUQUERQUE FIRE MARSHAL'S
DIVISION OFFICE PLANS
CHECKING DIVISION
PERMIT
PERMIT NUMBER:FP 22-011892
APPROVED DATE: 10/21/22
APPROVED

THESE CONSTRUCTION DOCUMENTS WERE REVIEWED AND APPROVED BY THE ALBUQUERQUE FIRE MARSHAL'S OFFICE IN ACCORDANCE WITH THE CITY ORDINANCE, THE INTERNATIONAL FIRE CODE AND NFPA STANDARDS. THIS PERMIT IS VALID FOR 180 DAYS. FINAL INSPECTION IS REQUIRED.
FIRE FLOW: 2000GPM 2 Hydrants



VICINITY MAP:
PROJECT LOCATION:

PROJECT SUMMARY:
LT 20-A-BLK. 2 PLAT OF ITS 10-A, 19-A
THRU 22-A-BLK. 2 UNIT 14 VOLCANO CLIFFS SUB

FIRE ONE NOTES:

- BUILDINGS WILL NOT BE SPRINKLED.
- THE PARKING LOT SURFACE SHALL BE ASPHALT AND CAPABLE OF SUPPORTING AN IMPOSED LOAD OF A FIRE APPARATUS WEIGHING 75,000 LBS.
- THE MINIMUM DRIVE ISLE WIDTH SHALL 26' UNLESS OTHERWISE SPECIFIED.
- BUILDINGS SHALL HAVE APPROVED ADDRESS NUMBERS OR BUILDING IDENTIFICATION PLACED IN A POSITION PLAINLY LEGIBLE AND VISIBLE FROM THE STREET.
- ALL DRIVING SURFACES SHALL NOT EXCEED 10 PERCENT IN GRADE.
- FIRE DEPARTMENT CONNECTIONS SHALL BE LOCATED WITHIN 200' OF A HYDRANT AND BE UNOBSTRUCTED FROM ANY OBJECT FOR A MINIMUM DISTANCE OF 3'.
- INDICATOR VALVES SHALL BE PROVIDED PER NFPA 13.
- A KNOX BOX SHALL BE PROVIDED AT ALL PROPOSED GATE LOCATIONS (IF ANY).
- ELEVATORS (IF ANY) SHALL MEET ALL THE REQUIREMENTS IN NFPA 13, CHAPTER 8 AND 72, CHAPTER 21.
- ALL HYDRANT SUPPLY LINES THAT BRANCH OFF FROM THE WATER MAIN AND FIRE SERVICE LINES TO BUILDINGS WILL BE 6" DIAMETER UNLESS OTHERWISE SPECIFIED. THE BUILDINGS WILL BE REQUIRED TO HAVE FIRE AND SMOKE ALARMS PER IBC 907.2.9.
- WORK SHALL BE IN ACCORDANCE WITH THE APPROVED CONSTRUCTION DOCUMENTS, AND ANY CHANGES MADE DURING CONSTRUCTION THAT ARE NOT IN COMPLIANCE WITH THE APPROVED CONSTRUCTION DOCUMENTS SHALL BE RESUBMITTED FOR APPROVAL AS AN AMENDED SET OF CONSTRUCTION DOCUMENTS. APPROVED WET STAMPED SHOP DRAWING SHALL BE ON SITE FOR INSPECTIONS.
- CLASS 1 STANDPIPE SHALL BE PROVIDED IN BUILDINGS WHERE THE FLOOR LEVEL OF THE HIGHEST STORY IS LOCATED MORE THAN 30' ABOVE THE LOWEST LEVEL OF FIRE DEPARTMENT VEHICLE ACCESS.
- THE MINIMUM TURNING RADIUS IS TO BE 28' AS DETERMINED BY THE FIRE CODE OFFICIAL. THE 28' RADIUS IS TO BE MEASURED FROM THE INSIDE RADIUS.

BUILDING TYPE	CONSTRUCTION TYPE	AREA	HEIGHT	SPRINKLED	FIRE FLOW	Occupancy
TYPE I	II-B	9,100 SF	18'	N	2,000 GPM	M

- LEGEND:**
- PROPERTY BOUNDARY
 - NEW WATERLINE
 - NEW MARKED FIRE LANE
 - EXISTING WATERLINE

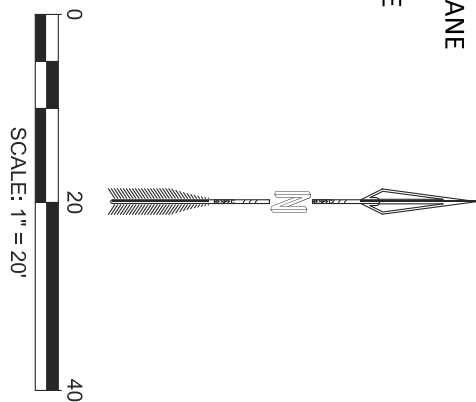

DATE: _____	PROJECT TITLE DOLLAR GENERAL 1500 UNIVERSE BLVD. NW ALBUQUERQUE, NEW MEXICO
SCALE: _____	PROJECT MANAGER STEPHEN DUNBAR, AIA
RE: SCALE _____	JOB NO. DG
	DRAWN BY: S
	SHEET TITLE FIRE-I SITE PLAN



MODULUS ARCHITECTS
100 SUN AVE. N.W. SUITE 600
ALBUQUERQUE, NEW MEXICO 87102
PHONE (505) 338-1499 FAX (505) 338-1498

REV	DATE	BY	REVISION
△			
△			
△			
△			
△			