

# **EROSION CONTROL MEASURES:**

THE CONTRACTOR SHALL BE HELD RESPONSIBLE FOR MANAGEMENT OF STORM RUNOFF DURING CONSTRUCTION; HE SHALL INSURE THAT THE FOLLOWING MEASURES ARE TAKEN:

- ADJACENT PROPERTY SHALL BE PROTECTED AT ALL TIMES BY CONSTRUCTION OF BERMS, DIKES, SWALES, PONDS AND OTHER TEMPORARY GRADING AS REQUIRED TO PREVENT STORM RUNOFF TO LEAVE THE SITE AND ENTERING ADJACENT PROPERTY.
- ADJACENT PUBLIC RIGHT-OF-WAYS SHALL BE PROTECTED AT ALL TIMES FROM STORM WATER RUNOFF FROM THE SITE; NO SEDIMENT BEARING WATER SHALL BE PERMITTED TO ENTER THE PUBLIC STREETS.
- THE CONTRACTOR SHALL IMMEDIATELY AND THOROUGHLY REMOVE ANY OR ALL SEDIMENT WITHIN THE PUBLIC STREETS THAT HAVE BEEN ERODED FROM THE SITE AND DEPOSITED THERE.

## **NOTE TO CONTRACTOR**

1. An excavation/construction permit will be required before beginning any work within the City right-of-way. Approved copy of this plan must be submitted at the time of application for permit.
2. All work detailed in this plan to be performed, except as otherwise stated or provided hereon, shall be constructed in accordance with City of Albuquerque Interim Standard Specification for Public Works Construction 1985.
3. Two working days prior to any excavation, contractor must contact line locating Services at (505) 260-1990 for locating existing utilities.
4. Prior to construction, the contractor shall excavate and verify the horizontal and vertical location of all construction. Should a conflict exist, the contractor shall notify the engineer so that the conflict can be resolved with a minimum amount of delay.
5. Backfill compaction shall be according to residential use.

## **GENERAL NOTES:**

1. ALL WORK ON THIS PROJECT SHALL BE PERFORMED IN ACCORDANCE WITH APPLICABLE FEDERAL, STATE AND LOCAL LAWS, RULES, AND REGULATIONS CONCERNING CONSTRUCTION SAFETY AND HEALTH.

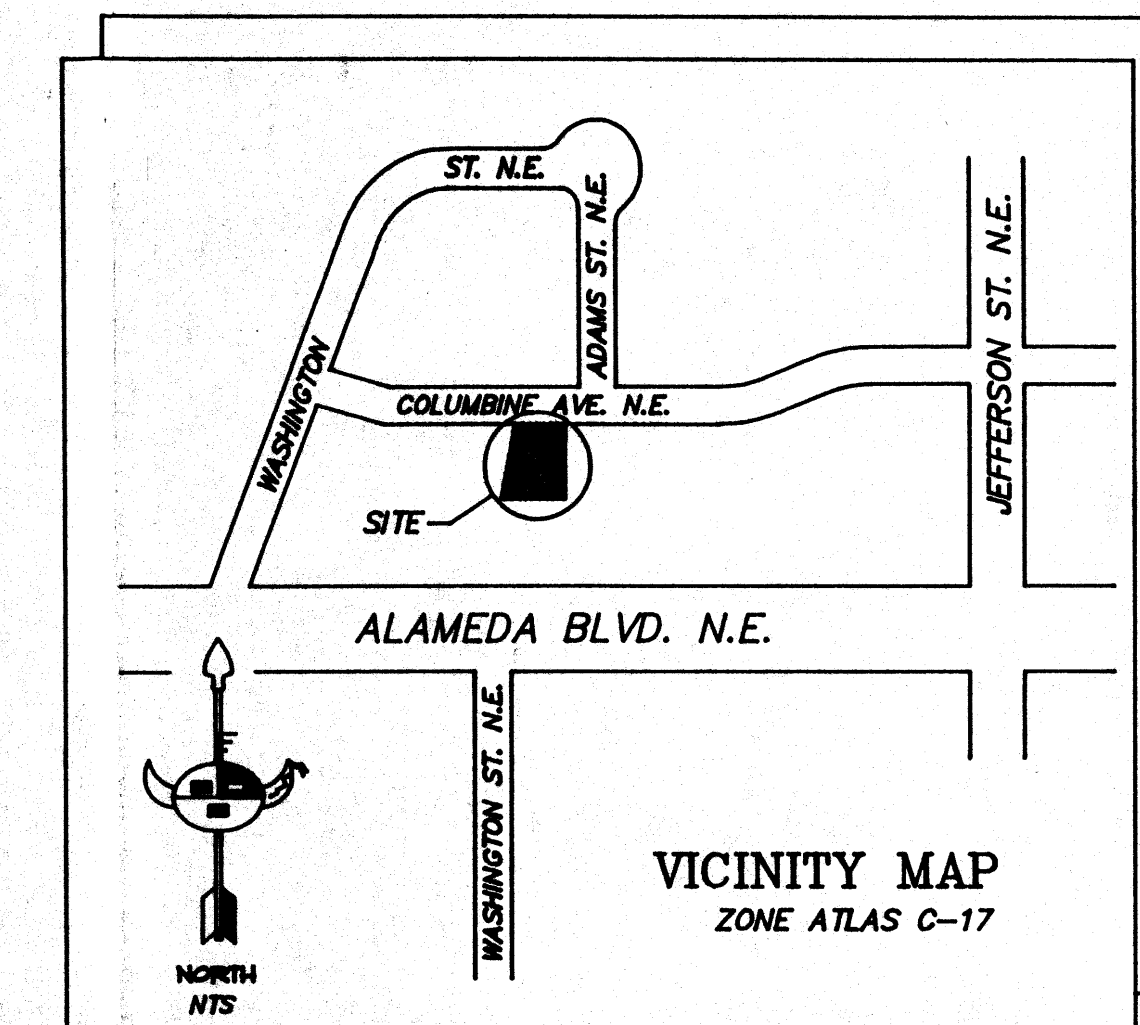
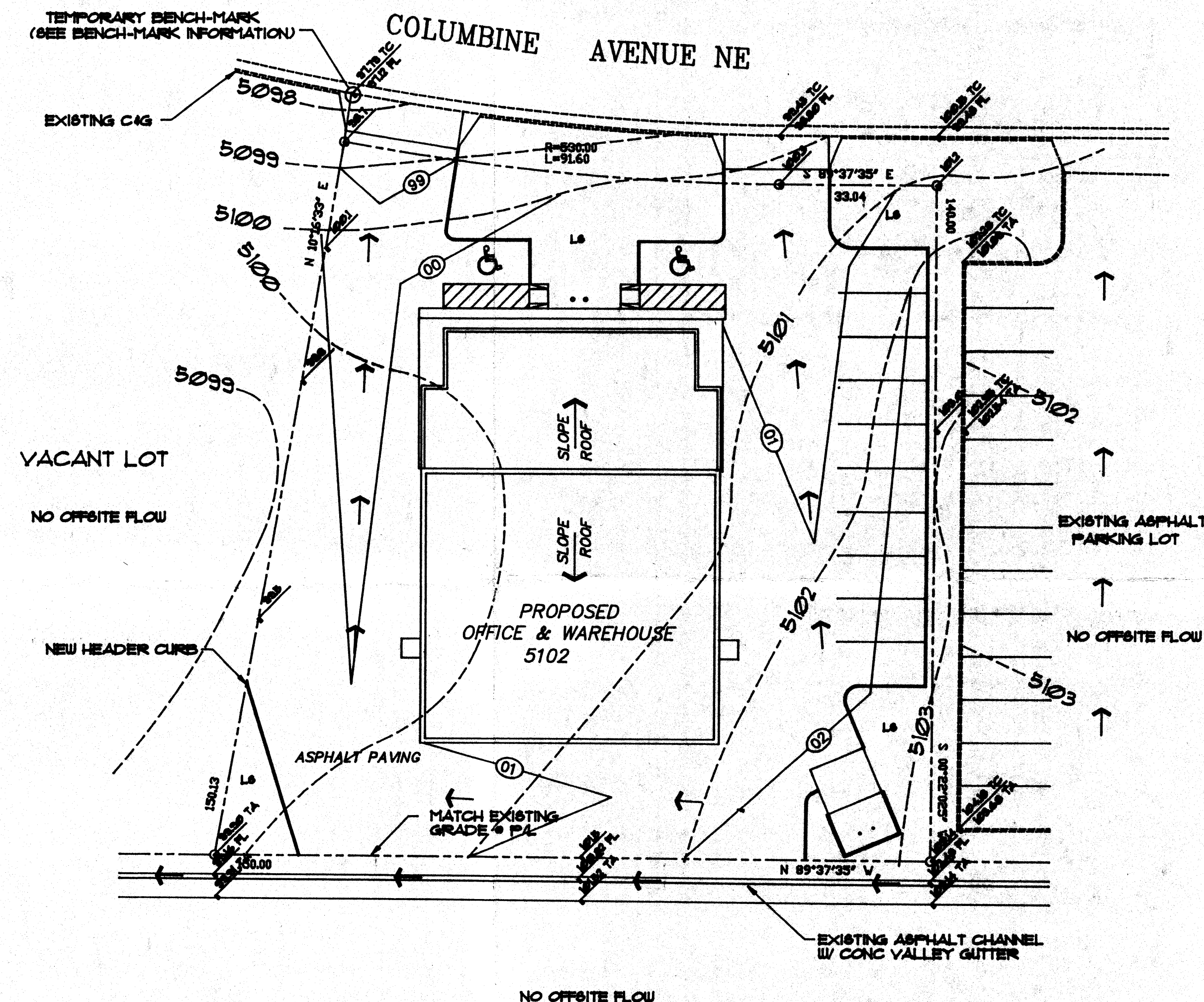

## **LEGAL DESCRIPTION**

LOT 9  
RICHFIELD PARK SUBD  
ALBUQUERQUE, BERNALILLO COUNTY,  
NEW MEXICO.

## **BENCH-MARK INFORMATION**

TEMPORARY BENCH-MARK BEING THE TOP OF CURB AT THE NORTH WEST CORNER BEARS ELEVATION 5097.79 (MSL). REFERENCE TO CITY BENCH-MARK 6-C17 BEARING ELEVATION 5120.260

## **SYMBOL LEGEND**

EXISTING CONTOUR	---	5102
EXISTING CONTOUR	---	25
DESIGNED SPOT ELEVATION	27.50 TC 27.00 TA	
PROPERTY LINE	---	
EASEMENT LINE	---	
FLOW DIRECTION	---	
EXISTING SPOT ELEVATION	---	

## **ABBREVIATION LEGEND**

TOP OF INLET GRATE	-	TG
TOP OF CURB	-	TC
TOP OF ASPHALT	-	TA
FLOWLINE	-	FL

## **CONCEPTUAL GRADING & DRAINAGE PLAN**

SCALE: 1"=20.0'

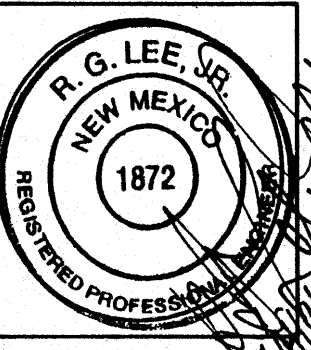
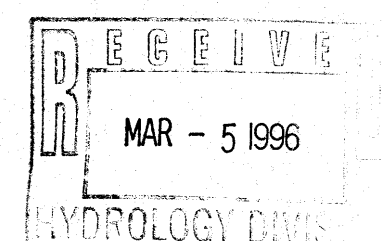
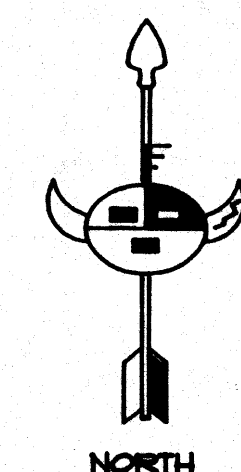
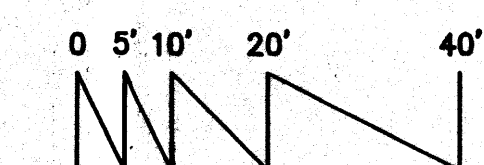

JOB NO. 001  
DATE: FEBRUARY 1996  
REVISION:  
DRAWN BY: HMOOD  
CHECKED BY: R.G. LEE, N.E.

**CONCEPTUAL  
GRADING & DRAINAGE PLAN**

**MILLER  
AND  
ASSOCIATES**  
PLANNERS  
2025 RICHFIELD PARK SUBD  
ALBUQUERQUE, NEW MEXICO 87102  
PHONE: 253-1234 FAX: 253-1235

**PROPOSED  
OFFICE & WAREHOUSE  
ALBUQUERQUE, NEW MEXICO**

JOB TITLE  
**1**