

CITY OF ALBUQUERQUE



January 25, 2016

Scott M. McGee, P.E.
9700 Tanoan Dr., NE
Albuquerque, NM

Re: ABQ Moving & Storage (Paving Plan)
5001 Paseo Del Norte NE
Traffic Circulation Layout
Engineer's/Architect's Stamp dated 1-25-16 (C17-D124)

Dear Mr. McGee,

The TCL submittal received 1-25-16 is approved for Building Permit. A copy of the stamped and signed plan will be needed for each of the building permit plans. Please keep the original to be used for certification of the site for final C.O. for Transportation.

When the site construction is completed and a Certificate of Occupancy (C.O.) is requested, use the original City stamped approved TCL for certification. Redline any minor changes and adjustments that were made in the field. A NM registered architect or engineer must stamp, sign, and date the certification TCL along with indicating that the development was built in "substantial compliance" with the TCL. Submit this certification TCL with a completed Drainage and Transportation Information Sheet to front counter personnel for log in and evaluation by Transportation.

Once verification of certification is completed and approved, notification will be made to Building Safety to issue Final C.O. To confirm that a final C.O. has been issued, call Building Safety at 924-3690.

Sincerely,

Racquel M. Michel, P.E.
Traffic Engineer, Planning Dept.
Development Review Services

\gs via: email
C: CO Clerk, File



City of Albuquerque

Planning Department
Development & Building Services Division

DRAINAGE AND TRANSPORTATION INFORMATION SHEET (REV 09/2015)

Project Title: ABQ Moving & Storage pavingPlan Building Permit #: _____ City Drainage #: C-17/D124

DRB#: _____ EPC#: _____ Work Order#: _____

Legal Description: _____

City Address: 5001 Paseo del Norte NE

Engineering Firm: Scott M McGee PE Contact: scott mcgee

Address: 9700 Tanoan Dr NE

Phone#: 263-2905 Fax#: _____ E-mail: scottmmcgee@gmail.com

Owner: ABQ Moving & Storage Contact: notah howe

Address: 5001 Paseo del Norte NE

Phone#: 823-1441 Fax#: _____ E-mail: _____

Architect: _____ Contact: _____

Address: _____

Phone#: _____ Fax#: _____ E-mail: _____

Other Contact: _____ Contact: _____

Address: _____

Phone#: _____ Fax#: _____ E-mail: _____

Check all that Apply:

DEPARTMENT:

- ☐ HYDROLOGY/ DRAINAGE
☒ TRAFFIC/ TRANSPORTATION
☐ MS4/ EROSION & SEDIMENT CONTROL

TYPE OF SUBMITTAL:

- ☐ ENGINEER/ ARCHITECT CERTIFICATION
☐ CONCEPTUAL G & D PLAN
☐ GRADING PLAN
☐ DRAINAGE MASTER PLAN
☐ DRAINAGE REPORT
☐ CLOMR/LOMR
☒ TRAFFIC CIRCULATION LAYOUT (TCL)
☐ TRAFFIC IMPACT STUDY (TIS)
☐ EROSION & SEDIMENT CONTROL PLAN (ESC)
☐ OTHER (SPECIFY) _____

IS THIS A RESUBMITTAL?: ☒ Yes ☐ No

DATE SUBMITTED: 1/25/16 By: Scott McGee

CHECK TYPE OF APPROVAL/ACCEPTANCE SOUGHT:

- ☐ BUILDING PERMIT APPROVAL
☐ CERTIFICATE OF OCCUPANCY
☐ PRELIMINARY PLAT APPROVAL
☐ SITE PLAN FOR SUB'D APPROVAL
☐ SITE PLAN FOR BLVD PERMIT APPROVAL
☐ FINAL PLAT APPROVAL
☐ SIA/ RELEASE OF FINANCIAL GUARANTEE
☐ FOUNDATION PERMIT APPROVAL
☐ GRADING PERMIT APPROVAL
☐ SO-19 APPROVAL
☒ PAVING PERMIT APPROVAL
☐ GRADING/ PAD CERTIFICATION
☐ WORK ORDER APPROVAL
☐ CLOMR/LOMR
☐ PRE-DESIGN MEETING
☐ OTHER (SPECIFY) _____

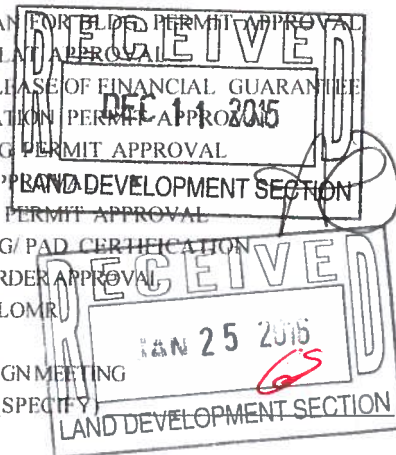

COA STAFF: _____ ELECTRONIC SUBMITTAL RECEIVED: _____

ALBUQUERQUE MOVING & STORAGE
5001 Paseo del Norte NE
Albuquerque, N.M.
DECEMBER 2015

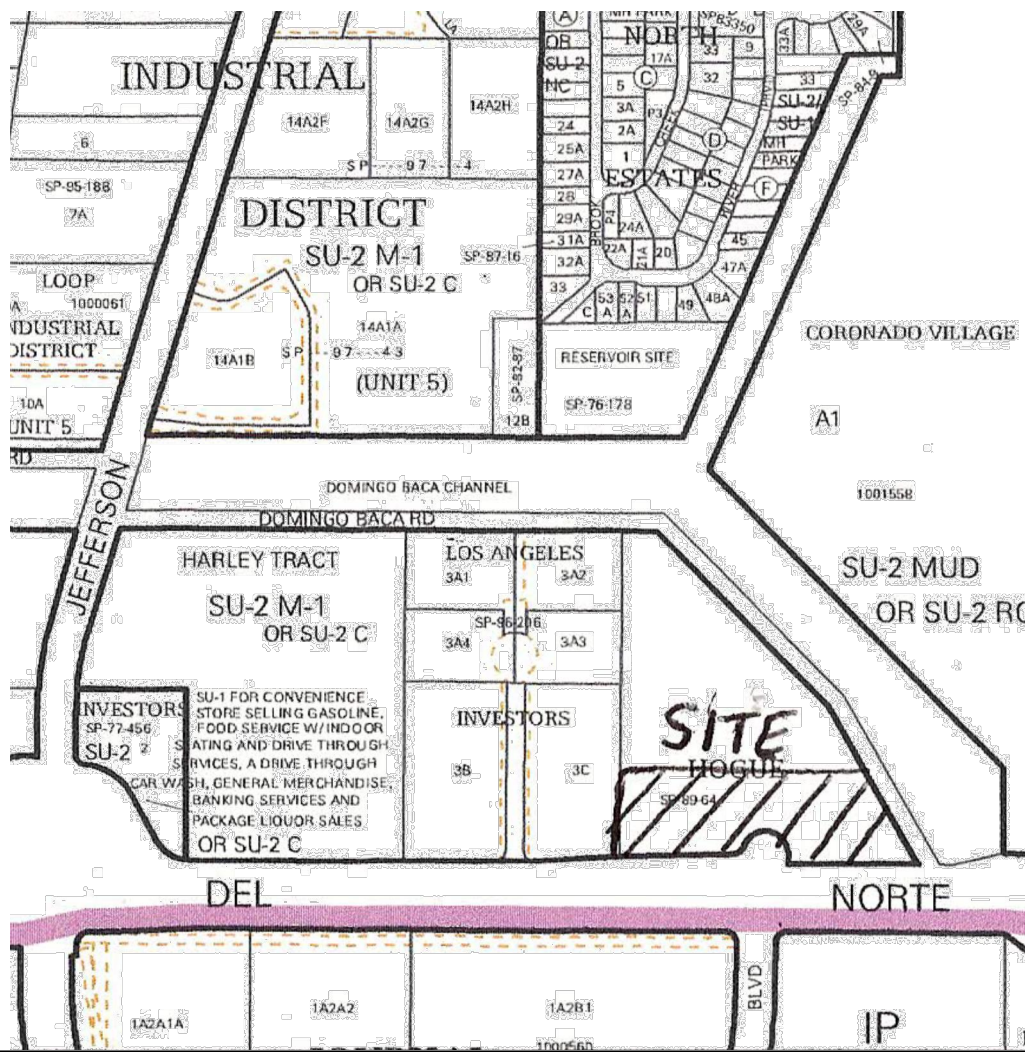

VICINITY MAP C-17 NTS

PARKING CALCULATIONS

ADDRESS: 5001 Paseo del Norte NE, Albuquerque, NM

Existing buildings include a 5,000 SF office area and a 78,000 SF warehouse building. Parking requirements are as follows:

PARKING CALCULATIONS:
Office at 5,000 SF (1 space/200 SF) = 25 spaces
Warehouse at 78,000 SF (1 space/ 2,000 SF) = 39 spaces

Total required parking = 64 spaces (2 motorcycle spaces)
Existing parking spaces along the west side of the site = 16 spaces
Proposed new parking spaces in this parking are = 50 spaces
Total number of parking spaces proposed = 66 spaces

KEYED NOTES

- PAVEMENT SIGNAGE (12" HIGH LETTERS x 2" WIDE), TO READ "NO PARKING" PER COA STANDARDS.
- 6' (MINIMUM) WIDE CONCRETE SIDEWALK.
- BUILD TWO NEW 4' x 8' CONCRETE MOTORCYCLE SPACES WITH 12" X 18" SIGNS EITHER POLE OR BUILDING MOUNTED.
- INSTALL DETECTABLE WARNING TACTILE STRIP (2' BY FULL WIDTH) ON BOTH SIDES OF THE EXISTING CURB CUT.

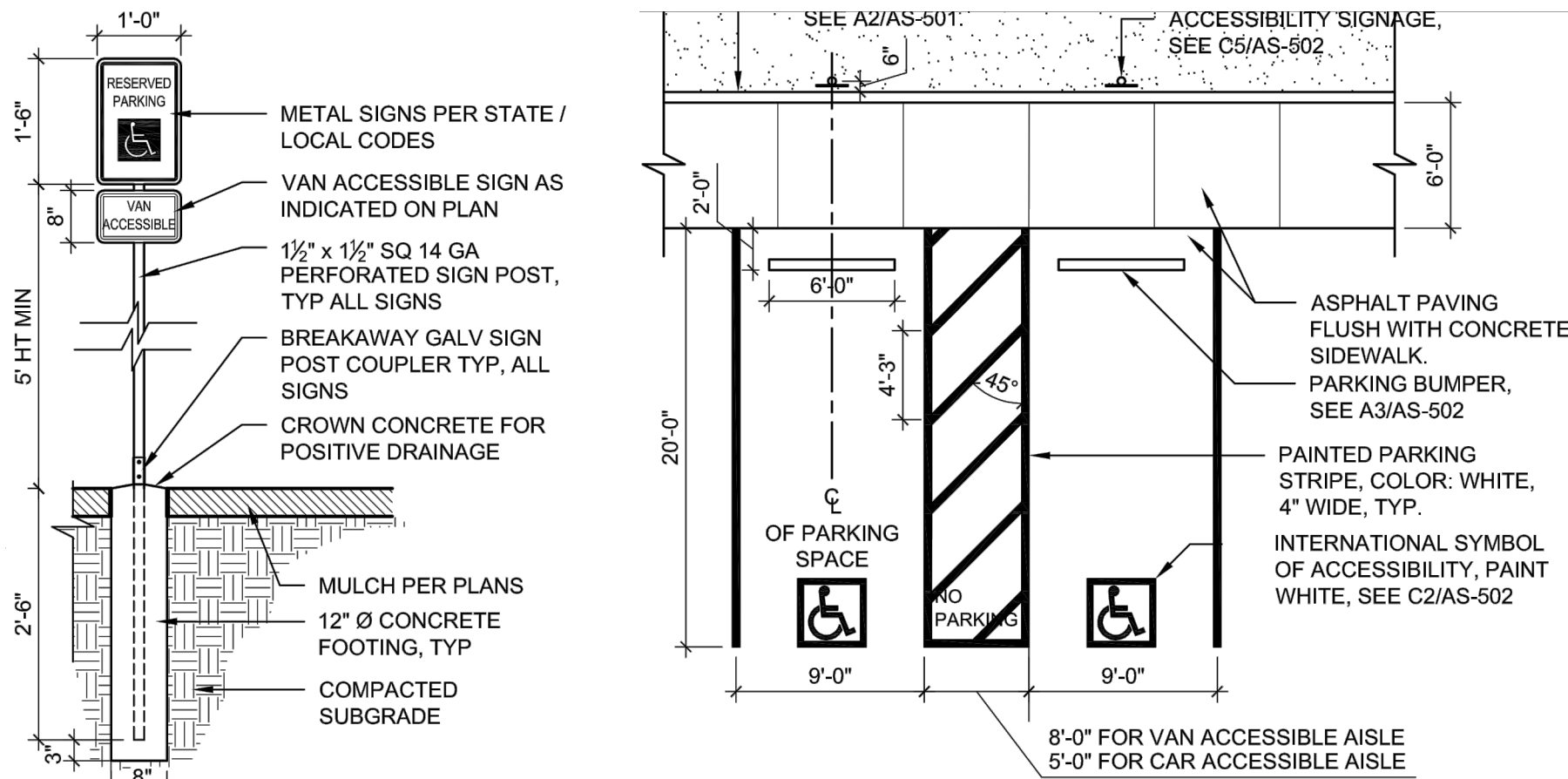

ADD THE FOLLOWING WARNING:
"VIOLATORS ARE SUBJECT
TO A FINE AND/OR TOWING"

H/C PARKING SIGN

ACCESSIBLE PARKING

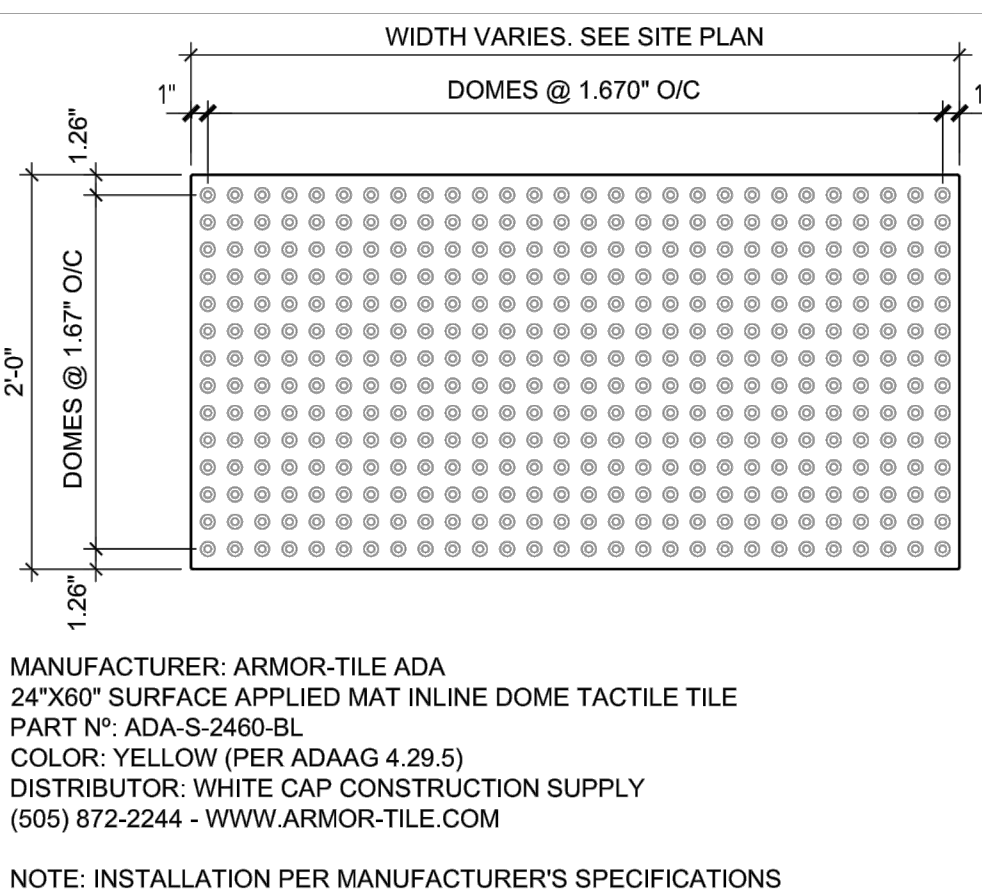

DETECTABLE WARNING

MANUFACTURER: ARMOR-TILE ADA
24"x60" SURFACE APPLIED MAT INLINE DOME TACTILE TILE
PART N°: ADA-S-2460-BL
COLOR: YELLOW (PER ADAAG 4.29.5)
DISTRIBUTOR: WHITE CAP CONSTRUCTION SUPPLY
(505) 872-2244 - WWW.ARMOR-TILE.COM

NOTE: INSTALLATION PER MANUFACTURER'S SPECIFICATIONS

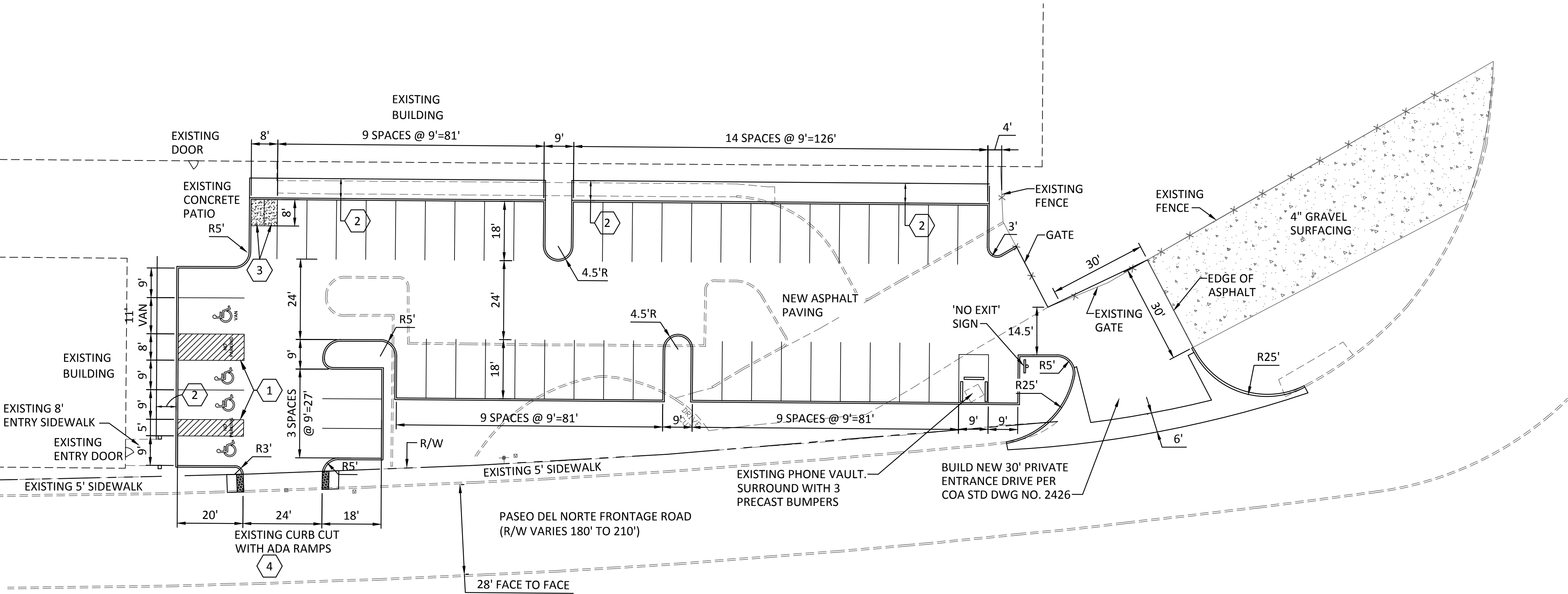

PARKING LOT LAYOUT PLAN

1" = 20'

0 20' 40'

Scott M McGee PE

9700 Tanoan Dr NE
Albuquerque, NM 87111
505.263.2905
scottmmcghee@gmail.com

