

- 1 COVER SHEET
- 2 PROJECT DETAILS
- 3 GENERAL NOTES
- 4 BEST MANAGEMENT PRACTICES
- 5 BEST MANAGEMENT PRACTICES
- 6 BEST MANAGEMENT PRACTICES
- 7 BEST MANAGEMENT PRACTICES
- 8 TEMPORARY EROSION & SEDIMENT CONTROL PLAN
- 9 FINAL STABILIZATION
- LANDSCAPING PLAN - BY OTHERS

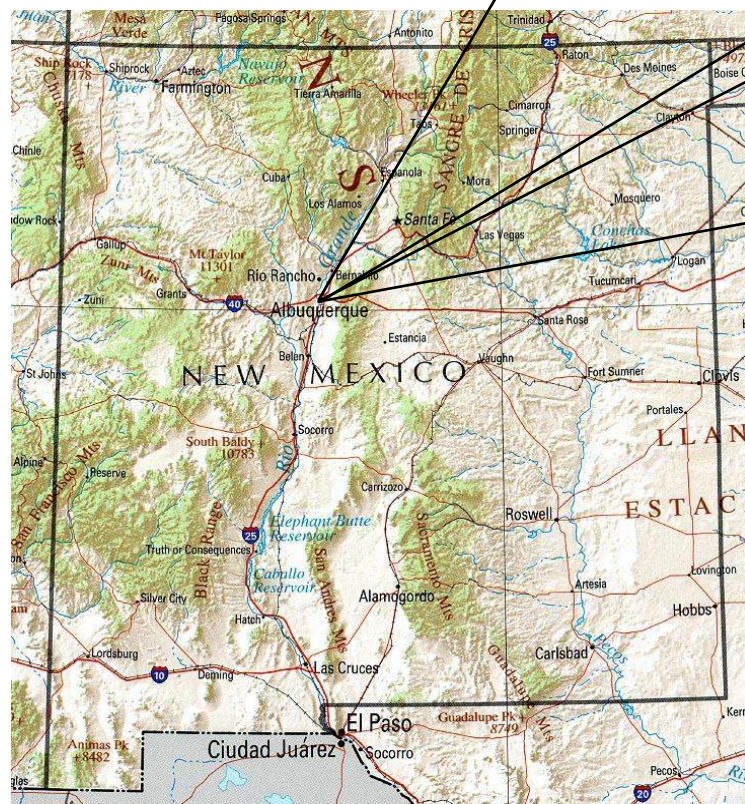
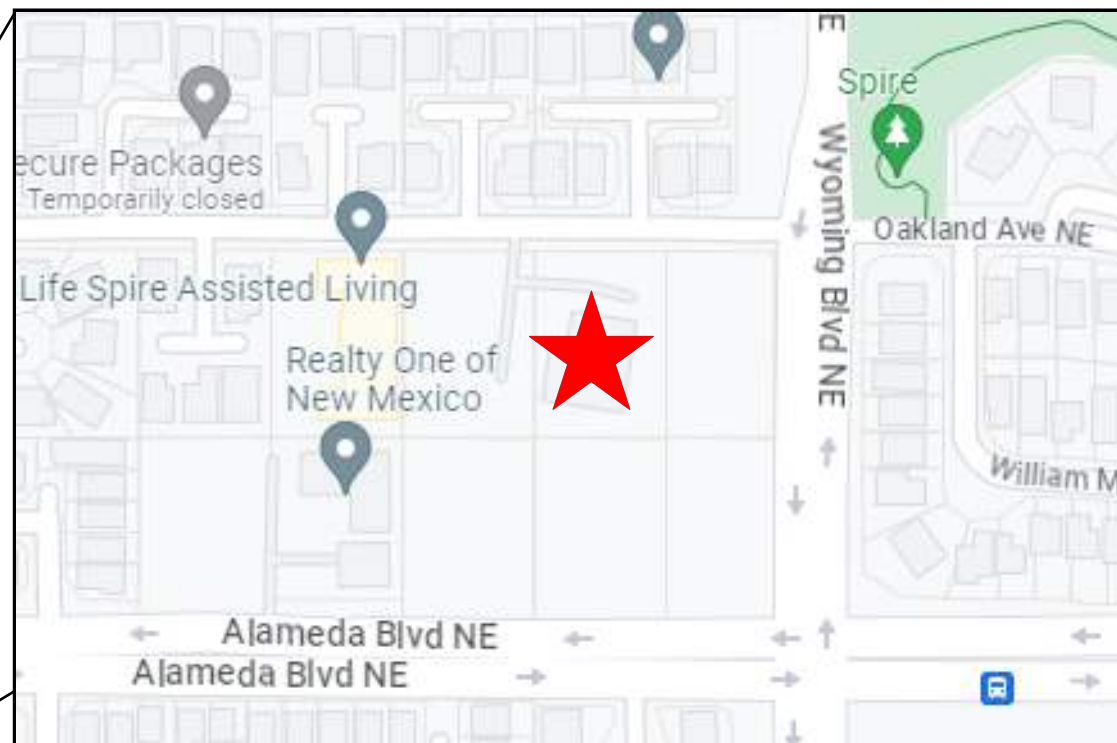

- SWPPP
- Stormwater
- Erosion Control
- Reclamation
- Seeding

www.e2rc.com | 505.867.4040

FRANKLIN'S EARTHMOVING, INC.
CITIZEN CHURCH NORTH
ALBUQUERQUE, NM

DESIGNED BY:
K. FETTER, P.E.
DRAWN BY:
S. FETTER

SHEET:

COVER

#	REVISION ITEM	DATE

PROJECT DETAILS

NPDES ID: NMR1005Q3, NMR1005PJ

ADDRESS: 7518 OAKLAND AVE. NE, ALBUQUERQUE, NM 87113

GPS COORDINATES: 35.185476, -106.560838

TOTAL ACREAGE: 2.5

ANTICIPATED DISTURBED ACREAGE: 2.5

FIRST RECEIVING WATER: COA MS4 THENCE ALAMEDA DRAIN

WATERS WITHIN ONE MILE OF PROJECT: UNNAMED WATER

IMPAIRED/TIERED WATERS: NONE

ENDANGERED SPECIES: CRITERION A

SUPPORT ACTIVITIES: SEE SECTION 3.6 OF SWPPP NARRATIVE

SOIL TYPE: SEE NRCS SOIL REPORT PROVIDED IN SWPPP BINDER

TYPE PRE-CONSTRUCTION COVER: EXISTING BUILDING, ROCK LANDSCAPING, EXPOSED SOILS, ASPHALT PAVEMENT, EXISTING RETAINING WALL

STABILIZATION MEASURES AND DEADLINES: SEE SECTION 6.0 OF SWPPP NARRATIVE

REGULATING AUTHORITY: ENVIRONMENTAL PROTECTION AGENCY (EPA)

OPERATORS

PROPERTY OWNER:
CITIZEN CHURCH
10500 COPPER AVE. NE
ALBUQUERQUE, NM 87123

OWNER CONTACT:
CHRIS BALDWIN
(972) 740-3551
CBALDWIN@CITIZEN.CHURCH

GENERAL CONTRACTOR (GC):
FRANKLIN'S EARTHMOVING, INC.
700 INDUSTRIAL AVE. NE
ALBUQUERQUE, NM 87107

GC CONTACT:
HOWARD ROSS
(505) 373-4945
HOWARD.ROSS@FEINM.COM

STORMWATER TEAM

SEE SECTION 2.0 OF THE SWPPP NARRATIVE FOR THE PROJECT'S STORMWATER TEAM, RESPONSIBILITIES AND CONTACT INFORMATION

SEQUENCE OF ACTIVITIES

REFER TO THE ANTICIPATED CONSTRUCTION SCHEDULE INCLUDED WITH THE SWPPP BINDER

PHASE I: SITE PREPARATION AND PRE – CONSTRUCTION

- 1.PRIOR TO BEGINNING EARTH DISTURBING ACTIVITIES, THE OPERATOR(S) WILL CLEARLY DEMARCATATE THE LIMITS OF DISTURBANCE WITH STAKES, RIBBONS, CONSTRUCTION FENCING, OR OTHER APPROPRIATE METHOD. THESE DEMARCATIONS SHALL REMAIN VISIBLE FOR THE DURATION OF THE PROJECT.
- 2.THE INITIAL EROSION CONTROL MEASURES SHALL BE INSTALLED PRIOR TO EARTH DISTURBANCE. THE INITIAL CONTROL MEASURES MAY INCLUDE BUT ARE NOT LIMITED TO:
- a.PERIMETER CONTROLS (E.G., SILT FENCE, WATTLES, CONSTRUCTION FENCE)
 - b.VEHICLE TRACKING PAD IF THE SITE ENTERS/EXITS ONTO A PAVED PUBLIC ROADWAY
 - c.NPDES NOTIFICATION POSTING
 - d.DESIGNATED STAGING AREA
 - e.ANCHORED SANILETS
 - f.DUMPSTERS

PHASE II: CONSTRUCTION ACTIVITIES

- 1.THE OPERATORS WILL MINIMIZE THE AREA DISTURBED AS MUCH AS FEASIBLY POSSIBLE.
- 2.ANY DISTURBED AREA IN WHICH CONSTRUCTION ACTIVITIES HAVE TEMPORARILY CEASED SHALL TEMPORARILY STABILIZED USING THE METHODS DESCRIBED IN SECTION 6.4 OF THE SWPPP NARRATIVE. SECTION 6.3 OF THE SWPPP NARRATIVE PROVIDES THE TEMPORARY STABILIZATION DEADLINES.
- 3.THE LOCATION OF SOME BMPS MAY REQUIRE ALTERATION IF DRAINAGE PATTERNS CHANGE DURING CONSTRUCTION. THE OPERATORS SHALL INSTALL ADDITIONAL BMPS OR UPGRADE BMPS IF NECESSARY.
- 4.IF CONCRETE IS USED ONSITE AND CONCRETE TRUCKS ARE UNABLE TO WASHOUT OFFSITE, THE OPERATORS WILL PROVIDE ONE OR MORE DESIGNATED CONCRETE WASHOUT AREAS. THE CONCRETE WASHOUTS MUST BE INSTALLED PRIOR TO CONCRETE USE ONSITE AND REMOVED ONLY AFTER CONCRETE WORK IS COMPLETE.

PHASE III: FINAL STABILIZATION AND CONSTRUCTION COMPLETION

- 1.IF APPLICABLE, REVEGETATION OR LANDSCAPING SHALL BE INITIATED IMMEDIATELY UPON KNOWING WORK IN A DISTURBED AREA HAS PERMANENTLY STOPPED AND THE AREA IS NOT COVERED BY PERMANENT STRUCTURES, UNLESS INFEASIBLE. SECTION 6.5 OF THE SWPPP NARRATIVE DISCUSSES PERMANENT STABILIZATION AND ASSOCIATED DEADLINES.
- 2.THE OPERATORS SHALL REMOVE TEMPORARY BMPS ONLY AFTER FINAL STABILIZATION IS COMPLETE.



www.e2rc.com | 505.867.4040



					DATE
					REVISION ITEM
					#

FRANKLIN'S EARTHMOVING, INC.
CITIZEN CHURCH NORTH
SWPPP NOTES

DESIGNED BY:
K. FETTER, P.E.
DRAWN BY:
S. FETTER

SHEET:
GENERAL
NOTES

GENERAL NOTES

THE NPDES COMPLIANCE SWPPP DRAWING AND ASSOCIATED DOCUMENTATION IS AND SHALL BE CONSIDERED A LIVING DOCUMENT ALLOWING FOR MODIFICATIONS AS SITE CONDITIONS CHANGE OR DICTATE.

ALL SITE FEATURES (EXISTING/PROPOSED GRADES, EXISTING CONSTRUCTION, FUTURE CONSTRUCTION, ETC.) SHOWN IS PER INFORMATION FROM OTHERS.

MINIMUM REQUIREMENTS TO FURTHER DEVELOP OR MODIFY THIS STORMWATER POLLUTION PREVENTION PLAN (SWPPP) DRAWING SHALL BE BASED ON THE CURRENT EDITION OF THE NEW MEXICO STATE HIGHWAY AND TRANSPORTATION DEPARTMENT (NMSHTD), NPDES LAW AND CITY OF ALBUQUERQUE ORDINANCE § 14-5-2-11.

ALL OPERATORS SHALL SUBMIT A NOTICE OF INTENT (NOI). THE NOI SHALL BE ACTIVE AND POSTED ON THE EPA'S WEBSITE PRIOR TO COMMENCING EARTH DISTURBING ACTIVITIES.

LOCATE TEMPORARY WASHOUT, ANCHORED TOILETS, CONSTRUCTION ENTRANCE AND PARKING, STAGING, REFUELING, TRASH CONTAINMENT AREA TO MINIMIZE SITE DISTURBANCE DURING CONSTRUCTION ACTIVITY.

THE OPERATOR IS REQUIRED TO REGULARLY PERFORM STREET SWEEPING AND CLEAN - UP MEASURES IN THE EVENT OF SEDIMENT TRACK - OUT.

THE FOLLOWING ARE STANDARD EROSION CONTROL REQUIREMENTS PER THE CITY OF ALBUQUERQUE STORMWATER QUALITY DEPARTMENT (JUNE 16, 2023):

ALL EROSION AND SEDIMENT CONTROL (ESC) WORK ON THESE PLANS, EXCEPT AS OTHERWISE STATED OR PROVIDED HEREON SHALL BE PERMITTED, CONSTRUCTED, INSPECTED, AND MAINTAINED IN ACCORDANCE WITH:

THE CITY ORDINANCE § 14-5-2-11, THE ESC ORDINANCE;
THE EPA'S 2022 CONSTRUCTION GENERAL PERMIT (CGP); AND
THE CITY OF ALBUQUERQUE CONSTRUCTION BMP MANUAL

ALL BEST MANAGEMENT PRACTICES (BMPs) MUST BE INSTALLED PRIOR TO BEGINNING ANY EARTH MOVING ACTIVITIES EXCEPT AS SPECIFIED HEREON IN THE PHASING PLAN. CONSTRUCTION OF EARTHEN BMPs SUCH AS SEDIMENT TRAPS, SEDIMENT BASINS, AND DIVERSION BERMS SHALL BE COMPLETED AND INSPECTED PRIOR TO ANY OTHER CONSTRUCTION OR EARTHWORK. SELF-INSPECTION IS REQUIRED AFTER INSTALLATION OF THE BMPs AND PRIOR TO BEGINNING CONSTRUCTION.

SEE SECTION 3.5 OF THE SWPPP NARRATIVE OR THE CONTRACTOR'S SCHEDULE FOR BMP SCHEDULING OR PHASING.

SELF-INSPECTIONS - IN ACCORDANCE WITH CITY ORDINANCE § 14-5-2-11(C)(1), AT A MINIMUM A ROUTINE SELF-INSPECTION IS REQUIRED TO REVIEW THE PROJECT FOR COMPLIANCE WITH THE CONSTRUCTION GENERAL PERMIT ONCE EVERY 14 DAYS AND AFTER ANY PRECIPITATION EVENT OF 1/4 INCH OR GREATER UNTIL THE SITE CONSTRUCTION HAS BEEN COMPLETED AND THE SITE DETERMINED AS STABILIZED BY THE CITY. REPORTS OF THESE INSPECTIONS SHALL BE KEPT BY THE PERSON OR ENTITY AUTHORIZED TO DIRECT THE CONSTRUCTION ACTIVITIES ON THE SITE AND MADE AVAILABLE UPON REQUEST.

CORRECTIVE ACTION REPORTS MUST BE KEPT BY THE PERSON OR ENTITY AUTHORIZED TO DIRECT THE CONSTRUCTION ACTIVITIES ON THE SITE AND MADE AVAILABLE UPON REQUEST.

FINAL STABILIZATION AND NOTICE OF TERMINATION (NOT) - IN ACCORDANCE WITH CITY ORDINANCE § 14-5-2-11(C)(1), SELF-INSPECTIONS MUST CONTINUE UNTIL THE SITE IS "DETERMINE AS STABILIZED BY THE CITY". THE PROPERTY OWNER/OPERATOR IS RESPONSIBLE FOR DETERMINING WHEN THE "CONDITIONS FOR TERMINATION CGP COVERAGE" PER CGP PART 8.2 ARE SATISFIED AND THE FOR FILING THEIR NOT WITH THE EPA. EACH OPERATOR MAY TERMINATE GCP COVERAGE ONLY IF ONE OR MORE OF THE CONDITIONS IN PART 8.2.1, 8.2.2 OR 8.2.3 HAS OCCURRED. AFTER FILING THE NOT WITH THE EPA, THE PROPERTY OWNER IS RESPONSIBLE FOR REQUESTING A DETERMINATION OF STABILIZATION FROM THE CITY.

WHEN DOING WORK IN THE CITY RIGHT-OF-WAY (E.G., SIDEWALK, DRIVE PADS, UTILITIES, ETC.) PREVENT SEDIMENT FROM ENTERING THE STREET. IF SEDIMENT IS PRESENT IN THE STREET, THE STREET SHOULD BE SWEEP DAILY OR PRIOR TO A RAIN EVENT OR CONTRACTOR INDUCED WATER EVENT (E.G. CURB CUT OR WATER TEST).

WHEN CUTTING THE STREET FOR UTILITIES, THE SEDIMENT SHALL BE PLACED ON THE UPHILL SIDE OF THE STREET CUT AND THE AREA SWEEP AFTER WORK IS COMPLETE. A WATTLE OR MULCH SOCK MAY BE PLACED AT THE TOE OF THE EXCAVATED DIRT PILE IF SITE CONSTRAINTS DO NOT ALLOW PLACING THE EXCAVATED DIRT ON THE UPHILL SIDE OF THE STREET CUT.

EROSION AND SEDIMENT CONTROL (ESC) PLANS MUST SHOW LONGITUDINAL STREET SLOPE AND STREET NAMES. ON STREETS WHERE THE LONGITUDINAL SLOPE IS STEEPER THAN 2.5%, WATTLES OR MULCH SOCKS OR J-HOOKED SILT FENCE SHALL BE SHOWN IN THE FRONT YARD SWALE OR ON THE SIDE OF THE STREET.



					DATE
					REVISION ITEM
					#

FRANKLIN'S EARTHMOVING, INC.
CITIZEN CHURCH NORTH
SWPPP NOTES





SWPPP
Stormwater
Erosion Control
Reclamation
Seeding

www.e2rc.com | 505.867.4040

DESIGNED BY:
K. FETTER, P.E.
DRAWN BY:
S. FETTER

SHEET:
GENERAL
NOTES

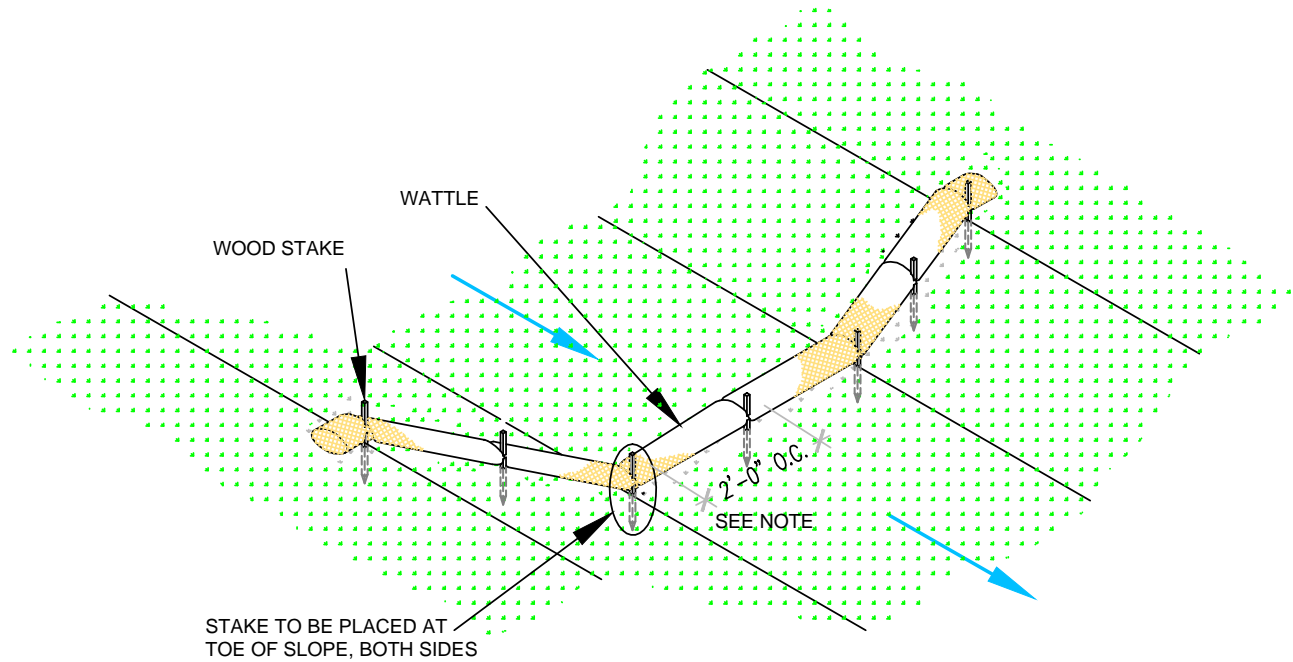

WATTLE WITHOUT BLANKET

NTS

2' FOR DRAWING ONLY. 8' MAX
SPACING BETWEEN STAKES

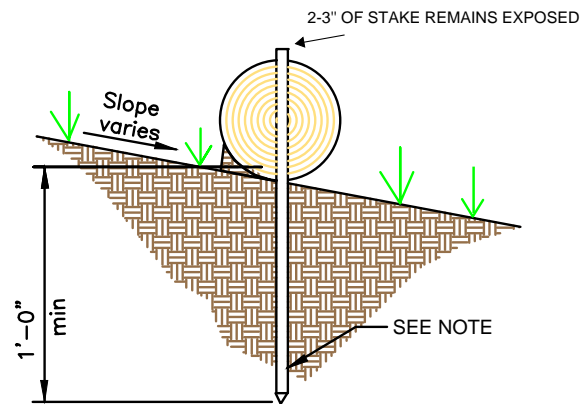

WATTLE

NTS

SECURE WATTLE WITH 18-24" STAKES EVERY 3-4' AND STAKES ON EACH END OF THE WATTLE.

DRIVE STAKES PERPENDICULAR TO THE SLOPE FACE AND THROUGH THE MIDDLE OF THE WATTLE LEAVING AT LEAST 2-3" OF THE STAKE ABOVE THE WATTLE.

VERTICAL SPACING DEPENDENT ON SLOPE GRADIENT.

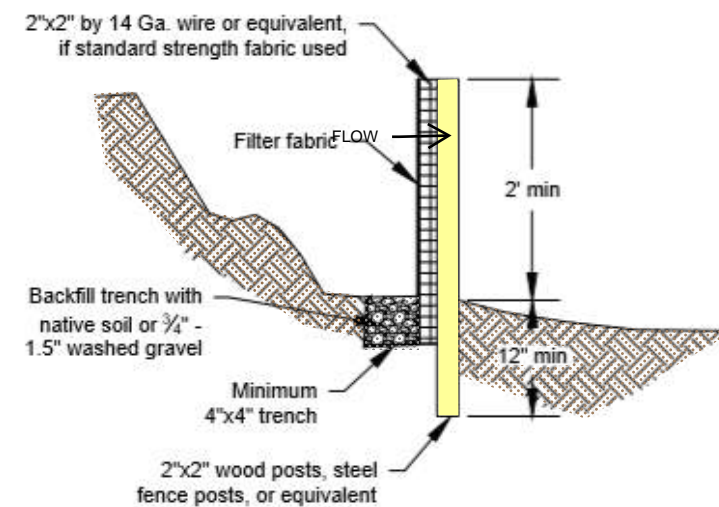
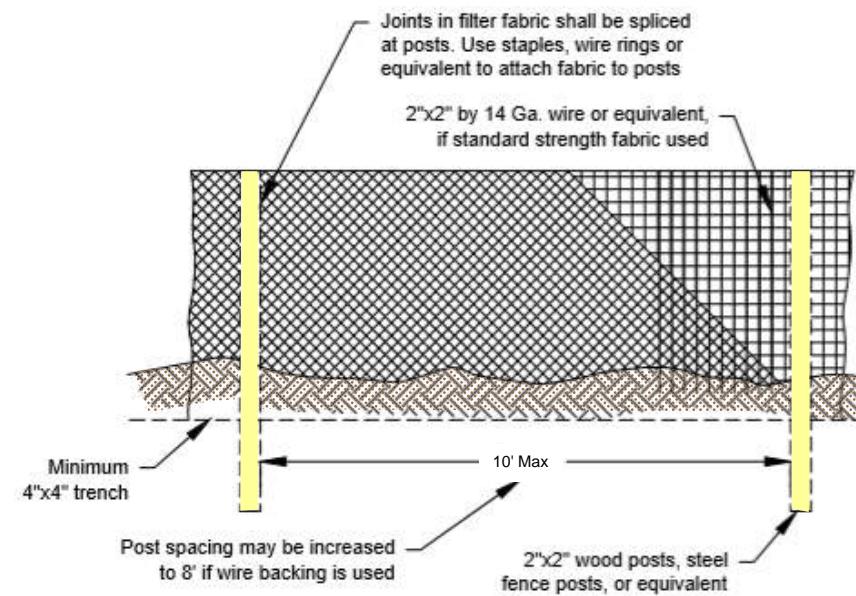
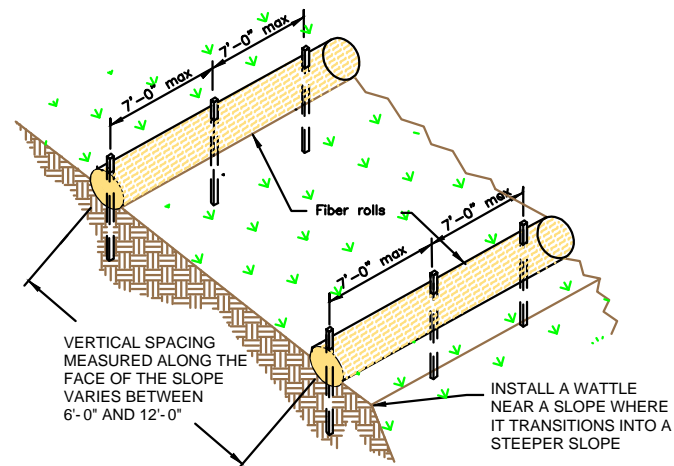

SILT FENCE

NTS

SILT FENCE IS TO BE PLACED PERPENDICULAR TO THE SLOPE OF THE SITE.

DIG A 4"X4" MINIMUM TRENCH UPSTREAM OF THE SILT FENCE. DRIVE STAKES AT LEAST 1' DEEP ON THE DOWNSTREAM EDGE.

RUN THE SILT FENCE ON THE INSIDE OF THE STAKES AND SECURE WITH HOG RINGS, WIRE, ZIP TIES OR STAPLES.

IF ONE CONTINUOUS PIECE OF FABRIC IS NOT AVAILABLE, OVERLAP THE FABRIC AT LEAST THE WIDTH OF THE STAKE AND SECURE WITH HOG RINGS, WIRE, ZIP TIES OR STAPLES.

COVER TRENCH WITH BACKFILLED COMPACTED SOIL, GRAVEL OR ROCK.

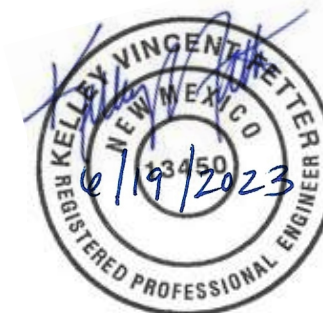

SWPPP
Stormwater
Erosion Control
Reclamation
Seeding

www.e2rc.com | 505.867.4040



				DATE
				REVISION ITEM
				#

FRANKLIN'S EARTHMOVING, INC.
CITIZEN CHURCH NORTH
BMP DETAILS

DESIGNED BY:
K. FETTER, P.E.
DRAWN BY:
S. FETTER

SHEET:

4

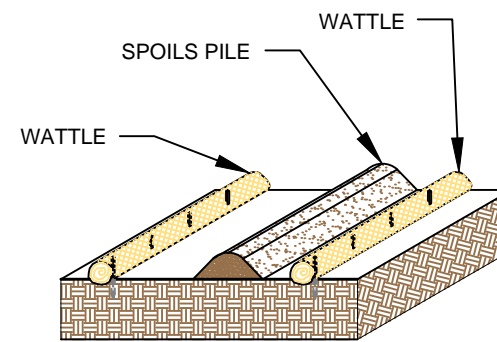

SPOILS PILE PROTECTION

NTS

PLACE WATTLES IN FUTURE LOCATIONS OF SPOILS STOCKPILES PRIOR TO CONSTRUCTION.

PLACE WATTLES CONTINUOUSLY ALONG THE EXTENT OF THE SPOILS STOCKPILE.

ANCHOR THE WATTLES USING A MINIMUM OF 1" X 2" X 18" WOODEN STAKES OR SAND BAGS.

ONCE/IF THE SPOILS STOCKPILE IS DEPLETED OR MOVED,
REMOVE THE WATTLES AND REUSE THEM IN THE NEXT
LOCATION.

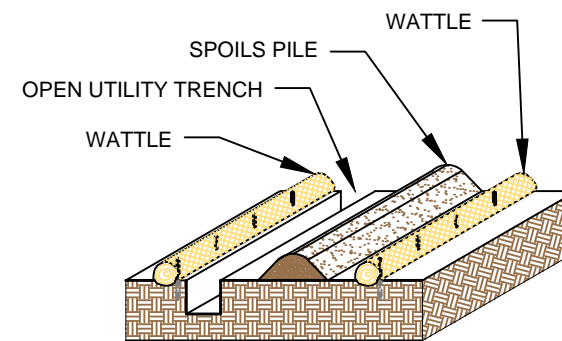

OPEN TRENCH SPOILS PILE PROTECTION

NTS

PLACE WATTLES CONTINUOUSLY ALONG THE EXTENT OF THE UTILITY TRENCH AND FUTURE LOCATION OF THE SPOILS STOCKPILE PRIOR TO EXCAVATION OF THE UTILITY.

WATTLES ARE TO REMAIN ANCHORED IN PLACE UNTIL THE UTILITY TRENCH IS BACKFILLED.

ANCHOR THE WATTLES USING A MINIMUM 1"X2"X18"
WOODEN STAKE OR SANDBAGS.

ONCE THE TRANCH IS BACKFILLED, WATTLES MAY BE REMOVED AND REUSED IN THE NEXT SECTION OF EXCAVATION PROVIDED THEY ARE IN GOOD CONDITION.

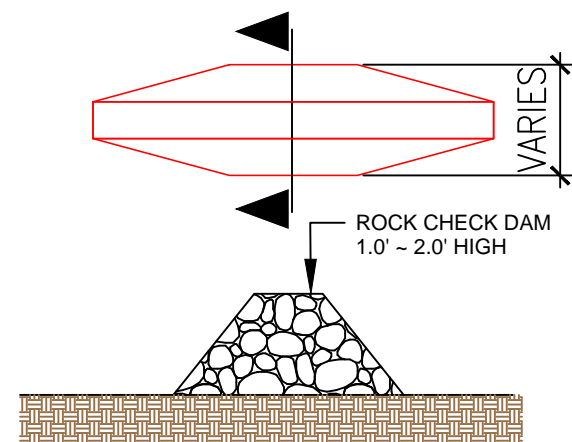

ROCK CHECK DAM

NTS

PLACE CHECK DAMS AT REGULARLY SPACED INTERVALS
ALONG SWALE OR DRAINAGE DITCH.

HEIGHTS SHOULD ALLOW FOR POOLS TO DEVELOP
UPSTREAM OF EACH CHECK DAM.

IF MULTIPLE DAMS ARE USED, THE TOP OF THE LOWER DAM SHOULD BE THE SAME HEIGHT AS THE ELEVATION AS THE TOE OF THE UPPER DAM.

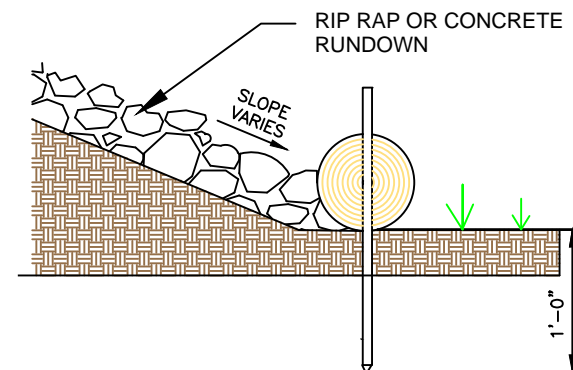

RUNDOWN DETAIL

NTS

8' MAX SPACING BETWEEN STAKES

PLACE WATTLES AT THE TOE OF SLOPE. THE RIP RAP OR CONCRETE RUNDOWN SHOULD ABUT THE WATTLE.

ANCHOR THE WATTLES WITH WOODEN STAKES. DRIVE THE STAKE A MINIMUM OF 12" INTO THE MIDDLE OF THE WATTLE AND SOIL UNDERNEATH.

2-3" OF THE WOODEN STAKE SHOULD BE PRESENT ABOVE THE WATTLE.

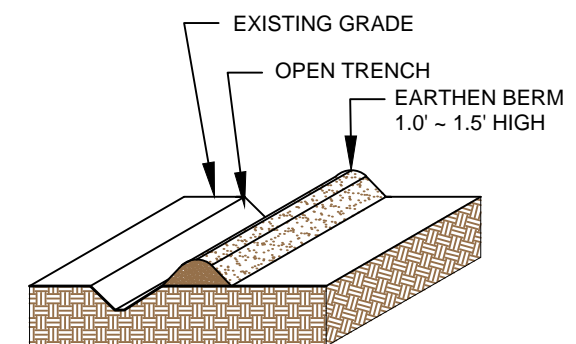

EARTHEN BERM

NTS

CONSTRUCT AN EARTHEN BERM DOWN HILL OF THE AREA
TO BE CONTROLLED.

BERM SHOULD BE A MINIMUM 12" HIGH AND 12" WIDE.

USE EQUIPMENT TO COMPACT EARTHEN BERM BY ROLLING OVER BERM TO MINIMIZE SPREAD.



- SWPPP
- Stormwater
- Erosion Control
- Reclamation
- Seeding

www.e2rc.com | 505.867.4040



#	REVISION ITEM	DATE

FRANKLIN'S EARTHMOVING, INC.
CITIZEN CHURCH NORTH
BMP DETAILS

DESIGNED BY:
K. FETTER, P.E.
DRAWN BY:
S. FETTER

SHEET:

5

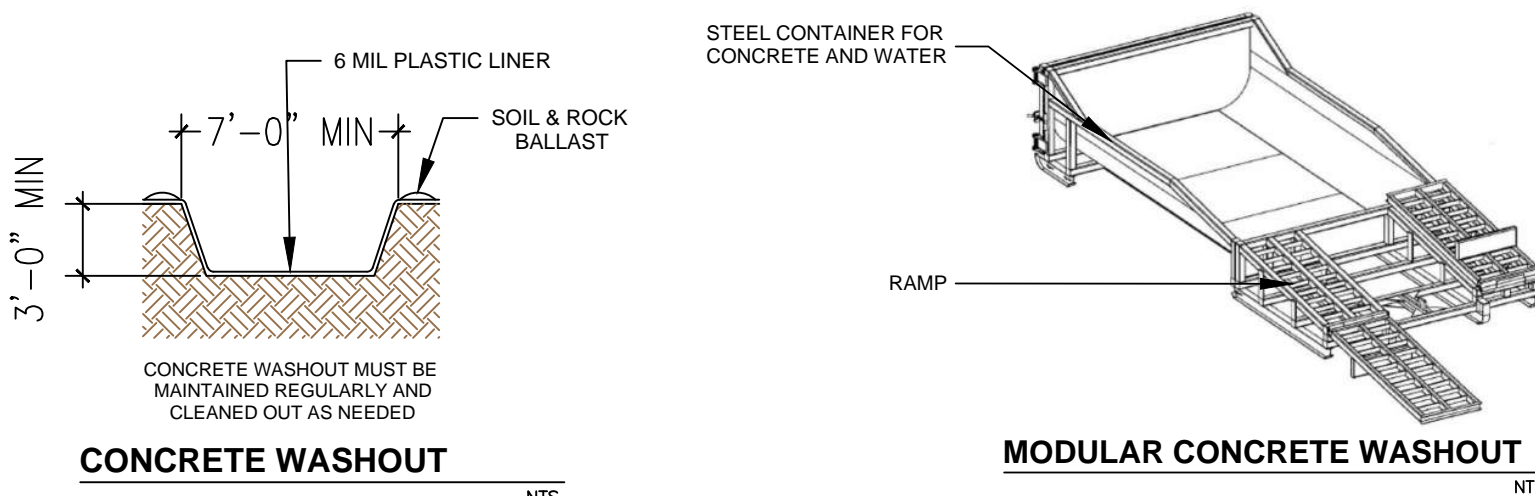

LOCATE WASHOUT AT LEAST 50 FT FROM STORMDRAINS, OPEN DITCHES, WATER BODIES OR PROJECT PERIMETER. A SIGN SHOULD BE INSTALLED ADJACENTLY TO THE WASHOUT.

WASH OUT WASTE INTO THE WASHOUT WHERE THE CONCRETE CAN SET, BE BROKEN UP AND DISPOSED OF CORRECTLY.

DO NOT CREATE RUNOFF BY DRAINING WATER TO BERMED AREA OR BY COLLECTING THE WATER WASTE WHEN WASHING CONCRETE TO REMOVE PARTICLES AND EXPOSE THE AGGREGATE.

DO NOT WASH SWEEPINGS FROM EXPOSED AGGREGATE CONCRETE INTO THE STREET, STORMDRAIN SYSTEMS OR OFF THE PROJECT SITE.

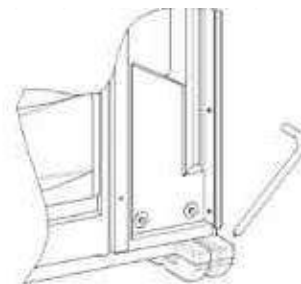

PORTABLE TOILET STAKING

PLACE THE PORTABLE TOILET ON LEVEL GROUND. A FLAT
PAVED SURFACE IS BEST IF AVAILABLE.

DRIVE THE STAKES OVER THE SKIDS OF THE PORTABLE
TOILET, AROUND ALL SIDES.

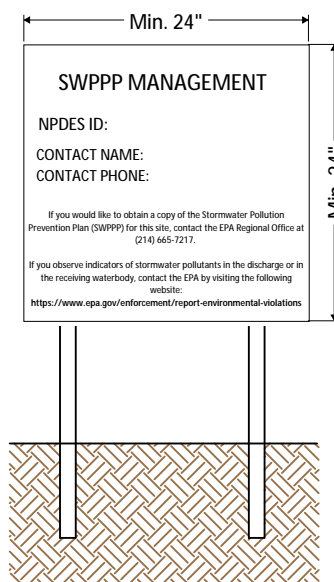

NPDES Permit must be positioned at the most active part of the project where it can be viewed by the public (e.g. project entrance).

NPDES POSTING BOARD

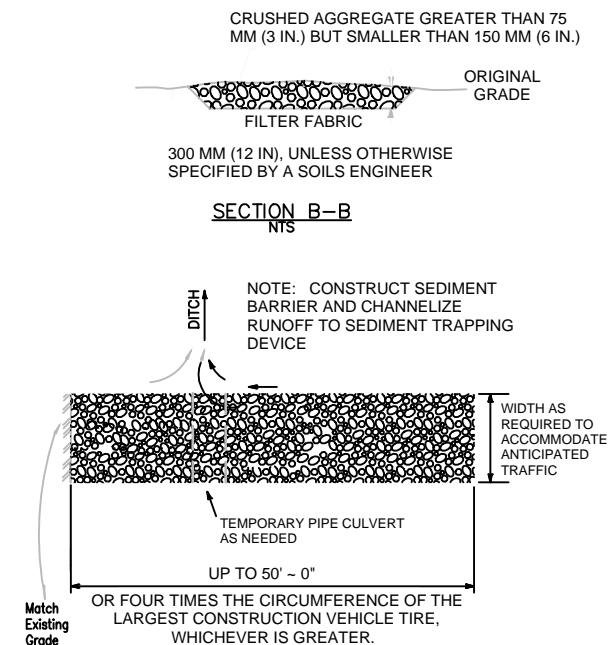

STABILIZED CONSTRUCTION ENTRANCE

CONSTRUCT THE ENTRANCE ON A LEVEL SURFACE WHERE AN UNPAVED ROAD MEETS A PAVED ROAD. TYPICALLY AT PROJECTS ACCESS AREA.

GRADE THE ENTRANCE TOWARD THE CONSTRUCTION SITE TO PREVENT RUNOFF.

INSPECT THE ENTRANCE TO KEEP TRASH AND DEBRIS OUT OF THE WAY.

AFTER PRECIPITATION EVENTS, INSPECT THE ENTRANCE FOR ANY REPAIRS THAT MAY BE NEEDED.



www.e2rc.com | 505.867.4040



#		REVISION ITEM		DATE	

FRANKLIN'S EARTHMOVING, INC.
CITIZEN CHURCH NORTH
BMP DETAILS

DESIGNED BY:
K. FETTER, P.E.
DRAWN BY:
S. FETTER

SHEET:

7

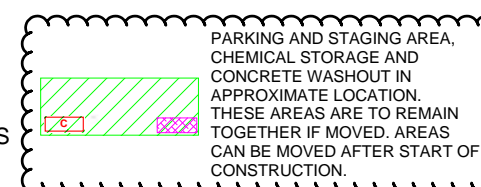
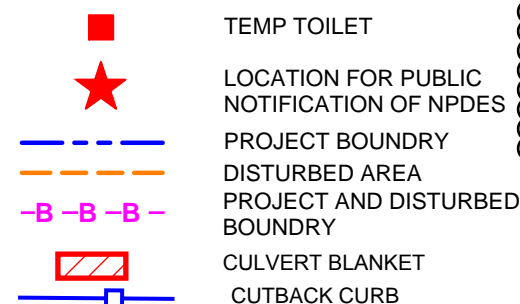
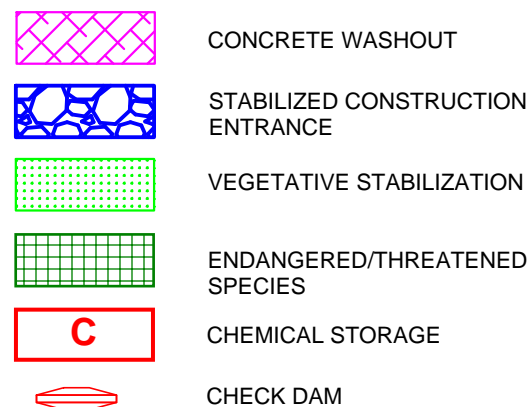
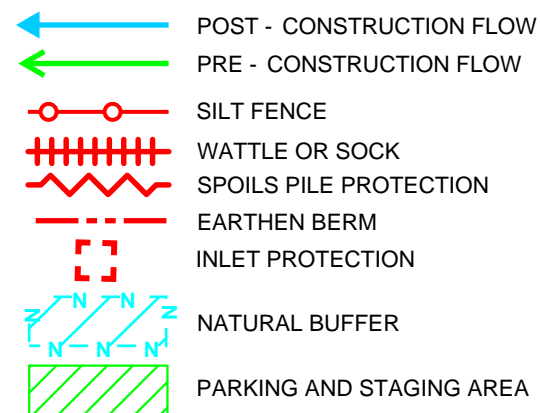

DRAWING KEY

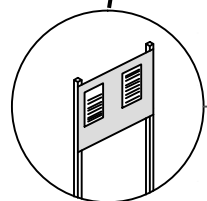
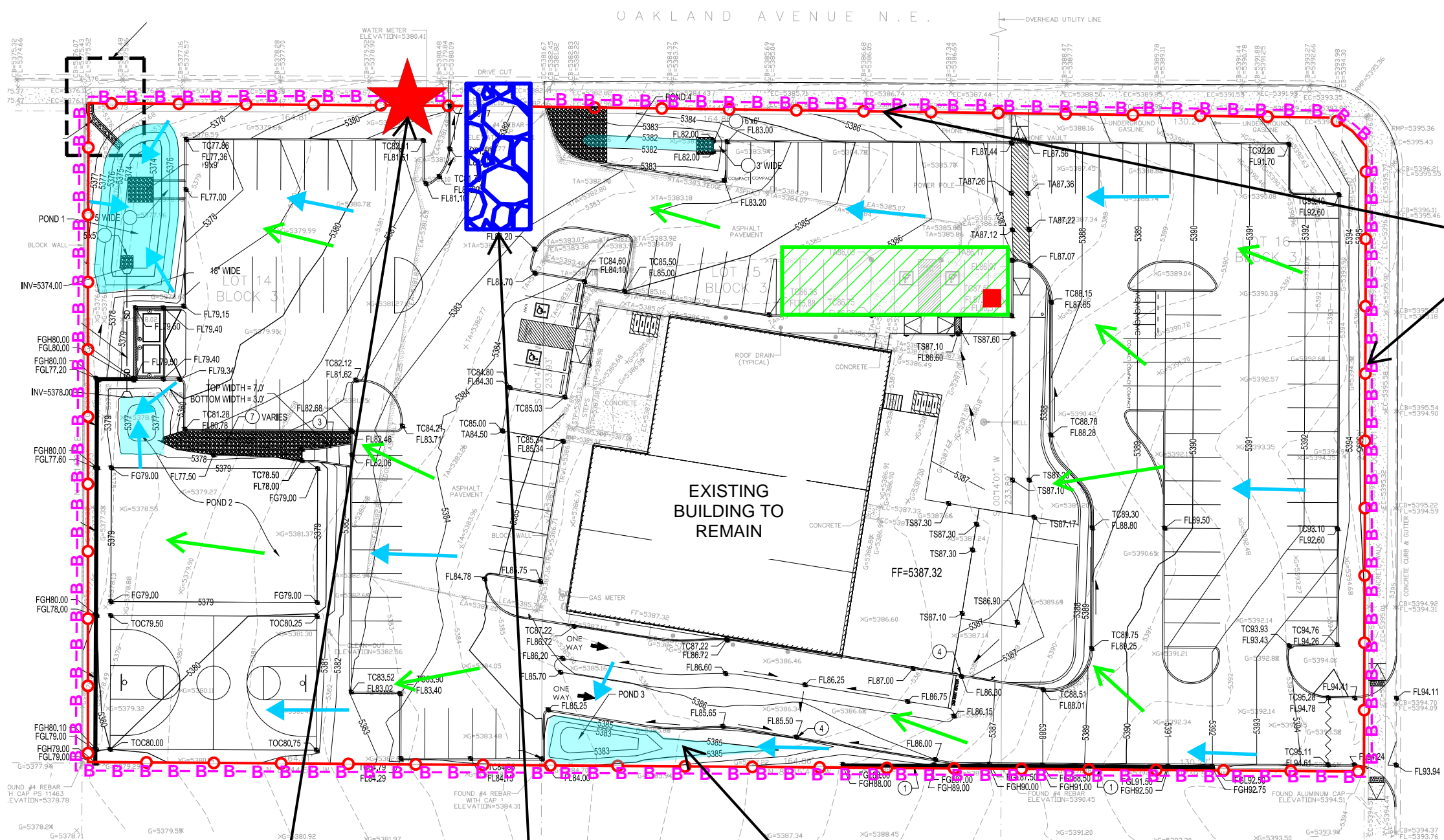

NPDES PERMITTING

IMPLEMENTATION	
BMP INSTALL	BMP REMOVE

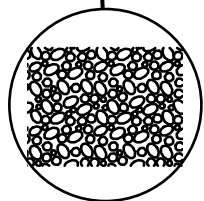

STABILIZED CONSTRUCTION
ENTRANCE

IMPLEMENTATION	
BMP INSTALL	BMP REMOVE

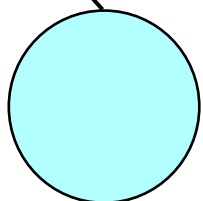

SEDIMENT POND

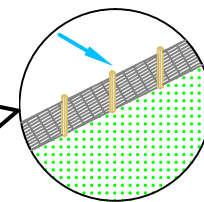

SILT FENCE

IMPLEMENTATION	
BMP INSTALL	BMP REMOV

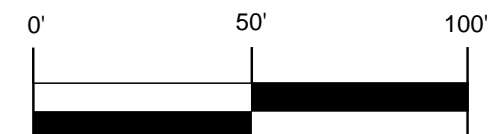

- SWPPP
- Stormwater
- Erosion Control
- Reclamation
- Seeding

www.e2rc.com | 505.867.4040

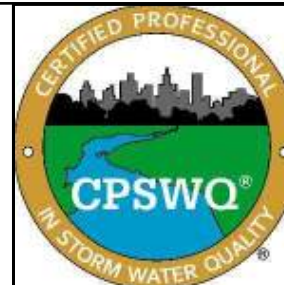

#	REVISION ITEM	DATE

FRANKLIN'S EARTHMOVING, INC.
CITIZEN CHURCH NORTH
TESCP

DESIGNED BY:
K. FETTER, P.E.
DRAWN BY:
S. FETTER

SHEET:

8

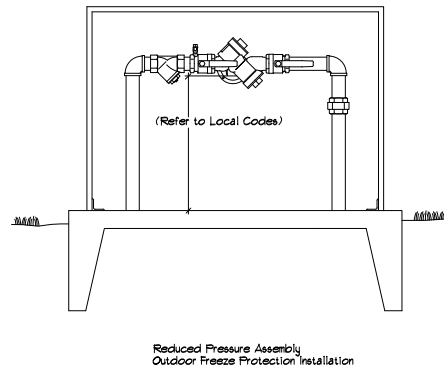

RPA, HOTBOX TYP.

N.T.S.

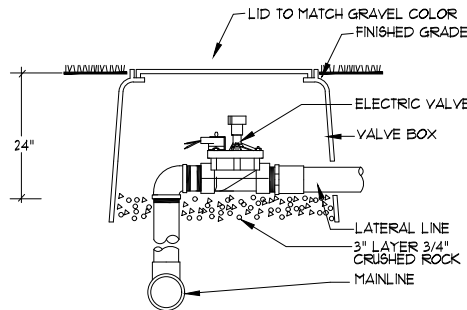

ELECTRIC VALVE ASSEMBLY

Install Y filter and Pressure Regulator for all drip valves.

N.T.S.

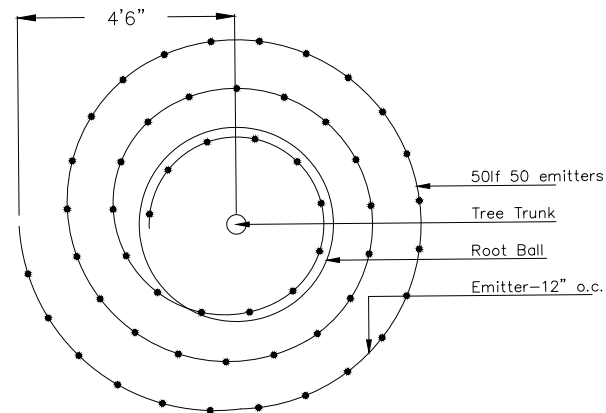

NETAFIM DETAIL

Netafim Spiral Detail

50lf 50 emitters, +/-1gpm per tree

N.T.S.

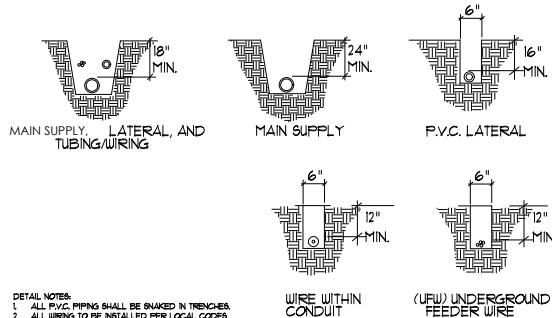

- DETAIL NOTES:
1. ALL P.V.C. PIPING SHALL BE BUNKED IN TRENCHES.
 2. ALL WIRING TO BE INSTALLED PER LOCAL CODES.
 3. ALL WIRING TO BE BUNDLED AND TAPED AT 10' INTERVALS.
 4. ALL MAIN SUPPLY LINES TO BE INSTALLED AS PER MANUFACTURER'S SPECIFICATIONS.
 5. PROVIDE PIPE AND WIRE SLEEVING UNDER ALL PAVED SURFACES.
 6. WIRE SHALL BE WITHIN SEPARATE 2" ELECTRICAL CHASE.

TRENCHING DETAIL

N.T.S.

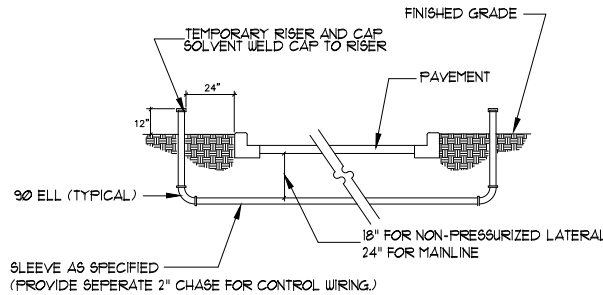

SLEEVE INSTALLATION DETAIL

N.T.S.

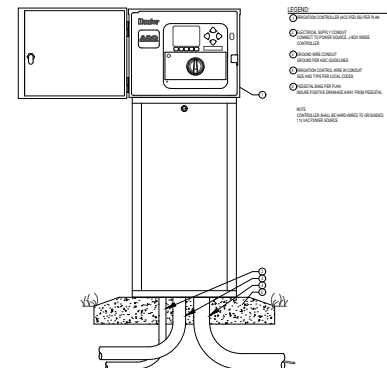

ACC - PEDESTAL MOUNT STAINLESS STEEL

C.ACC.05

NOT TO SCALE

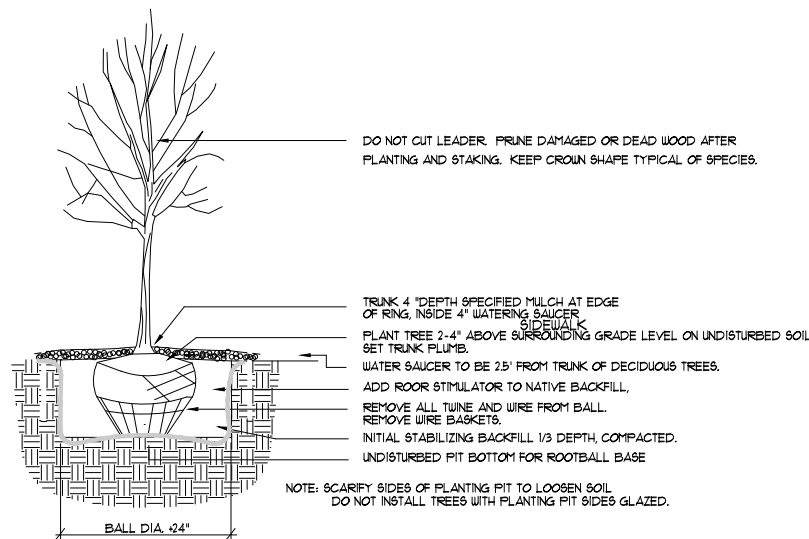

TREE PLANTING DETAIL

N.T.S.

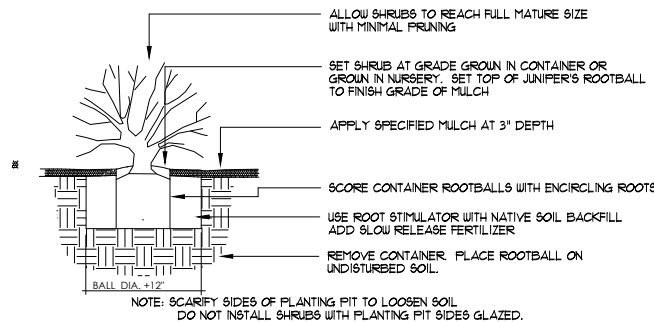

SHRUB PLANTING DETAIL

N.T.S.

LANDSCAPE DETAILS

CITIZEN CHURCH NORTH
Landscape Plan
7518 OAKLAND AVE
ALBUQUERQUE, NM 87113
PROJECT #2209

REVISION	DATE
1	10-24-2022
2	10-24-2022
3	10-24-2022
4	10-24-2022
5	10-24-2022
6	10-24-2022
7	10-24-2022
8	10-24-2022
9	10-24-2022
10	10-24-2022
11	10-24-2022
12	10-24-2022
13	10-24-2022
14	10-24-2022
15	10-24-2022
16	10-24-2022
17	10-24-2022
18	10-24-2022
19	10-24-2022
20	10-24-2022
21	10-24-2022
22	10-24-2022
23	10-24-2022
24	10-24-2022
25	10-24-2022
26	10-24-2022
27	10-24-2022
28	10-24-2022
29	10-24-2022
30	10-24-2022
31	10-24-2022
32	10-24-2022
33	10-24-2022
34	10-24-2022
35	10-24-2022
36	10-24-2022
37	10-24-2022
38	10-24-2022
39	10-24-2022
40	10-24-2022
41	10-24-2022
42	10-24-2022
43	10-24-2022
44	10-24-2022
45	10-24-2022
46	10-24-2022
47	10-24-2022
48	10-24-2022
49	10-24-2022
50	10-24-2022
51	10-24-2022
52	10-24-2022
53	10-24-2022
54	10-24-2022
55	10-24-2022
56	10-24-2022
57	10-24-2022
58	10-24-2022
59	10-24-2022
60	10-24-2022
61	10-24-2022
62	10-24-2022
63	10-24-2022
64	10-24-2022
65	10-24-2022
66	10-24-2022
67	10-24-2022
68	10-24-2022
69	10-24-2022
70	10-24-2022
71	10-24-2022
72	10-24-2022
73	10-24-2022
74	10-24-2022
75	10-24-2022
76	10-24-2022
77	10-24-2022
78	10-24-2022
79	10-24-2022
80	10-24-2022
81	10-24-2022
82	10-24-2022
83	10-24-2022
84	10-24-2022
85	10-24-2022
86	10-24-2022
87	10-24-2022
88	10-24-2022
89	10-24-2022
90	10-24-2022
91	10-24-2022
92	10-24-2022
93	10-24-2022
94	10-24-2022
95	10-24-2022
96	10-24-2022
97	10-24-2022
98	10-24-2022
99	10-24-2022
100	10-24-2022