

LEGAL DESCRIPTION

LOTS 19-20, BLOCK 5, TRACT 1, UNIT 3, NORTH ALBUQUERQUE ACRES

NOTES

1. ALL ELEVATIONS ARE FLOW LINE UNLESS OTHERWISE NOTED
2. TBM SAS MANHOLE AS SHOWN

LEGEND

- × 5376.90 EXISTING SPOT ELEVATION
- × 5376.90 PROPOSED SPOT ELEVATION
- EXISTING SAS MANHOLE
- EXISTING METER
- EXISTING VALVE W/BOX
- EXISTING FIRE HYDRANT
- EXISTING AIR RELEASE VALVE
- EXISTING REDUCER
- EX. 8" SAS --- EXISTING SANITARY SEWER LINE
- EX. 16" WL --- EXISTING WATER LINE
- EX. C&G --- EXISTING CURB & GUTTER
- EX. CONTOUR --- EXISTING CONTOUR (MAJOR)
- EX. CONTOUR --- EXISTING CONTOUR (MINOR)
- BOUNDARY LINE
- EASEMENT
- LIMITS OF TOP OF EXISTING SLOPE
- PROPOSED SIDEWALK
- PROPOSED FLOW DIRECTION
- PROPOSED FINISHED PAD

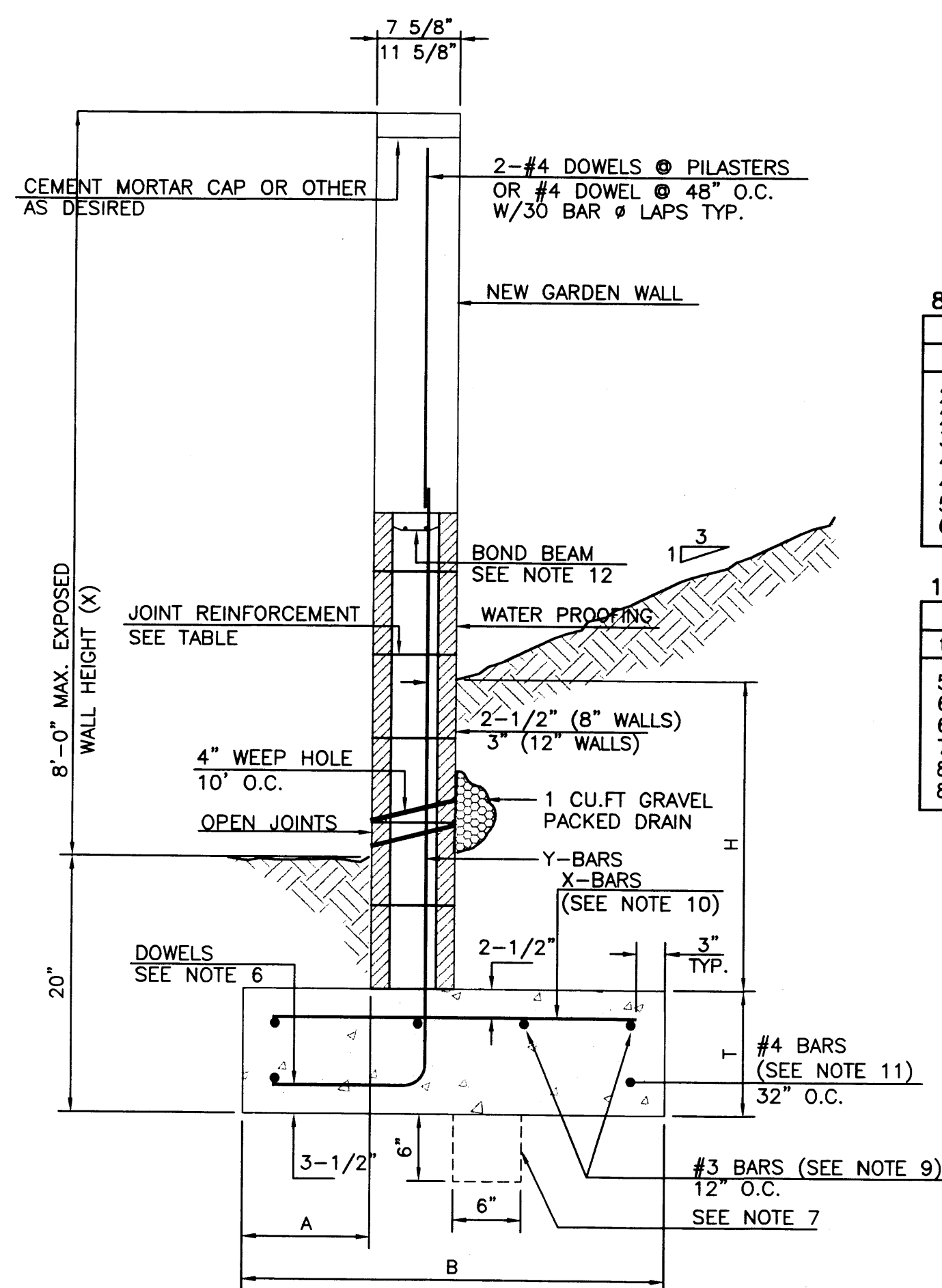

8 INCH REINFORCED CONCRETE MASONRY WALL

H	X	A	B	T	Y-BARS	X-BARS
ft.-in.	ft.-in.	in.	ft.-in.	in.		
2'-0"	1'-1"	8"	2'-4"	9"	#3 @32" O.C.	
2'-8"	1'-9"	8"	2'-9"	9"	#4 @32" O.C.	#3 @27" O.C.
3'-4"	2'-5"	8"	2'-4"	9"	#3 @32" O.C.	#3 @27" O.C.
4'-0"	3'-1"	10"	2'-9"	9"	#4 @32" O.C.	#3 @27" O.C.
4'-8"	3'-10"	12"	3'-4"	10"	#5 @32" O.C.	#3 @27" O.C.
5'-4"	4'-6"	14"	3'-8"	10"	#6 @16" O.C.	#4 @30" O.C.
6'-0"	5'-3"	16"	4'-2"	12"	#6 @24" O.C.	#4 @25" O.C.

12 INCH REINFORCED CONCRETE MASONRY WALL

H	X	A	B	T	Y-BARS	X-BARS
ft.-in.	ft.-in.	in.	ft.-in.	in.		
5'-4"	4'-8"	14"	3'-8"	10"	#4 @24" O.C.	#3 @25" O.C.
6'-0"	5'-4"	15"	4'-2"	12"	#4 @16" O.C.	#4 @30" O.C.
6'-8"	6'-0"	16"	4'-6"	12"	#6 @24" O.C.	#4 @22" O.C.
7'-4"	6'-8"	18"	4'-10"	12"	#5 @16" O.C.	#5 @26" O.C.
8'-0"	7'-4"	20"	5'-4"	12"	#7 @24" O.C.	#5 @21" O.C.
8'-8"	8'-0"	20"	5'-8"	12"	#7 @16" O.C.	#5 @21" O.C.

GENERAL NOTES:

1. ALL CONCRETE IS TO BE 4000 PSI @ 28 DAYS.
2. MINIMUM COMPACTION UNDER FOOTINGS IS TO BE 95% PER ASTM. D 1557 FOR A DEPTH OF 12" MOISTURE CONTENT IS TO BE ± 2.0%.
3. BACK FILL AGAINST WALLS IS TO BE HAND-PLACED AND COMPACTED.
4. ALL BARS ARE TO BE GRADE 60, ASTM 615.
5. TRUSS TYPE DWR-O-WALL EVERY OTHER COURSE.
6. DOWELS SHALL BE AT LEAST EQUAL IN SIZE AND SPACING TO V-BARS, SHALL PROJECT A MINIMUM OF 30 BAR DIA. INTO THE FILLED BLOCK CORES, AND SHALL EXTEND TO THE TOE OF THE FOOTING.
7. PROVIDE KEY FOR 8" AND 12" WALLS WHERE H EXCEEDS 6'-0"
8. USE EITHER EXPANSION JOINTS ON 20' CENTERS OR PILASTERS EVERY 12'
9. #3 BARS TO BE USED ON WALLS EXCEEDING 2'-8" HEIGHT
10. X BARS TO BE USED ON WALLS EXCEEDING 2'-8" HEIGHT
11. #4 BARS TO BE USED ON WALLS TALLER THAN 5'-4"
12. BOND BEAM, 1-#4 BARS FOR WALLS UNDER 3'-4", 2-#4 BARS FOR WALLS UNDER 5'-4", 2-#5 BARS FOR WALLS OVER 5'-4".

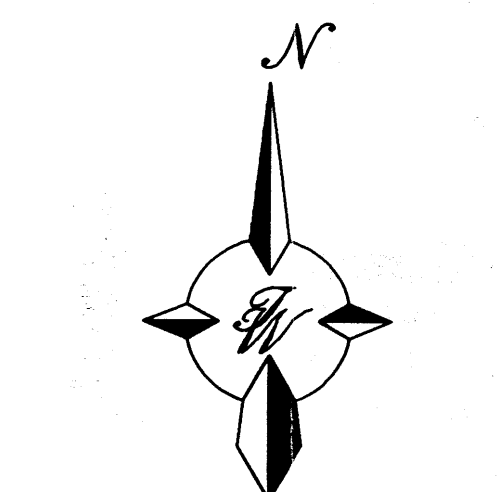

GRAPHIC SCALE

SCALE: 1"=30'

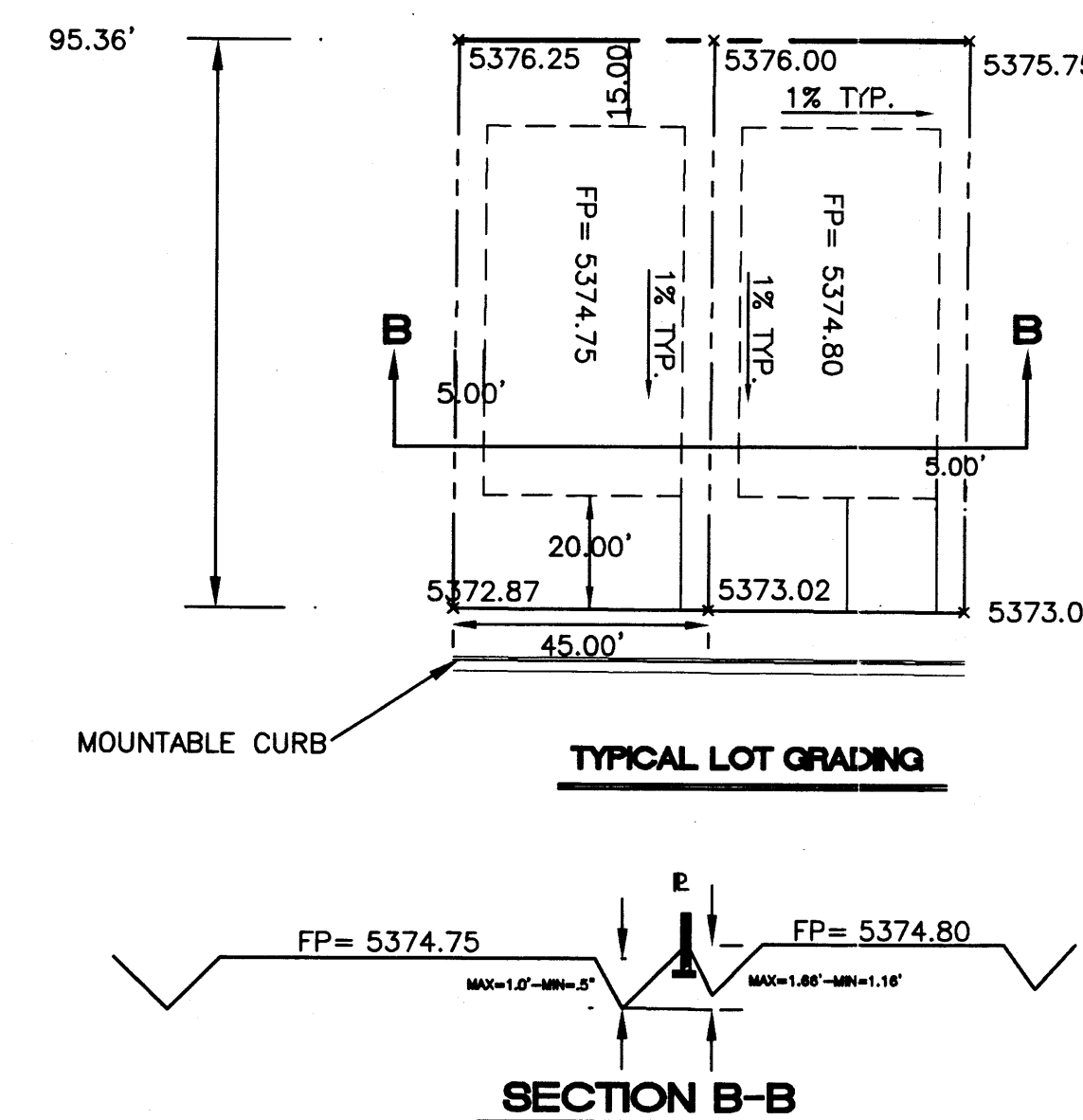

EROSION CONTROL PLAN AND POLLUTION PREVENTION NOTES

1. CONTRACTOR IS RESPONSIBLE FOR OBTAINING A TOPSOIL DISTURBANCE PERMIT PRIOR TO BEGINNING WORK.
2. CONTRACTOR IS RESPONSIBLE FOR CLEANING ALL SEDIMENT OUT OF EXISTING RIGHT-OF-WAY.
3. CONTRACTOR IS RESPONSIBLE FOR MAINTAINING ALL STORM RUN OFF ON SITE.
4. REPAIR OF DAMAGED FACILITIES AND CLEAN-UP OF SEDIMENT ACCUMULATION ON ADJACENT PROPERTIES AND IN PUBLIC FACILITIES IS THE RESPONSIBILITY OF THE CONTRACTOR.
5. ALL EXPOSED EARTH SURFACES MUST BE PROTECTED FROM WIND AND WATER EROSION PRIOR TO FINAL ACCEPTANCE OF ANY PROJECT.

ROUGH GRADING APPROVAL

ENGINEER'S SEAL 	COPPELL SUBDIVISION GRADING AND DRAINAGE PLAN TERRA WEST, LLC 4421 MLEOD ROAD, N.E., SUITE D ALBUQUERQUE, NEW MEXICO 87109 (505)883-7592	DRAWN BY: WCV/J DATE: 11-17-99 9947GR2.DWG
		SHEET # 3 JOB # 990047

C19-D 22

1/2

