

ABBREVIATIONS

A	=	AIR LINE
AD	=	AREA DRAIN
AIP	=	ABANDONED IN PLACE
BLDG	=	BUILDING
BM	=	BENCHMARK
CATV	=	CABLE TELEVISION LINE
CIP	=	CAST IRON PIPE
CMP	=	CORRUGATED METAL PIPE
CMPA	=	CORRUGATED METAL PIPE ARCH
CO	=	CLEANOUT
COA	=	CITY OF ALBUQUERQUE
CONC	=	CONCRETE
CL	=	CENTERLINE
DIA	=	DIAMETER
DIP	=	DUCTILE IRON PIPE
DTL	=	DETAIL
DWG	=	DRAWING
EG	=	EXISTING GRADE
ELEC.	=	ELECTRIC
ELEV	=	ELEVATION
EX	=	EXISTING
FF	=	FINISHED FLOOR ELEVATION
FG	=	FINISHED GRADE
FH	=	FIRE HYDRANT
FL	=	FLOW LINE
G	=	GAS PIPE
GM	=	GAS METER
GV	=	GATE VALVE
HI PT	=	HIGH POINT
INV	=	INVERT ELEVATION
LF	=	LINEAL FEET
LP	=	LIGHT POLE
L/S	=	LANDSCAPING
MH	=	MANHOLE
NG	=	NATURAL GROUND
OE	=	OVERHEAD ELECTRIC LINE
OT	=	OVERHEAD TELEPHONE LINE
PB	=	ELECTRICAL PULL BOX
PCC	=	PORTLAND CEMENT CONCRETE
PP	=	POWER POLE
PROP	=	PROPOSED
PVC	=	POLYVINYL CHLORIDE PIPE
RCP	=	REINFORCED CONCRETE PIPE
R/W	=	RIGHT-OF-WAY
S	=	SLOPE
SAS	=	SANITARY SEWER
SD	=	STORM DRAIN
STA	=	STATION
STD	=	STANDARD
SW	=	SIDEWALK
T	=	TELEPHONE
TA	=	TOP OF ASPHALT PAVEMENT
TAC	=	TOP OF ASPHALT CURB
TC	=	TOP OF CONCRETE SLAB (PAVEMENT)
TCC	=	TOP OF CONCRETE CURB
TS	=	TOP OF SIDEWALK
TW	=	TOP OF WALL
TYP	=	TYPICAL
UE	=	UNDERGROUND ELECTRIC
UT	=	UNDERGROUND TELEPHONE
W	=	WATER
WM	=	WATER METER
WV	=	WATER VALVE

# LOT 18, BLOCK 1, TRACT 3, UNIT 3, NAA SUBDIVISION

## CITY OF ALBUQUERQUE, IMPROVEMENTS FOR, GRADING, PAVING, WATER, AND SANITARY SEWER

### INDEX TO DRAWINGS

SHEET NO.	DESCRIPTION
1	COVER SHEET AND INDEX TO DRAWINGS
2	PLAT OF GEOMETRY
3	GRADING, DRAINAGE, AND PAVING PLAN

#### LEGEND

	FG 38.50	PROPOSED SPOT ELEVATION
		WIRE FENCE
		EXISTING CONCRETE BLOCK WALL
		NEW CONCRETE BLOCK WALL
		BURIED UTILITY CABLE
		OVERHEAD ELECTRIC LINE
		EXISTING CONTOURS AT 5 FT. INTERVALS
		EXISTING CONTOURS AT 1 FT. INTERVALS
		FINISHED GRADE CONTOURS AT 1 FT. INTERVALS
		FINISHED GRADE CONTOURS AT 5 FT. INTERVALS
		GRADE BREAK/SWALE
		EXISTING DRAINAGE BASIN BOUNDARY
		PROPOSED DRAINAGE BASIN BOUNDARY
		PROPOSED STND C&G (DWG 2415A)
		PROPOSED STND C&G (PROJ. 1003703)
		PROPOSED PERMANENT PAVEMENT

#### GENERAL NOTES

1. ALL WORK DETAILED ON THESE PLANS TO BE PERFORMED, EXCEPT AS OTHERWISE STATED OR PROVIDED HEREON, SHALL BE CONSTRUCTED IN ACCORDANCE WITH CITY OF ALBUQUERQUE STANDARD SPECIFICATIONS FOR PUBLIC WORKS CONSTRUCTION, 1986 EDITION THROUGH MOST RECENT UPDATE (UPDATE #7) AND WILL BE REFERRED TO HEREIN AS "STANDARD SPECIFICATIONS".
2. ALL CONSTRUCTION WITHIN CITY RIGHT-OF-WAY OR EASEMENTS MUST BE DONE FROM APPROVED WORK ORDER DOCUMENTS FROM THE CITY.
3. ALL WORK ON THIS PROJECT SHALL BE PERFORMED IN ACCORDANCE WITH APPLICABLE FEDERAL, STATE, AND LOCAL LAWS, ORDINANCES, RULES, AND REGULATIONS CONCERNING CONSTRUCTION SAFETY AND HEALTH.
4. CONTRACTOR AGREES THAT HE SHALL ASSUME THE SOLE AND COMPLETE RESPONSIBILITY FOR THE JOB SITE CONDITIONS DURING THE COURSE OF CONSTRUCTION OF THIS PROJECT, INCLUDING SAFETY OF ALL PERSONS AND PROPERTY. THIS REQUIREMENT SHALL APPLY CONTINUOUSLY AND NOT BE LIMITED TO NORMAL WORKING HOURS. CONTRACTOR SHALL DEFEND, INDEMNIFY, AND HOLD HARMLESS THE OWNER AND ENGINEER FROM ANY AND ALL LIABILITY REAL OR ALLEGED, IN CONNECTION WITH THE PERFORMANCE OF WORK ON THIS PROJECT, EXCEPT LIABILITY ARISING FROM THE SOLE NEGLIGENCE OF THE OWNER OR ENGINEER.
5. ALL EXCAVATION, TRENCHING, AND SHORING ACTIVITIES MUST BE ACCOMPLISHED IN ACCORDANCE WITH OSHA 29CFR 1926.650 SUBPART P.
6. AN EXCAVATION/CONSTRUCTION PERMIT WILL BE REQUIRED BEFORE BEGINNING ANY WORK WITHIN CITY RIGHT-OF-WAY.
7. CONTRACTOR SHALL SECURE A "TOPSOIL DISTURBANCE PERMIT" PRIOR TO BEGINNING CONSTRUCTION (IF REQUIRED BY CITY OF ALBUQUERQUE PUBLIC WORKS).
8. PERMIT REQUESTS MAY BE DENIED OR DELAYED DUE TO CONFLICTS WITH OTHER PROJECTS IN THE AREA.
9. CONTRACTOR SHALL NOTIFY THE ENGINEER NOT LESS THAN SEVEN (7) DAYS PRIOR TO STARTING WORK IN ORDER THAT THE CITY SURVEYOR MAY TAKE NECESSARY MEASURES TO INSURE THE PRESERVATION OF SURVEY MONUMENTS. CONTRACTOR SHALL NOT DISTURB PERMANENT SURVEY MONUMENTS WITHOUT THE CONSENT OF THE CITY SURVEYOR AND SHALL NOTIFY THE CITY SURVEYOR AND BEAR THE EXPENSE OF REPLACING ANY THAT MAY BE DISTURBED WITHOUT PERMISSION. ONLY THE CITY SURVEYOR SHALL REPLACE SURVEY MONUMENTS. WHEN A CHANGE IS MADE IN THE FINISHED ELEVATIONS OF THE PAVEMENT OF ANY ROADWAY IN WHICH A PERMANENT SURVEY MONUMENT IS LOCATED, CONTRACTOR SHALL, AT HIS OWN EXPENSE, ADJUST THE MONUMENT COVER TO THE NEW GRADE UNLESS OTHERWISE SPECIFIED. REFER TO STANDARD SPECIFICATIONS SECTION 4.4.
10. CONTRACTOR SHALL COORDINATE WITH WATER SYSTEMS DIVISION (857-8200) SEVEN (7) WORKING DAYS PRIOR TO ANY WORK THAT MAY AFFECT EXISTING CITY PUBLIC WATER OR SEWER UTILITIES. CONTRACTOR SHALL BE RESPONSIBLE FOR TIMING AND COORDINATION OF WATER SHUTOFF. EXISTING CITY VALVES TO BE OPERATED BY CITY PERSONNEL ONLY.
11. FIVE (5) WORKING DAYS PRIOR TO BEGINNING CONSTRUCTION, CONTRACTOR SHALL SUBMIT TO CONSTRUCTION COORDINATION DIVISION A DETAILED CONSTRUCTION SCHEDULE. TWO (2) WORKING DAYS PRIOR TO CONSTRUCTION, CONTRACTOR SHALL OBTAIN A BARRICADING PERMIT FROM THE CONSTRUCTION COORDINATION DIVISION. CONTRACTOR SHALL NOTIFY BARRICADE ENGINEER (924-3400) PRIOR TO OCCUPYING AN INTERSECTION. REFER TO SECTION 19 OF STANDARD SPECIFICATIONS.
12. CONTRACTOR SHALL DETERMINE IN ADVANCE OF HIS CONSTRUCTION IF OVERHEAD UTILITY LINES, SUPPORT STRUCTURES, POLES, GUYS, ETC. ARE AN OBSTRUCTION TO CONSTRUCTION OPERATIONS. IF ANY OBSTRUCTION TO CONSTRUCTION OPERATIONS IS EVIDENT, CONTRACTOR SHALL BE RESPONSIBLE FOR COORDINATING WITH THE APPROPRIATE UTILITY OWNER TO REMOVE OR SUPPORT THE UTILITY OBSTRUCTION. ANY COST ASSOCIATED WITH THIS EFFORT SHALL BE THE RESPONSIBILITY OF CONTRACTOR.
13. PNM WILL PROVIDE AT NO COST TO THE CITY OR THE CONTRACTOR THE REQUIRED PERSONNEL FOR INSPECTION OR OBSERVATION DEEMED NECESSARY BY PNM WHILE THE CONTRACTOR IS EXPOSING PNM'S CABLES. HOWEVER, THE CONTRACTOR SHALL BE CHARGED THE TOTAL COST ASSOCIATED WITH REPAIRS TO ANY DAMAGED CABLES OR FOR ANY COST ASSOCIATED WITH SUPPORTING OR RELOCATING THE POLES AND CABLES DURING CONSTRUCTION.
14. TWO (2) WORKING DAYS PRIOR TO ANY EXCAVATION, CONTRACTOR MUST CONTACT NEW MEXICO ONE CALL SYSTEM (260-1990) FOR LOCATION OF EXISTING UTILITIES.
15. PRIOR TO CONSTRUCTION, CONTRACTOR SHALL EXCAVATE AND VERIFY THE HORIZONTAL AND VERTICAL LOCATIONS OF ALL PERTINENT EXISTING UTILITIES AND/OR OBSTRUCTIONS. SHOULD A CONFLICT EXIST, THE CONTRACTOR SHALL NOTIFY THE ENGINEER SO THE CONFLICT CAN BE RESOLVED WITH A MINIMUM AMOUNT OF DELAY.
16. EXISTING UTILITY LINE LOCATION ARE SHOWN IN AN APPROXIMATE MANNER ONLY AND SUCH LINES MAY EXIST WHERE NONE ARE SHOWN. THE LOCATION OF ANY SUCH EXISTING LINES IS BASED UPON INFORMATION PROVIDED BY THE UTILITY COMPANY, THE OWNER, OR BY OTHERS, AND THE INFORMATION MAY BE INCOMPLETE OR MAY BE OBSOLETE BY THE TIME CONSTRUCTION COMMENCES.
17. THE ENGINEER HAS UNDERTAKEN NO FIELD VERIFICATION OF THE LOCATION, DEPTH, SIZE, OR TYPE OF EXISTING UNDERGROUND UTILITY LINES, MAKES NO REPRESENTATION PERTAINING THERETO, AND ASSUMES NO RESPONSIBILITY OR LIABILITY THEREFOR. CONTRACTOR SHALL INFORM ITSELF OF THE LOCATION OF ANY UTILITY LINE IN OR NEAR THE AREA OF THE WORK IN ADVANCE OF AND DURING EXCAVATION WORK. CONTRACTOR IS FULLY RESPONSIBLE FOR ANY AND ALL DAMAGE CAUSED BY ITS FAILURE TO LOCATE, IDENTIFY, AND PRESERVE ANY AND ALL EXISTING UTILITIES.
18. CONTRACTOR SHALL SUPPORT ALL EXISTING UNDERGROUND UTILITY LINES WHICH BECOME EXPOSED DURING CONSTRUCTION. PAYMENT FOR SUPPORTING WORK SHALL BE INCIDENTAL TO WATERLINE AND/OR SEWER LINE COSTS.

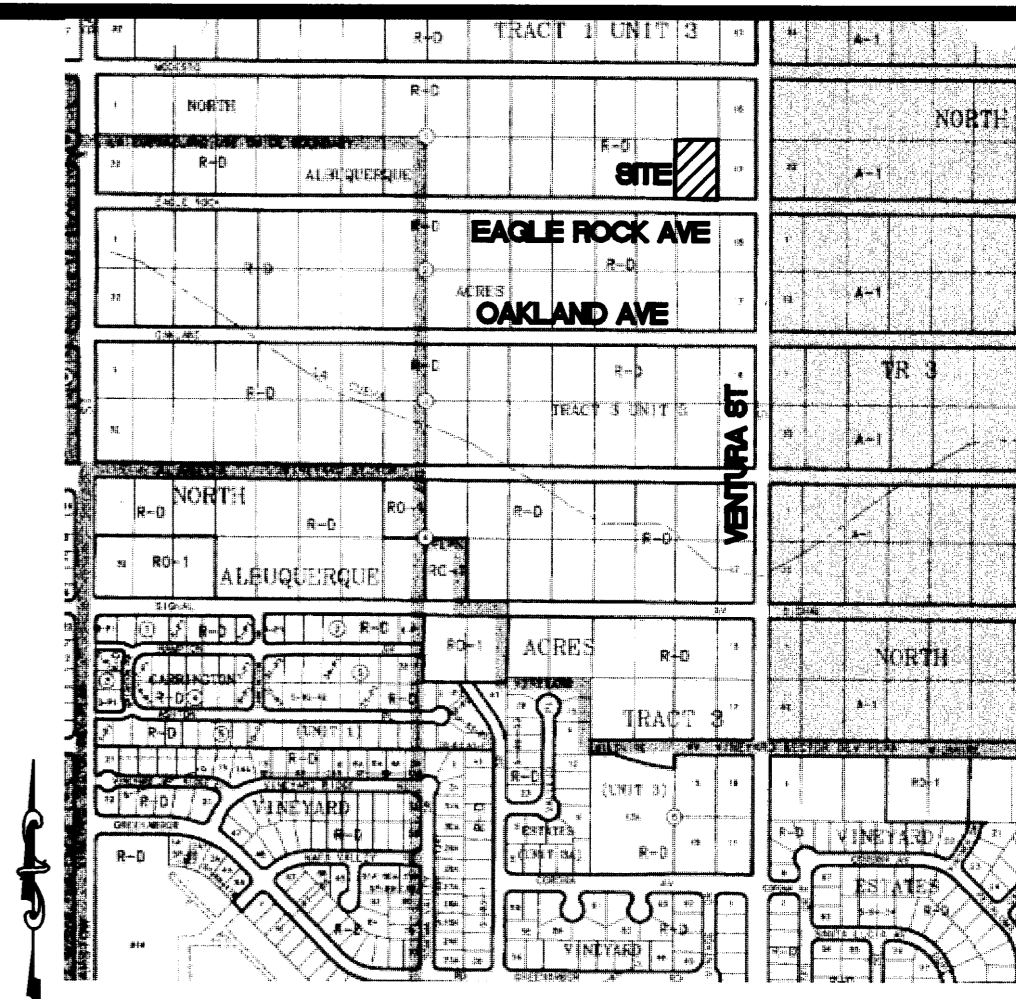

VICINITY MAP

ZONE ATLAS  
C-20

19. CONTRACTOR IS TO SUPPORT AND MAINTAIN THE INTEGRITY OF ALL UNDERGROUND TELEPHONE, ELECTRIC CABLES AND CABLE TELEVISION UTILITIES AT NO ADDITIONAL COST TO THE OWNER. CABLE IS TO BE SUPPORTED AT A MAXIMUM OF EVERY FIFTEEN (15) FEET. CONTRACTOR SHALL COORDINATE WITH AND MAKE NECESSARY PAYMENT (IF ANY) TO UTILITY OWNER FOR DE-ENERGIZATION OF CABLES OR SUPPORT OF CABLES BY THE UTILITY OWNER.
20. CONTRACTOR SHALL ASSIST THE ENGINEER/INSPECTOR IN THE RECORDING OF DATA ON ALL UTILITY LINES AND ACCESSORIES AS REQUIRED BY THE CITY OF ALBUQUERQUE FOR THE PREPARATION OF "AS CONSTRUCTED" DRAWINGS. CONTRACTOR SHALL NOT COVER UTILITY LINES AND ACCESSORIES UNTIL ALL DATA HAS BEEN RECORDED.
21. ALL UTILITIES AND UTILITY SERVICE LINES SHALL BE INSTALLED PRIOR TO PAVING.
22. ALL FINAL BACKFILL FOR TRENCHES SHALL BE COMPACTED TO A MINIMUM OF 90% MAXIMUM DENSITY PER ASTM D-1557 AND AS DIRECTED BY STANDARD SPECIFICATIONS SECTION 701.14.2 AND STANDARD DRAWING NUMBER 2315.
23. CONTRACTOR SHALL PROMPTLY CLEAN UP ANY MATERIAL EXCAVATED WITHIN THE PUBLIC RIGHT-OF-WAY OR PRIVATE ROADWAY EASEMENTS SO THAT THE EXCAVATED MATERIAL IS NOT SUSCEPTIBLE TO BEING WASHED DOWN THE STREET OR INTO ANY PUBLIC DRAINAGE FACILITY.
24. REMOVALS SHALL BE DISPOSED OF OFF-SITE AND SHALL BE THE RESPONSIBILITY OF THE CONTRACTOR.
25. CONTRACTOR SHALL DISPOSE OF ALL UNSUITABLE MATERIAL IN AN ENVIRONMENTALLY ACCEPTABLE MANNER AT A LOCATION ACCEPTABLE TO THE PROJECT MANAGER. THERE WILL BE NO DIRECT COMPENSATION FOR THIS WORK.
26. CONTRACTOR SHALL CONDUCT HIS OPERATIONS IN A MANNER WHICH WILL MINIMIZE INTERFERENCE WITH LOCAL TRAFFIC.
27. ANY WORK AFFECTING AN ARTERIAL ROADWAY REQUIRES TWENTY-FOUR (24) HOURS OF CONSTRUCTION.
28. ALL EXISTING SIGNS, MARKERS, DELINEATORS, ETC., WITHIN THE CONSTRUCTION LIMITS SHALL BE REMOVED, STORED AND RE-SET BY THE CONTRACTOR.
29. WHEN ABUTTING EXISTING PAVEMENT TO NEW, SAW CUT EXISTING PAVEMENT TO A STRAIGHT EDGE AND AT A RIGHT ANGLE, OR AS APPROVED BY THE FIELD ENGINEER. REMOVAL OF BROKEN OR CRACKED PAVEMENT WILL ALSO BE REQUIRED.
30. REMOVAL OF EXISTING CURB AND GUTTER OR SIDEWALK SHALL BE TO THE NEAREST JOINT OR SAW CUT.
31. AT HIS OWN EXPENSE, CONTRACTOR SHALL ASSUME RESPONSIBILITY FOR ANY DAMAGE TO EXISTING PAVEMENT, PAVEMENT MARKINGS, CURB AND GUTTER, HANDICAP RAMPS, AND SIDEWALK DURING CONSTRUCTION APART FROM THOSE SECTIONS INDICATED FOR REMOVAL ON THE PLANS AND SHALL REPAIR OR REPLACE, PER STANDARD SPECIFICATIONS.
32. ALL STREET STRIPING, ALTERED OR DESTROYED, SHALL BE REPLACED WITH PLASTIC REFLECTORIZED PAVEMENT MARKINGS BY CONTRACTOR TO SAME LOCATION AS EXISTING, OR AS INDICATED BY THIS PLAN SET.
33. CONTRACTOR SHALL MAINTAIN A GRAFFITI-FREE WORK SITE. CONTRACTOR SHALL PROMPTLY REMOVE ANY AND ALL GRAFFITI FROM EQUIPMENT, WHETHER PERMANENT OR TEMPORARY.

DRB NO. 1004785

REV.	SHEETS	CITY ENGINEER	DATE	USER DEPT.	DATE	USER DEPT.	DATE
ENGINEER'S SEAL		APPROVALS	ENGINEER	DATE	APPROVED FOR CONSTRUCTION		
		DRC CHAIRMAN			CITY ENGINEER		DATE
		TRANSPORTATION					
		WATER/WASTEWATER					
		HYDROLOGY					
		PARKS					
		CONSTR. COORD.					
		PROJECT NO.				SHEET 1 OF 2	

BUILDING  
ENGINEERING  
AND  
MUNICIPAL  
DESIGNS



855 POLARIS BLVD., SE  
RIO RANCHO, NM 87124  
PHONE (505) 896-0391  
FAX (505) 994-3952  
beamdesigns@qwest.net

