

TRACT B:
TEMPORARY STORM WATER QUALITY POND

Proposed Impervious Area (SF)	6074
Storm Water Quality retention depth (inches):	0.44
Required Storm Water Quality Volume (CF):	223

Proposed Storm Water Quality Retention Capacity:

Temporary Retention Pond	
Depth (FT):	0.65
Bottom (SF)	291
Top (SF)	394
Volume (CF)	223

TRACT C:

POND 1 AND 2

Proposed Impervious Area (SF)	17101
Storm Water Quality retention depth (inches):	0.44
Required Storm Water Quality Volume (CF):	627

POND 1	
Depth (FT):	0.16
Bottom (SF)	24
Top (SF)	121
Volume (CF)	12

POND 2	
Depth (FT):	0.83
Bottom (SF)	476
Top (SF)	1,018
Volume (CF)	620

SILT FENCE SHALL BE PLACED BEHIND CURBING ARE ATTACHED TO TEMPORARY CONSTRUCTION FENCE. STAGING ARE IS REPRESENTATIVE AND MAY BE MOVED TO ACCOMMODATE PROJECT

STORM WATER QUALITY:

RECENT STORM WATER QUALITY REQUIREMENTS OF THE CITY OF ALBUQUERQUE INCLUDE CAPTURE OF 0.44 INCHES OF RAINFALL OVER IMPERVIOUS SURFACES.

THE PROPOSED DESIGN CAPTURES AMPLE WATER QUALITY STORAGE VOLUME AT THE LOW ELEVATIONS OF THE PROPOSED GRADE DESIGN. THE REQUIRED STORM WATER QUALITY VOLUME IS FULLY CAPTURED WITHIN THE TEMPORARY TRACT B STORM WATER QUALITY POND AND THE TWO TRACT C STORM WATER QUALITY PONDS.

FRENCH DRAINS ARE FEATURES OF THE DESIGN TO HASTEN INFILTRATION WITHIN THE PONDS WHEN RUNOFF IS CAPTURED FROM STORM EVENTS.

TRACT C STORM WATER QUALITY PONDS ARE TO BE PERMANENT WITH THIS DEVELOPMENT AND TRACT B STORM WATER QUALITY POND IS TEMPORARY. THE CONTRIBUTING BASIN OF IMPERVIOUS AREA TO TRACT B TEMPORARY STORM WATER QUALITY POND IS OVER PORTIONS OF BOTH TRACT B AND TRACT C.

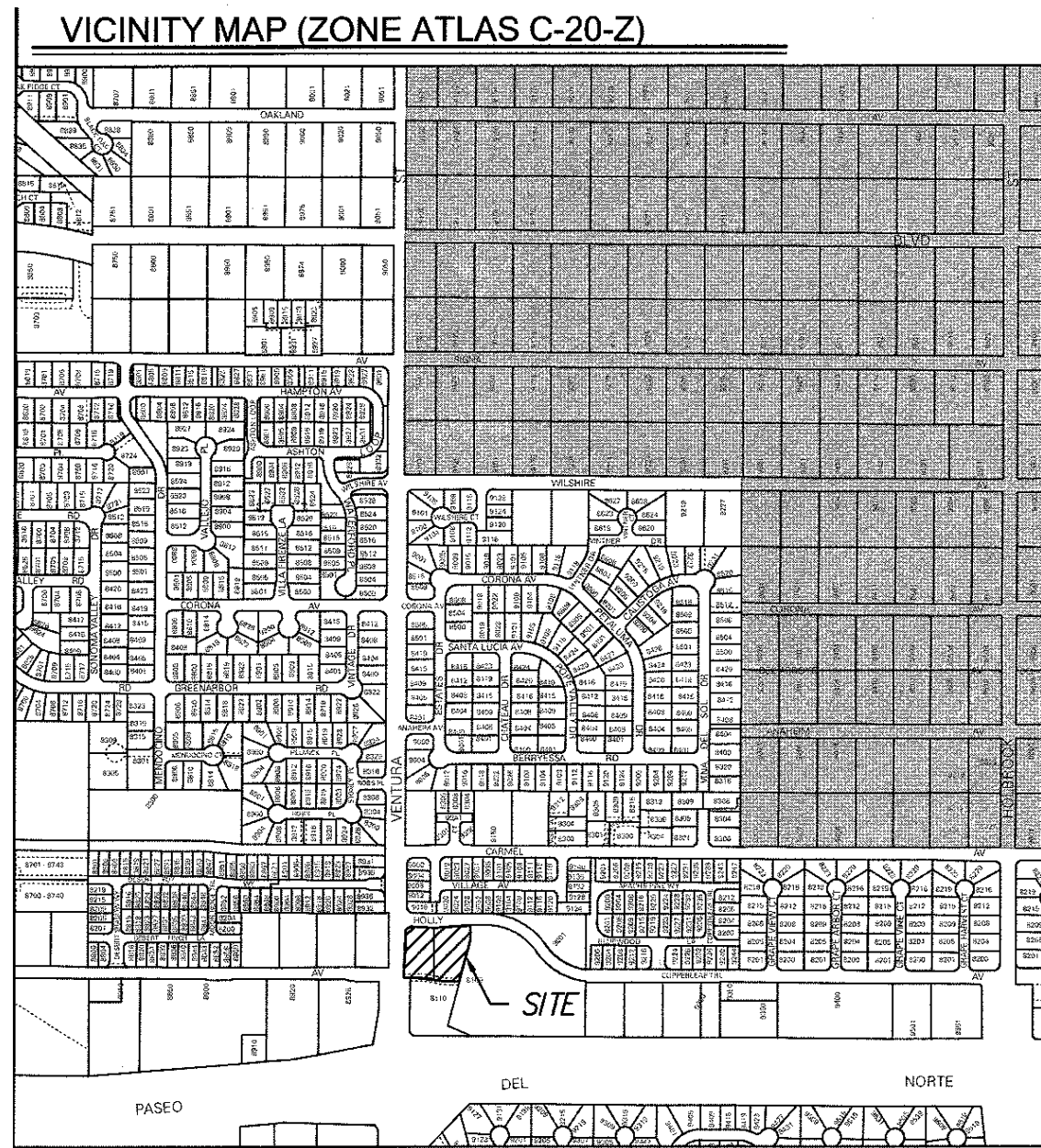

LEGEND

TEMPORARY EROSION AND SEDIMENT CONTROL PLAN

- PB -PB -PB -PB PROJECT PERIMETER & DISTURBED AREA
- SF - SF - SF SILT FENCE
- MULCH SOCKS
- FLOW DIRECTION
- STAGING AREA
- STABILIZED CONSTRUCTION ENTRANCE
- TRASH RECEPTACLE
- CHEMICAL TOILET
- CONCRETE WASHOUT
- RETENTION POND
- RIP RAP
- CHECK DAM
- DROP INLET PROTECTION
- OUTFALL
- POSTING SIGN
- PRESERVED VEGETATION

RECEIVING WATERS: **RIO GRANDE VIA ALBUQUERQUE MS4; TIER II AND IMPAIRED WITH E. COLI, PCBs, AND DISSOLVED OXYGEN**

CRITICAL HABITAT: **CRITERION "A"; NO CRITICAL HABITATS WITHIN THE PROJECT AREA**

GPS LOCATION: **35.1759, -106.5416**

FANNING ORTHODONTICS/SWIMLABS

PROJECT TITLE

ALBUQUERQUE, BERNALILLO COUNTY, NM

CITY, COUNTY, STATE

01/13/2020

DATE

C. DURKIN

DRAWN BY

INSPECTIONS PLUS



01/13/2020
CPESC Stamp

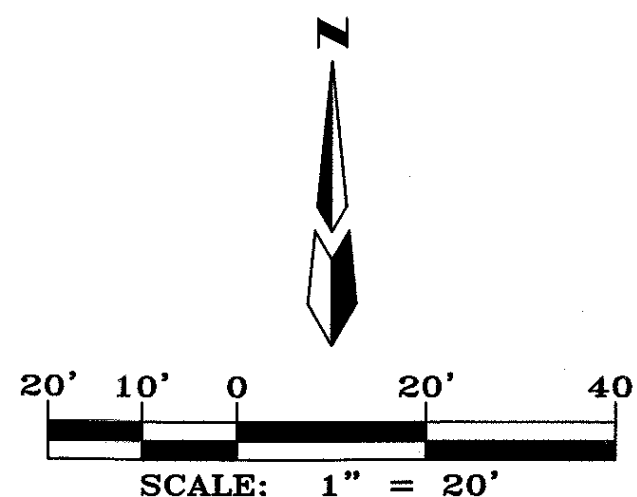

INLET PROTECTION

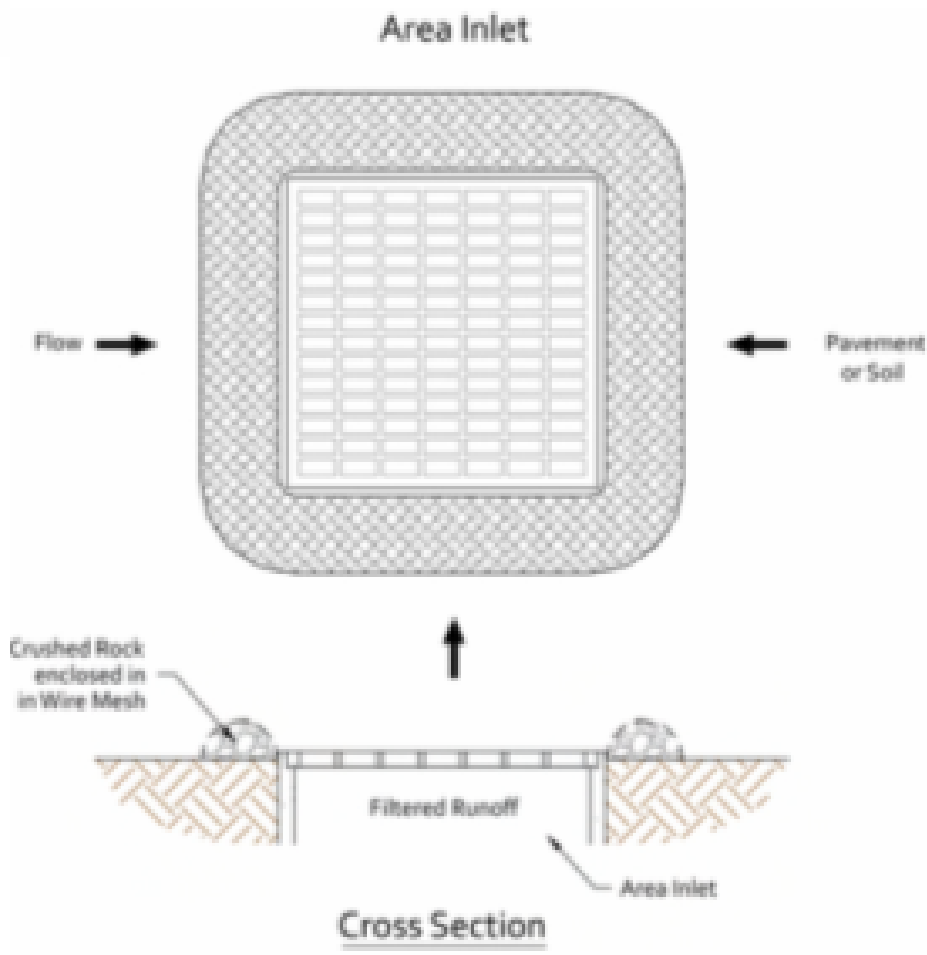

BMP Objectives

- Sediment Control
- Sheet Flow Runoff Control

SILT FENCE



BMP Objectives

- Sediment Control
- Sheet Flow Runoff Control
- Wind Erosion Control

SEDIMENT TRACK OUT CONTROL



BMP Objectives

- Sediment Control

MULCH SOCK/STRAW WATTLE



BMP Objectives

- Sediment Control
- Reduce Runoff Velocity
- Inlet Protection

BERMS AND SWALES



BMP Objectives

- Runoff Control
- Run-on Diversion

EROSION CONTOL NOTES

1. All perimeter erosion and sediment control measures shall be installed prior to the execution of any grading work and shall be maintained for the duration of the project. failure to install and maintain erosion controls is a violation of the Federal Permit and is subject to fines.
2. All Erosion Controls and their installation shall meet manufacturer specification and comply with the current guidelines for Stormwater Management for Construction Activities.
3. Sediment collected behind sediment filters and Silt Fences shall be removed when sediment reaches 1/3 the height of the barrier.
4. Inspection of erosion and sediment controls and other protective measures are required once every 7 days from July 1st to October 31st and once every 7 days from November 1st to June 30th for discharge to tier and Sensitive Waters. Storm Events that produce 0.25' or more shall be inspected within 24 hours of the storm event.
5. Erosion and Sediment control measures shall be removed following construction or upon permanent stabilization of the disturbed/graded areas, whichever occurs last.
6. All disturbed areas that are not to be paved shall be reseeded unless otherwise noted.
7. The Contractor shall keep the site clean at all times and control dust resulting from earthwork operations. The Contractor shall not track mud or sediment from the site onto the public streets.

RECEIVING WATERS:	RIO GRANDE VIA ALBUQUERQUE MS4; TIER II AND IMPAIRED WITH E. COLI, PCBs, AND DISSOLVED OXYGEN		
CRITICAL HABITAT:	CRITERION "A"; NO CRITICAL HABITATS WITHIN THE PROJECT AREA		
GPS LOCATION:	35.1759, -106.5416		
FANNING ORTHODONTICS/SWIMLABS			
PROJECT TITLE			
ALBUQUERQUE, BERNALILLO COUNTY, NM			
CITY, COUNTY, STATE			
01/13/2020		DATE	 INSPECTIONS PLUS
C. DURKIN		DRAWN BY	



01/13/2020
CPESC Stamp