

# CITY OF ALBUQUERQUE

*Planning Department*  
Alan Varela, Director



*Mayor Timothy M. Keller*

October 31, 2022

Sheldon Greer, P.E.  
RESPEC  
5971 Jefferson St. NE Suite 101  
Albuquerque, New Mexico 87109

**RE: Lot 16 Block 9 Volcano Cliffs Unit 18 SAD 228  
6520 Canavio Rd. NW  
Grading and Drainage Plan  
Engineers Stamp Date: 5/12/2020 (D10D003I16)  
Pad Certification Date: 9/23/2020  
CO Certification Date: 10/28/2022**

Mr. Greer,

Based on the Certification received on 10/28/2022, the site is acceptable for release of Certificate of Occupancy by Hydrology.

PO Box 1293

If you have any questions, please contact me at 924-3695 or Rudy Rael at 924-3977.

Albuquerque

Sincerely,

NM 87103

Tiequan Chen, P.E.  
Principal Engineer, Hydrology  
Planning Department, Development Review Services

[www.cabq.gov](http://www.cabq.gov)

RR/TC  
File D10D003I16



# City of Albuquerque

Planning Department

Development & Building Services Division

## DRAINAGE AND TRANSPORTATION INFORMATION SHEET (REV 11/2018)

**Project Title:** \_\_\_\_\_ **Building Permit #:** \_\_\_\_\_ **Hydrology File #:** \_\_\_\_\_

**DRB#:** \_\_\_\_\_ **EPC#:** \_\_\_\_\_ **Work Order#:** \_\_\_\_\_

**Legal Description:** \_\_\_\_\_

**City Address:** \_\_\_\_\_

**Applicant:** \_\_\_\_\_ **Contact:** \_\_\_\_\_

**Address:** \_\_\_\_\_

**Phone#:** \_\_\_\_\_ **Fax#:** \_\_\_\_\_ **E-mail:** \_\_\_\_\_

**Owner:** \_\_\_\_\_ **Contact:** \_\_\_\_\_

**Address:** \_\_\_\_\_

**Phone#:** \_\_\_\_\_ **Fax#:** \_\_\_\_\_ **E-mail:** \_\_\_\_\_

**TYPE OF SUBMITTAL:** \_\_\_\_\_ PLAT ( \_\_\_\_\_ # OF LOTS) \_\_\_\_\_ RESIDENCE \_\_\_\_\_ DRB SITE \_\_\_\_\_ ADMIN SITE

**IS THIS A RESUBMITTAL?:** \_\_\_\_\_ Yes \_\_\_\_\_ No

**DEPARTMENT:** \_\_\_\_\_ TRAFFIC/ TRANSPORTATION \_\_\_\_\_ HYDROLOGY/ DRAINAGE

Check all that Apply:

### TYPE OF SUBMITTAL:

- \_\_\_\_\_ ENGINEER/ARCHITECT CERTIFICATION
- \_\_\_\_\_ PAD CERTIFICATION
- \_\_\_\_\_ CONCEPTUAL G & D PLAN
- \_\_\_\_\_ GRADING PLAN
- \_\_\_\_\_ DRAINAGE MASTER PLAN
- \_\_\_\_\_ DRAINAGE REPORT
- \_\_\_\_\_ FLOODPLAIN DEVELOPMENT PERMIT APPLIC
- \_\_\_\_\_ ELEVATION CERTIFICATE
- \_\_\_\_\_ CLOMR/LOMR
- \_\_\_\_\_ TRAFFIC CIRCULATION LAYOUT (TCL)
- \_\_\_\_\_ TRAFFIC IMPACT STUDY (TIS)
- \_\_\_\_\_ OTHER (SPECIFY) \_\_\_\_\_
- \_\_\_\_\_ PRE-DESIGN MEETING?

### TYPE OF APPROVAL/ACCEPTANCE SOUGHT:

- \_\_\_\_\_ BUILDING PERMIT APPROVAL
- \_\_\_\_\_ CERTIFICATE OF OCCUPANCY
- \_\_\_\_\_ PRELIMINARY PLAT APPROVAL
- \_\_\_\_\_ SITE PLAN FOR SUB'D APPROVAL
- \_\_\_\_\_ SITE PLAN FOR BLDG. PERMIT APPROVAL
- \_\_\_\_\_ FINAL PLAT APPROVAL
- \_\_\_\_\_ SIA/ RELEASE OF FINANCIAL GUARANTEE
- \_\_\_\_\_ FOUNDATION PERMIT APPROVAL
- \_\_\_\_\_ GRADING PERMIT APPROVAL
- \_\_\_\_\_ SO-19 APPROVAL
- \_\_\_\_\_ PAVING PERMIT APPROVAL
- \_\_\_\_\_ GRADING/ PAD CERTIFICATION
- \_\_\_\_\_ WORK ORDER APPROVAL
- \_\_\_\_\_ CLOMR/LOMR
- \_\_\_\_\_ FLOODPLAIN DEVELOPMENT PERMIT
- \_\_\_\_\_ OTHER (SPECIFY) \_\_\_\_\_

**DATE SUBMITTED:** \_\_\_\_\_ **By:** \_\_\_\_\_

COA STAFF:

ELECTRONIC SUBMITTAL RECEIVED: \_\_\_\_\_

FEE PAID: \_\_\_\_\_



Project Name: Pulte Lot ID 3  
Project Address: 6520 Canavio Rd  
Pulte Site ID: Lot 3

Site Area	(sq. ft.)	15522
House Area	(sq. ft.)	3500
Driveway Area	(sq. ft.)	400
Other Imp Area	(sq. ft.)	1500
Total Imp. Area:		5400

AREA	% AREA	Q100 (CFS/AC)	Q100 (cfs)	DMP (2)	DMP (4)
A	0	0.0%	1.29	0.0%	0.00
B	5061	32.6%	2.03	10.0%	0.07
C	5061	32.6%	2.87	40.0%	0.41
D	5400	34.8%	4.37	50.0%	0.78
TOTAL	15522	100.00%	1.11		1.26

NOTES: (1) Zone 1 - Table A-9 Albuquerque DPM  
(2) Per Volcano Cliffs Drainage Management Plan  
(3) Total Discharge  
(4) Allowable Discharge

TABLE 2. WATER QUALITY STORM EVENT RUNOFF RATE AND VOLUME AS A PERCENT OF IMPERVIOUS AREA FOR 40-ACRE AND SMALLER SITES

Percent Impervious (%)	Runoff Depth (inches)	Runoff Rate (cfs/ac)	Runoff Volume (cubic)
0	0	0	0
20	0.09	0.5	327
40	0.18	0.8	653
60	0.27	1.2	980
80	0.36	1.35	1037
100	0.46	1.5	1670

Table Interpolation:	Site Area (sq. ft.)	Site Area (ac)	Imp. Area (Sq. ft.)	% Imp
	15522	0.36	5400	34.8%

Runoff Vol. (per ac)	0-20	20-40	40-60	60-80	80-100
	0	568.1	0	0	0

Total Water Quality Volume Required: 568.1  
Provided: 0.0

1.26 inches of runoff from Imp. Area

#### Cut/Fill Summary

Name	Cut Factor	Fill Factor	2d Area	Cut	Fill	Net
VOL FG	1.00	1.00	14460.70 Sq. Ft.	0.06 Cu. Yd.	1687.55 Cu. Yd.	1687.49 Cu. Yd.<Fill>
Totals			14460.70 Sq. Ft.	0.06 Cu. Yd.	1687.55 Cu. Yd.	1687.49 Cu. Yd.<Fill>

## DRAINAGE CERTIFICATION

I, SHELDON GREER P.E., NMPE 17154, OF THE ENGINEERING FIRM RESPEC, HEREBY CERTIFY THAT THIS PROJECT HAS BEEN GRADED AND WILL DRAIN IN SUBSTANTIAL COMPLIANCE WITH AND IN ACCORDANCE WITH THE DESIGN INTENT OF THE APPROVED PLAN DATED 5/12/2020. THE RECORD INFORMATION EDITED ONTO THE ORIGINAL DESIGN DOCUMENT HAS BEEN OBTAINED BY THOMAS W. PATRICK, NMPS 12651, OF THE FIRM COMMUNITY SCIENCE SERVICES. I FURTHER CERTIFY THAT I HAVE PERSONALLY VISITED THE PROJECT SITE ON 10/21/2022 AND HAVE DETERMINED BY VISUAL INSPECTION THAT THE SURVEY DATA PROVIDED IS REPRESENTATIVE OF ACTUAL SITE CONDITIONS AND IS TRUE AND CORRECT TO THE BEST OF MY KNOWLEDGE AND BELIEF. THIS CERTIFICATION IS SUBMITTED IN SUPPORT OF A REQUEST FOR CERTIFICATE OF OCCUPANCY. THE RECORD INFORMATION PRESENTED HEREON IS NOT NECESSARILY COMPLETE AND INTENDED ONLY TO VERIFY SUBSTANTIAL COMPLIANCE OF THE GRADING AND DRAINAGE ASPECTS OF THIS PROJECT. THOSE RELYING ON THIS RECORD DOCUMENT ARE ADVISED TO OBTAIN INDEPENDENT VERIFICATION OF ITS ACCURACY BEFORE USING IT FOR ANY OTHER PURPOSE.

SHELDON E. GREER, PE 17154  
DATE 10/21/2022



#### SWALE 1 PROFILE



### Asbuilt LOT 16, BLOCK 9 VOLCANO CLIFFS UNIT 18

DATE	10/19/22
CREW	PDW
DRAFTING	SLN
GPS	BABT
JN	N143-05

Community Sciences Corporation  
Land Surveying  
(505) 897.0000

DRAIN TO FRONT LOT AREA (sq. ft.)	DRAIN TO REAR LOT AREA (sq. ft.)	Q100 TO FRONT LOT (cfs)	Q100 TO REAR LOT (cfs)
0	0	0.00	0.00
800	4261	0.04	0.20
800	4261	0.05	0.28
600	4800	0.06	0.48
	13322	0.15	0.96

Proposed Conditions: The proposed site improvements will include the construction of a single family residence with landscaping and onsite improvements. In accordance with the SAD 228 drainage management plan for unit 19, the runoff will free discharge allowable discharge.

The allowable discharge was determined by analysis of the basin including the lot. The land use percentages of the basin were apportioned between roadways and lots based on area. The roof, driveway, and an additional 1500 SQ. FT. for structure improvements are included in the impervious area percentage for the lot.

5336.21  
X IN CONC

X IN CONC  
5336.37

5336.28

5336.70

5336.40

5336.78  
X IN CONC

CONSTRUCT ALL SWALES AND EROSION PROTECTION BELOW ADJACENT GRADE TO ENSURE RUNOFF CAN BE CAPTURED AND CONVEYED PROPERLY.

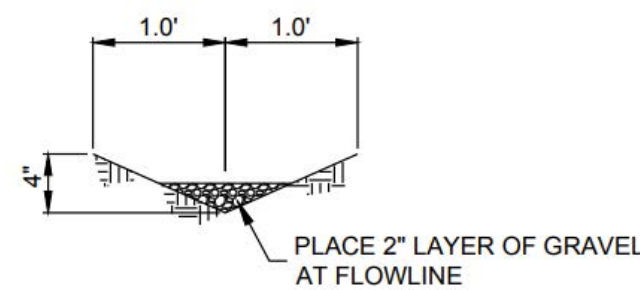

#### SWALE SECTION

#### SWALE 2 PROFILE

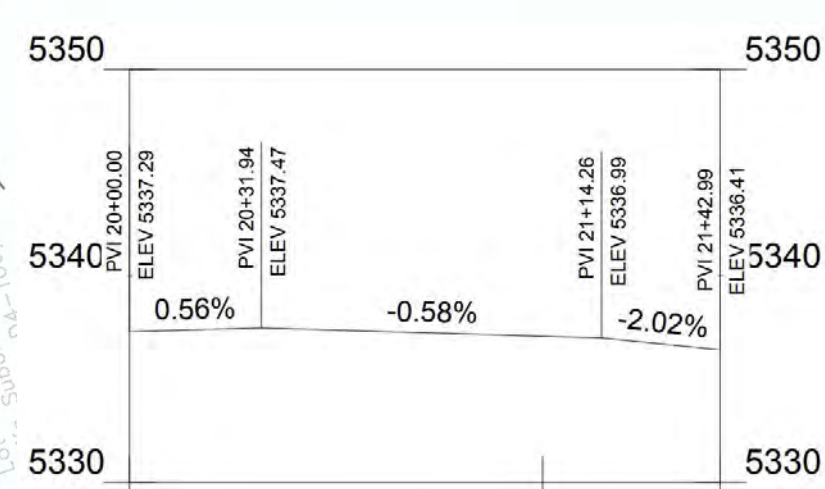

#### GENERAL NOTES:

- ALL WORK DETAILED ON THESE PLANS TO BE PERFORMED UNDER THE CONTRACT SHALL, EXCEPT AS OTHERWISE STATED OR PROVIDED HEREIN, BE CONSTRUCTED IN ACCORDANCE WITH THE CITY OF ALBUQUERQUE STANDARD SPECIFICATIONS FOR PUBLIC WORKS, 1986 EDITION, UPDATE NO. 8 VOL. 1 AND 2 JANUARY 2011.
- THE EROSION PROTECTION SPECIFIED THIS PLAN IS THE MINIMUM RECOMMENDED. THE OWNER IS ENCOURAGED TO INCORPORATE EROSION RESISTANT LANDSCAPING ON AREAS WHERE EROSION MAY OCCUR SUCH AS SLOPES AND SWALES. THE OWNER IS RESPONSIBLE FOR THE INSTALLATION AND MAINTENANCE OF ALL EROSION CONTROL FEATURES NECESSARY TO PRESERVE THE DESIGN INTENT OF THE GRADING PLAN.
- THE DRAINAGE INFRASTRUCTURE SHOWN ON THIS PLAN IS THE RESPONSIBILITY OF THE PROPERTY OWNER.
- ALL DISTURBED AREAS OUTSIDE THE BUILDING PAD MUST BE RESEDED OR LANDSCAPED.
- TWO (2) WORKING DAYS PRIOR TO ANY EXCAVATION, CONTRACTOR MUST CONTACT LINE LOCATING SERVICE, (260-1990) FOR LOCATION OF EXISTING UTILITIES.
- PRIOR TO CONSTRUCTION, THE CONTRACTOR SHALL EXCAVATE AND VERIFY THE HORIZONTAL AND VERTICAL LOCATIONS OF ALL OBSTRUCTIONS AND EXISTING PAVEMENT. SHOULD A CONFLICT EXIST, THE CONTRACTOR SHALL NOTIFY ENGINEER OR SURVEYOR SO THAT THE CONFLICT CAN BE RESOLVED WITH A MINIMUM OF DELAY.

#### NOTE:

THE ENGINEER HAS UNDERTAKEN LIMITED FIELD VERIFICATION OF THE LOCATION, DEPTH, SIZE, OR TYPE OF EXISTING UNDERGROUND UTILITY LINES. MAKES NO REPRESENTATION PERTAINING THERETO AND ASSUMES NO RESPONSIBILITY OR LIABILITY THEREFOR. THE CONTRACTOR SHALL INFORM ITSELF OF THE LOCATION OF ANY UTILITY LINE IN OR NEAR THE ARE OF WORK IN ADVANCE OF AND DURING EXCAVATION WORK. THE CONTRACTOR IS FULLY RESPONSIBLE FOR ANY AND ALL DAMAGE CAUSED BY ITS FAILURE TO LOCATE, IDENTIFY, AND PRESERVE ANY AND ALL EXISTING UTILITIES. THE CONTRACTOR SHALL COMPLY WITH STATE STATUTES, MUNICIPAL AND LOCAL ORDINANCES, IN PLANNING AND CONDUCTING EXCAVATION, WHETHER BY CALLING OR NOTIFYING THE UTILITIES, COMPLYING WITH "BLUE STAKES" PROCEDURES, OR OTHERWISE.

#### NOTE:

THESE DRAWINGS DO NOT INCLUDE THE NECESSARY COMPONENTS FOR CONSTRUCTION SAFETY WHICH SHALL REMAIN THE RESPONSIBILITY OF THE CONTRACTOR.

#### NOTE:

THIS DOCUMENT, AND THE IDEAS AND DESIGNS INCORPORATED HEREIN, ARE INTENDED FOR USE ON THIS PROJECT AND IS NOT TO BE USED, IN WHOLE OR IN PART, FOR ANY OTHER PROJECT WITHOUT THE WRITTEN AUTHORIZATION OF RESPEC INC. IN THE EVENT OF UNAUTHORIZED USE, THE USER ASSUMES ALL RESPONSIBILITY AND LIABILITY WHICH RESULTS.

#### EROSION CONTROL NOTES:

- THE CONTRACTOR IS RESPONSIBLE FOR OBTAINING A TOPSOIL DISTURBANCE PERMIT PRIOR TO BEGINNING OF WORK.
- CONTRACTOR IS RESPONSIBLE FOR MAINTAINING RUN-OFF ON SITE DURING CONSTRUCTION.
- CONTRACTOR IS RESPONSIBLE FOR CLEANING AL SEDIMENT THAT GETS INTO EXISTING RIGHT-OF-WAY
- REPAIR OF DAMAGED FACILITIES AND CLEANUP OF SEDIMENT ACCUMULATIONS ON ADJACENT PROPERTIES AND IN PUBLIC FACILITIES IS THE RESPONSIBILITIES OF THE CONTRACTOR.
- ALL EXPOSED EARTH SURFACES MUST BE PROTECTED FROM WIND AND WATER EROSION PRIOR TO FINAL (CITY) ACCEPTANCE OF ANY PROJECT.

#### KEYED NOTES

- EXISTING PROPERTY LINE
- EXISTING 10' P.U.E
- EXISTING STANDARD CURB AND GUTTER
- EXISTING SIDEWALK
- PAD EXTENTS
- HIGH POINT OF SWALE
- SWALE
- MATCH DRIVEWAY TO BACK OF EXISTING SIDEWALK
- IF PERIMETER WALL INSTALLED THEN PROVIDE TURNED BLOCK TO ALLOW FOR CROSS LOT DRAINAGE
- PROPOSED DRIVEWAY LOCATION. DRIVEWAY PERMIT BY OTHERS
- EXISTING WALL ADJACENT TO PROPERTY (RETAINING WALL MAY HAVE TO BE ADJUSTED WHEN EXISTING WALL ARE ENCOUNTERED.)
- RUNDOWN



DESIGNED SEG	DRAWN JT	CHECKED SEG	DATE 5.12.2020
RESPEC			
5971 Jefferson Street Suite 101 Albuquerque, NM 87109 Water and Natural Resources respec.com 505-253-9718			



THIS DRAWING IS INCOMPLETE AND NOT TO BE USED FOR CONSTRUCTION UNLESS IT IS STAMPED, SIGNED AND DATED



VOLCANO CLIFFS  
6520 CANAVIO RD NW  
PULTE ID 3

GRADING AND  
DRAINAGE PLAN

GRADING PERMIT

SHEET NUMBER:

1 OF 1

SCANNED