

# CITY OF ALBUQUERQUE

Planning Department  
Brennon Williams, Director



Mayor Timothy M. Keller

March 31, 2021

Sheldon Greer, P.E.  
RESPEC  
5971 Jefferson St. NE Suite 101  
Albuquerque, New Mexico 87109

RE: **Lot 15 Block 1 Unit 22 SAD 228 Volcano Cliffs Subd.  
8009 Agua Fria Ct. NW  
Grading and Drainage Plan  
Engineers Stamp Date 10/29/2020 (D10D003N15)  
Pad Certification Date: 3/11/2021**

Mr. Greer,

Based upon the information provided in your submittal received 3/31/2021, this plan cannot be approved for Building Permit until the following comments are addressed..

PO Box 1293

- Remove all dirt from the street. Dirt is not allowed to use as a ramp for going over the curb, only lumber or crusher fines are acceptable.
- Remove the dirt in the channel, it is blocking the flow from Alto Rey Ct. to Agua Fria Ct.

Albuquerque

Reiterate to the Owner/Contractor that a separate permit for a garden/retaining wall must be obtained with the approved G&D plan and Pad Certification. **Also, if a swimming pool is to be placed the grading and drainage plan will change and will need to be resubmitted.**

NM 87103

**Prior to Certificate of Occupancy release, Engineer Certification per the DPM checklist will be required.**

[www.cabq.gov](http://www.cabq.gov)

If you have any questions, please contact me at 924-3986 or Rudy Rael at 924-3977.

Sincerely,

Ernest Armijo, P.E.  
Principal Engineer, Planning Dept.  
Development Review Services



# City of Albuquerque

Planning Department

Development & Building Services Division

## DRAINAGE AND TRANSPORTATION INFORMATION SHEET (REV 11/2018)

**Project Title:** \_\_\_\_\_ **Building Permit #:** \_\_\_\_\_ **Hydrology File #:** \_\_\_\_\_

**DRB#:** \_\_\_\_\_ **EPC#:** \_\_\_\_\_ **Work Order#:** \_\_\_\_\_

**Legal Description:** \_\_\_\_\_

**City Address:** \_\_\_\_\_

**Applicant:** \_\_\_\_\_ **Contact:** \_\_\_\_\_

**Address:** \_\_\_\_\_

**Phone#:** \_\_\_\_\_ **Fax#:** \_\_\_\_\_ **E-mail:** \_\_\_\_\_

**Owner:** \_\_\_\_\_ **Contact:** \_\_\_\_\_

**Address:** \_\_\_\_\_

**Phone#:** \_\_\_\_\_ **Fax#:** \_\_\_\_\_ **E-mail:** \_\_\_\_\_

**TYPE OF SUBMITTAL:** \_\_\_\_\_ PLAT ( \_\_\_\_\_ # OF LOTS) \_\_\_\_\_ RESIDENCE \_\_\_\_\_ DRB SITE \_\_\_\_\_ ADMIN SITE

**IS THIS A RESUBMITTAL?:** \_\_\_\_\_ Yes \_\_\_\_\_ No

**DEPARTMENT:** \_\_\_\_\_ TRAFFIC/ TRANSPORTATION \_\_\_\_\_ HYDROLOGY/ DRAINAGE

Check all that Apply:

### TYPE OF SUBMITTAL:

- \_\_\_\_\_ ENGINEER/ARCHITECT CERTIFICATION
- \_\_\_\_\_ PAD CERTIFICATION
- \_\_\_\_\_ CONCEPTUAL G & D PLAN
- \_\_\_\_\_ GRADING PLAN
- \_\_\_\_\_ DRAINAGE MASTER PLAN
- \_\_\_\_\_ DRAINAGE REPORT
- \_\_\_\_\_ FLOODPLAIN DEVELOPMENT PERMIT APPLIC
- \_\_\_\_\_ ELEVATION CERTIFICATE
- \_\_\_\_\_ CLOMR/LOMR
- \_\_\_\_\_ TRAFFIC CIRCULATION LAYOUT (TCL)
- \_\_\_\_\_ TRAFFIC IMPACT STUDY (TIS)
- \_\_\_\_\_ OTHER (SPECIFY) \_\_\_\_\_
- \_\_\_\_\_ PRE-DESIGN MEETING?

### TYPE OF APPROVAL/ACCEPTANCE SOUGHT:

- \_\_\_\_\_ BUILDING PERMIT APPROVAL
- \_\_\_\_\_ CERTIFICATE OF OCCUPANCY
- \_\_\_\_\_ PRELIMINARY PLAT APPROVAL
- \_\_\_\_\_ SITE PLAN FOR SUB'D APPROVAL
- \_\_\_\_\_ SITE PLAN FOR BLDG. PERMIT APPROVAL
- \_\_\_\_\_ FINAL PLAT APPROVAL
- \_\_\_\_\_ SIA/ RELEASE OF FINANCIAL GUARANTEE
- \_\_\_\_\_ FOUNDATION PERMIT APPROVAL
- \_\_\_\_\_ GRADING PERMIT APPROVAL
- \_\_\_\_\_ SO-19 APPROVAL
- \_\_\_\_\_ PAVING PERMIT APPROVAL
- \_\_\_\_\_ GRADING/ PAD CERTIFICATION
- \_\_\_\_\_ WORK ORDER APPROVAL
- \_\_\_\_\_ CLOMR/LOMR
- \_\_\_\_\_ FLOODPLAIN DEVELOPMENT PERMIT
- \_\_\_\_\_ OTHER (SPECIFY) \_\_\_\_\_

**DATE SUBMITTED:** \_\_\_\_\_ **By:** \_\_\_\_\_

COA STAFF:

ELECTRONIC SUBMITTAL RECEIVED: \_\_\_\_\_

FEE PAID: \_\_\_\_\_



Project Name: Petroglyph Estates  
Project Address: 8000 Alto Ray CT  
Pulte Site ID: Lot 12

Site Area (sq. ft.) 14000  
House Area (sq. ft.) 5170  
Driveway Area (sq. ft.) 500  
Other Imp Area (sq. ft.) 1500  
Total Imp. Area: 7170

AREA (SF)	% AREA	Q100 /ACRE (CFS/AC.) (1)	Q100 (cfs) (3)	DMP % (2)	DMP Q100 (cfs) (4)	DRAIN TO FRONT LOT AREA (sq. ft.)	DRAIN TO REAR LOT AREA (sq. ft.)	Q100 TO FRONT LOT (cfs)	Q100 TO REAR LOT (cfs)
A	0	0.0%	1.29	0.00	0.00	0	0	0.00	0.00
B	3415	24.4%	2.03	0.16	10.0%	300	3115	0.01	0.15
C	3415	24.4%	2.87	0.23	40.0%	300	3115	0.02	0.21
D	7170	51.2%	4.37	0.72	50.0%	600	6570	0.06	0.66
TOTAL	14000	100.00%	1.10	1.14			12800	0.09	1.01

NOTES: (1) Zone 1 - Table A-9 Albuquerque DPM  
(2) Per Volcano Cliffs Drainage Management Plan  
(3) Total Discharge  
(4) Allowable Discharge

TABLE 2. WATER QUALITY STORM EVENT RUNOFF RATE AND VOLUME AS A PERCENT OF IMPERVIOUS AREA FOR 40-ACRE AND SMALLER SITES			
Percent Impervious (%D)	Runoff Depth (inches)	Runoff Rate (cfs/ac)	Runoff Volume (cubic feet/ac)
0	0	0	0
20	0.09	0.5	327
40	0.18	0.8	653
60	0.27	1.2	980
80	0.36	1.35	1037
100	0.46	1.5	1670

Table Interpolation:		Site Area (sq. ft.)	Site Area (ac.)	Imp. Area (Sq. ft.)	% Imp	Runoff Vol. (per ac.)				
		14000	0.32	7170	51.2%	0-20	20-40	40-60	60-80	80-100
						51.2	0	0	836.4	0
						Total Water Quality Volume Required: 268.8				
						Provided: 363.0				

Existing Conditions:

Proposed Conditions:

## PAD CERTIFICATION

I SHELTON GREER P.E., NMPE 17154, OF THE ENGINEERING FIRM RESPEC, HEREBY CERTIFY, BASED ON SURVEY DATA PROVIDED BY BRIAN MARTINEZ, NMRRS 18374, THAT THE AS CONSTRUCTED PAD ELEVATION IS WITHIN 0.2' OF THE DESIGN ELEVATION AND THAT THE HORIZONTAL LIMITS OF THE AS CONSTRUCTED PAD ARE AS SHOWN.

SHELTON E. GREER, PE 17154

3/11/2021  
DATE

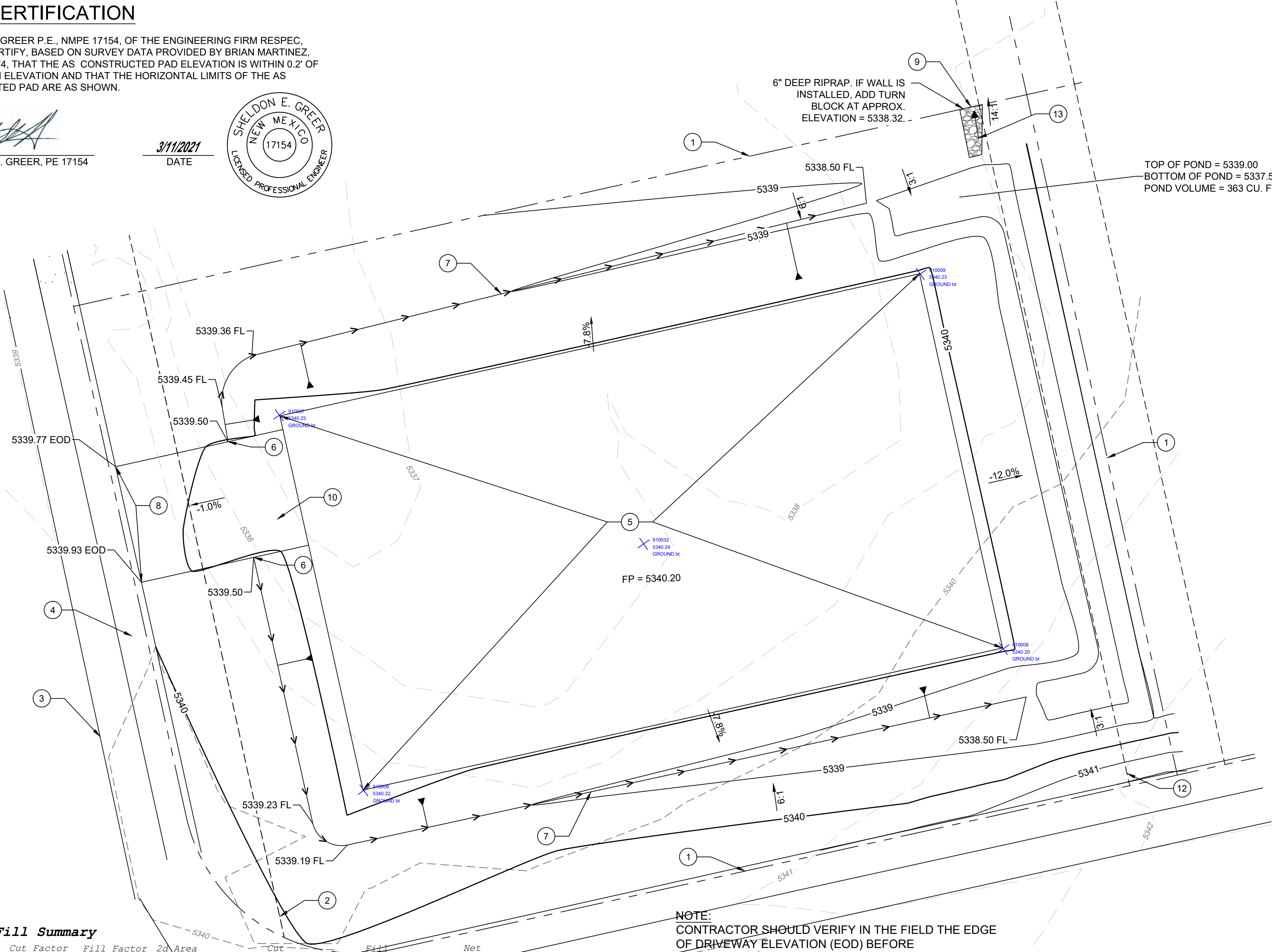

### Cut/Fill Summary

Name	Cut Factor	Fill Factor	2d Area	Cut	Net
VOLUME	1.00	1.25	13301.02 Sq. Ft.	137.50 Cu. Yd.	796.55 Cu. Yd.
Totals			13301.02 Sq. Ft.	137.50 Cu. Yd.	659.05 Cu. Yd.

NOTE: CONTRACTOR SHOULD VERIFY IN THE FIELD THE EDGE OF DRIVEWAY ELEVATION (EOD) BEFORE CONSTRUCTION. IF ANY DISCREPANCY BETWEEN FIELD ELEVATION AND G&D PLAN ELEVATION, CONTACT ENGINEER BEFORE MOVING FORWARD.



FIRM MAP:



VICINITY MAP:

### GENERAL NOTES:

- ALL WORK DETAILED ON THESE PLANS TO BE PERFORMED UNDER THE CONTRACT SHALL, EXCEPT AS OTHERWISE STATED OR PROVIDED HEREIN, BE CONSTRUCTED IN ACCORDANCE WITH THE CITY OF ALBUQUERQUE STANDARD SPECIFICATIONS FOR PUBLIC WORKS, 1986 EDITION, UPDATE NO. 8 VOL. 1 AND 2 JANUARY 2011.
- THE EROSION PROTECTION SPECIFIED THIS PLAN IS THE MINIMUM RECOMMENDED. THE OWNER IS ENCOURAGED TO INCORPORATE EROSION RESISTANT LANDSCAPING ON AREAS WHERE EROSION MAY OCCUR SUCH AS SLOPES AND SWALES. THE OWNER IS RESPONSIBLE FOR THE INSTALLATION AND MAINTENANCE OF ALL EROSION CONTROL FEATURES NECESSARY TO PRESERVE THE DESIGN INTENT OF THE GRADING PLAN.
- THE DRAINAGE INFRASTRUCTURE SHOWN ON THIS PLAN IS THE RESPONSIBILITY OF THE PROPERTY OWNER.
- ALL DISTURBED AREAS OUTSIDE THE BUILDING PAD MUST BE RESEEDING OR LANDSCAPED.
- TWO (2) WORKING DAYS PRIOR TO ANY EXCAVATION, CONTRACTOR MUST CONTACT LINE LOCATING SERVICE, (260-1990) FOR LOCATION OF EXISTING UTILITIES.
- PRIOR TO CONSTRUCTION, THE CONTRACTOR SHALL EXCAVATE AND VERIFY THE HORIZONTAL AND VERTICAL LOCATIONS OF ALL OBSTRUCTIONS AND EXISTING PAVEMENT. SHOULD A CONFLICT EXIST, THE CONTRACTOR SHALL NOTIFY ENGINEER OR SURVEYOR SO THAT THE CONFLICT CAN BE RESOLVED WITH A MINIMUM OF DELAY.

### NOTE:

THE ENGINEER HAS UNDERTAKEN LIMITED FIELD VERIFICATION OF THE LOCATION, DEPTH, SIZE, OR TYPE OF EXISTING UNDERGROUND UTILITY LINES, MAKES NO REPRESENTATION PERTAINING THERETO AND ASSUMES NO RESPONSIBILITY OR LIABILITY THEREFOR. THE CONTRACTOR SHALL INFORM ITSELF OF THE LOCATION OF ANY UTILITY LINE IN OR NEAR THE ARE OF WORK IN ADVANCE OF AND DURING EXCAVATION WORK. THE CONTRACTOR IS FULLY RESPONSIBLE FOR ANY AND ALL DAMAGE CAUSED BY ITS FAILURE TO LOCATE, IDENTIFY, AND PRESERVE ANY AND ALL EXISTING UTILITIES. THE CONTRACTOR SHALL COMPLY WITH STATE STATUTES, MUNICIPAL AND LOCAL ORDINANCES, IN PLANNING AND CONDUCTING EXCAVATION, WHETHER BY CALLING OR NOTIFYING THE UTILITIES, COMPLYING WITH "BLUE STAKES" PROCEDURES, OR OTHERWISE.

### NOTE:

THESE DRAWINGS DO NOT INCLUDE THE NECESSARY COMPONENTS FOR CONSTRUCTION SAFETY WHICH SHALL REMAIN THE RESPONSIBILITY OF THE CONTRACTOR.

### NOTE:

THIS DOCUMENT, AND THE IDEAS AND DESIGNS INCORPORATED HEREIN, ARE INTENDED FOR USE ON THIS PROJECT AND IS NOT TO BE USED, IN WHOLE OR IN PART, FOR ANY OTHER PROJECT WITHOUT THE WRITTEN AUTHORIZATION OF RESPEC INC. IN THE EVENT OF UNAUTHORIZED USE, THE USER ASSUMES ALL RESPONSIBILITY AND LIABILITY WHICH RESULTS.

### EROSION CONTROL NOTES:

- THE CONTRACTOR IS RESPONSIBLE FOR OBTAINING A TOPSOIL DISTURBANCE PERMIT PRIOR TO BEGINNING OF WORK.
- CONTRACTOR IS RESPONSIBLE FOR MAINTAINING RUN-OFF ON SITE DURING CONSTRUCTION.
- CONTRACTOR IS RESPONSIBLE FOR CLEANING ALL SEDIMENT THAT GETS INTO EXISTING RIGHT-OF-WAY
- REPAIR OF DAMAGED FACILITIES AND CLEANUP OF SEDIMENT ACCUMULATIONS ON ADJACENT PROPERTIES AND IN PUBLIC FACILITIES IS THE RESPONSIBILITIES OF THE CONTRACTOR.
- ALL EXPOSED EARTH SURFACES MUST BE PROTECTED FROM WIND AND WATER EROSION PRIOR TO FINAL (CITY) ACCEPTANCE OF ANY PROJECT.

### LEGEND

TW = TOP OF WALL  
FG = FINISHED GROUND  
EG = EXISTING GROUND  
FL = FLOW LINE  
EOD = EDGE OF DRIVEWAY  
FP = FINISHED PAD  
TOB = TOP OF BERM

### KEYED NOTES

- EXISTING PROPERTY LINE
- EXISTING 10' P.U.E.
- EXISTING STANDARD CURB AND GUTTER
- EXISTING SIDEWALK
- PAD EXTENTS
- HIGH POINT OF SWALE
- SWALE
- MATCH DRIVEWAY TO BACK OF EXISTING SIDEWALK
- IF PERIMETER WALL IS INSTALLED THEN PROVIDE TURNED BLOCK TO ALLOW FOR CROSS LOT DRAINAGE.
- PROPOSED DRIVEWAY LOCATION. DRIVEWAY PERMIT BY OTHERS
- EXISTING WALL ADJACENT TO PROPERTY (RETAINING WALL MAY HAVE TO BE ADJUSTED WHEN EXISTING WALL ARE ENCOUNTERED.)
- EXISTING 7' P.U.E.
- 6" RIPRAP RUNDOWN.

DESIGNED BY: RESPEC  
DRAWN BY: RESPEC  
CHECKED BY: RESPEC  
DATE: 3.11.2021

REVISION

STAMP  
SHELTON E. GREER  
NEW MEXICO  
17154  
10/20/2021  
REGISTERED PROFESSIONAL ENGINEER

THIS DRAWING IS INCOMPLETE AND NOT TO BE USED FOR CONSTRUCTION UNLESS IT IS STAMPED, SIGNED AND DATED

nm811  
Know what's below.  
Call before you dig.

PROJECT NAME: PETROGLYPH ESTATES  
8000 ALTO RAY CT  
PULTE ID 12

SHEET TITLE: GRADING AND DRAINAGE PLAN

SHEET NUMBER: 1 OF 1