

CITY OF ALBUQUERQUE

Planning Department
Alan Varela, Director



Mayor Timothy M. Keller

May 23, 2023

Sheldon Greer, P.E.
RESPEC
5971 Jefferson St. NE Suite 101
Albuquerque, New Mexico 87109

RE: **Lot 17 Block 1 Volcano Cliffs Unit 22 SAD 228**
8015 Agua Fria Ct. NW
Grading and Drainage Plan
Engineers Stamp Date: 10/29/2020 (D10D003N17)
CO Certification Date: 5/23/2023

Mr. Greer,

Based on the Certification received on 5/22/2023, the site is acceptable for release of Certificate of Occupancy by Hydrology.

PO Box 1293

If you have any questions, please contact me at 924-3695 or Rudy Rael at 924-3977.

Albuquerque

Sincerely,

NM 87103

Tiequan Chen, P.E.
Principal Engineer, Hydrology
Planning Department, Development Review Services

www.cabq.gov

RR/TC
File D10D003N17



City of Albuquerque

Planning Department

Development & Building Services Division

DRAINAGE AND TRANSPORTATION INFORMATION SHEET (REV 11/2018)

Project Title: _____ **Building Permit #:** _____ **Hydrology File #:** _____

DRB#: _____ **EPC#:** _____ **Work Order#:** _____

Legal Description: _____

City Address: _____

Applicant: _____ **Contact:** _____

Address: _____

Phone#: _____ **Fax#:** _____ **E-mail:** _____

Owner: _____ **Contact:** _____

Address: _____

Phone#: _____ **Fax#:** _____ **E-mail:** _____

TYPE OF SUBMITTAL: _____ PLAT (___# OF LOTS) _____ RESIDENCE _____ DRB SITE _____ ADMIN SITE

IS THIS A RESUBMITTAL?: _____ Yes _____ No

DEPARTMENT: _____ TRAFFIC/ TRANSPORTATION _____ HYDROLOGY/ DRAINAGE

Check all that Apply:

TYPE OF SUBMITTAL:

- _____ ENGINEER/ARCHITECT CERTIFICATION
- _____ PAD CERTIFICATION
- _____ CONCEPTUAL G & D PLAN
- _____ GRADING PLAN
- _____ DRAINAGE MASTER PLAN
- _____ DRAINAGE REPORT
- _____ FLOODPLAIN DEVELOPMENT PERMIT APPLIC
- _____ ELEVATION CERTIFICATE
- _____ CLOMR/LOMR
- _____ TRAFFIC CIRCULATION LAYOUT (TCL)
- _____ TRAFFIC IMPACT STUDY (TIS)
- _____ OTHER (SPECIFY) _____
- _____ PRE-DESIGN MEETING?

TYPE OF APPROVAL/ACCEPTANCE SOUGHT:

- _____ BUILDING PERMIT APPROVAL
- _____ CERTIFICATE OF OCCUPANCY
- _____ PRELIMINARY PLAT APPROVAL
- _____ SITE PLAN FOR SUB'D APPROVAL
- _____ SITE PLAN FOR BLDG. PERMIT APPROVAL
- _____ FINAL PLAT APPROVAL
- _____ SIA/ RELEASE OF FINANCIAL GUARANTEE
- _____ FOUNDATION PERMIT APPROVAL
- _____ GRADING PERMIT APPROVAL
- _____ SO-19 APPROVAL
- _____ PAVING PERMIT APPROVAL
- _____ GRADING/ PAD CERTIFICATION
- _____ WORK ORDER APPROVAL
- _____ CLOMR/LOMR
- _____ FLOODPLAIN DEVELOPMENT PERMIT
- _____ OTHER (SPECIFY) _____

DATE SUBMITTED: _____ **By:** _____

COA STAFF:

ELECTRONIC SUBMITTAL RECEIVED: _____

FEE PAID: _____

Project Name: Petrolyph Estates
 Project Address: 8015 Agua Fria CT
 Pulte Site ID: Lot 17

TABLE 2. WATER QUALITY STORM EVENT RUNOFF RATE AND VOLUME AS A PERCENT OF IMPERVIOUS AREA FOR 40-ACRE AND SMALLER SITES.

Percent Impervious (%)	Runoff Depth (inches)	Runoff Rate (cfs/ac)	Runoff Volume (cubic feet/ac)
0	0	0	0
20	0.09	0.5	327
40	0.18	0.8	653
60	0.27	1.2	980
80	0.36	1.35	1037
100	0.46	1.5	1070

Table Interpolation:

Site Area (sq. ft.)	Site Area (ac.)	Imp. Area (sq. ft.)	% Imp
16100	0.37	6840	42.5%
20000	0.46	8000	40.0%
24000	0.55	9600	40.0%
28000	0.64	11200	40.0%
32000	0.73	12800	40.0%
36000	0.82	14400	40.0%
40000	0.91	16000	40.0%
44000	1.00	17600	40.0%
48000	1.09	19200	40.0%
52000	1.18	20800	40.0%
56000	1.27	22400	40.0%
60000	1.36	24000	40.0%
64000	1.45	25600	40.0%
68000	1.54	27200	40.0%
72000	1.63	28800	40.0%
76000	1.72	30400	40.0%
80000	1.81	32000	40.0%
84000	1.90	33600	40.0%
88000	1.99	35200	40.0%
92000	2.08	36800	40.0%
96000	2.17	38400	40.0%
100000	2.26	40000	40.0%

AREA (SF)	% AREA	Q100 (cfs)		DMP %	DMP Q100 (cfs)	DRAIN TO FRONT LOT AREA (sq. ft.)	DRAIN TO REAR LOT AREA (sq. ft.)	Q100 TO FRONT LOT (cfs)	Q100 TO REAR LOT (cfs)
		(1)	(2)						
A	0.0%	1.29	0.00	0.0%	0.00	0	0	0.00	0.00
B	28.8%	2.03	0.22	10.0%	0.08	300	4300	0.01	0.20
C	46.9%	2.87	0.31	40.0%	0.42	300	4300	0.02	0.29
D	68.4%	4.37	0.69	50.0%	0.81	600	6240	0.06	0.63
TOTAL	100.00%	1.21			1.81	14900	0.09	1.11	

NOTES: (1) Zone 1 - Table A-9 Albuquerque DPM
 (2) Per Volcano Cliffs Drainage Management Plan
 (3) Total Discharge
 (4) Allowable Discharge

Existing Conditions: The existing site is not within a designated flood zone. The site surface drains to the drainage channel on Lots 9 and 16.

Proposed Conditions: The proposed site improvements will include the construction of a single family residence with landscaping and other site improvements. In accordance with the SAD 228 drainage management plan, the runoff will free discharge allowable discharge. The allowable discharge was determined by analysis of the basin including the lot. The lot use percentages of the basin were apportioned between roadways and lots based on area. The roof, driveway, and an additional 1500 sq. ft. for structure improvements are included in the impervious area percentage for the lot.



DRAINAGE CERTIFICATION

I, SHELDON GREER P.E., NMPE 17154, OF THE ENGINEERING FIRM RESPEC HEREBY CERTIFY THAT THIS PROJECT HAS BEEN GRADED AND WILL DRAIN IN SUBSTANTIAL COMPLIANCE WITH AND IN ACCORDANCE WITH THE DESIGN INTENT OF THE APPROVED PLAN DATED 10/29/2020. THE RECORD INFORMATION EDITED ONTO THE ORIGINAL DESIGN DOCUMENT HAS BEEN OBTAINED BY THOMAS W. PATRICK, NMPS 12651, OF THE FIRM COMMUNITY SCIENCES SERVICES. I FURTHER CERTIFY THAT I HAVE PERSONALLY VISITED THE PROJECT SITE ON 5/12/2023 AND HAVE DETERMINED BY VISUAL INSPECTION THAT THE SURVEY DATA PROVIDED IS REPRESENTATIVE OF ACTUAL SITE CONDITIONS AND IS TRUE AND CORRECT TO THE BEST OF MY KNOWLEDGE AND BELIEF. THIS CERTIFICATION IS SUBMITTED IN SUPPORT OF A REQUEST FOR CERTIFICATE OF OCCUPANCY. THE RECORD INFORMATION PRESENTED HEREON IS NOT NECESSARILY COMPLETE AND INTENDED ONLY TO VERIFY SUBSTANTIAL COMPLIANCE OF THE GRADING AND DRAINAGE ASPECTS OF THIS PROJECT. THOSE RELYING ON THIS RECORD DOCUMENT ARE ADVISED TO OBTAIN INDEPENDENT VERIFICATION OF ITS ACCURACY BEFORE USING IT FOR ANY OTHER PURPOSE.

SHELDON E. GREER, PE 17154
 5/12/2023 DATE

RESPEC
 COMMUNITY SCIENCES SERVICES
 500 ALBUQUERQUE, NEW MEXICO 87102
 WWW.RESPEC.COM PHONE: 505.262.9318

DESIGNED BY: SHELDON E. GREER
 DRAWN BY: SHELDON E. GREER
 CHECKED BY: SHELDON E. GREER
 DATE: 5/24/2021

REVISION

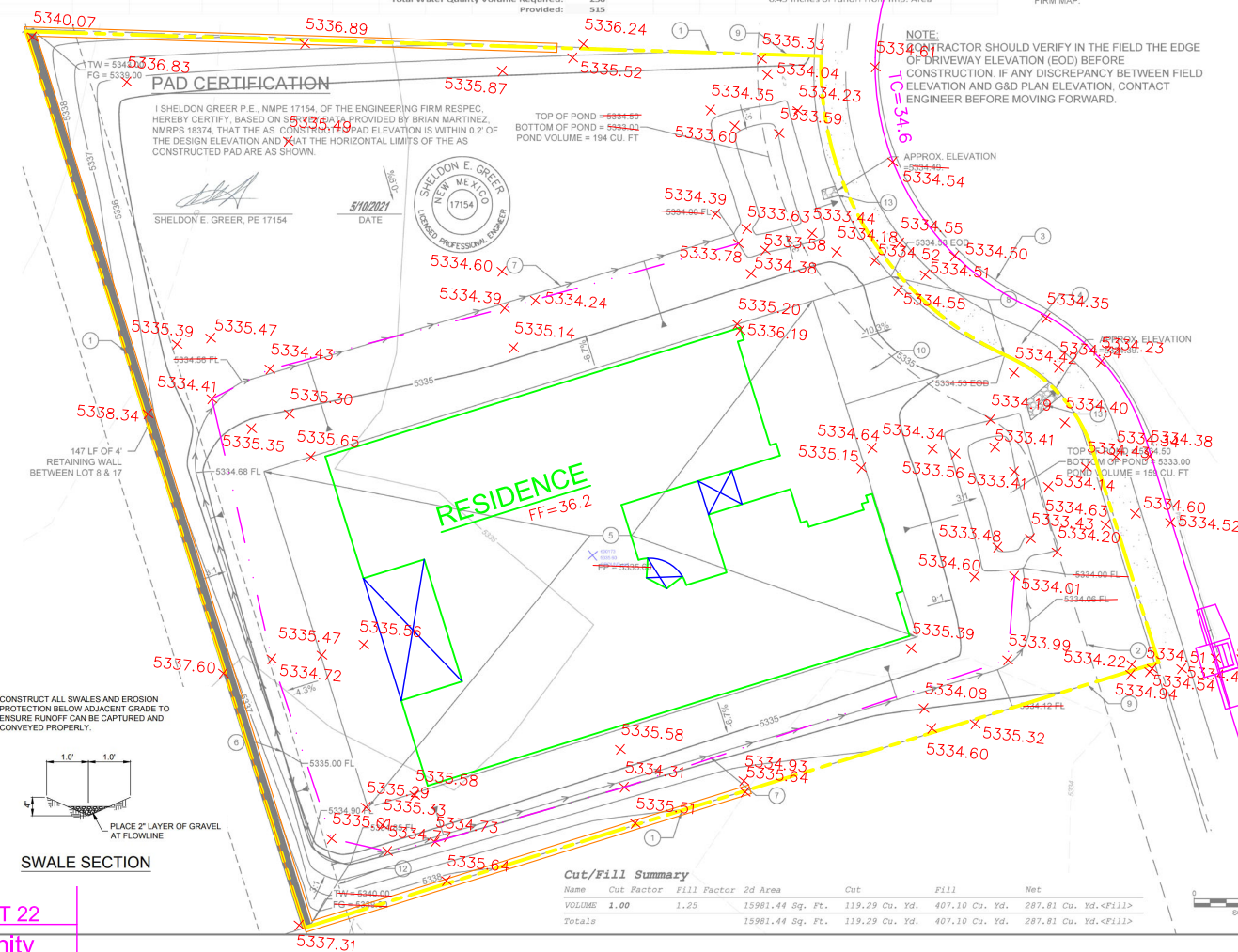

- GENERAL NOTES:**
- ALL WORK DETAILED ON THESE PLANS TO BE PERFORMED UNDER THE CONTRACT SHALL, EXCEPT AS OTHERWISE STATED OR PROVIDED HEREIN, BE CONSTRUCTED IN ACCORDANCE WITH THE CITY OF ALBUQUERQUE STANDARD SPECIFICATIONS FOR PUBLIC WORKS, 1986 EDITION, UPDATE NO. 8 VOL. 1 AND 2 JANUARY 2011.
 - THE EROSION PROTECTION SPECIFIED THIS PLAN IS THE MINIMUM RECOMMENDED. THE OWNER IS ENCOURAGED TO INCORPORATE EROSION RESISTANT LANDSCAPING ON AREAS WHERE EROSION MAY OCCUR SUCH AS SLOPES AND SWALES. THE OWNER IS RESPONSIBLE FOR THE INSTALLATION AND MAINTENANCE OF ALL EROSION CONTROL FEATURES NECESSARY TO PRESERVE THE DESIGN INTENT OF THE GRADING PLAN.
 - THE DRAINAGE INFRASTRUCTURE SHOWN ON THIS PLAN IS THE RESPONSIBILITY OF THE PROPERTY OWNER.
 - ALL DISTURBED AREAS OUTSIDE THE BUILDING PAD MUST BE RESEED OR LANDSCAPED.
 - TWO (2) WORKING DAYS PRIOR TO ANY EXCAVATION, CONTRACTOR MUST CONTACT LINE LOCATING SERVICE, (260-1990) FOR LOCATION OF EXISTING UTILITIES.
 - PRIOR TO CONSTRUCTION, THE CONTRACTOR SHALL EXCAVATE AND VERIFY THE HORIZONTAL AND VERTICAL LOCATIONS OF ALL OBSTRUCTIONS AND EXISTING PAVEMENT. SHOULD A CONFLICT EXIST, THE CONTRACTOR SHALL NOTIFY ENGINEER OR SURVEYOR SO THAT THE CONFLICT CAN BE RESOLVED WITH A MINIMUM OF DELAY.
 - GRADING SHOWN HEREIN ASSUMES THE CONCURRENT GRADING OF THE ADJACENT LOTS BELONGING TO THE SAME PROPERTY OWNER.
- NOTE:**
 THE ENGINEER HAS UNDERTAKEN LIMITED FIELD VERIFICATION OF THE LOCATION, DEPTH, SIZE, OR TYPE OF EXISTING UNDERGROUND UTILITY LINES. MAKES NO REPRESENTATION PERTAINING THERETO AND ASSUMES NO RESPONSIBILITY OR LIABILITY THEREFOR. THE CONTRACTOR SHALL INFORM ITSELF OF THE LOCATION OF ANY UTILITY LINES IN OR NEAR THE AREA OF WORK IN ADVANCE OF AND DURING EXCAVATION WORK. THE CONTRACTOR IS FULLY RESPONSIBLE FOR ANY AND ALL DAMAGE CAUSED BY ITS FAILURE TO LOCATE, IDENTIFY, AND PRESERVE ANY AND ALL EXISTING UTILITIES. THE CONTRACTOR SHALL COMPLY WITH STATE STATUTES, MUNICIPAL AND LOCAL ORDINANCES, IN PLANNING AND CONDUCTING EXCAVATION, WHETHER BY CALLING OR NOTIFYING THE UTILITIES, COMPLYING WITH "BLUE STAKES" PROCEDURES, OR OTHERWISE.
- NOTE:**
 THESE DRAWINGS DO NOT INCLUDE THE NECESSARY COMPONENTS FOR CONSTRUCTION SAFETY WHICH SHALL REMAIN THE RESPONSIBILITY OF THE CONTRACTOR.
- NOTE:**
 THIS DOCUMENT, AND THE IDEAS AND DESIGNS INCORPORATED HEREIN, ARE INTENDED FOR USE ON THIS PROJECT AND IS NOT TO BE USED, IN WHOLE OR IN PART, FOR ANY OTHER PROJECT WITHOUT THE WRITTEN AUTHORIZATION OF RESPEC, INC. IN THE EVENT OF UNAUTHORIZED USE, THE USER ASSUMES ALL RESPONSIBILITY AND LIABILITY WHICH RESULTS.
- EROSION CONTROL NOTES:**
- THE CONTRACTOR IS RESPONSIBLE FOR OBTAINING A TOPSOIL DISTURBANCE PERMIT PRIOR TO BEGINNING OF WORK.
 - CONTRACTOR IS RESPONSIBLE FOR MAINTAINING RUN-OFF ON SITE DURING CONSTRUCTION.
 - CONTRACTOR IS RESPONSIBLE FOR CLEANING ALL SEDIMENT THAT GETS INTO EXISTING RIGHT-OF-WAY.
 - REPAIR OF DAMAGED FACILITIES AND CLEANUP OF SEDIMENT ACCUMULATIONS ON ADJACENT PROPERTIES AND IN PUBLIC FACILITIES IS THE RESPONSIBILITIES OF THE CONTRACTOR.
 - ALL EXPOSED EARTH SURFACES MUST BE PROTECTED FROM WIND AND WATER EROSION PRIOR TO FINAL (CITY) ACCEPTANCE OF ANY PROJECT.
- LEGEND**
- TW = TOP OF WALL
 BW = BOTTOM OF WALL
 FG = FINISHED GROUND
 EG = EXISTING GROUND
 FL = FLOW LINE
 EOD = EDGE OF DRIVEWAY
 FP = FINISHED PAD
 TOB = TOP OF BERM
- RETAINING WALL
 TOP OF BERM
- KEYED NOTES**
- EXISTING PROPERTY LINE
 - EXISTING 10' P.U.E.
 - EXISTING STANDARD CURB AND GUTTER
 - EXISTING SIDEWALK
 - PAD EXTENTS
 - HIGH POINT OF SWALE
 - SWALE
 - MATCH DRIVEWAY TO BACK OF EXISTING SIDEWALK
 - IF PERIMETER WALL IS INSTALLED THEN PROVIDE TURNED BLOCK TO ALLOW FOR CROSS LOT DRAINAGE.
 - PROPOSED DRIVEWAY LOCATION. DRIVEWAY PERMIT BY OTHERS
 - EXISTING WALL ADJACENT TO PROPERTY (RETAINING WALL MAY HAVE TO BE ADJUSTED WHEN EXISTING WALL ARE ENCOUNTERED.)
 - EXISTING 7' P.U.E.
 - 6" RIPRAP RUNDOWN

Asbuilt
 LOT 17, BLOCK 1
 VOLCANO CLIFFS UNIT 22

DATE: 05/16/23
 CREW: RGR/DCN
 DRAFTING: AHM
 GPS: VIEJO
 JN: N143-05

Community Sciences Corporation
 Land Surveying
 (505) 897.0000

SHEET TITLE: GRADING AND DRAINAGE PLAN
 SHEET NUMBER: 1 OF 1
 PROJECT NAME: PETROLYPH ESTATES 8015 AGUA FRIA CT PULTE ID 17
 SUBMITTED FOR: PAD CERTIFICATION