

CITY OF ALBUQUERQUE

Planning Department
Brennon Williams, Director



Mayor Timothy M. Keller

November 2, 2020

Sheldon Greer, P.E.
RESPEC
5971 Jefferson St. NE Suite 101
Albuquerque, New Mexico 87109

RE: **Lot 2 Block 1 Volcano Cliffs Unit 22 SAD 228
8005 Alto Rey Ct. NW
Grading and Drainage Plan
Engineers Stamp Date 10/29/2020 (D10D003N2)**

Mr. Greer,

Based upon the information provided in your submittal received 10/30/2020, this plan is approved for Grading Permit.

Please attach a copy of this approved plan to the construction sets in the permitting process prior to sign-off by Hydrology.

PO Box 1293

Prior to Building permit approval a Pad Certification will be required, provided by the Engineer or a registered Land Surveyor.

Albuquerque

Reiterate to the Owner/Contractor that a separate permit for a garden/retaining wall must be obtained with the approved G&D plan and Pad Certification. **Also, if a swimming pool is to be placed the grading and drainage plan will change and will need to be resubmitted.**

NM 87103

Prior to Certificate of Occupancy release, Engineer Certification per the DPM checklist will be required.

www.cabq.gov

If you have any questions, please contact me at 924-3986 or Rudy Rael at 924-3977.

Sincerely,

Ernest Armijo, P.E.
Principal Engineer, Planning Dept.
Development Review Services



City of Albuquerque

Planning Department

Development & Building Services Division

DRAINAGE AND TRANSPORTATION INFORMATION SHEET (REV 11/2018)

Project Title: _____ **Building Permit #:** _____ **Hydrology File #:** _____

DRB#: _____ **EPC#:** _____ **Work Order#:** _____

Legal Description: _____

City Address: _____

Applicant: _____ **Contact:** _____

Address: _____

Phone#: _____ **Fax#:** _____ **E-mail:** _____

Owner: _____ **Contact:** _____

Address: _____

Phone#: _____ **Fax#:** _____ **E-mail:** _____

TYPE OF SUBMITTAL: _____ PLAT (___# OF LOTS) _____ RESIDENCE _____ DRB SITE _____ ADMIN SITE

IS THIS A RESUBMITTAL?: _____ Yes _____ No

DEPARTMENT: _____ TRAFFIC/ TRANSPORTATION _____ HYDROLOGY/ DRAINAGE

Check all that Apply:

TYPE OF SUBMITTAL:

- _____ ENGINEER/ARCHITECT CERTIFICATION
- _____ PAD CERTIFICATION
- _____ CONCEPTUAL G & D PLAN
- _____ GRADING PLAN
- _____ DRAINAGE MASTER PLAN
- _____ DRAINAGE REPORT
- _____ FLOODPLAIN DEVELOPMENT PERMIT APPLIC
- _____ ELEVATION CERTIFICATE
- _____ CLOMR/LOMR
- _____ TRAFFIC CIRCULATION LAYOUT (TCL)
- _____ TRAFFIC IMPACT STUDY (TIS)
- _____ OTHER (SPECIFY) _____
- _____ PRE-DESIGN MEETING?

TYPE OF APPROVAL/ACCEPTANCE SOUGHT:

- _____ BUILDING PERMIT APPROVAL
- _____ CERTIFICATE OF OCCUPANCY
- _____ PRELIMINARY PLAT APPROVAL
- _____ SITE PLAN FOR SUB'D APPROVAL
- _____ SITE PLAN FOR BLDG. PERMIT APPROVAL
- _____ FINAL PLAT APPROVAL
- _____ SIA/ RELEASE OF FINANCIAL GUARANTEE
- _____ FOUNDATION PERMIT APPROVAL
- _____ GRADING PERMIT APPROVAL
- _____ SO-19 APPROVAL
- _____ PAVING PERMIT APPROVAL
- _____ GRADING/ PAD CERTIFICATION
- _____ WORK ORDER APPROVAL
- _____ CLOMR/LOMR
- _____ FLOODPLAIN DEVELOPMENT PERMIT
- _____ OTHER (SPECIFY) _____

DATE SUBMITTED: _____ **By:** _____

COA STAFF:

ELECTRONIC SUBMITTAL RECEIVED: _____

FEE PAID: _____

Project Name:	Petroglyph Estates									
Project Address:	8005 Alto Ray CT									
Pulte Site ID:	Lot 2									
	AREA	% AREA	Q100	Q100	DMP	DMP	DRAIN TO	DRAIN TO	Q100 TO	Q100 TO
	(SF)		(CFS/AC.)	(cfs)	%	(cfs)	FRONT	REAR	FRONT	REAR
	(1)		(2)		(3)		(4)		(5)	(6)
Site Area (sq. ft.)	14000									
House Area (sq. ft.)	5170									
Driveway Area (sq. ft.)	500									
Other Imp Area (sq. ft.)	1500									
Total Imp. Area:	7170									

- NOTES:
- (1) Zone 1 - Table A-9 Albuquerque DPM
 - (2) Per Volcano Cliffs Drainage Management Plan
 - (3) Total Discharge
 - (4) Allowable Discharge

TABLE 2. WATER QUALITY STORM EVENT RUNOFF RATE AND VOLUME AS A PERCENT OF IMPERVIOUS AREA FOR 40-ACRE AND SMALLER SITES

Percent Impervious (%D)	Runoff Depth (Inches)	Runoff Rate (cfs/ac)	Runoff Volume (cubic feet/ac)
0	0	0	0
20	0.09	0.5	327
40	0.18	0.8	653
60	0.27	1.2	980
80	0.36	1.35	1037
100	0.46	1.5	1670

Existing Conditions: Proposed Conditions:

Table Interpolation:	Site Area (sq. ft.)	Site Area (ac.)	Imp. Area (Sq. ft.)	% Imp	Runoff Vol. (per ac.)					
					0-20	20-40	40-60	60-80	80-100	
	14000	0.32	7170	51.2%	51.2	0	0	836.4	0	0
Total Water Quality Volume Required:					268.8					
Provided:					274.0					

0.45 inches of runoff from imp. Area

Cut/Fill Summary

Name	Cut Factor	Fill Factor	2d Area	Cut	Fill	Net
VOLUMS	1.00	1.25	13948.65 Sq. Ft.	21.47 Cu. Yd.	1754.52 Cu. Yd.	1733.05 Cu. Yd.<Fill>
Totals			13948.65 Sq. Ft.	21.47 Cu. Yd.	1754.52 Cu. Yd.	1733.05 Cu. Yd.<Fill>



FIRM MAP: 35001C012G VICINITY MAP: D-10-Z

NOTE: CONTRACTOR SHOULD VERIFY IN THE FIELD THE EDGE OF DRIVEWAY ELEVATION (EOD) BEFORE CONSTRUCTION. IF ANY DISCREPANCY BETWEEN FIELD ELEVATION AND G&D PLAN ELEVATION, CONTACT ENGINEER BEFORE MOVING FORWARD.

GENERAL NOTES:

- ALL WORK DETAILED ON THESE PLANS TO BE PERFORMED UNDER THE CONTRACT SHALL, EXCEPT AS OTHERWISE STATED OR PROVIDED HEREIN, BE CONSTRUCTED IN ACCORDANCE WITH THE CITY OF ALBUQUERQUE STANDARD SPECIFICATIONS FOR PUBLIC WORKS, 1986 EDITION, UPDATE NO. 8 VOL. 1 AND 2 JANUARY 2011.
- THE EROSION PROTECTION SPECIFIED THIS PLAN IS THE MINIMUM RECOMMENDED. THE OWNER IS ENCOURAGED TO INCORPORATE EROSION RESISTANT LANDSCAPING ON AREAS WHERE EROSION MAY OCCUR SUCH AS SLOPES AND SWALES. THE OWNER IS RESPONSIBLE FOR THE INSTALLATION AND MAINTENANCE OF ALL EROSION CONTROL FEATURES NECESSARY TO PRESERVE THE DESIGN INTENT OF THE GRADING PLAN.
- THE DRAINAGE INFRASTRUCTURE SHOWN ON THIS PLAN IS THE RESPONSIBILITY OF THE PROPERTY OWNER.
- ALL DISTURBED AREAS OUTSIDE THE BUILDING PAD MUST BE RESEEDING OR LANDSCAPED.
- TWO (2) WORKING DAYS PRIOR TO ANY EXCAVATION, CONTRACTOR MUST CONTACT LINE LOCATING SERVICE, (260-1990) FOR LOCATION OF EXISTING UTILITIES.
- PRIOR TO CONSTRUCTION, THE CONTRACTOR SHALL EXCAVATE AND VERIFY THE HORIZONTAL AND VERTICAL LOCATIONS OF ALL OBSTRUCTIONS AND EXISTING PAVEMENT. SHOULD A CONFLICT EXIST, THE CONTRACTOR SHALL NOTIFY ENGINEER OR SURVEYOR SO THAT THE CONFLICT CAN BE RESOLVED WITH A MINIMUM OF DELAY.

NOTE:

THE ENGINEER HAS UNDERTAKEN LIMITED FIELD VERIFICATION OF THE LOCATION, DEPTH, SIZE, OR TYPE OF EXISTING UNDERGROUND UTILITY LINES, MAKES NO REPRESENTATION PERTAINING THERETO AND ASSUMES NO RESPONSIBILITY OR LIABILITY THEREFOR. THE CONTRACTOR SHALL INFORM ITSELF OF THE LOCATION OF ANY UTILITY LINE IN OR NEAR THE ARE OF WORK IN ADVANCE OF AND DURING EXCAVATION WORK. THE CONTRACTOR IS FULLY RESPONSIBLE FOR ANY AND ALL DAMAGE CAUSED BY ITS FAILURE TO LOCATE, IDENTIFY, AND PRESERVE ANY AND ALL EXISTING UTILITIES. THE CONTRACTOR SHALL COMPLY WITH STATE STATUTES, MUNICIPAL AND LOCAL ORDINANCES, IN PLANNING AND CONDUCTING EXCAVATION, WHETHER BY CALLING OR NOTIFYING THE UTILITIES, COMPLYING WITH "BLUE STAKES" PROCEDURES, OR OTHERWISE.

NOTE:

THESE DRAWINGS DO NOT INCLUDE THE NECESSARY COMPONENTS FOR CONSTRUCTION SAFETY WHICH SHALL REMAIN THE RESPONSIBILITY OF THE CONTRACTOR.

NOTE:

THIS DOCUMENT, AND THE IDEAS AND DESIGNS INCORPORATED HEREIN, ARE INTENDED FOR USE ON THIS PROJECT AND IS NOT TO BE USED, IN WHOLE OR IN PART, FOR ANY OTHER PROJECT WITHOUT THE WRITTEN AUTHORIZATION OF RESPEC INC. IN THE EVENT OF UNAUTHORIZED USE, THE USER ASSUMES ALL RESPONSIBILITY AND LIABILITY WHICH RESULTS.

EROSION CONTROL NOTES:

- THE CONTRACTOR IS RESPONSIBLE FOR OBTAINING A TOPSOIL DISTURBANCE PERMIT PRIOR TO BEGINNING OF WORK.
- CONTRACTOR IS RESPONSIBLE FOR MAINTAINING RUN-OFF ON SITE DURING CONSTRUCTION.
- CONTRACTOR IS RESPONSIBLE FOR CLEANING ALL SEDIMENT THAT GETS INTO EXISTING RIGHT-OF-WAY
- REPAIR OF DAMAGED FACILITIES AND CLEANUP OF SEDIMENT ACCUMULATIONS ON ADJACENT PROPERTIES AND IN PUBLIC FACILITIES IS THE RESPONSIBILITIES OF THE CONTRACTOR.
- ALL EXPOSED EARTH SURFACES MUST BE PROTECTED FROM WIND AND WATER EROSION PRIOR TO FINAL (CITY) ACCEPTANCE OF ANY PROJECT.

LEGEND

- TW = TOP OF WALL
- FG = FINISHED GROUND
- EG = EXISTING GROUND
- FL = FLOW LINE
- EOD = EDGE OF DRIVEWAY
- FP = FINISHED PAD
- TOB = TOP OF BERM

KEYED NOTES

- EXISTING PROPERTY LINE
- EXISTING 10' P.U.E.
- EXISTING STANDARD CURB AND GUTTER
- EXISTING SIDEWALK
- PAD EXTENTS
- HIGH POINT OF SWALE
- SWALE
- MATCH DRIVEWAY TO BACK OF EXISTING SIDEWALK
- IF PERIMETER WALL INSTALLED THEN PROVIDE TURNED BLOCK TO ALLOW FOR CROSS LOT DRAINAGE
- PROPOSED DRIVEWAY LOCATION. DRIVEWAY PERMIT BY OTHERS
- EXISTING WALL ADJACENT TO PROPERTY (RETAINING WALL MAY HAVE TO BE ADJUSTED WHEN EXISTING WALL ARE ENCOUNTERED.)
- EXISTING 7' P.U.E.
- 6" RIPRAP RUNDOWN

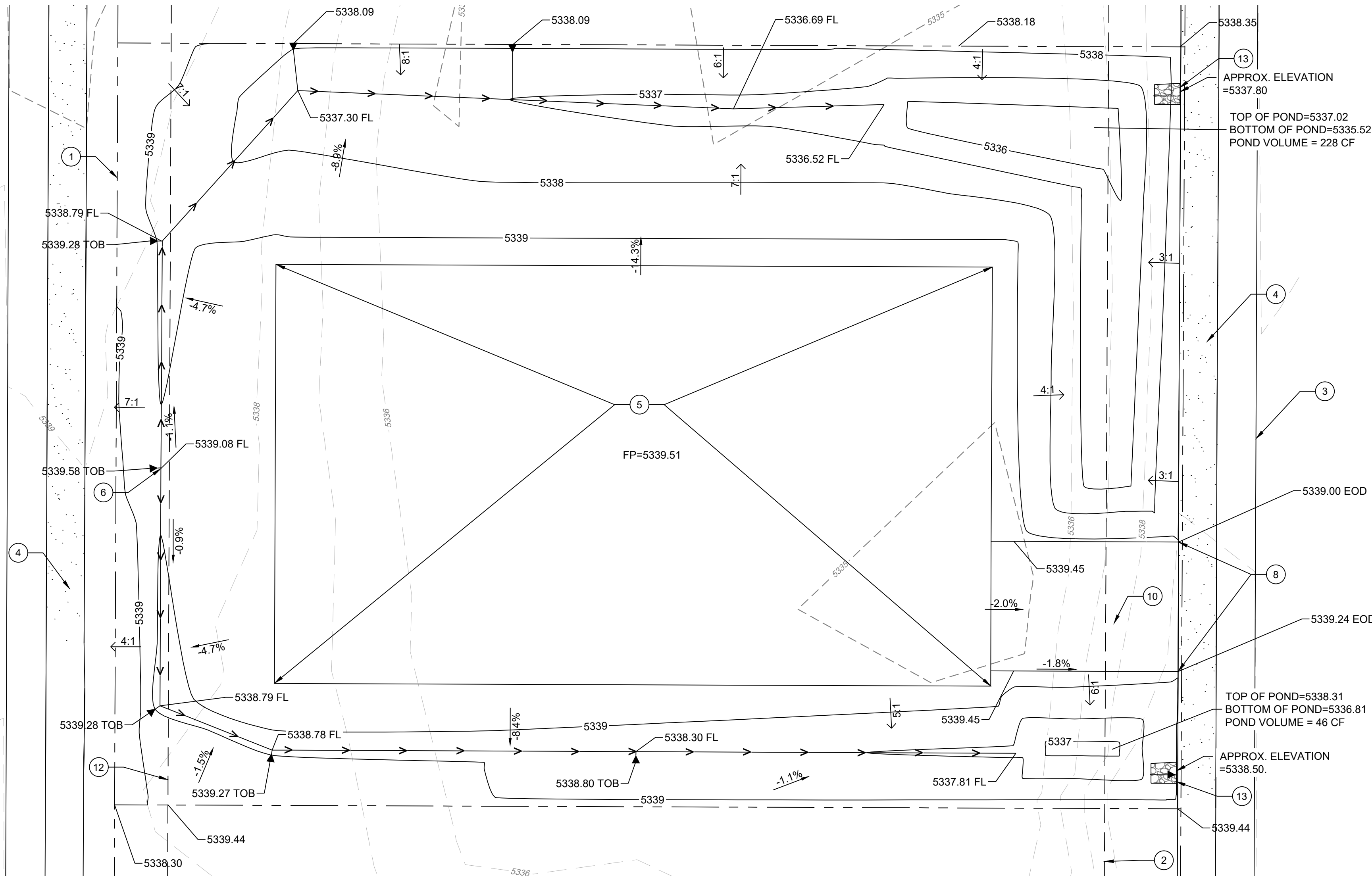
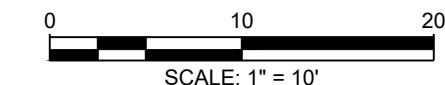

DESIGNED BY: RESPEC
 DRAWN BY: RESPEC
 CHECKED BY: RESPEC
 DATE: 10.29.2020

STAMP: SHELDON E. GREER, NEW MEXICO, 17154, 10/29/2020, PLS 5339

THIS DRAWING IS INCOMPLETE AND NOT TO BE USED FOR CONSTRUCTION UNLESS IT IS STAMPED, SIGNED AND DATED.

nm811
 Know what's below.
 Call before you dig.

PROJECT NAME:
**PETROGLYPH ESTATES
 8005 ALTO RAY CT
 PULTE ID 2**

SHEET TITLE:
**GRADING AND
 DRAINAGE PLAN**

SUBMITTED FOR:
GRADING PERMIT

SHEET NUMBER:
1 OF 1

NAME: L:\Active Projects\04197 Petroglyph Estates\3 DWG\Sheets\04197 Lot 2.dwg PLOT DATE: Oct 29, 2020 9:45am