

CITY OF ALBUQUERQUE

Planning Department
Brennon Williams, Director



Mayor Timothy M. Keller

June 21, 2021

Sheldon Greer, P.E.
RESPEC
5971 Jefferson St. NE Suite 101
Albuquerque, New Mexico 87109

**RE: Lot 22 Block 1 Volcano Cliffs Unit 22 SAD 228
8008 Agua Fria Ct. NW
Grading and Drainage Plan
Engineers Stamp Date: 10/29/2020 (D10D003N22)
Pad Certification Date: 5/10/21**

Mr. Greer,

PO Box 1293

Based upon the information provided in your submittal received 5/14/2021, this plan cannot be approved for Grading Permit until the following comments are addressed.

Albuquerque

- Provide the approval letter or email given by Doug Hughes.

NM 87103

If you have any questions, please contact me at 924-3986 or Rudy Rael at 924-3977.

Sincerely,

www.cabq.gov

Ernest Armijo, P.E.
Principal Engineer, Planning Dept.
Development Review Services



City of Albuquerque

Planning Department

Development & Building Services Division

DRAINAGE AND TRANSPORTATION INFORMATION SHEET (REV 11/2018)

Project Title: _____ **Building Permit #:** _____ **Hydrology File #:** _____

DRB#: _____ **EPC#:** _____ **Work Order#:** _____

Legal Description: _____

City Address: _____

Applicant: _____ **Contact:** _____

Address: _____

Phone#: _____ **Fax#:** _____ **E-mail:** _____

Owner: _____ **Contact:** _____

Address: _____

Phone#: _____ **Fax#:** _____ **E-mail:** _____

TYPE OF SUBMITTAL: _____ PLAT (____# OF LOTS) _____ RESIDENCE _____ DRB SITE _____ ADMIN SITE

IS THIS A RESUBMITTAL?: _____ Yes _____ No

DEPARTMENT: _____ TRAFFIC/ TRANSPORTATION _____ HYDROLOGY/ DRAINAGE

Check all that Apply:

TYPE OF SUBMITTAL:

- _____ ENGINEER/ARCHITECT CERTIFICATION
- _____ PAD CERTIFICATION
- _____ CONCEPTUAL G & D PLAN
- _____ GRADING PLAN
- _____ DRAINAGE MASTER PLAN
- _____ DRAINAGE REPORT
- _____ FLOODPLAIN DEVELOPMENT PERMIT APPLIC
- _____ ELEVATION CERTIFICATE
- _____ CLOMR/LOMR
- _____ TRAFFIC CIRCULATION LAYOUT (TCL)
- _____ TRAFFIC IMPACT STUDY (TIS)
- _____ OTHER (SPECIFY) _____
- _____ PRE-DESIGN MEETING?

TYPE OF APPROVAL/ACCEPTANCE SOUGHT:

- _____ BUILDING PERMIT APPROVAL
- _____ CERTIFICATE OF OCCUPANCY
- _____ PRELIMINARY PLAT APPROVAL
- _____ SITE PLAN FOR SUB'D APPROVAL
- _____ SITE PLAN FOR BLDG. PERMIT APPROVAL
- _____ FINAL PLAT APPROVAL
- _____ SIA/ RELEASE OF FINANCIAL GUARANTEE
- _____ FOUNDATION PERMIT APPROVAL
- _____ GRADING PERMIT APPROVAL
- _____ SO-19 APPROVAL
- _____ PAVING PERMIT APPROVAL
- _____ GRADING/ PAD CERTIFICATION
- _____ WORK ORDER APPROVAL
- _____ CLOMR/LOMR
- _____ FLOODPLAIN DEVELOPMENT PERMIT
- _____ OTHER (SPECIFY) _____

DATE SUBMITTED: _____ **By:** _____

COA STAFF:

ELECTRONIC SUBMITTAL RECEIVED: _____

FEE PAID: _____

Project Name: Petroglyph Estates
Project Address: 8008 Agua Fria CT
Pulte Site ID: Lot 22

Site Area (sq. ft.) 14000
House Area (sq. ft.) 5170
Driveway Area (sq. ft.) 500
Other Imp Area (sq. ft.) 1500
Total Imp. Area: 7170

	AREA (SF)	% AREA	Q100 (CFS/AC.)	Q100 (cfs)	DMP (%)	DMP (cfs)	DRAIN TO FRONT AREA (sq. ft.)	DRAIN TO REAR AREA (sq. ft.)	Q100 TO FRONT LOT (cfs)	Q100 TO REAR LOT (cfs)
A	0	0.0%	1.29	0.00	0.0%	0.00	0	0	0.00	0.00
B	3415	24.4%	2.03	0.16	10.0%	0.07	300	3115	0.01	0.15
C	3415	24.4%	2.87	0.23	40.0%	0.37	300	3115	0.02	0.21
D	7170	51.2%	4.37	0.72	50.0%	0.70	600	6570	0.06	0.66
TOTAL	14000	100.00%	1.10	1.14				12800	0.09	1.01

NOTES:
(1) Zone 1 - Table A-9 Albuquerque DPM
(2) Per Volcano Cliffs Drainage Management Plan
(3) Total Discharge
(4) Allowable Discharge

TABLE 2. WATER QUALITY STORM EVENT RUNOFF RATE AND VOLUME AS A PERCENT OF IMPERVIOUS AREA FOR 40-ACRE AND SMALLER SITES

Percent Impervious (%D)	Runoff Depth (inches)	Runoff Rate (cfs/ac)	Runoff Volume (cubic feet/ac)
0	0	0	0
20	0.09	0.5	327
40	0.18	0.8	653
60	0.27	1.2	980
80	0.36	1.35	1037
100	0.46	1.5	1670

Existing Conditions:
The existing site is not within a designated flood zone. The site surface drains to the northeast corner of the property.

Proposed Conditions:
The proposed site improvements will include the construction of a single family residence with landscaping and onsite improvements. In accordance with the SAD 228 drainage management plan, the runoff will free discharge allowable discharge. The allowable discharge was determined by analysis of the basin including the lot. The lot use percentages of the basin were apportioned between roadways and lots based on area. The roof, driveway, and an additional 1500 sq. ft. for structure improvements are included in the impervious area percentage for the lot.

PAD CERTIFICATION

I SHELTON GREER P.E., NMPE 17154, OF THE ENGINEERING FIRM RESPEC, HEREBY CERTIFY, BASED ON SURVEY DATA PROVIDED BY BRIAN MARTINEZ, NMRRS 18374, THAT THE AS CONSTRUCTED PAD ELEVATION IS WITHIN 0.2' OF THE DESIGN ELEVATION AND THAT THE HORIZONTAL LIMITS OF THE AS CONSTRUCTED PAD ARE AS SHOWN.

SHELTON E. GREER, PE 17154

5/10/2021
DATE



FIRM MAP:

35001C012G

VICINITY MAP:

D-10-Z

DESIGNED BY
DRAWN BY
CHECKED BY
DATE 5.24.2021

RESPEC
COMMUNITY DESIGN SOLUTIONS
5971 JEFFERSON STREET SUITE 101
DALLAS, TEXAS 75231
WWW.RESPEC.COM PHONE: (952) 533-9718

STAMP
SHELTON E. GREER
NEW MEXICO
17154
PE 5330

THIS DRAWING IS INCOMPLETE
AND NOT TO BE USED FOR
CONSTRUCTION UNLESS IT IS
STAMPED, SIGNED AND DATED

Cut/Fill Summary

Name	Cut Factor	Fill Factor	2d Area	Cut	Fill	Net
VOLUME	1.00	1.25	13912.54 Sq. Ft.	1.53 Cu. Yd.	2830.56 Cu. Yd.	2829.02 Cu. Yd.<Fill>
Totals			13912.54 Sq. Ft.	1.53 Cu. Yd.	2830.56 Cu. Yd.	2829.02 Cu. Yd.<Fill>

Runoff Vol. (per ac.)	0-20	20-40	40-60	60-80	80-100
51.2	0	0	836.4	0	0

Total Water Quality Volume Required: 269 cu. ft.
Provided: 915 cu. ft.
0.45 inches of runoff from Imp. Area

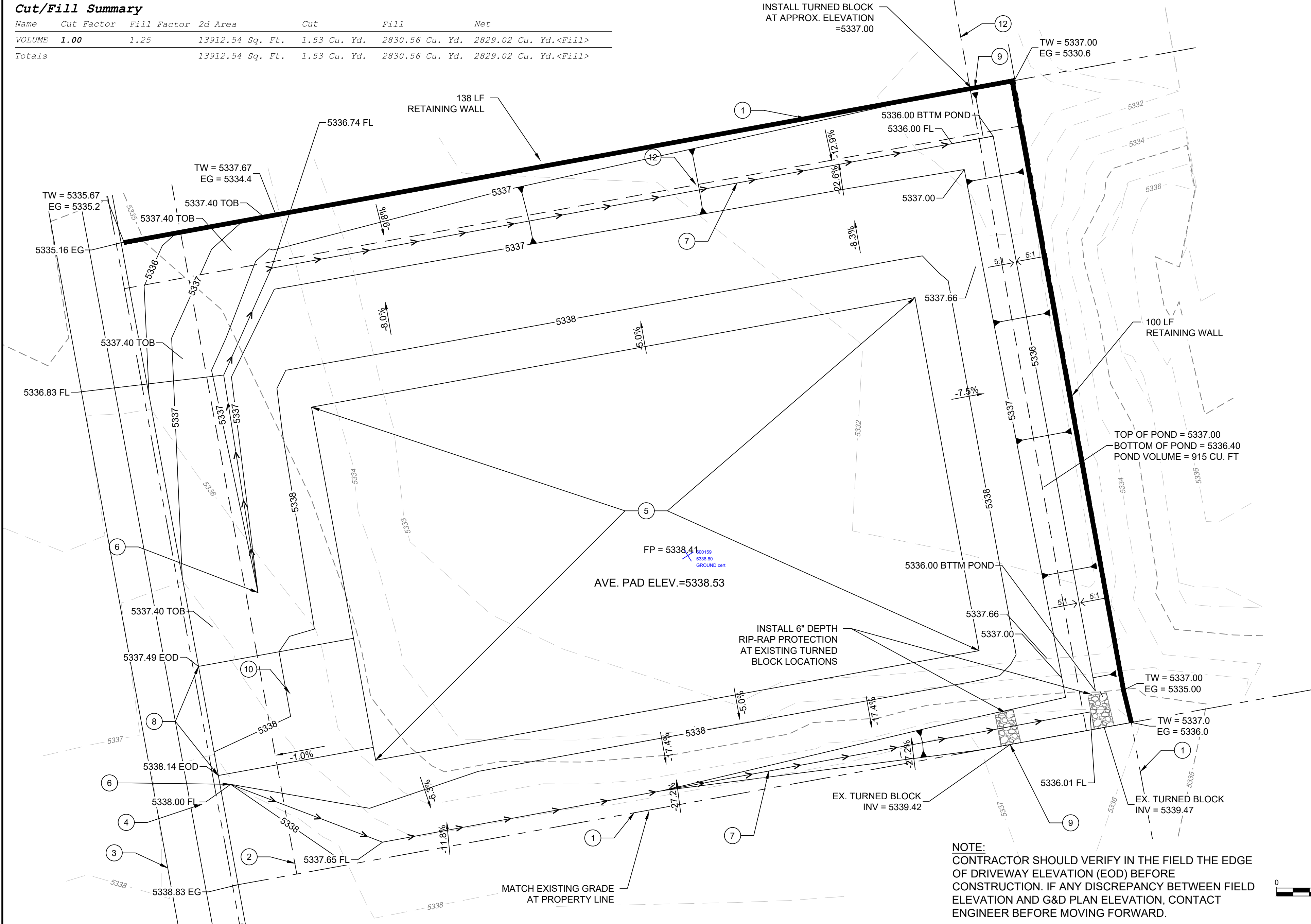

GENERAL NOTES:

- ALL WORK DETAILED ON THESE PLANS TO BE PERFORMED UNDER THE CONTRACT SHALL, EXCEPT AS OTHERWISE STATED OR PROVIDED HEREIN, BE CONSTRUCTED IN ACCORDANCE WITH THE CITY OF ALBUQUERQUE STANDARD SPECIFICATIONS FOR PUBLIC WORKS, 1986 EDITION, UPDATE NO. 8 VOL. 1 AND 2 JANUARY 2011.
- THE EROSION PROTECTION SPECIFIED THIS PLAN IS THE MINIMUM RECOMMENDED. THE OWNER IS ENCOURAGED TO INCORPORATE EROSION RESISTANT LANDSCAPING ON AREAS WHERE EROSION MAY OCCUR SUCH AS SLOPES AND SWALES. THE OWNER IS RESPONSIBLE FOR THE INSTALLATION AND MAINTENANCE OF ALL EROSION CONTROL FEATURES NECESSARY TO PRESERVE THE DESIGN INTENT OF THE GRADING PLAN.
- THE DRAINAGE INFRASTRUCTURE SHOWN ON THIS PLAN IS THE RESPONSIBILITY OF THE PROPERTY OWNER.
- ALL DISTURBED AREAS OUTSIDE THE BUILDING PAD MUST BE RESEEDDED OR LANDSCAPED.
- TWO (2) WORKING DAYS PRIOR TO ANY EXCAVATION, CONTRACTOR MUST CONTACT LINE LOCATING SERVICE, (260-1990) FOR LOCATION OF EXISTING UTILITIES.
- PRIOR TO CONSTRUCTION, THE CONTRACTOR SHALL EXCAVATE AND VERIFY THE HORIZONTAL AND VERTICAL LOCATIONS OF ALL OBSTRUCTIONS AND EXISTING PAVEMENT. SHOULD A CONFLICT EXIST, THE CONTRACTOR SHALL NOTIFY ENGINEER OR SURVEYOR SO THAT THE CONFLICT CAN BE RESOLVED WITH A MINIMUM OF DELAY.
- GRADING SHOWN HEREIN ASSUMES THE CONCURRENT GRADING OF THE ADJACENT LOTS BELONGING TO THE SAME PROPERTY OWNER.

NOTE:

THE ENGINEER HAS UNDERTAKEN LIMITED FIELD VERIFICATION OF THE LOCATION, DEPTH, SIZE, OR TYPE OF EXISTING UNDERGROUND UTILITY LINES, MAKES NO REPRESENTATION PERTAINING THERETO AND ASSUMES NO RESPONSIBILITY OR LIABILITY THEREFOR. THE CONTRACTOR SHALL INFORM ITSELF OF THE LOCATION OF ANY UTILITY LINE IN OR NEAR THE ARE OF WORK IN ADVANCE OF AND DURING EXCAVATION WORK. THE CONTRACTOR IS FULLY RESPONSIBLE FOR ANY AND ALL DAMAGE CAUSED BY ITS FAILURE TO LOCATE, IDENTIFY, AND PRESERVE ANY AND ALL EXISTING UTILITIES. THE CONTRACTOR SHALL COMPLY WITH STATE STATUTES, MUNICIPAL AND LOCAL ORDINANCES, IN PLANNING AND CONDUCTING EXCAVATION, WHETHER BY CALLING OR NOTIFYING THE UTILITIES, COMPLYING WITH "BLUE STAKES" PROCEDURES, OR OTHERWISE.

NOTE:

THESE DRAWINGS DO NOT INCLUDE THE NECESSARY COMPONENTS FOR CONSTRUCTION SAFETY WHICH SHALL REMAIN THE RESPONSIBILITY OF THE CONTRACTOR.

NOTE:

THIS DOCUMENT, AND THE IDEAS AND DESIGNS INCORPORATED HEREIN, ARE INTENDED FOR USE ON THIS PROJECT AND IS NOT TO BE USED, IN WHOLE OR IN PART, FOR ANY OTHER PROJECT WITHOUT THE WRITTEN AUTHORIZATION OF RESPEC INC. IN THE EVENT OF UNAUTHORIZED USE, THE USER ASSUMES ALL RESPONSIBILITY AND LIABILITY WHICH RESULTS.

EROSION CONTROL NOTES:

- THE CONTRACTOR IS RESPONSIBLE FOR OBTAINING A TOPSOIL DISTURBANCE PERMIT PRIOR TO BEGINNING OF WORK.
- CONTRACTOR IS RESPONSIBLE FOR MAINTAINING RUN-OFF ON SITE DURING CONSTRUCTION.
- CONTRACTOR IS RESPONSIBLE FOR CLEANING ALL SEDIMENT THAT GETS INTO EXISTING RIGHT-OF-WAY
- REPAIR OF DAMAGED FACILITIES AND CLEANUP OF SEDIMENT ACCUMULATIONS ON ADJACENT PROPERTIES AND IN PUBLIC FACILITIES IS THE RESPONSIBILITIES OF THE CONTRACTOR.
- ALL EXPOSED EARTH SURFACES MUST BE PROTECTED FROM WIND AND WATER EROSION PRIOR TO FINAL (CITY) ACCEPTANCE OF ANY PROJECT.

LEGEND

TW = TOP OF WALL
BW = BOTTOM OF WALL
FG = FINISHED GROUND
EG = EXISTING GROUND
FL = FLOW LINE
EOD = EDGE OF DRIVEWAY
FP = FINISHED PAD
TOB = TOP OF BERM
RETAINING WALL
TOP OF BERM

KEYED NOTES

- EXISTING PROPERTY LINE
- EXISTING 10' P.U.E.
- EXISTING STANDARD CURB AND GUTTER
- EXISTING SIDEWALK
- PAD EXTENTS
- HIGH POINT OF SWALE
- SWALE
- MATCH DRIVEWAY TO BACK OF EXISTING SIDEWALK
- IF PERIMETER WALL IS INSTALLED THEN PROVIDE TURNED BLOCK TO ALLOW FOR CROSS LOT DRAINAGE.
- PROPOSED DRIVEWAY LOCATION. DRIVEWAY PERMIT BY OTHERS
- EXISTING WALL ADJACENT TO PROPERTY (RETAINING WALL MAY HAVE TO BE ADJUSTED WHEN EXISTING WALL ARE ENCOUNTERED.)
- EXISTING 7' P.U.E.
- 6" RIPRAP RUNDOWN

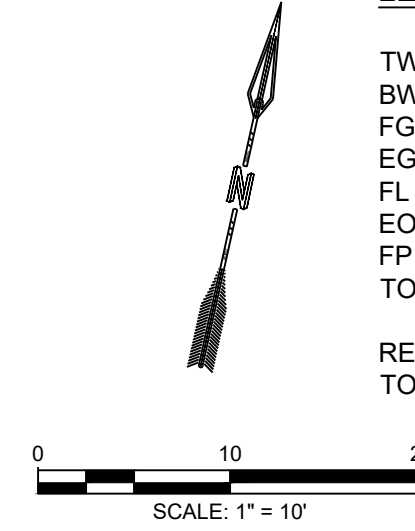

NAME: N:\Projects\04-197 Pulte\04-197.001 Petroglyph Estates\3_DWG\Sheets\Pad Certification\04197 Lot 22.dwg PLOT DATE: May 24, 2021 9:51am

PROJECT NAME:
PETROGLYPH ESTATES
8008 AGUA FRIA CT
PULTE ID 22

SHEET TITLE:
GRADING AND
DRAINAGE PLAN

SUBMITTED FOR:
PAD CERTIFICATION

SHEET NUMBER:
1 OF 1