

CITY OF ALBUQUERQUE

Planning Department
Suzanne Lubar, Director



Mayor Richard J. Berry

May 2, 2016

Steve Metro, P.E.
Metro Development Inc.
8860 Desert Finch Ln. NE
Albuquerque, New Mexico 87122

RE: **Block 1 Lot 23 Unit 22 Volcano Cliffs SAD 228**
8004 Agua Fria Ct. NW
Grading and Drainage Plan
Engineers Stamp Date 4/29/16 (D10D003N23)

Dear Mr. Metro,

Based upon the information provided in your submittal received 4/29/2016, this plan is approved for Grading Permit and Building Permit.

Please inform the Architect/Owner or contractor to attach a copy of this approved plan dated 4/29/16 to the construction sets in the permitting process prior to sign-off by Hydrology, otherwise the permitting process will be delayed until this plan is provided. Also advise the owner/contractor that a separate wall permit will be needed.

Prior to Certificate of Occupancy release, Engineer Certification per the DPM checklist will be required.

If you have any questions, please contact me at 924-3695 or Rudy Rael at 924-3977.

Sincerely,

Rita Harmon, P.E.
Senior Engineer, Hydrology
Planning Department

RR/RH
C: File



City of Albuquerque

Planning Department

Development & Building Services Division

DRAINAGE AND TRANSPORTATION INFORMATION SHEET (REV 09/2015)

Project Title: 8004 Agua Fria Ct, NW G+D Plan Building Permit #: _____ City Drainage #: _____

DRB#: _____ EPC#: _____ Work Order#: _____

Legal Description: Lot 23, Block F, Unit 22 Volcano Cliffs Subdivision

City Address: 8004 Agua Fria Ct, NW

Engineering Firm: Metro Development, Inc. Contact: Steve Metro

Address: 8860 Desert Pkwy NE, Albuquerque, NM 87122

Phone#: 505-280-4553 Fax#: _____ E-mail: steve.metro@wilsonco.com

Owner: ABRAZO HOMES Contact: Mackenzie Bishop

Address: PO Box 65808

Phone#: 505-249-0915 Fax#: _____ E-mail: Mackenzie@abrazohomes.com

Architect: _____ Contact: _____

Address: _____

Phone#: _____ Fax#: _____ E-mail: _____

Other Contact: _____ Contact: _____

Address: _____

Phone#: _____ Fax#: _____ E-mail: _____

Check all that Apply:

DEPARTMENT:

- ☒ HYDROLOGY/ DRAINAGE
☐ TRAFFIC/ TRANSPORTATION
☐ MS4/ EROSION & SEDIMENT CONTROL

TYPE OF SUBMITTAL:

- ☐ ENGINEER/ ARCHITECT CERTIFICATION
☐ CONCEPTUAL G & D PLAN
☒ GRADING PLAN
☐ DRAINAGE MASTER PLAN
☐ DRAINAGE REPORT
☐ CLOMR/LOMR
☐ TRAFFIC CIRCULATION LAYOUT (TCL)
☐ TRAFFIC IMPACT STUDY (TIS)
☐ EROSION & SEDIMENT CONTROL PLAN (ESC)
☐ OTHER (SPECIFY) _____

CHECK TYPE OF APPROVAL/ACCEPTANCE SOUGHT:

- ☒ BUILDING PERMIT APPROVAL
☐ CERTIFICATE OF OCCUPANCY
☐ PRELIMINARY PLAT APPROVAL
☐ SITE PLAN FOR SUB'D APPROVAL
☐ SITE PLAN FOR BLDG. PERMIT APPROVAL
☐ FINAL PLAT APPROVAL
☐ SIA/ RELEASE OF FINANCIAL GUARANTEE
☐ FOUNDATION PERMIT APPROVAL
☐ GRADING PERMIT APPROVAL
☐ SO-19 APPROVAL
☐ PAVING PERMIT APPROVAL
☐ GRADING/ PAD CERTIFICATION
☐ WORK ORDER APPROVAL
☐ CLOMR/LOMR
☐ PRE-DESIGN MEETING
☐ OTHER (SPECIFY) _____

IS THIS A RESUBMITTAL?: ☐ Yes ☒ No

DATE SUBMITTED: 4-29-16 By: Steven Metro

COA STAFF: _____ ELECTRONIC SUBMITTAL RECEIVED _____

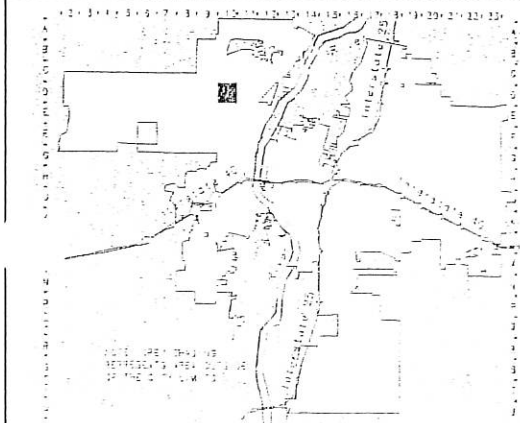
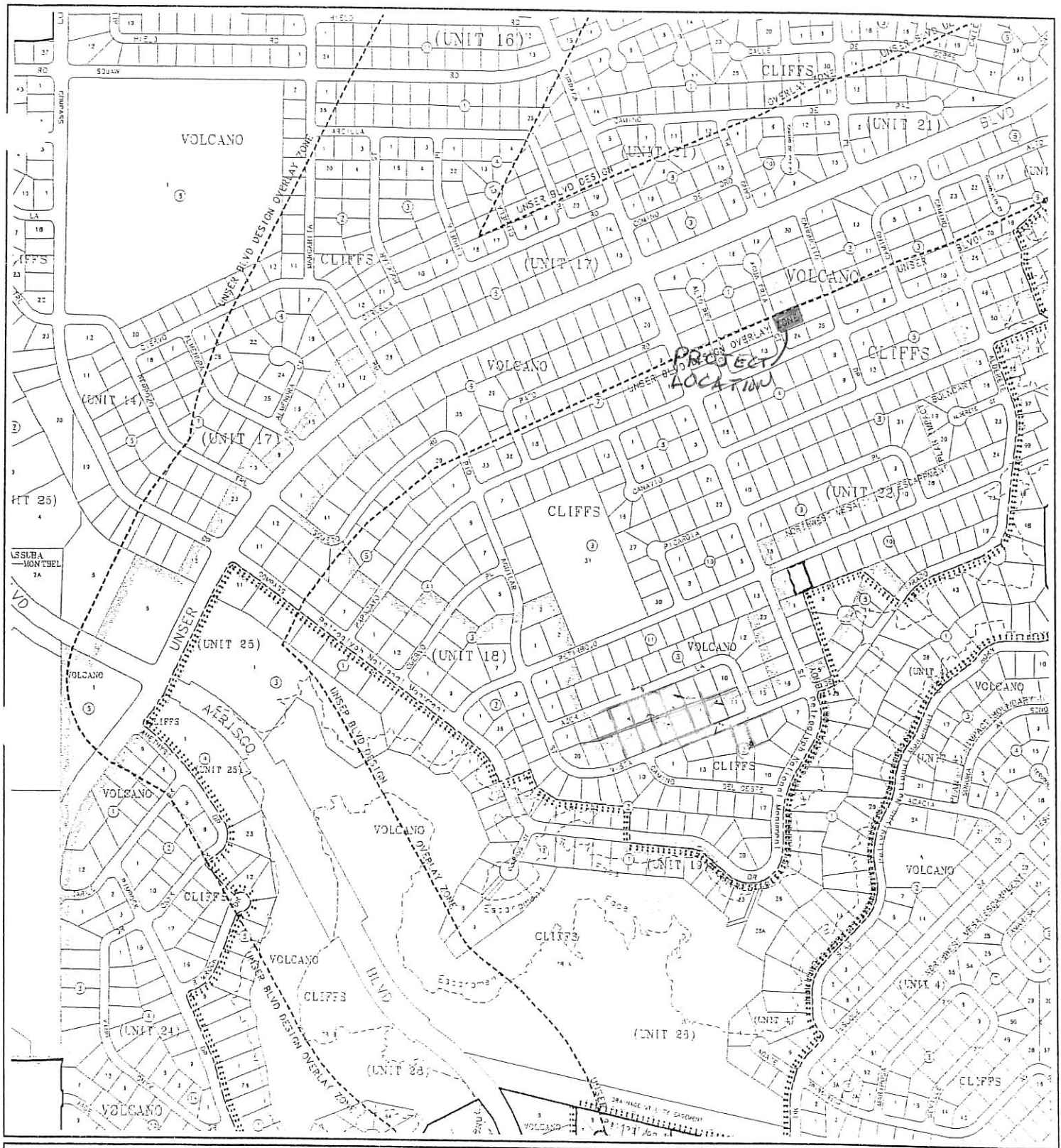

CITY OF
Albuquerque

A G I S
ALBUQUERQUE
PLANNING DEPARTMENT

© Copyright 2003

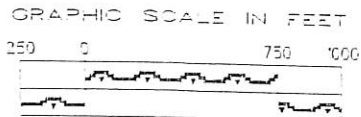

Zone Atlas Page

D-10-Z

Map Amended through January 21, 2003

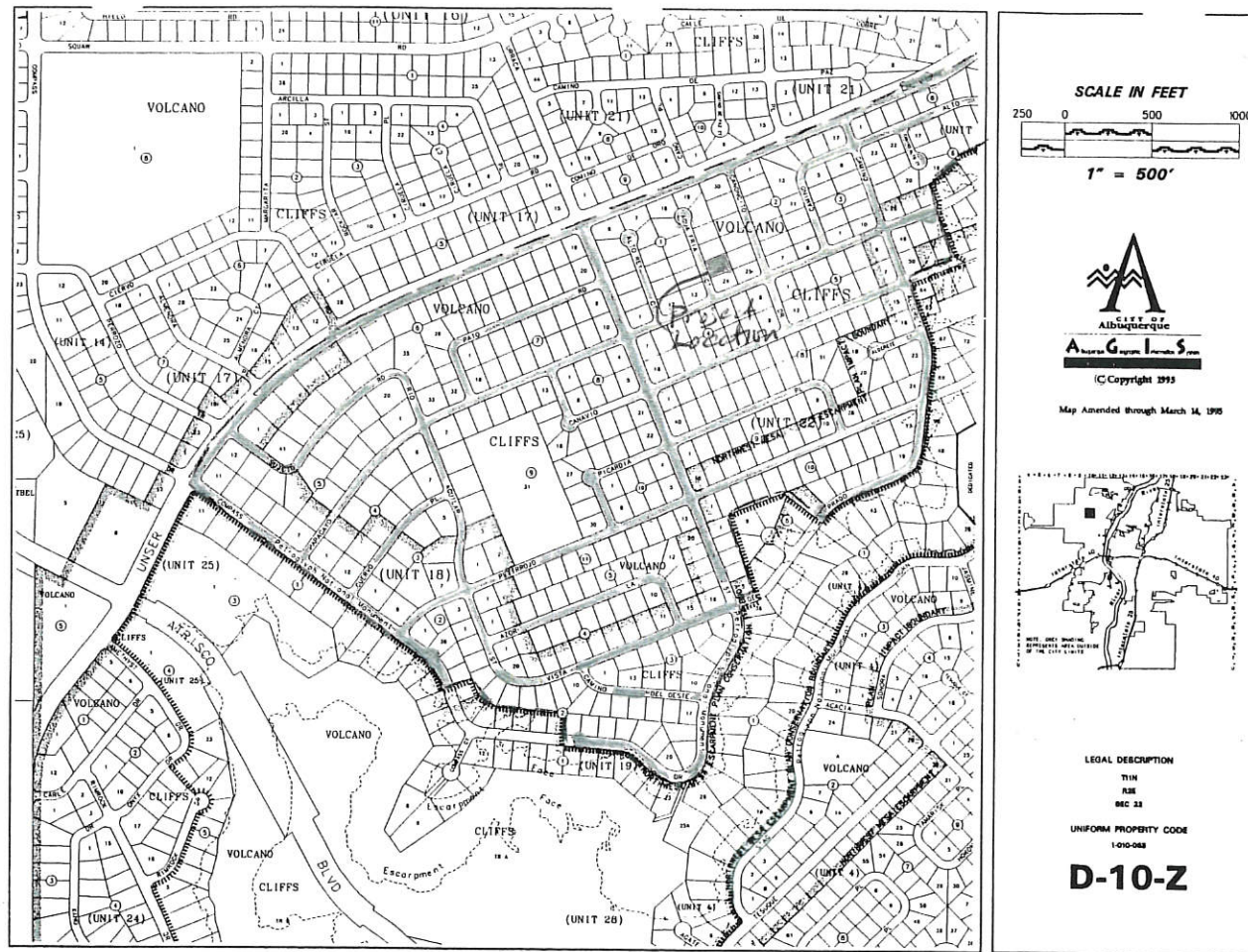

VICINITY MAP

Narrative

Grading and Drainage Plan for the construction of the building pad for Lot 23, Block 1, Unit 22, Volcano Cliffs Subdivision, being a part of SAD 228.

Address: 8004 Agua Fria Ct, NW Albuquerque, NM

Purpose of this Plan is to establish the first floor elevation, house layout, lot drainage including offsite flows.

First Flush per EPA Standards

The Initial First Flush to be managed is 0.44" less 0.10" initial impervious abstraction = 0.34" or 340 cubic feet. The initial storage on site will be collected and held in the two landscape ponds near the street as shown on the Plan.



FEMA MAP



METRO
Development, Inc.
8860 Desert Finch Ln NE
Albuquerque, NM 87122
(505) 280-4553

GRADING AND DRAINAGE PLAN
LOT 23 , BLOCK 1 , UNIT 22 , VCS
ADDRESS: 8004 Agua Fria Ct NW

