



***Planning Department
Transportation Development Services***

September 24, 2015

Don Dudley
Dudley Architects
400 Gold Ave., SW Studio 850
Albuquerque, NM

**Re: Marie Hughes Elementary School
5701 Mojave, NW
Traffic Circulation Layout**
Engineer's/Architect's Stamp dated 8-10-15 (D11-D007)

Dear Mr. Dudley,

The TCL submittal received 9-22-15 approved for Building Permit. A copy of the stamped and signed plan will be needed for each of the building permit plans. Please keep the original to be used for certification of the site for final C.O. for Transportation.

When the site construction is completed and a Certificate of Occupancy (C.O.) is requested, use the original City stamped approved TCL for certification. Redline any minor changes and adjustments that were made in the field. A NM registered architect or engineer must stamp, sign, and date the certification TCL along with indicating that the development was built in "substantial compliance" with the TCL. Submit this certification TCL with a completed Drainage and Transportation Information Sheet to front counter personnel for log in and evaluation by Transportation.

Once verification of certification is completed and approved, notification will be made to Building Safety to issue Final C.O. To confirm that a final C.O. has been issued, call Building Safety at 924-3690.

Sincerely,

Racquel M. Michel, P.E.
Traffic Engineer, Planning Dept.
Development Review Services

\gs via: email
C: CO Clerk, File



City of Albuquerque

Planning Department

Development & Building Services Division

DRAINAGE AND TRANSPORTATION INFORMATION SHEET (REV 09/2015)

Project Title: MARIE HUGHES ELEM. SCH. Building Permit #: _____ City Drainage #: D11D007

DRB#: _____ EPC#: _____ Work Order#: _____

Legal Description: _____

City Address: 5701 MOSAIC, NW ABQ, NM 87120

Engineering Firm: _____ Contact: _____

Address: _____

Phone#: _____ Fax#: _____ E-mail: _____

Owner: _____ Contact: _____

Address: _____

Phone#: _____ Fax#: _____ E-mail: _____

Architect: DUDLEY ARCHITECTS Contact: DON DUDLEY

Address: 400 GOLD AVE, SW # STUDIO 850 ABQ, NM

Phone#: 243-8100 Fax#: _____ E-mail: dondudley@donaldudleydesign.com

Other Contact: _____ Contact: _____

Address: _____

Phone#: _____ Fax#: _____ E-mail: _____

Check all that Apply:

DEPARTMENT:

- ☐ HYDROLOGY/ DRAINAGE
☐ TRAFFIC/ TRANSPORTATION
☐ MS4/ EROSION & SEDIMENT CONTROL

TYPE OF SUBMITTAL:

☐ ENGINEER/ ARCHITECT CERTIFICATION

☐ CONCEPTUAL G & D PLAN

☐ GRADING PLAN

☐ DRAINAGE MASTER PLAN

☐ DRAINAGE REPORT

☐ CLOMR/LOMR

☒ TRAFFIC CIRCULATION LAYOUT (TCL) REV.

☐ TRAFFIC IMPACT STUDY (TIS)

☐ EROSION & SEDIMENT CONTROL PLAN (ESC)

☐ OTHER (SPECIFY) _____

IS THIS A RESUBMITTAL? ☒ Yes ☐ No

DATE SUBMITTED: 9/22/15 By: DON DUDLEY

COA STAFF: _____ ELECTRONIC SUBMITTAL RECEIVED: _____

CHECK TYPE OF APPROVAL/ACCEPTANCE SOUGHT:

- ☒ BUILDING PERMIT APPROVAL
☐ CERTIFICATE OF OCCUPANCY

- ☐ PRELIMINARY PLAT APPROVAL
☐ SITE PLAN FOR SUB'D APPROVAL
☐ SITE PLAN FOR BLDG. PERMIT APPROVAL
☐ FINAL PLAT APPROVAL
☐ SIA/ RELEASE OF FINANCIAL GUARANTEE
☐ FOUNDATION PERMIT APPROVAL
☐ GRADING PERMIT APPROVAL
☐ SO-19 APPROVAL
☐ PAVING PERMIT APPROVAL
☐ GRADING/ PAD CERTIFICATION
☐ WORK ORDER APPROVAL
☐ CLOMR/LOMR

- ☐ PRE-DESIGN MEETING
☐ OTHER (SPECIFY) _____

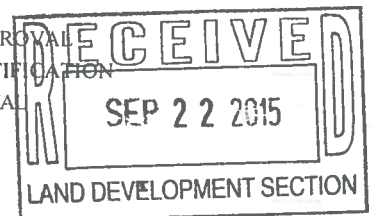

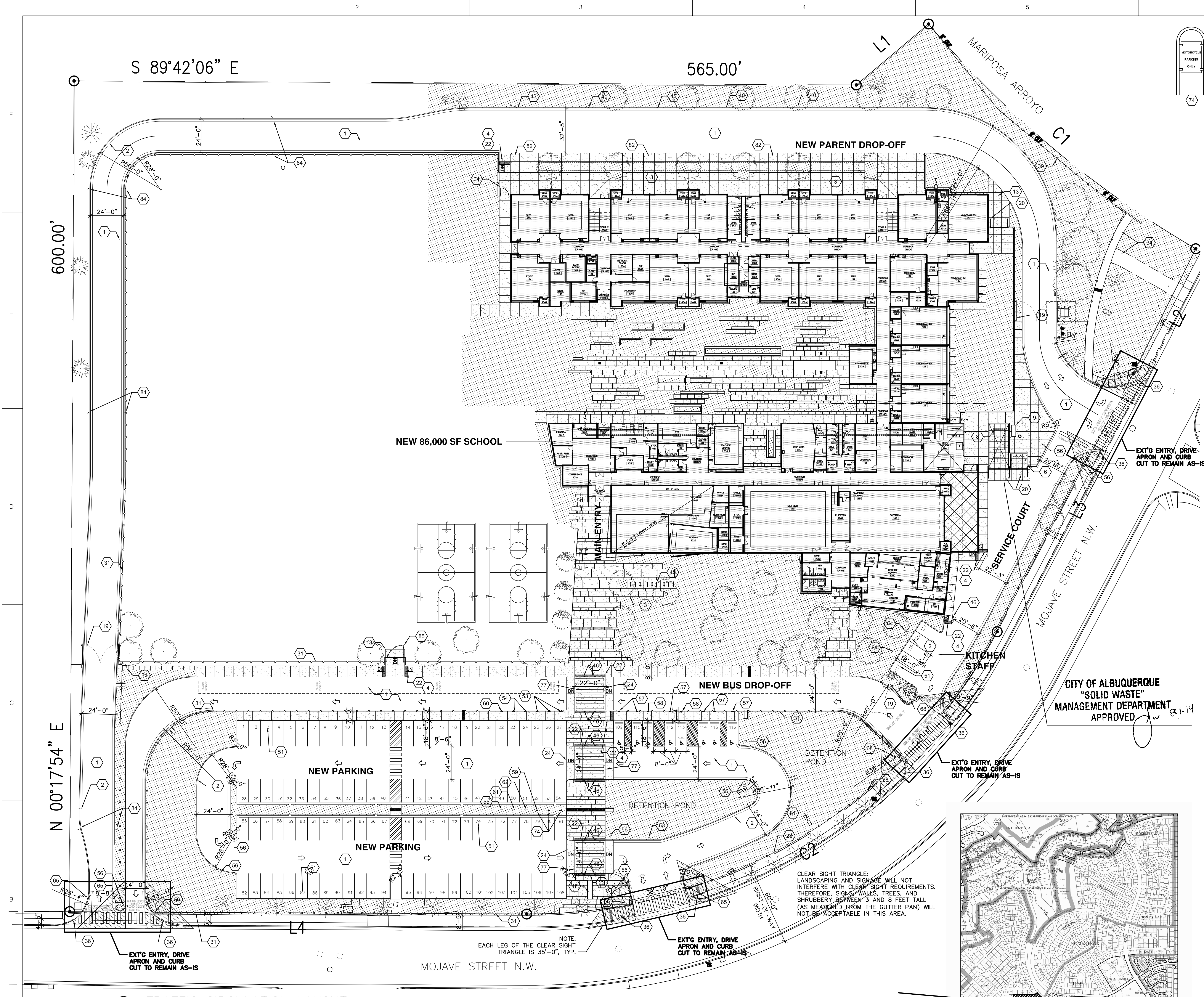

S 89°42'06" E

565.00'

600.00'

N 00°17'54" E

B1 TRAFFIC CIRCULATION LAYOUT
1"=30'-0"

PARKING ANALYSIS

REQUIRED FOR ELEMENTARY SCHOOL (14-16-3-1.28): ONE SPACE FOR EACH EMPLOYEE
CURRENT NUMBER OF STAFF: 60
REQUIRED NUMBER OF SPACES: 60
REQUIRED NUMBER OF DISABLED SPACES: 4 (FOR 51-100 SPACES)
REQUIRED NUMBER OF BICYCLE SPACES: 30 (1 PER 20 STUDENTS)
REQUIRED NUMBER OF MOTORCYCLE SPACES: 3 (FOR 21-100 SPACES)

PARKING		DISABLED BICYCLES		MOTORCYCLE	
REQUIRED	60	4	30	3	3
PROVIDED	118	8 (2 VAN)	30	3	3

NOTE:
ALL DRIVEWAYS AND ADA SIDEWALKS & PATHWAYS IN THE CITY RIGHT-OF-WAY WERE REVIEWED ON-SITE BY JEANNE WOLFENBERGER, C.O.A. 5/21/2015. ALL DEFICIENCIES HAVE BEEN ADDRESSED AND ALL MEET CURRENT CODE.

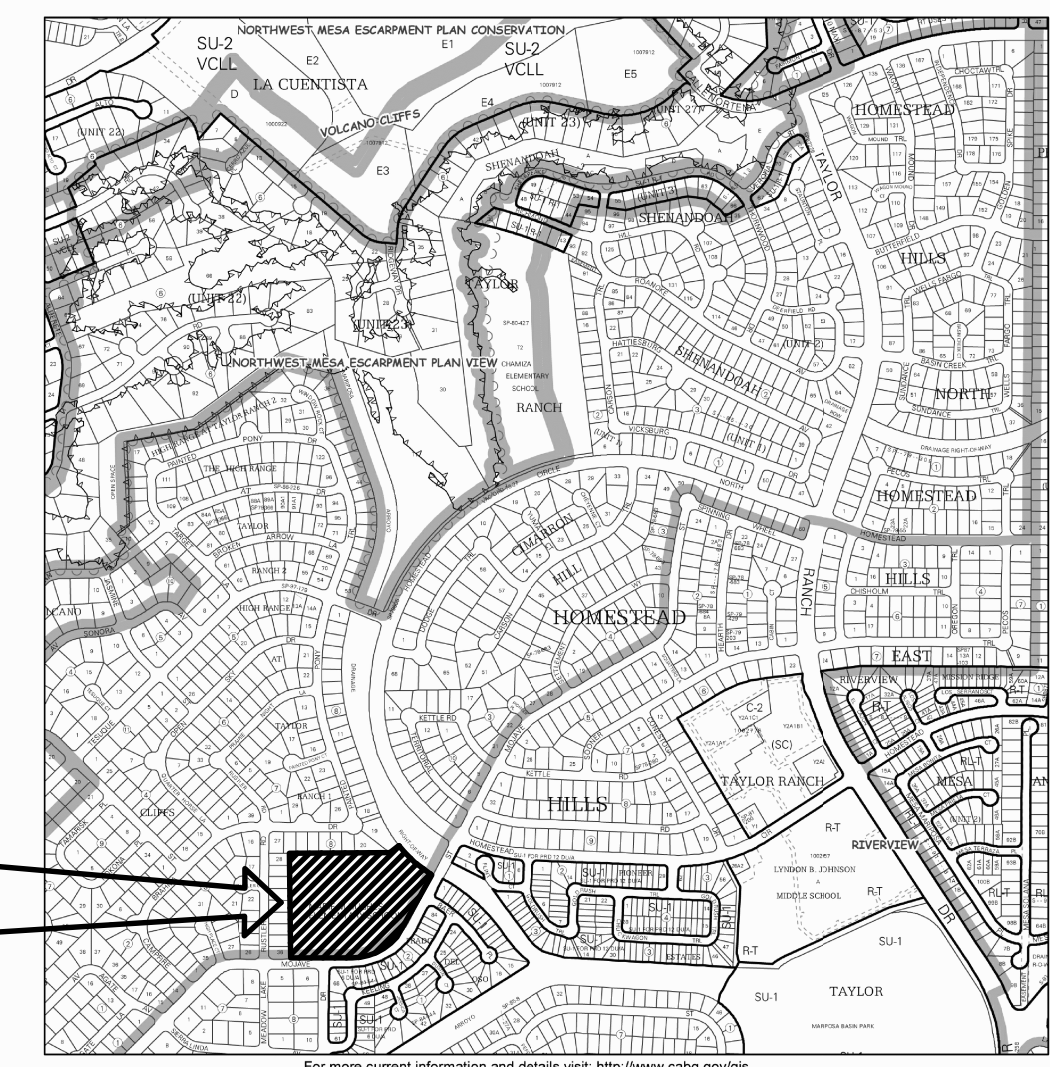

PROPERTY INFORMATION

PROPERTY ADDRESS: 5701 MOJAVE STREET NE ALBUQUERQUE, NM 87120
ZONING: R-1
ZONE MAP PAGE: D-11-Z

GENERAL SHEET NOTES

- A. DO NOT SCALE DRAWINGS.
- B. CONTRACTOR TO COORDINATE ALL DRAWINGS PRIOR TO CONSTRUCTION.
- C. VERIFY EXISTING CONDITIONS IN FIELD. BRING DISCREPANCIES TO ATTENTION OF ARCHITECT.
- D. DEMOLITION DIMENSIONS ARE APPROXIMATE AND SHOULD BE CROSS-REFERENCED WITH CIVIL AND ARCH.
- E. SITE PRIOR TO EXECUTING WORK.
- F. SEE AD-101 FOR PROTECTION OF TREES

SHEET KEYNOTES

1. NEW ASPHALT PAVING AND PARKING LOT STRIPING AS INDICATED
2. NEW CONCRETE CURB, SEE A1/AS-101
3. 3000 PSI, AIR ENTRAINED CONCRETE PAVING
4. ADA CURB RAMP, MAX SLOPE 1:12
5. not used
6. DUMPSTER ENCLOSURE, SEE E2/AS-202
7. not used
8. NEW TRASH COMPACTOR ENCLOSURE, SEE E2/AS-202.
9. NEW HOTBOX, SEE CIVIL
10. NEW REMOTE STANDPIPE CONNECTION, SEE FIRE PROTECTION DRAWINGS.
11. NEW TRANSFORMER WITH CONCRETE PAD AND BOLLARDS, SEE SITE UTILITY PLAN.
12. NEW REINF. CONCRETE APRON AND DRIVE PAD, 6" THICK. TIE INTO EXT'G ADJ. CONCRETE.
13. NEW FDC. SEE FIRE PROTECTION DRAWINGS.
14. not used
15. not used
16. not used
17. not used
18. not used
19. NEW PIPE GATE, SEE D5/AS-201.
20. NEW STEEL GATE. SEE ENLARGED SITE PLANS.
21. not used
22. CAST IN PLACE, MECHANICALLY FASTENED DARK RED TRUNCATED DOME DETECTABLE WARNING TILE. APPLY CONTINUOUS URETHANE SEALANT AROUND ALL EDGES.
23. not used
24. SPEED TABLE.
25. not used
26. not used
27. not used
28. EXISTING METAL FENCE. LENGTH OF FENCE ALONG CITY SIDEWALK TO REMAIN AND TO BE RE-PAINTED WITH COLOR AS DIRECTED BY ARCHITECT.
29. not used
30. not used
31. CHAIN LINK FENCE, 48" HIGH. SEE SPECIFICATIONS.
32. not used
33. not used
34. EXISTING WALKWAY TO REMAIN
35. not used
36. EXISTING ADA CURB CUT TO REMAIN
37. not used
38. not used
39. EXISTING CHAIN LINK FENCE TO REMAIN
40. not used
41. not used
42. ADHESIVE LETTER COLORS AS DIRECTED BY ARCHITECT.
43. not used
44. not used
45. NEW BIKE RACK (4 PER LOOP), SEE B1/AS-201.
46. NEW STEEL BOLLARD, SEE A1/AS-202. GENERAL CONTRACTOR TO ENSURE THAT ALL BOLLARDS ON-SITE MATCH IN APPEARANCE WITH DETAILING AS SHOWN IN DRAWINGS.
47. MONUMENT SIGN, SEE E1/AS-203.
48. not used
49. not used
50. not used
51. PARKING SPACE NUMBER FOR ILLUSTRATIVE PURPOSES ONLY. TYP. STRIPING NOT REQ'D.
52. not used
53. SIGN - RESERVED FOR PRINCIPAL
54. SIGN - RESERVED FOR APS PERSONNEL
55. SIGN - RESERVED FOR W&O PERSONNEL
56. SIGN - DO NOT ENTER/EXIT ONLY (COORDINATE WITH ASPHALT STRIPING)
57. SIGN - ACCESSIBLE PARKING. CONFORM TO NMSA REQUIREMENTS.
58. SIGN - VAN ACCESSIBLE HANDICAP PARKING. CONFORM TO NMSA REQUIREMENTS.
59. SIGN - VISITOR PARKING
60. SIGN - RESERVED FOR A.P.D.
61. SIGN - RESERVED FOR EMERGENCY PERSONNEL
62. SIGN - RESERVED FOR MEDICAL PERSONNEL
63. SIGN - ONE WAY (ARROW POINT RIGHT)
64. SIGN - RESERVED FOR KITCHEN STAFF
65. SIGN - ENTER
66. SIGN - AUTHORIZED PERSONNEL ONLY
67. SIGN - DO NOT ENTER (COORDINATE WITH ASPHALT STRIPING)
68. SIGN - AUTHORIZED PERSONNEL ONLY
69. 1 1/2" O.D. STANDARD STEEL TUBING
70. SIGN ON EXPOSED 18 GA. S.S.- NMBC APPROVED.
71. 1"x2"x1/8" STEEL TABS WELDED TO PIPE.
72. CONCRETE FOOTING AS INDICATED.
73. NELSON STUD.
74. SIGN - MOTORCYCLE PARKING ONLY
75. not used
76. not used
77. BLACK STRIPING ON LIGHT CONCRETE SPEED TABLE AS INDICATED.
78. not used
79. not used
80. not used
81. ELECTRICAL STUB OUT FOR FUTURE MARQUEE SIGN
82. SIGN - PARENT DROP-OFF/PICK-UP
83. not used
84. SIGN - FIRE LANE/NO PARKING
85. NEW VEHICLE GATE. SEE GATE SCHEDULE AS-204.
86. not used
87. not used
88. not used
89. not used
90. not used

A8 SIGNAGE
1/2"=1'-0"

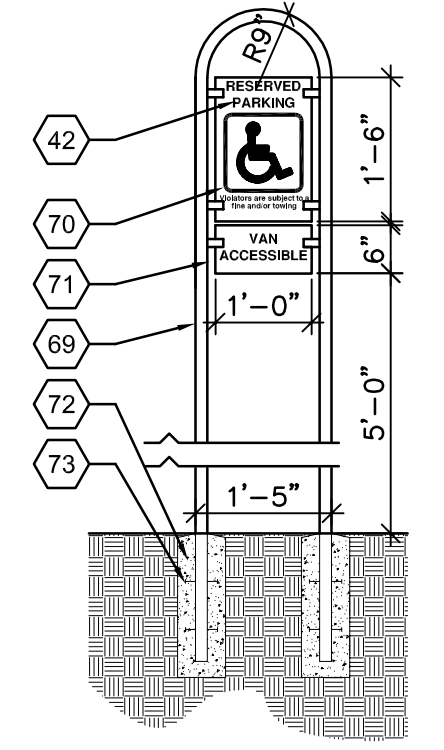

A8 SIGN MOUNT, TYP.
1/2"=1'-0"

LEGEND

- ASPHALT PAVING
- CONCRETE PAVING
- LANDSCAPED AREA

SIMMS TOWER STUDIO 850
400 GOLD AVENUE SW
ALBUQUERQUE, NEW MEXICO
87102
505.243.8100
studio@simmsdesign.com

G. DONALD DUDLEY AIA
400 GOLD AVENUE SW
ALBUQUERQUE, NEW MEXICO
87102
505.243.8100
gdd@simmsdesign.com

ARCHITECT

ARCHITECTURE • INTERIORS • PLANNING
AIA • NCARB • LEED AP

OF NEW MEXICO
DONALD DUDLEY JR.
No. 3873
8/10/2015
REGISTERED

PUBLIC SCHOOL • DONALD DUDLEY JR.
CAPITAL

ALBUQUERQUE
PUBLIC SCHOOLS
Expect Great Things!

AP

MARIE HUGHES
ELEMENTARY SCHOOL
5701 Mojave St, NW
Albuquerque, NM 87120

ADDENDUM #2	CLARIFICATION #1	ADDENDUM #4	PERMIT REVISIONS	MARK	DATE	DESCRIPTION
9.4.2015	9.8.2015	9.11.2015	9.22.2015			

GDPA PROJECT NO: 13-004

DATE: 08.10.2015

DRAWN BY: dd, sj, rh, ct

CHECKED BY: gdd/rjh

SET NO:

SHEET TITLE:
T C L

T C L