

VICINITY MAP ZONE MAP: D-16

T B M (TEMPORARY BENCHMARK)

LEGAL DESCRIPTION

TRACT 7, VILLA DEL NORTE

LEGEND

NEW RETAINING WALL	NEW FINISHED PAD ELEVATION
NEW MOUNTABLE CURB & GUTTER	NEW STANDARD 8" CURB & GUTTER
NEW SPOT ELEVATION	PROPERTY LINE
NEW WHEELCHAIR RAMP	NEW DROP INLET
NEW STORM DRAIN LINE	NEW STORM DRAIN MANHOLE #1
NEW WATERBLOCK	EXISTING CONTOUR
EXISTING CONTOUR	EXISTING SPOT ELEVATION

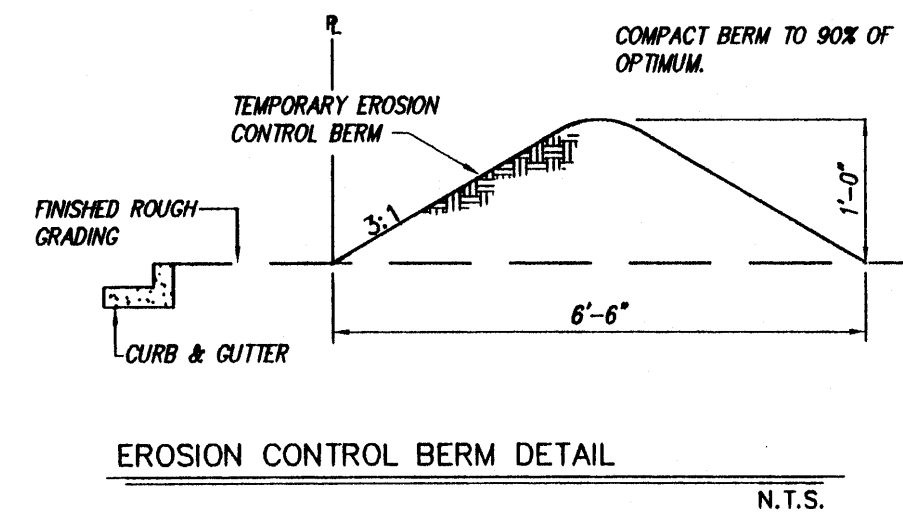
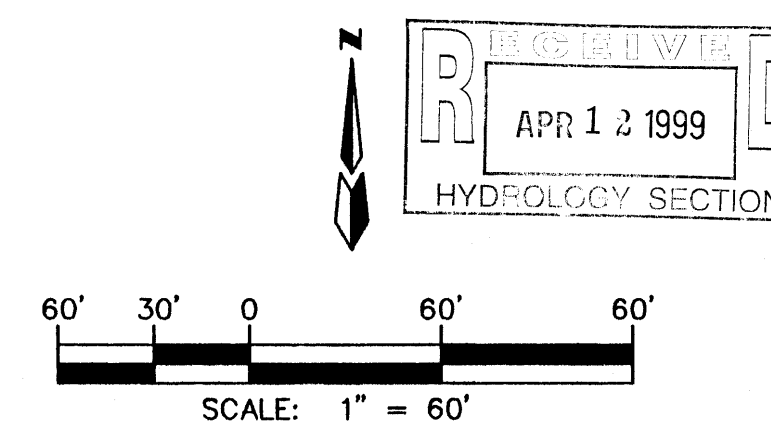

EROSION CONTROL NOTES

1. CONTRACTOR IS RESPONSIBLE FOR OBTAINING A TOPSOIL DISTURBANCE PERMIT PRIOR TO BEGINNING WORK.
2. CONTRACTOR IS RESPONSIBLE FOR KEEPING ALL SEDIMENT OUT OF EXISTING RIGHT-OF-WAY.
3. CONTRACTOR IS RESPONSIBLE FOR CLEANING UP ANY SEDIMENT THAT GETS INTO EXISTING RIGHT-OF-WAY.
4. EROSION CONTROL BERMS ARE REQUIRED AROUND THE ENTIRE SITE.
5. ALL EROSION CONTROL BERMS MUST BE IN PLACE AND ENGINEER CERTIFIED PRIOR TO BUILDING PERMIT RELEASE.

AS BUILT INFORMATION		BENCH MARKS		SURVEY INFORMATION		ENGINEER'S SEAL		REVISIONS		DESIGNED BY		DRAWN BY		CHECKED BY	
CONTRACTOR	DATE	ACS MONUMENT	DATE	FIELD NOTES	BY	NO.	DATE	NO.	DATE	NO.	DATE	NO.	DATE	NO.	DATE
WORK STAKED BY	DATE	"M4-8"	DATE												
ADJUSTED BY	DATE	Y=1513713.15	DATE												
FIELD ADJUSTED BY	DATE	X=393003.61	DATE												
ADJUSTED BY	DATE	G=6-09996702	DATE												
ADJUSTED BY	DATE	DELTA ALPHA = -0012'16"	DATE												
ADJUSTED BY	DATE	CENTRAL ZONE	DATE												
ADJUSTED BY	DATE	(NAD 1927/SLD 1929)	DATE												
ADJUSTED BY	DATE	ELEVATION=5075.6	DATE												

CITY OF ALBUQUERQUE
PUBLIC WORKS DEPARTMENT
ENGINEERING DEVELOPMENT GROUP

TITLE: **LOS PRADOS DEL NORTE**
GRADING AND DRAINAGE PLAN

DESIGN REVIEW COMMITTEE CITY ENGINEER APPROVAL

LAST DESIGN UPDATE

CITY PROJECT NO. ZONE MAP NO. SHEET OF

8048LPDN/8048GD60 4/6/99 BJG,MJR

1 1

WITH APPROVAL OF C.O.A. CONSTRUCTION MANAGEMENT
TYPE "3" 4' MANHOLE BARRELS WERE SUBSTITUTED FOR
TYPE "E" 8' MANHOLE BARRELS. 8' INTERMEDIATE
LANDINGS, (C.O.A. STANDARD DRAWING 2107) WERE PLACED
ON CAST IN PLACE MANHOLE BASES TO SUPPORT THE PRE
CAST MANHOLE BARRELS.

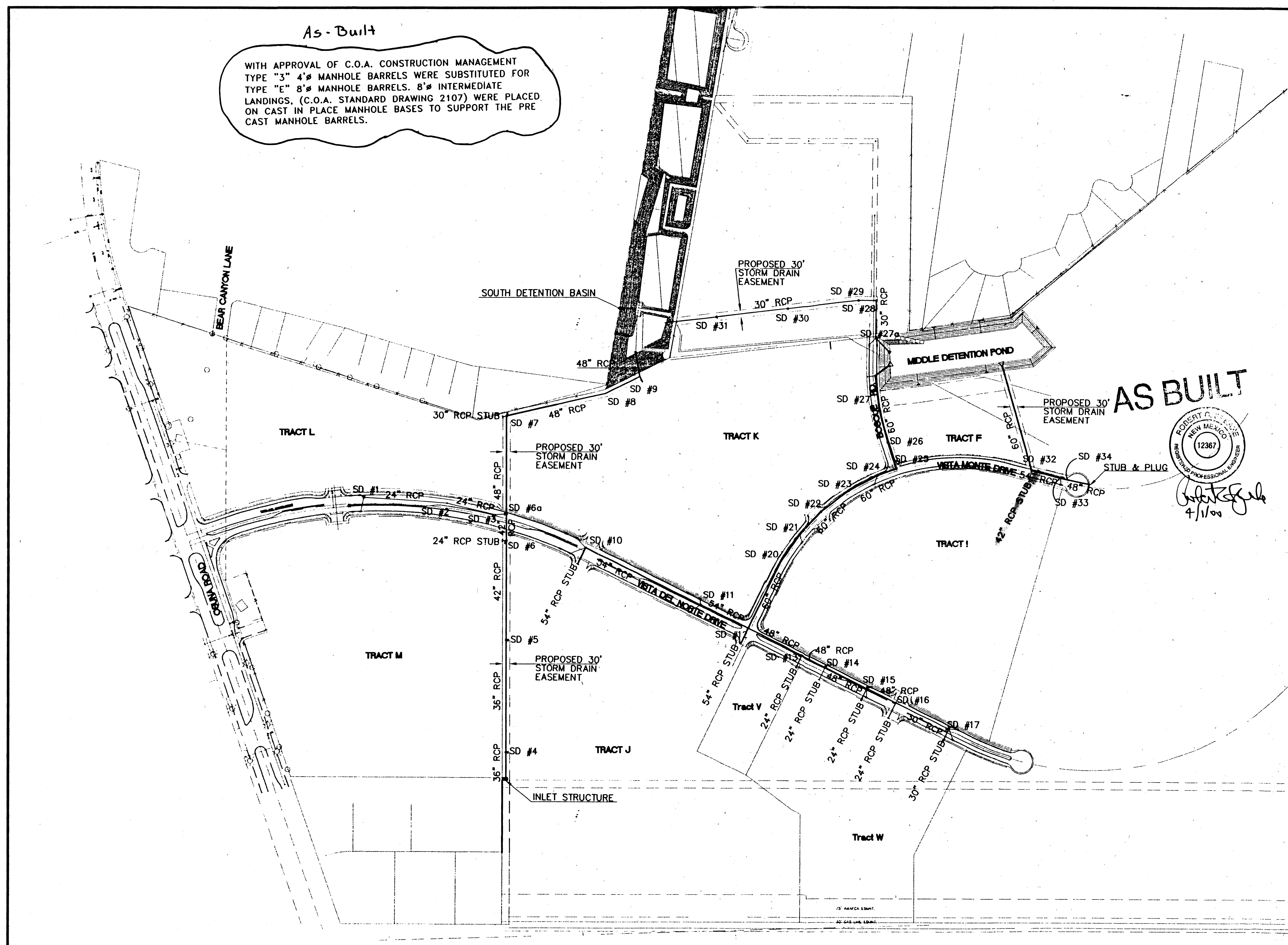











AS BUILT

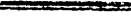

[Signature]
4/11/00

- 1.) STATIONING ALONG C OF STREET
UNLESS OTHERWISE NOTED.
- 2.) SLOPES ARE COMPUTED INVERT TO
INVERT. MH RIM ELEVATIONS GIVEN
ARE APPROXIMATE. CONTRACTOR
SHALL ADJUST ALL RIMS TO FINAL
GRADE.
- 3.) DISTANCES ARE FROM CENTER OF
MANHOLE TO CENTER OF MANHOLE.
- 4.) CONTRACTOR IS RESPONSIBLE FOR
COORDINATION WITH UTILITY COMPANIES.
- 5.) CONTRACTOR SHALL VERIFY ALL
EXISTING UTILITIES AND UTILITY
CONNECTIONS PRIOR TO BEGINNING
CONSTRUCTION. SHOULD A CONFLICT
EXIST OR DESIGN REVISIONS BE
REQUIRED FOR ANY REASON, THE
CONTRACTOR SHALL NOTIFY THE
ENGINEER AND ALLOW SUFFICIENT
TIME FOR DESIGN REVISIONS SO AS
TO NOT DELAY THE CONSTRUCTION
SCHEDULE.

LEGEND

- | | |
|---|---------------------------------|
|  | CENTERLINE OF STREET |
|  | EXISTING CURB & GUTTER |
|  | PROPOSED STANDARD CURB & GUTTER |
|  | PROPOSED MEDIAN CURB & GUTTER |
|  | PROPOSED CONCRETE VALLEY GUTTER |
|  | PROPOSED STORM DRAIN |
|  | EXISTING STORM DRAIN |
|  | PROPOSED STORM INLET |
|  | PROPOSED FIRE HYDRANT |
|  | EXISTING GATE VALVE |
|  | PROPOSED GATE VALVE |

RECEIVED
MAY 11 2009
HYDROLOGY SECTION

PB Parsons
Brinckerhoff

CITY OF ALBUQUERQUE
PUBLIC WORKS DEPARTMENT
TRANSPORTATION DEVELOPMENT

OVERALL STORM DRAIN PLAN
VISTA DEL NORTE UNIT 1

DESIGN REVIEW COMMITTEE	CITY ENGINEER APPROVAL	MO./DAY/YR.	MO./DAY/YR.

City Project No. 5970.81	Zone Map No. D-16-Z & E-16-Z	Sheet 36a	Of 90
-----------------------------	---------------------------------	--------------	----------

ENVISTA-DEL-NORTE.DRAWINGS\65%\PLANSET\36A-OVER-SD.DWG 3-8-99 3:41:10 pm EST

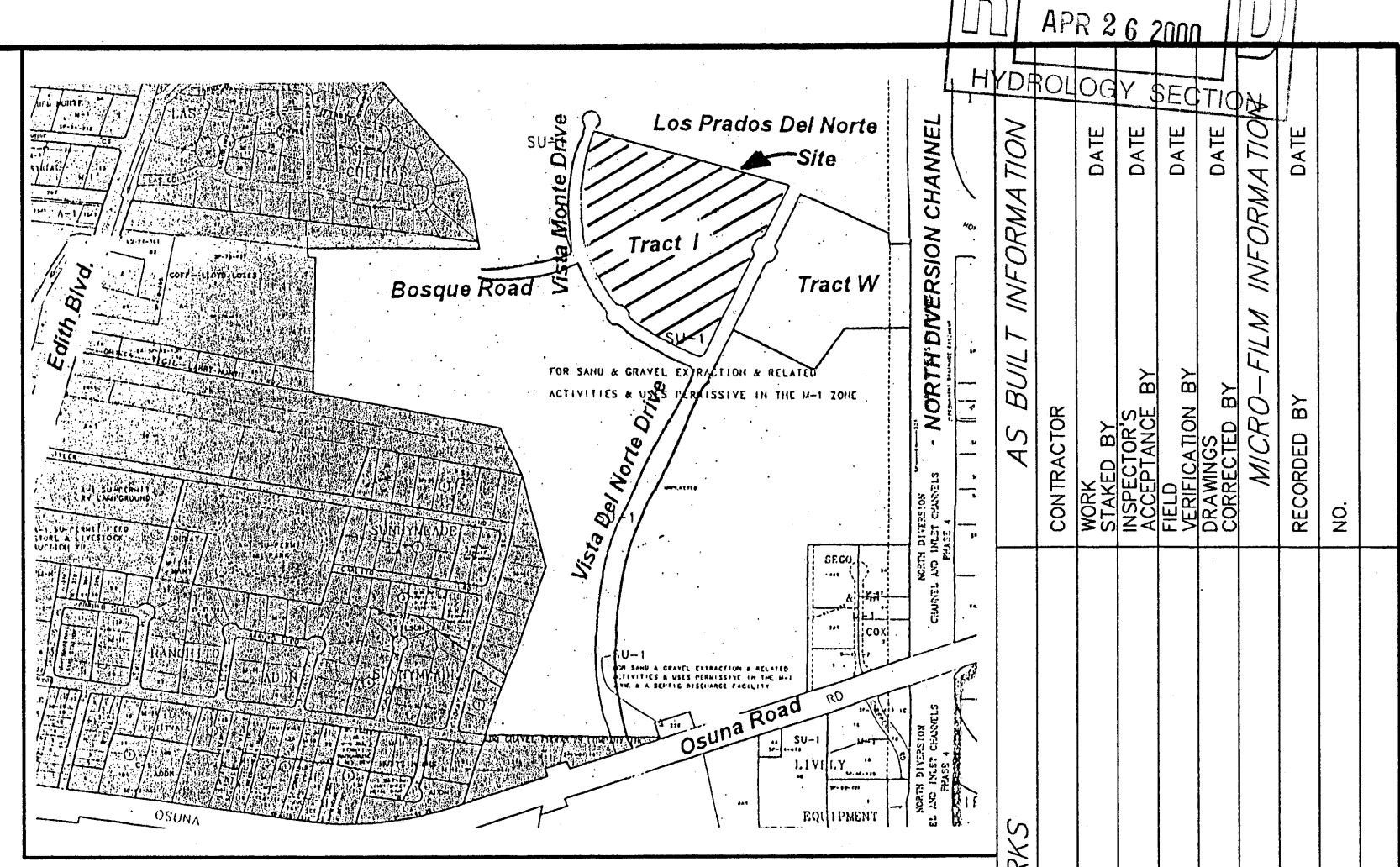

VICINITY MAP ZONE MAP: D-16

T B M (TEMPORARY BENCHMARK)

LEGAL DESCRIPTION

TRACT "T", VILLA DEL NORTE
VISA

LEGEND

- NEW RETAINING WALL
- NEW FINISHED PAD ELEVATION
- NEW MOUNTABLE CURB & GUTTER
- NEW STANDARD 8" CURB & GUTTER
- NEW SPOT ELEVATION
- PROPERTY LINE
- NEW WHEELCHAIR RAMP
- NEW DROP INLET
- NEW STORM DRAIN LINE
- NEW STORM DRAIN MANHOLE #1
- NEW WATERBLOCK
- EXISTING CONTOUR
- EXISTING SPOT ELEVATION

RECORD DRAWING
I hereby certify that the information contained on this drawing has been revised in accordance with information furnished by the contractor, Sundt Corporation, and by the surveyor, Aldrich Land Surveying, and reflects the construction as actually accomplished. This plan as constructed is in substantial compliance with the Approved Plan.

Mark Goodwin
Mark Goodwin NMPE 8948
APR 26 2000
FINAL PROJECT 4/26/00

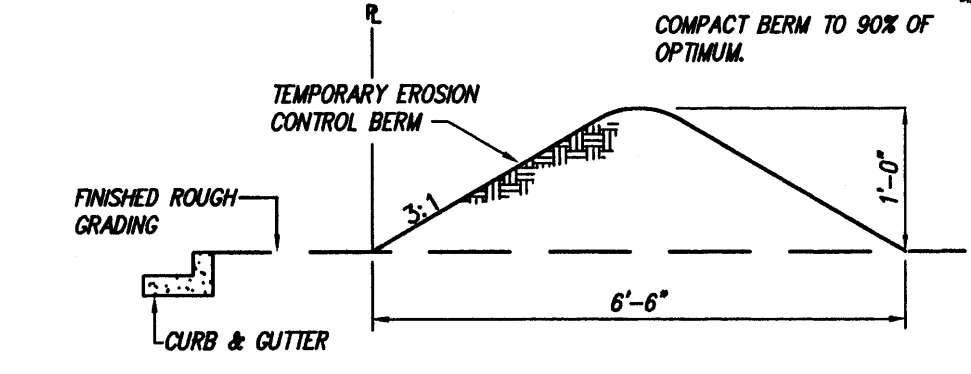

- EROSION CONTROL NOTES
- CONTRACTOR IS RESPONSIBLE FOR OBTAINING A TOPSOIL DISTURBANCE PERMIT PRIOR TO BEGINNING WORK.
 - CONTRACTOR IS RESPONSIBLE FOR KEEPING ALL SEDIMENT OUT OF EXISTING RIGHT-OF-WAY.
 - CONTRACTOR IS RESPONSIBLE FOR CLEANING UP ANY SEDIMENT THAT GETS INTO EXISTING RIGHT-OF-WAY.
 - EROSION CONTROL BERMS ARE REQUIRED AROUND THE ENTIRE SITE.
 - ALL EROSION CONTROL BERMS MUST BE IN PLACE AND ENGINEER CERTIFIED PRIOR TO BUILDING PERMIT RELEASE.

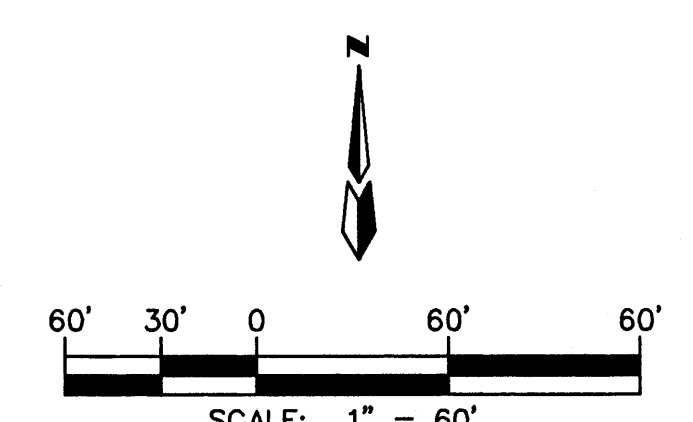

CITY OF ALBUQUERQUE PUBLIC WORKS DEPARTMENT ENGINEERING DEVELOPMENT GROUP	
TITLE: LOS PRADOS DEL NORTE GRADING AND DRAINAGE PLAN	
DESIGN REVIEW COMMITTEE	CITY ENGINEER APPROVAL
LAST DESIGN UPDATE	MO./DAY/YR.
CITY PROJECT NO.	ZONE MAP NO.
SHEET	OF

LA SALA DEL NORTE
SUBDIVISION
(PROPOSED)