

CITY OF ALBUQUERQUE



October 30, 2020

David M. Coley, R.A.
LBYD, Inc.
880 Montclair Rd.
Birmingham, AL 35213

**Re: ADA Corrections Rehabilitation Hospital of ABQ.
7000 Jefferson NE
Request for Certificate of Occupancy
Transportation Development Final Inspection
Engineer's/Architect's Stamp dated 5-23-19 (D17D061A)
Certification dated 9-26-20**

Dear Mr. Coley

Based upon the information provided in your submittal received 10-28-20, Transportation Development has no objection to the issuance of a Permanent Certificate of Occupancy. This letter serves as a "green tag" from Transportation Development for a Permanent Certificate of Occupancy to be issued by the Building and Safety Division.

PO Box 1293

Albuquerque

If you have any questions, please contact Ernie Gomez at (505) 924-3981.

NM 87103

Sincerely,

Jeanne Wolfenbarger, P.E.
Traffic Engineer, Planning Dept.
Development Review Services

www.cabq.gov

Ernie Gomez
Plan Checker, Planning Dept.
Development Review Services

EG via: email
C: CO Clerk, File

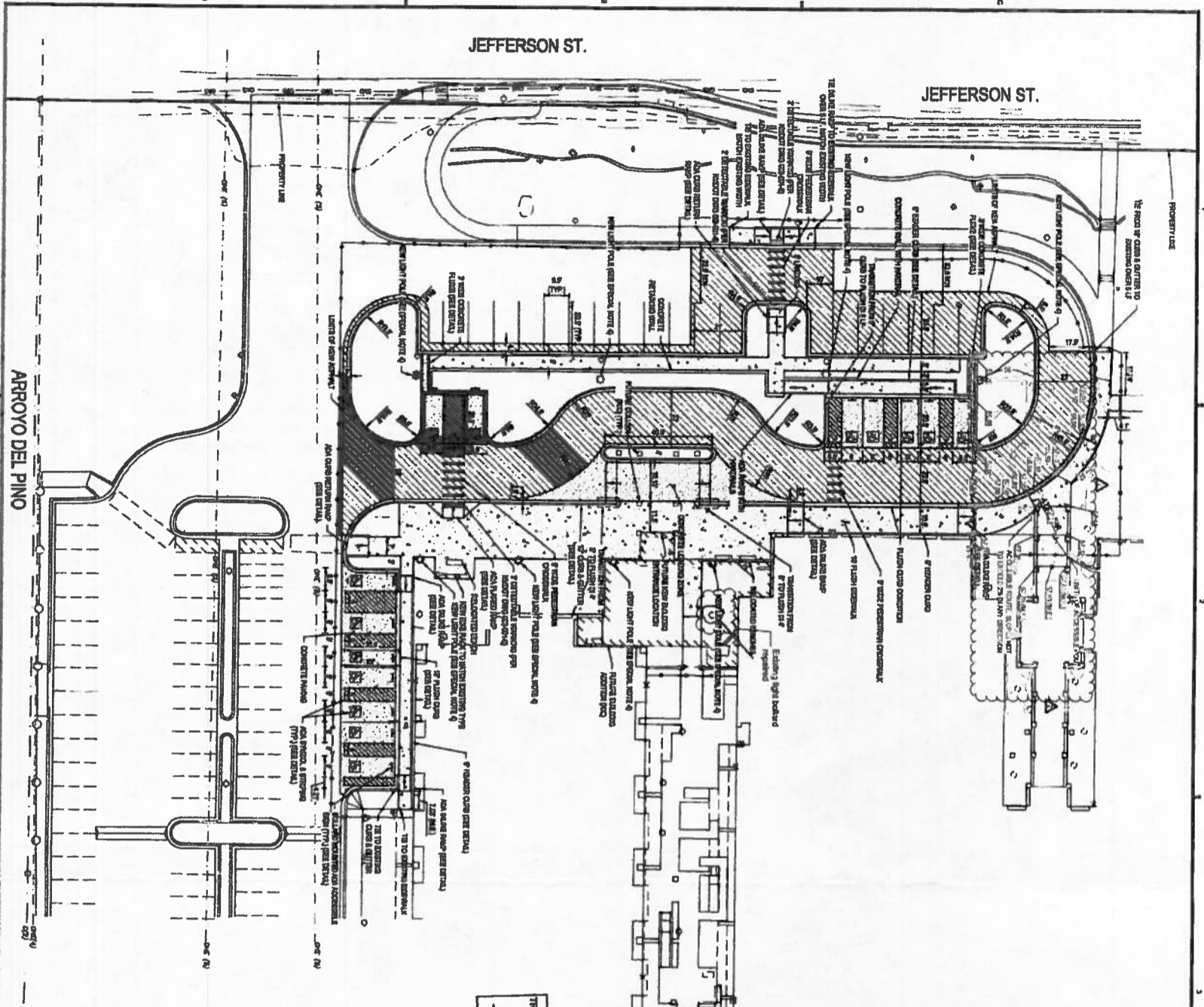

TRAFFIC CIRCULATION LAYOUT
APPROVED

ALL WHEELCHAIR RAMPERS LOCATED WITHIN THE PUBLIC FRONT OF WAY

LAYOUT NOTES:

1. ALL ACCESSIBLE RAMP, STAIR, PLATFORM, AND PLATFORM BUILDING AND ACCESS ROUTES MUST CONFORM TO THE LATEST ADA REQUIREMENTS.
2. THE LOCATION OF ANY ACCESSIBLE RAMP, STAIR, PLATFORM, AND PLATFORM SHALL BE SHOWN BY THE LATEST LAYOUT NOTES AND THE LOCATION OF ANY ACCESSIBLE RAMP, STAIR, PLATFORM, AND PLATFORM SHALL BE SHOWN BY THE LATEST LAYOUT NOTES.
3. ALL ACCESSIBLE RAMP, STAIR, PLATFORM, AND PLATFORM SHALL BE SHOWN BY THE LATEST LAYOUT NOTES AND THE LOCATION OF ANY ACCESSIBLE RAMP, STAIR, PLATFORM, AND PLATFORM SHALL BE SHOWN BY THE LATEST LAYOUT NOTES.
4. ALL ACCESSIBLE RAMP, STAIR, PLATFORM, AND PLATFORM SHALL BE SHOWN BY THE LATEST LAYOUT NOTES AND THE LOCATION OF ANY ACCESSIBLE RAMP, STAIR, PLATFORM, AND PLATFORM SHALL BE SHOWN BY THE LATEST LAYOUT NOTES.
5. ALL ACCESSIBLE RAMP, STAIR, PLATFORM, AND PLATFORM SHALL BE SHOWN BY THE LATEST LAYOUT NOTES AND THE LOCATION OF ANY ACCESSIBLE RAMP, STAIR, PLATFORM, AND PLATFORM SHALL BE SHOWN BY THE LATEST LAYOUT NOTES.
6. ALL ACCESSIBLE RAMP, STAIR, PLATFORM, AND PLATFORM SHALL BE SHOWN BY THE LATEST LAYOUT NOTES AND THE LOCATION OF ANY ACCESSIBLE RAMP, STAIR, PLATFORM, AND PLATFORM SHALL BE SHOWN BY THE LATEST LAYOUT NOTES.
7. ALL ACCESSIBLE RAMP, STAIR, PLATFORM, AND PLATFORM SHALL BE SHOWN BY THE LATEST LAYOUT NOTES AND THE LOCATION OF ANY ACCESSIBLE RAMP, STAIR, PLATFORM, AND PLATFORM SHALL BE SHOWN BY THE LATEST LAYOUT NOTES.

SOO

SOO

CONSULTANTS

ADA CORRECTIONS
 Rehabilitation Hospital
 of Albuquerque
 7000 Jefferson NE
 Albuquerque, NM 87109

Encompass Health

8001 Liberty Parkway
 Birmingham, AL 35242

PROJECT NO: 019-00712-00

DRAWING TITLE: TRAFFIC CIRCULATION LAYOUT (TCL)

SCALE: 1/8" = 1'-0"

DATE: 01/10/2024

DRAWING NO: C1.0

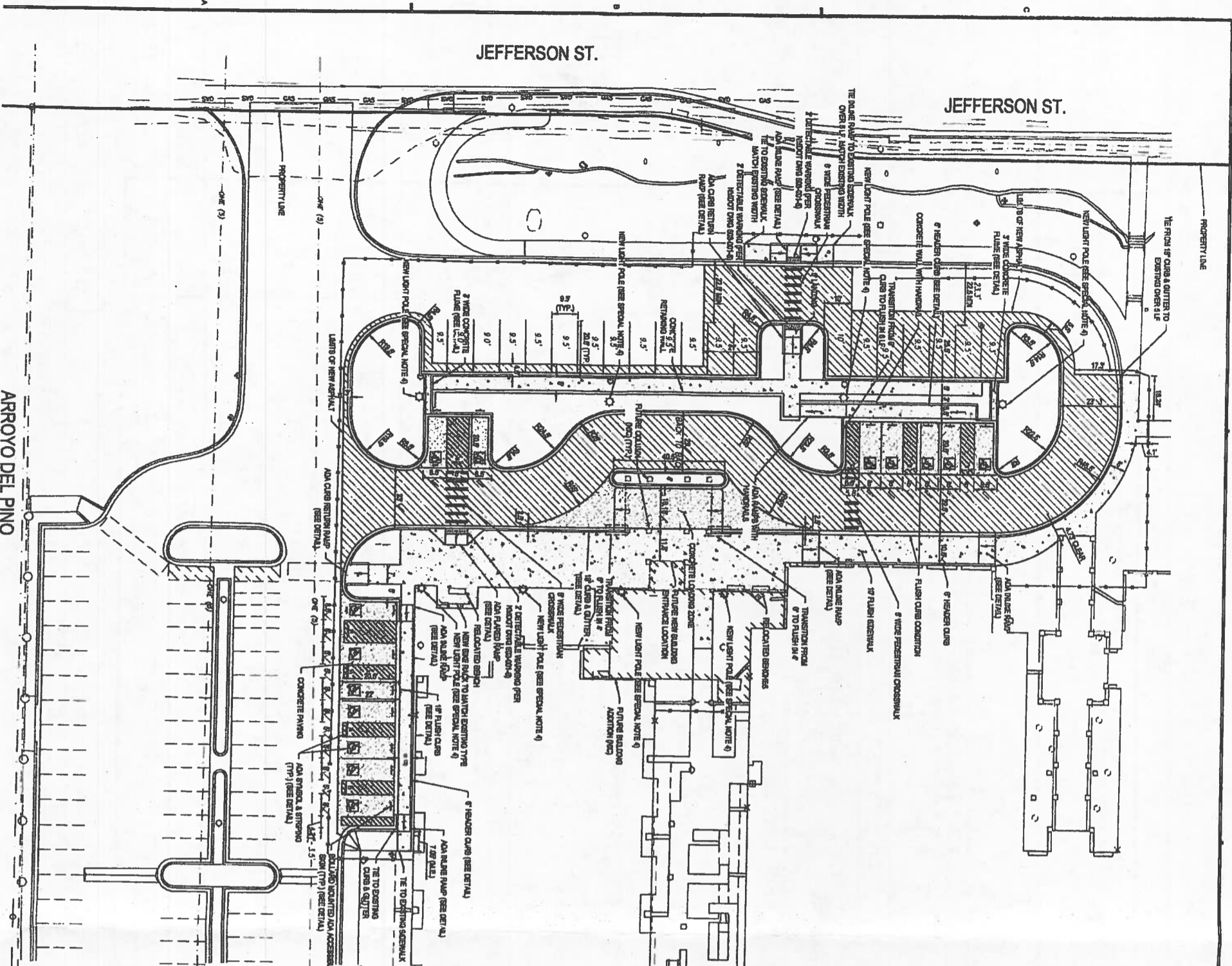

To the best of my knowledge, this work was done in substantial compliance with the approved T.C.I. dated 10/16/2019



TRAFFIC CIRCULATION LAYOUT APPROVED

ALL WHEEL CHAIR RAMPS LOCATED WITHIN THE PUBLIC RIGHT OF WAY

- LAYOUT NOTES:**
1. ALL ACCESSIBLE RAMP, GRAB, STAIRS, & HAND RAILS AND ACCESS ROUTES MUST CONFORM TO THE LATEST ADA REQUIREMENTS.
 2. THE MAXIMUM SLOPE IN ACCESSIBLE PAVEMENT AREAS SHALL NOT EXCEED 2% GRADE IN ANY DIRECTION. SLOPE IN THE DIRECTION OF TRAVEL IN ALL WALKWAY ACCESS ROUTES SHALL NOT EXCEED 1/8" GRADE AND 2% CROSS SLOPE.
 3. ALL DIMENSIONS AND COORDINATES SHOWN ARE TO THE OUTSIDE FACE OF BUILDING AND 2% CROSS SLOPE. EDGE OF SURFACING UNLESS OTHERWISE NOTED. REFER TO ARCHITECTURAL PLANS FOR SPECIFIC BUILDING APPROVALS.
 4. ALL STRENGTH TO BE PER THE LATEST EDITION OF THE AASHTO UNLESS NOTED OTHERWISE.
 5. THE CONTRACTOR SHALL BE RESPONSIBLE FOR REPAIRING ALL SITE CONSTRUCTION TRAFFIC CONTROL PLAN AND GRADING PLAN REQUIRED APPROVALS FROM THE LOCAL AGENCY. THE SITE CONSTRUCTION TRAFFIC CONTROL PLAN SHALL TAKE INTO ACCOUNT THE EXISTING AND EXTERIOR OF CONSTRUCTION TRAFFIC CONTROL PLAN AND THE TRAFFIC CONTROL PLAN SHALL BE IN ACCORDANCE WITH THE LATEST EDITION OF THE AASHTO. THIS SITE CONSTRUCTION TRAFFIC CONTROL PLAN SHALL BE IN ADDITION TO ANY TRAFFIC CONTROL PLAN PROVIDED IN THE PLAN SET FOR ROADWAY CONSTRUCTION.
 6. CONTRACTOR IS RESPONSIBLE FOR ADJUSTING ELEVATIONS OF ALL ABOVE-GRADE STRUCTURES AND UTILITIES TO MATCH EXISTING, MAINTAINED, BULLETIN WALLS, ETC TO MATCH PROPOSED FINISHED GRADES.
 7. CONTRACTOR SHALL REPLACE SALVAGED PAVED ZONE 1 SECTIONAL GRADE. PROVIDE NEW POSTS, COORDINATE LOCATIONS WITH OWNER.

SEAL ON THIS DOCUMENT AUTHORIZED BY:

DAVID M. COLLET
LICENSED PROFESSIONAL ENGINEER
NEW MEXICO
10075

09/21/2020
DATE

JOSEPH M. SOLIMON, JR.
REGISTERED PROFESSIONAL ARCHITECT
NEW MEXICO
15075

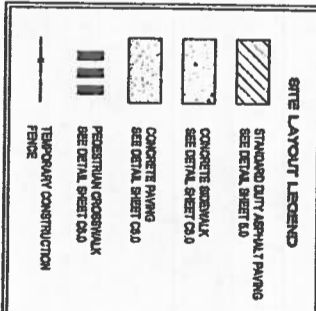

SITE SUMMARY

REQUIRED PAVING	194 SPACES
BUILDING	1
STAIRS	1
CONCRETE SIDEWALK	1
CONCRETE PAVING	1
PERESTRIMA CROSSWALK	1
TEMPORARY CONSTRUCTION FENCE	1
TOTAL	198 SPACES

- SPECIAL NOTES:**
1. ALL HANDRAILS SHALL BE PER THE NEW MEXICO DEPARTMENT OF TRANSPORTATION STANDARD DRAWING 607-20
 2. ALL INTERIABLE WALKWAYS SHALL BE PER THE NEW MEXICO DEPARTMENT OF TRANSPORTATION STANDARD DRAWING 607-20
 3. COORDINATE WITH OWNER TO LABELS SUBJECTS TO OWNERS ACTION
 4. MAINTAIN REQUIRED SIGNAGE ROUTES, PROVIDE TEMPORARY SIGNAGE AS REQUIRED TO ACCOMMODATE CONSTRUCTION. NEW LIGHT POLE LOCATIONS SHOWN FOR REFERENCE ONLY. SEE ELECTRICAL PLANS FOR LOCATIONS AND CIRCUITS.

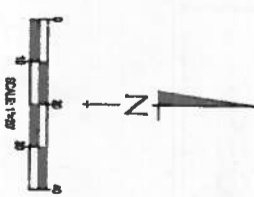

8850e

CONSULTANTS

SEAL ON THIS DOCUMENT AUTHORIZED BY:

DAVID M. COLLET
LICENSED PROFESSIONAL ENGINEER
NEW MEXICO
10075

PROJECT INFORMATION:

ADA CORRECTIONS
Rehabilitation Hospital
of Albuquerque
7000 Jefferson NE
Albuquerque, NM 87109

CLIENT INFORMATION:

Encompass Health

9001 Liberty Parkway
Birmingham, AL 35242

CLIENT PROJECT NO:

PROJECT NO: 019-00712-00

PROJECT MANAGER: ANDY BIRBEL

DESIGNER: LANDON SORRELL

CHECKER: CLAYTON SANDY

DRAWING TITLE: TRAFFIC CIRCULATION LAYOUT (TCL)

DRAWING NO.: C1.0



City of Albuquerque

Planning Department

Development & Building Services Division

DRAINAGE AND TRANSPORTATION INFORMATION SHEET (REV 11/2018)

D170061A

Project Title: ADA Corrections Rehabilitation Hospital of Albuquerque **Building Permit #:** BP-2019-36690 **Hydrology File #:** 0170061A

DRB#: _____ **EPC#:** _____ **Work Order#:** _____

Legal Description: _____

City Address: 7000 Jefferson NE, Albuquerque, NM 87109

Applicant: SDB, Inc **Contact:** Lucas Rogers

Address: 1001 S Edward Dr., Tempe, AZ 85281

Phone#: 602-469-6832 **Fax#:** _____ **E-mail:** lucas.rogers@sdb.com

Owner: Encompass Health **Contact:** Tony Lucero

Address: 9001 Liberty Parkway, Birmingham, AL 35242

Phone#: 505-220-9539 **Fax#:** _____ **E-mail:** tony.lucero@encompasshealth.com

TYPE OF SUBMITTAL: _____ PLAT (___ # OF LOTS) _____ RESIDENCE _____ DRB SITE _____ ADMIN SITE

IS THIS A RESUBMITTAL?: _____ Yes No

DEPARTMENT: TRAFFIC/ TRANSPORTATION _____ HYDROLOGY/ DRAINAGE

Check all that Apply:

TYPE OF SUBMITTAL:

- ENGINEER/ARCHITECT CERTIFICATION
- _____ PAD CERTIFICATION
- _____ CONCEPTUAL G & D PLAN
- _____ GRADING PLAN
- _____ DRAINAGE MASTER PLAN
- _____ DRAINAGE REPORT
- _____ FLOODPLAIN DEVELOPMENT PERMIT APPLIC
- _____ ELEVATION CERTIFICATE
- _____ CLOMR/LOMR
- TRAFFIC CIRCULATION LAYOUT (TCL)
- _____ TRAFFIC IMPACT STUDY (TIS)
- _____ OTHER (SPECIFY) _____
- _____ PRE-DESIGN MEETING?

TYPE OF APPROVAL/ACCEPTANCE SOUGHT:

- _____ BUILDING PERMIT APPROVAL
- CERTIFICATE OF OCCUPANCY
- _____ PRELIMINARY PLAT APPROVAL
- _____ SITE PLAN FOR SUB'D APPROVAL
- _____ SITE PLAN FOR BLDG. PERMIT APPROVAL
- _____ FINAL PLAT APPROVAL
- _____ SIA/ RELEASE OF FINANCIAL GUARANTEE
- _____ FOUNDATION PERMIT APPROVAL
- _____ GRADING PERMIT APPROVAL
- _____ SO-19 APPROVAL
- _____ PAVING PERMIT APPROVAL
- _____ GRADING/ PAD CERTIFICATION
- _____ WORK ORDER APPROVAL
- _____ CLOMR/LOMR
- _____ FLOODPLAIN DEVELOPMENT PERMIT
- _____ OTHER (SPECIFY) _____

DATE SUBMITTED: 10/28/2020 **By:** Lucas Rogers

COA STAFF:

ELECTRONIC SUBMITTAL RECEIVED: _____

FEE PAID: _____