

# CITY OF ALBUQUERQUE

*Planning Department*  
Alan Varela, Interim Director



*Mayor Timothy M. Keller*

January 14, 2022

Robert Fierro, P.E.  
Fierro & Company  
6300 Montano Rd. NW  
Albuquerque, NM 87120

**RE: Loading Dock Enclosure  
7447 Pan American Fwy. NE  
Grading and Drainage Plan  
Engineer's Stamp Date: 1/3/22  
Certification Date: 1/3/22  
Hydrology File: D17D077A**

Dear Mr. Fierro:

PO Box 1293

Based on the submittal received on 1/7/22 and site visit on 1/14/22, this certification is approved in support of Permanent Certificate of Occupancy by Hydrology.

Albuquerque

If you have any questions, please contact me at 924-3986 or [earmijo@cabq.gov](mailto:earmijo@cabq.gov).

NM 87103

Sincerely,

[www.cabq.gov](http://www.cabq.gov)

Ernest Armijo, P.E.  
Principal Engineer, Planning Dept.  
Development Review Services



# City of Albuquerque

Planning Department

Development & Building Services Division

## DRAINAGE AND TRANSPORTATION INFORMATION SHEET (REV 11/2018)

**Project Title:** \_\_\_\_\_ **Building Permit #:** \_\_\_\_\_ **Hydrology File #:** \_\_\_\_\_

**DRB#:** \_\_\_\_\_ **EPC#:** \_\_\_\_\_ **Work Order#:** \_\_\_\_\_

**Legal Description:** \_\_\_\_\_

**City Address:** \_\_\_\_\_

**Applicant:** \_\_\_\_\_ **Contact:** \_\_\_\_\_

**Address:** \_\_\_\_\_

**Phone#:** \_\_\_\_\_ **Fax#:** \_\_\_\_\_ **E-mail:** \_\_\_\_\_

**Owner:** \_\_\_\_\_ **Contact:** \_\_\_\_\_

**Address:** \_\_\_\_\_

**Phone#:** \_\_\_\_\_ **Fax#:** \_\_\_\_\_ **E-mail:** \_\_\_\_\_

**TYPE OF SUBMITTAL:** \_\_\_\_\_ PLAT (\_\_\_\_# OF LOTS) \_\_\_\_\_ RESIDENCE \_\_\_\_\_ DRB SITE \_\_\_\_\_ ADMIN SITE

**IS THIS A RESUBMITTAL?:** \_\_\_\_\_ Yes \_\_\_\_\_ No

**DEPARTMENT:** \_\_\_\_\_ TRAFFIC/ TRANSPORTATION \_\_\_\_\_ HYDROLOGY/ DRAINAGE

Check all that Apply:

### TYPE OF SUBMITTAL:

- \_\_\_\_\_ ENGINEER/ARCHITECT CERTIFICATION
- \_\_\_\_\_ PAD CERTIFICATION
- \_\_\_\_\_ CONCEPTUAL G & D PLAN
- \_\_\_\_\_ GRADING PLAN
- \_\_\_\_\_ DRAINAGE MASTER PLAN
- \_\_\_\_\_ DRAINAGE REPORT
- \_\_\_\_\_ FLOODPLAIN DEVELOPMENT PERMIT APPLIC
- \_\_\_\_\_ ELEVATION CERTIFICATE
- \_\_\_\_\_ CLOMR/LOMR
- \_\_\_\_\_ TRAFFIC CIRCULATION LAYOUT (TCL)
- \_\_\_\_\_ TRAFFIC IMPACT STUDY (TIS)
- \_\_\_\_\_ OTHER (SPECIFY) \_\_\_\_\_
- \_\_\_\_\_ PRE-DESIGN MEETING?

### TYPE OF APPROVAL/ACCEPTANCE SOUGHT:

- \_\_\_\_\_ BUILDING PERMIT APPROVAL
- \_\_\_\_\_ CERTIFICATE OF OCCUPANCY
- \_\_\_\_\_ PRELIMINARY PLAT APPROVAL
- \_\_\_\_\_ SITE PLAN FOR SUB'D APPROVAL
- \_\_\_\_\_ SITE PLAN FOR BLDG. PERMIT APPROVAL
- \_\_\_\_\_ FINAL PLAT APPROVAL
- \_\_\_\_\_ SIA/ RELEASE OF FINANCIAL GUARANTEE
- \_\_\_\_\_ FOUNDATION PERMIT APPROVAL
- \_\_\_\_\_ GRADING PERMIT APPROVAL
- \_\_\_\_\_ SO-19 APPROVAL
- \_\_\_\_\_ PAVING PERMIT APPROVAL
- \_\_\_\_\_ GRADING/ PAD CERTIFICATION
- \_\_\_\_\_ WORK ORDER APPROVAL
- \_\_\_\_\_ CLOMR/LOMR
- \_\_\_\_\_ FLOODPLAIN DEVELOPMENT PERMIT
- \_\_\_\_\_ OTHER (SPECIFY) \_\_\_\_\_

**DATE SUBMITTED:** \_\_\_\_\_ **By:** \_\_\_\_\_

COA STAFF:

ELECTRONIC SUBMITTAL RECEIVED: \_\_\_\_\_

FEE PAID: \_\_\_\_\_



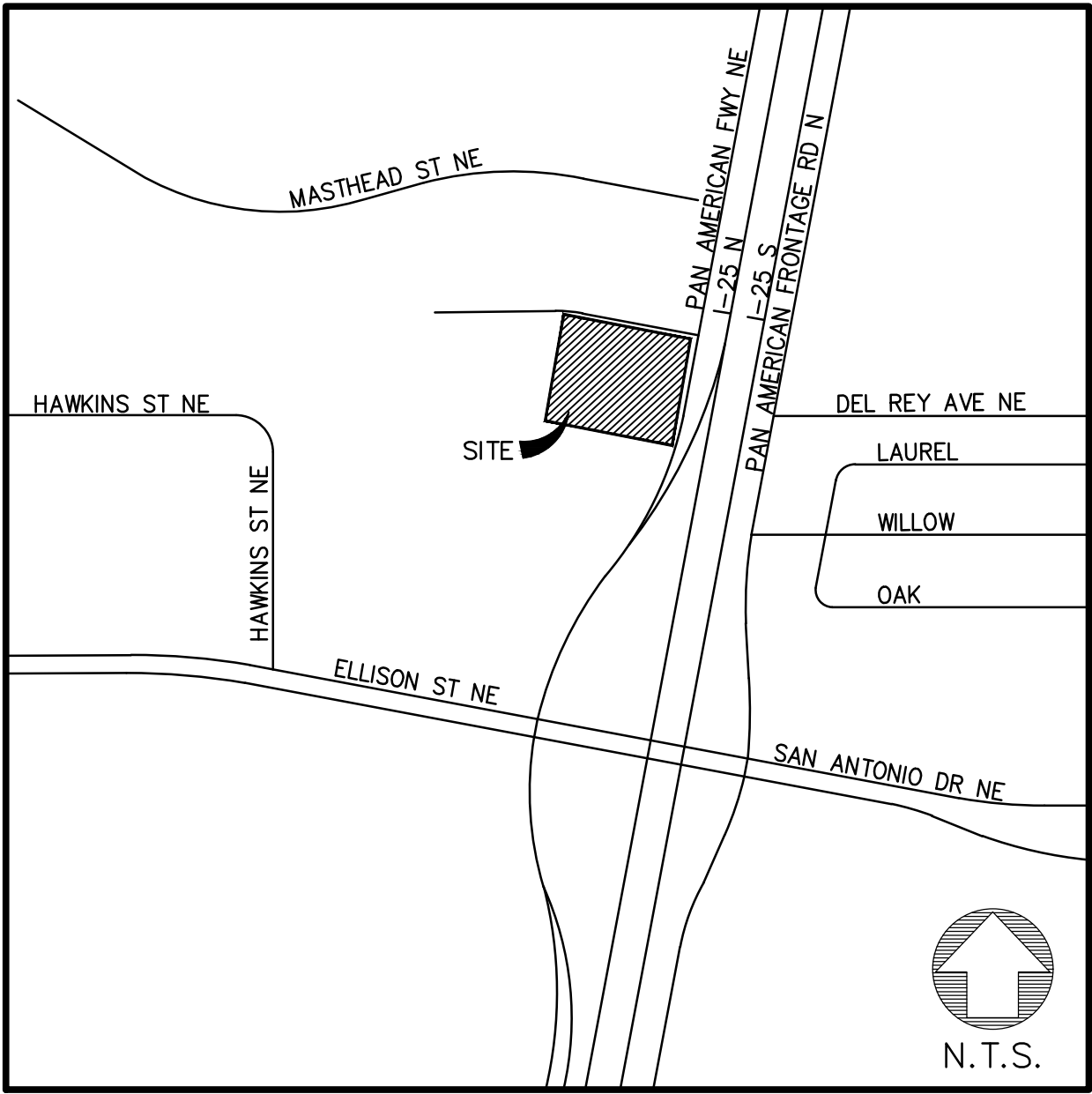

VICINITY MAP:

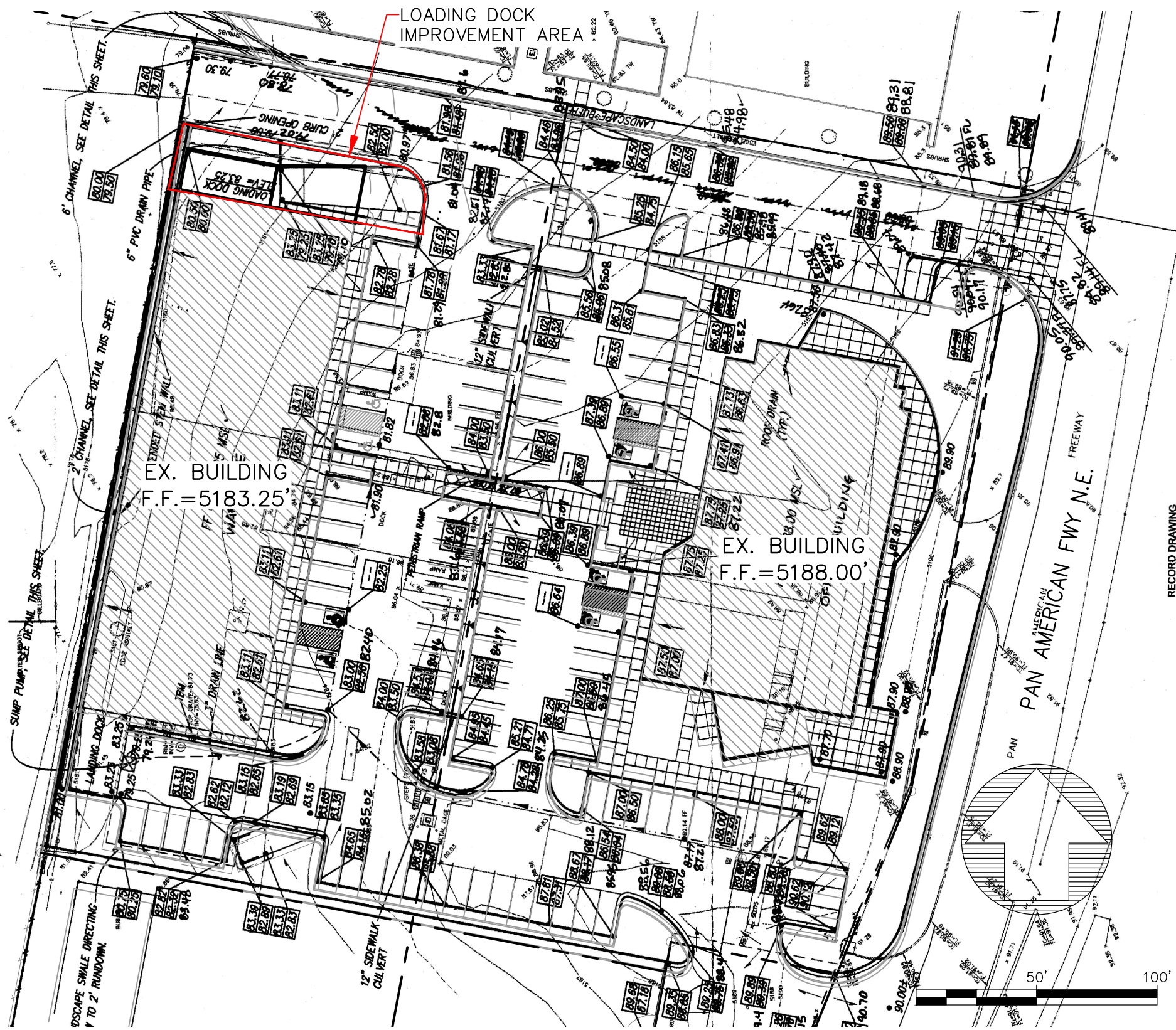

1 AS-BUILT PLAN FROM HYDROLOGY FILE D17-D77 WITH ENGINEER'S CERT. DATED 1-27-2000  
SCALE: NTS

DRAINAGE NARRATIVE

THE SITE IS LOCATED AT 7447 PAN AMERICAN FWY N.E., ALBUQUERQUE, NM BEING LOT A-1-A-1 OF ACADEMY FOR BOY'S. AN APPROVED GRADING PLAN AND AN APPROVED CERTIFICATE OF OCCUPANCY FROM HYDROLOGY DATED ON FEBRUARY 16, 2000 WAS ISSUED UNDER HYDROLOGY FILE D17-D77. RECENT CONSTRUCTION INCLUDES A LOADING DOCK ADDITION OF APPROXIMATELY 750 SQ.FT. THE PRIOR LOADING DOCK IS SHOWN IN THE AS-BUILT WITH ENGINEERS CERTIFICATION DATED 1/27/2000 (REFER TO 1/C-1). DETAIL 2/C-1 SHOWS THE AS-BUILT OF THE NEW LOADING DOCK THAT WAS RECENTLY CONSTRUCTED. THERE IS NOT AN NET INCREASE IN IMPERVIOUS AREA, SINCE THE LOADING DOCK ADDITION WAS EXTENDED ALONG A CONCRETE RAMP. THE DRAINAGE PATTERN REMAINS THE SAME WITH THE DRAINAGE DISCHARGING TO A CONCRETE RUNDOWN LOCATED NORTH OF THE DRIVE AISLE.

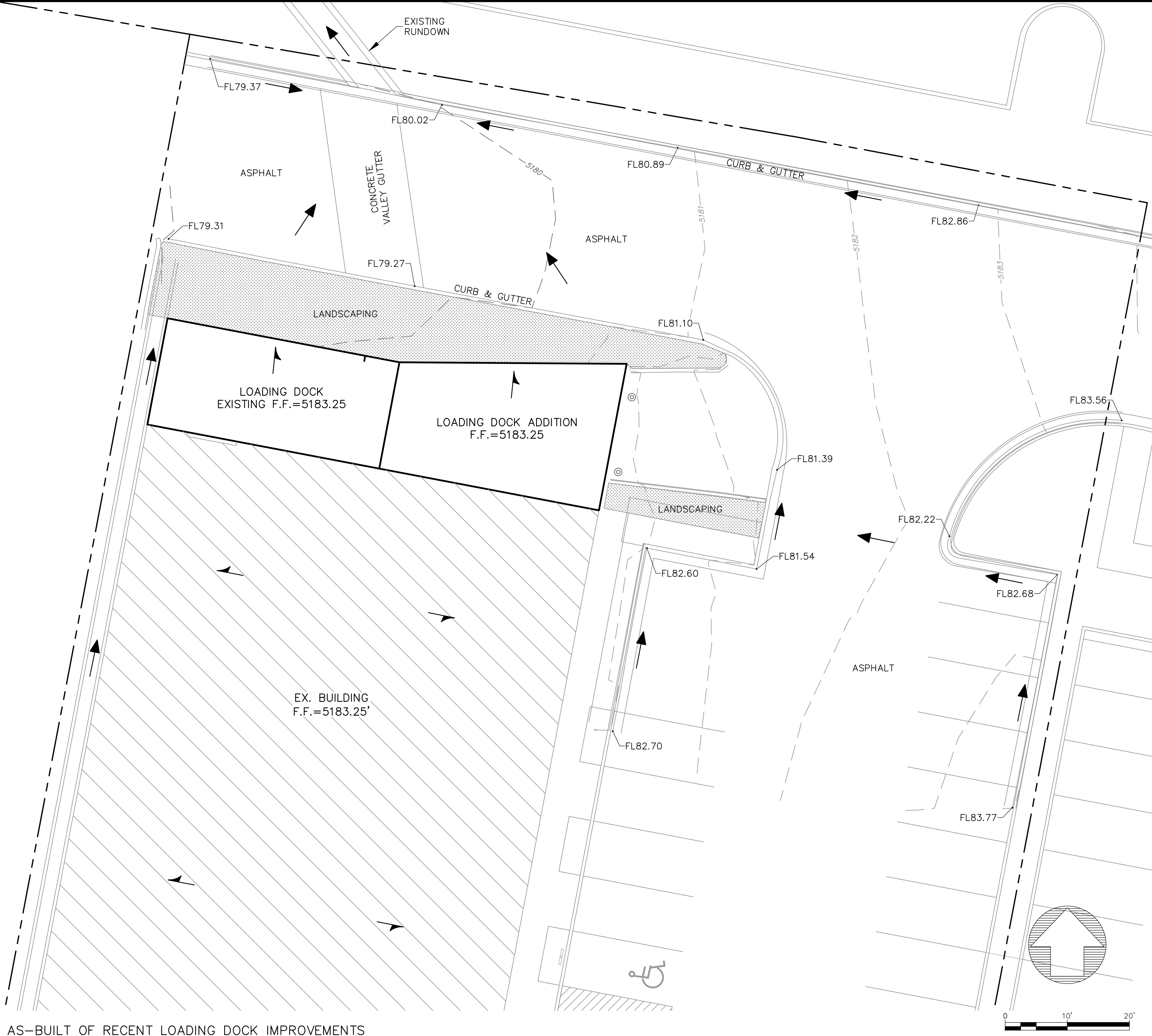

2 AS-BUILT OF RECENT LOADING DOCK IMPROVEMENTS  
SCALE: NTS

DRAINAGE CERTIFICATION OF SUBSTANTIAL COMPLIANCE

I, ROBERT J. FIERRO, NMPE 20585, OF FIRM FIERRO & COMPANY, HEREBY CERTIFY THAT THIS PROJECT HAS WILL DRAIN IN SUBSTANTIAL COMPLIANCE WITH AND IN ACCORDANCE WITH THE DESIGN INTENT OF THE GRADING & DRAINAGE PLAN/REPORT APPROVED ON FEBRUARY 16, 2000. THE RECORD INFORMATION OF THE NEW IMPROVEMENTS HAS BEEN OBTAINED BY ME, NMPS 22909. I FURTHER CERTIFY THAT I HAVE PERSONALLY VISITED THE PROJECT SITE ON DECEMBER 20, 2021 AND HAVE DETERMINED BY VISUAL INSPECTION THAT THE SURVEY DATA PROVIDED IS REPRESENTATIVE OF ACTUAL SITE CONDITIONS AND IS TRUE AND CORRECT TO THE BEST OF MY KNOWLEDGE AND BELIEF. THIS CERTIFICATION IS SUBMITTED IN SUPPORT OF A REQUEST FOR CERTIFICATE OF OCCUPANCY.

THE RECORD INFORMATION PRESENTED HEREON IS NOT NECESSARILY COMPLETE AND INTENDED ONLY TO VERIFY SUBSTANTIAL COMPLIANCE OF THE GRADING AND DRAINAGE ASPECTS OF THIS PROJECT. THOSE RELYING ON THE RECORD DOCUMENTS ARE ADVISED TO OBTAIN INDEPENDENT VERIFICATION OF ITS ACCURACY BEFORE USING IT FOR ANY PURPOSE.



Robert J. Fierro N.M.P.E. No. 20585

LEGEND

- APPARENT PROPERTY BOUNDARY
- FLOW DIRECTION
- ROOF FLOW DIRECTION
- EXISTING MAJOR CONTOUR
- EXISTING MINOR CONTOUR
- FG26.29 FINISHED GRADE
- FL FLOW LINE

**Fierro & Company**  
ENGINEERING | SURVEYING  
6300 MONTANO RD. NW, SUITE C  
ALBUQUERQUE, NEW MEXICO 87120  
PH (505) 352-8930  
www.fierrocompany.com



LOADING DOCK ENCLOSURE  
7447 PAN AMERICAN FWY N.E.  
ALBUQUERQUE, NM

PROJECT NAME

BY	DESCRIPTION	DATE	REV.

PROJECT NO:	21096
DESIGNED BY:	RJF
DRAWN BY:	JB
CHECKED BY:	RJF
DATE:	JANUARY 2021
SHEET TITLE	

GRADING PLAN

SHEET NO:

C-1