



Inspections Plus, Inc.

Engineer Stamp



5/5/16

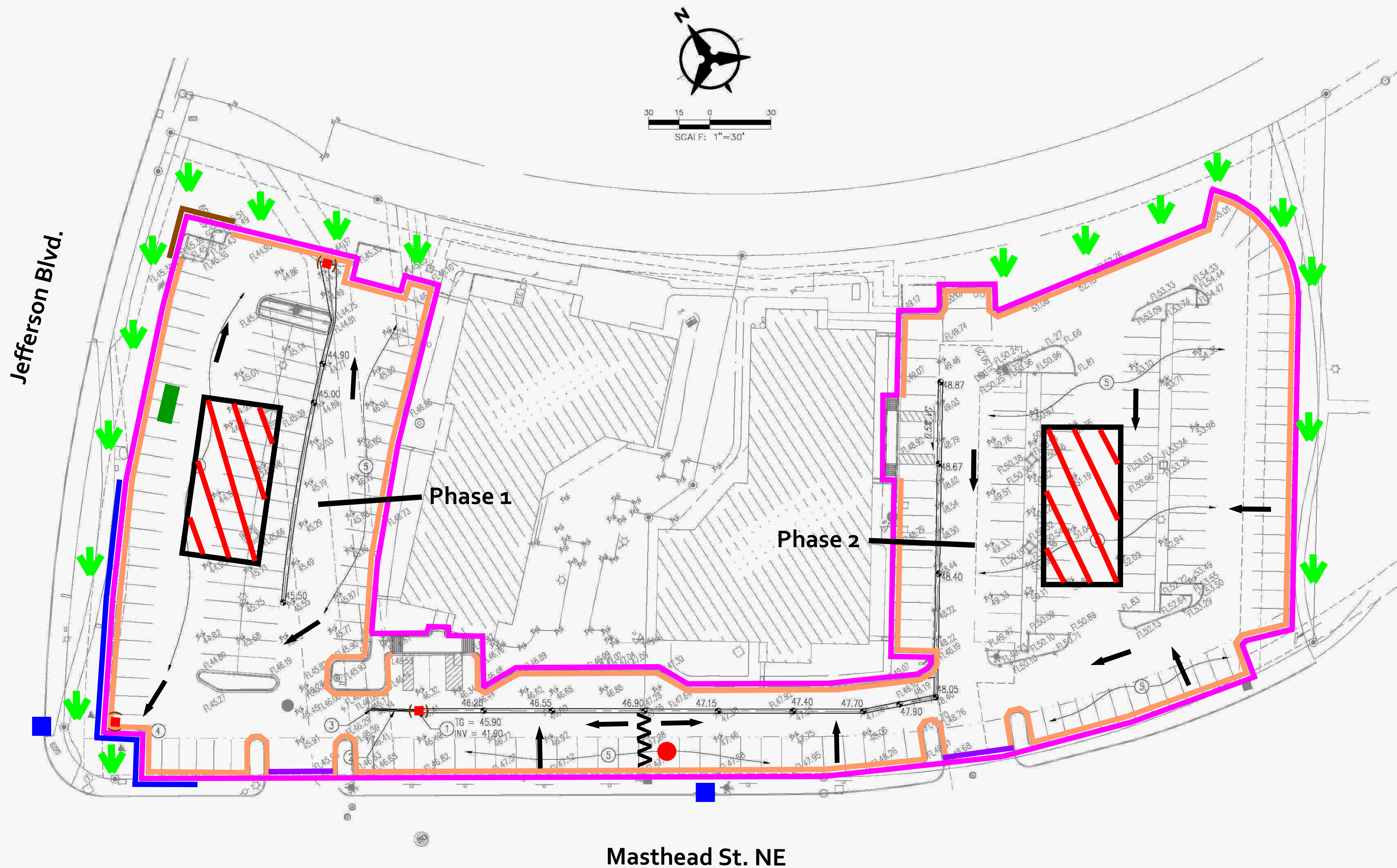

Legend

Erosion Sediment Control Plan

- Project Perimeter & Disturbed Area
- Pre Flow & Post Flow
- Outfall
- Maintain existing vegetation & gravel mulch.
- Staging Area
- Chemical Toilet
- Cut Back at curb / Sediment Barrier
- Existing Curb to stay in place. Acts as a sediment barrier
- Inlet protection. Cover inletw with coco fiber filters when they are actively connected to the MS4 drainage system.
- Existing Storm Inlet . Protect as needed.
- Phase break
- Asphalt cut creating 6" sediment barrier.
- Place wattle here if ther is a forcasted rain event.
- Block Wall
- Mulch Socks

Note:
When doing work in the City ROW (sidewalk, storm drain, drive pads) avoid dirt from getting into the street. If dirt is present in the street, the street should be swept every few days or the same day if rain is imminent.

Note:
1. The repaving project will be constructed in two phases to allow parking for ongoing business.
2. No construction track out pad will be used due to the nature of construcdtion phasing.
3. Sediment track out onto public streets will be swept daily.

**Bohannon Huston
Parking Lot Repaving Project**