



City of Albuquerque Stormwater Construction Site Inspection Report

General Information

Project Name and Location	Elan Santa Monica Louisiana & Drickson		
Site Contact Name & Agency	Robert Gallegos Reis and Associates	Contact Phone #/ E-mail	robertg @ reisassociates .com
Date of Inspection	2-6-17	Start/End Time	12:55/1:05
Inspector Name, COA Dept.	Curtis Cherne, Stormwater Quality		
Inspector Phone / E-mail	505-924-3420/ccherne@cabq.gov		
Inspector Qualifications	Qualified Compliance Inspector of Stormwater- Stormwater One		
Describe Present Phase of Construction	Stabilized		

Type of Inspection:

☒ Regular
 ☐ During storm event
 ☐ Post-storm event (> 0.5 inch)
 ☐ 311 / Complaint Response
 ☐ Follow-Up

Weather Information

Weather at time of this inspection?

Temperature: ~ 50 °F

☐ Clear
 ☒ Cloudy
 ☐ Rain
 ☐ Sleet
 ☐ Fog
 ☐ Snowing
 ☐ Windy

Has there been a storm event since the site was Permitted? ☒ Yes ☐ No

Amount: ☐ < 1/4" ☒ 1/4" to 3/4" ☐ > 3/4" ☐ Snow _____"

Erosion & Sediment Control Inspection

- Entrance / Track-Out N/A
- Sediment Controls / Silt Fence, Check Dams, Waddles, etc. Stabilized
- Erosion Controls / Mulch, Seed, gravel and asphalt
- Housekeeping/Pollutant Controls _____
- Debris/Pollutants/Sediment in MS4 _____
- Notes _____

Is site being maintained in compliance with the Drainage Ordinance? ☒ Yes ☐ No

Signature

Date



City of Albuquerque Stormwater Construction Site Inspection Report

General Information

Project Name and Location	<u>Elan Santa Monica, Louisiana & Drucker</u>		
Site Contact Name & Agency	<u>Robert Garkas</u> <u>Reid and Associates</u>	Contact Phone #/ E-mail	<u>Robert G @</u> <u>reidassociates</u> <u>.com</u>
Date of Inspection	<u>10-18-16</u>	Start/End Time	<u>10:20 / 10:50</u>
Inspector Name, COA Dept.	<u>Curtis Cherne, Stormwater Quality</u>		
Inspector Phone / E-mail	<u>505-924-3420/ccherne@cabq.gov</u>		
Inspector Qualifications	<u>Qualified Compliance Inspector of Stormwater- Stormwater One</u>		
Describe Present Phase of Construction	<u>Bldg vertical, base cover to pave</u>		
Type of Inspection:	<input type="checkbox"/> Regular <input type="checkbox"/> During storm event <input type="checkbox"/> Post-storm event (> 0.5 inch) <input type="checkbox"/> 311 / Complaint Response <input checked="" type="checkbox"/> Follow-Up		

Weather Information

Weather at time of this inspection?	Temperature: <u>~20</u> F°
<input checked="" type="checkbox"/> Clear <input type="checkbox"/> Cloudy <input type="checkbox"/> Rain <input type="checkbox"/> Sleet <input type="checkbox"/> Fog <input type="checkbox"/> Snowing <input type="checkbox"/> Windy	
Has there been a storm event since the site was Permitted?	<input checked="" type="checkbox"/> Yes <input type="checkbox"/> No
Amount: <input type="checkbox"/> < 1/4" <input type="checkbox"/> 1/4" <input checked="" type="checkbox"/> 1/2" <input type="checkbox"/> 3/4" <input type="checkbox"/> > 3/4" <input type="checkbox"/> Snow _____"	

Erosion & Sediment Control Inspection

- Entrance / Track-Out ok
- Sediment Controls / Silt Fence, Check Dams, Waddles, etc. ok
- Erosion Controls / Mulch, Seed, nb
- Housekeeping/Pollutant Controls ok
- Debris/Pollutants/Sediment in MS4 _____
- Notes Heavily mitigated from last visit

Is site being maintained in compliance with the Drainage Ordinance ? ☐ Yes ☐ No

Signature _____

Date _____



City of Albuquerque Stormwater Construction Site Inspection Report

General Information

Project Name and Location	<u>Elan Santa Monica</u> <u>Louisiana & Davidson</u>		
Site Contact Name & Agency	<u>Robert Gallegos</u> <u>Road & Assoc.</u>	Contact Phone #/ E-mail	<u>RobertG@</u> <u>Reit Assoc. com</u>
Date of Inspection	<u>10-10-16</u>	Start/End Time	<u>11:35/12:25</u>
Inspector Name, COA Dept.	<u>Curtis Cherne, Stormwater Quality</u>		
Inspector Phone / E-mail	<u>505-924-3420/ccherne@cabq.gov</u>		
Inspector Qualifications	<u>Qualified Compliance Inspector of Stormwater- Stormwater One</u>		
Describe Present Phase of Construction	<u>bldg vertical, grading to pave drive</u>		
Type of Inspection:	<input checked="" type="radio"/> Regular • During storm event • Post-storm event (> 0.5 inch) • 311 / Complaint Response • Follow-Up		

Weather Information

Weather at time of this inspection?	Temperature: ~ <u>70</u> °F
<input checked="" type="radio"/> Clear • Cloudy • Rain • Sleet • Fog • Snowing • Windy	
Has there been a storm event since the site was Permitted? <input checked="" type="radio"/> Yes • No	
Amount: • < 1/4" • 1/4" to 3/4" • > 3/4" • Snow _____	

Erosion & Sediment Control Inspection

Entrance / Track-Out	<u>① entrance needs maintenance - minor track-out</u>
Sediment Controls / Silt Fence, Check Dams, Waddles, etc.	<u>- dirt/rocks pushed onto sidewalk Louisiana</u> <u>- need silt fence / remove dirt - check - sweep</u> <u>- discuss dirt rd north side</u>
Erosion Controls / Mulch, Seed,	<u>- Second BMP near corner staging lot</u>
Housekeeping/Pollutant Controls	<u>① Stucco pollution near entrance ② cement pollution NE corner</u>
Debris/Pollutants/Sediment in MS4	_____
Notes	<u>① Robert said more - rocks coming out this week</u> <u>Spoke to Robert after inspection</u>

Is site being maintained in compliance with the Drainage Ordinance ? • Yes • ☒ No

Signature

Date

Cherne, Curtis

From: Cherne, Curtis
Sent: Monday, October 10, 2016 3:36 PM
To: 'robertg@reidassoc.com'
Subject: Elan Santa Monica SWPPP inspection
Attachments: trackout_pad.jpg; cement_pollution.jpg; cement_pollution2.jpg; derickson.jpg; dirt_road_BMP.jpg

Robert,

Thank you for taking time to speak with me today.

As discussed, I am sending this e-mail to provide a list of issues observed during today's inspection.

- ✓ 1. Track-out pad needs maintenance.
- ✓ 2. There was cement pollution (stucco?) in the pond near the trailer. Please remove material and provide an acceptable (bind, lined hole, Outpak) wash-out.
3. There was cement pollution near the northeast corner of the site. . Please remove material and provide an acceptable (bind, lined hole, Outpak) wash-out.
4. There were some stretches along Derickson where the dirt was higher than the curb and spilling into the street. Either provide silt fence/wattle or lower the dirt below the height of the curb. Sweep the street.
- ✓ 5. The dirt road used to help concrete strength should have some protection so the dirt won't wash down the street. A mulch sock in the gutter pan west of it would work.
- ✓ 6. Provide silt fence or mulch sock at the northeast corner of the lay-down yard.

Thanks,

Swept Derickson

Curtis Cherne, PE, QCIS
Stormwater Quality Engineer
COA
505-924-3420

"Cement (concrete, stucco, mortar...) pollution is preventable.....Let's prevent it. Thank you."



City of Albuquerque Stormwater Construction Site Inspection Report

General Information

Project Name and Location	Blan Santa Monica Louisiana & Drickson		
Site Contact Name & Agency	John Boney Reid & Associates	Contact Phone #	505 891-2528
Date of Inspection	4-7-16	Start/End Time	2:40/2:55
Inspector Name, COA Dept.	Curtis Cherne, Stormwater Quality		
Inspector Phone / E-mail	505-924-3420/ccherne@cabq.gov		
Inspector Qualifications	Qualified Compliance Inspector of Stormwater- Stormwater One		
Describe Present Phase of Construction	Site graded, bldg vertical		
Type of Inspection:	<input checked="" type="radio"/> Regular • During storm event • Post-storm event • 311 / Complaint Response • Follow-Up		

Weather Information

Weather at time of this inspection?	Temperature: ~65 F°
<input checked="" type="radio"/> Clear • Cloudy • Rain • Sleet • Fog • Snowing • Windy	
Has there been a storm event since the site was Permitted? <input checked="" type="radio"/> Yes • No	
Amount: <input checked="" type="radio"/> < 1/4" • 1/4" to 3/4" • > 3/4" • Snow _____"	

Erosion & Sediment Control Inspection

Check any BMPs that have FAILED or REQUIRE MAINTENANCE

- Entrance / Off Tracking OK
- Sediment Controls / Silt Fence, Check Dams, Waddles, etc. OK
- Erosion Controls / Mulch, Seed, NO
- Wind Blown Erosion NO
- Debris/Pollutants/Sediment in MS4 NO
- _____

Is site being maintained in compliance with the Drainage Ordinance? ☒ Yes • No

Signature

Date

Curtis Cherne 4-7-16



City of Albuquerque Stormwater Construction Site Inspection Report

General Information

Project Name and Location	Elm. Santa Monica Louisiana and San Vicente		
Site Contact Name & Agency	John Bonney Periaw Assoc.	Contact Phone #	505 891-2520
Date of Inspection	2-10-16	Start/End Time	10:40/11:08
Inspector Name, COA Dept.	Curtis Cherne, Stormwater Quality		
Inspector Phone / E-mail	505-924-3420/ccherne@cabq.gov		
Inspector Qualifications	Qualified Compliance Inspector of Stormwater- Stormwater One		
Describe Present Phase of Construction	fini graded		
Type of Inspection:	<input checked="" type="radio"/> Regular • During storm event • Post-storm event • 311 / Complaint Response • Follow-Up		

Weather Information

Weather at time of this inspection?	Temperature: ~ <u>45</u> F°
<input checked="" type="radio"/> Clear • Cloudy • Rain • Sleet • Fog • Snowing • Windy	
Has there been a storm event since the site was Permitted? • Yes • <input checked="" type="radio"/> No	
Amount: • < 1/4" • 1/4" to 3/4" • > 3/4" • Snow _____	

Erosion & Sediment Control Inspection

Check any BMPs that have FAILED or REQUIRE MAINTENANCE

- Entrance / Off Tracking good
- Sediment Controls / Silt Fence, Check Dams, Waddles, etc. good
- Erosion Controls / Mulch, Seed, NO
- Wind Blown Erosion NO
- Debris/Pollutants/Sediment in MS4 good
- no approved ESC plan

Is site being maintained in compliance with the Drainage Ordinance? • ☒ Yes • No

Signature

Date

Curtis Cherne

2-10-16



City of Albuquerque Stormwater Construction Site Inspection Report

General Information

Project Name and Location	Bro Elan Dunckson & Louisiana	ESC PERMIT #	
Site Contact Name & Agency	Brian Patterson Titan Development	Contact Phone #	996-063
Date of Inspection	9-22-15	Start/End Time	10:30 / 10:45
Inspector Name, COA Dept.	Curtis Cherne, Stormwater Quality		
Inspector Phone / E-mail	505-924-3420/ccherne@cabq.gov		
Inspector Qualifications	Stormwater USA		
Describe Present Phase of Construction	rough graded		

Type of Inspection:

- ☐ Regular
 ☐ Drive-By/Random
 ☐ During storm event
 ☐ Post-storm event
 ☐ 311 / Complaint Response
☒ Follow-Up

Weather Information

Weather at time of this inspection?

 Temperature: ~ 75 F°

- ☐ Clear
 ☐ Cloudy
 ☒ Rain
 ☐ Sleet
 ☐ Fog
 ☐ Snowing
 ☐ High Winds
 ☐ Other: _____

Has there been a storm event since the site was Permitted? • Yes • No

Amount: • < 1/4"
 ☒ 1/4" to 3/4"
 • > 3/4"
 Intensity: • Light • Med. • Hvy.
 • Snow _____"

Erosion & Sediment Control Inspection

Check any BMPs that have FAILED or REQUIRE MAINTENANCE

- Entrance / Off Tracking OK
- Sediment Controls / Silt Fence, Check Dams, Waddles, etc. OK
- Erosion Controls / Mulch, Seed, OK
- Wind Blown Erosion _____
- Housekeeping / Pollutant Controls Good
- _____

 Is site being maintained in compliance with Const. Gen. Permit? • ☒ Yes • No

Curtis Cherne
Signature

9-22-15
Date

Cherne, Curtis

From: Cherne, Curtis
Sent: Friday, July 24, 2015 4:34 PM
To: 'grant@inspectionsplusinc.com'; 'Brian Patterson'
Subject: RE: Del Rey (Santa Monica) ESC Plan

Grant,
Thank you for your prompt response.
I retract my comment on this being the first notice.

It is difficult for me to keep track of this when I don't have a plan on file. I realize the original plan site plan was produced prior to the requirement to submit a plan to the City.
Just getting a little stressed out with the EPA audit next week and if they happen to want to check this one, what was I supposed to tell them? The City has been tasked with having a handle on this.

I had no comments on the maintenance of the BMPs or condition of the site as it looked good.
This is good news. I can change my inspection results to a pass.

Curtis

From: Grant Morrison [<mailto:grant@inspectionsplusinc.com>]
Sent: Friday, July 24, 2015 4:17 PM
To: Cherne, Curtis; 'Brian Patterson'
Subject: RE: Del Rey (Santa Monica) ESC Plan

Curtis
The site ECP in your email was from 2012 when the first demolition of this area started. Many things have happened since then and the SWPPP has been constantly updated. There is no requirement to send in updated to the EPA website. I have attached the subsequent ECP's showing BMP placement.
The east half of the project was included in the original SWPPP but it was not being disturbed so there were no BMP's shown on the sheet you say does not provide coverage. That disturbance is shown on these updated BMP sheets.

Is that what you are referring to?

Maybe we should speak so I can be clear about your concerns. If there is something needs done we will certainly take care of it.
Thanks

Grant Morrison
Inspections Plus, Inc
4382 Alexander Blvd NE
Albuquerque, NM 87107
Cell 505-489-5077
Off 505-344-9410

From: Cherne, Curtis [<mailto:CCherne@cabq.gov>]
Sent: Friday, July 24, 2015 3:59 PM
To: 'Brian Patterson'; grant@inspectionsplusinc.com
Subject: RE: Del Rey (Santa Monica) ESC Plan

Brian,
I left you voicemail.



CONTACTS PROJECT MANAGER PROJECT ENGINEER ARCHITECT CONSULTING ENGINEER GENERAL CONTRACTOR SPECIALTY CONTRACTOR SUBMITTAL REVIEWER SPECIALTY TRADES DESIGN REVIEWER	LEGEND Existing Building Component New Building Component Existing Building Component New Building Component Existing Building Component New Building Component Existing Building Component New Building Component	NOTES 1. General Notes 2. Section Notes 3. Detail Notes 4. Material Notes 5. Construction Notes 6. Other Notes	APPENDICES A. General Information B. Material Specifications C. Construction Specifications D. Other Information
---	---	---	---

Santa Monica @ Del Rey East Side

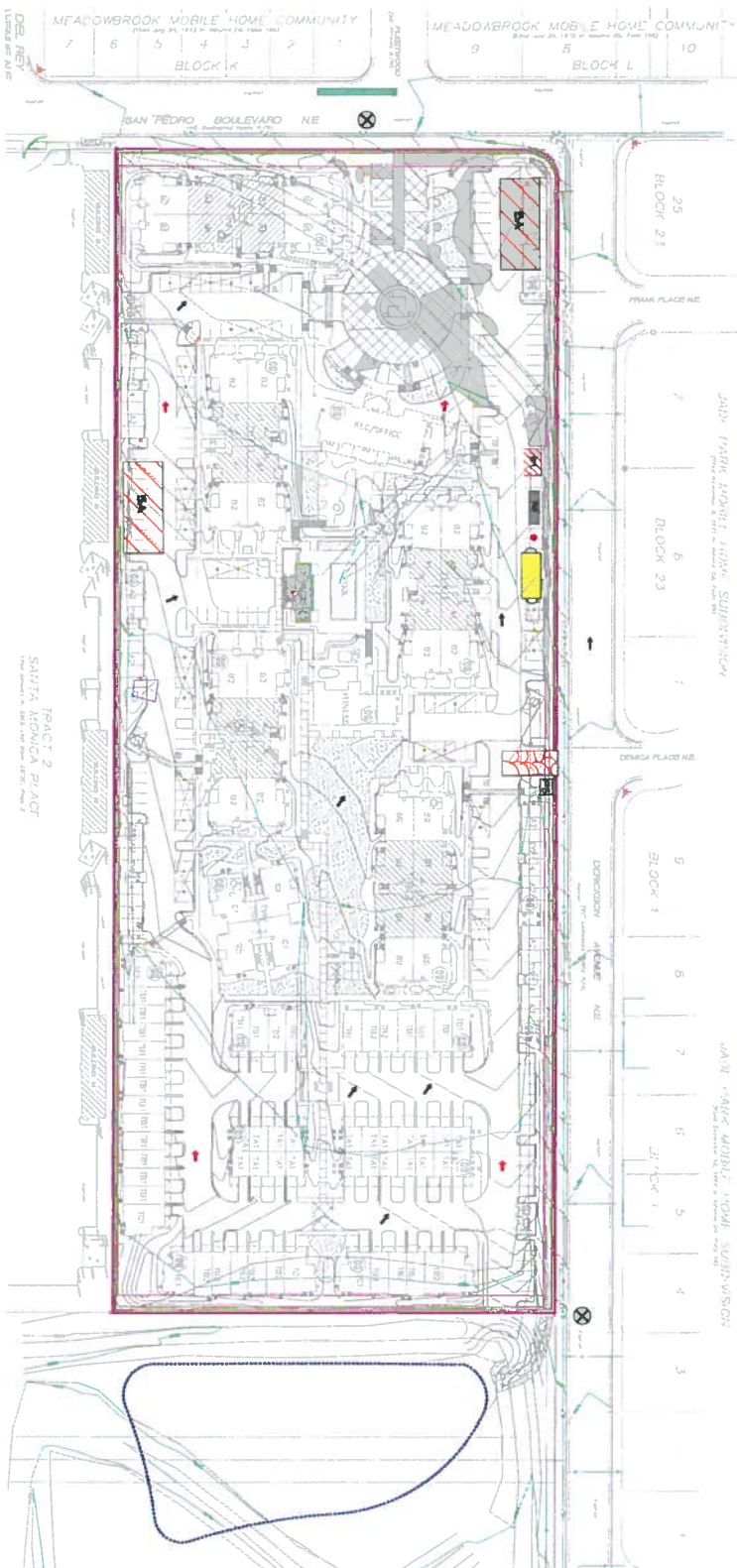

LEGEND

CONTROLS

- PROJECT BOUNDARY / DISTURBED AREA
- SILT FENCE
- RETENTION POND
- STABILIZED CONSTRUCTION ENTRANCE
- PROPOSED INLET PROTECTION
- STAGING AREA
- PORT-O-LET
- SOLID WASTE CONTAINMENT
- CONCRETE WASHOUT
- CONSTRUCTION TRAILER
- POST FLOW
- PRE-FLOW
- PROJECT SIGN
- OUTFALL

NOTES

MAP IS NOT TO SCALE
 RECEIVING WATERS
 Rio Grande
 5.5 Miles to Mouth
IMPAIRMENTS
 E.coli, Dissolved Oxygen, PCB's in Fish Tissue,
 Temperature, Fish Consumption Advisory

NORTH



City of Albuquerque Stormwater Construction Site Inspection Report

General Information

Project Name and Location	Elan Derickson and Louise	ESC PERMIT #	NI
Site Contact Name & Agency	Brian Patterson Titan Development	Contact Phone #	998-0163
Date of Inspection	7-23-15	Start/End Time	10:05/10:10
Inspector Name, COA Dept.	Curtis Cherne, Stormwater Quality		
Inspector Phone / E-mail	505-924-3420/ccherne@cabq.gov		
Inspector Qualifications	Stormwater USA		
Describe Present Phase of Construction	rough graded		
Type of Inspection:			
<input type="checkbox"/> Regular <input checked="" type="checkbox"/> Drive-By/Random <input type="checkbox"/> During storm event <input type="checkbox"/> Post-storm event <input type="checkbox"/> 311 / Complaint Response <input type="checkbox"/> Follow-Up			

Weather Information

Weather at time of this inspection?	Temperature: ~ <u>80</u> F°
<input type="checkbox"/> Clear <input type="checkbox"/> Cloudy <input type="checkbox"/> Rain <input type="checkbox"/> Sleet <input type="checkbox"/> Fog <input type="checkbox"/> Snowing <input type="checkbox"/> High Winds <input type="checkbox"/> Other: _____	
Has there been a storm event since the site was Permitted? • Yes • No <u>NO EXIST</u>	
Amount: • < 1/4" • 1/4" to 3/4" • > 3/4" Intensity: • Light • Med. • Hvy. • Snow _____	

Erosion & Sediment Control Inspection

Check any BMPs that have FAILED or REQUIRE MAINTENANCE

- Entrance / Off Tracking NO
- Sediment Controls / Silt Fence, Check Dams, Waddles, etc. good
- Erosion Controls / Mulch, Seed, NO
- Wind Blown Erosion NO
- Housekeeping / Pollutant Controls good
- _____

 Is site being maintained in compliance with Const. Gen. Permit? • Yes ☒ No ☐
Curtis Ch
Signature

7-23-15
Date

Cherne, Curtis

From: Cherne, Curtis
Sent: Friday, July 24, 2015 3:59 PM
To: 'Brian Patterson'; grant@inspectionsplusinc.com
Subject: RE: Del Rey (Santa Monica) ESC Plan
Attachments: Santa Monica.pdf; north-area.jpg; northish-area.jpg; south-area.jpg; graded-site.jpg

Brian,
I left you voicemail.
I went to the EPA CGP eNOI site and tried to find your site under Del Rey and with no hits tried the zip code 87109.
I found an eNOI for Santa Monica Tracking number NMR12AD01. I have attached a copy of the site map and photos of the graded areas.

It does not provide coverage for the areas that have been graded at the northeast corner of the site and east of the apartments along Santa Monica.
Hopefully, it was filed under the wrong zip code or something.
If Grant finds something, have him turn in the ESC plan with the eNOI.
This is not something that should sit.

Don't like to be a bummer, but consider this your first notice.

Have a good weekend.

Curtis
924-3420

From: Brian Patterson [<mailto:bpatterson@Titan-Development.com>]
Sent: Thursday, July 23, 2015 12:11 PM
To: grant@inspectionsplusinc.com
Cc: Cherne, Curtis
Subject: Del Rey (Santa Monica) ESC Plan

Grant,
Can you please send Curtis the ESC plan for Del Rey? He has one for Broadstone Promenade but nothing in his file for the eastern portion of the site. Also, if you have the eNOI tracking number too, please send that to him.

If you have any questions, please give me a call.

Brian Patterson
Development Project Manager



(O) 505-998-0163
(M) 505-934-3344
bpatterson@titan-development.com | www.titan-development.com