

Note:

- When doing work in the City ROW (sidewalk, storm drain, drive pads) avoid dirt from getting into the street. If dirt is present in the street, the street should be swept every few days or the same day if rain is imminent.
- If stock piling dirt in the street and rain is forecasted, place wattles along the down slope side of the pile.

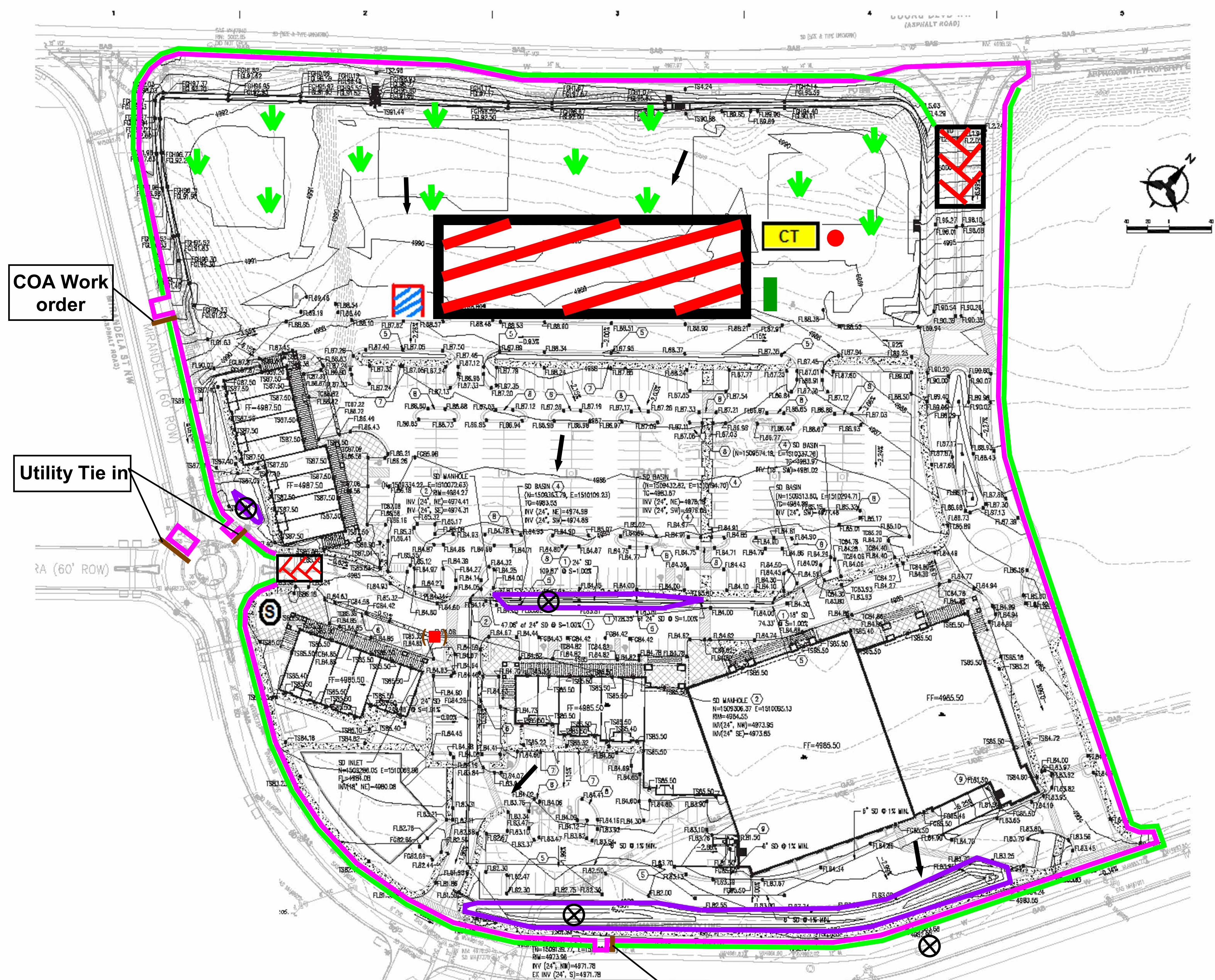

Legend

Erosion Sediment Control Plan

- Project Perimeter & Disturbed Area
- Silt Fence
- Pre Flow & Post Flow
- Outfall
- Posting Sign
- Preserved Vegetation (minor amounts)
- Staging Area
- Stabilized Construction Entrance
- Trash Receptacle
- Chemical Toilet
- Concrete Washout
- Inlet Protection
- Proposed Grate Inlet with protection
- Mulch Socks
- Construction Trailer

Andalucia Phase 1

Receiving Waters and Critical Habitat: Rio Grande is located 0.5 miles to the SouthEast.

Impairments: E. coli, Dissolved Oxygen, PCBs in Fish Tissue, Water Temperature

Grade: Before and After 1%