

CITY OF ALBUQUERQUE



November 29, 2007

Levi Valdez, P.E.
George Rodriguez - Consultant
12800 San Juan NE
Albuquerque, NM 87123

**Re: Los Mochos – Gruber Ave NE, 6901 Gruber Ave NE,
Approval of Permanent Certificate of Occupancy (C.O.)
Engineer's Stamp dated 03/09/07 (E-17/D071)
Certification dated 11/16/07**

Based upon the information provided in your submittal received 11/28/07, the above referenced certification is approved for release of Permanent Certificate of Occupancy by Hydrology.

P.O. Box 1293

If you have any questions, you can contact me at 924-3982.

Albuquerque

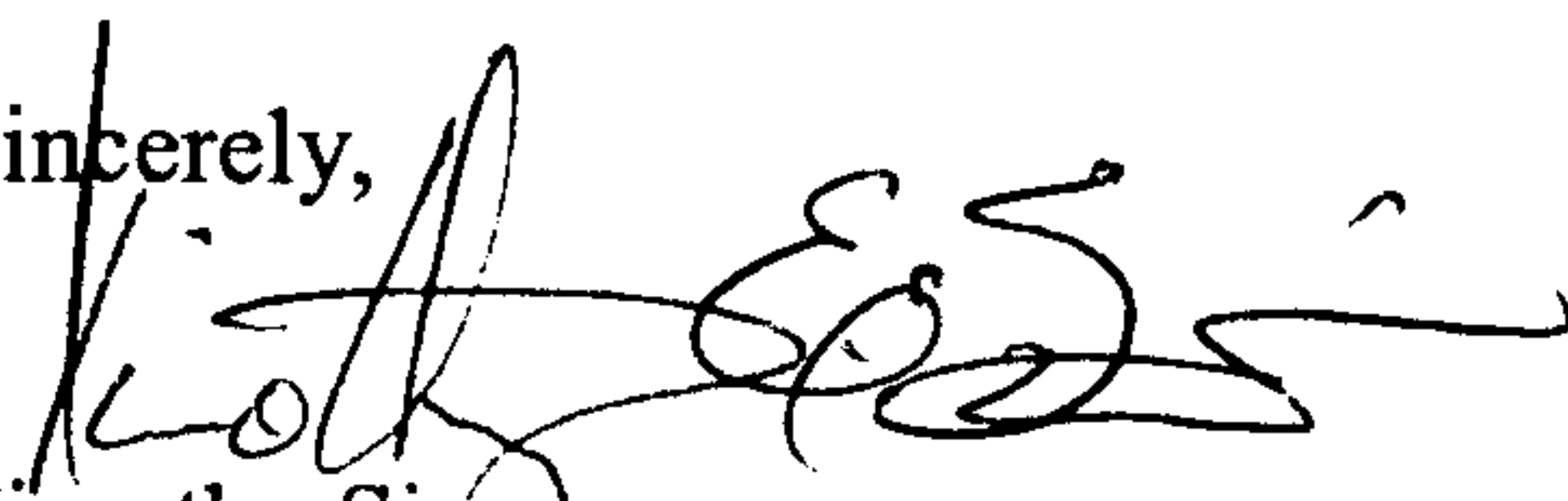
Sincerely,

Timothy Sims
Plan Checker - Hydrology
Development and Building Services

New Mexico 87103

www.cabq.gov

C: CO Clerk-Katrina Sigala
File

CITY OF ALBUQUERQUE



June 26, 2008

Levi J. Valdez, P.E.
Levi Valdez & George Rodriguez Consulting
12800 San Juan NE
Albuquerque, NM 87123

Re: Los Mochos Addition (Gruber Manufacturing)
6901 Gruber NE, Grading and Drainage Plan
Engineer's Stamp dated 05-20-08 (E-17/D071)

Dear Mr. Valdez,

Based upon the information provided in your submittal received 05-28-08, the above referenced plan is approved for Building Permit. Please attach a copy of this approved plan to the construction sets prior to sign-off by Hydrology. **Prior to Certificate of Occupancy release, Engineer Certification per the DPM checklist will be required.**

If you have any questions, you can contact me at 924-3630.

Sincerely,

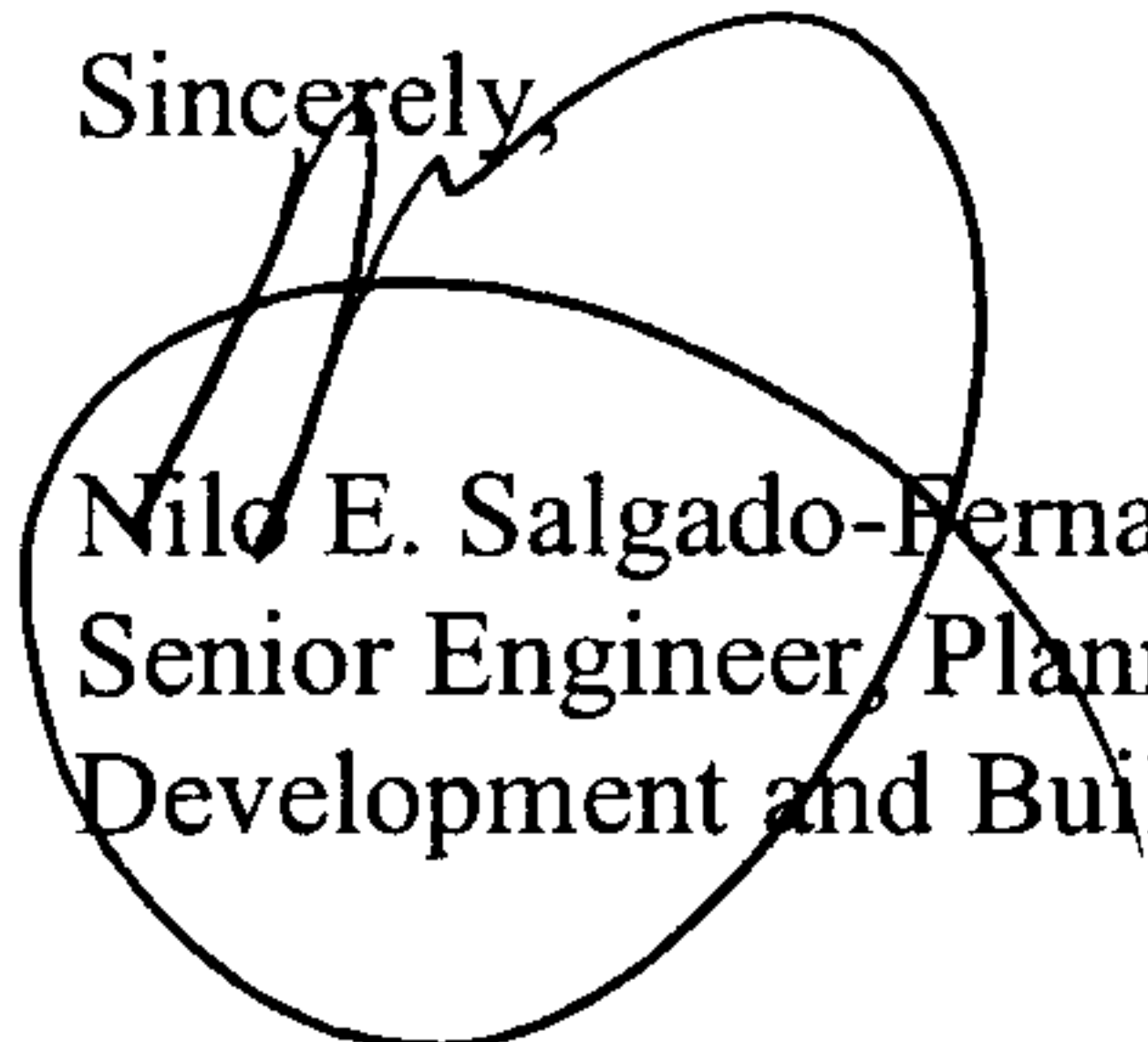
Nilo E. Salgado-Fernandez, P.E.
Senior Engineer, Planning Dept.
Development and Building Services

C: File

P.O. Box 1293

Albuquerque

New Mexico 87103

www.cabq.gov

CITY OF ALBUQUERQUE

March 15, 2007



Levi J. Valdez, P.E.
12800 San Juan NE
Levi J. Valdez & George T. Rodriguez Consulting
Albuquerque, NM 87123

Re: 6901 Gruber NE, Engineer's Stamp Dated 3-9-07
Tract A of the Gruber Manufacturing Site, (E17/D71)

Dear Mr. Valdez,

Based upon the information provided in your submittal received March 15, 2007, the above referenced plan is approved for Building Permit. It is also approved for SO-19. Please attach a copy of this letter and the approved plan to the construction sets prior to sign-off by Hydrology. Prior to Certificate of Occupancy release, Engineer Certification per the DPM checklist will be required.

This project will also require a National Pollutant Discharge Elimination System (NPDES) permit. Inquiries regarding this permit should be directed to Sertil Kandar at 768-3645.

P.O. Box 1293

If you have any questions or need additional information, feel free to contact me at 924-3990.

Albuquerque

Sincerely,

New Mexico 87103

Jeremy Hoover, P.E.
Senior Engineer
Hydrology Section
Development and Building Services

www.cabq.gov

cc: file (E17/D71)
Dwayne Schmitz, DMD Street / Storm Maintenance
Antoinette Baldonado, Construction Services

CITY OF ALBUQUERQUE



**Planning Department
Transportation Development Services Section**

December 20, 2007

Levi J. Valdez, P.E.
George Rodriguez Land Use & Development Consultant
12800 San Juan NE
Albuquerque, NM 87123

Re: Certification Submittal for Final Building Certificate of Occupancy for
Gruber Manufacturing Site, [E-17 / D71]
6901 Gruber Ave. NE
Engineer's Stamp Dated 11/16/07

P.O. Box 1293

Dear Mr. Valdez:

Albuquerque

The TCL / Letter of Certification submitted on December 19, 2007 is sufficient for acceptance by this office for final Certificate of Occupancy (C.O.). Notification has been made to the Building and Safety Section.

New Mexico 87103

Sincerely,

www.cabq.gov

Nilo E. Salgado-Fernandez, P.E.
Senior Traffic Engineer
Development and Building Services
Planning Department

c: Engineer
Hydrology file
CO Clerk

1. The first part of the document discusses the importance of maintaining accurate records of all transactions. It emphasizes that this is crucial for ensuring the integrity of the financial statements and for providing a clear audit trail.

2. The second part of the document outlines the various methods used to collect and analyze data. It includes a detailed description of the sampling techniques employed and the statistical tests used to evaluate the results.

3. The third part of the document provides a comprehensive overview of the findings of the study. It highlights the key areas where significant differences were observed and discusses the potential reasons for these differences.

4. The fourth part of the document discusses the implications of the findings for practice. It offers practical recommendations for improving the accuracy and efficiency of the data collection process and for enhancing the overall quality of the financial reporting.

5. The fifth part of the document concludes the study by summarizing the main points and highlighting the limitations of the research. It also suggests areas for further research and provides a final statement on the overall value of the study.

6. The sixth part of the document contains the references and a list of the sources used in the study. It also includes a list of the authors' contact information and a statement of their affiliations.

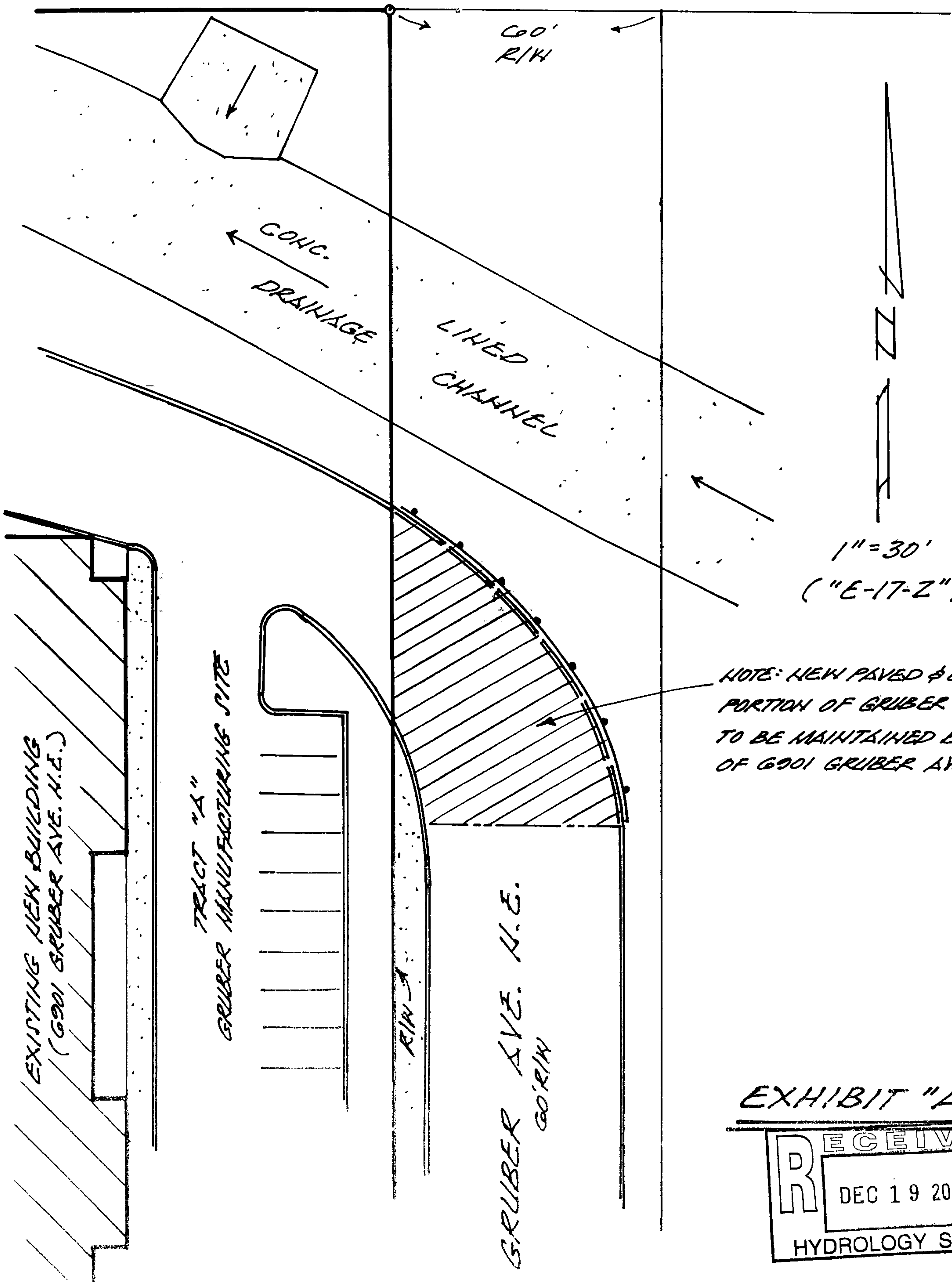

NOTE: NEW PAVED & CURBED PORTION OF GRUBER AVE. N.E. TO BE MAINTAINED BY OWNER(S) OF 6901 GRUBER AVE. N.E.

EXHIBIT "A"

R	RECEIVED	D
	DEC 19 2007	
HYDROLOGY SECTION		

CITY OF ALBUQUERQUE

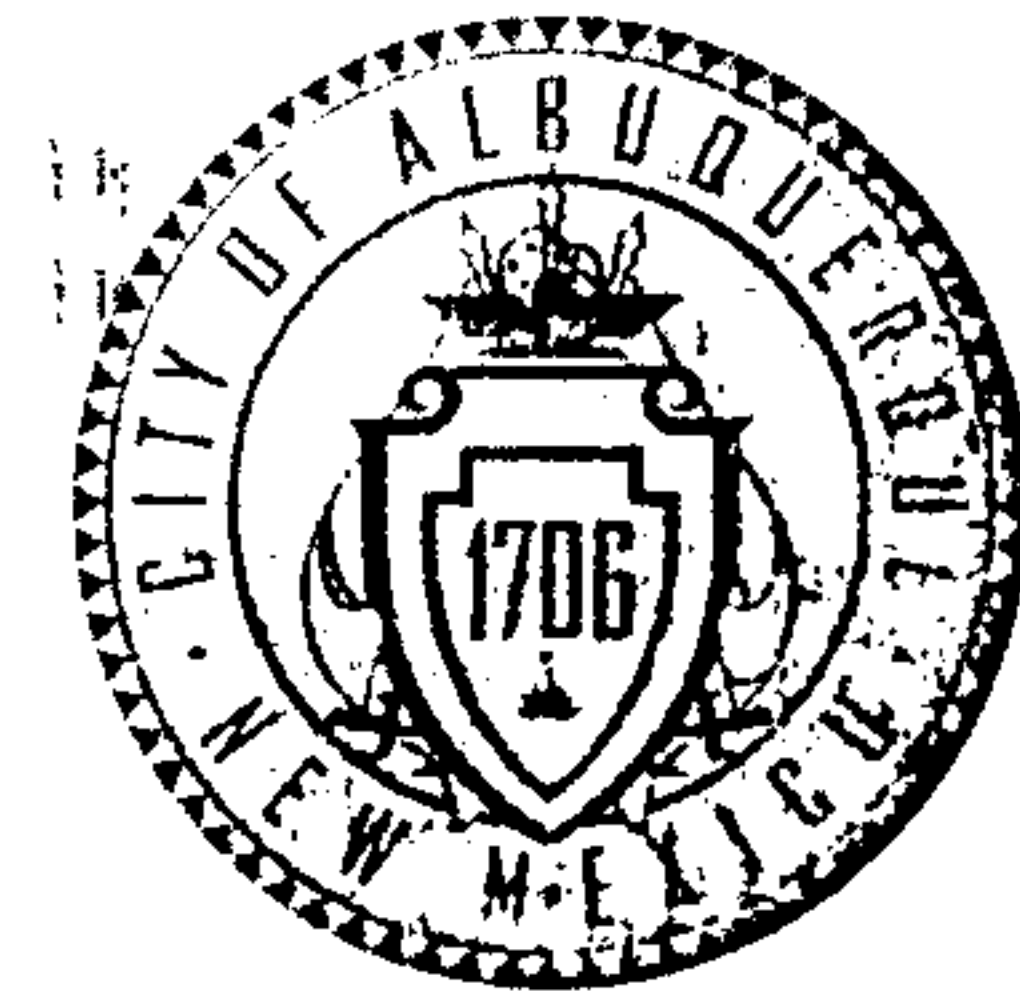

July 2, 2008

Levi Valdez, P.E.
George T. Rodriguez Development Consultants
12800 San Juan NE
Albuquerque, NM 87123

Re: Los Mochos LLP, Proposed Development of Tract A Gruber Manufacturing Site, 6901
Gruber Avenue NE, Traffic Circulation Layout
Engineer's Stamp dated 6-12-08 (E17-D71)

Dear Mr. Valdez,

The TCL submittal received 6-26-08 is approved for Building Permit. The plan is stamped and signed as approved. A copy of this plan will be needed for each of the building permit plans. Please keep the original to be used for certification of the site for final C.O. for Transportation. **Public infrastructure or work done within City Right-of-Way shown on these plans is for information only and is not part of approval. A separate DRC and/or other appropriate permits are required to construct these items.**

PO Box 1293

Albuquerque

NM 87103

www.cabq.gov

If a temporary CO is needed, a copy of the original TCL that was stamped as approved by the City will be needed. This plan must include a statement that identifies the outstanding items that need to be constructed or the items that have not been built in "substantial compliance," as well as the signed and dated stamp of a NM registered architect or engineer. Submit this TCL with a completed Drainage and Transportation Information Sheet to Hydrology at the Development Services Center of Plaza Del Sol Building.

When the site is completed and a final C.O. is requested, use the original City stamped approved TCL for certification. A NM registered architect or engineer must stamp, sign, and date the certification TCL along with indicating that the development was built in "substantial compliance" with the TCL. Submit this certification TCL with a completed Drainage and Transportation Information Sheet to Hydrology at the Development Services Center of Plaza Del Sol Building.

Once verification of certification is completed and approved, notification will be made to Building Safety to issue Final C.O. To confirm that a final C.O. has been issued, call Building Safety at 924-3306.

Sincerely,

Kristal D. Metro, P.E.
Senior Engineer, Planning Dept.
Development and Building Services

C: File

CITY OF ALBUQUERQUE



March 19, 2007

Levi Valdez, P.E.
George T. Rodriguez Development Consultants
12800 San Juan NE
Albuquerque, NM 87123

Re: Los Mochos LLP, Proposed Development of Tract A Gruber Manufacturing Site,
Gruber Avenue NE, Traffic Circulation Layout
Engineer's Stamp dated 3-09-07 (E17-D71)

Dear Mr. Valdez,

The TCL submittal received 3-15-07 is approved for Building Permit. The plan is stamped and signed as approved. A copy of this plan will be needed for each of the building permit plans. Please keep the original to be used for certification of the site for final C.O. for Transportation. **Public infrastructure or work done within City Right-of-Way shown on these plans is for information only and is not part of approval. A separate DRC and/or other appropriate permits are required to construct these items.**

P.O. Box 1293

If a temporary CO is needed, a copy of the original TCL that was stamped as approved by the City will be needed. This plan must include a statement that identifies the outstanding items that need to be constructed or the items that have not been built in "substantial compliance," as well as the signed and dated stamp of a NM registered architect or engineer. Submit this TCL with a completed Drainage and Transportation Information Sheet to Hydrology at the Development Services Center of Plaza Del Sol Building.

Albuquerque

New Mexico 87103

When the site is completed and a final C.O. is requested, use the original City stamped approved TCL for certification. A NM registered architect or engineer must stamp, sign, and date the certification TCL along with indicating that the development was built in "substantial compliance" with the TCL. Submit this certification TCL with a completed Drainage and Transportation Information Sheet to Hydrology at the Development Services Center of Plaza Del Sol Building.

www.cabq.gov

Once verification of certification is completed and approved, notification will be made to Building Safety to issue Final C.O. To confirm that a final C.O. has been issued, call Building Safety at 924-3306.

Sincerely,

Kristal D. Metro, P.E.
Senior Engineer, Planning Dept.
Development and Building Services

C: File