

CITY OF ALBUQUERQUE

Planning Department
Brennon Williams, Director



Mayor Timothy M. Keller

January 13, 2022

Max Parrill
Dekker Perich Sabatini
7601 Jefferson NE, Suite 100
Albuquerque, NM 87109

Re: PHS Healthplex Pool
6301 Forest Hills Dr. NE
30-Day Temporary Certificate of Occupancy
Transportation Development Final Inspection
Engineer's Stamp dated 12-18-2020(E18-D036A)
Certification dated 01-05-22

Dear Mr. Parrill ,

Based upon the information provided in your submittal received 01-06-22, Transportation Development has no objection to a 30-day Temporary Certificate of Occupancy based. This letter serves as a "green tag" from Transportation Development for a 30-day Temporary Certificate of Occupancy to be issued by the Building and Safety Division.

Prior to the issuance of a permanent Certificate of Occupancy, the following items must be addressed:

- Remove porta potties.
- Install all new handicapped signage.
- The ramps to the asphalt walkway path on the west side of the facility were not installed (Keyed Note 20).
- Please include a copy of the approved Administrative Amendment with any red-marked as-built changes prior to permanent C.O.

Once these corrections are complete, email pictures showing the changes to PLNDRS@cabq.gov, and submit an administrative fee of \$40 for log in and evaluation by Transportation.

If you have any questions, please contact me at (505) 924-3991.

Sincerely,

Jeanne Wolfenbarger

Jeanne Wolfenbarger, P.E.
Traffic Engineer, Planning Dept.
Development Review Services
via: email
CO Clerk, File



City of Albuquerque

Planning Department

Development & Building Services Division

DRAINAGE AND TRANSPORTATION INFORMATION SHEET (REV 11/2018)

Project Title: _____ **Building Permit #:** _____ **Hydrology File #:** _____

DRB#: _____ **EPC#:** _____ **Work Order#:** _____

Legal Description: _____

City Address: _____

Applicant: _____ **Contact:** _____

Address: _____

Phone#: _____ **Fax#:** _____ **E-mail:** _____

Owner: _____ **Contact:** _____

Address: _____

Phone#: _____ **Fax#:** _____ **E-mail:** _____

TYPE OF SUBMITTAL: _____ PLAT (____# OF LOTS) _____ RESIDENCE _____ DRB SITE _____ ADMIN SITE

IS THIS A RESUBMITTAL?: _____ Yes _____ No

DEPARTMENT: _____ TRAFFIC/ TRANSPORTATION _____ HYDROLOGY/ DRAINAGE

Check all that Apply:

TYPE OF SUBMITTAL:

- _____ ENGINEER/ARCHITECT CERTIFICATION
- _____ PAD CERTIFICATION
- _____ CONCEPTUAL G & D PLAN
- _____ GRADING PLAN
- _____ DRAINAGE MASTER PLAN
- _____ DRAINAGE REPORT
- _____ FLOODPLAIN DEVELOPMENT PERMIT APPLIC
- _____ ELEVATION CERTIFICATE
- _____ CLOMR/LOMR
- _____ TRAFFIC CIRCULATION LAYOUT (TCL)
- _____ TRAFFIC IMPACT STUDY (TIS)
- _____ OTHER (SPECIFY) _____
- _____ PRE-DESIGN MEETING?

TYPE OF APPROVAL/ACCEPTANCE SOUGHT:

- _____ BUILDING PERMIT APPROVAL
- _____ CERTIFICATE OF OCCUPANCY
- _____ PRELIMINARY PLAT APPROVAL
- _____ SITE PLAN FOR SUB'D APPROVAL
- _____ SITE PLAN FOR BLDG. PERMIT APPROVAL
- _____ FINAL PLAT APPROVAL
- _____ SIA/ RELEASE OF FINANCIAL GUARANTEE
- _____ FOUNDATION PERMIT APPROVAL
- _____ GRADING PERMIT APPROVAL
- _____ SO-19 APPROVAL
- _____ PAVING PERMIT APPROVAL
- _____ GRADING/ PAD CERTIFICATION
- _____ WORK ORDER APPROVAL
- _____ CLOMR/LOMR
- _____ FLOODPLAIN DEVELOPMENT PERMIT
- _____ OTHER (SPECIFY) _____

DATE SUBMITTED: _____ **By:** _____

COA STAFF:

ELECTRONIC SUBMITTAL RECEIVED: _____

FEE PAID: _____

January 05, 2022



Ernie Gomez
Traffic Engineering
Development & Building Services; Planning Dept.
600 2nd Street NW
Albuquerque, NM 87102

Re: Traffic Certification for
Permanent Certification of Occupancy
PHS Healthplex Pool
6301 Forest Hills Dr NE, Albuquerque, NM 87109

Dear Ernie:

I, Max Parrill, of the firm Dekker/Perich/Sabatini, hereby certify that this project substantial compliance with and in accordance with the design intent of the approved EPC site plan dated July 07, 1992. I further certify that I have personally visited the project site on January 04, 2022 and have determined by visual inspection that the data provided is representative of actual site conditions and is true and correct to the best of my knowledge and belief. This certification is submitted in support of a request for Permanent Certification of Occupancy.

The record information presented hereon is not necessarily complete and intended only to verify substantial compliance of the traffic aspects of this project. Those relying on the record document are advised to obtain independent verification of its accuracy before using it for any other purpose.

Very truly yours,

A handwritten signature in black ink, appearing to read 'M. Parrill', with a horizontal line extending to the right.

Dekker/Perich/Sabatini Ltd.

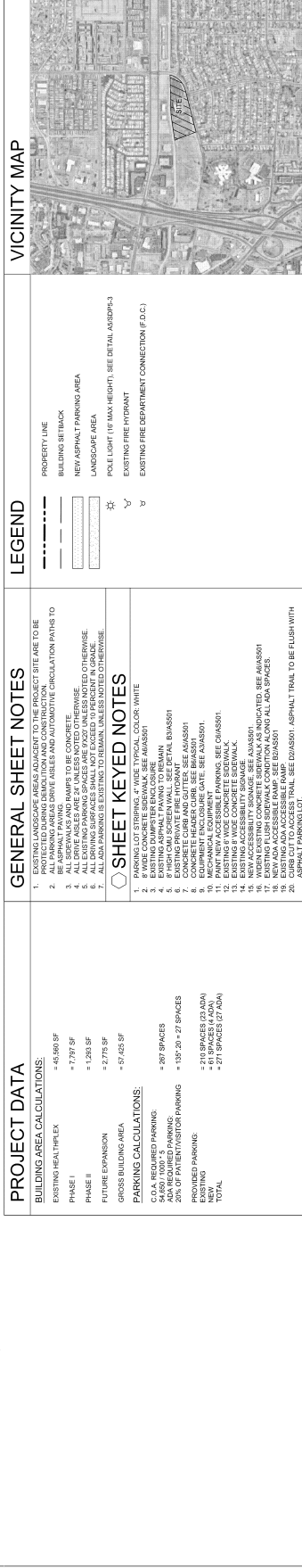

ADMINISTRATIVE AMENDMENT

FILE # SI-2020-0057
3 PROJECT # PR-2020-00408
1

Addition to building footprint on the southern façade of existing facility

Addition of parking and landscaping on the northwest side of the facility

Digitally signed by James M. Aranda

DN: cn=James M. Aranda, o=City of

Albuquerque, ou=Planning

Department,

email=jmaranda@cabq.gov, c=US

Date: 2020.12.18 15:18:54 -07'00'

12/18/2020

J.M. Aranda
APPROVED BY

DATE

NOTES:
1. SEE SITE PLAN FOR CURB CUT LOCATIONS.

— CURB AND GUTTER

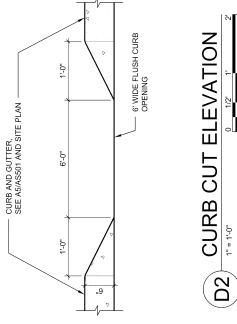

CURB CUT ELEVATION

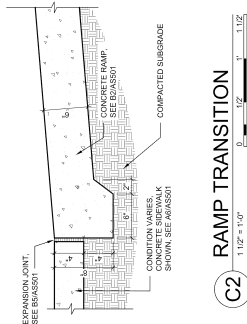

RAMP TRANSITION

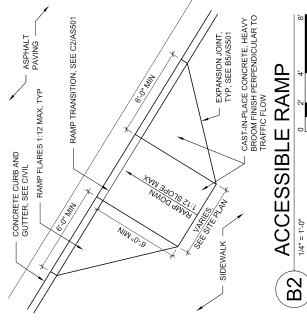

 ACCESSIBLE RAMP

NOTE:
WHERE INSTALLED AT ACCESSIBLE PARKING
SPACES, PAINT RIMMER ADA R111F

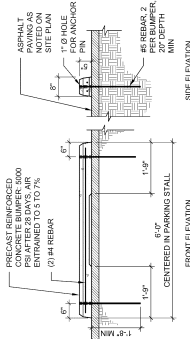

PARKING BUMPER

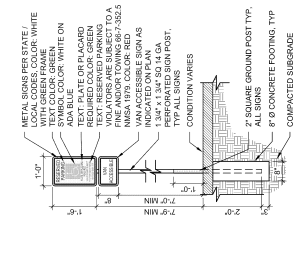

POLE MOUNTED H.C.
SIGN (VAN)

NOTE: PROVIDE MASONRY CONTROL JOINTS
NEED DETAIL CORRECTIONS AT JOINTS OF C.C. MASONRY

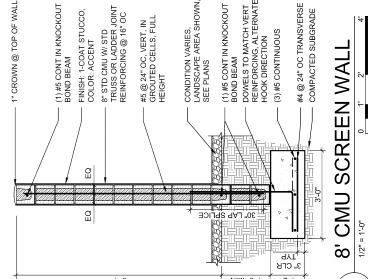

8" CMU SCREEN WALL

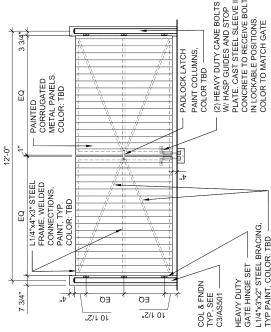

ENCLOSURE GATE

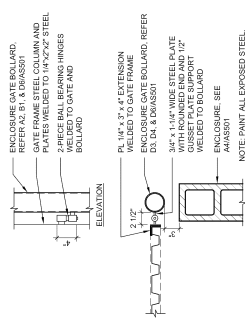

POST CONNECTION @
UTILITY ENCLOSURE GATE



CONTROL AND EXPANSION JOINT SPACING - UNLESS NOTED OTHERWISE ON PLANS			
APPROX WIDTH OF CONCRETE	CURB & GUTTER, ROLL HEADER, FLUSH CURBS	5' WALK	5' WALK & BLDG APRON
CONTROL JOINTS	4' OC	5' OC	6' OC
EXPANSION JOINTS	16' OC	15' OC	24' OC
			18' OC

CONCRETE JOINTS

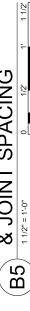

NOTES:

1. WHERE BACK OF CURB AND GUTTER IS EXPOSED ALONG A RAMP, ADD 1/2" RADIUS ON EXPOSED EDGES.
2. CAST-IN-PLACE CONCRETE, LIGHT BROOM FINISH, WITH 1/2" RADIUS ON

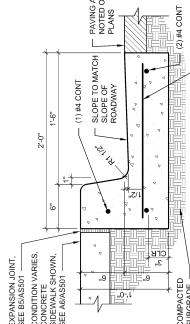

CONCRETE CURB & GUTTER

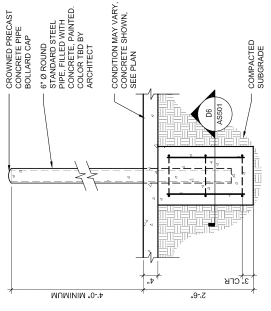

PIPE BOLLARD

ACCESSIBLE PARKING

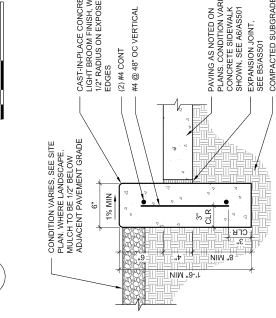

CONCRETE HEADER CURB



NOTES:

1. SEE SITE PLANS AND BS/AS501 FOR JOINING.
2. CAST-IN-PLACE CONCRETE PAVING/LIGHT BROOM FINISH PERPENDICULAR TO TRAFFIC FLOW WITH 1/2" RADIUS ON EXPOSED EDGES
3. INTEGRAL COLOR WHERE NOTED ON PLANS.
4. FINISH GRADE FOR LANDSCAPE AREAS SHALL BE 1/2" BELOW TOP OF PAVING.

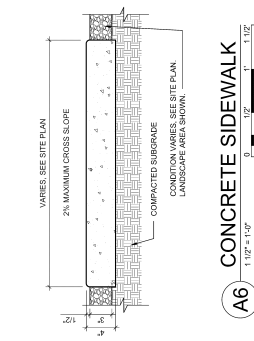

CONCRETE SIDEWALK