

VICINITY MAP E-19

GOODYEAR TIRE CENTER
WYOMING COMMERCIAL COMPLEX PHASE I

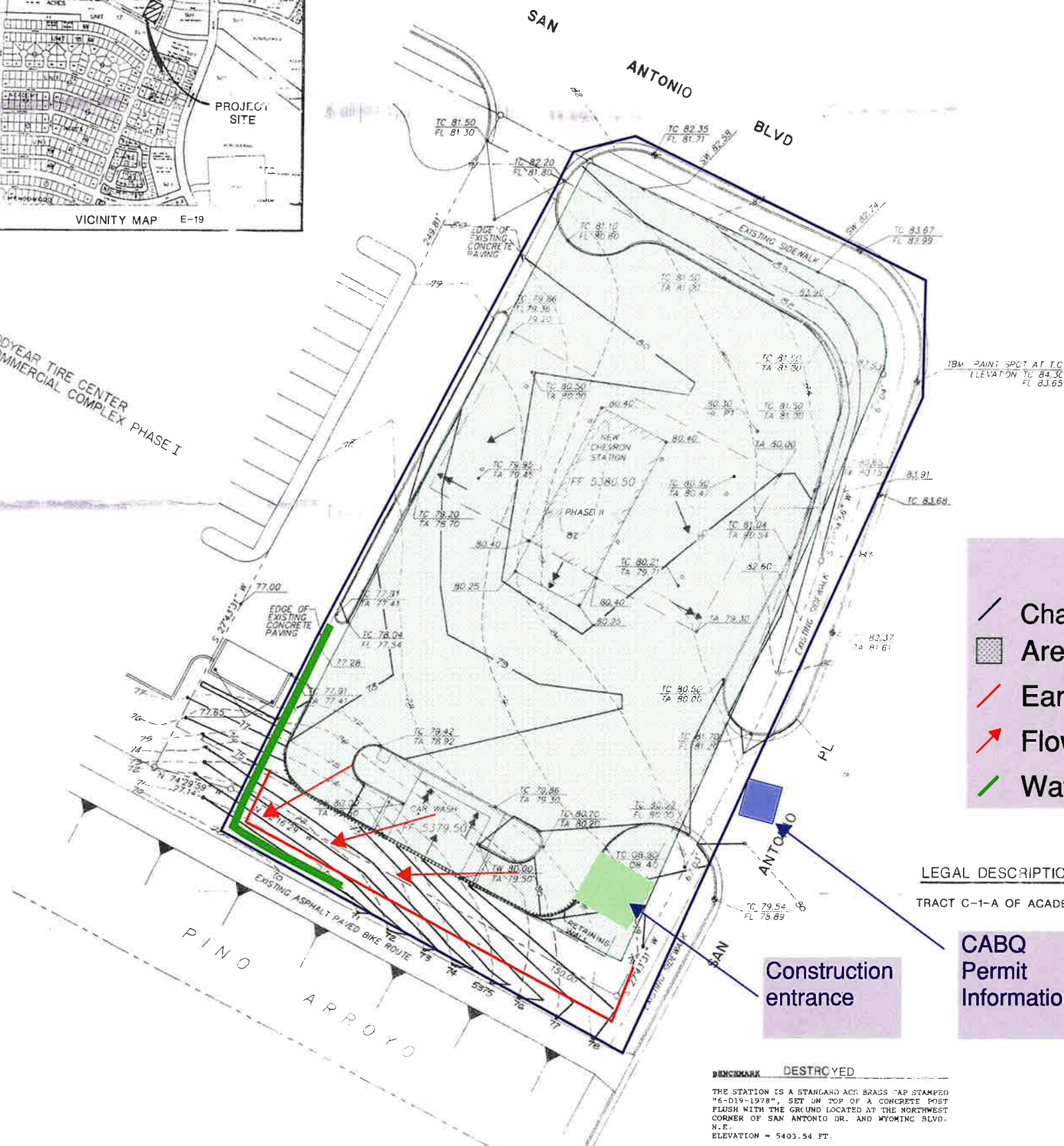

LEGEND

BUILDING	
EXISTING SPOT	
NEW SPOT	
CURB	
EXISTING CONTOUR	
NEW CONTOUR	
ROOF DRAIN	
DIRECTION OF FLOW	

EXISTING ON-SITE CONDITIONS:

SURFACE TYPE	"C" VALUE	A (ACRES)	"C" X A	COMPOSITE
Streets, Drives, Walks	0.95			
Roofs	0.90			
Lawns & Landscaping	0.25			
Undeveloped	0.40	0.9642	0.3857	0.40
TOTAL			0.9642	

$Q(100) = (0.40)(5.06)(0.9642) = 2.0 \text{ cfs}$
 $Q(10) = (0.657)(2) = 1.3 \text{ cfs}$
 $CU = 60$ Plate 22.2 C-2
Direct Runoff = 0.3 in. Plate 22.2 C-4
 $V(100) = (0.3)(0.9642)(43560)/12 = 1050 \text{ cu. ft.}$
 $V(10) = (0.657)(1050) = 690 \text{ cu. ft.}$

PROPOSED ON-SITE CONDITIONS:

SURFACE TYPE	"C" VALUE	A (ACRES)	"C" X A	COMPOSITE
Streets, Drives, Walks	0.95	0.5809	0.5519	
Roofs	0.90	0.1588	0.1420	
Lawns & Landscaping	0.25	0.2245	0.0561	
Undeveloped	0.40	0.9642	0.3857	0.70
TOTAL			0.9642	

$Q(100) = (0.70)(5.06)(0.9642) = 3.5 \text{ cfs}$
 $Q(10) = (0.657)(2) = 1.3 \text{ cfs}$
 $CU = 60$ Plate 22.2 C-2
Direct Runoff = 0.70 in. Plate 22.2 C-4
 $V(100) = (0.70)(0.9642)(43560)/12 = 2400 \text{ cu. ft.}$
 $V(10) = (0.657)(2400) = 1570 \text{ cu. ft.}$

LOCATION AND DESCRIPTION:
THE SITE IS LOCATED ON THE SOUTHWEST CORNER OF SAN ANTONIO DRIVE AND SAN ANTONIO PLACE N.E. THE SITE, CONTAINING APPROXIMATELY 0.9642 ACRES, IS PRESENTLY UNDEVELOPED AND IS PHASE II OF THE WYOMING COMMERCIAL COMPLEX.

EXISTING CONDITIONS:
PRESENTLY, STORM WATER PONDS ON THE SITE. THIS CONDITION WAS CREATED WHEN THE ADJACENT DEVELOPMENT WAS BUILT, PHASE I. NO OFF-SITE FLOODS ENTER THE SITE DUE TO EXISTING ELEVATIONS.

PROPOSED CONDITIONS:
PROPOSED DEVELOPMENT WILL INCLUDE A CHEVRON STATION WITH CAR WASH, ASPHALT PARKING AND LANDSCAPING. THIS DEVELOPMENT WAS APPROVED BY L.P.C. ON 4/10/90. RUNOFF FROM THE SITE WILL BE CONVEYED ACROSS THE ADJACENT DEVELOPED GOODYEAR TIRE CENTER TO A CONCRETE RUNDOWN AT THE P.O. BOX 10. A DRAINAGE AGREEMENT ALLOWING CROSS LOT DRAINAGE HAS BEEN APPROVED.

PHASE III
CALCULATIONS:
Area = 0.9642 acres
1.2 in./hr. Plate 22.2 D-2
100-year rainfall = 2.4 in. Plate 22.2 D-1
 $(2.4)(1)(2.4) = 5.06 \text{ in./hr.}$

CONTROL STATION DATA
NAME OF STATION: 6-E19A
SPIRIT LEVEL ELEV: 5408.59

Note that area of disturbance will be stabilized with a 3-month temporary hydromulch stabilant.

Legend

	Chain Link Fence
	Area of Disturbance
	Earth Berm
	Flow Direction
	Wattle

LEGAL DESCRIPTION
TRACT C-1-A OF ACADEMY ACRES UNIT 17

Construction entrance

CABQ Permit Information

BENCHMARK DESTROYED
THE STATION IS A STANDARD ACS BRASS "AP STAMPED "6-D19-1978", SET ON TOP OF A CONCRETE POST FLUSH WITH THE GROUND LOCATED AT THE NORTHWEST CORNER OF SAN ANTONIO DR. AND WYOMING BLVD. N.E. ELEVATION = 5403.54 FT.

GRADING & DRAINAGE PLAN

SCALE: 1"=20.0'



JOB NO: 9103
DATE:
REVISIONS
MAY 3 1994
HYDROLOGY DIVISION

SHEET

C2

MARKET BUILDING AND CAR WASH
FOR EVEREADY OIL COMPANY
SAN ANTONIO DRIVE AT SAN ANTONIO PLACE,
ALBUQUERQUE, NEW MEXICO

ARCHITECTURE BY
THE KEN HOVEY DESIGN GROUP INC.
255-9400 • 335 JEFFERSON STREET, SUITE B, ALBUQUERQUE, N.M. 87108