

GRADING AND DRAINAGE PLAN
SCALE: 1" = 40'

LEGEND
LIMITS OF DUMPED RIPRAP

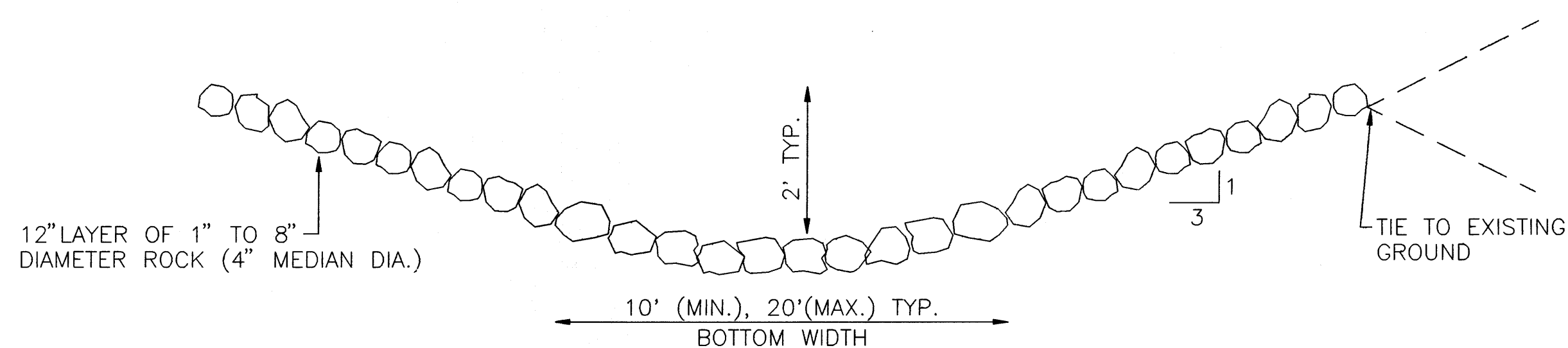

TYPICAL DRAINAGE CHANNEL
NOT TO SCALE

NOTE:
ALL DISTURBED AREAS SHALL BE REVEGETATED PER COA STANDARDS.

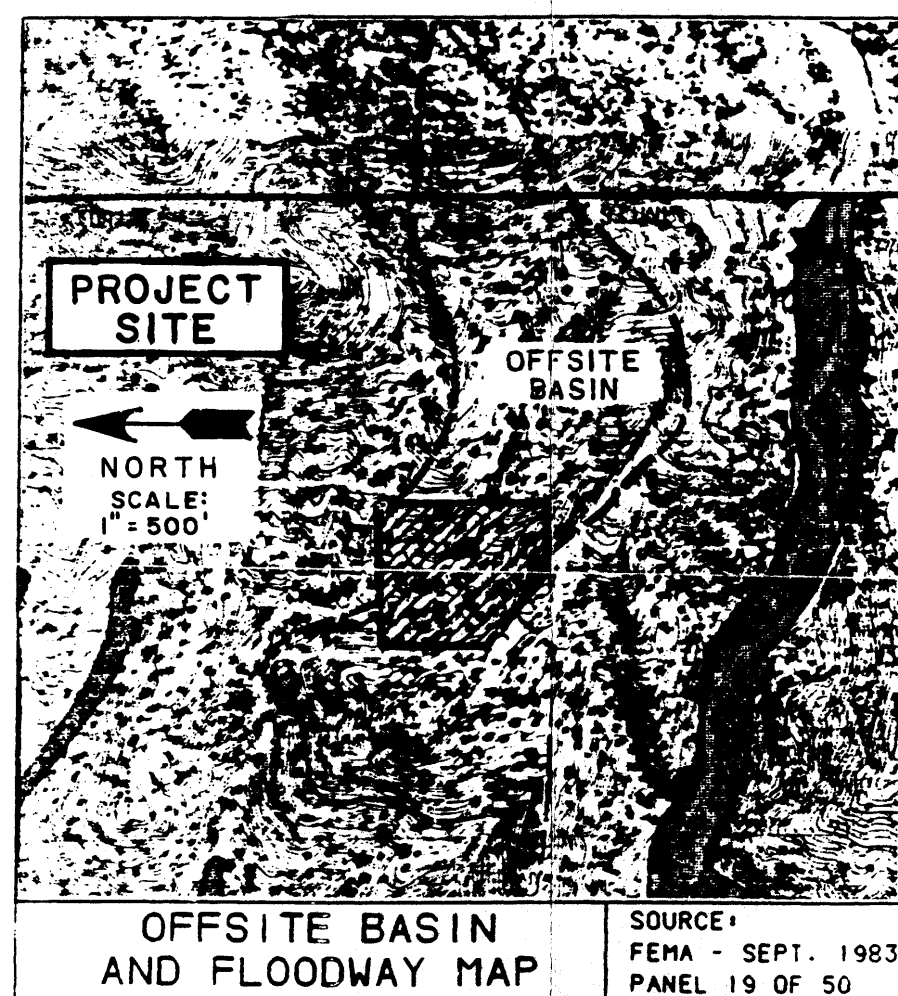
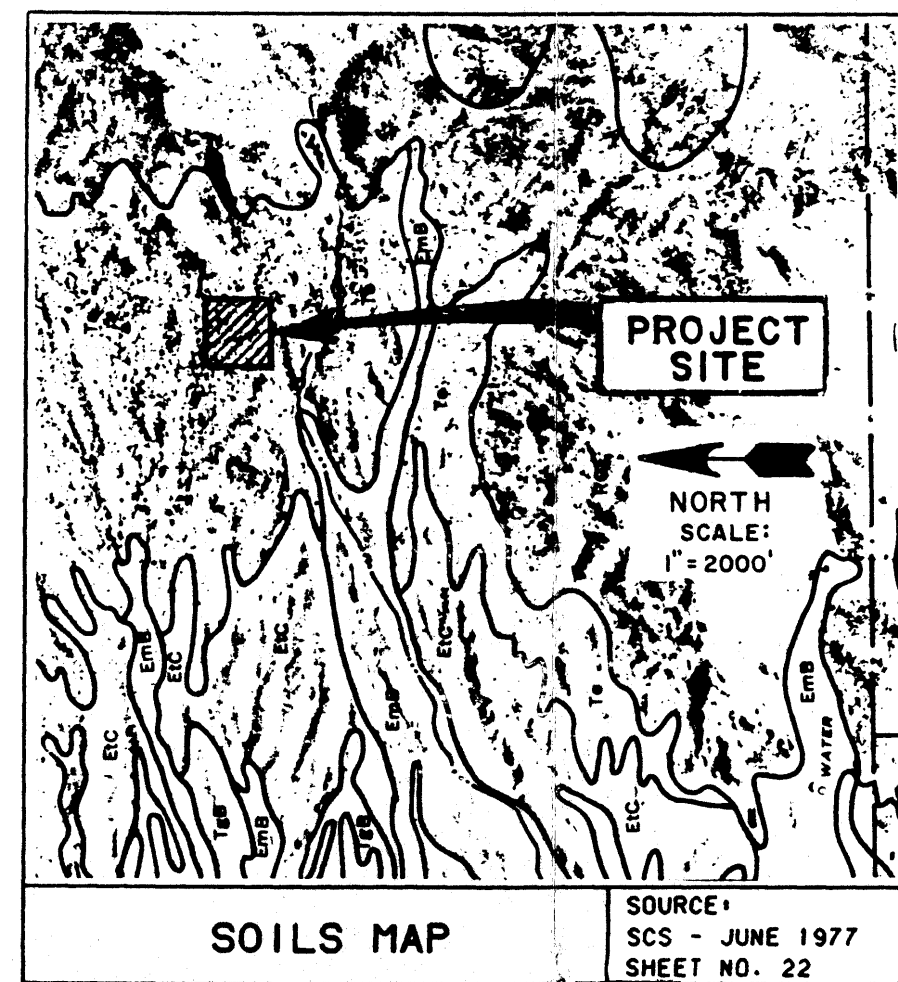
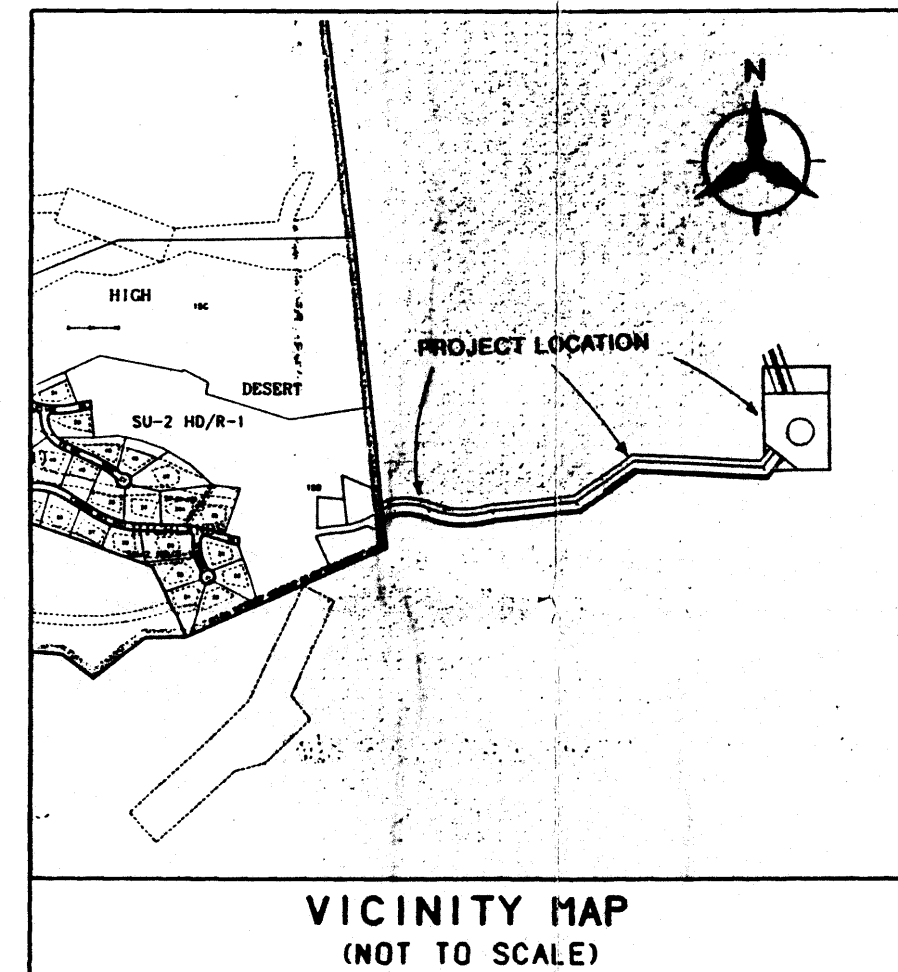
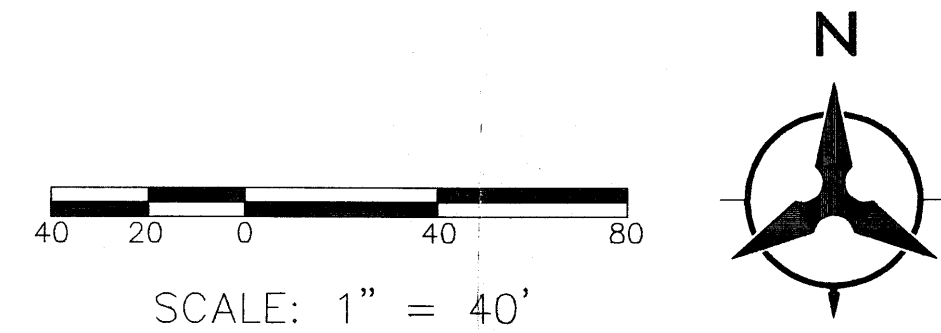

CAÑADA RESERVOIR DRAINAGE PLAN

PLANNING HISTORY: The reservoir site and waterline easement were dedicated for these specific uses when the Albuquerque Academy sold the surrounding land to the U.S. Forest Service in 1982. The reservoir site was selected since it could house the proposed facilities without having a visual impact on land to the west. No other action has been taken on this property.

LEGAL DESCRIPTION: Tract F, "Reservoir Site," as shown on the Elena Gallegos Grant Summary Plat within Projected Sections 25, 26, and 35, T.11N., R.4E, N.M.P.M. within the Elena Gallegos Grant, Bernalillo County, New Mexico, June 1982, containing 3.3373 Acres.

BENCH MARK: 3" brass cap stamped "EMERY," located 223.67 feet west-southwest of the northwest corner of the proposed reservoir site. Elevation = 6509.96.

OFF-SITE FLOWS: Flow from the very upper reach of the Bear Canyon Tributary enters the east and south sides of the proposed site, in unimproved mountainous streams, which flow during and following local rainfall events, but are otherwise dry. Contributing off-site areas are in many areas steep with slopes greater to 20%. Consequently, some of the off-site areas are land use treatment "B" and "C."

ON-SITE FLOWS:

Existing: The site is bisected by the headwater reach of the Bear Canyon Tributary, which flows generally southeast to northwest across the site.

Proposed: Off-site flows from the east and south will be diverted around the proposed reservoir in an improved rock-lined channel section. On-site runoff will be directed radially away from the proposed reservoir to the improved channel. The reservoir site will be fully revegetated to minimize any increase in developed flow rates.

RUNOFF CALCULATION SUMMARY TABLE
CAÑADA RESERVOIR
100 YEAR STORM RUNOFF - SPW PROCEDURE

BASIN	AREA (ACRES)	% LAND TREATMENT				PEAK DISCHARGE - (CFS/AC)				EXISTING (CFS)
		A	B	C	D	A	B	C	D	
OFF-SITE	12.27	15.75	46.14	36.11	0.00	2.20	2.92	3.73	5.25	38.16
ON-SITE	3.34	26.35	53.29	20.36	0.00	2.20	2.92	3.73	5.25	9.67

BASIN	AREA (ACRES)	% LAND TREATMENT				PEAK DISCHARGE - (CFS/AC)				PROPOSED (CFS)
		A	B	C	D	A	B	C	D	
OFF-SITE	12.27	15.75	46.14	36.11	0.00	2.20	2.92	3.73	5.25	38.16
ON-SITE	3.34	5.00	35.33	59.56	0.00	2.20	2.92	3.73	5.25	11.24

NOTES: BASED ON SECTION 22.2. HYDROLOGY OF THE DEVELOPMENT PROCESS MANUAL, VOLUME 2, DESIGN CRITERIA FOR THE CITY OF ALBUQUERQUE.

LEGEND

- SITE PROPERTY LINE
- PUBLIC EASEMENT LINE
- EXISTING CONTOUR
- EXISTING INDEX CONTOUR
- PROPOSED CONTOUR
- PROPOSED INDEX CONTOUR
- SURFACE FLOW DIRECTION
- PROPOSED STORM DRAIN

CAÑADA RESERVOIR GRADING & DRAINAGE PLAN

PREPARED FOR:
CITY OF ALBUQUERQUE
PUBLIC WORKS DEPARTMENT
UTILITIES PLANNING DIVISION

DESIGNED BY: C.W.H. 10/95
DRAWN BY: J.S.M. 10/95
CHECKED BY: H.C.S. 10/95

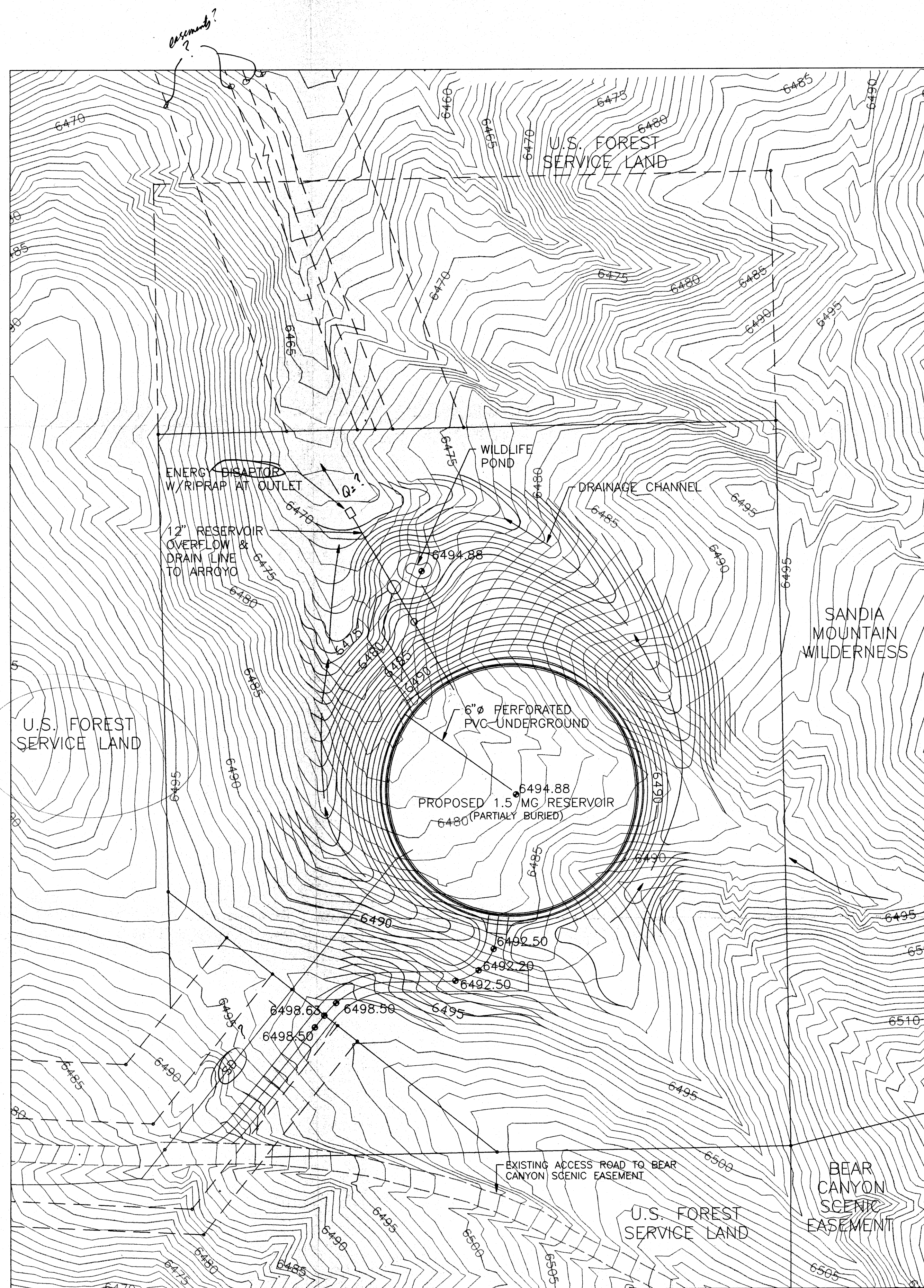

GRADING AND DRAINAGE PLAN
SCALE 1"=40'

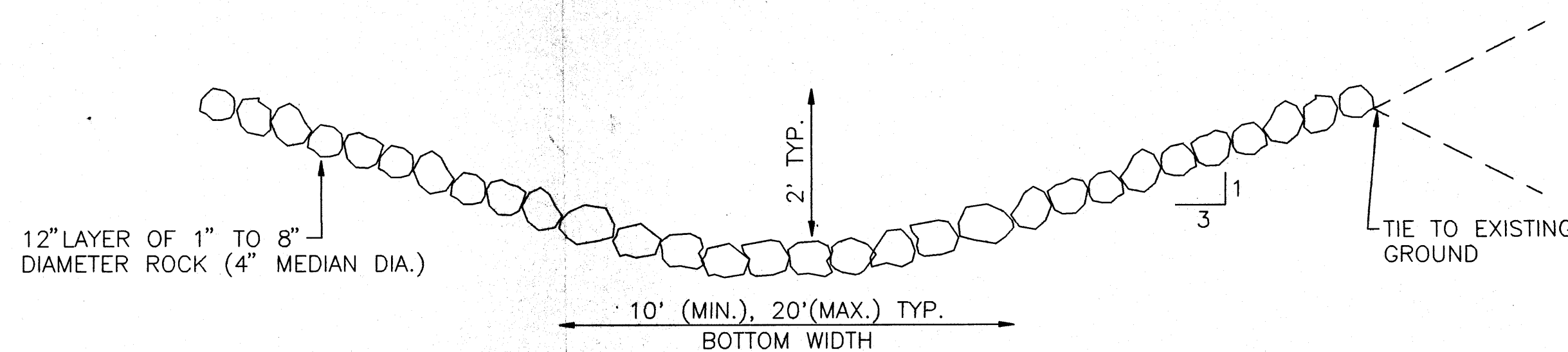

TYPICAL DRAINAGE CHANNEL
NOT TO SCALE

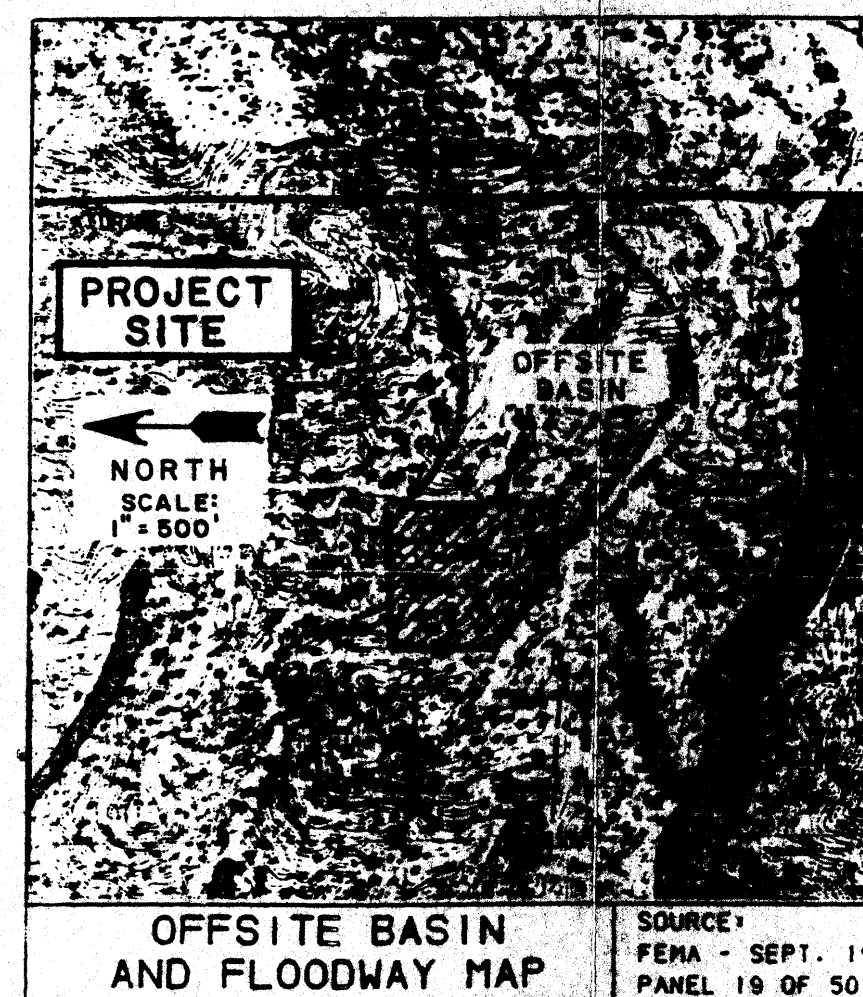
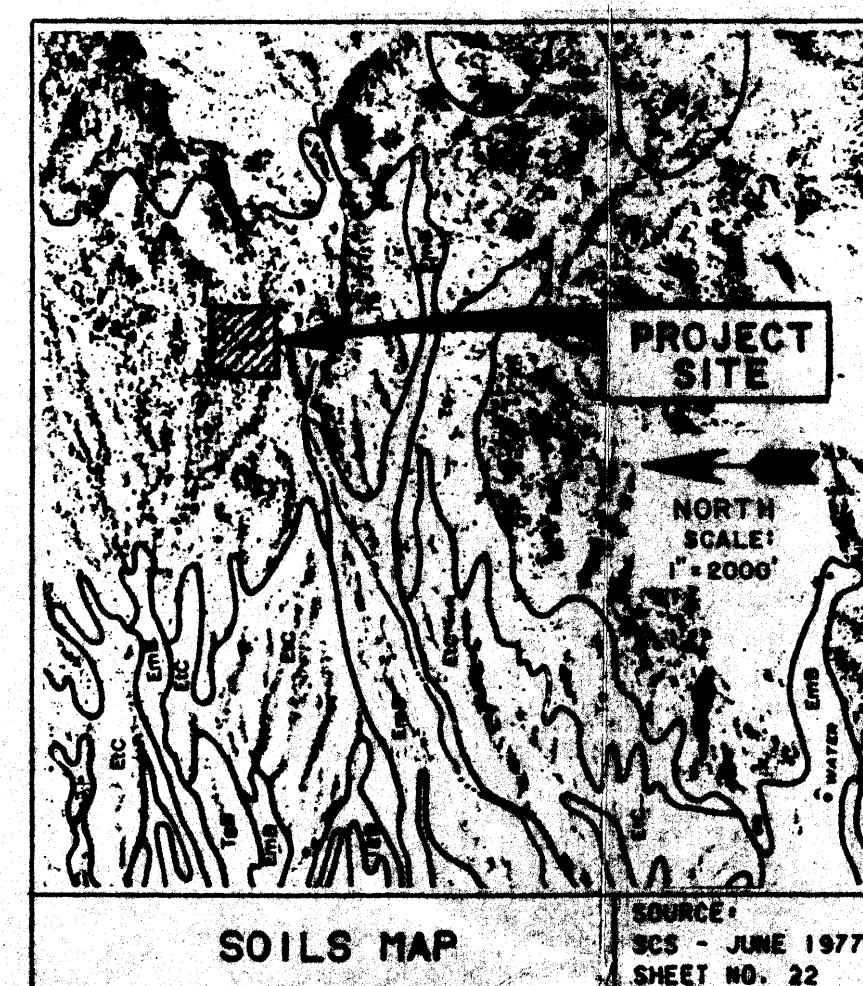
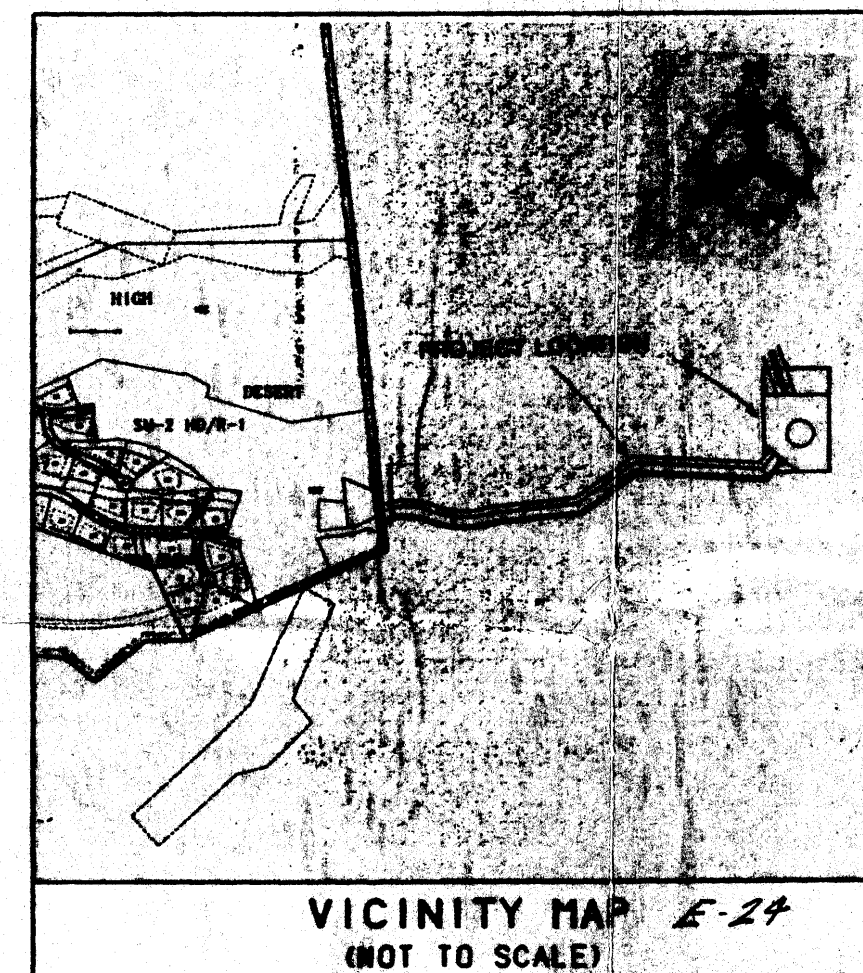
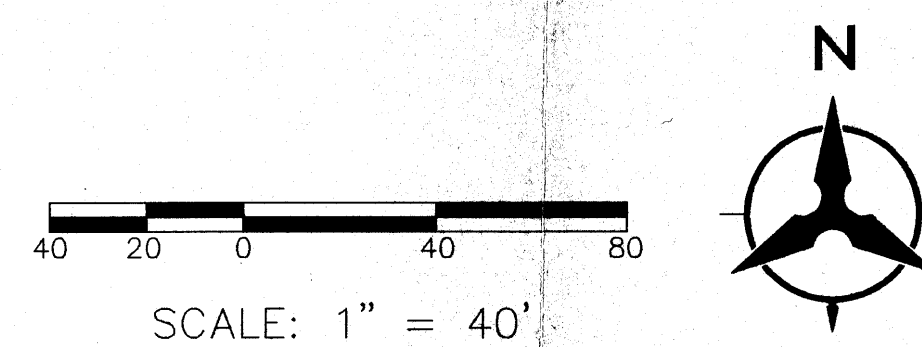

CAÑADA RESERVOIR DRAINAGE PLAN

PLANNING HISTORY: The reservoir site and waterline easement were dedicated for these specific uses when the Albuquerque Academy sold the surrounding land to the U.S. Forest Service in 1982. The reservoir site was selected since it could house the proposed facilities without having a visual impact on land to the west. No other action has been taken on this property.

LEGAL DESCRIPTION: Tract F, "Reservoir Site," as shown on the Elena Gallegos Grant Summary Plat within Projected Sections 25, 26, and 35, T.11N., R.4E, N.M.P.M. within the Elena Gallegos Grant, Bernalillo County, New Mexico, June 1982, containing 3.3373 Acres.

BENCH MARK: 3" brass cap stamped "EMERY," located 223.67 feet west-southwest of the northwest corner of the proposed reservoir site. Elevation = 6509.96.

OFF-SITE FLOWS: Flow from the very upper reach of the Bear Canyon Tributary enters the east and south sides of the proposed site, in unimproved mountainous streams, which flow during and following local rainfall events, but are otherwise dry. Contributing off-site areas are in many areas steep with slopes greater to 20%. Consequently, some of the off-site areas are land use treatment "B" and "C."

ON-SITE FLOWS:

Existing: The site is bisected by the headwater reach of the Bear Canyon Tributary, which flows generally southeast to northwest across the site.

Proposed: Off-site flows from the east and south will be diverted around the proposed reservoir in an improved rock-lined channel section. On-site runoff will be directed away from the proposed reservoir to the improved channel. The reservoir site will be fully revegetated to minimize any increase in developed flow rates.

RUNOFF CALCULATION SUMMARY TABLE CAÑADA RESERVOIR 100 YEAR STORM RUNOFF - DPM PROCEDURE

BASIN	AREA (ACRES)	% LAND TREATMENT				PEAK DISCHARGE - (CFS/AC)				EXISTING Q (100-YR)
		A	B	C	D	A	B	C	D	
OFF-SITE	12.57	15.75	48.14	38.11	0.00	2.20	2.92	3.73	5.25	3.19
ON-SITE	3.34	26.35	63.29	20.36	0.00	2.20	2.92	3.73	5.25	3.67

BASIN	AREA (ACRES)	% LAND TREATMENT				PEAK DISCHARGE - (CFS/AC)				PROPOSED Q (100-YR)
		A	B	C	D	A	B	C	D	
OFF-SITE	12.57	15.75	48.14	38.11	0.00	2.20	2.92	3.73	5.25	3.19
ON-SITE	3.34	5.09	35.33	55.57	0.00	2.20	2.92	3.73	5.25	3.23

NOTES:
BASED ON SECTION 22.2, HYDROLOGY OF THE DEVELOPMENT PROCESS MANUAL, VOLUME 2, DESIGN CRITERIA FOR THE CITY OF ALBUQUERQUE.

LEGEND

SITE PROPERTY LINE	_____
PUBLIC EASEMENT LINE	-----
EXISTING CONTOUR	~~~~~
EXISTING INDEX CONTOUR	~~~~~ 6490 ~~~~~
PROPOSED CONTOUR	~~~~~
PROPOSED INDEX CONTOUR	~~~~~ 6490 ~~~~~
SURFACE FLOW DIRECTION	—————>
PROPOSED STORM DRAIN	——SD——

CAÑADA RESERVOIR GRADING & DRAINAGE PLAN

PREPARED FOR:
CITY OF ALBUQUERQUE
PUBLIC WORKS DEPARTMENT
UTILITIES PLANNING DIVISION

DESIGNED BY: C.W.H. 10/95
DRAWN BY: J.S.M. 10/95
CHECKED BY: H.C.S. 10/95

SHEET 4 OF 4