

# CITY OF ALBUQUERQUE



December 3, 2014

David Thompson, P.E.  
Thompson Engineering Consultants, Inc.  
PO Box 65760  
Albuquerque, New Mexico 87193

**RE: La Luz Del Oeste Unit 4 Lots K-6, K-7, K-8, K-9, K-10 & K-11  
Grading and Drainage Plan  
Engineers Stamp Date 9/2/14 (F11-D002A)  
Certification Date 12/2/14**

Dear Mr. Thompson,

Based upon the information provided in your submittal received 12/2/2014, the above referenced Certification is not acceptable for building permit. The following comments need to be addressed before acceptance.

PO Box 1293

- Lots K-6 & K-7 have a pile of fresh concrete between them.
- Lots K-8, K-9, K-10 & K-11 pads are below the finish grade stake in the field and the FP call out on the plan are below the street elevation.

Albuquerque

New Mexico 87103 If you have any questions, please contact me at 924-3986 or Rudy Rael at 924-3977.

[www.cabq.gov](http://www.cabq.gov)







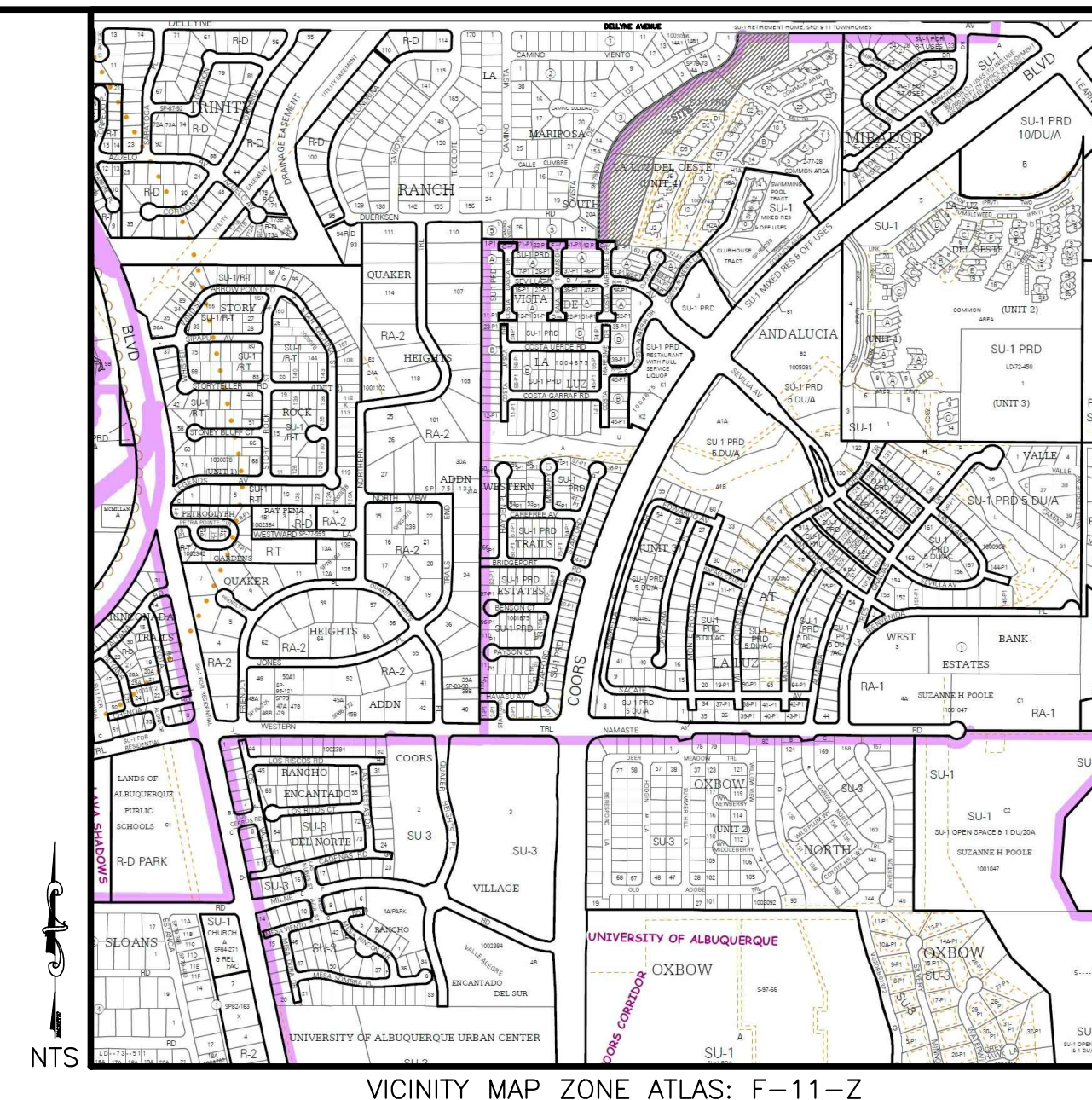

Sincerely,

Curtis Cherne, P.E.  
Principal Engineer, Planning Department  
Development and Review Services

RR/CC  
C: File





FF =93.00	FINISHED FLOOR ELEVATION
92.00	SPOT ELEVATIONS
	EXIST. MAJOR CONTOURS
	EXIST. MINOR CONTOURS
	PROP. MAJOR CONTOURS
	PROP. MINOR CONTOURS
	FLOW DIRECTION
	PROPOSED BUILDING ENVELOPE
	BOUNDARY
	PROP. RETAINING WALL

GRAPHIC SCALE

( IN FEET )  
1 inch = 40 ft.

<u>BASIN</u>	<u>100YR 6HR VOLUME</u>	<u>100-YR WSEL</u>	<u>AS-BUILT VOLUME PROVIDED</u>
101	2,592 CF	5112.65	3,250 CF
102	7,553 CF	5103.70	10,950 CF
103	3,866 CF	5112.18	9,000 CF
104	4,064 CF	5104.27	4,260 CF
<del>105</del>	<del>2,547 CF</del>	<del>5105.49</del>	
<del>106</del>	<del>3,659 CF</del>	<del>5112.52</del>	
<del>107</del>	<del>7,314 CF</del>	<del>5105.38</del>	

DATE \_\_\_\_\_

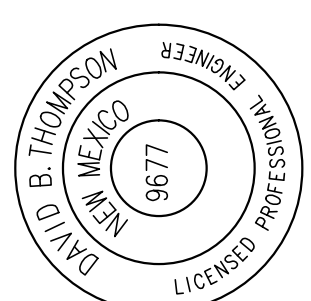
[illegible]

# GRADING AND DRAINAGE PLAN

CITY/COUNTY REVIEW		SIGN-OFF	DATE
DEPARTMENT			
WASTEWATER MGMT. DIV.			
WATER SERVICES			
SUBDIVISION ENG.			
STREETS			
TRAFFIC			
FOR CITY/COUNTY USE ONLY			

1 of 3