

CITY OF ALBUQUERQUE



February 16, 2016

Verlyn Miller, PE
Miller Engineering Consultants
3500 Comanche NE Bldg. F
Albuquerque, NM 87110

Re: Taco Bell Renovations
4815 4th St NW
Request for 90-Day Temporary C.O. - Accepted
Engineer's Stamp dated: 8-26-15 (F14D071)
Certification dated: ~~NA~~ 2-16-16

Dear Mr. Miller,

Based on the certification provided in your submittal received 2/16/2016, the above referenced is approved for a 90-day Temporary Release of Occupancy by Hydrology. However, before a permanent CO can be accepted the following comments must be addressed.

PO Box 1293

Albuquerque

New Mexico 87103

www.cabq.gov

- The sidewalk culvert must be completed. Until it is complete it must remain barricaded with "Sidewalk Closed" signs on both sides starting at each entrance to the site. The bottom of water harvest on this pond needs to be approximately 3'-3" below TOC.
- The pond that diverts to the above mention culvert needs to be graded to flow into the culvert.
- The bottom of water harvest on the NW corner needs to be approximately 3'-3" below TOC.
- The 3' curb cut is missing from this water harvest area.
- The bottom of water harvest on the SE corner needs to be approximately 2'-3" below TOC.
- The bottom of water harvest on the east side needs to be approximately 2'3" below TOC.

An inspection by our office will need to take place after these corrects are made.

If you have any questions, you can contact me at 924-3686 or Totten Elliott at 924-3982.

CITY OF ALBUQUERQUE



Sincerely,

Abiel Carrillo, P.E.
Principal Engineer, Planning Department
Development and Review Services

TE/AC
C: email, Cordova, Camille C.; Miranda, Rachel; Cordova, Camille C.; Blocker, Lois

PO Box 1293

Albuquerque

New Mexico 87103

www.cabq.gov

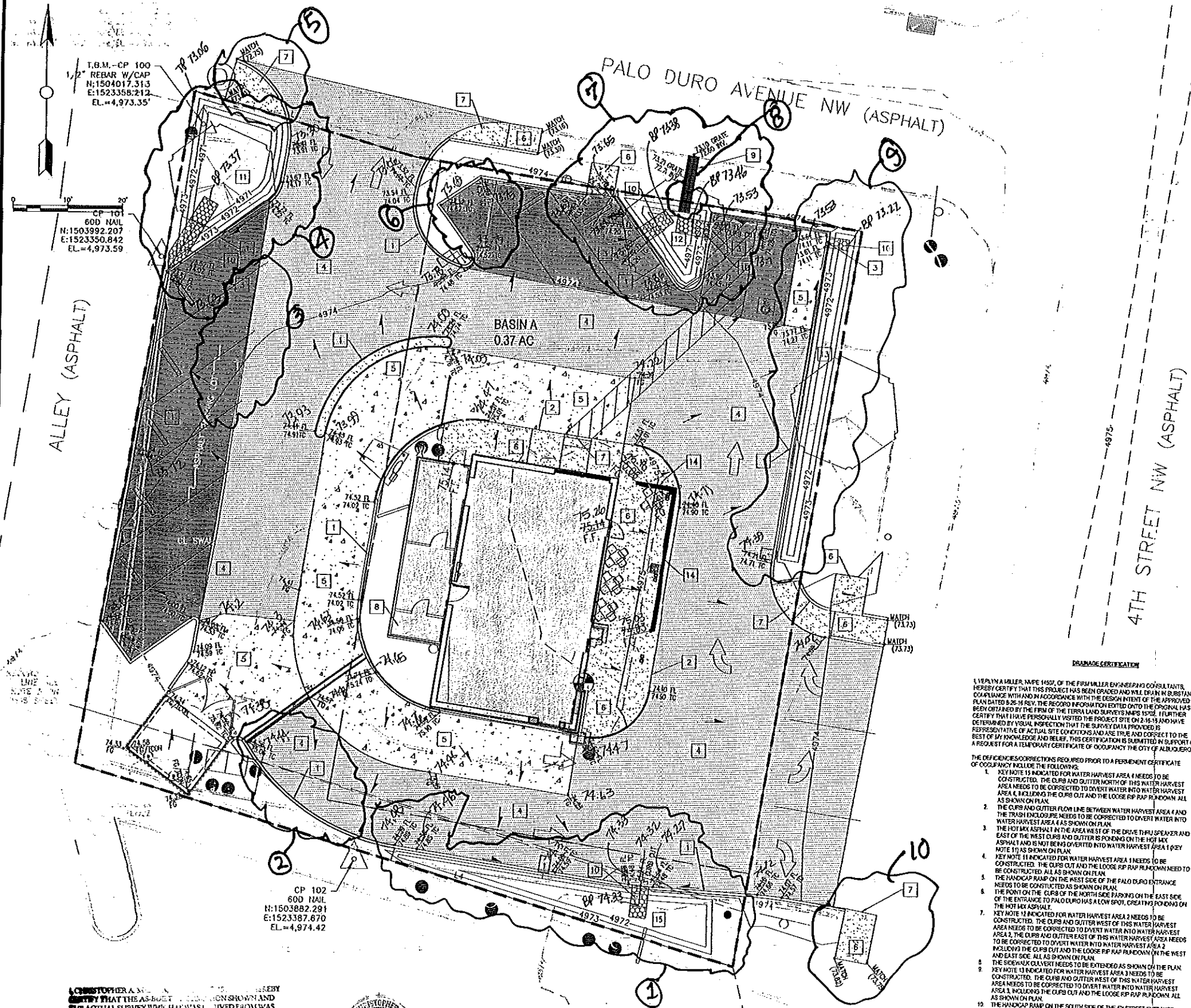

LEGEND:

3600	PROPOSED SPOT ELEVATIONS (FINISHED GRADE)
3610	MATCH EXISTING ELEVATIONS
100H	TOP OF CONCRETE
FL	FLOW LINE, CURB
RV	INVERT
FO	FINISH GRADE
TBC	TOP OF BASE COURSE
TC	TOP OF CURB
TO	TOP OF GRATE
	FLOW ARROW
	GRADE BREAK-HIGH POINT
SD	SWALE
5895	STORM DRAIN LINE
	PROPOSED MAJOR CONTOUR
	PROPOSED MINOR CONTOUR
	EXISTING MAJOR CONTOUR
	EXISTING MINOR CONTOUR
	HEAVY DUTY ASPHALT PAVING
	LIGHT DUTY ASPHALT PAVING
	HEAVY DUTY CONCRETE PAVING
	PROPOSED BASIN BOUNDARY

KEYED NOTES:

1. NEW CURB AND GUTTER. SEE ARCHITECTURAL PLANS FOR DETAIL.
2. NEW TURN DOWN CONCRETE SIDEWALK EDGE. SEE ARCHITECTURAL PLANS FOR DETAIL.
3. NEW 3' CURB CUT.
4. NEW HEAVY DUTY ASPHALT PAVING. SEE SECTION DETAILS ON ARCHITECTURAL PLANS.
5. NEW HEAVY DUTY CONCRETE PAVING. SEE SECTION DETAILS ON ARCHITECTURAL PLANS.
6. NEW CONCRETE SIDEWALK. SEE ARCHITECTURAL PLANS FOR DETAIL.
7. NEW CONCRETE HC ACCESS RAMPS. SEE ARCHITECTURAL PLANS FOR DETAIL.
8. NEW BUILDING ADDITION. SEE ARCHITECTURAL PLANS FOR DETAILS.
9. NEW SIDEWALK CULVERT PER C.O.A. STD. DWG. 2236, SEE SHT. C-500. EXTEND 2' PAST PROPERTY LINE.
10. NEW LOOSE RIP RAP RUNDOWN. SEE SHEET C-500 FOR DETAILS.
11. NEW WATER HARVEST AREA 1. TOP=73.0, INV=71.0. SIDE SLOPE 1:1. SEE DETAIL ON SHEET C-500.
12. NEW WATER HARVEST AREA 2. TOP=73.0, INV=71.0. SIDE SLOPE 1:1. SEE DETAIL ON SHEET C-500.
13. NEW WATER HARVEST AREA 3. TOP=73.0, INV=72.0. SIDE SLOPE 1:1. SEE DETAIL ON SHEET C-500.
14. NEW WALL WITH WEEP HOLES. SEE ARCHITECTURAL DRAWINGS FOR DETAIL.
15. NEW WATER HARVEST AREA 4. TOP=73.0, INV=72.0. SIDE SLOPE 1:1. SEE DETAIL ON SHEET C-500.

12134.140

CONTRACT DATE: 07.08.2015
BUILDING TYPE: EXPLORER
PLAN VERSION: APRIL 2015 (R)
SITE NUMBER: XXXXXX
STORE NUMBER: XXXXX

TACO BELL
4915 4TH STREET NW
ALBUQUERQUE, NM

ME
EXPLORER
CONVERSION

GRADING AND
DRAINAGE PLAN

C-101

VERLYN A. MILLER, N.E. 14507, OF THE FIRM MILLER ENGINEERING CONSULTANTS, HEREBY CERTIFY THAT THIS PROJECT HAS BEEN GRADED AND WILL BE IN SUBSTANTIAL COMPLIANCE WITH AND IN ACCORDANCE WITH THE DESIGN INTENT OF THE APPROVED PLAN DATED 12.16.14. THE RECORD INFORMATION EDITED ONTO THE ORIGINAL HAS BEEN OBTAINED BY THE FIRM OF THE TERRA LAND SURVEYING, INC. AND I HAVE CERTIFY THAT I HAVE PERSONALLY VISITED THE PROJECT SITE ON 2-14-15 AND HAVE DETERMINED BY VISUAL INSPECTION THAT THE SURVEY DATA PROVIDED IS REPRESENTATIVE OF ACTUAL SITE CONDITIONS AND IS TRUE AND CORRECT TO THE BEST OF MY KNOWLEDGE AND BELIEF. THIS CERTIFICATION IS SUBMITTED IN SUPPORT OF A REQUEST FOR A TEMPORARY CERTIFICATE OF OCCUPANCY THE CITY OF ALBUQUERQUE.

THE DEFICIENCIES/REVISIONS REQUIRED PRIOR TO A PERMANENT CERTIFICATE OF OCCUPANCY INCLUDE THE FOLLOWING:

1. KEY NOTE 11 INDICATED FOR WATER HARVEST AREA 1 NEEDS TO BE CONSTRUCTED. THE CURB AND GUTTER NORTH OF THIS WATER HARVEST AREA NEEDS TO BE CORRECTED TO DIVERT WATER INTO WATER HARVEST AREA 1 INCLUDING THE CURB CUT AND THE LOOSE RIP RAP RUNDOWN ALL AS SHOWN ON PLAN.
2. THE CURB AND GUTTER FLOW LINE BETWEEN WATER HARVEST AREA 1 AND THE TUSH ENCLOSED AREA NEEDS TO BE CORRECTED TO DIVERT WATER INTO WATER HARVEST AREA 1 AS SHOWN ON PLAN.
3. THE HOT MIX ASPHALT IN THE AREA WEST OF THE DRIVE THRU SPEAKER AND EAST OF THE WEST CURB AND GUTTER IS PONDING ON THE HOT MIX ASPHALT AND IS NOT BEING DIVERTED INTO WATER HARVEST AREA 1 (KEY NOTE 11) AS SHOWN ON PLAN.
4. KEY NOTE 11 INDICATED FOR WATER HARVEST AREA 1 NEEDS TO BE CONSTRUCTED. THE CURB CUT AND THE LOOSE RIP RAP RUNDOWN NEED TO BE CONSTRUCTED. ALL AS SHOWN ON PLAN.
5. THE HANDICAP RAMP ON THE WEST SIDE OF THE PALO DURO ENTRANCE NEEDS TO BE CONSTRUCTED AS SHOWN ON PLAN.
6. THE POINT OF THE CURB OF THE NORTH SIDE PARKING ON THE EAST SIDE OF THE ENTRANCE TO PALO DURO HAS A LOW SPOT. CREATING FLOWWAYS ON THE HOT MIX ASPHALT.
7. KEY NOTE 11 INDICATED FOR WATER HARVEST AREA 2 NEEDS TO BE CONSTRUCTED. THE CURB AND GUTTER WEST OF THIS WATER HARVEST AREA NEEDS TO BE CORRECTED TO DIVERT WATER INTO WATER HARVEST AREA 2. THE CURB AND GUTTER EAST OF THIS WATER HARVEST AREA NEEDS TO BE CORRECTED TO DIVERT WATER INTO WATER HARVEST AREA 2 INCLUDING THE CURB CUT AND THE LOOSE RIP RAP RUNDOWN ON THE WEST AND EAST SIDE. ALL AS SHOWN ON PLAN.
8. THE SIDEWALK CULVERT NEEDS TO BE EXTENDED AS SHOWN ON PLAN.
9. KEY NOTE 13 INDICATED FOR WATER HARVEST AREA 3 NEEDS TO BE CONSTRUCTED. THE CURB AND GUTTER WEST OF THIS WATER HARVEST AREA NEEDS TO BE CORRECTED TO DIVERT WATER INTO WATER HARVEST AREA 3 INCLUDING THE CURB CUT AND THE LOOSE RIP RAP RUNDOWN ALL AS SHOWN ON PLAN.
10. THE HANDICAP RAMP ON THE SOUTH SIDE OF THE 4TH STREET ENTRANCE NEEDS TO BE CONSTRUCTED AS SHOWN ON PLAN.

THE RECORD INFORMATION PRESENTED HEREON IS NOT NECESSARILY COMPLETE AND INTENDED ONLY TO VERIFY SUBSTANTIAL COMPLIANCE OF THE GRADING AND DRAINAGE ASPECTS DRAWINGS OF THIS PROJECT. THOSE RELYING ON THIS RECORD DOCUMENT ARE ADVISED TO OBTAIN INDEPENDENT VERIFICATION OF ITS ACCURACY BEFORE USING IT FOR ANY OTHER PURPOSE.

VERLYN A. MILLER 2/14/16
DATE



ME
MILLER ENGINEERING CONSULTANTS
Engineers • Planners
3000 COUNTRY, NE
ALBUQUERQUE, NM 87110
(505) 262-1200
(505) 262-1200 (FAX)
WWW.MECALCON.COM

CHRISTOPHER A. MEDDA, N.E. 14507, OF THE FIRM MILLER ENGINEERING CONSULTANTS, HEREBY CERTIFY THAT THE AS-BUILT DRAWING SHOWN AND THE ACTUAL SURVEY WHILE IT WAS LIVED FROM WAS PERFORMED BY ME OR UNDER MY DIRECT SUPERVISION AND THAT THE INFORMATION IS TRUE AND CORRECT TO THE BEST OF MY KNOWLEDGE AND BELIEF.
CHRISTOPHER A. MEDDA, N.E. 14507, N.E. 14507
DATE 2/14/16

