

# CITY OF ALBUQUERQUE



September 1, 2016

Mr. Kirk Randall  
2010 North Redwood Rd  
Salt Lake City, UT 84116

**Re: Smith's #423 Fuel Center  
Request for Permanent C.O. - Accepted  
Engineer's Stamp Date 2-2-16 (F14D072)  
Certification date: 8-31-16**

Dear Mr. Randall,

Based upon the information provided in your submittal received 8/31/2016, the above referenced Certification received is acceptable for the release of Certificate of Occupancy by Hydrology.

If you have any questions, you can contact me at 924-3695 or Rudy Rael at 924-3977.

Sincerely,

PO Box 1293

Albuquerque

Rita Harmon, P.E.  
Senior Engineer, Planning Dept.  
Development Review Services

New Mexico 87103

[www.cabq.gov](http://www.cabq.gov)

RR/RH  
C: email

Cordova, Camille C.; Miranda, Rachel; Sandoval, Darlene M.; Blocker,  
Lois



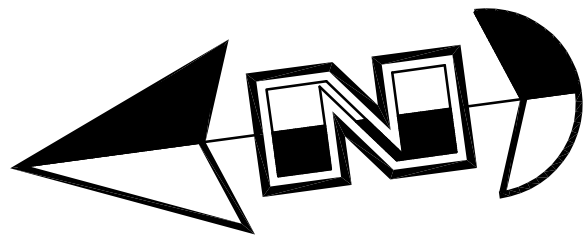

Scale: 1" = 10'



**General Grading Notes:**

- All grading shall be in accordance with the project geotechnical report.
- Cut slopes shall be no steeper than 3 horizontal to 1 vertical.
- Fill slopes shall be no steeper than 3 horizontal to 1 vertical.
- Fills shall be compacted per the recommendations of the geotechnical report prepared for the project and shall be certified by the Owner's Special Inspection.
- Areas to receive fill shall be properly prepared and approved by the Owner's Special Inspection prior to placing fill.
- Fills shall be benched into competent material as per specifications and geotechnical report.
- All trench backfill shall be tested and certified by the Owner's Special Inspection.
- The Owner's Special Inspection shall perform periodic inspections and submit a complete report and map upon completion of the rough grading.
- The final compaction report and certification from the Owner's Special Inspection shall contain the type of field testing performed. Each test shall be identified with the method of obtaining the in-place density, whether sand cone or drive ring and shall be so noted for each test. Sufficient maximum density determinations shall be performed to verify the accuracy of the maximum density curves used by the field technician.
- Dust shall be controlled by watering.
- The location and protection of all utilities is the responsibility of the permittee.
- Approved protective measures and temporary drainage provisions must be used to protect adjoining properties during the grading process.
- All public roadways must be cleared daily of all dirt, mud and debris deposited on them as a result of the grading operation. Cleaning is to be done to the satisfaction of the City Engineer.
- The site shall be cleared and grubbed of all vegetation and deleterious matter prior to grading.
- The contractor shall provide shoring in accordance with OSHA requirements for trench walls.
- Aggregate base shall be compacted per the geotechnical report prepared for the project.
- The recommendations in the following Geotechnical Engineering Report by Kleinfelder are included in the requirements of grading and site preparation. The report is titled "Geological Engineering Report Proposed Smith's Food & Drug Fuel Center Retail Store #423 5640 4th Street NW Albuquerque, New Mexico".  
Project No.: 20152711.001A  
Dated: October 29, 2014
- As part of the construction documents, owner has provided contractor with a topographic survey performed by manual or aerial means. Such survey was prepared for project design purposes and is provided to the contractor as a courtesy. It is expressly understood that such survey may not accurately reflect existing topographic conditions.
- If Contractor observes evidence of hazardous materials or contaminated soils he shall immediately contact the project engineer to provide notification and obtain direction before proceeding with disturbance of said materials or contaminated soil.
- Contractor will be responsible to phase the construction development so that storm water improvements and storm water facilities including detention or retention improvement facilities are constructed and functional prior to an offsite storm water release and take necessary construction precautions so that no offsite flooding will occur.
- Importing fill material from an off-site location without prior written approval from the Owner's Project Manager is strictly prohibited. Identification of offsite borrow locations and material must be coordinated and documented with the SMC. The Owner's Special Inspection shall verify the suitability of all off-site material. This includes an analysis to insure that no environmental contamination is present. If any material is brought on site without prior written approval of the Owner's Project Manager, the Contractor will bear all costs associated with removing the material, testing for contamination, monitoring the clean-up operation, disposal in an approved landfill, and certifying that the Owner's site is environmentally clean. If requested, the Owner's Project Manager or the Owner's Special Inspection must be granted unfettered access to any and all borrow sites.

**Curb and Gutter Construction Notes:**

- Open face gutter shall be constructed where drainage is directed away from curb.
- Open face gutter locations are indicated by shading and notes on the grading plan.
- It is the responsibility of the surveyor to adjust top of asphalt grades to top of curb grades at the time of construction staking.
- Refer to the typical details for a standard and open face curb and gutter for dimensions.
- Transitions from open face to standard curb and gutter are to be smooth. Hand form these areas if necessary.

**DRAINAGE CERTIFICATION WITH SURVEY WORK BY PROFESSIONAL SURVEYOR**

**DRAINAGE CERTIFICATION**

I, David G. Anderson, NMPE 20167, of the firm Anderson Wahlen & Associates, hereby certify that this project has been graded and will drain in substantial compliance with and in accordance with the design intent of the approved plan dated 02-02-16. The record information edited onto the original design document has been obtained by Russ P. Hugg, NMPS 9750, of the firm Tek, Inc. I further verify that I have reviewed the site improvements and personnel under my direct supervision have observed the project site on 08-24-16 and have determined by visual observation that the survey data provided is representative of actual site conditions and is true and correct to the best of my knowledge and belief. This documentation is submitted in support of a request for Final Occupancy Permit. (Describe any exceptions and/or qualifications here in a separate paragraph)

None

(Describe any deficiencies and/or corrections required here in a separate paragraph)

None

The record information presented hereon is not necessarily complete and intended only to verify substantial compliance of the grading and drainage aspects of this project. Those relying on this record document are advised to obtain independent verification of its accuracy before using it for any other purpose.

David G. Anderson, NMPE 20167

(seal)

Date



**NOTE:**

See Plans by Madison Industries for Footing Depth.

New Mexico One Call, Inc.



**Accessible Note:**

Contractor must maintain a running slope on Accessible routes no steeper than 5.0% (1:20). The cross slope for Accessible routes must be no steeper than 2.0% (1:50). All Accessible routes must have a minimum clear width of 36". If Grades on pions do not meet this requirement notify Consultant immediately.

The Client, Contractor and Subcontractor should immediately notify the Consultant of any conditions of the project that they believe do not comply with the current state of the (ICC/ANSI) A117.1-Latest Edition) and/or FHAA.

Tank Depth of Bury Calculations			
DESCRIPTION	FURTHEST ISLAND	LOWEST ISLAND	
1. Elevation at Top of Island	4977.37	4976.52	
2. Min. Slope of Piping = (L) x 1/8" per foot			
Where L1 = 215 ft., L2 = 60 ft.	2.2	0.6	ft
3. Dispenser Island			
Concrete Drive Slab	6"		
Pipe Cover	6"		
Pipe Diameter	3"		
Tank Connection	10"		
Total	33"		
4. Grade Differential = (#2 + #3)	4.95	3.35	ft
5. Top of Tanks = (#1 - #4)	4972.42	4973.17	ft
6. Top of Tanks = Lowest Calculated Elevation		4972.42	
Check Min. / Max. Burial Depth		4.0' Min. / 7.0' Max.	
7. Lowest Elevation of Slab Above Tank		4975.50	
8. Depth of Bury = (#7 - #6)		3.08	ft
NOTE: If #8 < 4.5 ft., Set Top of Tanks at (#7 - 4.5 ft.) = 4971.00			
If #8 > 7 ft., Contact Owner for Certification of Burial Depth with Tank			
		4971.00	

**Tank Installation Notes:**

- Contractor shall verify that a minimum of 1% slope is provided on all vapor recovery lines from the MPD to the tanks.

**Filter Fabric Notes:**

- The bottom and all four sides of tank hole are to be lined with Amoco CEF 4545 or equivalent filter fabric.
- All adjoining filter fabric panel seams are to be overlapped a minimum of 24"
- All filter fabric is to be properly anchored to prevent movement while backfilling tank hole.

4th Street N.W.

Gene Avenue N.W.

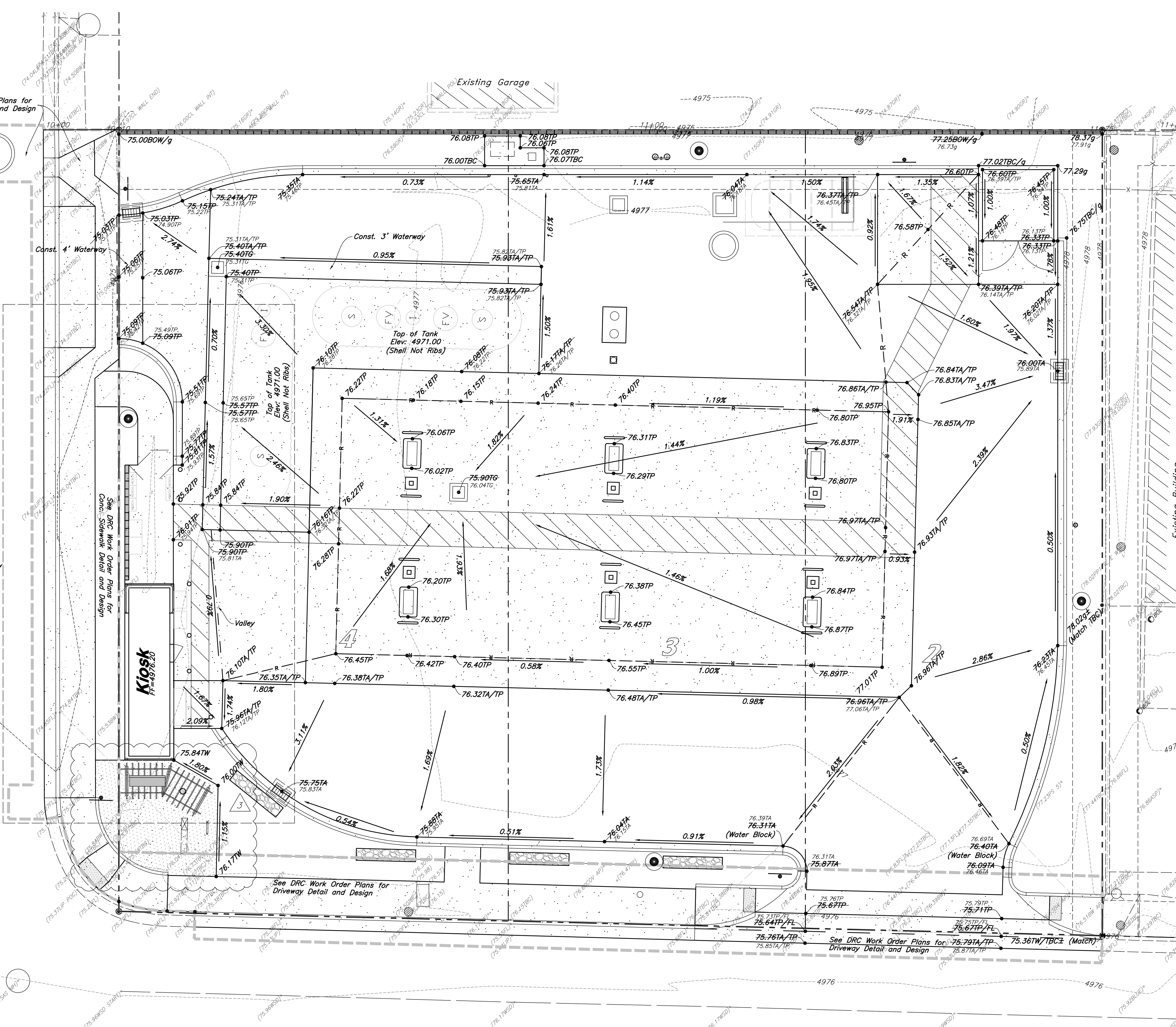

Anderson Wahlen & Associates logo and contact information.

Grading Plan title block.

Smith's #423 Fuel Center address and location.

Professional Engineer Seal for David G. Anderson, NMPE 20167.

Feb 02, 2016 date stamp.

C2.1 project identifier.





1. All grading shall be in accordance with the project geotechnical report.
2. Cut slopes shall be no steeper than 3 horizontal to 1 vertical.
3. Fill slopes shall be no steeper than 3 horizontal to 1 vertical.
4. Fills shall be compacted per the recommendations of the geotechnical report prepared for the project and shall be certified by the Owner's Special Inspection.
5. Areas to receive fill shall be properly prepared and approved by the Owner's Special Inspection prior to placing fill.
6. Fills shall be benched into competent material as per specifications and geotechnical report.
7. All trench backfill shall be tested and certified by the Owner's Special Inspection.
8. The Owner's Special Inspection shall perform periodic inspections and submit a complete report and map upon completion of the rough grading.
9. The final completion report and certification from the Owner's Special Inspection shall contain the type of field testing performed. Each test shall be identified with the method of obtaining the in-place density, whether sand cone or drive ring and shall be so noted for each test. Sufficient maximum density determinations shall be performed to verify the accuracy of the maximum density curves used by the field technician.
10. Dust shall be controlled by watering.
11. The location and protection of all utilities is the responsibility of the permittee.
12. Approved protective measures and temporary drainage provisions must be used to protect adjoining properties during the grading process.
13. All public roadways must be cleared daily of all dirt, mud and debris deposited on them as a result of the grading operation. Cleaning is to be done to the satisfaction of the City Engineer.
14. The site shall be cleared and grubbed of all vegetation and deleterious matter prior to grading.
15. The contractor shall provide shoring in accordance with OSHA requirements for trench walls.
16. Aggregate base shall be compacted per the geotechnical report prepared for the project.
17. The recommendations in the following Geotechnical Engineering Report by Kleinfelder are included in the requirements of grading and site Preparation. The Report is titled "Geological Engineering Report Proposed Smith's Book & Drug Fuel Center Retail Store #423 5640 4th Street NW Albuquerque, New Mexico

Project No.: 20152711.0014  
Dated: October 29, 2014

18. As part of the construction documents, owner has provided contractor with a topographic survey performed by manual or aerial means. Such survey shall be prepared for the project design purposes and is provided to the contractor as a courtesy. It is expressly understood that such survey may not accurately reflect existing topographic conditions.
19. If Contractor observes evidence of hazardous materials or contaminated soils he shall immediately contact the project engineer to provide notification and obtain direction before proceeding with disturbance of said materials or contaminated soil.
20. Contractor will be responsible to phase the construction development so that storm water management and storm water facilities including detention or retention improvement facilities are constructed and functional prior to an offsite storm water release and take necessary construction precautions so that no offsite flooding will occur.
21. Importing fill material from an off-site location without prior written approval from the Owner's Project Manager is strictly prohibited. Identification of offsite borrow locations and material must be coordinated and documented with the SWPPP. The Owner's Special Inspection shall verify the suitability of all off-site material. This includes an analysis to insure that no environmental contamination is introduced in any way. If the material is environmentally clean, if requested, the Owner's Project Manager, the Contractor will bear all costs associated with removing the material, testing for contamination, monitoring the clean-up operation, disposal in an approved landfill, and certify that the Owner's site is environmentally clean. If requested, the Owner's Project Manager or the Owner's Special Inspection must be granted unfettered access to any and all borrow sites.

1. *Open face gutter shall be constructed where drainage is directed away from curb.*
2. *Open face gutter locations are indicated by shading and notes on the grading plan.*
3. *It is the responsibility of the surveyor to adjust top of asphalt grades to top of curb grades at the time of construction staking.*
4. *Refer to the typical details for a standard and open face curb and gutter for dimensions.*
5. *Transitions from open face to standard curb and gutter are to be smooth. Hand form these areas if necessary.*

Date \_\_\_\_\_



Scale: 1" = 5'

**Accessible Note:**

*Contractor must maintain a running slope on Accessible routes no steeper than 5.0% (1:20). The cross slope for Accessible routes must be no steeper than 2.0% (1:50). All Accessible routes must have a minimum clear width of 36". If Grades on plans do not meet this requirement notify Consultant immediately.*

*The Client, Contractor and Subcontractor should immediately notify the Consultant of any conditions of the project that they believe do not comply with the current state of the (ICC/ANSI A117.1—Latest Edition) and/or FHAA.*

SHEET NO.

## C2.2



# City of Albuquerque

Planning Department

Development & Building Services Division

## DRAINAGE AND TRANSPORTATION INFORMATION SHEET (REV 1/2016)

Project Title: SMITH'S #423 FUEL CENTER Building Permit #: \_\_\_\_\_ Hydrology File #: F14-D072  
DRB#: \_\_\_\_\_ EPC#: \_\_\_\_\_ Work Order#: 587880  
Legal Description: LOTS 2, 3 & 4 HARPER ADDITION  
City Address: 5640 4th St. NW

Applicant: SMITH'S FOOD & DRUG CENTERS, INC. Contact: KIRK RANDALL  
Address: 2010 No. REDWOOD ROAD, SLC. UT 84116  
Phone#: 801-410-8520 Fax#: 801-521-9551 E-mail: KIRK@ANAENG.COM

Other Contact: \_\_\_\_\_ Contact: \_\_\_\_\_  
Address: \_\_\_\_\_  
Phone#: \_\_\_\_\_ Fax#: \_\_\_\_\_ E-mail: \_\_\_\_\_

Check all that Apply:

### DEPARTMENT:

- ☒ HYDROLOGY/ DRAINAGE  
☐ TRAFFIC/ TRANSPORTATION  
☐ MS4/ EROSION & SEDIMENT CONTROL

### TYPE OF SUBMITTAL:

- ☒ AS-BUILT CERTIFICATION  
  
☐ CONCEPTUAL G & D PLAN  
☐ GRADING PLAN  
☐ DRAINAGE MASTER PLAN  
☐ DRAINAGE REPORT  
☐ CLOMR/LOMR  
  
☐ TRAFFIC CIRCULATION LAYOUT (TCL)  
☐ TRAFFIC IMPACT STUDY (TIS)  
☐ NEIGHBORHOOD IMPACT ASSESMENT (NIA)  
  
☐ EROSION & SEDIMENT CONTROL PLAN (ESC)  
☐ OTHER (SPECIFY) \_\_\_\_\_

### TYPE OF APPROVAL/ACCEPTANCE SOUGHT:

- ☐ BUILDING PERMIT APPROVAL  
☒ CERTIFICATE OF OCCUPANCY  
☐ GRADING/ESC PERMIT APPROVAL  
  
☐ PRELIMINARY PLAT APPROVAL  
☐ SITE PLAN FOR SUB'D APPROVAL  
☐ SITE PLAN FOR BLDG. PERMIT APPROVAL  
☐ FINAL PLAT APPROVAL  
  
☐ SIA/ RELEASE OF FINANCIAL GUARANTEE  
☐ FOUNDATION PERMIT APPROVAL  
☐ SO-19 APPROVAL  
☐ PAVING PERMIT APPROVAL  
☐ GRADING/ PAD CERTIFICATION  
☐ WORK ORDER APPROVAL  
☐ CLOMR/LOMR  
  
☐ PRE-DESIGN MEETING?  
  
☐ OTHER (SPECIFY) \_\_\_\_\_

IS THIS A RESUBMITTAL?: ☐ Yes ☒ No

DATE SUBMITTED: 8-30-16 By: KIRK RANDALL

COA STAFF: ELECTRONIC SUBMITTAL RECEIVED: \_\_\_\_\_

FEE RECEIVED: \_\_\_\_\_