



City of Albuquerque

Planning Department

Development & Building Services Division

DRAINAGE AND TRANSPORTATION INFORMATION SHEET

(REV 02/2013)

Project Title: _____ Building Permit #: _____ City Drainage #: _____

DRB#: _____ EPC#: _____ Work Order#: _____

Legal Description: _____

City Address: _____

Engineering Firm: _____ Contact: _____

Address: _____

Phone#: _____ Fax#: _____ E-mail: _____

Owner: _____ Contact: _____

Address: _____

Phone#: _____ Fax#: _____ E-mail: _____

Architect: _____ Contact: _____

Address: _____

Phone#: _____ Fax#: _____ E-mail: _____

Surveyor: _____ Contact: _____

Address: _____

Phone#: _____ Fax#: _____ E-mail: _____

Contractor: _____ Contact: _____

Address: _____

Phone#: _____ Fax#: _____ E-mail: _____

TYPE OF SUBMITTAL:

- _____ DRAINAGE REPORT
- _____ DRAINAGE PLAN 1st SUBMITTAL
- _____ DRAINAGE PLAN RESUBMITTAL
- _____ CONCEPTUAL G & D PLAN
- _____ GRADING PLAN
- _____ EROSION & SEDIMENT CONTROL PLAN (ESC)
- _____ ENGINEER'S CERT (HYDROLOGY)
- _____ CLOMR/LOMR
- _____ TRAFFIC CIRCULATION LAYOUT (TCL)
- _____ ENGINEER'S CERT (TCL)
- _____ ENGINEER'S CERT (DRB SITE PLAN)
- _____ ENGINEER'S CERT (ESC)
- _____ SO-19
- _____ OTHER (SPECIFY)

CHECK TYPE OF APPROVAL/ACCEPTANCE SOUGHT:

- _____ SIA/FINANCIAL GUARANTEE RELEASE
- _____ PRELIMINARY PLAT APPROVAL
- _____ S. DEV. PLAN FOR SUB'D APPROVAL
- _____ S. DEV. FOR BLDG. PERMIT APPROVAL
- _____ SECTOR PLAN APPROVAL
- _____ FINAL PLAT APPROVAL
- _____ CERTIFICATE OF OCCUPANCY (PERM)
- _____ CERTIFICATE OF OCCUPANCY (TCL TEMP)
- _____ FOUNDATION PERMIT APPROVAL
- _____ BUILDING PERMIT APPROVAL
- _____ GRADING PERMIT APPROVAL
- _____ PAVING PERMIT APPROVAL
- _____ WORK ORDER APPROVAL
- _____ GRADING CERTIFICATION
- _____ SO-19 APPROVAL
- _____ ESC PERMIT APPROVAL
- _____ ESC CERT. ACCEPTANCE
- _____ OTHER (SPECIFY)

WAS A PRE-DESIGN CONFERENCE ATTENDED: _____ Yes _____ No _____ Copy Provided

DATE SUBMITTED: _____ By: _____

Requests for approvals of Site Development Plans and/or Subdivision Plats shall be accompanied by a drainage submittal. The particular nature, location, and scope to the proposed development defines the degree of drainage detail. One or more of the following levels of submittal may be required based on the following:

1. **Conceptual Grading and Drainage Plan:** Required for approval of Site Development Plans greater than five (5) acres and Sector Plans
2. **Drainage Plans:** Required for building permits, grading permits, paving permits and site plans less than five (5) acres
3. **Drainage Report:** Required for subdivision containing more than ten (10) lots or constituting five (5) acres or more
4. **Erosion and Sediment Control Plan:** Required for any new development and redevelopment site with 1-acre or more of land disturbing area, including project less than 1-acre than are part of a larger common plan of development

March 18, 2015

Racquel Michel
City of Albuquerque
Transportation Development Coordination
600 2nd Street NW
Albuquerque, NM 87102

**Re: Montano Transit Center
TCL for Final C.O.**

Dear Ms. Michel:

I, Sara Lavy, of the firm Parametrix, hereby certify that the referenced portion of this project is in substantial compliance and in accordance with the design intent of the approved Traffic Circulation Layout dated 5-29-13. Parametrix personnel visited the project site on November 11, 2014, and verified the construction for the site. This certification is submitted in support of a request for a Final Certificate of Occupancy for the entire site. All hardscape including asphalt paving, concrete curbs, concrete sidewalks, ramps, etc. are complete throughout the site.

The record information presented herein is not complete and is intended only to verify substantial compliance of the traffic aspects for this project as they relate to the above mentioned site. Those relying on the record document are advised to obtain independent verifications of its accuracy before using it for any other purpose. If you have any questions, please feel free to contact myself or Jerry Parker at (505) 821-4700.

Sincerely,

Sara Lavy, PE

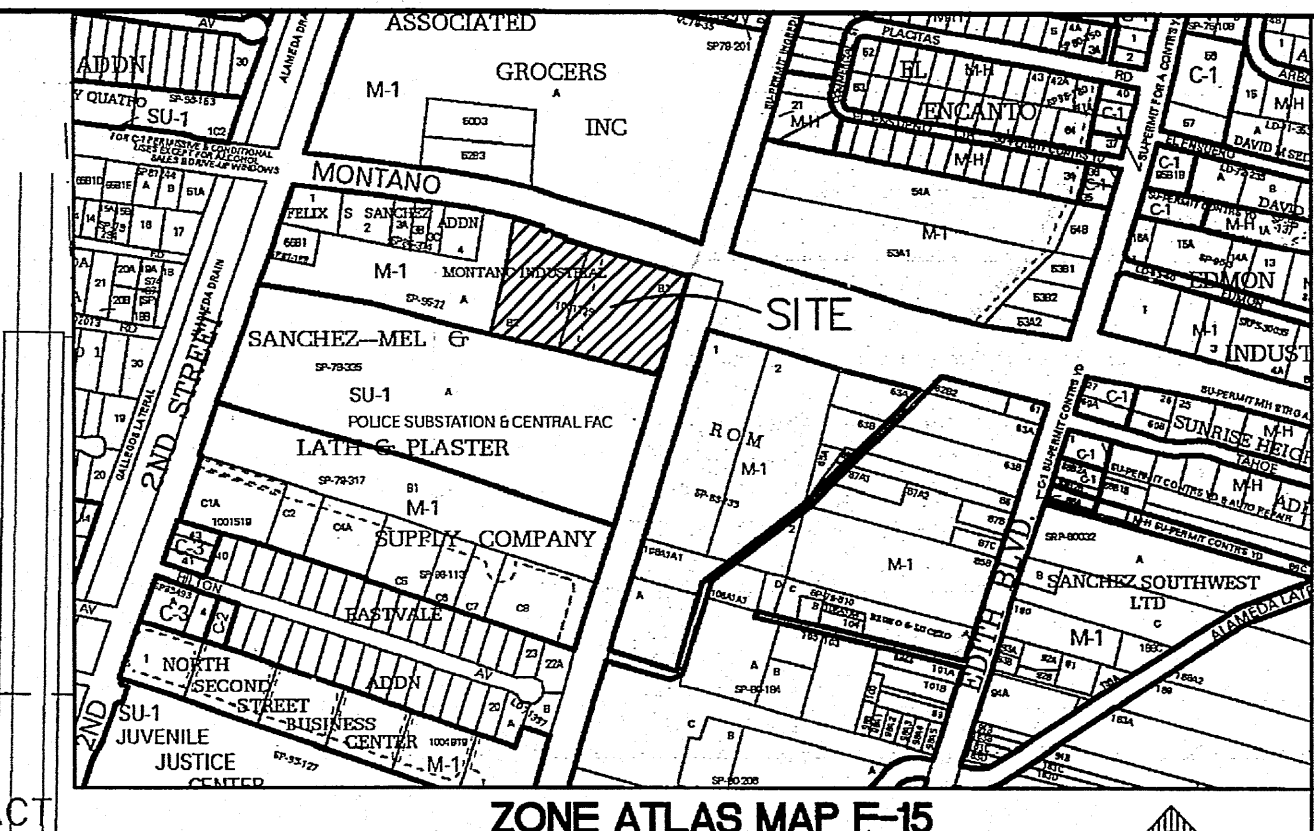
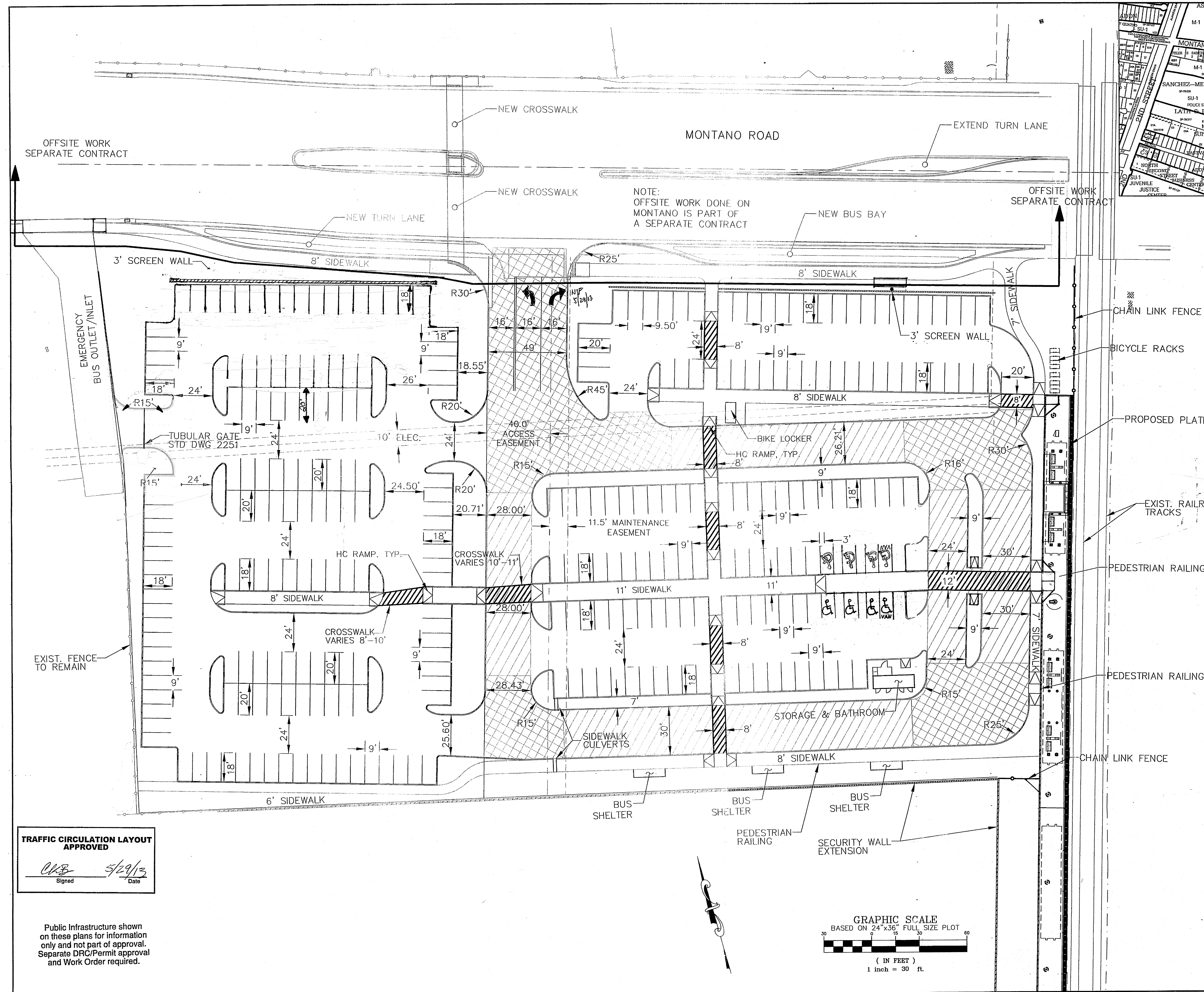

LEGAL DESCRIPTION:
TRACTS B1 & B2
MONTANO INDUSTRIAL
SUBDIVISION

- NOTES:**
1. LANDSCAPING AND SIGNING WILL NOT INTERFERE WITH CLEAR SITE REQUIREMENTS. THEREFORE, SIGNS, WALLS, TREES, AND SHRUBBERY BETWEEN 3 AND 8 FEET TALL (AS MEASURED FROM THE GUTTER PAN) WILL NOT BE ACCEPTABLE IN THIS AREA.
 2. SEE ALSO SHEETS C-009, C-010, C-013, C-014, C-015, C-016.
 3. ALL ON-SITE CURB SHALL BE 6" HEADER CURB. SEE DETAIL ON SHEET C-009.
 4. ALL APPLICABLE COA STANDARDS SHALL BE FOLLOWED.

SITE AREA=4.91 ACRES
PARKING SPACES REQ'D=1/200 PER STATION CANOPY AREA=2084/200
=11 SPACES
TOTAL PARKING SPACES=291
HANDICAP SPACES=8
VAN SPACES=2

- PVMNT. SECTION 3
SEE SHT. C-009
- PVMNT. SECTION 2
SEE SHT. C-009
- PVMNT. SECTION 1
SEE SHT. C-009

**TRAFFIC CIRCULATION LAYOUT
APPROVED**

CKB 5/29/13
Signed Date

Public Infrastructure shown on these plans for information only and not part of approval. Separate DRC/Permit approval and Work Order required.

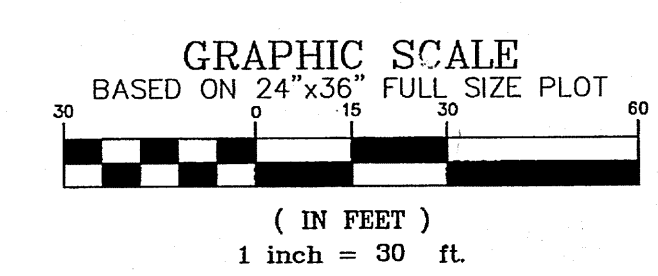

TITLE: **NEW MEXICO RAIL RUNNER EXPRESS
MONTANO STATION
TRAFFIC CIRCULATION LAYOUT**

Vector Engineering, LLC

Sheet No. **C-003**

DESIGNED BY	SL	DATE	05/2013
DRAWN BY	BN	DATE	05/2013
CHECKED BY	CB	DATE	05/2013

ALL WHEELCHAIR RAMPS LOCATED WITHIN THE PUBLIC RIGHT OF WAY MUST HAVE TRUNCATED DOMES.