

# CITY OF ALBUQUERQUE



*Planning Department*  
Suzanne Lubar, Director

*Mayor Richard J. Berry*

June 1, 2017

David Soule, PE  
Rio Grande Engineering  
1606 Central SE Suite 201  
Albuquerque, NM 87106

RE: **SECU**  
**3521 Montgomery Blvd. NE**  
**Requested for 30 Day Temporary C. O. - Accepted**  
**Engineers Stamp Date 10/19/16 (F16D001)**  
**Certification dated: 6-1-17**

PO Box 1293

Dear Mr. Soule,

Albuquerque

Based on the certification provided in your submittal received 5/24/2017, the above referenced is approved for a 30-day Temporary Release of Occupancy by Hydrology. However, before a permanent CO can be accepted the following comments must be addressed.

New Mexico 87103

- The Drainage Covenant must be reviewed and approved.

An inspection by our office will need to take place after these corrections are made.

[www.cabq.gov](http://www.cabq.gov)

If you have any questions, you can contact me at 924-3986 or Totten Elliott at 924-3982.

Sincerely,

James D. Hughes, P.E.  
Principal Engineer, Planning Dept.  
Development and Review Services

TE/JH

C: email, Serna, Yvette M.; Fox, Debi; Tena, Victoria C.; Sandoval, Darlene M.



I David Soule, NMPE 14522, of the firm Rio Grande Engineering, hereby certify that this project has been graded and will drain in substantial compliance with and in accordance with the design intend of the approved plan dated 11/8/16 The record information edited on the original design document has performed by me or under my direct supervision and is true and correct to the best of my knowledge and belief. The as-built survey was provided DEAN SHRADER #12451. The certification is submitted in support of a request for PERMANENT CERTIFICATE OF OCCUPANCY. The record information presented heron is not necessarily complete and intended only to verify substantial compliance of the grading and drainage aspects of this project. Those relying on this record document are advised to obtain independent verification of its accuracy before using it for any other purpose.



5/23/17

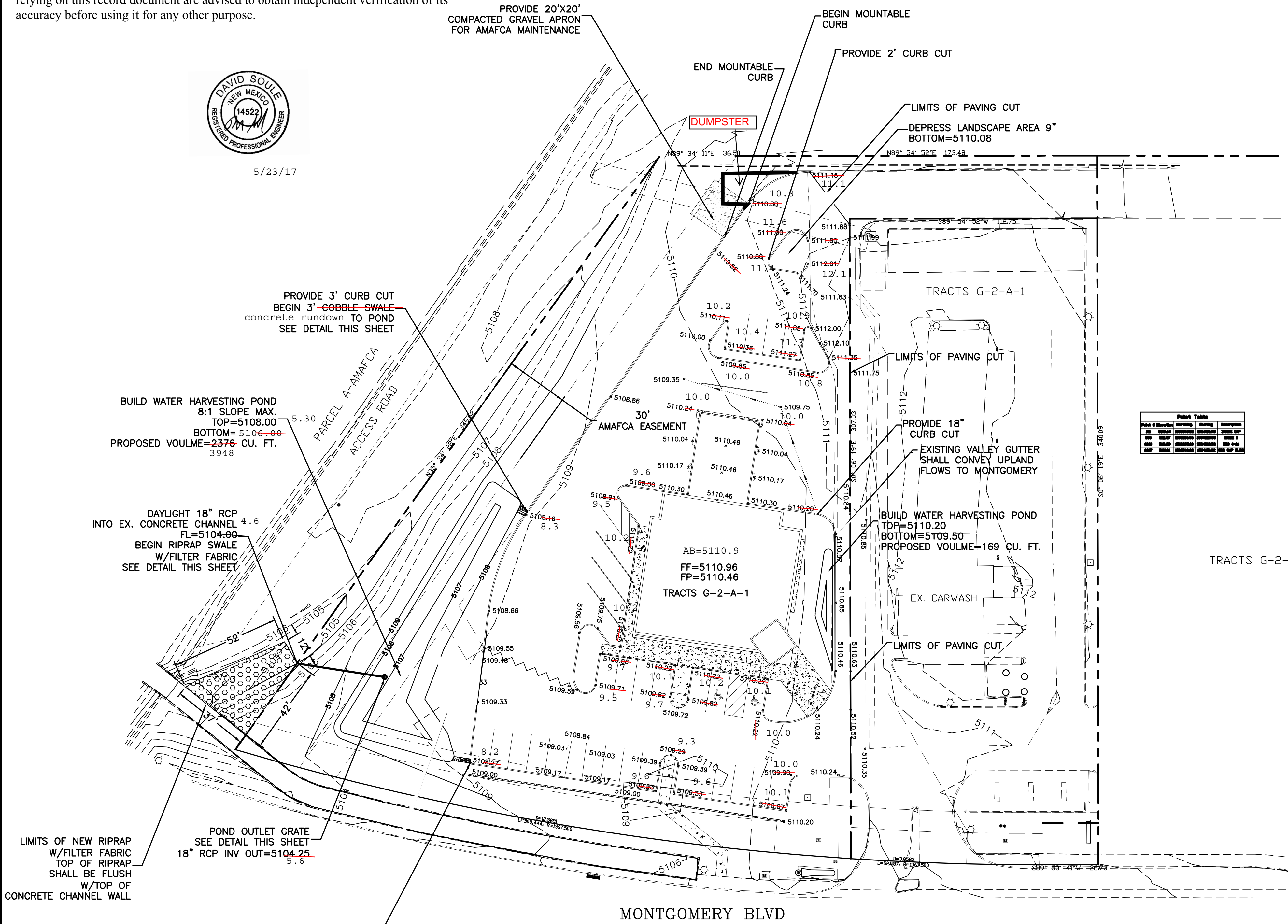

LIMITS OF NEW RIPRAP W/FILTER FABRIC TOP OF RIPRAP SHALL BE FLUSH W/TOP OF CONCRETE CHANNEL WALL

POND OUTLET GRATE SEE DETAIL THIS SHEET 18" RCP INV OUT=5104.25 5.6

PROVIDE 2' CURB CUT BEGIN 2' COBBLE SWALE TO POND SEE DETAIL THIS SHEET concrete rundown

**CAUTION:**  
EXISTING UTILITIES ARE NOT SHOWN. IT SHALL BE THE SOLE RESPONSIBILITY OF THE CONTRACTOR TO CONDUCT ALL NECESSARY FIELD INVESTIGATIONS PRIOR TO ANY EXCAVATION TO DETERMINE THE ACTUAL LOCATION OF UTILITIES & OTHER IMPROVEMENTS.

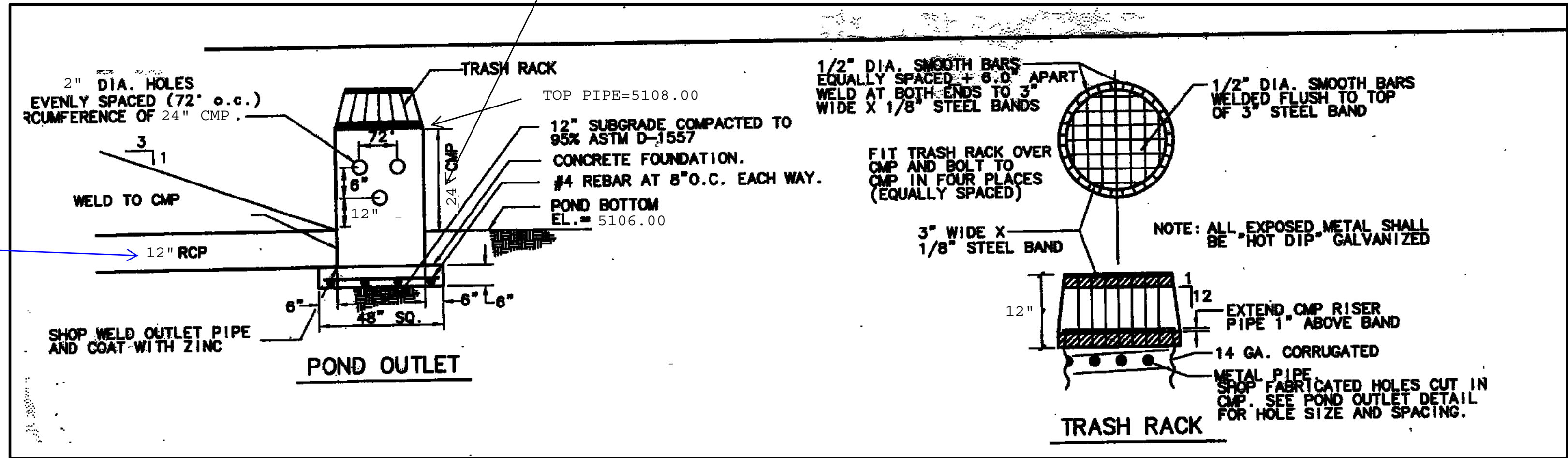

### EROSION CONTROL NOTES:

1. CONTRACTOR IS RESPONSIBLE FOR OBTAINING A TOPSOIL DISTURBANCE PERMIT PRIOR TO BEGINNING WORK.
2. CONTRACTOR IS RESPONSIBLE FOR MAINTAINING RUN-OFF ON SITE DURING CONSTRUCTION.
3. CONTRACTOR IS RESPONSIBLE FOR CLEANING ALL SEDIMENT THAT GETS INTO EXISTING RIGHT-OF-WAY.
4. REPAIR OF DAMAGED FACILITIES AND CLEANUP OF SEDIMENT ACCUMULATIONS ON ADJACENT PROPERTIES AND IN PUBLIC FACILITIES IS THE RESPONSIBILITY OF THE CONTRACTOR.
5. ALL EXPOSED EARTH SURFACES MUST BE PROTECTED FROM WIND AND WATER EROSION PRIOR TO FINAL ACCEPTANCE OF ANY PROJECT.

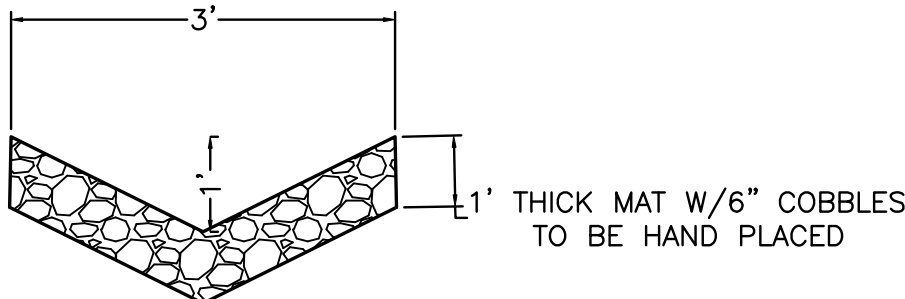

COBBLE SWALE DETAIL

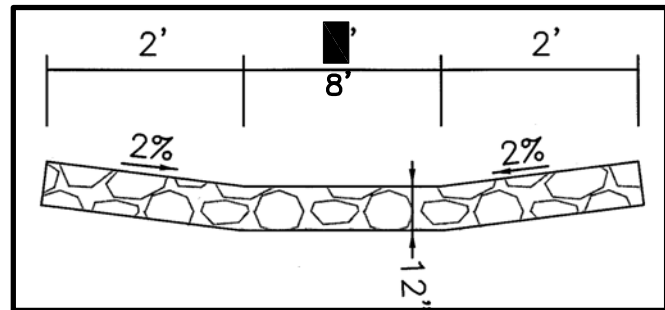

RIPRAP SWALE DETAIL D50=4\"/>

### AMAFC A GENERAL NOTES

1. AMAFC A'S PROJECT MANAGER SHALL BE NOTIFIED 48 HOURS PRIOR TO START OF ANY WORK AND PRIOR TO FINAL INSPECTION OF THE WORK WITHIN THE AMAFC A RIGHT-OF-WAY OR EASEMENT. TELEPHONE NUMBER IS 884-2215.
2. NO WORK WILL BE PERFORMED IN THE AMAFC A RIGHT-OF-WAY OR EASEMENT BETWEEN MAY 15 AND OCTOBER 15 WITHOUT WRITTEN PERMISSION FROM AMAFC A.
3. ALL SUBGRADE, BACKFILL AND EMBANKMENT SHALL BE COMPACTED TO 95% (MODIFIED PROCTOR) WITHIN THE AMAFC A RIGHT-OF-WAY OR EASEMENT. TESTING REPORTS SHALL BE PROVIDED TO AMAFC A.
4. CERTIFIED AS-BUILT PLANS MUST BE SUBMITTED TO AMAFC A FOR THE CONSTRUCTION WITHIN THE AMAFC A RIGHT-OF-WAY OR EASEMENT.
5. CONTRACTOR SHALL PROVIDE A CERTIFICATE OF LIABILITY INSURANCE IN THE AMOUNT OF \$2,000,000.00, NAMING AMAFC A AS ADDITIONAL INSURED, PRIOR TO STARTING WORK.
6. ALL DISTURBED GROUND AREAS SHALL BE REVEGETATED IN ACCORDANCE WITH CITY OF ALBUQUERQUE STANDARD SPECIFICATIONS FOR PUBLIC WORKS CONSTRUCTION, SECTION 1012 NATIVE GRASS SEEDING, AS CURRENTLY UPDATED.
7. ANY EXISTING SURVEY CONTROL MONUMENTS THAT ARE MOVED OR DESTROYED AS A RESULT OF THE CONSTRUCTION SHALL BE REPLACED BY A LICENSED SURVEYOR AT THE OWNER'S EXPENSE.

APPROVED FOR CONSTRUCTION WITHIN AMAFC A RIGHT-OF-WAY / EASEMENT:

(FOR AMAFC A)

DATE

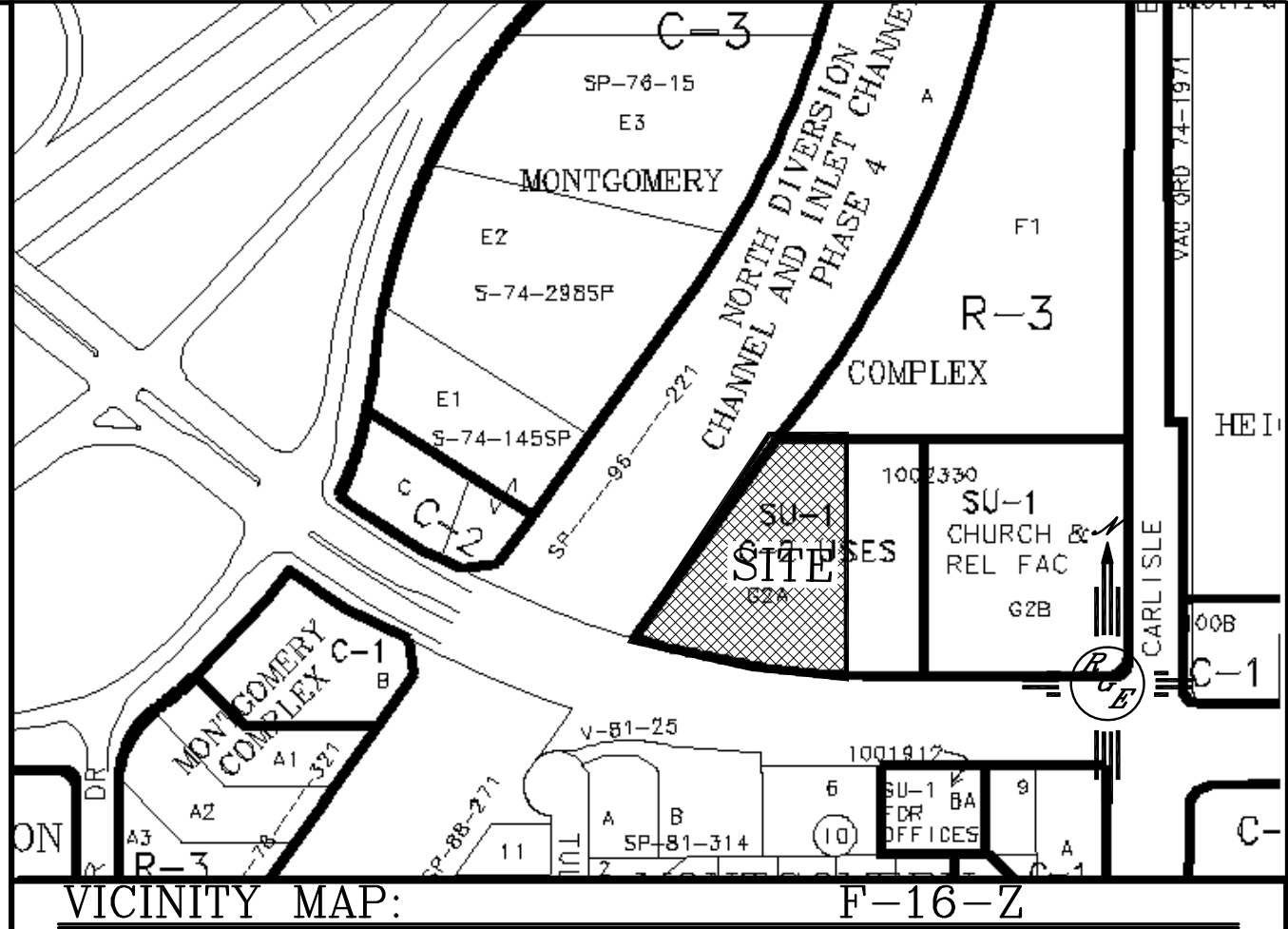

LEGAL DESCRIPTION:  
TR. G-2-A-1, MONTGOMERY COMPLEX

NOTES:  
1. ALL SPOT ELEVATIONS REPRESENT FLOWLINE ELEVATION UNLESS OTHERWISE NOTED.

### LEGEND

- 5414 --- EXISTING CONTOUR
- 5415 --- EXISTING INDEX CONTOUR
- 5414 --- PROPOSED CONTOUR
- 5415 --- PROPOSED INDEX CONTOUR
- 3:1 SLOPE TIE MAX.
- 1 x 4048.25 EXISTING SPOT ELEVATION
- 1 x 4048.25 PROPOSED SPOT ELEVATION
- BOUNDARY
- PROPOSED LOT LINE
- RIGHT-OF-WAY
- PROPOSED CURB AND GUTTER
- EXISTING CURB
- PROPOSED SCREEN WALL
- PROPOSED RETAINING WALL DESIGN BY OTHERS

ENGINEER'S SEAL	STATE EMPLOYEE FEDERAL CREDIT UNION	DRAWN BY WCWJ
DAVID SOULE NEW MEXICO 14522 PROFESSIONAL ENGINEER	GRADING AND DRAINAGE PLAN	DATE 11-08-16
	 1606 CENTRAL AVENUE SE SUITE 201 ALBUQUERQUE, NM 87106 (505) 872-0999	21628-LAYOUT-6-28-16
DAVID SOULE P.E. #14522		SHEET # 4
		JOB # 21628





# City of Albuquerque

Planning Department

Development & Building Services Division

## DRAINAGE AND TRANSPORTATION INFORMATION SHEET (REV 09/2015)

**Project Title:** \_\_\_\_\_ **Building Permit #:** \_\_\_\_\_ **City Drainage #:** \_\_\_\_\_

**DRB#:** \_\_\_\_\_ **EPC#:** \_\_\_\_\_ **Work Order#:** \_\_\_\_\_

**Legal Description:** \_\_\_\_\_

**City Address:** \_\_\_\_\_

**Engineering Firm:** \_\_\_\_\_ **Contact:** \_\_\_\_\_

**Address:** \_\_\_\_\_

**Phone#:** \_\_\_\_\_ **Fax#:** \_\_\_\_\_ **E-mail:** \_\_\_\_\_

**Owner:** \_\_\_\_\_ **Contact:** \_\_\_\_\_

**Address:** \_\_\_\_\_

**Phone#:** \_\_\_\_\_ **Fax#:** \_\_\_\_\_ **E-mail:** \_\_\_\_\_

**Architect:** \_\_\_\_\_ **Contact:** \_\_\_\_\_

**Address:** \_\_\_\_\_

**Phone#:** \_\_\_\_\_ **Fax#:** \_\_\_\_\_ **E-mail:** \_\_\_\_\_

**Other Contact:** \_\_\_\_\_ **Contact:** \_\_\_\_\_

**Address:** \_\_\_\_\_

**Phone#:** \_\_\_\_\_ **Fax#:** \_\_\_\_\_ **E-mail:** \_\_\_\_\_

Check all that Apply:

**DEPARTMENT:**

- ☐ HYDROLOGY/ DRAINAGE  
☐ TRAFFIC/ TRANSPORTATION  
☐ MS4/ EROSION & SEDIMENT CONTROL

**TYPE OF SUBMITTAL:**

- ☐ ENGINEER/ ARCHITECT CERTIFICATION
- ☐ CONCEPTUAL G & D PLAN  
☐ GRADING PLAN  
☐ DRAINAGE MASTER PLAN  
☐ DRAINAGE REPORT  
☐ CLOMR/LOMR
- ☐ TRAFFIC CIRCULATION LAYOUT (TCL)  
☐ TRAFFIC IMPACT STUDY (TIS)  
☐ EROSION & SEDIMENT CONTROL PLAN (ESC)
- ☐ OTHER (SPECIFY) \_\_\_\_\_

**CHECK TYPE OF APPROVAL/ACCEPTANCE SOUGHT:**

- ☐ BUILDING PERMIT APPROVAL  
☐ CERTIFICATE OF OCCUPANCY
- ☐ PRELIMINARY PLAT APPROVAL  
☐ SITE PLAN FOR SUB'D APPROVAL  
☐ SITE PLAN FOR BLDG. PERMIT APPROVAL  
☐ FINAL PLAT APPROVAL  
☐ SIA/ RELEASE OF FINANCIAL GUARANTEE  
☐ FOUNDATION PERMIT APPROVAL  
☐ GRADING PERMIT APPROVAL  
☐ SO-19 APPROVAL  
☐ PAVING PERMIT APPROVAL  
☐ GRADING/ PAD CERTIFICATION  
☐ WORK ORDER APPROVAL  
☐ CLOMR/LOMR
- ☐ PRE-DESIGN MEETING  
☐ OTHER (SPECIFY) \_\_\_\_\_

IS THIS A RESUBMITTAL?: ☐ Yes ☐ No

DATE SUBMITTED: \_\_\_\_\_ By: DAVID SOULE

COA STAFF: \_\_\_\_\_ ELECTRONIC SUBMITTAL RECEIVED: \_\_\_\_\_