

August 3, 1998

Kim Kemper
Kemper-Vaughan Engineering
3700 Coors Rd. NW
Albuquerque, New Mexico 87120

RE: REVISED DRAINAGE PLAN FOR NAPA AUTO PARTS (F17-D17) REVISION DATED
7/14/98

Dear Mr. Kemper:

Based on the information provided on your July 15, 1998 resubmittal, the above referenced site is approved for Building Permit.

Please attach a copy of this approved plan to the construction sets prior to sign-off by Hydrology.

Also, prior to Certificate of Occupancy release, the following must be submitted:

1. Engineer Certification per the DPM checklist.
2. Concurrence from Glenn Jurgenson for the drop inlet modifications.

If I can be of further assistance, please feel free to contact me at 924-3986.

C: Andrew Garcia ✓

File

Sincerely

Bernie J. Montoya CE
Associate Engineer

Good for You, Albuquerque!



DRAINAGE INFORMATION SHEET

PROJECT TITLE: NAPA AUTO PARTS ZONE ATLAS/DRNG. FILE #: F-17 D 17

DRB #: _____ EPC #: _____ WORK ORDER #: _____

LEGAL DESCRIPTION: TRACT A LANDS OF NAVAJO FREIGHT.

CITY ADDRESS: SAN MATEO

ENGINEERING FIRM: KEMPER-VAUGHAN CONSULTING ^{ENGRS.} CONTACT: KIM R. KEMPER

ADDRESS: 3700 COORS RD NW PHONE: 831-4520

OWNER: BILL ROBERTS CONTACT: BILL ROBERTS

ADDRESS: 408 ARIZONA SE 87108 PHONE: 262-1107

ARCHITECT: DURA BILT PRODUCTS. CONTACT: BRAD LITTLE

ADDRESS: 4808 JEFFERSON PHONE: 883-9100

SURVEYOR: RIO GRANDE SURVEYING CONTACT: REX VOGLER

ADDRESS: 3700 COORS RD. PHONE: 831-4511

CONTRACTOR: DURA BILT PRODUCTS. CONTACT: BRAD LITTLE

ADDRESS: 4808 JEFFERSON PHONE: 883-9100

TYPE OF SUBMITTAL:

- ☐ DRAINAGE REPORT
- ☒ DRAINAGE PLAN
- ☐ CONCEPTUAL GRADING & DRAINAGE PLAN
- ☒ GRADING PLAN
- ☐ EROSION CONTROL PLAN
- ☐ ENGINEER'S CERTIFICATION
- ☐ OTHER _____

PRE-DESIGN MEETING:

- ☐ YES
- ☒ NO
- ☐ COPY PROVIDED

CHECK TYPE OF APPROVAL SOUGHT:

- ☐ SKETCH PLAT APPROVAL
- ☐ PRELIMINARY PLAT APPROVAL
- ☐ S. DEV. PLAN FOR SUB'D. APPROVAL
- ☐ S. DEV. PLAN FOR BLDG. PERMIT APPROVAL
- ☐ SECTOR PLAN APPROVAL
- ☐ FINAL PLAT APPROVAL
- ☐ FOUNDATION PERMIT APPROVAL
- ☒ BUILDING PERMIT APPROVAL
- ☐ CERTIFICATE OF OCCUPANCY APPROVAL
- ☐ GRADING PERMIT APPROVAL
- ☐ PAVING PERMIT APPROVAL
- ☐ S.A.D. DRAINAGE REPORT
- ☐ DRAINAGE REQUIREMENTS
- ☐ OTHER _____ (SPECIFY)

DATE SUBMITTED: 7/15/98

BY: [Signature]

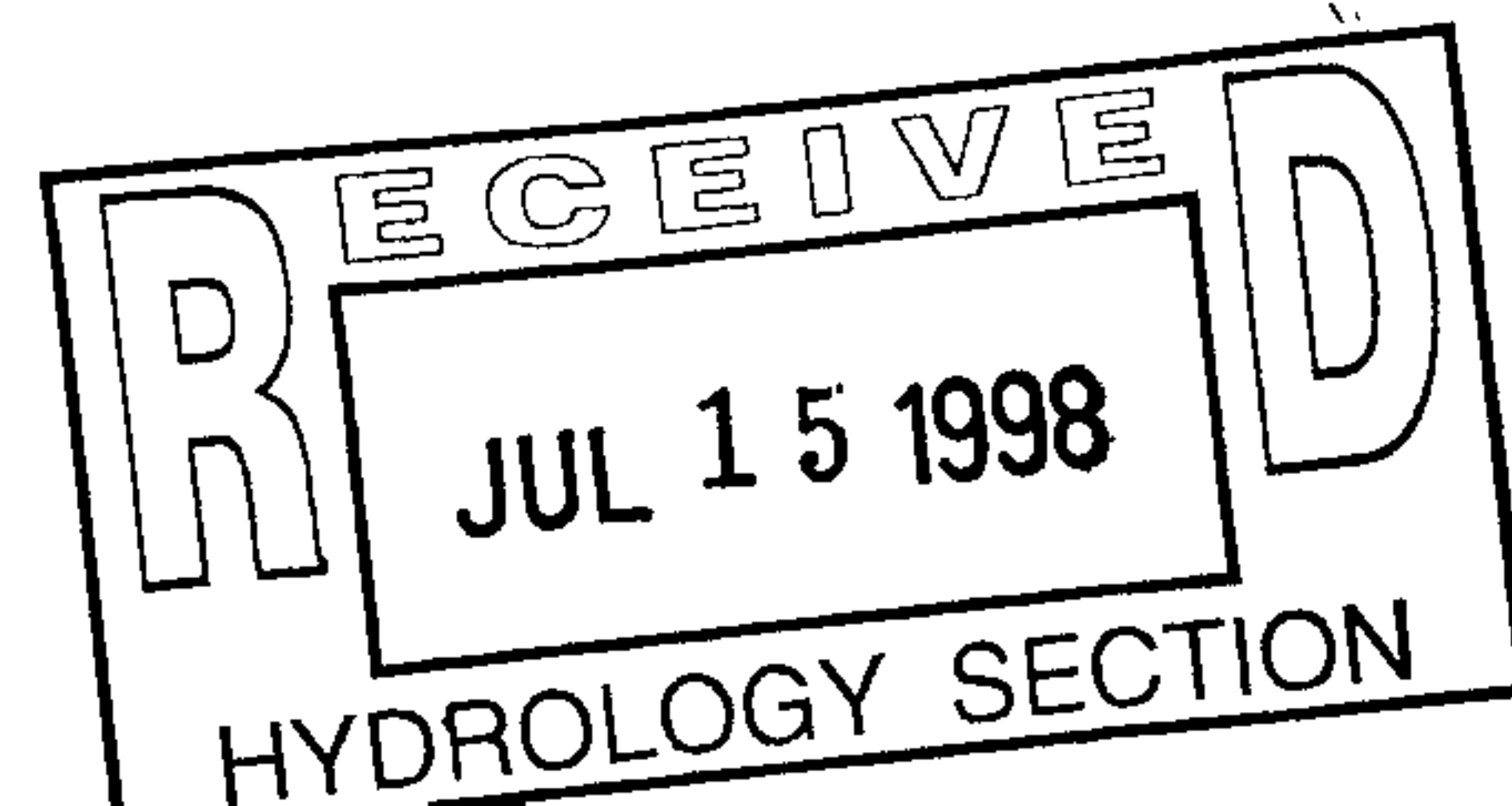

11-7

ATLANTA OIL & GAS

7 MONTHS DIAGNOSIS TO EQUINOX 1971
OILMAN WAS

SEARCHED FOR OIL

OSCAR 1970

SEARCHED FOR OIL

IN THE SAME AREA

1971

1972

SEARCHED FOR OIL

1973

SEARCHED FOR OIL

1974

SEARCHED FOR OIL

1975

SEARCHED FOR OIL

1976

SEARCHED FOR OIL

1977

SEARCHED FOR OIL

1978

OIL
CHANGE
Exist vs
Prop?

SEARCHED FOR OIL
1979

CITY OF ALBUQUERQUE

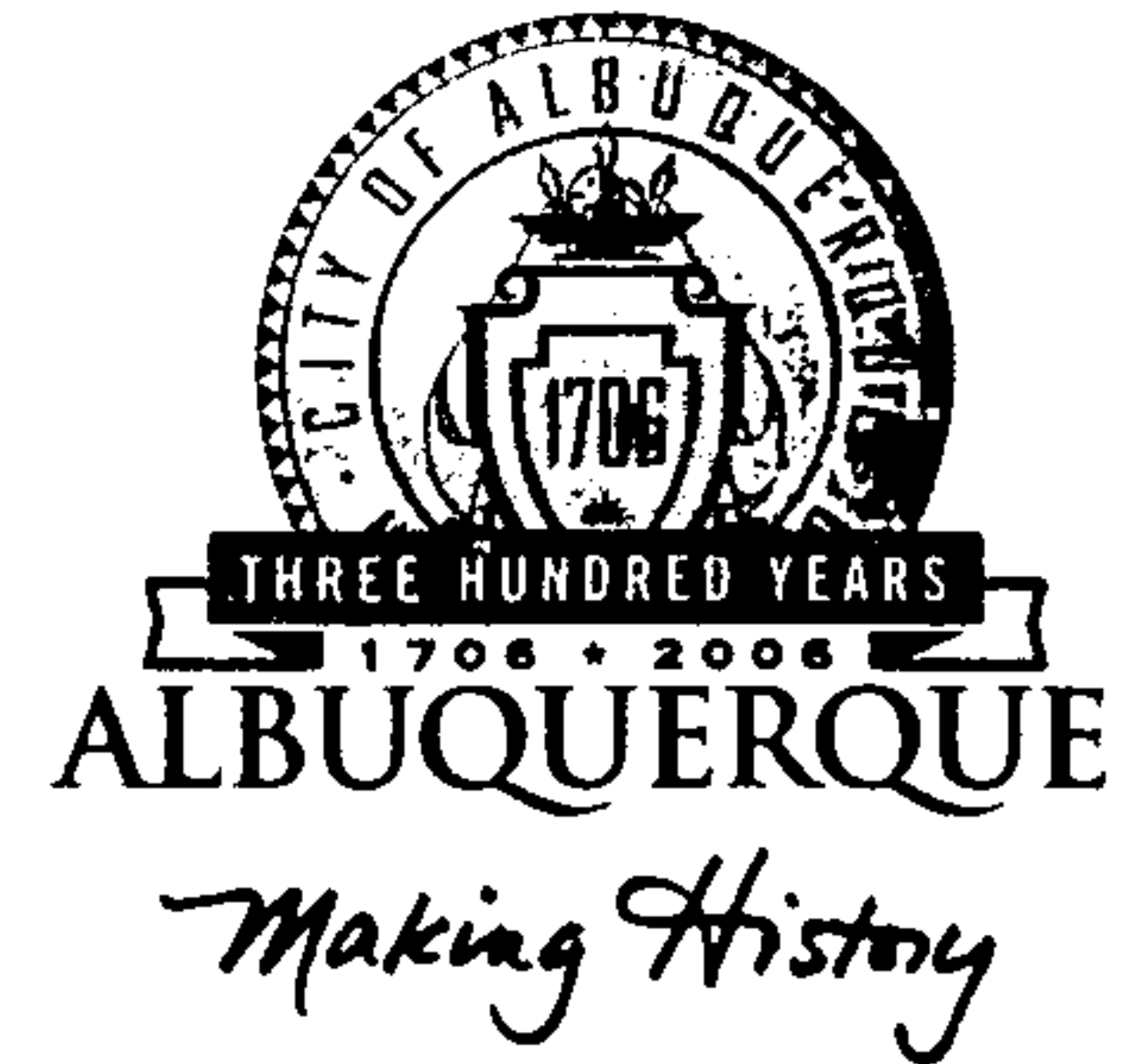

April 29, 2005

Berent Groth, R.A.
3546 Sequoia Place NW
Albuquerque, NM 87120

Re: NAPA Auto Parts, 4700 Lincoln NE, Traffic Circulation Layout
Architect's Stamp dated 4-26-05 (F17-D17)

Dear Mr. Groth,

The TCL submittal received 4-27-05 is approved for Building Permit. The plan is stamped and signed as approved. A copy of this plan will be needed for each of the building permit plans. Please keep the original to be used for certification of the site for final C.O. for Transportation.

If a temporary CO is needed, a copy of the original TCL that was stamped as approved by the City will be needed. This plan must include a statement that identifies the outstanding items that need to be constructed or the items that have not been built in "substantial compliance," as well as the signed and dated stamp of a NM registered architect or engineer. Submit this TCL with a completed Drainage and Transportation Information Sheet to Hydrology at the Development Services Center of Plaza Del Sol Building.

When the site is completed and a final C.O. is requested, use the original City stamped approved TCL for certification. A NM registered architect or engineer must stamp, sign, and date the certification TCL along with indicating that the development was built in "substantial compliance" with the TCL. Submit this certification TCL with a completed Drainage and Transportation Information Sheet to Hydrology at the Development Services Center of Plaza Del Sol Building.

Once verification of certification is completed and approved, notification will be made to Building Safety to issue Final C.O. To confirm that a final C.O. has been issued, call Building Safety at 924-3306.

Sincerely,

Kristal D. Metro
Engineering Associate, Planning Dept.
Development and Building Services

cc: file

P.O. Box 1293

Albuquerque

New Mexico 87103

www.cabq.gov

DRAINAGE AND TRANSPORTATION INFORMATION SHEET

(REV. 1/28/2003rd)

PROJECT TITLE: Napa Auto Parts Parking Change
4700 LINCOLN NE ZONE MAP/DRG. FILE #: F-17/D17
 DRB #: _____ EPOCH: _____ WORK ORDER#: _____

LEGAL DESCRIPTION: TRACT "F"
 CITY ADDRESS: 4700 LINCOLN NE

ENGINEERING FIRM: _____
 ADDRESS: _____
 CITY, STATE: _____

CONTACT: _____
 PHONE: _____
 ZIP CODE: _____

OWNER: CHANT ASSOCIATES
 ADDRESS: PO BOX 2523
 CITY, STATE: ALB. NM

CONTACT: GREG CHANT
 PHONE: 244 1633
 ZIP CODE: 87109

ARCHITECT: BERENT GROTH AIA
 ADDRESS: 3546 SEQUOIA NW
 CITY, STATE: ALB. NM 87120

CONTACT: BERENT GROTH
 PHONE: 266 6700
 ZIP CODE: 87120

SURVEYOR: _____
 ADDRESS: _____
 CITY, STATE: _____

CONTACT: _____
 PHONE: _____
 ZIP CODE: _____

CONTRACTOR: _____
 ADDRESS: _____
 CITY, STATE: _____

CONTACT: _____
 PHONE: _____
 ZIP CODE: _____

CHECK TYPE OF SUBMITTAL:

- ☐ DRAINAGE REPORT
☐ DRAINAGE PLAN 1st SUBMITTAL, *REQUIRES TCL or equal*
☐ DRAINAGE PLAN RESUBMITTAL
☐ CONCEPTUAL GRADING & DRAINAGE PLAN
☐ GRADING PLAN
☐ EROSION CONTROL PLAN
☐ ENGINEER'S CERTIFICATION (HYDROLOGY)
☐ CLOM/LOMR
☒ TRAFFIC CIRCULATION LAYOUT (TCL)
☐ ENGINEER'S CERTIFICATION (TCL)
☐ ENGINEER'S CERTIFICATION (DRB APPRO SITE PLAN)
☐ OTHER

CHECK TYPE OF APPROVAL SOUGHT:

- ☐ SIA / FINANCIAL GUARANTEE RELEASE
☐ PRELIMINARY PLAT APPROVAL
☐ S. DEV. PLAN FOR SUB'D. APPROVAL
☐ S. DEV. PLAN FOR BLDG. PERMIT APPROVAL
☐ SECTOR PLAN APPROVAL
☐ FINAL PLAT APPROVAL
☐ FOUNDATION PERMIT APPROVAL
☒ BUILDING PERMIT APPROVAL
☐ CERTIFICATE OF OCCUPANCY (PERM.)
☐ CERTIFICATE OF OCCUPANCY (TEMP.)
☐ GRADING PERMIT APPROVAL
☐ PAVING PERMIT APPROVAL
☐ WORK ORDER APPROVAL
☐ OTHER (SPECIFY)

WAS A PRE-DESIGN CONFERENCE ATTENDED:

- ☐ YES
☐ NO
☐ COPY PROVIDED

DATE SUBMITTED: 4/27/05 BY: BERENT GROTH

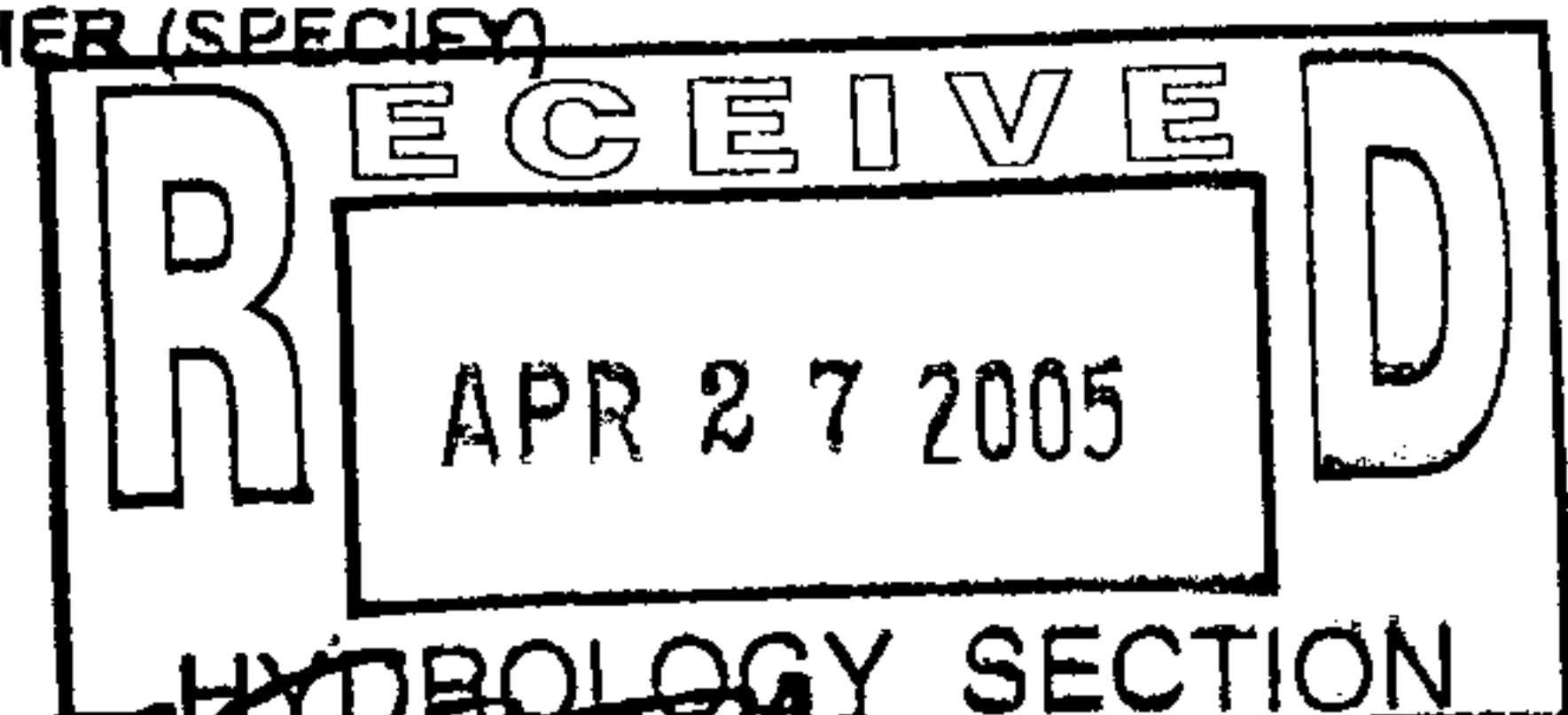

Requests for approvals of Site Development Plans and/or Subdivision Plats shall be accompanied by a drainage submittal. The particular nature, location and scope of the proposed development defines the degree of drainage detail. One or more of the following levels of submittal may be required based on the following:

1. Conceptual Grading and Drainage Plan: Required for approval of Site Development Plans greater than five (5) acres and Sector Plans.

2. Drainage Plans: Required for building permits, grading permits, paving permits and site plans less than five

(5)

acres.

3. Drainage Report: Required for subdivisions containing more than ten (10) lots or constituting five (5) acres or more.

BERENT GROTH ARCHITECT AIA

3546 SEQUOIA PLACE NW ALBUQUERQUE NEW MEXICO 87120

e-mail: bgrothala@aol.com

phone: (505) 266 6700

fax: (505) 836 6461

Mr. Wilfred Gallegos, P.E.
Traffic Engineer
Transportation Department
City of Albuquerque

April 22, 2005

RE: TCL Modification, Site Plan for 4700 Lincoln NE Parking Changes along Monroe St.

Dear Sir,

Attached please find a Site Plan for 4700 Lincoln NE. The Plan shows the modifications to parking along Monroe St. which we discussed.

Thank you for your attention to this matter.

Very truly yours,



Berent Groth, Architect
NM Registration No. 958
266 6700

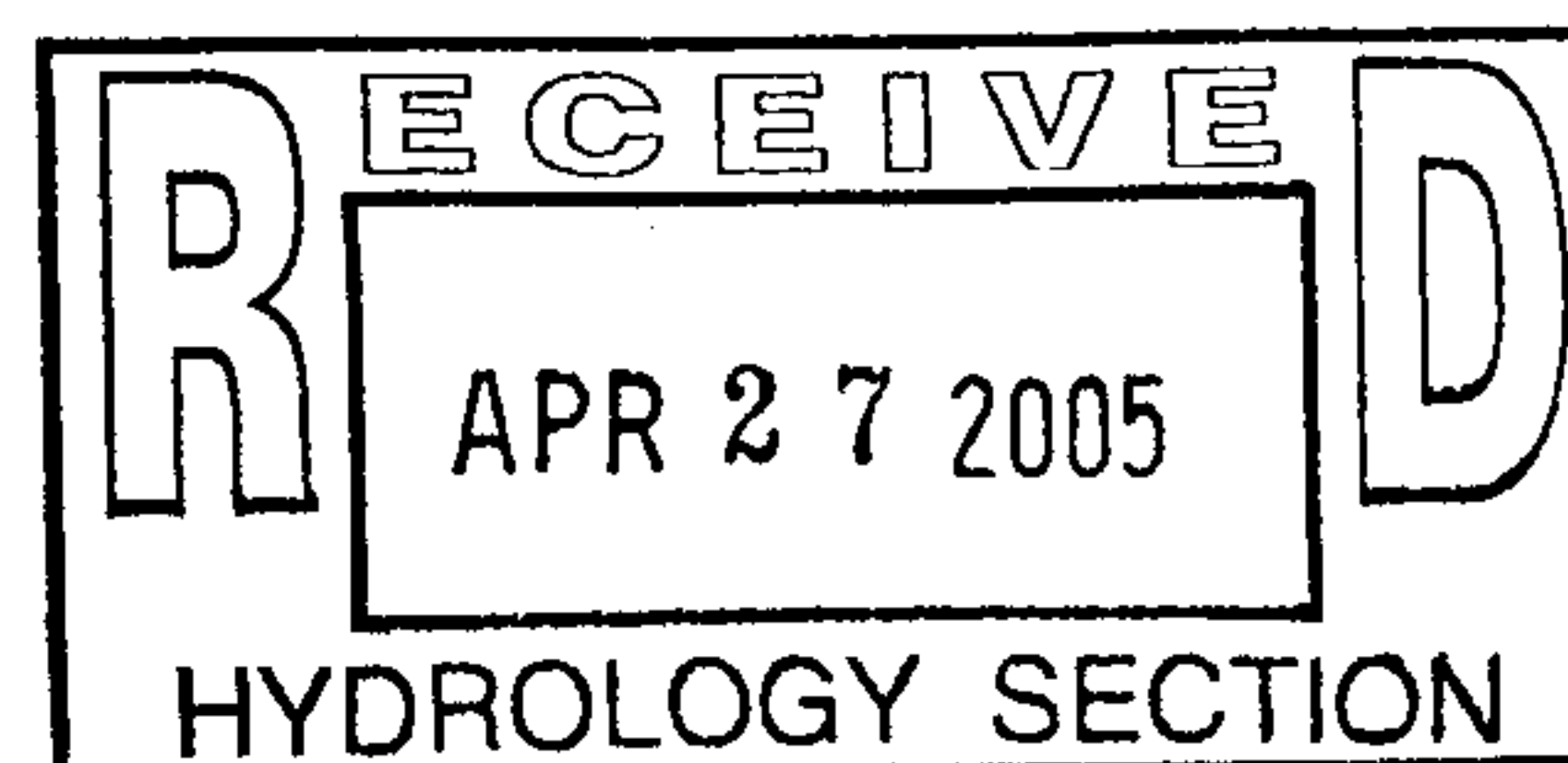

Berent Groth AIA

505 266 6700

505 836 6461 fax

bgrothaia@aol.com

www.berentgroth.com

Member, American Institute of Architects

3546 Sequoia Place NW. Albuquerque NM 87120

B E R E N T G R O T H A R C H I T E C T

Please File

ATTN: WILFRED GALLEGOS, P.E.

DRAINAGE AND TRANSPORTATION INFORMATION SHEET **F17/D17**
(REV. 1/28/2003rd)

PROJECT TITLE: PARKING CHANGE/4700 LINCOLN ZONE MAP/DRG. FILE #: F-17-2
DRB #: _____ EPC#: _____ WORK ORDER#: _____

LEGAL DESCRIPTION: _____
CITY ADDRESS: 4700 LINCOLN NE

ENGINEERING FIRM: _____
ADDRESS: _____
CITY, STATE: _____

CONTACT: _____
PHONE: _____
ZIP CODE: _____

OWNER: CHANT ASSOCIATES
ADDRESS: PO BOX 3529
CITY, STATE: ALB NM

CONTACT: ETHAN CHANT
PHONE: 344 1633
ZIP CODE: 87109

ARCHITECT: BERENT GROTH
ADDRESS: 3546 SEQUOIA PL. NW
CITY, STATE: ALB NM

CONTACT: BERENT
PHONE: 266 6700
ZIP CODE: 87120

SURVEYOR: _____
ADDRESS: _____
CITY, STATE: _____

CONTACT: _____
PHONE: _____
ZIP CODE: _____

CONTRACTOR: _____
ADDRESS: _____
CITY, STATE: _____

CONTACT: _____
PHONE: _____
ZIP CODE: _____

CHECK TYPE OF SUBMITTAL:

- ☐ DRAINAGE REPORT
☐ DRAINAGE PLAN 1st SUBMITTAL, *REQUIRES TCL or equal*
☐ DRAINAGE PLAN RESUBMITTAL
☐ CONCEPTUAL GRADING & DRAINAGE PLAN
☐ GRADING PLAN
☐ EROSION CONTROL PLAN
☐ ENGINEER'S CERTIFICATION (HYDROLOGY)
☐ CLOMR/LOMR
☒ **TRAFFIC CIRCULATION LAYOUT (TCL)**
☐ ENGINEERS CERTIFICATION (TCL)
☐ ENGINEERS CERTIFICATION (DRB APPR. SITE PLAN)
☐ OTHER

CHECK TYPE OF APPROVAL SOUGHT:

- ☐ SIA / FINANCIAL GUARANTEE RELEASE
☐ PRELIMINARY PLAT APPROVAL
☐ S. DEV. PLAN FOR SUB'D. APPROVAL
☒ S. DEV. PLAN FOR BLDG. PERMIT APPROVAL
☐ SECTOR PLAN APPROVAL
☐ FINAL PLAT APPROVAL
☐ FOUNDATION PERMIT APPROVAL
☒ **BUILDING PERMIT APPROVAL**
☐ CERTIFICATE OF OCCUPANCY (PERM.)
☐ CERTIFICATE OF OCCUPANCY (TEMP.)
☐ GRADING PERMIT APPROVAL
☐ PAVING PERMIT APPROVAL
☐ WORK ORDER APPROVAL
☐ OTHER (SPECIFY)

WAS A PRE-DESIGN CONFERENCE ATTENDED:

- ☐ YES
☐ NO
☒ **COPY PROVIDED**

N-Verbal; need 24836 ~~DRB Sited Plan~~ ^{TCL, Vicinity Map & Arch. Stamp}
w/appropriate language, Info sheet, Called Berent to advise.

DATE SUBMITTED: 4/22/05 BY: BERENT GROTH ARCHITECT

Requests for approvals of Site Development Plans and/or Subdivision Plats shall be accompanied by a drainage submittal. The particular nature, location and scope of the proposed development defines the degree of drainage detail. One or more of the following levels of submittal may be required based on the following:

1. **Conceptual Grading and Drainage Plan:** Required for approval of Site Development Plans greater than five (5) acres and Sector Plans.
2. **Drainage Plans:** Required for building permits, grading permits, paving permits and site plans less than five (5) acres.
3. **Drainage Report:** Required for subdivisions containing more than ten (10) lots or constituting five (5) acres or more.

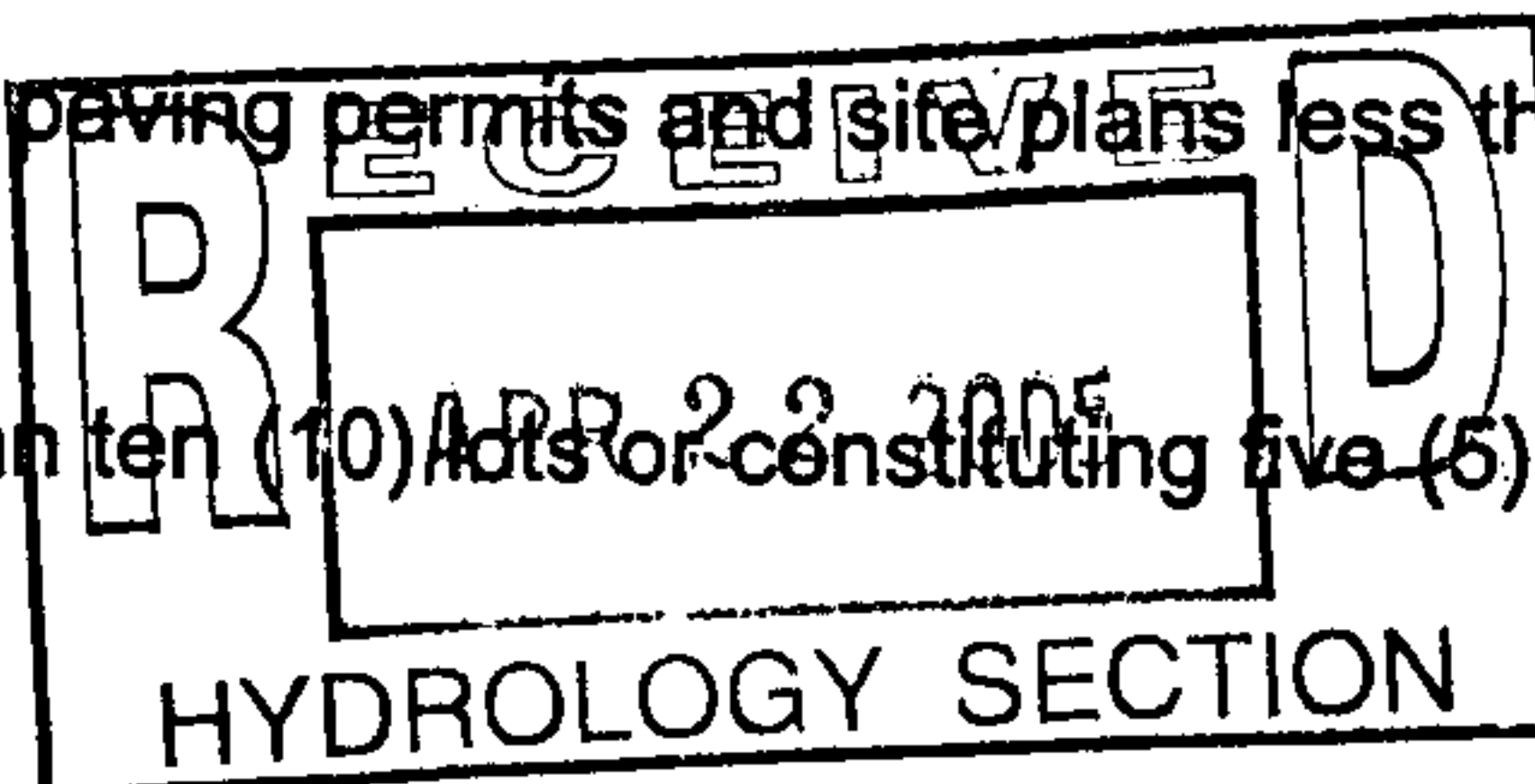

MONROE STREET N.E. (50' R/W 20' PAVING WIDTH)

BERENT GROTH
ARCHITECT
AIA

PROJECT DESCRIPTION

PROJECT TYPE: TENANT IMPROVEMENTS
ADDRESS: 4700 LINCOLN RD. NE (Z-F-17)
LEGAL: TRACT F, NAVAJO TERMINALS INC.

REQUIRED PARKING CALCULATION

BLDG. NET LEASABLE AREA: 21,324 SF
@1/200 TOTAL REQUIRED SPACES: 107
TOTAL OFF-STREET PKG. PROVIDED: 112 SP.
INCL. 6 ACCESS. PLUS 2 VAN ACCESS. SPACES

ZONING-NET LEASABLE AREA
GROSS LEASABLE AREA=23935 SF
LOBBY, RECEPTION, SERVICES, BREAK, TOILETS, SERVER= 2,182 SF
OTHER TOILETS/BREAK: 164 SF
ELEC. CLOS.: 265 SF
TOTAL: 2,611 SF
NET LEASABLE= 21,324 SF

REQUIRED LANDSCAPING CALCULATION

APPROX. SITE AREA: 75,112 SF
GROSS BLDG. AREA: 24,340 SF
EXIST. ON-SITE LANDSC. AREA: 10,560 SF
EXCEEDS 15% NET SITE AREA: 7,615 SF

LANDSCAPING IS OWNER MAINTAINED,
INCLUDES AUTOMATIC IRRIGATION SYSTEM

LINCOLN ROAD N.E. (64' R/W)

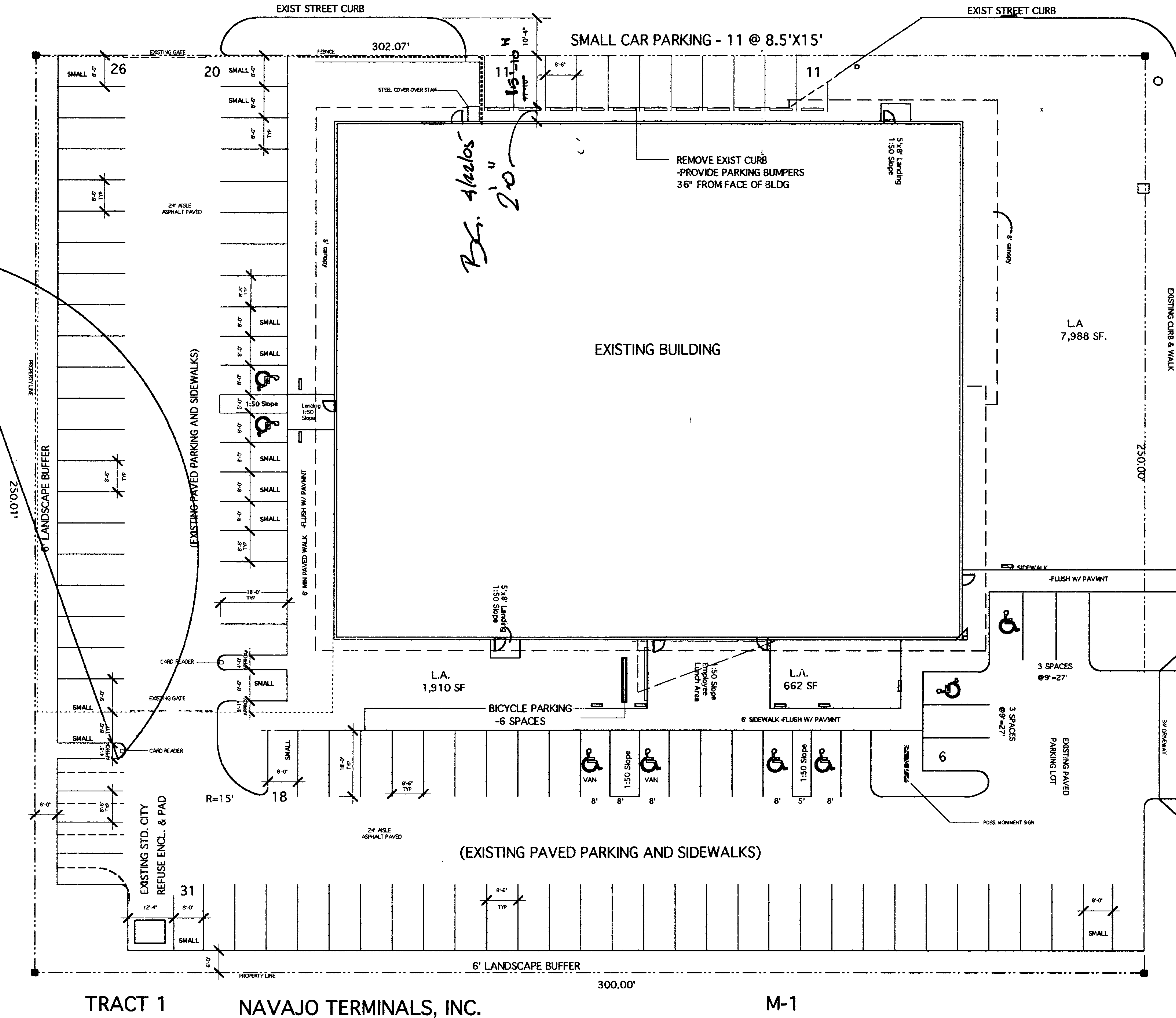

SITE PLAN

APR 22 2005

4700 LINCOLN RD OFFICES

CHANT ASSOCIATES



City of Albuquerque

P.O. BOX 1293 ALBUQUERQUE, NEW MEXICO 87103

December 4, 1998

Kim Kemper
Kemper-Vaughan
3700 Coors Rd. NW
Albuquerque, New Mexico 87120

RE: ENGINEER CERTIFICATION FOR NAPA AUTO PARTS (F17-D17) ENGINEER'S
CERTIFICATION STATEMENT DATED 12/2/98

Dear Mr. Kemper:

Based on the information provided on your December 3, 1998 submittal, Engineer Certification for the above referenced site is acceptable.

If I can be of further assistance, please feel free to contact me at 924-3986.

C: Andrew Garcia
File ✓

Sincerely

Bernie J. Montoya CE
Associate Engineer

DRAINAGE INFORMATION SHEET

PROJECT TITLE: NAPA AUTO PARTS. ZONE ATLAS/DRNG. FILE #: F-17/D17

DRB #: _____ EPC #: _____ WORK ORDER #: _____

LEGAL DESCRIPTION: TRACT A LANDS OF NAVAJO FREIGHT

CITY ADDRESS: SAN MATEO

ENGINEERING FIRM: KEMPER-VAUGHAN CONTACT: KIM R. KEMPER

ADDRESS: 3700 COORS RD NW PHONE: 831-4520

OWNER: BILL ROBERTS CONTACT: _____

ADDRESS: 408 ARIZONA, SE 87108 PHONE: 262-1607

ARCHITECT: DURA BILT PRODUCTS CONTACT: BRAD LITLE

ADDRESS: 4808 JEFFERSON PHONE: 883-9100

SURVEYOR: RIO GRANDE SURVEYING CONTACT: REX VOGLER

ADDRESS: 3700 COORS RD. PHONE: 831-4611

CONTRACTOR: DURA BILT PRODUCTS CONTACT: BRAD LITLE

ADDRESS: 4808 JEFFERSON PHONE: 883-9100

TYPE OF SUBMITTAL:

☐ DRAINAGE REPORT

☒ DRAINAGE PLAN

☐ CONCEPTUAL GRADING & DRAINAGE PLAN

☐ GRADING PLAN

☐ EROSION CONTROL PLAN

☒ ENGINEER'S CERTIFICATION

☐ OTHER _____

PRE-DESIGN MEETING:

☐ YES

☐ NO

☐ COPY PROVIDED

CHECK TYPE OF APPROVAL SOUGHT:

☐ SKETCH PLAT APPROVAL

☐ PRELIMINARY PLAT APPROVAL

☐ S. DEV. PLAN FOR SUB'D. APPROVAL

☐ S. DEV. PLAN FOR BLDG. PERMIT APPROVAL

☐ SECTOR PLAN APPROVAL

☐ FINAL PLAT APPROVAL

☐ FOUNDATION PERMIT APPROVAL

☐ BUILDING PERMIT APPROVAL

☒ CERTIFICATE OF OCCUPANCY APPROVAL

☐ GRADING PERMIT APPROVAL

☐ PAVING PERMIT APPROVAL

☐ S.A.D. DRAINAGE REPORT

☐ DRAINAGE REQUIREMENTS

☐ OTHER _____ (SPECIFY)

DATE SUBMITTED: 12/3/98

BY: [Signature]

RECEIVED
DEC 03 1998
HYDROLOGY SECTION