

GENERAL LEGEND

EXISTING CONTOUR	73
PROPOSED CONTOUR	72
EXISTING SPOT ELEVATION	x 48.55
PROPOSED SPOT ELEVATION	55.4
FLOWLINE	
FLOW DIRECTION ARROW	
PROPOSED CONCRETE	
TOP OF CURB ELEVATION	TC
FLOWLINE ELEVATION	FL
TOP OF ASPHALT	TA
RECORD DRAWING ELEV.	x 79.3

This site is in substantial compliance with the approved grading and drainage plan with engineer's seal dated 2-15-00 (with the revisions as reflected in the record drawing elevations shown hereon). The site drainage will function as originally proposed.

LUMBER AVE. N.E.

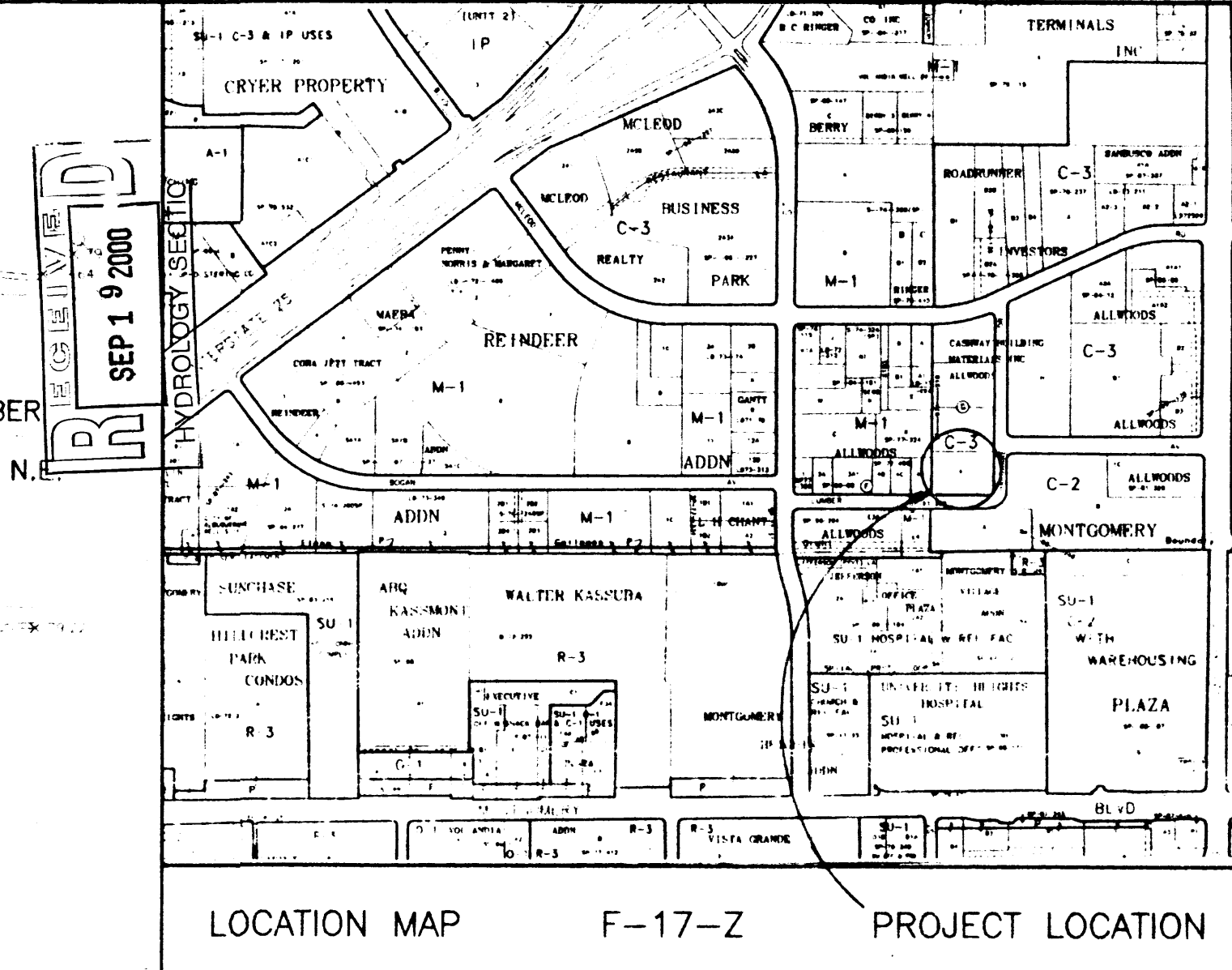

GENERAL NOTES

- PRIOR TO ANY CONSTRUCTION, THE CONTRACTOR SHALL EXCAVATE AND VERIFY THE LOCATION OF ALL POTENTIAL OBSTRUCTIONS. SHOULD A CONFLICT EXIST, THE CONTRACTOR SHALL NOTIFY THE ENGINEER AS SOON AS POSSIBLE TO RESOLVE THE CONFLICT WITH A MINIMUM AMOUNT OF DELAY. ALL WORK ON THIS PLAN SHALL BE PERFORMED IN ACCORDANCE WITH APPLICABLE FEDERAL, STATE AND LOCAL LAWS, RULES AND REGULATIONS CONCERNING CONSTRUCTION SAFETY AND HEALTH.
- IF ANY UTILITY LINES, PIPELINES, OR UNDERGROUND UTILITY LINES ARE SHOWN ON THESE DRAWINGS, THEY ARE SHOWN IN AN APPROXIMATE LOCATION ONLY, AND LINES MAY EXIST WHERE NONE ARE SHOWN, THE LOCATION IS BASED UPON INFORMATION PROVIDED BY THE UTILITY OWNER OR FROM EXISTING PLANS, AND THIS INFORMATION MAY BE INCOMPLETE, OR OBSOLETE AT THE TIME OF CONSTRUCTION. THE ENGINEER HAS NOT UNDERTAKEN ANY FIELD VERIFICATION OF THESE LOCATIONS, LINE SIZES OR MATERIAL TYPE, MAKES NO REPRESENTATION THERETO, AND ASSUMES NO RESPONSIBILITY OR LIABILITY THEREFOR. THE CONTRACTOR SHALL INFORM ITSELF OF THE LOCATION OF ANY UTILITY LINE, PIPELINE OR UNDERGROUND INSTALLATION IN OR NEAR THE AREA IN ADVANCE OF AND DURING ANY EXCAVATION WORK. THE CONTRACTOR IS FULLY RESPONSIBLE FOR ANY AND ALL DAMAGES CAUSED BY ITS FAILURE TO LOCATE, IDENTIFY AND PRESERVE ANY AND ALL EXISTING UTILITIES, PIPELINES AND UNDERGROUND FACILITIES. IN PLANNING AND CONDUCTING EXCAVATIONS, THE CONTRACTOR SHALL COMPLY WITH ALL STATE STATUTES, MUNICIPAL AND LOCAL ORDINANCES, RULES AND REGULATIONS, IF ANY, PERTAINING TO THE LOCATION OF THESE LINES AND FACILITIES.
- THE CONTRACTOR SHALL INSURE THAT NO SOIL ERODES FROM THE SITE INTO PUBLIC RIGHTS-OF-WAY OR ONTO PRIVATE PROPERTY. THIS CAN BE ACHIEVED BY CONSTRUCTING TEMPORARY BERMS AND BY WETTING THE SOIL TO KEEP IT FROM BLOWING. THE CONTRACTOR SHALL OBTAIN ANY AND ALL PERMITS REQUIRED BY THE CITY OF ALB. FOR THE COMPLETION OF THE WORK PRIOR TO BEGINNING CONSTRUCTION.
- ALL CONSTRUCTION SHALL BE IN ACCORDANCE WITH THE CITY OF ALBUQUERQUE STANDARD SPECIFICATIONS FOR PUBLIC WORKS CONSTRUCTION, 1986 EDITION AND ALL CURRENT UPDATES.
- AN EXCAVATION/CONSTRUCTION PERMIT WILL BE REQUIRED BEFORE BEGINNING WORK WITHIN CITY RIGHT-OF-WAY. AN APPROVED COPY OF THESE PLANS MUST BE SUBMITTED AT THE TIME OF APPLICATION FOR PERMIT.
- TWO WORKING DAYS PRIOR TO AN EXCAVATION, CONTRACTOR MUST CONTACT LINE LOCATING SERVICE A 260-1990 FOR LOCATION OF EXISTING UTILITIES.
- PRIOR TO CONSTRUCTION, THE CONTRACTOR SHALL EXCAVATE AND VERIFY THE HORIZONTAL AND VERTICAL LOCATIONS OF ALL CONSTRUCTIONS. SHOULD A CONFLICT EXIST, THE CONTRACTOR SHALL NOTIFY THE ENGINEER SO THAT THE CONFLICT CAN BE RESOLVED WITH A MINIMUM AMOUNT OF DELAY.
- BACKFILL COMPACTION SHALL BE ACCORDING TO COLLECTOR STREET USE.
- MAINTENANCE OF THESE FACILITIES SHALL BE THE RESPONSIBILITY OF THE OWNER OF THE PROPERTY SERVED.

BENCH MARK

"9-F18", A BRASS CAP IN THE MEDIAN ON SAN MATEO BLVD. NORTH OF MONTGOMERY ROAD. ELEV. = 5209.56

LEGAL DESCRIPTION

LOT 4, BLOCK G ALLWOODS SUBDIVISION.

PROPOSED SITE IMPROVEMENTS

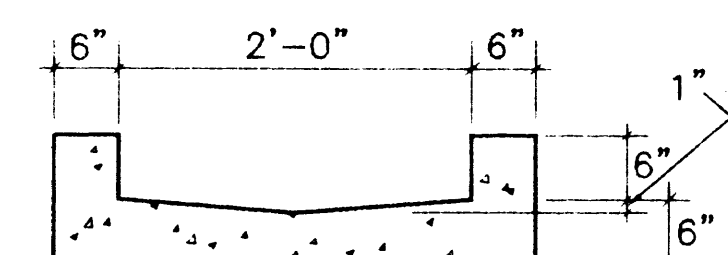
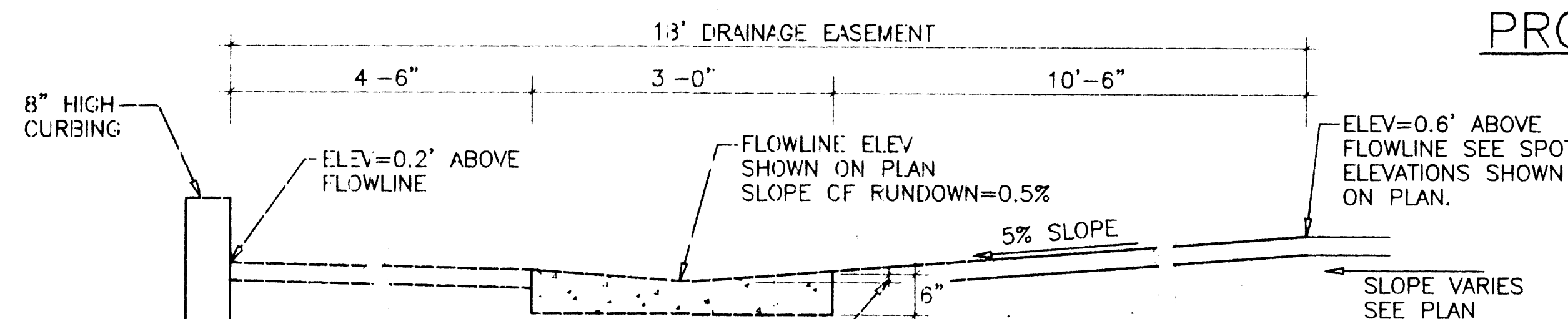

CONCRETE RUNDOWN
NTS

THE EXISTING SURVEY INFORMATION SHOWN HEREON WAS PREPARED FROM A FIELD SURVEY DONE BY RIO GRANDE SURVEYING CO., INC., IN NOVEMBER 1999. A SUBSEQUENT FIELD REVIEW BY THIS OFFICE REVEALED THAT THE INFORMATION SHOWN HEREON IS CONSISTENT WITH THE ACTUAL CONDITIONS THAT EXIST IN THE FIELD.

NAME	DATE
HYDROLOGY	
INSPECTOR	
A.C.E./FIELD	

INTEGRATED TECHNOLOGIES
GRADING AND DRAINAGE PLAN

KEMPER-VAUGHAN
CONSULTING ENGINEERS

3700 COORS RD. N.W. • ALBUQUERQUE, NEW MEXICO 87120 • (505) 831-4520
Designed KRK Drawn _____ Checked KRK Sheet _____ of _____
File DURABILT/ITC G&D Date JANUARY 2000 C1

GENERAL LEGEND

EXISTING CONTOUR	73
PROPOSED CONTOUR	72
EXISTING SPOT ELEVATION	x 48.55
PROPOSED SPOT ELEVATION	53.4
FLOWLINE	
FLOW DIRECTION ARROW	
PROPOSED CONCRETE	
TOP OF CURB ELEVATION	TC
FLOWLINE ELEVATION	FL
TOP OF ASPHALT	TA

BEGIN NEW VALLEY GUTTER AT CURB LINE. FLOWLINE ELEV.= 72.70. TAPER FROM EXISTING 6" CHANNEL BOTTOM TO 3" GUTTER IN FIRST 10'. TRANSITION CURB TO MATCH EXISTING CHANNEL BACKSLOPE.

NEW 3" VALLEY GUTTER. SEE DETAIL THIS SHT. (SLOPE=0.5%)

HEADER CURB TO BE 8" IN HEIGHT ALONG WEST BOUNDARY

END NEW VALLEY GUTTER AT CURB LINE. FLOWLINE AT ELEV.=71.90. CURB ON S. SIDE OF LAST PARKING SPACE TO BE FLUSH WITH PROPOSED ASPHALT. RE-GRADE EXISTING CHANNEL TO TRANSITION TO ASPHALT SECTION.

BENCH MARK

"9-F18", A BRASS CAP IN THE MEDIAN ON SAN MATEO BLVD. NORTH OF MONTGOMERY ROAD. ELEV. = 5209.56

LEGAL DESCRIPTION

LOT 4, BLOCK G ALLWOODS SUBDIVISION.

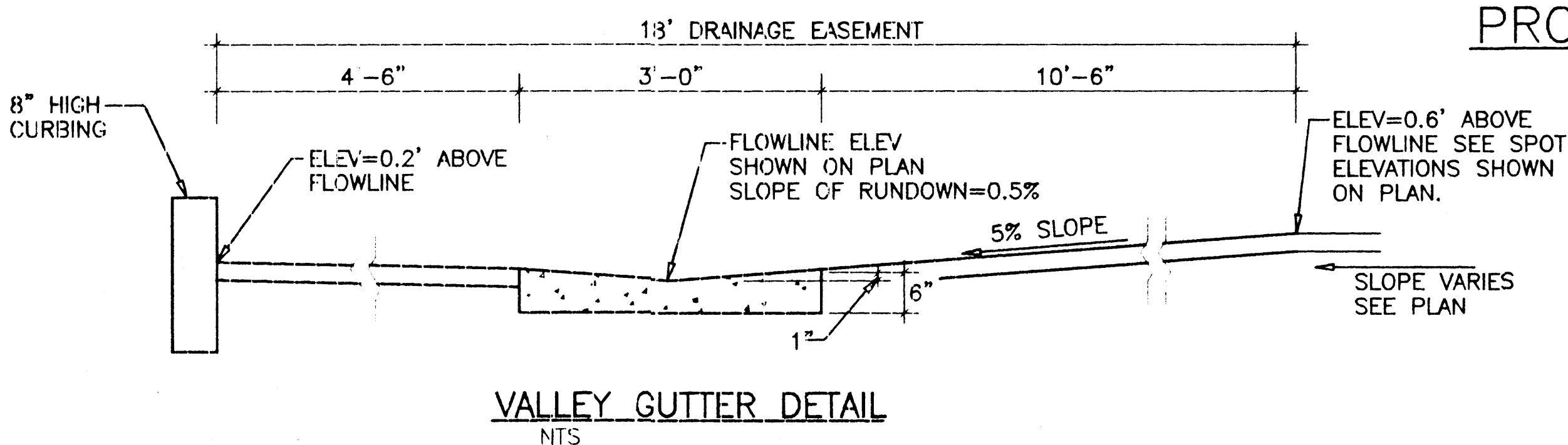

PROPOSED SITE IMPROVEMENTS

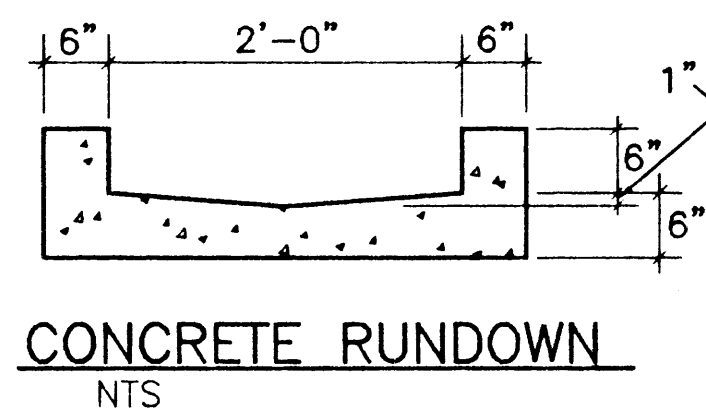

THE EXISTING SURVEY INFORMATION SHOWN HEREON WAS PREPARED FROM A FIELD SURVEY DONE BY RIO GRANDE SURVEYING CO., INC., IN NOVEMBER 1999. A SUBSEQUENT FIELD REVIEW BY THIS OFFICE REVEALED THAT THE INFORMATION SHOWN HEREON IS CONSISTENT WITH THE ACTUAL CONDITIONS THAT EXIST IN THE FIELD.

LUMBER AVE. N.E.

LOCATION MAP F-17-Z PROJECT LOCATION

GENERAL NOTES

- PRIOR TO ANY CONSTRUCTION, THE CONTRACTOR SHALL EXCAVATE AND VERIFY THE LOCATION OF ALL POTENTIAL OBSTRUCTIONS. SHOULD A CONFLICT EXIST, THE CONTRACTOR SHALL NOTIFY THE ENGINEER AS SOON AS POSSIBLE TO RESOLVE THE CONFLICT WITH A MINIMUM AMOUNT OF DELAY.
- ALL WORK ON THIS PLAN SHALL BE PERFORMED IN ACCORDANCE WITH APPLICABLE FEDERAL, STATE AND LOCAL LAWS, RULES AND REGULATIONS CONCERNING CONSTRUCTION SAFETY AND HEALTH.
- IF ANY UTILITY LINES, PIPELINES, OR UNDERGROUND UTILITY LINES ARE SHOWN ON THESE DRAWINGS, THEY ARE SHOWN IN AN APPROXIMATE LOCATION ONLY, AND LINES MAY EXIST WHERE NONE ARE SHOWN, THE LOCATION IS BASED UPON INFORMATION PROVIDED BY THE UTILITY OWNER OR FROM EXISTING PLANS, AND THIS INFORMATION MAY BE INCOMPLETE, OR OBSOLETE AT THE TIME OF CONSTRUCTION. THE ENGINEER HAS NOT UNDERTAKEN ANY FIELD VERIFICATION OF THESE LOCATIONS, LINE SIZES OR MATERIAL TYPE, MAKES NO REPRESENTATION THERETO, AND ASSUMES NO RESPONSIBILITY OR LIABILITY THEREFOR. THE CONTRACTOR SHALL INFORM ITSELF OF THE LOCATION OF ANY UTILITY LINE, PIPELINE OR UNDERGROUND INSTALLATION IN OR NEAR THE AREA IN ADVANCE OF AND DURING ANY EXCAVATION WORK. THE CONTRACTOR IS FULLY RESPONSIBLE FOR ANY AND ALL DAMAGES CAUSED BY ITS FAILURE TO LOCATE, IDENTIFY AND PRESERVE ANY AND ALL EXISTING UTILITIES, PIPELINES AND UNDERGROUND FACILITIES. IN PLANNING AND CONDUCTING EXCAVATIONS, THE CONTRACTOR SHALL COMPLY WITH ALL STATE STATUTES, MUNICIPAL AND LOCAL ORDINANCES, RULES AND REGULATIONS, IF ANY, PERTAINING TO THE LOCATION OF THESE LINES AND FACILITIES.
- THE CONTRACTOR SHALL INSURE THAT NO SOIL ERODES FROM THE SITE INTO PUBLIC RIGHTS-OF-WAY OR ONTO PRIVATE PROPERTY. THIS CAN BE ACHIEVED BY CONSTRUCTING TEMPORARY BERMS AND BY WETTING THE SOIL TO KEEP IT FROM BLOWING. THE CONTRACTOR SHALL OBTAIN ANY AND ALL PERMITS REQUIRED BY THE CITY OF ALB. FOR THE COMPLETION OF THE WORK PRIOR TO BEGINNING CONSTRUCTION.
- ALL CONSTRUCTION SHALL BE IN ACCORDANCE WITH THE CITY OF ALBUQUERQUE STANDARD SPECIFICATIONS FOR PUBLIC WORKS CONSTRUCTION, 1986 EDITION AND ALL CURRENT UPDATES.
- AN EXCAVATION/CONSTRUCTION PERMIT WILL BE REQUIRED BEFORE BEGINNING WORK WITHIN CITY RIGHT-OF-WAY. AN APPROVED COPY OF THESE PLANS MUST BE SUBMITTED AT THE TIME OF APPLICATION FOR PERMIT.
- TWO WORKING DAYS PRIOR TO AN EXCAVATION, CONTRACTOR MUST CONTACT LINE LOCATING SERVICE A 260-1990 FOR LOCATION OF EXISTING UTILITIES.
- PRIOR TO CONSTRUCTION, THE CONTRACTOR SHALL EXCAVATE AND VERIFY THE HORIZONTAL AND VERTICAL LOCATIONS OF ALL CONSTRUCTIONS. SHOULD A CONFLICT EXIST, THE CONTRACTOR SHALL NOTIFY THE ENGINEER SO THAT THE CONFLICT CAN BE RESOLVED WITH A MINIMUM AMOUNT OF DELAY.
- BACKFILL COMPACTION SHALL BE ACCORDING TO COLLECTOR STREET USE.
- MAINTENANCE OF THESE FACILITIES SHALL BE THE RESPONSIBILITY OF THE OWNER OF THE PROPERTY SERVED.

NAME	DATE
HYDROLOGY	
INSPECTOR	
A.C.E./FIELD	

INTEGRATED TECHNOLOGIES
GRADING AND DRAINAGE PLAN

KEMPER-VAUGHAN
CONSULTING ENGINEERS

3700 COORS RD. N.W. • ALBUQUERQUE, NEW MEXICO 87120 • (505) 831-4520
Designed KRK Drawn Checked KRK Sheet of
File DURABIL/ITC G&D Date JANUARY 2000 C1

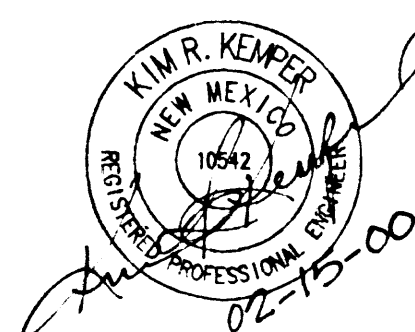

GENERAL LEGEND

EXISTING CONTOUR	75
PROPOSED CONTOUR	72
EXISTING SPOT ELEVATION	x 48.55
PROPOSED SPOT ELEVATION	56.4
FLOWLINE	
FLOW DIRECTION ARROW	
PROPOSED CONCRETE	
TOP OF CURB ELEVATION	TC
FLOWLINE ELEVATION	FL
TOP OF ASPHALT	TA

BEGIN NEW VALLEY GUTTER AT CURB LINE. FLOWLINE ELEV.= 72.70. TAPER FROM EXISTING 6" CHANNEL BOTTOM TO 3" GUTTER IN FIRST 10'. TRANSITION CURB TO MATCH EXISTING CHANNEL BACKSLOPE.

NEW 3' VALLEY GUTTER. SEE DETAIL THIS SHT. (SLOPE=0.5%)

HEADER CURB TO BE 8" IN HEIGHT ALONG WEST BOUNDARY

END NEW VALLEY GUTTER AT CURB LINE. FLOWLINE AT ELEV.=71.90. CURB ON S. SIDE OF LAST PARKING SPACE TO BE FLUSH WITH PROPOSED ASPHALT. RE-GRADE EXISTING CHANNEL TO TRANSITION TO ASPHALT SECTION.

BENCH MARK

"9-F18", A BRASS CAP IN THE MEDIAN ON SAN MATEO BLVD. NORTH OF MONTGOMERY ROAD. ELEV. = 5209.56

LEGAL DESCRIPTION

LOT 4, BLOCK G ALLWOODS SUBDIVISION.

REMOVE EXISTING CURB AND GUTTER AND REPLACE WITH NEW 30" CURB CUT PER C.O.A. STANDARDS DETAIL #2426

INSTALL NEW 2' CONC. RUNDOWN SEE DETAIL THIS SHT.

T.B.M. NORTH BONNET BOLT OF FIRE HYDRANT. ELEV. = 4977.48

LOCATION MAP F-17-Z PROJECT LOCATION

GENERAL NOTES

- PRIOR TO ANY CONSTRUCTION, THE CONTRACTOR SHALL EXCAVATE AND VERIFY THE LOCATION OF ALL POTENTIAL OBSTRUCTIONS. SHOULD A CONFLICT EXIST, THE CONTRACTOR SHALL NOTIFY THE ENGINEER AS SOON AS POSSIBLE TO RESOLVE THE CONFLICT WITH A MINIMUM AMOUNT OF DELAY.
- ALL WORK ON THIS PLAN SHALL BE PERFORMED IN ACCORDANCE WITH APPLICABLE FEDERAL, STATE AND LOCAL LAWS, RULES AND REGULATIONS CONCERNING CONSTRUCTION SAFETY AND HEALTH.
- IF ANY UTILITY LINES, PIPELINES, OR UNDERGROUND UTILITY LINES ARE SHOWN ON THESE DRAWINGS, THEY ARE SHOWN IN AN APPROXIMATE LOCATION ONLY, AND LINES MAY EXIST WHERE NONE ARE SHOWN, THE LOCATION IS BASED UPON INFORMATION PROVIDED BY THE UTILITY OWNER OR FROM EXISTING PLANS, AND THIS INFORMATION MAY BE INCOMPLETE, OR OBSOLETE AT THE TIME OF CONSTRUCTION. THE ENGINEER HAS NOT UNDERTAKEN ANY FIELD VERIFICATION OF THESE LOCATIONS, LINE SIZES OR MATERIAL TYPE, MAKES NO REPRESENTATION THERETO, AND ASSUMES NO RESPONSIBILITY OR LIABILITY THEREFOR. THE CONTRACTOR SHALL INFORM ITSELF OF THE LOCATION OF ANY UTILITY LINE, PIPELINE OR UNDERGROUND INSTALLATION IN OR NEAR THE AREA IN ADVANCE OF AND DURING ANY EXCAVATION WORK. THE CONTRACTOR IS FULLY RESPONSIBLE FOR ANY AND ALL DAMAGES CAUSED BY ITS FAILURE TO LOCATE, IDENTIFY AND PRESERVE ANY AND ALL EXISTING UTILITIES, PIPELINES AND UNDERGROUND FACILITIES. IN PLANNING AND CONDUCTING EXCAVATIONS, THE CONTRACTOR SHALL COMPLY WITH ALL STATE STATUTES, MUNICIPAL AND LOCAL ORDINANCES, RULES AND REGULATIONS, IF ANY, PERTAINING TO THE LOCATION OF THESE LINES AND FACILITIES.
- THE CONTRACTOR SHALL INSURE THAT NO SOIL ERODES FROM THE SITE INTO PUBLIC RIGHTS-OF-WAY OR ONTO PRIVATE PROPERTY. THIS CAN BE ACHIEVED BY CONSTRUCTING TEMPORARY BERMS AND BY WETTING THE SOIL TO KEEP IT FROM FLOWING.
- THE CONTRACTOR SHALL OBTAIN ANY AND ALL PERMITS REQUIRED BY THE CITY OF ALB. FOR THE COMPLETION OF THE WORK PRIOR TO BEGINNING CONSTRUCTION.

THE EXISTING SURVEY INFORMATION SHOWN HEREON WAS PREPARED FROM A FIELD SURVEY DONE BY RIO GRANDE SURVEYING CO., INC., IN NOVEMBER 1999. A SUBSEQUENT FIELD REVIEW BY THIS OFFICE REVEALED THAT THE INFORMATION SHOWN HEREON IS CONSISTENT WITH THE ACTUAL CONDITIONS THAT EXIST IN THE FIELD.

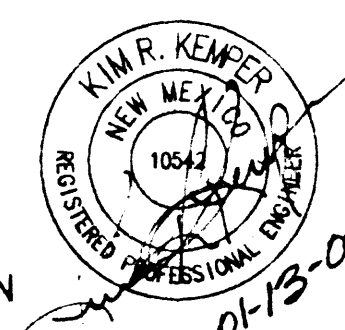

PROPOSED SITE IMPROVEMENTS

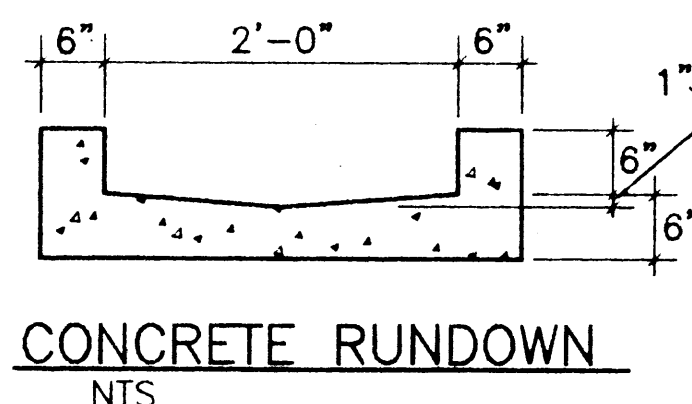
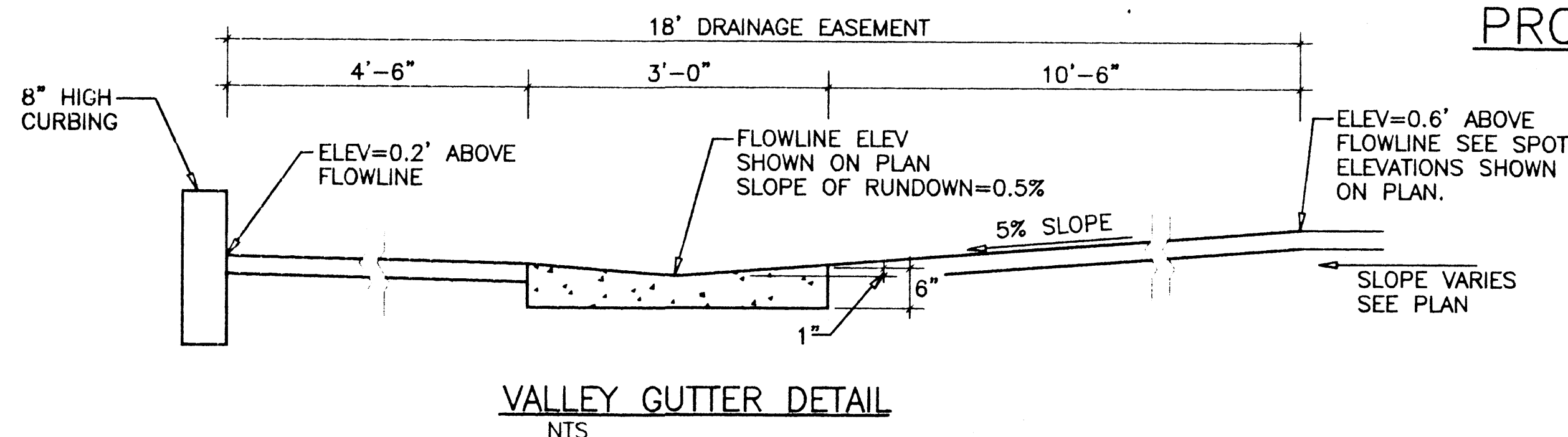

SCALE: 1" = 20'

ONE FOOT CONTOUR INTERVAL
ADD 4900' TO ELEV'S. SHOWN FOR M.S.L.

INTEGRATED TECHNOLOGIES
GRADING AND DRAINAGE PLAN

KEMPER-VAUGHAN
CONSULTING ENGINEERS

3700 COORS RD. N.W. • ALBUQUERQUE, NEW MEXICO 87120 • (505) 831-4520
Designed KRK Drawn KRK Checked KRK Sheet C1
File DURABILT/ITC G&D Date JANUARY 2000