

OVERALL SITE PLAN

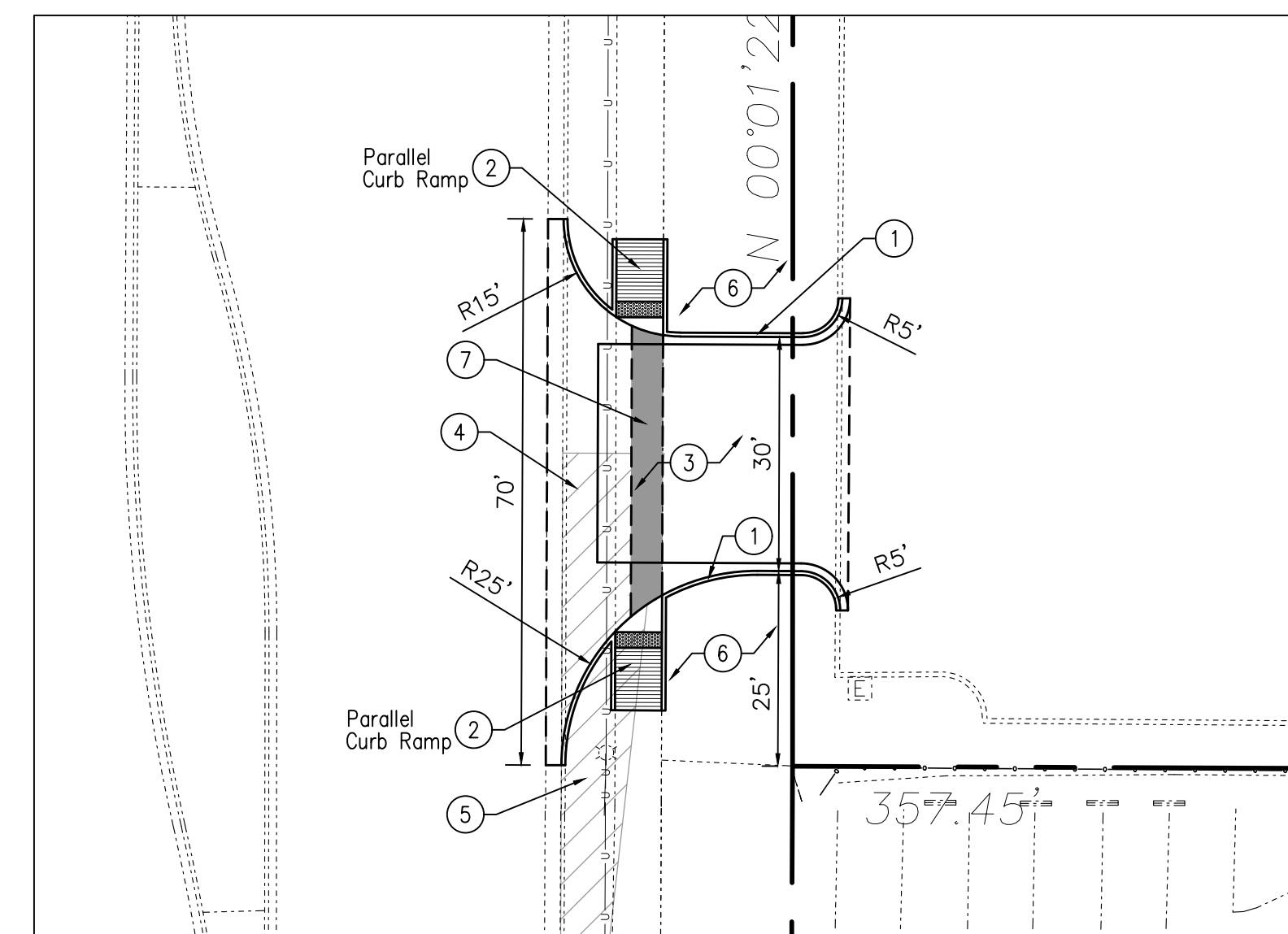

SITE PLAN DETAIL

KEYED NOTES

1. INSTALL STANDARD CURB/GUTTER (8" HIGH) PER COA STD DWG 2415A.
2. INSTALL PARALLEL CURB RAMP PER NMDOT STD DWGS 608-001, SHEETS 1-12 WITH DETECTABLE WARNING SURFACE. MATCH ADJACENT SIDEWALK WIDTH. SEE NMDOT DETAIL, SHEET C102.
3. ASPHALT PAVEMENT PER DETAIL, SHEET C102.
4. INSTALL VALLEY GUTTER PER COA STD DWG 2420.
5. 13'X120' CLEAR SIGHT TRIANGLE. LANDSCAPING, FENCING, AND SIGNAGE WILL NOT INTERFERE WITH CLEAR SIGHT REQUIREMENTS. THEREFORE; SIGNS, WALLS, TREES, AND SHRUBBERY BETWEEN 3 AND 8 FEET TALL (AS MEASURED FROM THE GUTTER PAN) WILL NOT BE ACCEPTABLE IN THE CLEAR SIGHT TRIANGLE.
6. REPAIR AND REPLACE EXISTING LANDSCAPE AND/OR IRRIGATION AS REQUIRED DUE TO NEW DRIVEWAY CONSTRUCTION.
7. MINIMUM 4 FOOT WIDE ADA ROUTE AT SIDEWALK CROSSING. ENSURE CROSS SLOPE DOES NOT EXCEED 2.0%.

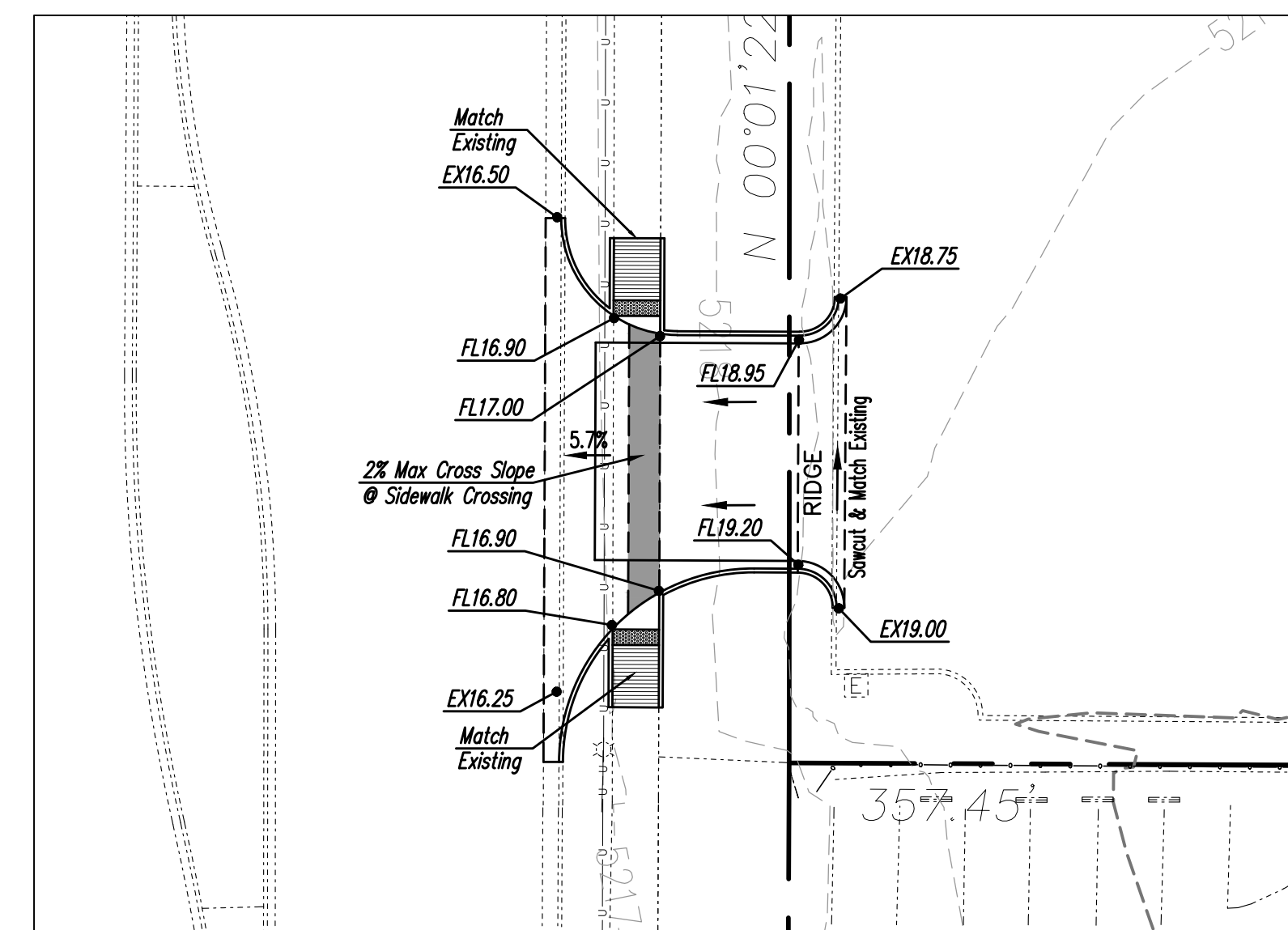

GRADING PLAN DETAIL

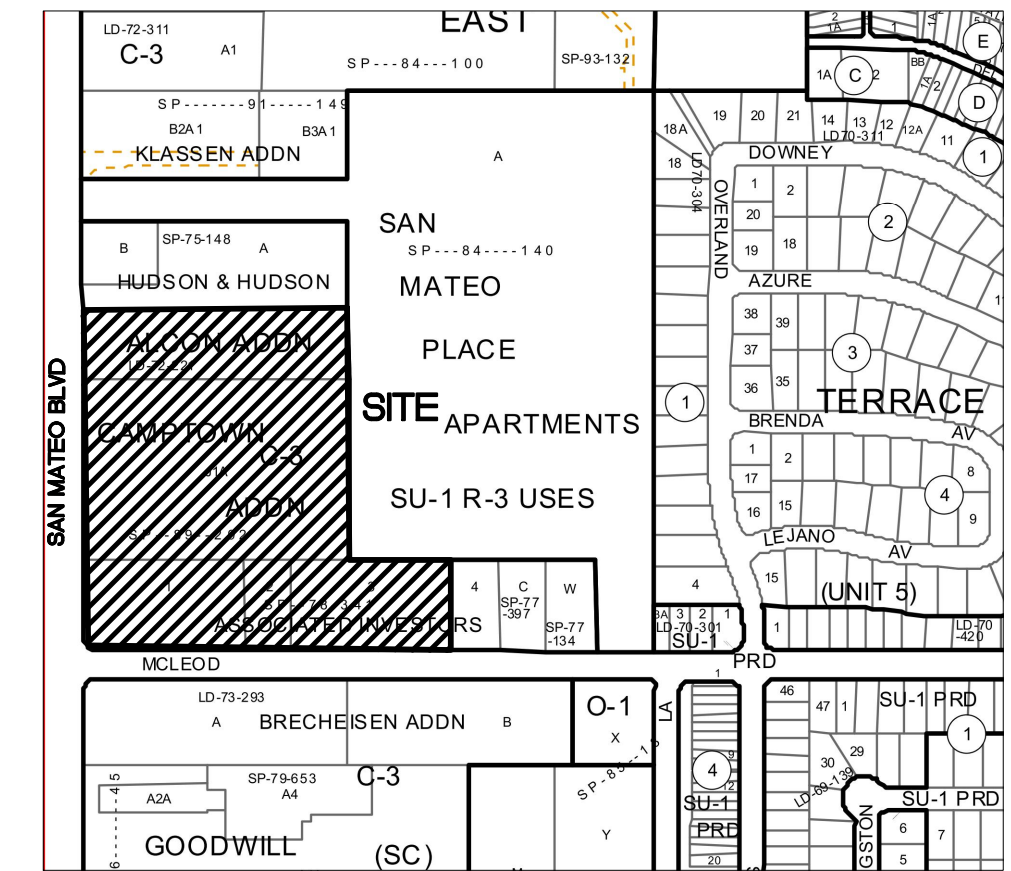

VICINITY MAP - Zone F-18-Z
 Legal Description: Tract J1A Camptown, Addition Formally TRS J1 and J2 Cont. 5.3972 ACM/L

CAUTION - NOTICE TO CONTRACTOR
 THE CONTRACTOR IS SPECIFICALLY CAUTIONED THAT THE LOCATION AND/OR ELEVATION OF EXISTING UTILITIES AS SHOWN ON THESE PLANS IS BASED ON RECORDS OF THE VARIOUS UTILITY COMPANIES AND, WHERE POSSIBLE, MEASUREMENTS TAKEN IN THE FIELD. THE INFORMATION IS NOT TO BE RELIED ON AS BEING EXACT OR COMPLETE. THE CONTRACTOR MUST CALL THE APPROPRIATE UTILITY COMPANY AT LEAST 48 HOURS BEFORE ANY EXCAVATION TO REQUEST EXACT FIELD LOCATION OF UTILITIES. IT SHALL BE THE RESPONSIBILITY OF THE CONTRACTOR TO RELOCATE ALL EXISTING UTILITIES WHICH CONFLICT WITH THE PROPOSED IMPROVEMENTS SHOWN ON THE PLANS.

TRAFFIC CIRCULATION LAYOUT APPROVED

11/10/2020

Jeanne Wolfenbarger

NO.	DATE	REMARKS	BY
		DESIGN	
		REVISIONS	

DESIGNED BY: JW
 DRAWN BY: RG
 DRAWN NAME: J.WOLFENBARGER
 CHECKED BY: JW
 DATE: Oct 2020
 DATE: Oct 2020
 JOB NO.: 2018006
 DATE: Oct 2020

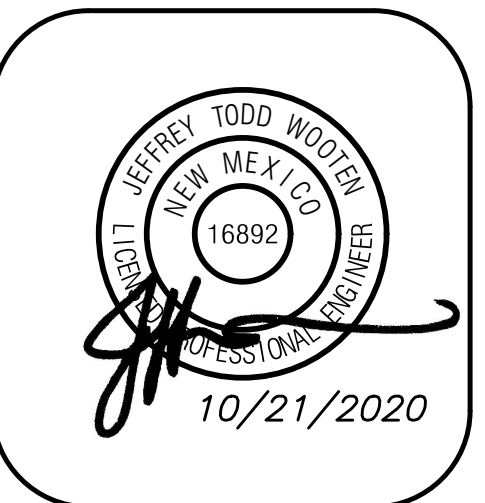

Wooten Engineering
 PO BOX 15814
 Rio Rancho, N.M. 87174
 Phone: (505) 980-3560

COVID-19 Testing Site
 5200 San Mateo Blvd
 Albuquerque, NM

Traffic Circulation Layout

C101