

# CITY OF ALBUQUERQUE

*Planning Department*  
Alan Varela, Director



*Mayor Timothy M. Keller*

November 20, 2024

Treveston Elliott,  
Treveston Elliott Architect.  
1317 Stagecoach RD SE,  
Albuquerque, NM 87123

**Re: Storage Warehouse  
714 San Mateo Ave  
Traffic Circulation Layout  
Engineer's/Architect's Stamp 11-20-24 (F18D040)**

Dear Mr. Elliott,

The TCL submittal received 11-20-2024 is approved for Building Permit by transportation. A copy of the stamped and signed plan will be needed for each of the building permit plans. Please keep the original to be used for certification of the site for final C.O. for Transportation.

When the site construction is completed and an inspection for Certificate of Occupancy (C.O.) is requested, use the original City stamped approved TCL for certification. Redline any minor changes and adjustments that were made in the field. A NM registered architect or engineer must stamp, sign, and date the certification TCL along with indicating that the development was built in "substantial compliance" with the TCL. Submit this certification, the TCL, and a completed Drainage and Transportation Information Sheet to [plndrs@cabq.gov](mailto:plndrs@cabq.gov) for log in and evaluation by Transportation.

Once verification of certification is completed and approved, notification will be made to Building Safety to issue Final C.O. To confirm that a final C.O. has been issued, call Building Safety at 924-3690.

Sincerely,

Ernest Armijo, P.E.  
Principal Engineer, Planning Dept.  
Development Review Services

\xxx via: email  
C: CO Clerk, File



# City of Albuquerque

Planning Department  
Development & Building Services Division

## DRAINAGE AND TRANSPORTATION INFORMATION SHEET (DTIS)

Project Title: \_\_\_\_\_ Hydrology File # \_\_\_\_\_

Legal Description: \_\_\_\_\_

City Address, UPC, OR Parcel: \_\_\_\_\_

Applicant/Agent: \_\_\_\_\_ Contact: \_\_\_\_\_

Address: \_\_\_\_\_ Phone: \_\_\_\_\_

Email: \_\_\_\_\_

Applicant/Owner: \_\_\_\_\_ Contact: \_\_\_\_\_

Address: \_\_\_\_\_ Phone: \_\_\_\_\_

Email: \_\_\_\_\_

**TYPE OF DEVELOPMENT:**      Plat (# of lots) \_\_\_\_\_      Single Family Home  
All other Developments

RE-SUBMITTAL:      YES      NO

**DEPARTMENT:**      TRANSPORTATION      HYDROLOGY/DRAINAGE

**Check all that apply under Both the Type of Submittal and the Type of Approval Sought:**

### TYPE OF SUBMITTAL:

Engineering / Architect Certification  
Conceptual Grading & Drainage Plan  
Grading & Drainage Plan, and/or Drainage Report  
Drainage Report (Work Order)  
Drainage Master Plan  
Conditional Letter of Map Revision (CLOMR)  
Letter of Map Revision (LOMR)  
Floodplain Development Permit  
Traffic Circulation Layout (TCL) – Administrative  
Traffic Circulation Layout (TCL) – DFT Approval  
Traffic Impact Study (TIS)  
Street Light Layout  
OTHER (SPECIFY) \_\_\_\_\_

### TYPE OF APPROVAL SOUGHT:

Pad Certification  
Building Permit  
Grading Permit  
Paving Permit  
SO-19 Permit  
Foundation Permit  
Certificate of Occupancy -      Temp      Perm  
Preliminary / Final Plat  
Site Plan for Building Permit - DFT  
Work Order (DRC)  
Release of Financial Guarantee (ROFG)  
CLOMR / LOMR  
Conceptual TCL - DFT  
OTHER (SPECIFY) \_\_\_\_\_

DATE SUBMITTED: \_\_\_\_\_

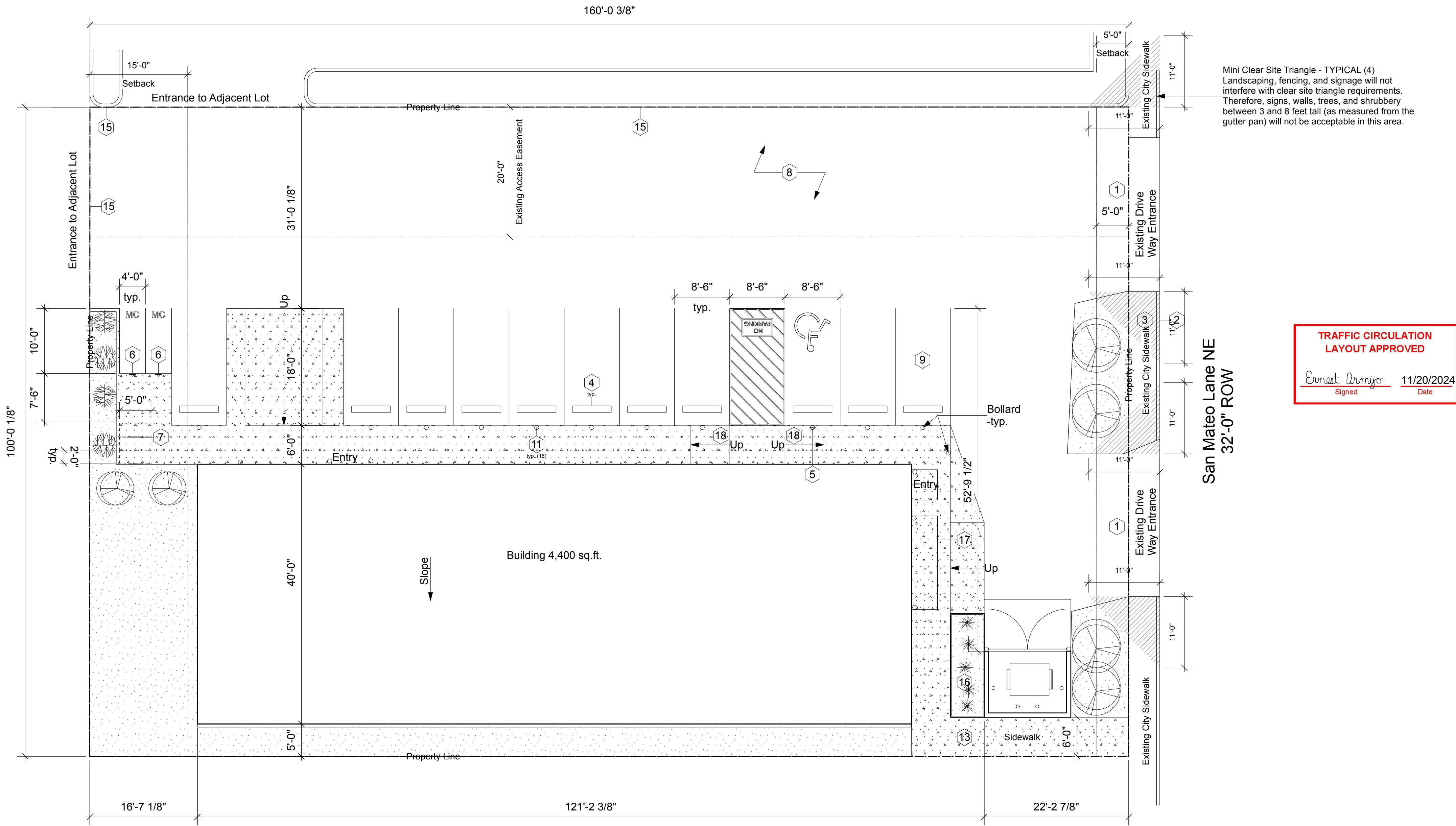

Mini Clear Site Triangle - TYPICAL (4)  
Landscaping, fencing, and signage will not interfere with clear site triangle requirements. Therefore, signs, walls, trees, and shrubbery between 3 and 8 feet tall (as measured from the gutter pan) will not be acceptable in this area.

TRAFFIC CIRCULATION  
LAYOUT APPROVED  
*Ernest Druyma* 11/20/2024  
Signed Date

PROJECT SUMMARY

Construct new metal building for storage uses.

PROJECT INFORMATION

PROJECT ADDRESS

4714 SAN MATEO LANE  
ALBUQUERQUE NM 87109

APPLICABLE CODES

2024 UAC  
2021 International Building Code  
2021 International Existing Building Code  
2021 IFC  
2021 Uniform Plumbing Code  
2021 Uniform Mechanical Code  
2020 National Electrical Code  
2021 International Energy Conservation Code  
2021 ICC

ZONING

MX-H

KEYED NOTES

- EXISTING CONCRETE DRIVEPAD PER CITY OF ALBUQUERQUE STANDARD SPECIFICATION. REFER TO CITY STANDARD DETAIL 2425 SEE DETAIL TCL SHEET
- EXISTING CONCRETE CURB AND GUTTER PER CITY OF ALBUQUERQUE STANDARD SPECIFICATION. REFER TO CITY STANDARD DETAIL 2415A SEE DETAIL TCL SHEET
- EXISTING CONCRETE SIDEWALK PER CITY OF ALBUQUERQUE STANDARD SPECIFICATION. REFER TO CITY STANDARD DETAIL 2430 SEE DETAIL TCL SHEET
- 6' X 5.75' X 4" H WHEEL STOP. PROVIDE (2) 18" LONG #4 REBAR STAKES AT EA. STOP WITH IN PARKING SPACES AS INDICATED SEE DETAIL TCL SHEET
- ADA ACCESSIBLE PARKING SIGN SEE DETAIL TCL SHEET
- MOTORCYCLE PARKING SIGN SEE DETAIL TCL SHEET
- BICYCLE RACK SEE DETAIL TCL SHEET
- PARKING AND DRIVE AISLE FOR FIRE APPARATUS ACCESS ROADS SHALL HAVE AN ASPHALT, CONCRETE SURFACE CAPABLE OF SUPPORTING THE IMPOSED LOAD OF APPARATUS WEIGHING AT LEAST 75,000 POUNDS. CONTRACTOR TO PROVIDE ENGINEER DATA FOR APPROVAL.
- PARKING STRIPING 2" WIDE X 2' O.C. DIAGONAL PAINT STRIPPING. SEE INDICATED LAYOUT WITH 3'X3' HANDICAP SYMBOL AND WORDS "NO PARKING" IN CAPITAL LETTERS 1" HIGH 2" STROKE AS CLOSE TO WHERE ADJACENT VEHICLES REAR TIRE WOULD BE PARKED. ALL STRIPPING IN BLUE
- ALL WHEELCHAIR RAMPS LOCATED WITHIN THE PUBLIC RIGHT OF WAY MUST HAVE TRUNCATED DOMES.
- 4" STEEL BOLLARD -SEE SWR #6
- ALL BROKEN OR CRACKED SIDEWALK MUST BE REPLACED WITH SIDEWALK AND CURB AND GUTTER PER CoA STD. DTL. 2415
- PROVIDE 6' WIDE ACCESSIBLE PATH (≤2.0% CROSS-SLOPE) ACROSS THE EXISTING DRIVE ENTRANCE WITH TRUNCATED DOMES AT EACH END.
- ALL INTERNAL RAMPS TO ADA ACCESSIBLE MAX SLOPE 1:12 WITH MAX 2% CROSS SLOPE LANDING AREA MIN. 5'X5' SEE CoA DWG 2430
- EXISTING CONCRETE CURB
- 12" RAISED PLANTER
- AWNING
- ALL INTERNAL RAMPS TO ADA ACCESSIBLE MAX SLOPE 1:12 WITH MAX 2% CROSS SLOPE LANDING AREA MIN. 5'X5' SEE CoA DWG 2430

LEGEND

- PROPERTY LINE
- NEW CONCRETE
- LANDSCAPE AREA

PARKING REQUIREMENTS

|                            |             |
|----------------------------|-------------|
| 1/3,000 GSF (Self Storage) | 4,400 = 1.4 |
| Total Spaces required      | = 1         |
| ADA (1 per Building)       | = 1         |
| Motorcycle                 | = 1         |
| Bicycle                    | = 3         |
| Total Spaces Required      | = 1         |
| Total Spaces Provided      | = 11        |

PROJECT AREA

STORAGE = 4,400 Sq. Ft. (Non-Sprinkled)

ALLOWABLE AREA = S-1 @ 17,500 sq.ft./ 2 Stories per tables 504.4 / 506.2

TREVESTON ELLIOTT  
ARCHITECT

811 12TH ST. NW  
ALBUQUERQUE, NEW MEXICO  
87102  
C 505.259.4617  
treveston@trevestonarchitect.com  
www.trevestonarchitect.com

Metal Building

4714 San Mateo Ave.

ALBUQUERQUE, NEW MEXICO 87109

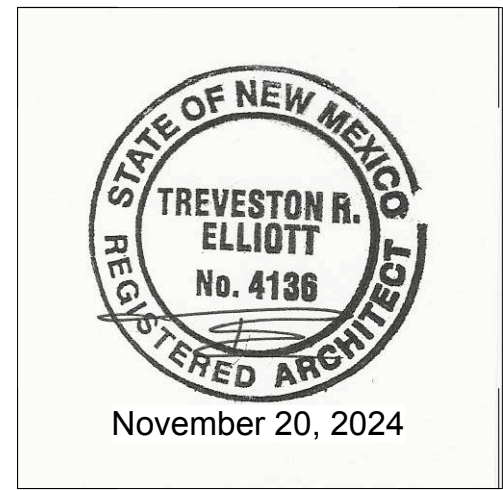

Date: November 20, 2024

Sheet: TCL

TCL